

| NO. | DATE | DESCRIPTION | BY | CHKD. | DATE | DESCRIPTION |
|--------|------------|---------------------------|-----|-------|------------|---------------------------|
| No. 1 | 11/25/2011 | Issue Book Description 1 | MRV | MRV | 11/25/2011 | Issue Book Description 1 |
| No. 2 | 11/25/2011 | Issue Book Description 2 | MRV | MRV | 11/25/2011 | Issue Book Description 2 |
| No. 3 | 11/25/2011 | Issue Book Description 3 | MRV | MRV | 11/25/2011 | Issue Book Description 3 |
| No. 4 | 11/25/2011 | Issue Book Description 4 | MRV | MRV | 11/25/2011 | Issue Book Description 4 |
| No. 5 | 11/25/2011 | Issue Book Description 5 | MRV | MRV | 11/25/2011 | Issue Book Description 5 |
| No. 6 | 11/25/2011 | Issue Book Description 6 | MRV | MRV | 11/25/2011 | Issue Book Description 6 |
| No. 7 | 11/25/2011 | Issue Book Description 7 | MRV | MRV | 11/25/2011 | Issue Book Description 7 |
| No. 8 | 11/25/2011 | Issue Book Description 8 | MRV | MRV | 11/25/2011 | Issue Book Description 8 |
| No. 9 | 11/25/2011 | Issue Book Description 9 | MRV | MRV | 11/25/2011 | Issue Book Description 9 |
| No. 10 | 11/25/2011 | Issue Book Description 10 | MRV | MRV | 11/25/2011 | Issue Book Description 10 |
| No. 11 | 11/25/2011 | Issue Book Description 11 | MRV | MRV | 11/25/2011 | Issue Book Description 11 |
| No. 12 | 11/25/2011 | Issue Book Description 12 | MRV | MRV | 11/25/2011 | Issue Book Description 12 |
| No. 13 | 11/25/2011 | Issue Book Description 13 | MRV | MRV | 11/25/2011 | Issue Book Description 13 |
| No. 14 | 11/25/2011 | Issue Book Description 14 | MRV | MRV | 11/25/2011 | Issue Book Description 14 |
| No. 15 | 11/25/2011 | Issue Book Description 15 | MRV | MRV | 11/25/2011 | Issue Book Description 15 |
| No. 16 | 11/25/2011 | Issue Book Description 16 | MRV | MRV | 11/25/2011 | Issue Book Description 16 |
| No. 17 | 11/25/2011 | Issue Book Description 17 | MRV | MRV | 11/25/2011 | Issue Book Description 17 |
| No. 18 | 11/25/2011 | Issue Book Description 18 | MRV | MRV | 11/25/2011 | Issue Book Description 18 |

| | |
|--------------|-------------|
| DATE: | 25 NOV 2011 |
| PROJECT NO.: | 9400 |
| DESIGNED BY: | MRV |
| CHECKED BY: | MRV |
| DATE: | |
| PROJECT NO.: | |
| DESIGNED BY: | |
| CHECKED BY: | |
| DATE: | |
| PROJECT NO.: | |
| DESIGNED BY: | |
| CHECKED BY: | |

NOTES:
 1. SOUNDINGS ARE IN FEET AND TENTHS AND REFER TO MEAN LOW WATER.
 2. HORIZONTAL DATUM IS SOUTH CAROLINA STATE PLANE COORDINATES NAD 1983.
 3. THE SOUNDINGS ON THIS DRAWING ONLY INDICATE THE GENERAL CONDITION OF THE CHANNEL ON THE DATE OF SURVEY.
 4. DATE OF SURVEY: 13 NOV. 2011 CONDITION

CLARK CREEK CHANNEL
 GEORGETOWN, CHARLESTON, COUNTIES, SOUTH CAROLINA
 9400

Submitted by: _____
 Chief, Navigation Section
 Approval Recommended: _____
 Chief, Construction-Operations Branch
 Approved by: _____
 Chief, Technical Services Division

SHEET 1 OF 3

428.000

427.000

426.000

425.000

424.000

2,466,000

2,467,000

2,468,000

2,469,000

2,470,000

2,471,000

2,472,000

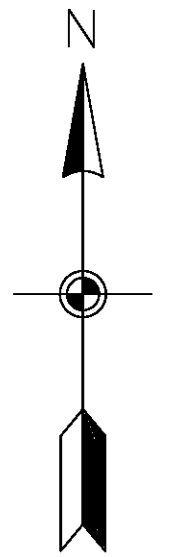

- NOTES:
1. SOUNDINGS ARE IN FEET AND TENTHS AND REFER TO MEAN LOWER LOW WATER.
 2. HORIZONTAL DATUM IS SOUTH CAROLINA STATE PLANE COORDINATES NAD 1983.
 3. THE SOUNDINGS ON THIS DRAWING ONLY INDICATE THE GENERAL CONDITION OF THE CHANNEL ON THE DATE OF SURVEY.
 4. DATE OF SURVEY: 3 NOV. 2011 CONDITION

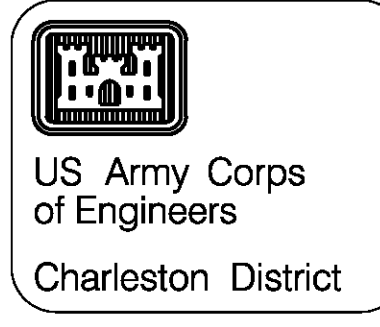
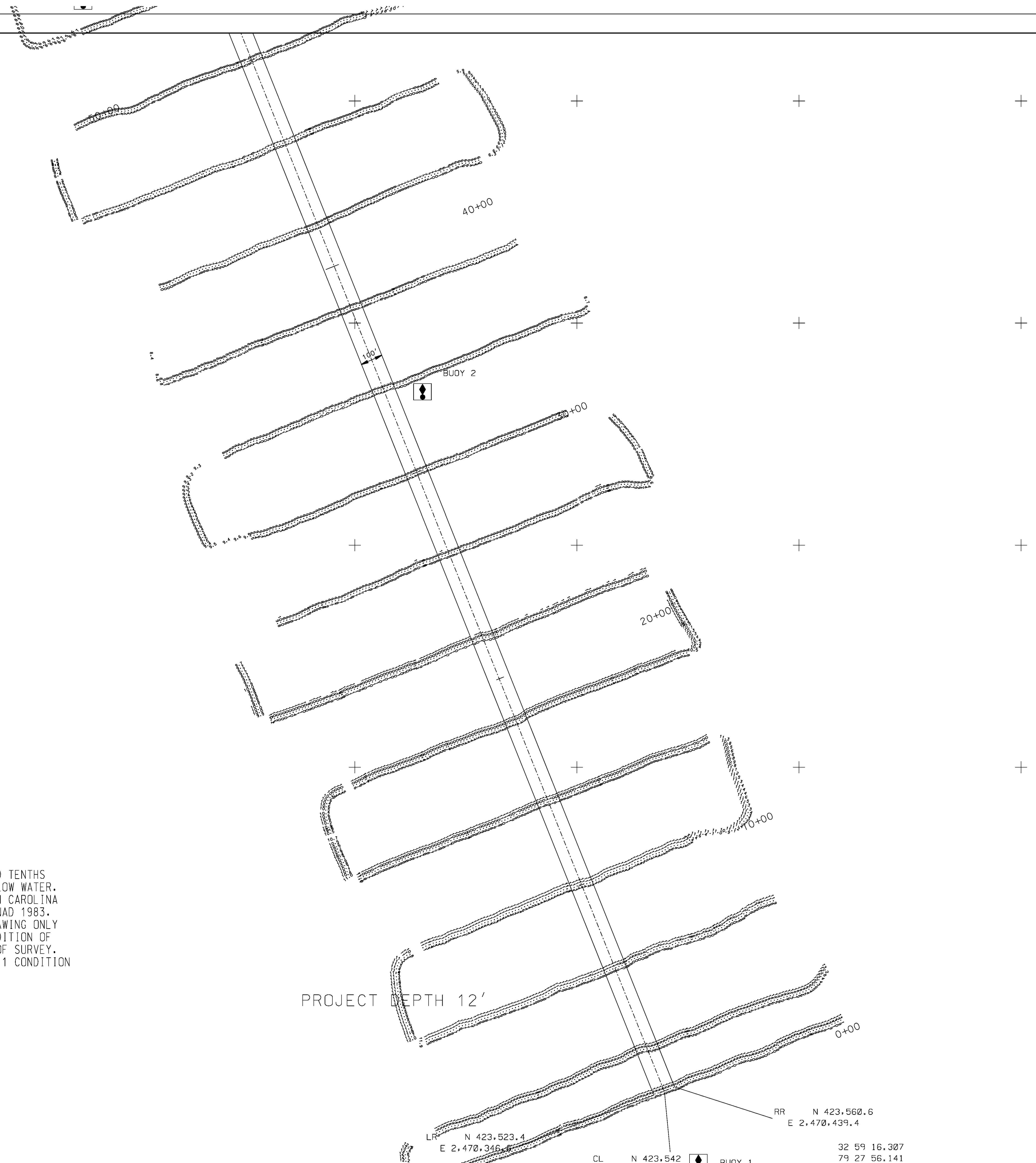

| No. | Date | Description | DATE | APPROV. | DESCRIPTION |
|--------|---------|----------------|------|---------|-------------|
| No. 1 | Date 1 | Description 1 | DATE | APPROV. | DESCRIPTION |
| No. 2 | Date 2 | Description 2 | DATE | APPROV. | DESCRIPTION |
| No. 3 | Date 3 | Description 3 | DATE | APPROV. | DESCRIPTION |
| No. 4 | Date 4 | Description 4 | DATE | APPROV. | DESCRIPTION |
| No. 5 | Date 5 | Description 5 | DATE | APPROV. | DESCRIPTION |
| No. 6 | Date 6 | Description 6 | DATE | APPROV. | DESCRIPTION |
| No. 7 | Date 7 | Description 7 | DATE | APPROV. | DESCRIPTION |
| No. 8 | Date 8 | Description 8 | DATE | APPROV. | DESCRIPTION |
| No. 9 | Date 9 | Description 9 | DATE | APPROV. | DESCRIPTION |
| No. 10 | Date 10 | Description 10 | DATE | APPROV. | DESCRIPTION |
| No. 11 | Date 11 | Description 11 | DATE | APPROV. | DESCRIPTION |
| No. 12 | Date 12 | Description 12 | DATE | APPROV. | DESCRIPTION |
| No. 13 | Date 13 | Description 13 | DATE | APPROV. | DESCRIPTION |
| No. 14 | Date 14 | Description 14 | DATE | APPROV. | DESCRIPTION |
| No. 15 | Date 15 | Description 15 | DATE | APPROV. | DESCRIPTION |
| No. 16 | Date 16 | Description 16 | DATE | APPROV. | DESCRIPTION |
| No. 17 | Date 17 | Description 17 | DATE | APPROV. | DESCRIPTION |
| No. 18 | Date 18 | Description 18 | DATE | APPROV. | DESCRIPTION |
| No. 19 | Date 19 | Description 19 | DATE | APPROV. | DESCRIPTION |
| No. 20 | Date 20 | Description 20 | DATE | APPROV. | DESCRIPTION |

DATE: 25 NOV 2011

DESIGN NO.: 9400

DESIGNER: MFR

REVIEWER:

DATE: 25 NOV 2011

SCALE: 1" = 200'

U.S. ARMY ENGINEER DISTRICT
CHARLESTON, SOUTH CAROLINA

CLARK CREEK
9400
NEW CHANNEL

SHEET 2 OF 3

| No. | DATE | DESCRIPTION |
|--------|------|-------------|
| No. 1 | DATE | DESCRIPTION |
| No. 2 | DATE | DESCRIPTION |
| No. 3 | DATE | DESCRIPTION |
| No. 4 | DATE | DESCRIPTION |
| No. 5 | DATE | DESCRIPTION |
| No. 6 | DATE | DESCRIPTION |
| No. 7 | DATE | DESCRIPTION |
| No. 8 | DATE | DESCRIPTION |
| No. 9 | DATE | DESCRIPTION |
| No. 10 | DATE | DESCRIPTION |
| No. 11 | DATE | DESCRIPTION |
| No. 12 | DATE | DESCRIPTION |
| No. 13 | DATE | DESCRIPTION |
| No. 14 | DATE | DESCRIPTION |
| No. 15 | DATE | DESCRIPTION |
| No. 16 | DATE | DESCRIPTION |
| No. 17 | DATE | DESCRIPTION |
| No. 18 | DATE | DESCRIPTION |
| No. 19 | DATE | DESCRIPTION |
| No. 20 | DATE | DESCRIPTION |

| | |
|-------------------|-------------------|
| DATE: 25 NOV 2011 | DESIGN NO: 9400 |
| DESIGNED BY: MFW | CHECKED BY: |
| DATE: 25 NOV 2011 | DATE: 25 NOV 2011 |
| SCALE: 1" = 200' | |

CLARK CREEK
CONDITION
PROPOSED NEW CHANNEL
9400

- NOTES:
 1. SOUNDINGS ARE IN FEET AND TENTHS AND REFER TO MEAN LOWER LOW WATER.
 2. HORIZONTAL DATUM IS SOUTH CAROLINA STATE PLANE COORDINATES NAD 1983.
 3. THE SOUNDINGS ON THIS DRAWING ONLY INDICATE THE GENERAL CONDITION OF THE CHANNEL ON THE DATE OF SURVEY.
 4. DATE OF SURVEY: 3 NOV. 2011 CONDITION

