

JOINT PUBLIC NOTICE

**CHARLESTON DISTRICT, CORPS OF ENGINEERS
69A Hagood Avenue
Charleston, South Carolina 29403-5107**

**And the
S.C. DEPARTMENT OF HEALTH AND ENVIRONMENTAL CONTROL
OFFICE OF OCEAN AND COASTAL RESOURCE MANAGEMENT
1362 McMillan Avenue, Suite 400
Charleston, South Carolina 29405**

REGULATORY DIVISION

Refer to: P/N #2015-00399-2IY

3 April 2015

Pursuant to Section 10 of the Rivers and Harbors Act of 1899 (33 U.S.C. 403), Section 401 of the Clean Water Act (33 U.S.C. 1341), and the South Carolina Coastal Zone Management Act (48-39-10 et seq.), an application has been submitted to the Department of the Army and the South Carolina Department of Health and Environmental Control by

**DANIEL ISLAND ASSOCIATES, LLC
ATTN: BILL MCKENZIE
230 SEVEN FARMS DRIVE, SUITE 201
CHARLESTON, SOUTH CAROLINA 29492**

for a permit to construct a private recreational dock on

BERESFORD CREEK

at Lot EH-A7 in Parcel E, Phase 2 on the north end of Daniel Island off an extension of Brailsford Street in the City of Charleston, Berkeley County, South Carolina (Latitude 32.88991 North, Longitude -79.90366 West)

In order to give all interested parties an opportunity to express their views

NOTICE

is hereby given that written statements regarding the proposed work will be received by the Corps until

15 Days from the Date of this Notice,

and **SCDHEC** will receive written statements regarding the proposed work until

30 Days from the Date of this Notice

from those interested in the activity and whose interests may be affected by the proposed work.

The proposed work consists of constructing a 5' x 451.34' walkway leading to a 10' x 16' covered pierhead. A gangway attached to the pierhead will lead to a 10' x 20' floating dock. The purpose of the proposed project is to provide access to Beresford Creek for private recreational use.

REGULATORY DIVISION

Refer to: P/N #2015-00399-2IY

3 April 2015

NOTE: Plans depicting the work described in this notice are available and will be provided, upon receipt of a written request, to anyone that is interested in obtaining a copy of the plans for the specific project. The request must identify the project of interest by public notice number and a self-addressed stamped envelope must also be provided for mailing the drawings to you. Your request for drawings should be addressed to the

**U.S. Army Corps of Engineers
ATTN: REGULATORY DIVISION
69A Hagood Avenue
Charleston, South Carolina 29403-5107**

The District Engineer has concluded that the discharges associated with this project, both direct and indirect, should be reviewed by the South Carolina Department of Health and Environmental Control in accordance with provisions of Section 401 of the Clean Water Act. As such, this notice constitutes a request, on behalf of the applicant, for certification that this project will comply with applicable effluent limitations and water quality standards (Section 401 of the Clean Water Act). The District Engineer will not process this application to a conclusion until such certification is received. The applicant is hereby advised that supplemental information may be required by the State to facilitate the review. Persons wishing to comment or object to Water Quality Certification must submit all comments in writing to the S.C. Department of Health and Environmental Control at the above address within thirty (30) days of the date of this notice.

This notice initiates the Essential Fish Habitat (EFH) consultation requirements of the Magnuson-Stevens Fishery Conservation and Management Act. Implementation of the proposed project would impact 0.008 acres of estuarine substrates utilized by various life stages of species comprising the shrimp and snapper-grouper management complexes. Our initial determination is that the proposed action would not have a substantial individual or cumulative adverse impact on EFH or fisheries managed by the South Atlantic Fishery Management Council and the National Marine Fisheries Service (NMFS). Our final determination relative to project impacts and the need for mitigation measures is subject to review by and coordination with the NMFS.

The District Engineer has consulted the most recently available information and has determined that the project will have no effect on any Federally endangered, threatened, or proposed species and will not result in the destruction or adverse modification of designated or proposed critical habitat. This public notice serves as a request to the U.S. Fish and Wildlife Service and the National Marine Fisheries Service for any additional information they may have on whether any listed or proposed endangered or threatened species or designated or proposed critical habitat may be present in the area which would be affected by the activity, pursuant to Section 7(c) of the Endangered Species Act of 1973 (as amended).

Pursuant to Section 106 of the National Historic Preservation Act (NHPA), this public notice also constitutes a request to Indian Tribes to notify the District Engineer of any historic properties of religious and cultural significance to them that may be affected by the proposed undertaking.

REGULATORY DIVISION

Refer to: P/N #2014-00399-2IY

3 April 2015

In accordance with the NHPA, the District Engineer has also consulted the latest published version of the National Register of Historic Places for the presence or absence of registered properties, or properties listed as being eligible for inclusion therein, and this worksite is not included as a registered property or property listed as being eligible for inclusion in the Register. To insure that other cultural resources that the District Engineer is not aware of are not overlooked, this public notice also serves as a request to the State Historic Preservation Office to provide any information it may have with regard to historic and cultural resources.

Any person may request, in writing, within the comment period specified in this notice, that a public hearing be held to consider this application. Requests for a public hearing shall state, with particularity, the reasons for holding a public hearing.

The decision whether to issue a permit will be based on an evaluation of the probable impact including cumulative impacts of the activity on the public interest. That decision will reflect the national concern for both protection and utilization of important resources. The benefit which reasonably may be expected to accrue from the project must be balanced against its reasonably foreseeable detriments. All factors which may be relevant to the project will be considered including the cumulative effects thereof; among those are conservation, economics, aesthetics, general environmental concerns, wetlands, historic properties, fish and wildlife values, flood hazards, flood plain values, land use, navigation, shoreline erosion and accretion, recreation, water supply and conservation, water quality, energy needs, safety, food and fiber production and, in general, the needs and welfare of the people. A permit will be granted unless the District Engineer determines that it would be contrary to the public interest. In cases of conflicting property rights, the Corps of Engineers cannot undertake to adjudicate rival claims.

The Corps of Engineers is soliciting comments from the public; Federal, state, and local agencies and officials; Indian Tribes; and other interested parties in order to consider and evaluate the impacts of this activity. Any comments received will be considered by the Corps of Engineers to determine whether to issue, modify, condition or deny a permit for this project. To make this decision, comments are used to assess impacts on endangered species, historic properties, water quality, general environmental effects, and the other public interest factors listed above. Comments are used in the preparation of an Environmental Assessment and/or an Environmental Impact Statement pursuant to the National Environmental Policy Act. Comments are also used to determine the need for a public hearing and to determine the overall public interest of the activity.

If there are any questions concerning this public notice, please contact David Chamberlain at 843-329-8044 or toll free at 1-866-329-8187.

N:\21272.0003\Engineering\Drawings\Exhibits\COMMUNITY DOCK 05-E-1-D-VICINITY.dwg - Feb 13, 2015 - 11:52:34 PM

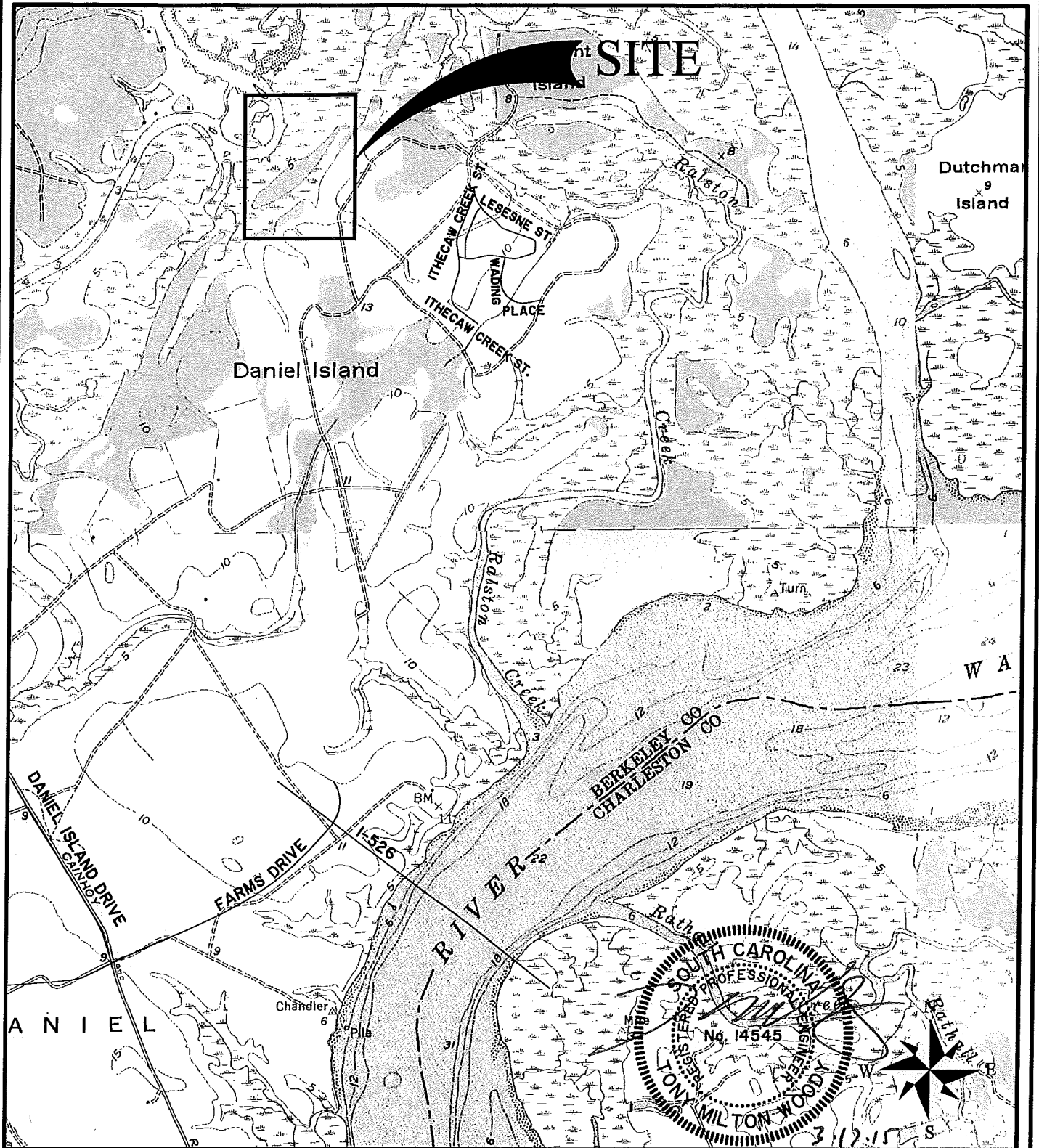

DANIEL ISLAND PARCEL E EH-A7 DOCK

VICINITY MAP *SAC 2015-00399-21Y*

APPLICANT:
DANIEL ISLAND ASSOCIATES, LLC

LOCATION: DANIEL ISLAND (BERKLEY), SC
DATE: March 13, 2015
JOB NUMBER: J- 21272.0003

SHEET: 01
SCALE: 1"=2000'

THOMAS & HUTTON
Engineering | Surveying | Planning | GIS | Consulting

682 Johnnie Dodds Blvd. • Suite 100
Mt. Pleasant, SC 29464 • 843.849.0200

www.thomasandhutton.com

N:\21272.0003\Engineering\Drawings\Exhibits\COMMUNITY DOCK DS-E\02-LOCATION.dwg - Feb 13, 2015 - 1:53:23 PM

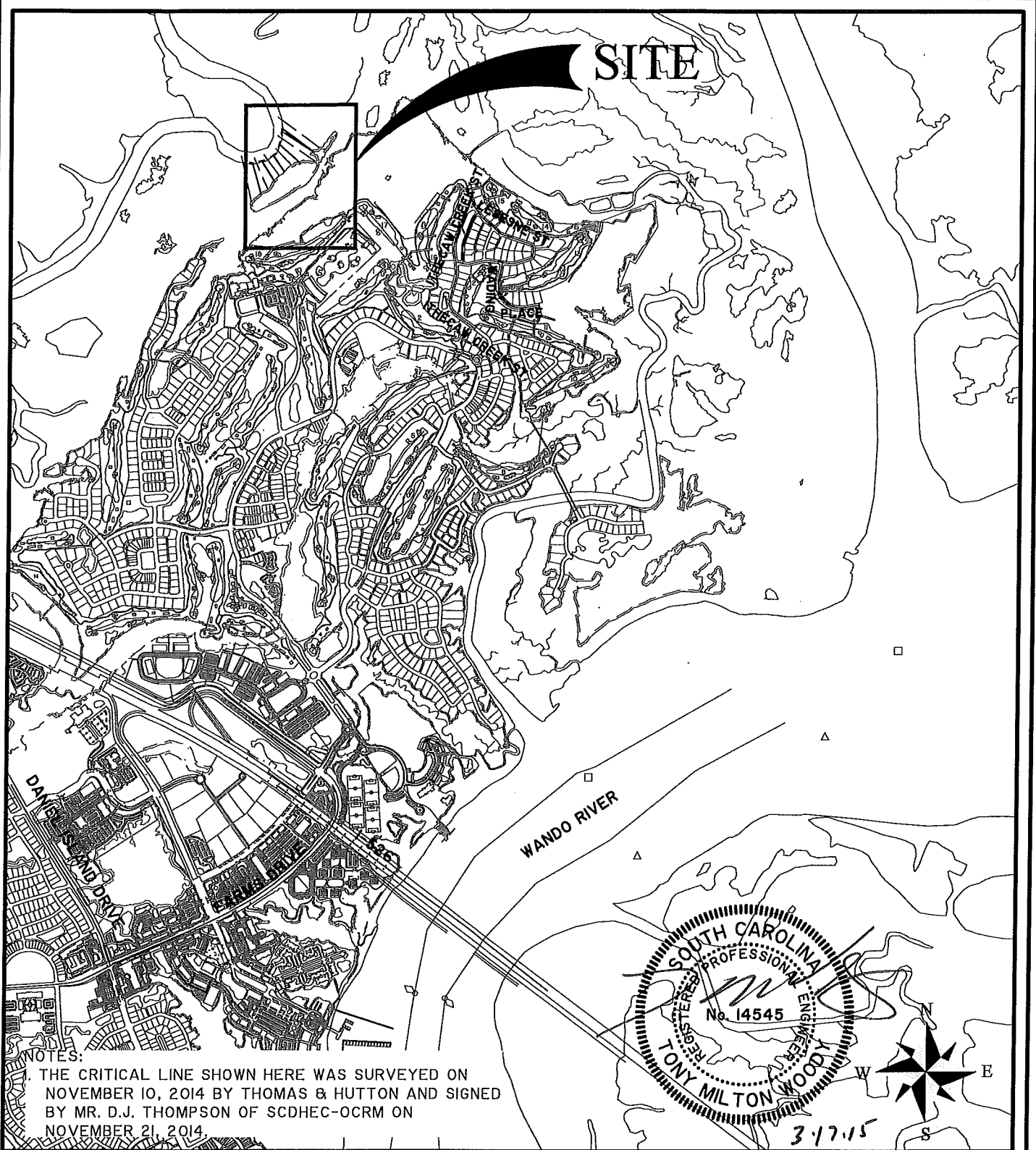

NOTES:

1. THE CRITICAL LINE SHOWN HERE WAS SURVEYED ON NOVEMBER 10, 2014 BY THOMAS & HUTTON AND SIGNED BY MR. D.J. THOMPSON OF SCDHEC-OCRM ON NOVEMBER 21, 2014

DANIEL ISLAND PARCEL E EH-A7 DOCK

LOCATION MAP SAC 2015-00399-2 E y

APPLICANT:
DANIEL ISLAND ASSOCIATES, LLC

LOCATION: DANIEL ISLAND (BERKLEY), SC
DATE: March 13, 2015
JOB NUMBER: J - 21272.0003

SHEET: 02
SCALE: 1"=2000'

THOMAS & HUTTON
Engineering | Surveying | Planning | GIS | Consulting

682 Johnnie Dodds Blvd. • Suite 100
Mt. Pleasant, SC 29464 • 843.849.0200

www.thomasandhutton.com

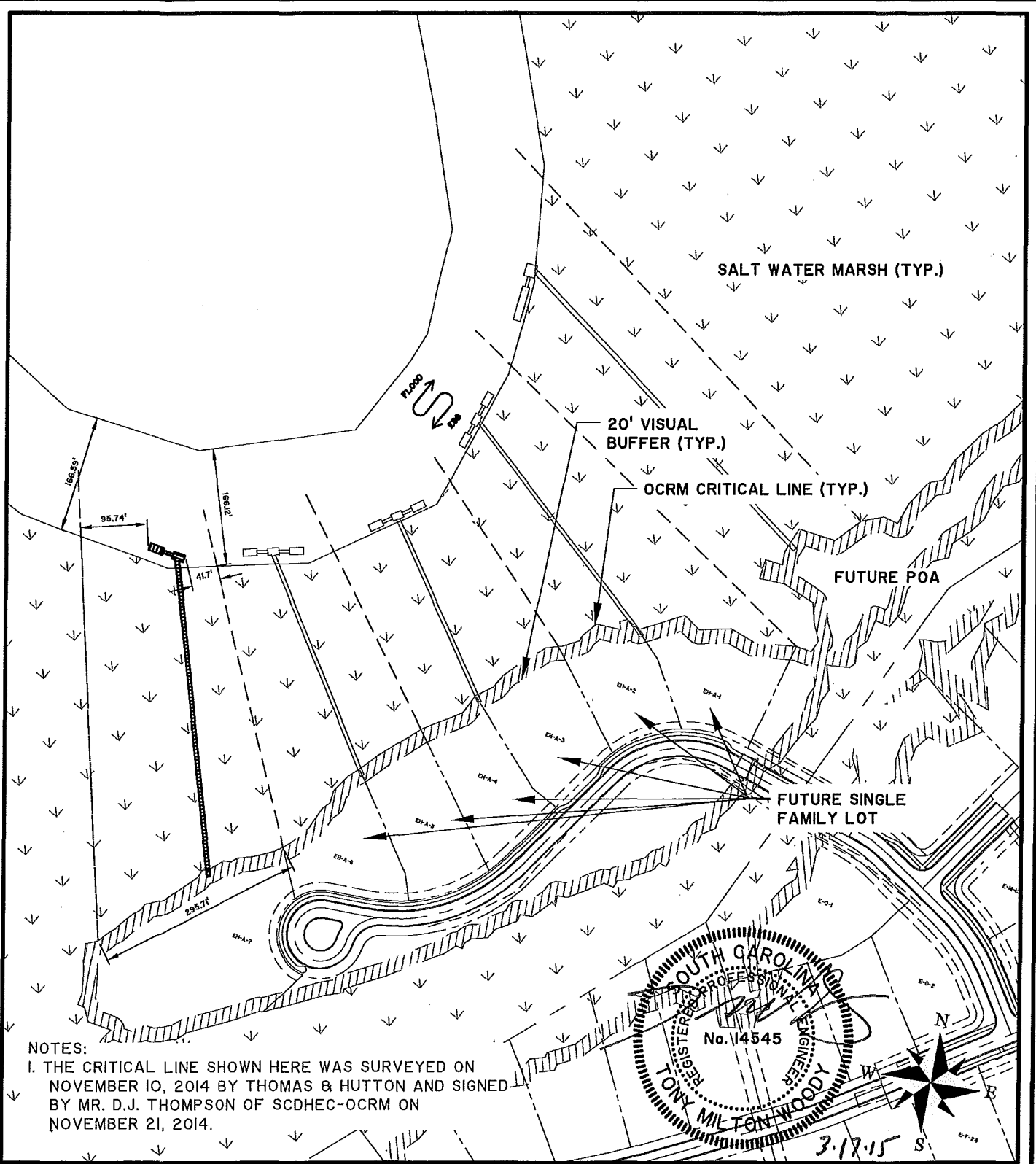

NOTES:
 1. THE CRITICAL LINE SHOWN HERE WAS SURVEYED ON NOVEMBER 10, 2014 BY THOMAS & HUTTON AND SIGNED BY MR. D.J. THOMPSON OF SCDHEC-OCRM ON NOVEMBER 21, 2014.

REGISTERED PROFESSIONAL ENGINEER
 SOUTH CAROLINA
 No. 14545
 MILTON WOOD
 3.17.15 S

DANIEL ISLAND PARCEL E EH-A7 DOCK

LOCATION OF DOCK *SAC 2015-00399-2FY*

APPLICANT:
DANIEL ISLAND ASSOCIATES, LLC

LOCATION: DANIEL ISLAND (BERKLEY), SC
 DATE: March 13, 2015
 JOB NUMBER: J - 21272.0003

SHEET: 03
 SCALE: 1"=100'

THOMAS & HUTTON
 Engineering | Surveying | Planning | GIS | Consulting

682 Johnnie Dodds Blvd. • Suite 100
 Mt. Pleasant, SC 29464 • 843.849.0200

www.thomasandhutton.com

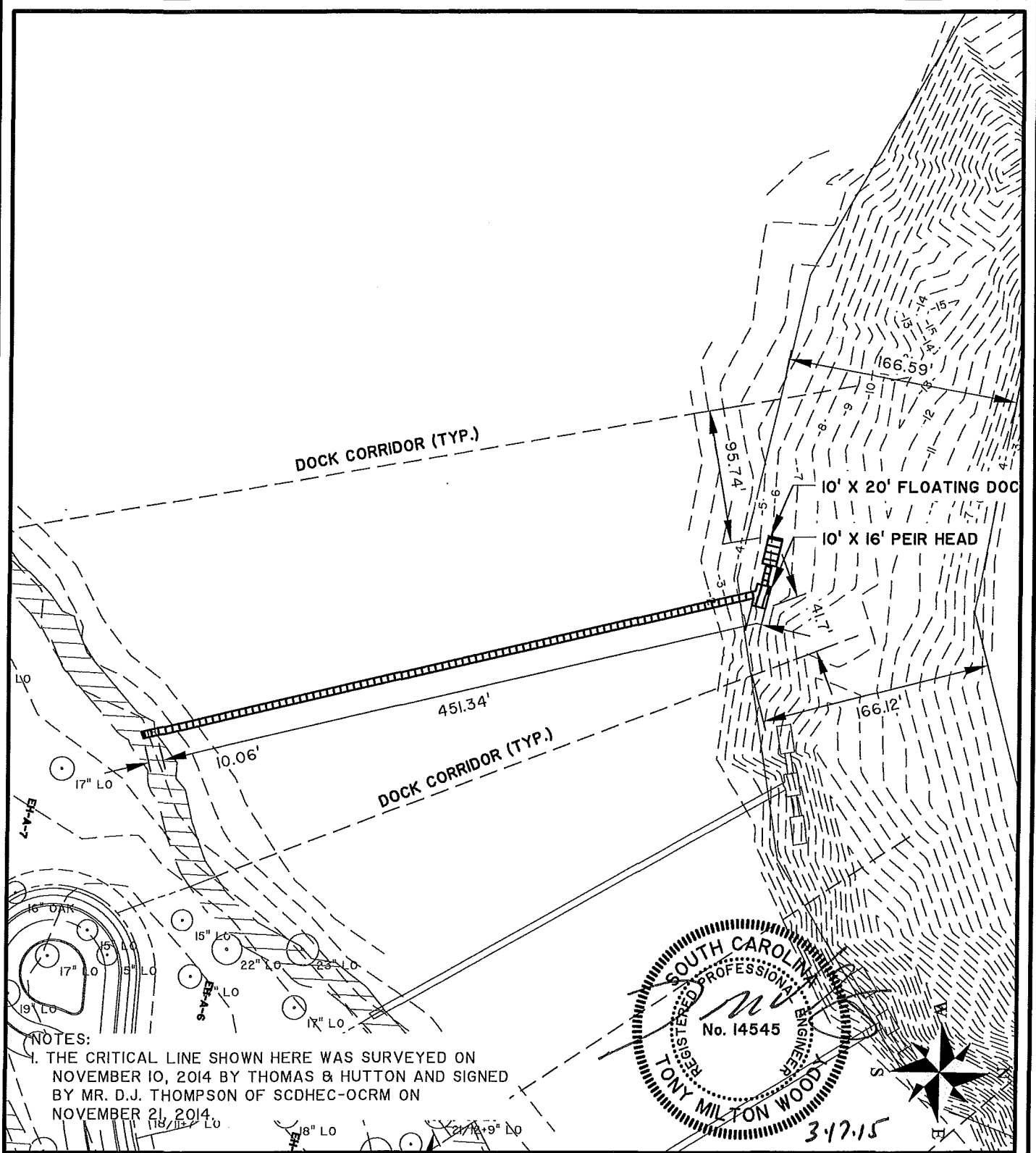

NOTES:

1. THE CRITICAL LINE SHOWN HERE WAS SURVEYED ON NOVEMBER 10, 2014 BY THOMAS & HUTTON AND SIGNED BY MR. D.J. THOMPSON OF SCDHEC-OCRM ON NOVEMBER 21, 2014.

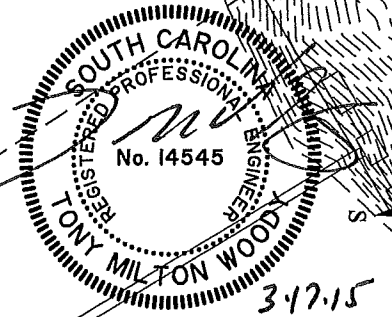

DANIEL ISLAND PARCEL E EH-A7 DOCK

PLAN VIEW SAC 2015-00399-2 I Y

APPLICANT: DANIEL ISLAND ASSOCIATES, LLC

LOCATION: DANIEL ISLAND (BERKLEY), SC
DATE: March 13, 2015
JOB NUMBER: J- 21272.0003

SHEET: 04
SCALE: 1"=100'



682 Johnnie Dodds Blvd. • Suite 100
Mt. Pleasant, SC 29464 • 843.849.0200

www.thomasandhutton.com

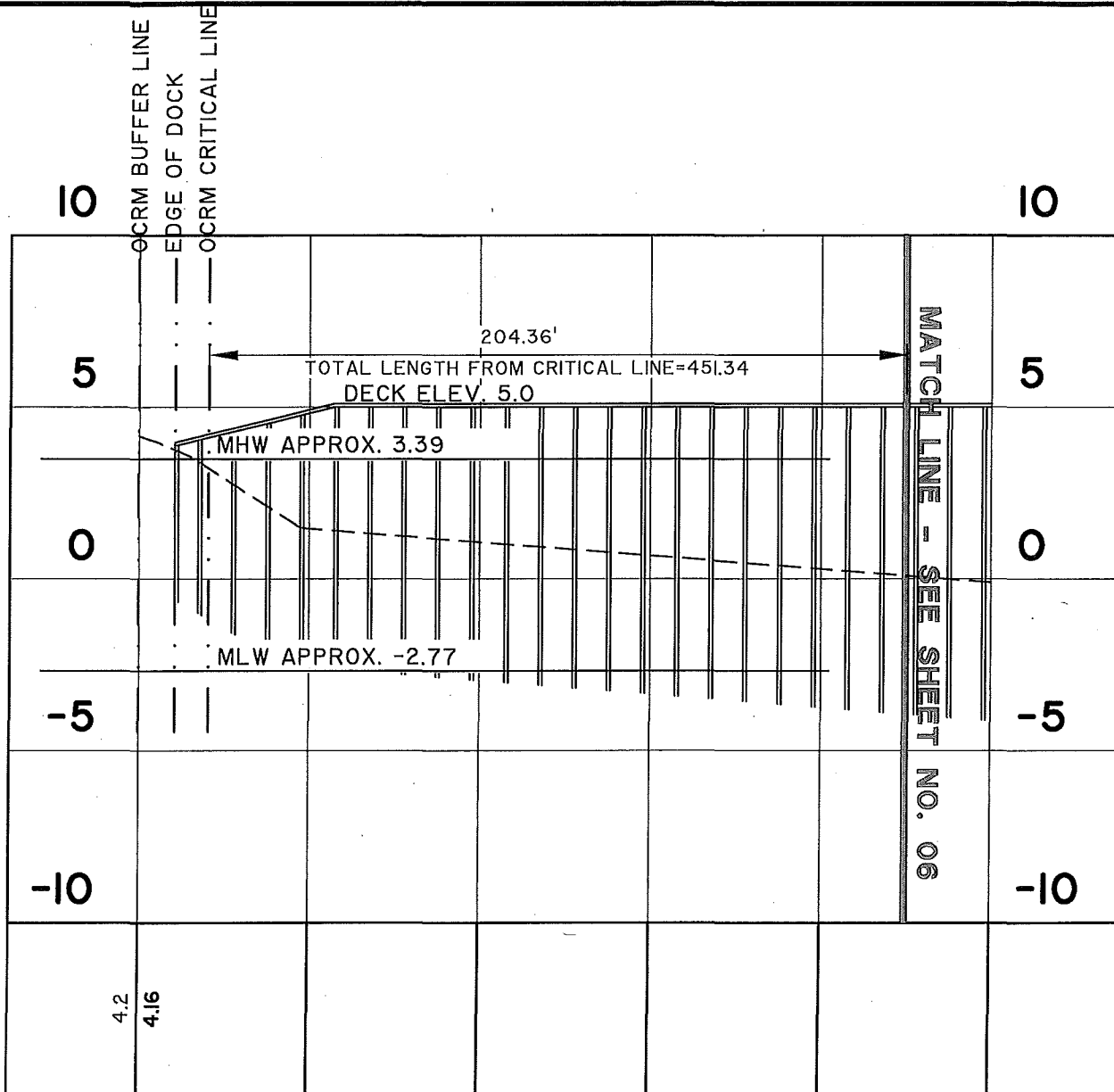

ALIGNMENT - EH-A7 DOCK

STATIONS: 0+00 - 2+50

SCALE: HORZ.: 1" = 50'

VERT.: 1" = 5'

NOTES:

- 1. THE CRITICAL LINE SHOWN HERE WAS SURVEYED ON NOVEMBER 10, 2014 BY THOMAS & HUTTON AND SIGNED BY MR. D.J. THOMPSON OF SCDHEC-OCRМ ON NOVEMBER 21, 2014.

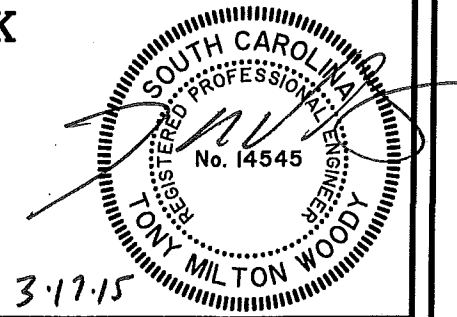

DANIEL ISLAND PARCEL E EH-A7 DOCK

DOCK PROFILES SAC 2015-00399-2EY

APPLICANT:

DANIEL ISLAND ASSOCIATES, LLC

LOCATION: DANIEL ISLAND (BERKLEY), SC

DATE: March 13, 2015

JOB NUMBER: J - 21272.0003

SHEET: 05

SCALE: 1"=50'



THOMAS & HUTTON

Engineering | Surveying | Planning | GIS | Consulting

682 Johnnie Dodds Blvd. • Suite 100
Mt. Pleasant, SC 29464 • 843.849.0200

www.thomasandhutton.com

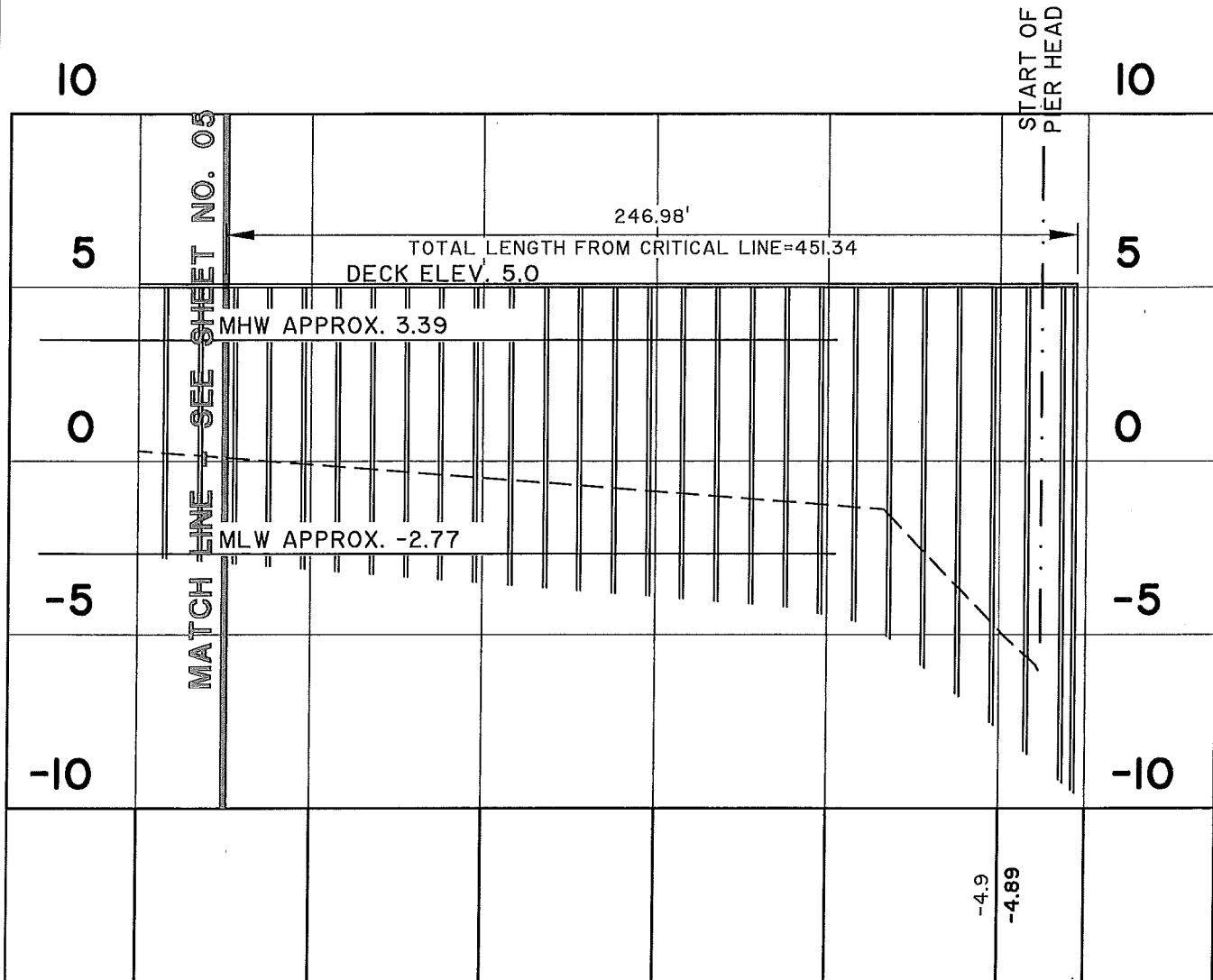

ALIGNMENT - EH-A7 DOCK

STATIONS: 2+00 - 4+75

SCALE: HORZ.: 1" = 50'

VERT.: 1" = 5'

NOTES:

- I. THE CRITICAL LINE SHOWN HERE WAS SURVEYED ON NOVEMBER 10, 2014 BY THOMAS & HUTTON AND SIGNED BY MR. D.J. THOMPSON OF SCDHEC-OCRM ON NOVEMBER 21, 2014.

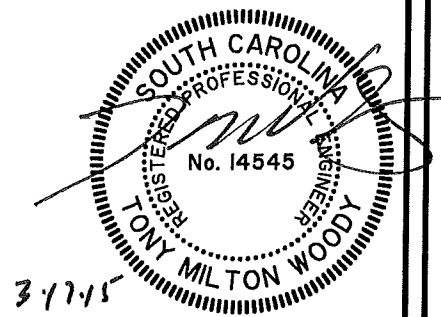

DANIEL ISLAND PARCEL E EH-A7 DOCK

DOCK PROFILES (CONT.) SAC 2015-00399-21Y

APPLICANT:

DANIEL ISLAND ASSOCIATES, LLC

LOCATION: DANIEL ISLAND (BERKLEY), SC

DATE: March 13, 2015

JOB NUMBER: J - 21272.0003

SHEET: 06

SCALE: 1"=50'



THOMAS & HUTTON
Engineering | Surveying | Planning | GIS | Consulting

682 Johnnie Dodds Blvd. • Suite 100
Mt. Pleasant, SC 29464 • 843.849.0200

www.thomasandhutton.com

\\21272.0003\Engineering\Drawings\Exhibits\COMMUNITY DOCK OS-E-07 - CROSS SECTION.dwg - Feb 13, 2015 - 1:57:20 PM

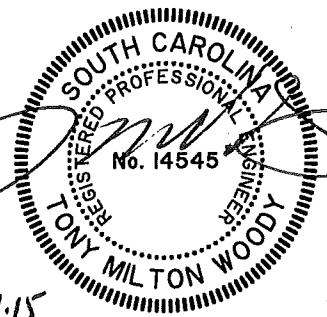
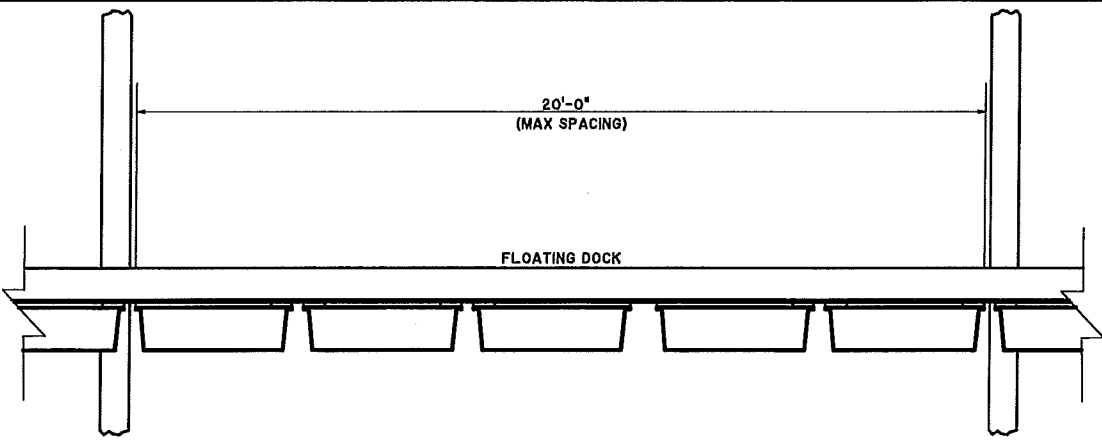
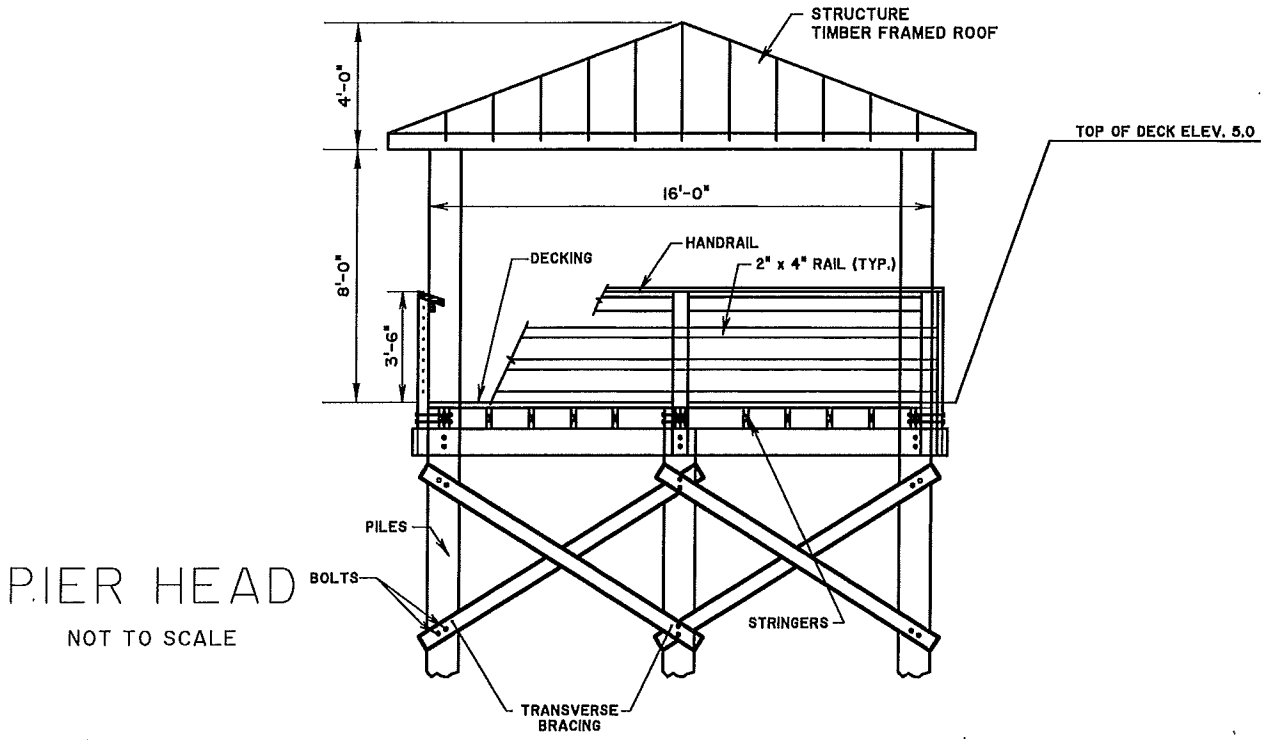

3-17-15

DANIEL ISLAND PARCEL E EH-A7 DOCK

CROSS SECTION SAC 2015-00399-2IY

APPLICANT:
DANIEL ISLAND ASSOCIATES, LLC

LOCATION: DANIEL ISLAND (BERKLEY), SC
DATE: March 13, 2015
JOB NUMBER: J - 21272.0003

SHEET: 07
SCALE: NTS



682 Johnnie Dodds Blvd. • Suite 100
Mt. Pleasant, SC 29464 • 843.849.0200

www.thomasandhutton.com

N:\21272.0003\Engineering\Drawings\Exhibits\COMMUNITY DOCK 05-E-1.5 - COMMUNITY DOCK PIER HEAD.dwg - Feb 13, 2015 - 1:57:02 PM

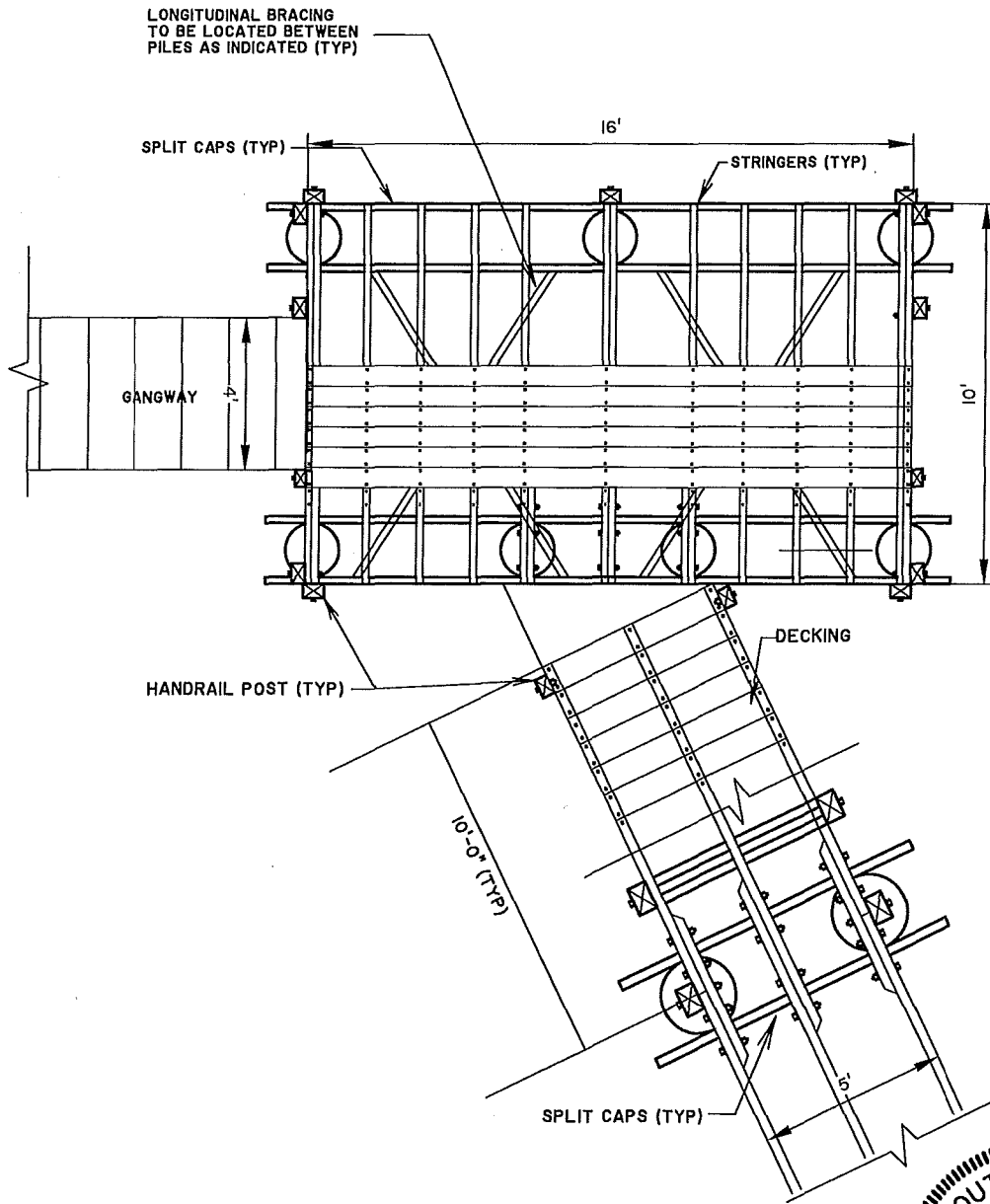

3-17-15

SOUTH CAROLINA
 REGISTERED PROFESSIONAL ENGINEER
 No. 14545
MILTON WOODY

DANIEL ISLAND PARCEL E EH-A7 DOCK

PIERHEAD DETAIL *SAK 2015-00399-2 IY*

APPLICANT:
DANIEL ISLAND ASSOCIATES, LLC

LOCATION: DANIEL ISLAND (BERKLEY), SC
DATE: March 13, 2015
JOB NUMBER: J - 21272.0003

SHEET: 08
SCALE: NTS

THOMAS & HUTTON
Engineering | Surveying | Planning | GIS | Consulting

682 Johnnie Dodds Blvd. • Suite 100
Mt. Pleasant, SC 29464 • 843.849.0200

www.thomasandhutton.com

NS\21272.0003\Engineering\Drawings\Exhibits\DOCK EH-A7.09 - CREEK CROSS SECTION.dwg - Apr. 1, 2015 - 11:50:43 AM

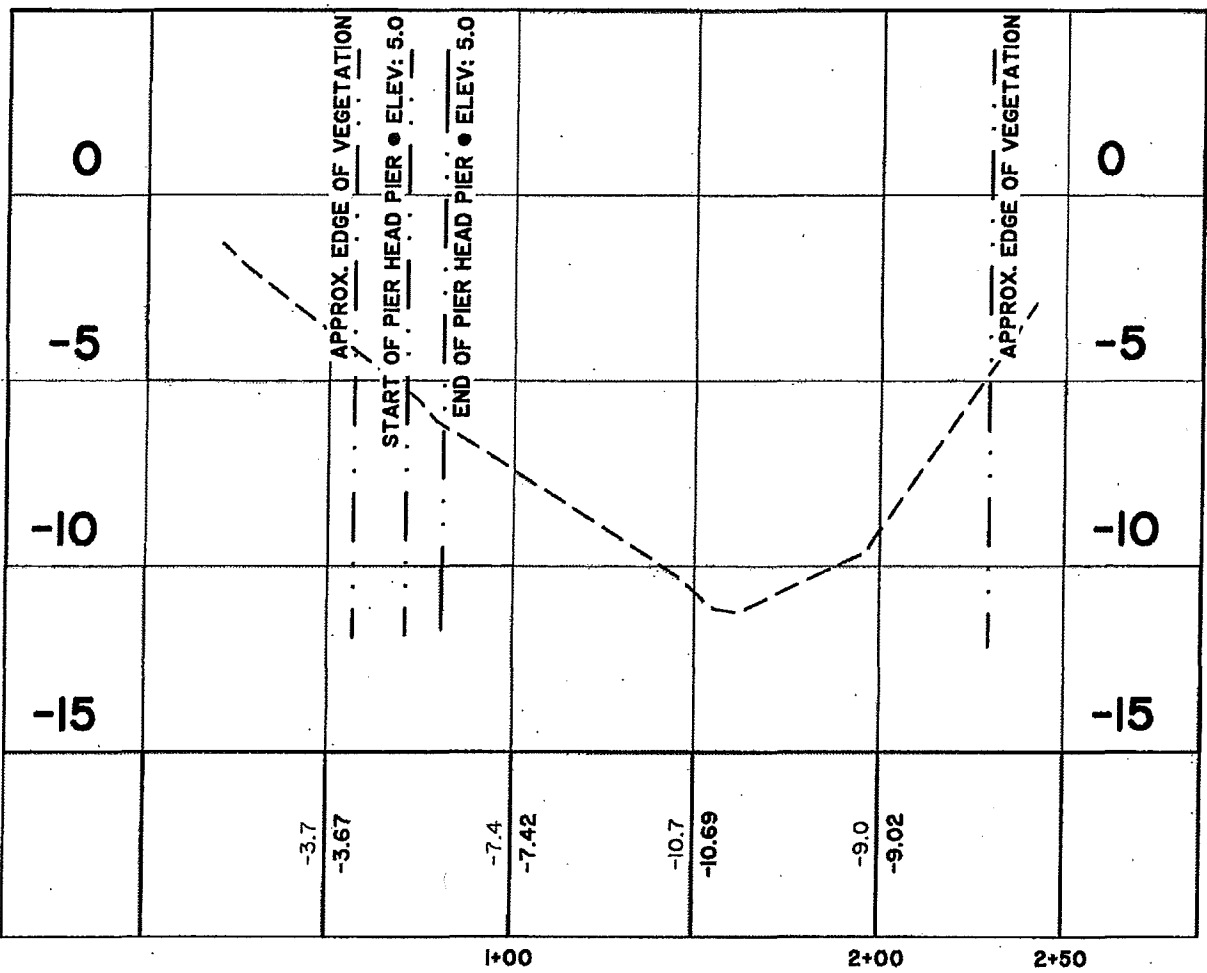

ALIGNMENT - EH-A7 CREEK CROSS SECTION

STATIONS: 0+00 - 2+50
 SCALE: HORZ.: 1" = 50'
 VERT.: 1" = 5'

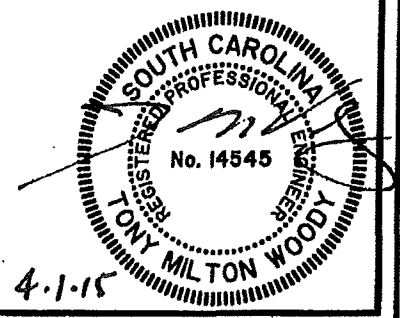

DANIEL ISLAND PARCEL E EH-A7 DOCK
 CREEK CROSS SECTION SAC2015-00399-21Y
 APPLICANT:
 DANIEL ISLAND ASSOCIATES, LLC
 LOCATION: DANIEL ISLAND (BERKELEY), SC
 DATE: March 13, 2015
 JOB NUMBER: J- 21272.0003

SHEET: 09
 SCALE: 1"=50'

THOMAS & HUTTON
 Engineering | Surveying | Planning | GIS | Consulting

682 Johnnie Dodds Blvd. • Suite 100
 Mt. Pleasant, SC 29464 • 843.849.0200

www.thomasandhutton.com