

**JOINT**  
**PUBLIC NOTICE**

**CHARLESTON DISTRICT, CORPS OF ENGINEERS**  
**69A Hagood Avenue**  
**Charleston, South Carolina 29403-5107**

and

**THE S.C. DEPARTMENT OF HEALTH AND ENVIRONMENTAL CONTROL**  
**Office of Environmental Quality Control**  
**Water Quality Certification and Wetlands Programs Section**  
**2600 Bull Street**  
**Columbia, South Carolina 29201**

REGULATORY DIVISION

Refer to: P/N # SAC 2010-01085-DS

August 12, 2014

Pursuant to Section 10 of the Rivers and Harbors Act of 1899 (33 U.S.C. 403) and Sections 401 and 404 of the Clean Water Act (33 U.S.C. 1341), an application has been submitted to the Department of the Army and the South Carolina Department of Health and Environmental Control by

**South Carolina Department of Transportation**  
**P.O. Box 191, 955 Park Street**  
**Columbia, South Carolina 29202**

for a permit to place fill in wetlands adjacent to, tributaries to

**Manchester Creek**

at a location along a three mile segment of Celriver Road/Red River Road (S-50) from its intersection with Cherry Road (US-21) to its intersection with Dave Lyle Boulevard (SC-122) in York County, South Carolina (northern terminus: 34.974476°N, -80.985462°W; southern terminus: 34.941638°N, -80.956308°W)

In order to give all interested parties an opportunity to express their views

**NOTICE**

is hereby given that written statements regarding the proposed work will be received by the **Corps** until

**15 DAYS FROM THE DATE OF THIS NOTICE**

And **SCDHEC** will receive written statements regarding the proposed work until

**30 DARYS FROM THE DATE OF THIS NOTICE**

from those interested in the activity and whose interests may be affected by the proposed work.

Project Description: The proposed work consists of widening of a three mile segment of Celriver Road/Red River Road (S-50) from its intersection with Cherry Road (US-21) to its intersection with Dave Lyle Boulevard (SC-122). The project consists of a construction of a five lane roadway section that includes four travel lanes with a single 15 foot wide center turn lane/median, two 4 foot wide bicycle lanes, and two five foot wide pedestrian walkways adjacent to the widened roadway.

Proposed Impacts to waters of the US: The proposed project will impact a total of 0.007 acres of wetlands from

REGULATORY DIVISION

Refer to: P/N # SAC-2010-01085-DS

the placement of culvert extension and rock rip rap armor. Additionally, the project will impact a total of 471 linear feet of Manchester Creek and tributaries to Manchester Creek which includes 345 linear feet of fill/culvert and cover impacts, 48.5 linear feet of rock rip rap armor, 26.8 feet of mechanical clearing, and 50.2 linear feet of excavation/relocation.

Purpose: According to the applicant, the purpose of the proposed work is to increase capacity, improve traffic flow, provided connectivity on the east side of I-77, and to replace the functionally obsolete and structurally deficient bridge across Manchester Creek. In addition, the project is expected to improve the public safety of travelers on the roadway.

Avoidance and Minimization: The applicant states that efforts to avoid and/or minimize impact to waters of the U.S. include;

- The applicant considered several different roadway alignments for this project during project development. The preferred alternative utilizes widening along the existing roadway alignment with minor alignment shifts to allow maintenance of traffic on the roadway and to minimize impacts to residences/facilities adjacent to the existing roadway. Based on the permit application, the preferred alternative (when compared to other project alignment alternatives) has the least total impacts to waters of the U.S. while still meeting project purpose and need.
- 2:1 roadway approach fill slopes were designed where feasible to reduce overall roadway fill widths.
- Bridge span across Manchester Creek will be increase from 60 feet to 88.5 feet.
- Sedimentation and erosion control measures, consistent with the State's best management practices (BMP's) will be installed during construction.

Mitigation: For the unavoidable impact to waters of the U.S., the applicant is proposing to purchase 1382.7 mitigation credits from Taylors Creek Mitigation Bank.

---

The District Engineer has concluded that the discharges associated with this project, both direct and indirect, should be reviewed by the South Carolina Department of Health and Environmental Control in accordance with provisions of Section 401 of the Clean Water Act. As such, this notice constitutes a request, on behalf of the applicant, for certification that this project will comply with applicable effluent limitations and water quality standards. The District Engineer will not process this application to a conclusion until such certification is received. The applicant is hereby advised that supplemental information may be required by the State to facilitate the review. Persons wishing to comment or object to Water Quality Certification must submit all comments in writing to the S.C. Department of Health and Environmental Control at the above address within thirty (30) days of the date of this notice.

This notice initiates the Essential Fish Habitat (EFH) consultation requirements of the Magnuson-Stevens Fishery Conservation and Management Act. Implementation of the proposed project would impact 0.0007 acres of estuarine substrates and emergent wetlands utilized by various life stages of species comprising the red drum, shrimp, and snapper-grouper management complexes. Our initial determination is that the proposed action would not have a substantial individual or cumulative adverse impact on EFH or fisheries managed by the South Atlantic Fishery Management Council and the National Marine Fisheries Service (NMFS). Our final determination relative to project impacts and the need for mitigation measures is subject to review by and coordination with the NMFS.

Pursuant to Section 7(c) of the Endangered Species Act of 1973 (as amended), the applicant has provided a protected species survey for the property associated with the activity described above. Based upon this report, the District Engineer has determined that the project is not likely to adversely affect any Federally endangered,

threatened, or proposed species or result in the destruction or adverse modification of designated or proposed critical habitat. This public notice serves as a request for written concurrence from the U.S. Fish and Wildlife Service and/or the National Marine Fisheries Service on this determination.

Pursuant to Section 106 of the National Historic Preservation Act (NHPA), this public notice also constitutes a request to Indian Tribes to notify the District Engineer of any historic properties of religious and cultural significance to them that may be affected by the proposed undertaking.

In accordance with the NHPA, the District Engineer has also consulted the latest published version of the National Register of Historic Places for the presence or absence of registered properties, or properties listed as being eligible for inclusion therein, and this worksite is not included as a registered property or property listed as being eligible for inclusion in the Register. To insure that other cultural resources that the District Engineer is not aware of are not overlooked, this public notice also serves as a request to the State Historic Preservation Office to provide any information it may have with regard to historic and cultural resources.

Any person may request, in writing, within the comment period specified in this notice, that a public hearing be held to consider this application. Requests for a public hearing shall state, with particularity, the reasons for holding a public hearing.

The decision whether to issue a permit will be based on an evaluation of the probable impact including cumulative impacts of the activity on the public interest and will include application of the guidelines promulgated by the Administrator, Environmental Protection Agency (EPA), under authority of Section 404(b) of the Clean Water Act and, as appropriate, the criteria established under authority of Section 102 of the Marine Protection, Research and Sanctuaries Act of 1972, as amended. That decision will reflect the national concern for both protection and utilization of important resources. The benefit which reasonably may be expected to accrue from the project must be balanced against its reasonably foreseeable detriments. All factors which may be relevant to the project will be considered including the cumulative effects thereof; among those are conservation, economics, aesthetics, general environmental concerns, wetlands, historic properties, fish and wildlife values, flood hazards, flood plain values, land use, navigation, shoreline erosion and accretion, recreation, water supply and conservation, water quality, energy needs, safety, food and fiber production and, in general, the needs and welfare of the people. A permit will be granted unless the District Engineer determines that it would be contrary to the public interest. In cases of conflicting property rights, the Corps of Engineers cannot undertake to adjudicate rival claims.

The Corps of Engineers is soliciting comments from the public; Federal, state, and local agencies and officials; Indian Tribes; and other interested parties in order to consider and evaluate the impacts of this activity. Any comments received will be considered by the Corps of Engineers to determine whether to issue, modify, condition or deny a permit for this project. To make this decision, comments are used to assess impacts on endangered species, historic properties, water quality, general environmental effects, and the other public interest factors listed above. Comments are used in the preparation of an Environmental Assessment and/or an Environmental Impact Statement pursuant to the National Environmental Policy Act. Comments are also used to determine the need for a public hearing and to determine the overall public interest of the activity.

If there are any questions concerning this public notice, please contact **(Stephen Brumagin)** at 803-253-3445.

FED. PD. DIST. NO.	STATE	COUNTY	PRJ. NO.	ROAD NO.	SHEET NO.
1	S.C.	YORK	101085	101	1A

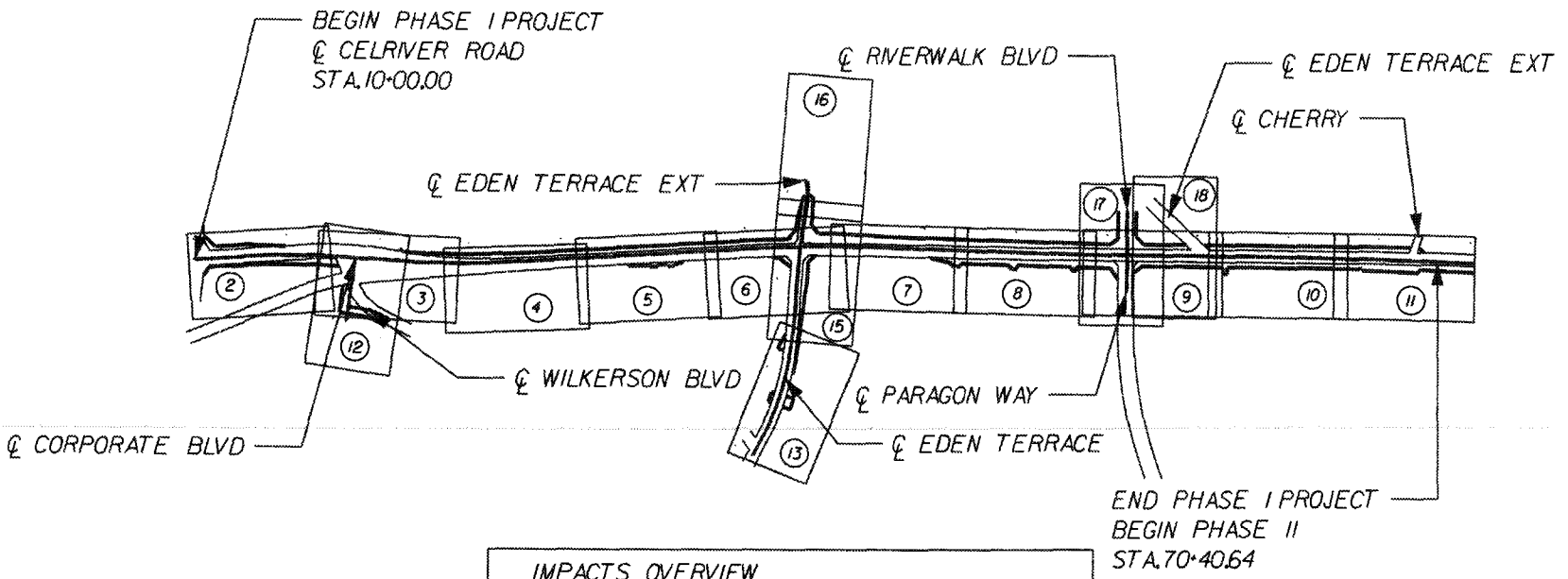

**IMPACTS OVERVIEW**

WETLAND CUT/FILL = 0.0006 AC

WETLAND CLEAR = 0.0001 AC

STREAMS CUT/FILL = 443.8 LF (0.1560 AC)

STREAMS CLEAR = 26.8 LF (0.0048 AC)

TOTAL = WETLANDS = 0.0007 AC (31.83 SF)

STREAMS = 470.5 LF (0.1614 AC)

SHEET NUMBER (X)

P/N 2010-01085-DS Sheet 1 of 3.5

THIS SHEET  
 PERM FILL  
 PERM CUT  
 PERM CLEAR  
 TEMP FILL  
 TEMP CLEAR

JURISDICTIONAL WETLAND  
 BARRIER FENCE  
 PROTECTION

SHEET TOTAL



HDR Engineering, Inc.  
 of the Carolinas  
 157 E. Main St., Suite 400  
 Rock Hill, SC 29730  
 803-969-2200

**PRELIMINARY PLANS**  
 DO NOT USE FOR CONSTRUCTION



4			
3			
2			
1			
REV.	BY	DATE	DESCRIPTION OF REVISION

SOUTH CAROLINA  
 DEPARTMENT OF TRANSPORTATION  
 ROAD DESIGN COLUMBIA, S.C.

**WETLAND PERMIT**

COVER SHEET 1A

SCALE: P=1000' RTE. 5-50



FED. RD. DIST. NO.	STATE	COUNTY	FILE NO.	ROAD NO.	SHEET NO.
5	S.C.	YORK	48,000-01	S-55	7

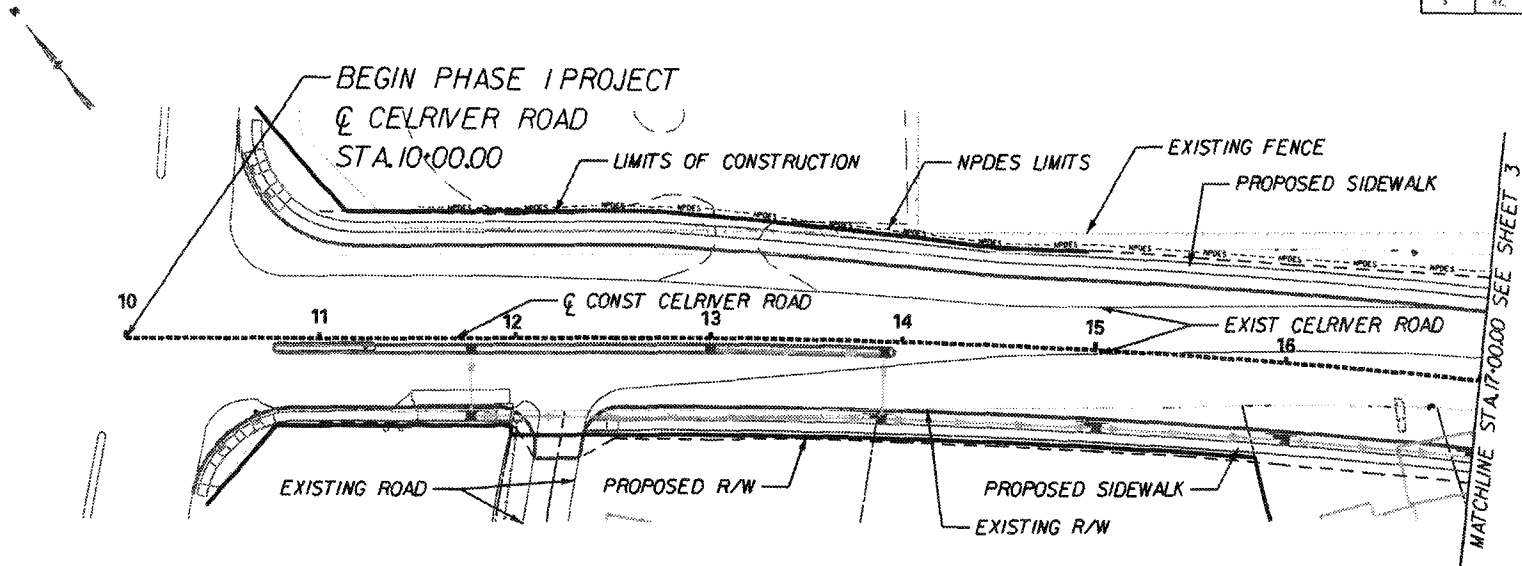

P/N 2010-01085-DS Sheet 3 of 35

THIS SHEET	
PERM FILL	0 AC
PERM CUT	0 AC
PERM CLEAR	0 AC
TEMP FILL	0 AC
TEMP CLEAR	0 AC

JURISDICTIONAL WETLAND BARRIER FENCE PROTECTION	
SHEET TOTAL	
0 LF	



HDR Engineering, Inc.  
of the Carolinas  
157 E. Main St., Suite 400  
York, PA, SC 29730  
803-485-2200

**PRELIMINARY PLANS**  
DO NOT USE FOR CONSTRUCTION



4			
3			
2			
1			
REV.	BY	DATE	DESCRIPTION OF REVISION

SOUTH CAROLINA  
DEPARTMENT OF TRANSPORTATION  
ROAD DESIGN COLUMBIA, S.C.  
**WETLAND PERMIT**  
PLAN SHEET 2  
STA. 10+00 TO STA. 17+00  
SCALE 1"=50' RTE. S-50

01/26/2010 10:58:58 AM C:\Users\j...

FED. RD. DIST. NO.	STATE	COUNTY	FILE NO.	ROAD NO.	SHEET NO.
3	S.C.	YOKE	4076447	543	4

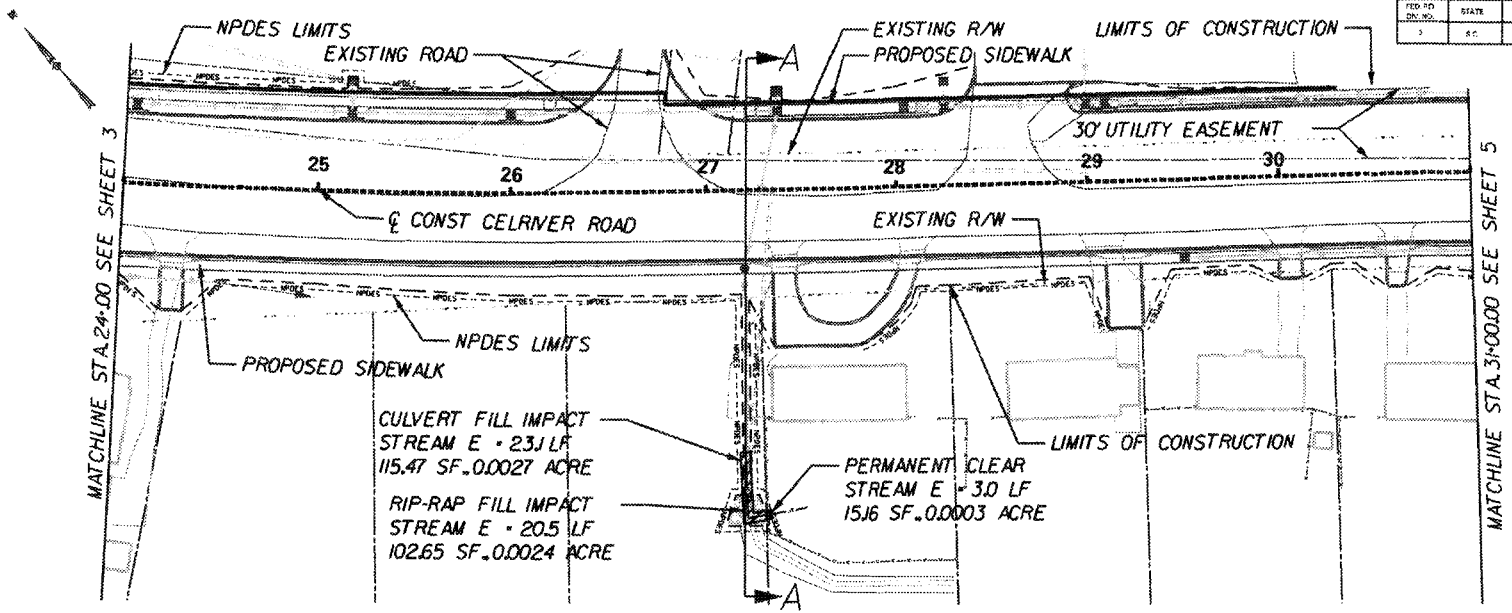

CULVERT FILL IMPACT  
 STREAM E = 23.1 LF  
 115.47 SF, 0.0027 ACRE

RIP-RAP FILL IMPACT  
 STREAM E = 20.5 LF  
 102.65 SF, 0.0024 ACRE

PERMANENT CLEAR  
 STREAM E = 3.0 LF  
 15.16 SF, 0.0003 ACRE

CROSS SECTION

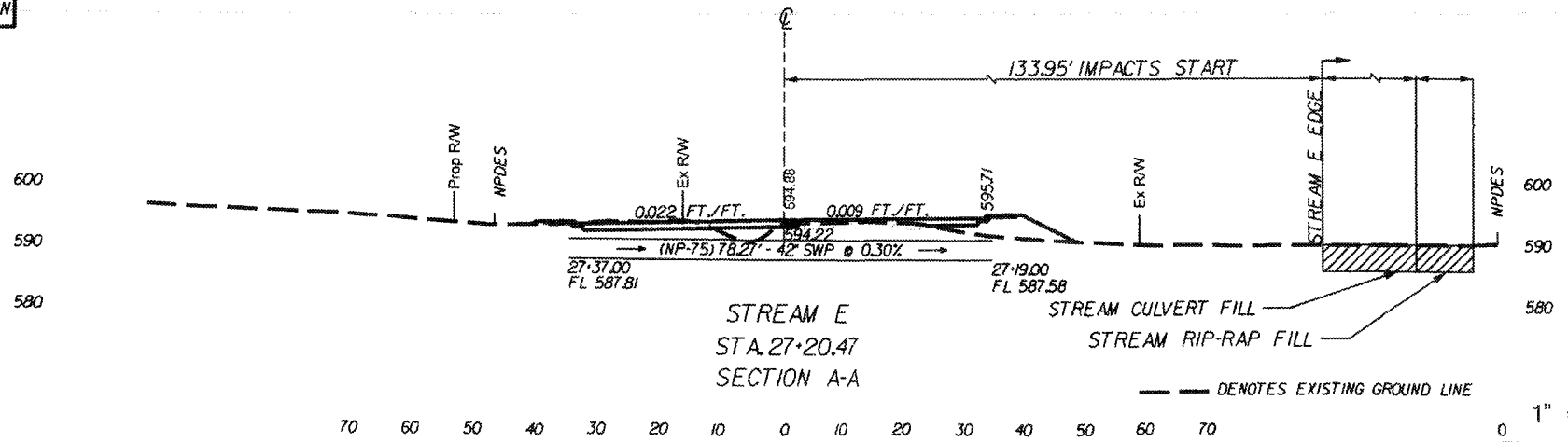

STREAM E  
 STA. 27+20.47  
 SECTION A-A

STREAM CULVERT FILL  
 STREAM RIP-RAP FILL

--- DENOTES EXISTING GROUND LINE

P/N 2010-01085-DS Sheet 4 of 35

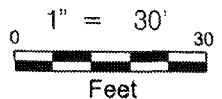

THIS SHEET

PERM FLL	0.0051 AC (43.6 LF) 0 AC
PERM CUT	0 AC
PERM CLEAR	0.0003 AC (3.0 LF) 0 AC
TEMP FLL	0 AC
TEMP CLEAR	0 AC

JURISDICTIONAL WETLAND BARRIER FENCE PROTECTION

SHEET TOTAL	0 LF
-------------	------



HDR Engineering, Inc.  
 of the Carolinas  
 157 E. Main St., Suite 400  
 Rock Hill, SC 29730  
 803-929-2200

**PRELIMINARY PLANS**  
 DO NOT USE FOR CONSTRUCTION



REV.	BY	DATE	DESCRIPTION OF REVISION
1			
2			
3			
4			

SOUTH CAROLINA  
 DEPARTMENT OF TRANSPORTATION  
 ROAD DESIGN COLUMBIA, S.C.

**WETLAND PERMIT**

PLAN AND CROSS SECTION SHEET  
 STA. 04+00 TO STA. 31+00

SCALE: P/100' RTE. 5-50

FED. RD. DIST. NO.	STATE	COUNTY	FILE NO.	ROAD NO.	SHEET NO.
3	S.C.	YORK	44-10-001	506	5

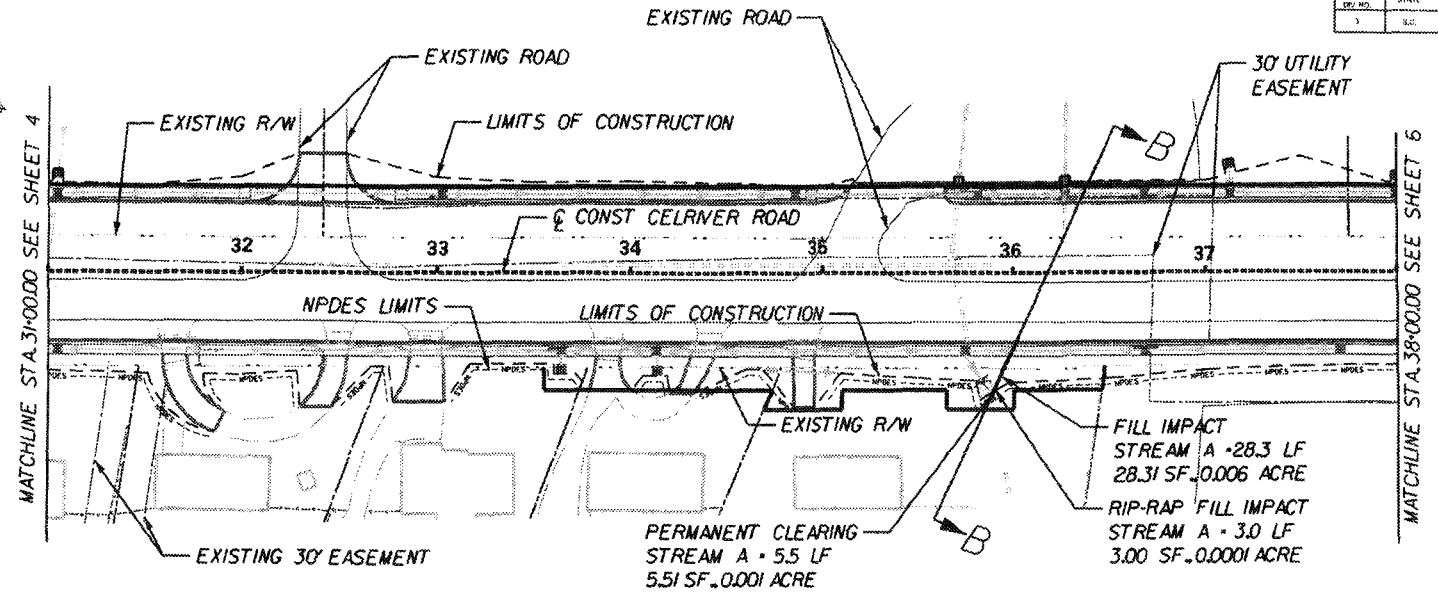

**CROSS SECTION**

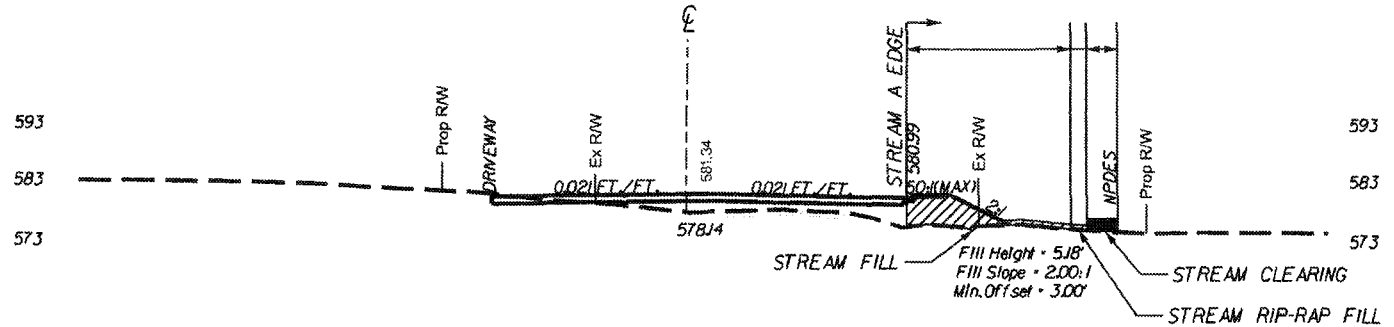

P/N 2010-01085-DS Sheet 5 of 35

STREAM A  
STA. 36+18.14  
SECTION B-B

--- DENOTES EXISTING GROUND LINE

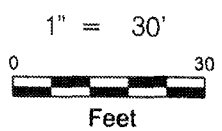

70 60 50 40 30 20 10 0 10 20 30 40 50 60 70

<b>THIS SHEET</b>	
PERM FILL	0.0007 AC (31.3 LF) 0 AC
PERM CUT	0 AC
PERM CLEAR	0.0000 AC (5.5 LF) 0 AC
TEMP FILL	0 AC
TEMP CLEAR	0 AC

<b>JURISDICTIONAL WETLAND BARRIER FENCE PROTECTION</b>	
SHEET TOTAL	
0 LF	



HDR Engineering, Inc.  
of the Carolinas  
157 E. Main St., Suite 400  
Ave. 148, SC 29710  
803-909-1210

**PRELIMINARY PLANS**  
DO NOT USE FOR CONSTRUCTION



4			
3			
2			
1			
DATE	DATE	DATE	DESCRIPTION OF REVISION
BY	BY	BY	GROUP

SOUTH CAROLINA  
DEPARTMENT OF TRANSPORTATION  
ROAD DESIGN COLUMBIA, S.C.  
**WETLAND PERMIT**  
PLAN AND CROSS SECTION SHEET 5  
STA. 31+00 TO STA. 38+00  
SCALE 1"=30' RTE. 5-50



FILE NO. (SHEET NO.)	STATE	COUNTY	FILE NO.	ROAD NO.	SHEET NO.
3	S.C.	JOHN	2010-01085	540	6

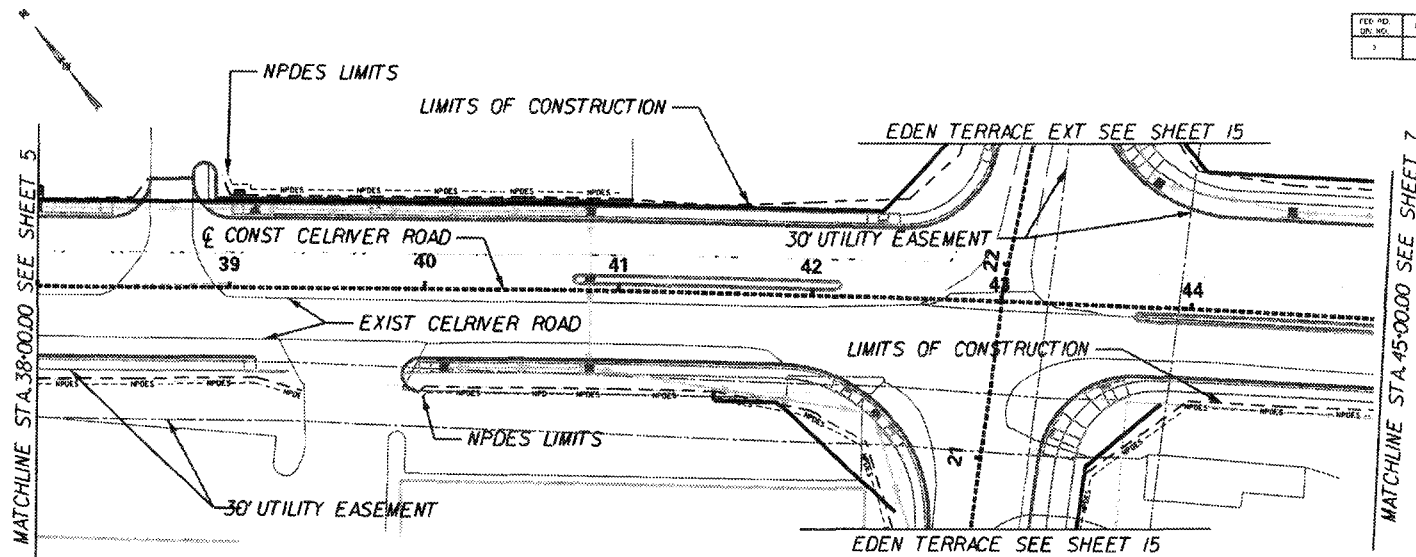

P/N 2010-01085-DS Sheet 6 of 35

RELEASE TO: 08/08/2010 08:55:55 AM BY: 08/08/2010 08:55:55 AM

THIS SHEET	
PERM FILL	0 AC
PERM CUT	0 AC
PERM CLEAR	0 AC
TEMP FILL	0 AC
TEMP CLEAR	0 AC

JURISDICTIONAL WETLAND BARRIER FENCE PROTECTION	
SHEET TOTAL	
0 LF	



HDR Engineering, Inc.  
 of the Carolinas  
 157 E. Main St., Suite 400  
 Rock Hill, SC 29778  
 803-968-2100

**PRELIMINARY PLANS**  
 DO NOT USE FOR CONSTRUCTION



4			
3			
2			
1			
REV.	BY	DATE	DESCRIPTION OF REVISION

SOUTH CAROLINA DEPARTMENT OF TRANSPORTATION ROAD DESIGN COLUMBIA, S.C.	
<b>WETLAND PERMIT</b>	
PLAN SHEET STA. 38+00 TO STA. 45+00	
6	
SCALE 1"=100' RTE. 5-50	

FED RD DISTRICT	STATE	COUNTY	FILE NO.	ROAD NO.	SHEET NO.
3	S.C.	RYAN	40-000001	5-40	7

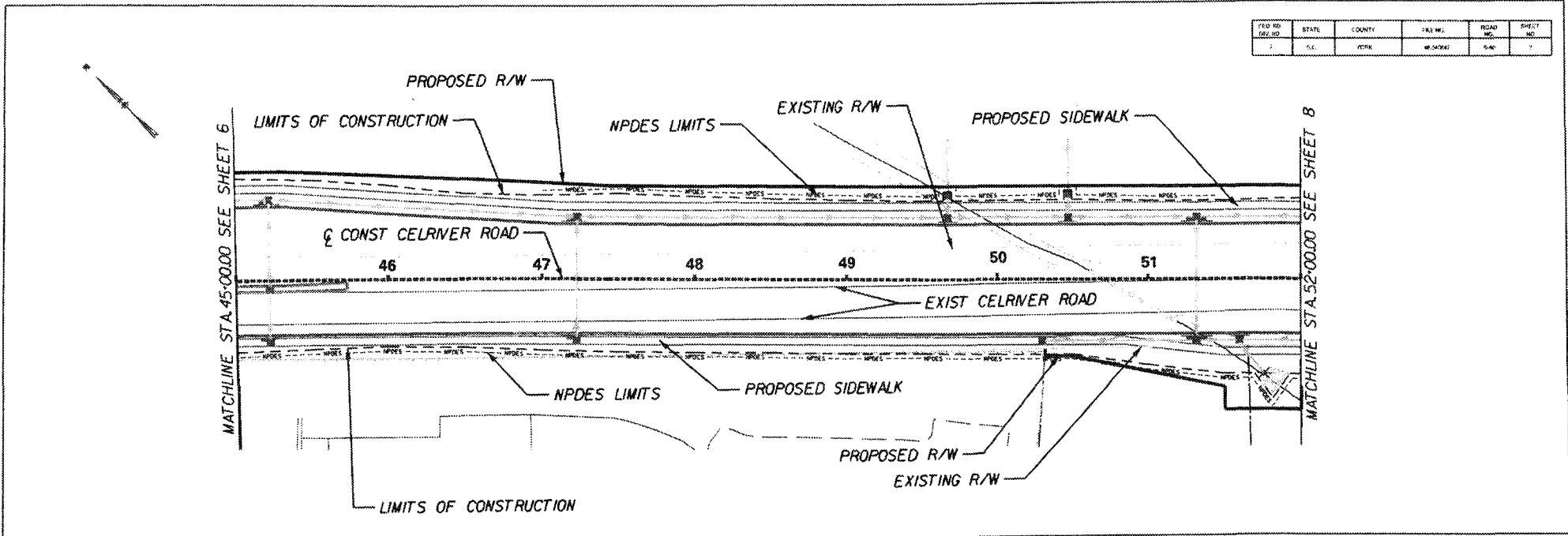

P/N 2010-01085-DS Sheet 7 of 35

THIS SHEET	0 AC
PERM FILL	0 AC
PERM CUT	0 AC
PERM CLEAR	0 AC
TEMP FILL	0 AC
TEMP CLEAR	0 AC

JURISDICTIONAL WETLAND BARRIER FENCE PROTECTION	
SHEET TOTAL	0 LF



HDR Engineering Inc.  
of the Carolinas  
157 E. Main St., Suite 400  
Rock Hill, SC 29730  
803-969-2200

**PRELIMINARY PLANS**  
DO NOT USE FOR CONSTRUCTION

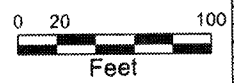

4			
3			
2			
1			
REV.	BY	CHK.	DESCRIPTION OF REVISION

SOUTH CAROLINA  
DEPARTMENT OF TRANSPORTATION  
ROAD DESIGN COLUMBIA, S.C.

**WETLAND PERMIT**

PLAN SHEET 7

STA. 45+00 TO STA. 52+00

SCALE: H200 RTE. S-50

04/10/10 10:55 AM C:\projects\2010-01085-DS\sheet7.dwg

FED. RD. DIST. NO.	STATE	COUNTY	FILE NO.	ROAD NO.	SHEET NO.
3	S.C.	KOFE	RENDER	540	8

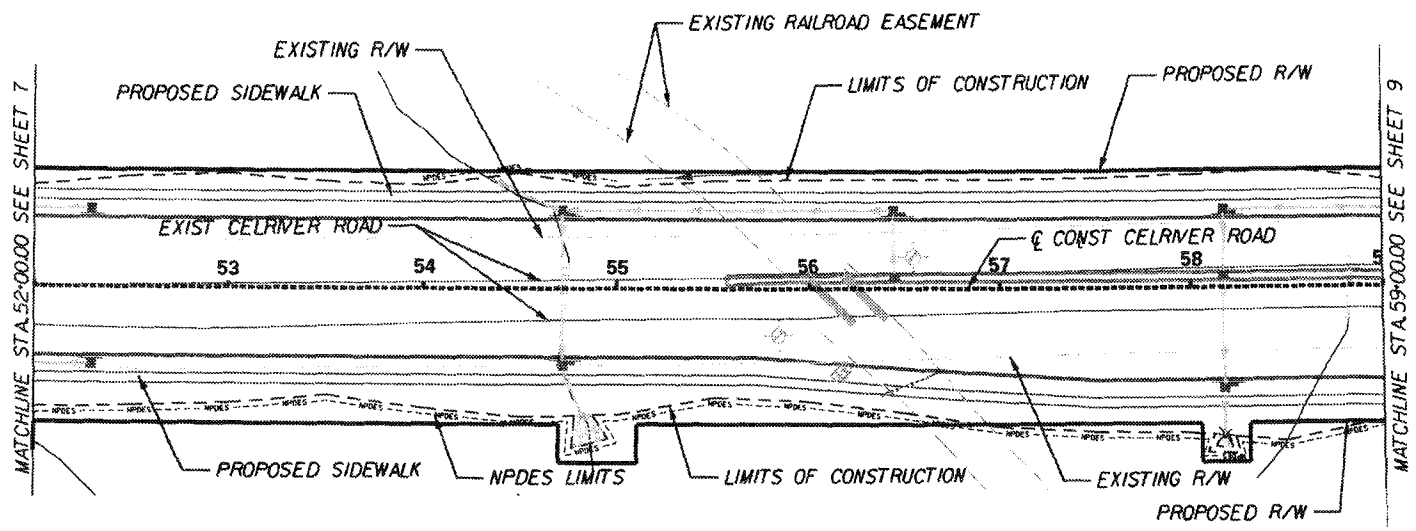

P/N 2010-01085-DS Sheet 8 of 35

THIS SHEET	
	PERM FILL = 0 AC
	PERM CUT = 0 AC
	PERM CLEAR = 0 AC
	TEMP FILL = 0 AC
	TEMP CLEAR = 0 AC

JURISDICTIONAL WETLAND BARRIER FENCE PROTECTION	
SHEET TOTAL	
0 LF	



HDR Engineering, Inc.  
of the Carolinas  
131 E. Main St., Suite 470  
Raleigh, NC 27601  
919.286.2200

**PRELIMINARY PLANS**  
DO NOT USE FOR CONSTRUCTION



4			
3			
2			
1			
REV	BY	DATE	DESCRIPTION OF REVISION

SOUTH CAROLINA DEPARTMENT OF TRANSPORTATION ROAD DESIGN COLUMBIA, S.C.	
WETLAND PERMIT	
PLAN SHEET STA. 52+00 TO STA. 59+00	
SCALE 1"=100'	RTE. S-50

8

FCD NO.	STATE	COUNTY	FILE NO.	ROAD NO.	SHEET NO.
3	S.C.	WYCK	47246647	552	5

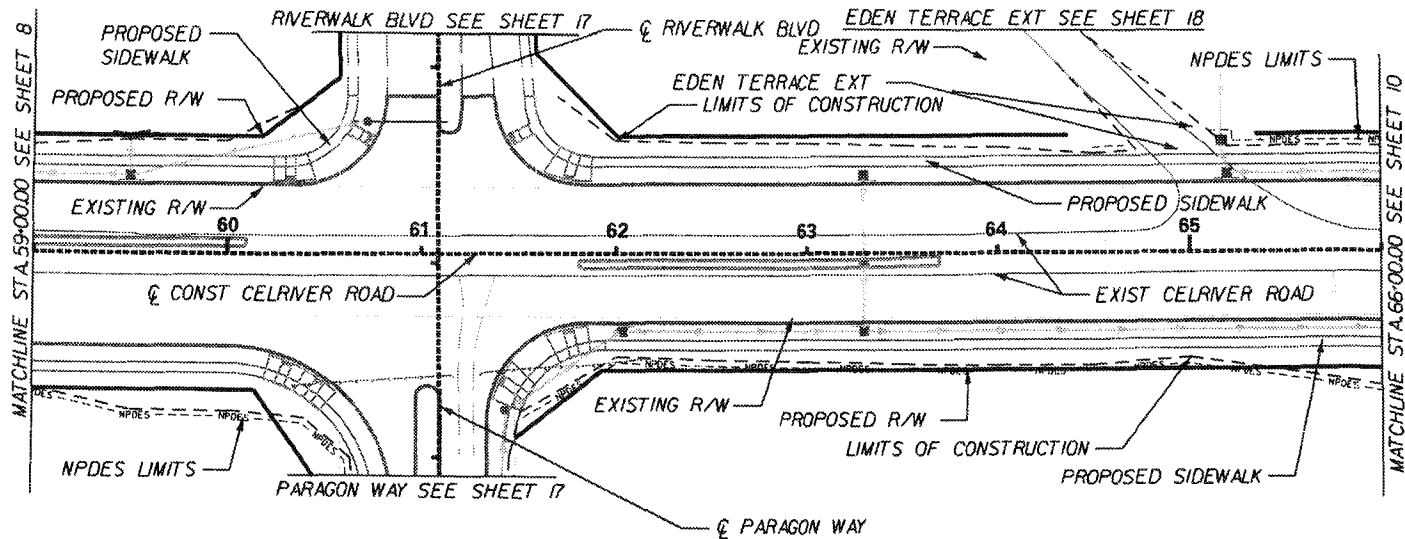

P/N 2010-01085-DS Sheet 4 of 35

Project 15  
 88820101085  
 88820101085

THIS SHEET	
PERM FILL	0 AC
PERM CUT	0 AC
PERM CLEAR	0 AC
TEMP FILL	0 AC
TEMP CLEAR	0 AC

JURISDICTIONAL WETLAND BARRIER FENCE PROTECTION	
SHEET TOTAL	
0 LF	



HDR Engineering, Inc.  
 of the Carolinas  
 157 E. Main St., Suite 400  
 Rock Hill, SC 29730  
 803-924-2200

**PRELIMINARY PLANS**  
DO NOT USE FOR CONSTRUCTION



4			
3			
2			
1			
REV.	BY	DATE	DESCRIPTION OF REVISION
TOPG		DATE	
DMC		DATE	
SP		DATE	

SOUTH CAROLINA  
 DEPARTMENT OF TRANSPORTATION  
 ROAD DESIGN COLUMBIA, S.C.  
**WETLAND PERMIT**  
 PLAN SHEET  
 STA. 59+00 TO STA. 66+00

SCALE 1"=100' RTE. S-30

FED. RD. DIST. NO.	STATE	COUNTY	FILE NO.	ROAD NO.	SHEET NO.
9	SC	WILKINSON	AP-50604	547	10

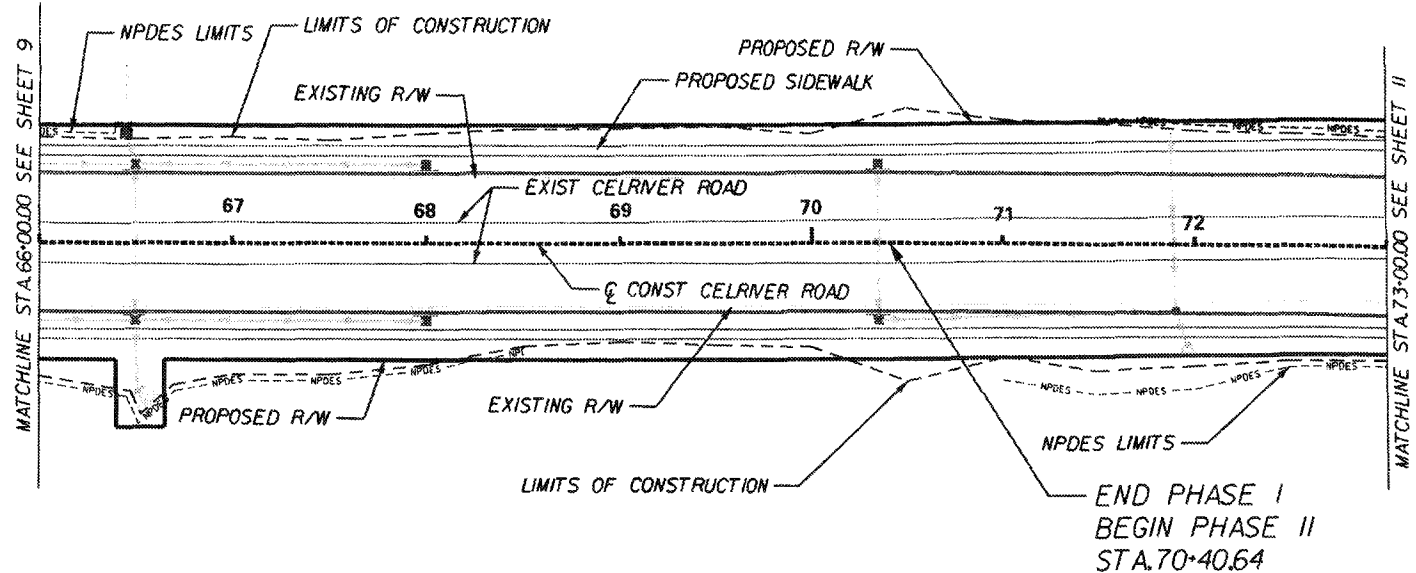

P/N 2010-01085-DS Sheet 10 of 35

8/10/2010 10:00 AM  
 8/10/2010 10:00 AM  
 8/10/2010 10:00 AM

THIS SHEET	
PERM FILL	0 AC
PERM CUT	0 AC
PERM CLEAR	0 AC
TEMP FILL	0 AC
TEMP CLEAR	0 AC

JURISDICTIONAL WETLAND BARRIER FENCE PROTECTION	
SHEET TOTAL	
0 LF	



HDR Engineering, Inc.  
 of the Carolinas  
 157 E. Main St., Suite 400  
 Rock Hill, SC 29730  
 803-699-6200

**PRELIMINARY PLANS**  
 DO NOT USE FOR CONSTRUCTION



4			
3			
2			
1			
REV.	BY	DATE	DESCRIPTION OF REVISION

SOUTH CAROLINA  
 DEPARTMENT OF TRANSPORTATION  
 ROAD DESIGN COLUMBIA, S.C.

**WETLAND PERMIT**  
 PLAN SHEET  
 STA. 66+00 TO STA. 73+00

10

SCALE 1"=50'     RTE. S-50

FED. RD. DIST. NO.	STATE	COUNTY	P.L.C. NO.	ROAD NO.	SHEET NO.
3	S.C.	YORK	46098A1	640	11

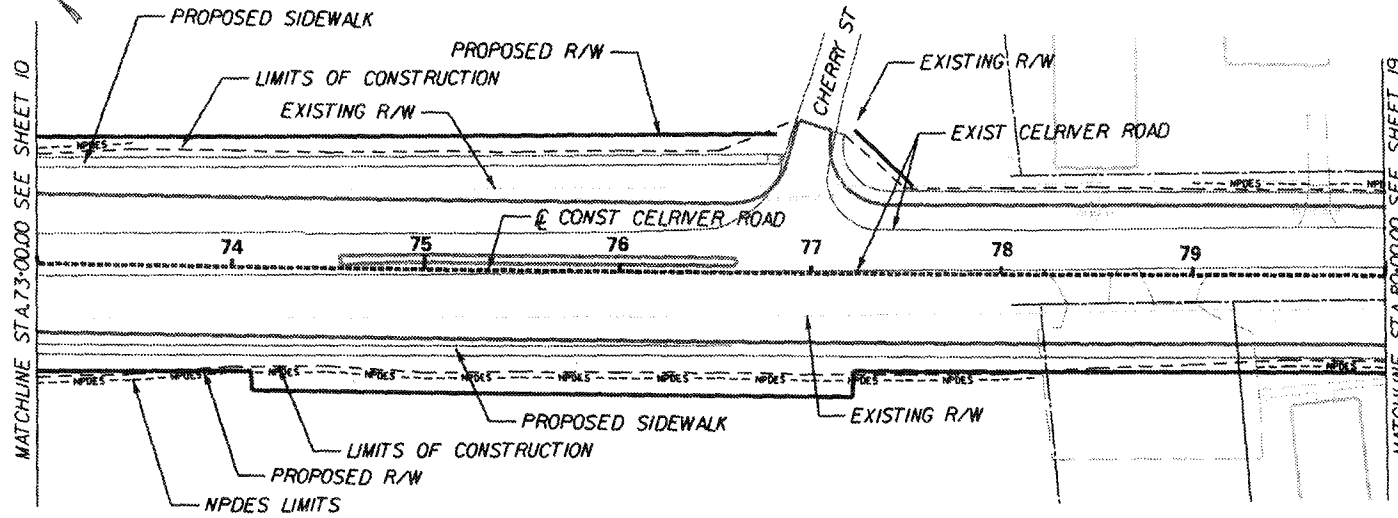

P/N 2010-01085-DS Sheet 11 of 35

<b>THIS SHEET</b>	
PERM FILL	0 AC
PERM CUT	0 AC
PERM CLEAR	0 AC
TEMP FILL	0 AC
TEMP CLEAR	0 AC

<b>JURISDICTIONAL WETLAND AND BARRIER FENCE PROTECTION</b>	
<b>SHEET TOTAL</b>	0 LF



HDR Engineering, Inc.  
of the Carolinas  
157 E. Main St., Suite 400  
Rock Hill, SC 29730  
803.999.2200

**PRELIMINARY PLANS**  
DO NOT USE FOR CONSTRUCTION



1			
2			
3			
4			
REV.	BY	DATE	DESCRIPTION OF REVISION

SOUTH CAROLINA DEPARTMENT OF TRANSPORTATION ROAD DESIGN COLUMBIA, S.C.	
<b>WETLAND PERMIT</b>	
PLAN SHEET STA. 73+00 TO STA. 80+00	
SCALE 1"=50'	RTS. S-90

FED. RD. DIST. NO.	STATE	COUNTY	FILE NO.	ROAD DIST.	SHEET NO.
3	SC	WILKINSON	1010001	400	12

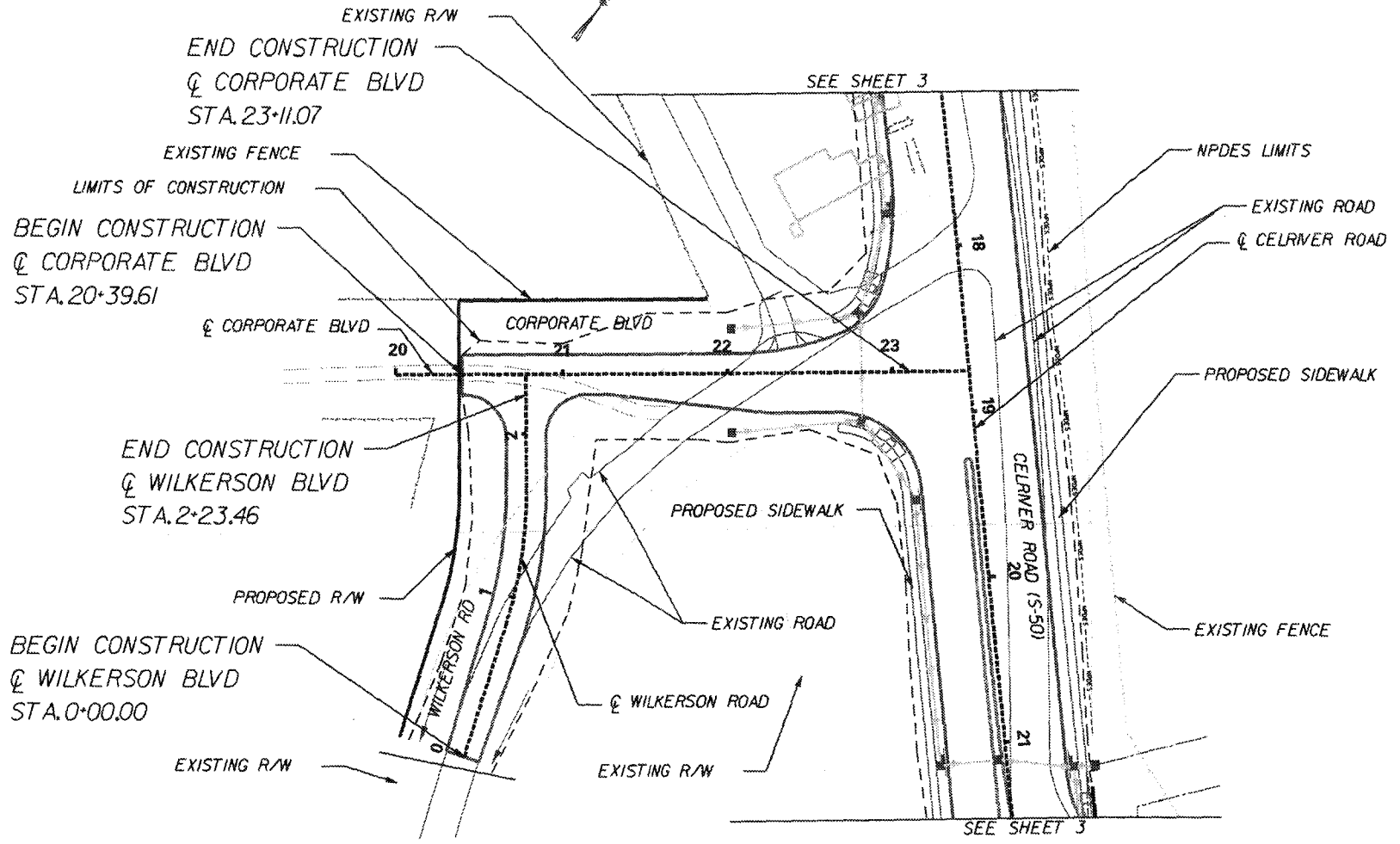

P/N 2010-01085-DS Sheet 12 of 35

THIS SHEET		
PERM FILL	0 AC	
PERM CUT	0 AC	
PERM CLEAR	0 AC	
TEMP FILL	0 AC	
TEMP CLEAR	0 AC	

JURISDICTIONAL WETLAND BARRIER FENCE PROTECTION	
SHEET TOTAL	0 LF



HDR Engineering, Inc.  
 107 E. Main St., Suite 400  
 North Charleston, SC 29505  
 803-205-2200

**PRELIMINARY PLANS**  
 DO NOT USE FOR CONSTRUCTION



4			
3			
2			
1			
REV. NO.	BY	DATE	DESCRIPTION OF REVISION
1/10			
2/10			
3/10			

SOUTH CAROLINA  
 DEPARTMENT OF TRANSPORTATION  
 ROAD DESIGN COLUMBIA, S.C.

**WETLAND PERMIT**  
 PLAN SHEET 12  
 CORPORATE BLVD/WILKERSON BLVD

SCALE: P=100' RTE. 5-50

FED. RD. DIST. NO.	STATE	COUNTY	FILE NO.	NEARBY H.Q.	SHEET NO.
1	SC	KPDS	4504047	880	13

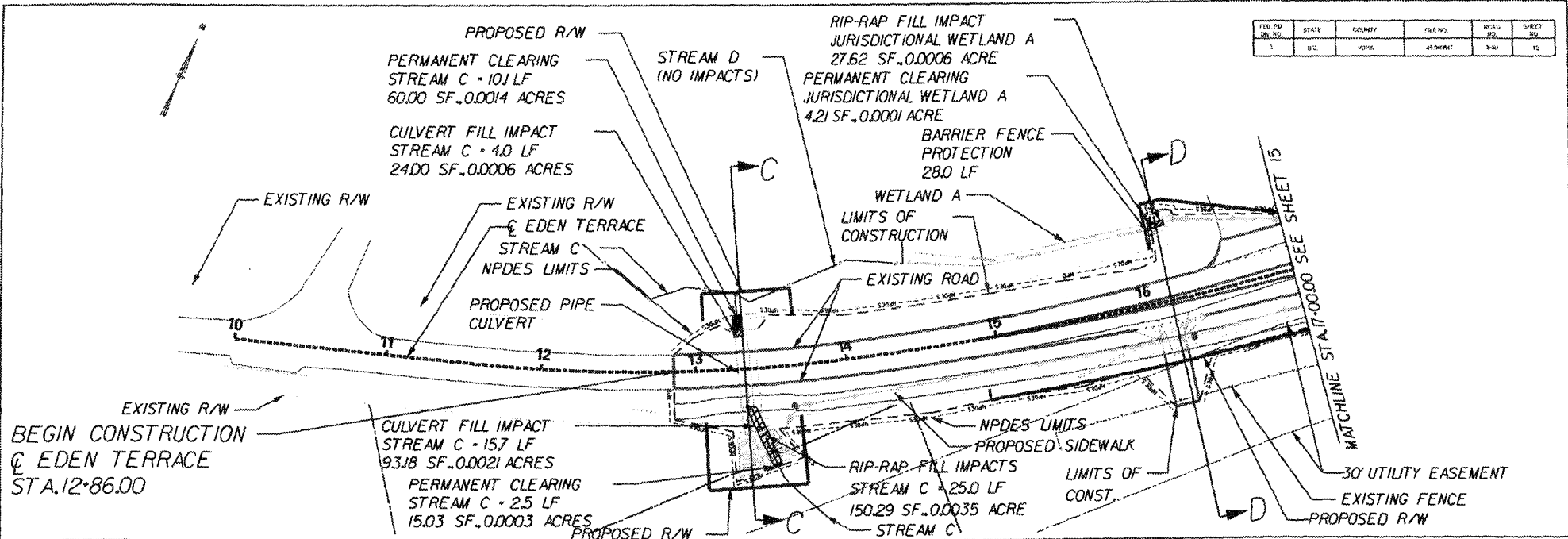

**CROSS SECTION**

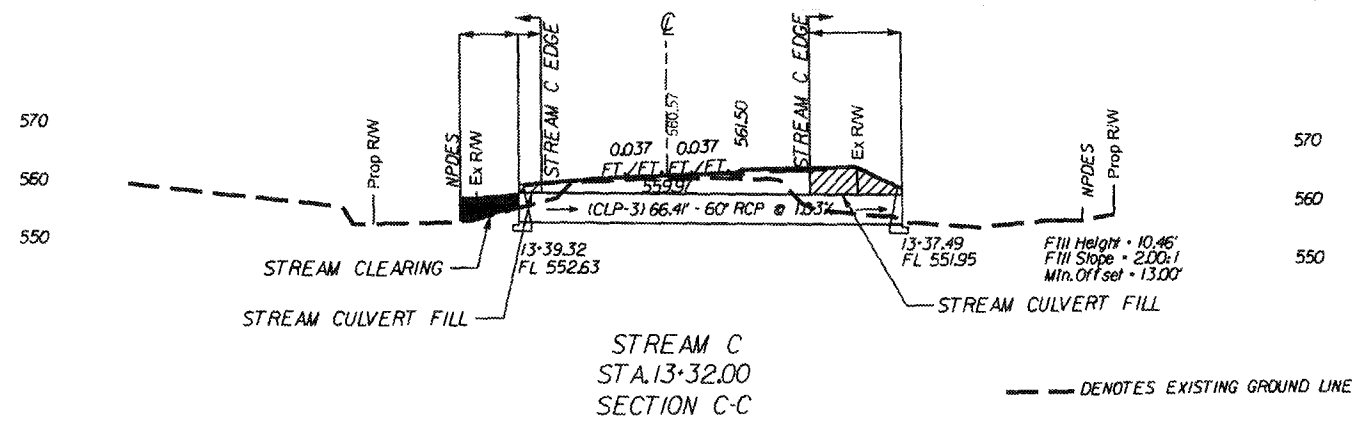

70 60 50 40 30 20 10 0 10 20 30 40 50 60 70

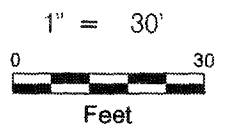

P/N 2010-01085-DS Sheet 13 of 35

THIS SHEET

PERM FILL	0.0068 AC (44.8 LF)
PERM CUT	0 AC
PERM CLEAR	0.0008 AC (2.5 LF)
TEMP FILL	0 AC
TEMP CLEAR	0 AC

JURISDICTIONAL WETLAND BARRIER FENCE PROTECTION

SHEET TOTAL	28.0 LF
-------------	---------



HDR Engineering, Inc.  
of the Carolinas  
157 E. Main St., Suite 400  
Rock Hill, SC 29730  
803-405-2200

**PRELIMINARY PLANS**  
DO NOT USE FOR CONSTRUCTION



REV.	BY	DATE	DESCRIPTION OF REVISION
4			
3			
2			
1			

DRP	DATE	GROUP
INC	DATE	
EX	DATE	

SOUTH CAROLINA  
DEPARTMENT OF TRANSPORTATION  
ROAD DESIGN COLUMBIA, S.C.

**WETLAND PERMIT**

PLAN AND CROSS SECTION SHEET 13  
STA. 16+00 TO STA. 17+00

SCALE: P=100' RTE. S-50

P:\User\13 88888807\1388888888\1388888888\1388888888.dwg  
 11/10/2010 10:00:00 AM



CROSS SECTION

FED. RD. DIST. NO.	STATE	COUNTY	FILE NO.	ROAD NO.	SHEET NO.
2	SC	DOOR	AR 543647	5-52	14

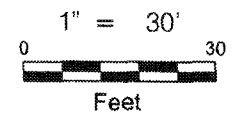
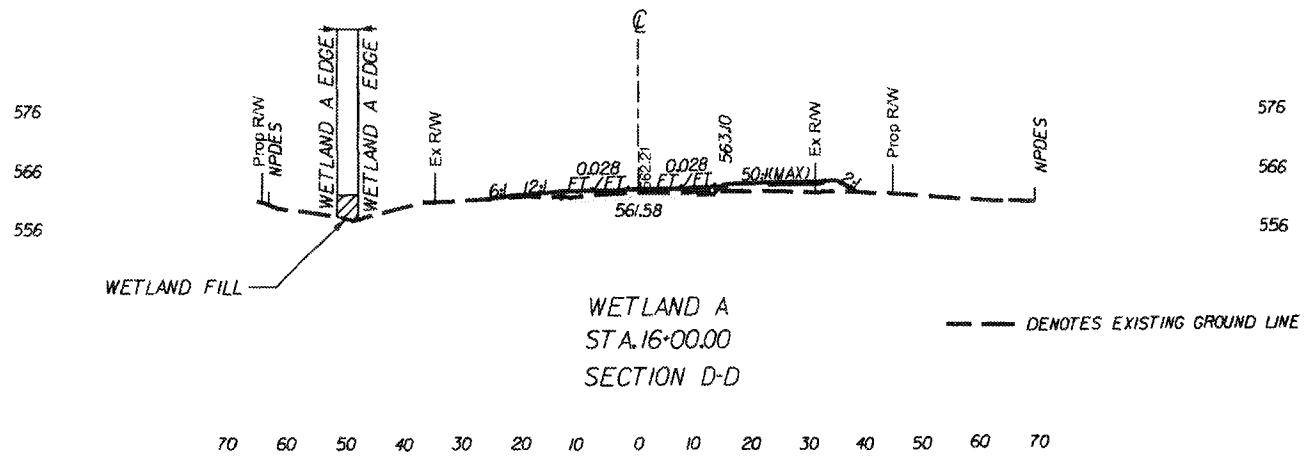

P/N 2010-01085-DS Sheet 14 of 35

THIS SHEET			
PERM FILL	=	0 AC	
PERM CUT	=	0 AC	
PERM CLEAR	=	0 AC	
TEMP FILL	=	0 AC	
TEMP CLEAR	=	0 AC	

JURISDICTIONAL WETLAND BARRIER FENCE PROTECTION	
SHEET TOTAL	0 LF



HDR Engineering, Inc.  
4010 Cantelago  
157 E. Main St., Suite 400  
Rock Hill, SC 29730  
803-516-2200

**PRELIMINARY PLANS**  
DO NOT USE FOR CONSTRUCTION



4				
3				
2				
1				
REV.	BY	DATE	DESCRIPTION OF REVISION	

SOUTH CAROLINA DEPARTMENT OF TRANSPORTATION ROAD DESIGN COLUMBIA, S.C.	
WETLAND PERMIT	
CROSS SECTION EDEN TERRACE	14
SCALE 1"=30'	RTS. 5-50

C:\Users\jbr\OneDrive\Desktop\p101085\101085\101085-DS-14.dwg

FED. RD. DIST. NO.	STATE	COUNTY	PROJECT NO.	ROAD NO.	SHEET NO.
3	S.C.	WYCK	43-90841	3-40	15

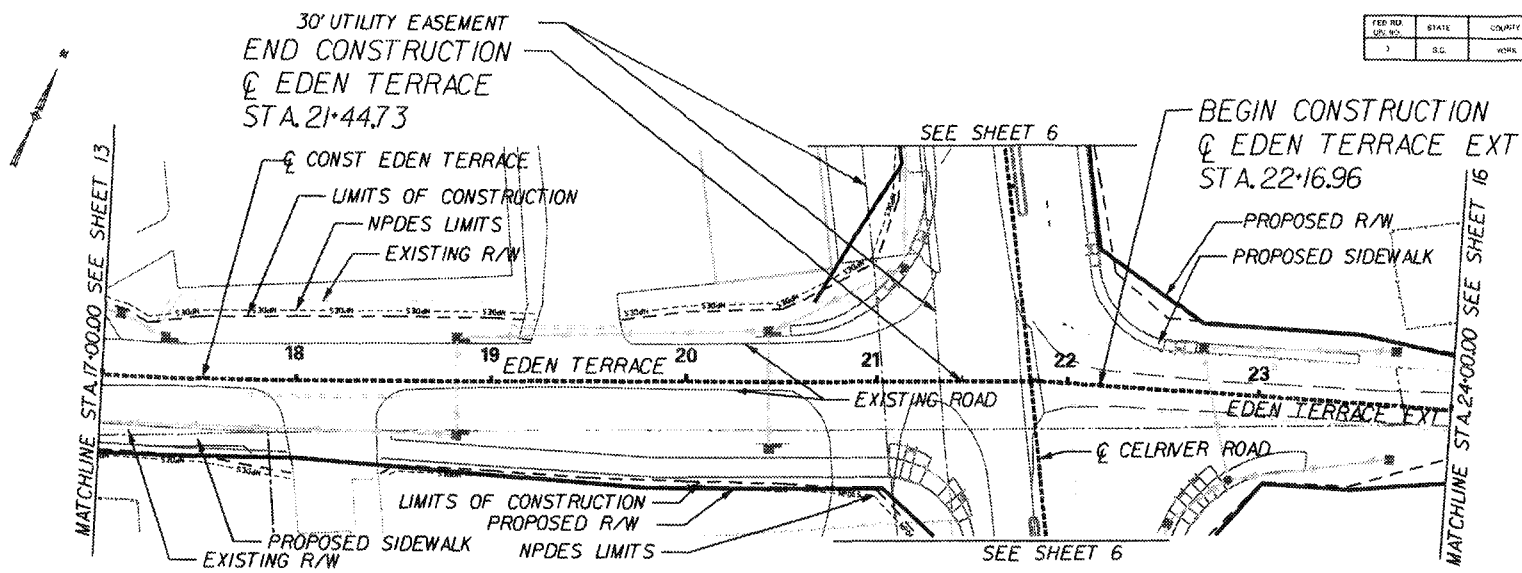

P/N 2010-01085-DS Sheet 15 of 35

6/10/09 09:44:58 AM 10/18/09 08:58:58 AM 10/18/09 08:58:58 AM

THIS SHEET	
	PERM FILL = 0 AC
	PERM CUT = 0 AC
	PERM CLEAR = 0 AC
	TEMP FILL = 0 AC
	TEMP CLEAR = 0 AC

JURISDICTIONAL WETLAND BARRIER FENCE PROTECTION	
SHEET TOTAL	
0 LF	



HDR Engineering, Inc.  
 157 E. Main St., Suite 400  
 Rock Hill, SC 29730  
 803/951-2200

**PRELIMINARY PLANS**  
 DO NOT USE FOR CONSTRUCTION

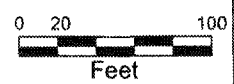

4			
3			
2			
1			
REV.	DATE	BY	DESCRIPTION OF REVISION

SOUTH CAROLINA DEPARTMENT OF TRANSPORTATION ROAD DESIGN COLUMBIA, S.C.	
<b>WETLAND PERMIT</b>	
PLAN SHEET STA. 17+00 TO STA. 24+00	
SCALE 1"=50'	RTE. 5-50

15

FED. RD. DIST.	STATE	COUNTY	PROJECT	ROAD NO.	SHEET NO.
2	SC	YORK	WETLAND	24+00	16

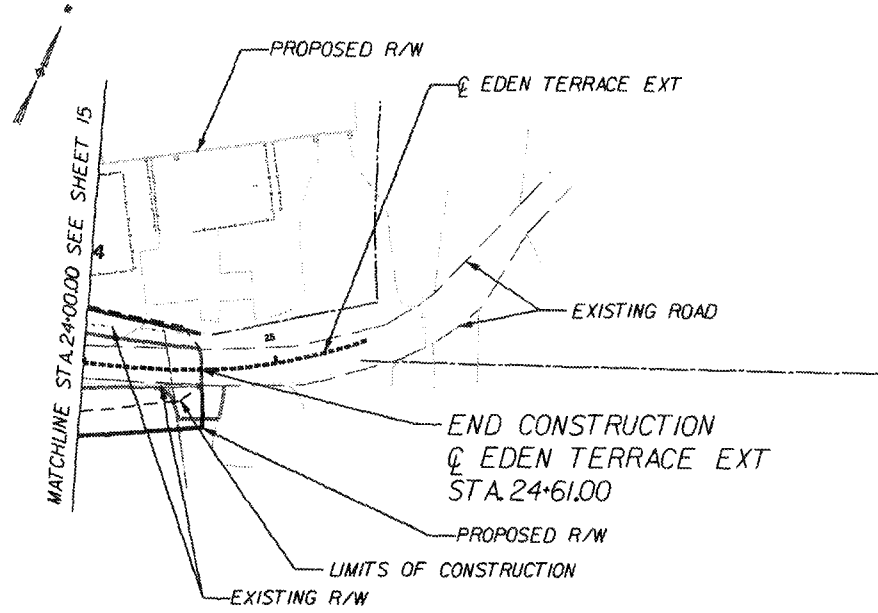

P/N 2010-01085-DS Sheet 16 of 35

THIS SHEET	
▨ PERM FILL :	0 AC
▨ PERM CUT :	0 AC
▨ PERM CLEAR :	0 AC
▨ TEMP FILL :	0 AC
▨ TEMP CLEAR :	0 AC

JURISDICTIONAL WETLAND BARRIER FENCE PROTECTION	
SHEET TOTAL	
0 LF	



HDR Engineering, Inc.  
of the Carolinas  
157 E. Main St., Suite 400  
Spartanburg, SC 29701  
803-609-2210

**PRELIMINARY PLANS**  
DO NOT USE FOR CONSTRUCTION



4			
3			
2			
1			
REV. NO.	BY	DATE	DESCRIPTION OF REVISION

SOUTH CAROLINA  
DEPARTMENT OF TRANSPORTATION  
ROAD DESIGN COLUMBIA, S.C.  
**WETLAND PERMIT**  
PLAN SHEET 16  
STA. 24+00 TO STA. 24+61  
SCALE 1"=100' RITE S-50

\s\user32\...  
 \s\user32\...  
 \s\user32\...

FED. RD. DIST. NO.	STATE	COUNTY	FILE NO.	ROAD DIST.	SHEET NO.
3	SC	WYCK	W-1000-17	5-50	17

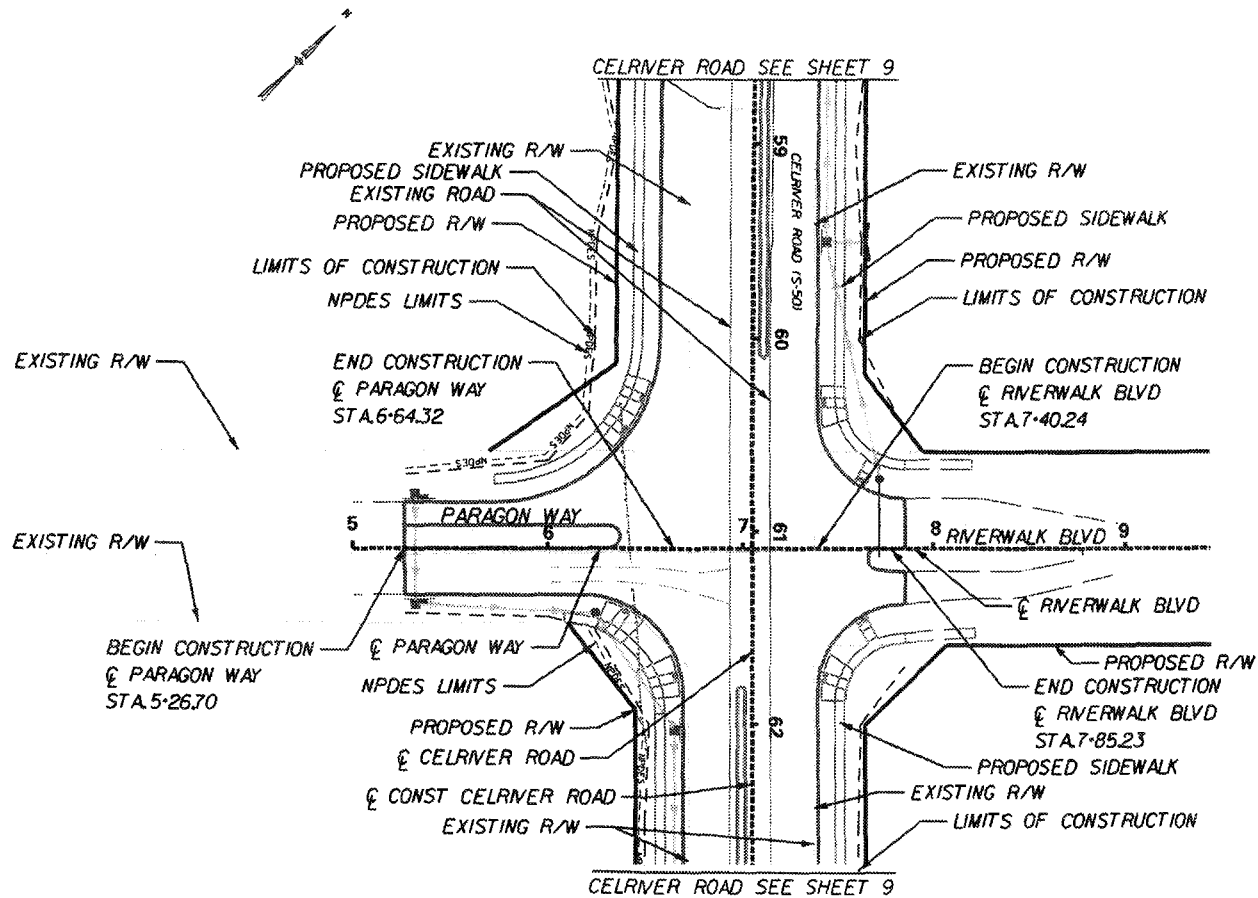

P/N 2010-01085-DS Sheet 17 of 35

THIS SHEET	
PERM FILL	0 AC
PERM CUT	0 AC
PERM CLEAR	0 AC
TEMP FILL	0 AC
TEMP CLEAR	0 AC

JURISDICTIONAL WETLAND BARRIER FENCE PROTECTION	
SHEET TOTAL	
0 LF	



HDR Engineering, Inc.  
157 E. Main St., Suite 400  
Rock Hill, SC 29730  
803-906-2200

**PRELIMINARY PLANS**  
DO NOT USE FOR CONSTRUCTION



4			
3			
2			
1			
REV.	BY	DATE	DESCRIPTION OF REVISION

SOUTH CAROLINA DEPARTMENT OF TRANSPORTATION ROAD DESIGN COLUMBIA, S.C.	
WETLAND PERMIT	
PLAN SHEET	17
PARAGON WAY-RIVERWALK BLVD	
SCALE 1"=400'	RTE. 5-50

8/22/10 11:55 AM 10/10/10 11:55 AM 10/10/10 11:55 AM

FED. RD. DIST. NO.	STATE	COUNTY	TRAC. NO.	ROAD NO.	SHEET NO.
3	S.C.	YORK	4040, 4041	540	18

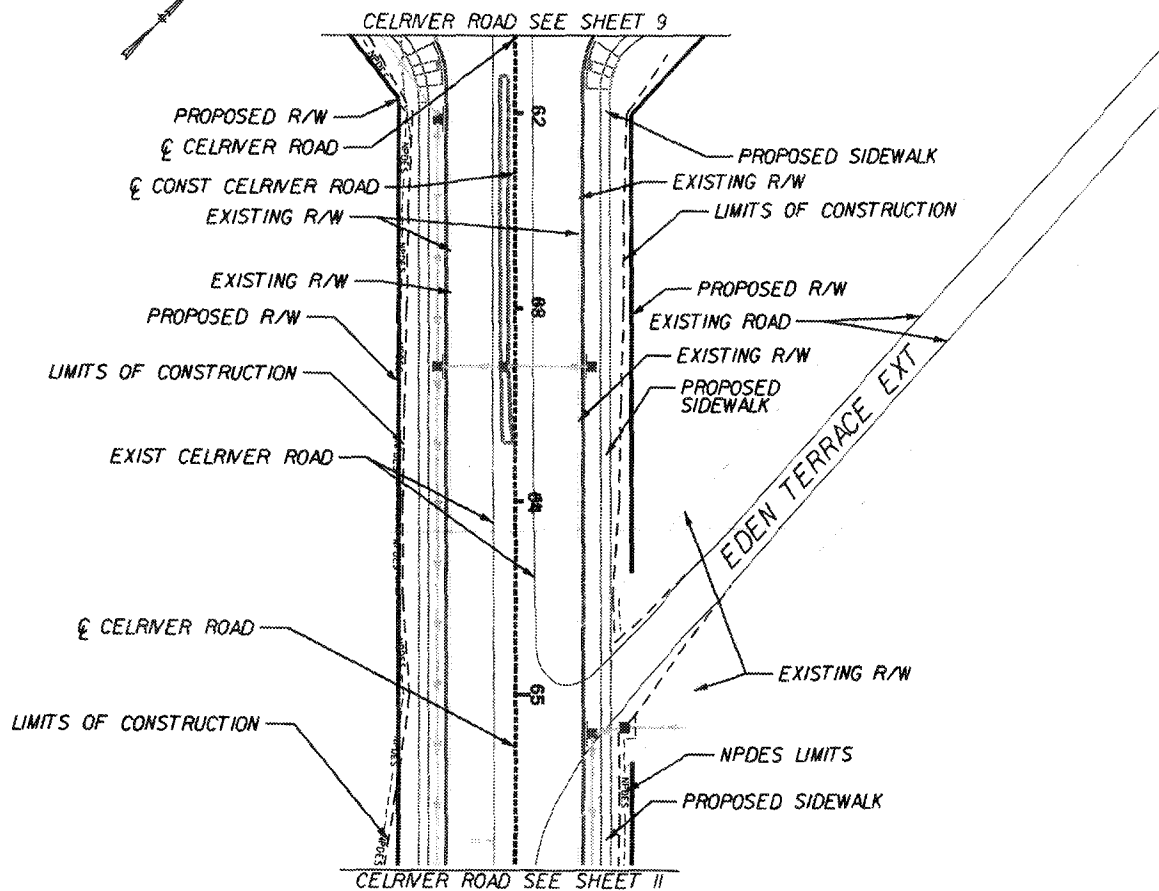

P/N 2010-01085-DS Sheet 18 of 35

THIS SHEET	0 AC
PERM FILL	0 AC
PERM CUT	0 AC
PERM CLEAR	0 AC
TEMP FILL	0 AC
TEMP CLEAR	0 AC

JURISDICTIONAL WETLAND BARRIER FENCE PROTECTION	
SHEET TOTAL	0 LF



HDR Engineering, Inc.  
of the Carolinas  
157 E. Main St., Suite 400  
Rock Hill, SC 29730  
803.409.2200

**PRELIMINARY PLANS**  
DO NOT USE FOR CONSTRUCTION



4			
3			
2			
1			
REV.	BY	DATE	DESCRIPTION OF REVISION

SOUTH CAROLINA DEPARTMENT OF TRANSPORTATION ROAD DESIGN COLUMBIA, S.C.	
WETLAND PERMIT	
PLAN SHEET EDEN TERRACE EXT	
SCALE 1"=100'	RTE. 5-50

FED. RD. DIST. NO.	STATE	COUNTY	FILE NO.	ROAD NO.	SHEET NO.
3	S.C.	YORK	05-10-000	S40	19

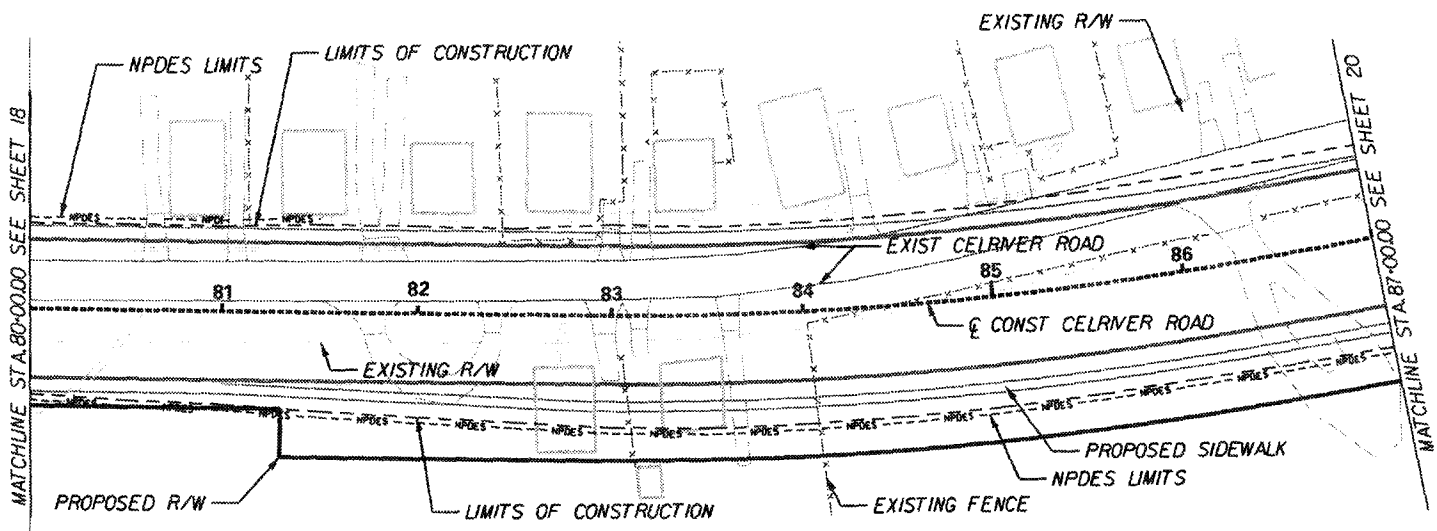

P/N 2010-01085-DS Sheet 19 of 35

THIS SHEET	
	PERM FILL = 0 AC
	PERM CUT = 0 AC
	PERM CLEAR = 0 AC
	TEMP FILL = 0 AC
	TEMP CLEAR = 0 AC

JURISDICTIONAL WETLAND BARRIER FENCE PROTECTION	
SHEET TOTAL	
0 LF	



HDR Engineering, Inc.  
151 E. Main St., Suite 400  
Rock Hill, SC 29730  
803-969-2200

**PRELIMINARY PLANS**  
DO NOT USE FOR CONSTRUCTION



4			
3			
2			
1			
REV.	BY	DATE	DESCRIPTION OF REVISION

SOUTH CAROLINA  
DEPARTMENT OF TRANSPORTATION  
ROAD DESIGN  
COLUMBIA, S.C.

**WETLAND PERMIT**

PLAN SHEET 19  
STA. 80+00.00 TO STA. 87+00.00

SCALE 1"=60' RTE. S-50

2010-01-085-DS 19 of 35  
 2010-01-085-DS 19 of 35  
 2010-01-085-DS 19 of 35

FED. RD. DIST. NO.	STATE	COUNTY	FILE NO.	ROAD NO.	SHEET NO.
3	S.C.	YORK	1074047	S-50	20

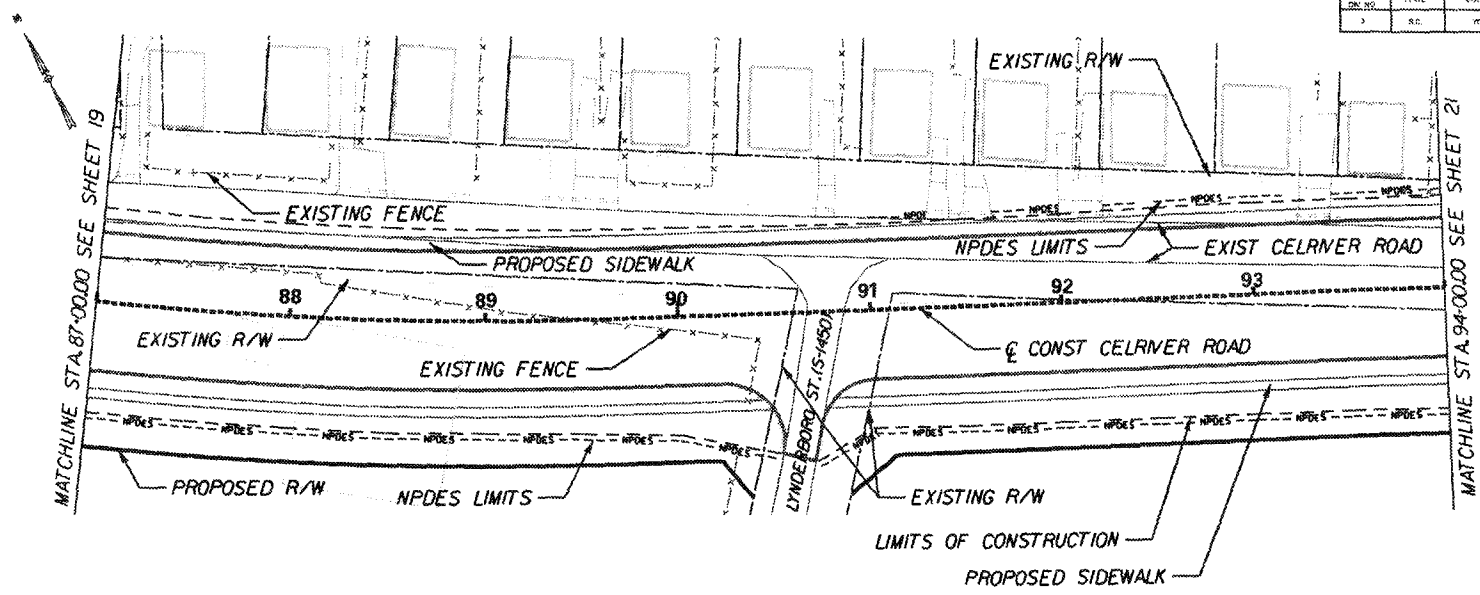

P/N 2010-01085-DS Sheet 20 of 35

THIS SHEET	
PERM FILL	0 AC
PERM CUT	0 AC
PERM CLEAR	0 AC
TEMP FILL	0 AC
TEMP CLEAR	0 AC

JURISDICTIONAL WETLAND BARRIER FENCE PROTECTION	
SHEET TOTAL	
0 LF	



HDR Engineering, Inc.  
4100 Columbia  
127 E. Main St., Suite 400  
Rock Hill, SC 29730  
803-503-2270

**PRELIMINARY PLANS**  
DO NOT USE FOR CONSTRUCTION



4			
3			
2			
1			
REV.	BY	DATE	DESCRIPTION OF REVISION

SOUTH CAROLINA  
DEPARTMENT OF TRANSPORTATION  
ROAD DESIGN COLUMBIA, S.C.  
**WETLAND PERMIT**  
PLAN SHEET 20  
STA 87+00 TO STA. 94+00  
SCALE: P=100' RTE. S-50

01/15/2010 10:58:11 AM  
 C:\Users\jrd\Documents\1074047\1074047.dwg  
 1074047.dwg  
 10/15/2010 10:58:11 AM

FED. RD. DIST. NO.	STATE	COUNTY	FILE NO.	ROAD DIST.	SHEET
2	S.C.	YORK	101085	5-50	21

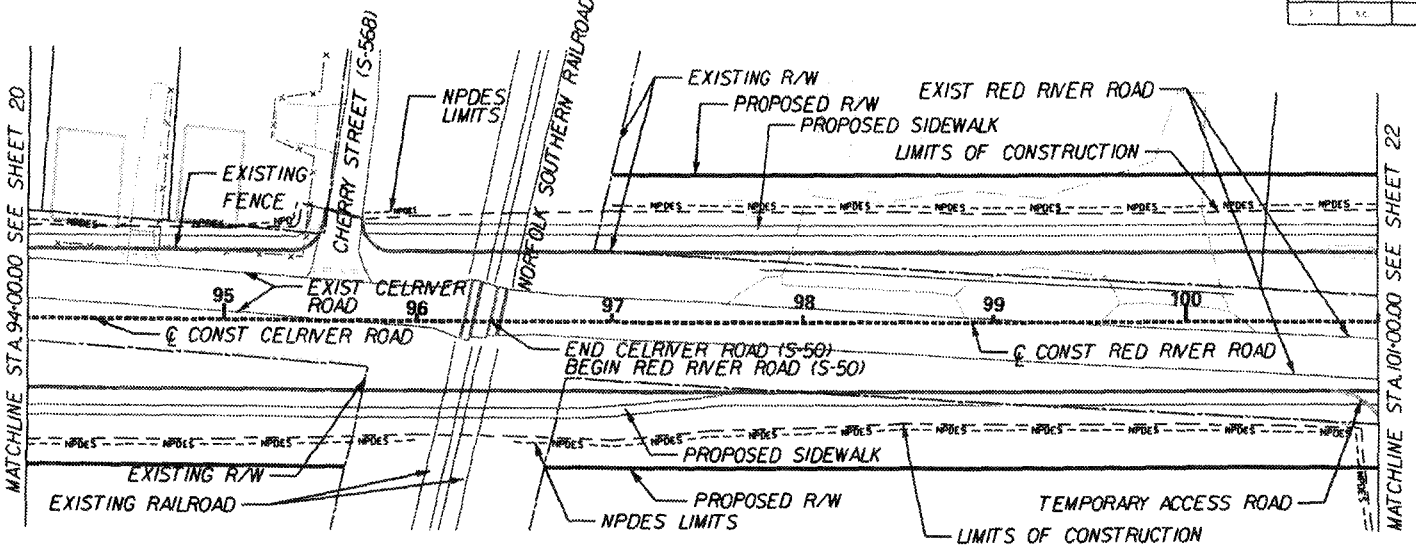

MATCHLINE STA 94+00.00 SEE SHEET 20

MATCHLINE STA 101+00.00 SEE SHEET 22

P/N 2010-01085-DS Sheet 21 of 35

WETLAND PERMIT DESIGN SHEET

THIS SHEET	
PERM FILL	0 AC
PERM CUT	0 AC
PERM CLEAR	0 AC
TEMP FILL	0 AC
TEMP CLEAR	0 AC

JURISDICTIONAL WETLAND BARRIER FENCE PROTECTION	
SHEET TOTAL	
0 LF	



HDR Engineering, Inc.  
of the Carolinas  
157 E. Main St., Suite 400  
Rock Hill, SC 29730  
803-409-2600

**PRELIMINARY PLANS**  
DO NOT USE FOR CONSTRUCTION



4			
3			
2			
1			
REV.	BY	DATE	DESCRIPTION OF REVISION

SOUTH CAROLINA  
DEPARTMENT OF TRANSPORTATION  
ROAD DESIGN COLUMBIA, S.C.  
**WETLAND PERMIT**  
PLAN SHEET 21  
STA. 94+00 TO STA. 101+00  
SCALE 1"=100' RTE. 5-50



FED. RD. DIST. NO.	STATE	COUNTY	FILE NO.	ROAD NO.	SHEET NO.
3	S.C.	YORK	48,268-1	569	22

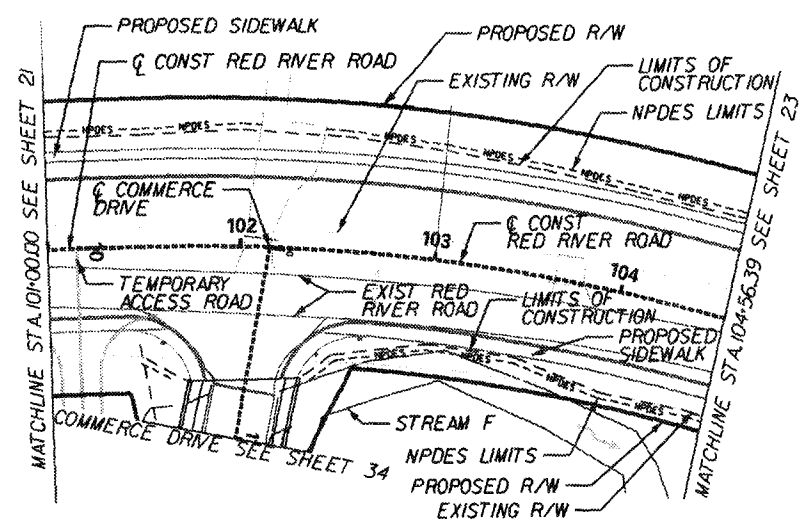

P/N 2010-01085-DS Sheet 22 of 35

THIS SHEET	
PERM FILL	0 AC
PERM CUT	0 AC
PERM CLEAR	0 AC
TEMP FILL	0 AC
TEMP CLEAR	0 AC

JURISDICTIONAL WETLAND BARRIER FENCE PROTECTION	
SHEET TOTAL	0 LF



HDR Engineering, Inc.  
 of the Carolinas  
 157 E. Main St., Suite 400  
 Rock Hill, SC 29730  
 803-995-2260

**PRELIMINARY PLANS**  
 DO NOT USE FOR CONSTRUCTION



4			
3			
2			
1			
REV.	BY	DATE	DESCRIPTION OF REVISION

SOUTH CAROLINA  
 DEPARTMENT OF TRANSPORTATION  
 ROAD DESIGN COLUMBIA, S.C.

**WETLAND PERMIT**

PLAN SHEET **22**  
 STA. 101+00.00 TO STA. 104+56.39

SCALE: 1"=40' RTE. S-50

10/10/2010 10:00:00 AM C:\Users\jrd\Documents\2010-01085-DS\2010-01085-DS.dwg

FED. RD DIST. NO.	STATE	COUNTY	F.B.E. NO.	ROAD NO.	SHEET NO.
1	SC	YORK	4820047	R-50	23

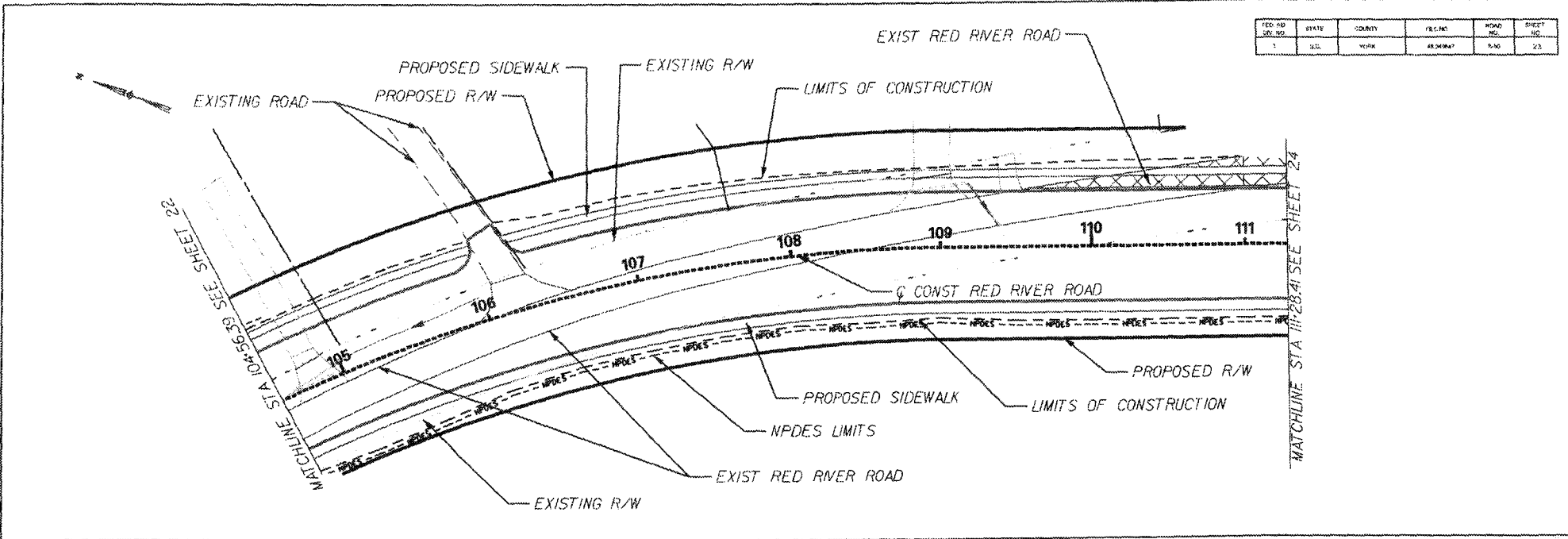

P/N 2010-01085-DS Sheet 23 of 35

11/15/10 10:58:58 AM 10/15/10 10:58:58 AM 10/15/10 10:58:58 AM 10/15/10 10:58:58 AM 10/15/10 10:58:58 AM

THIS SHEET	
	PERM FILL = 0 AC
	PERM CUT = 0 AC
	PERM CLEAR = 0 AC
	TEMP FILL = 0 AC
	TEMP CLEAR = 0 AC

JURISDICTIONAL WETLAND BARRIER FENCE PROTECTION
SHEET TOTAL
0 LF



HDR Engineering, Inc.  
 of the Carolinas  
 157 E. Main St., Suite 600  
 Fort Mill, SC 29728  
 803-548-2200

**PRELIMINARY PLANS**  
 DO NOT USE FOR CONSTRUCTION



4			
3			
2			
1			
REV.	BY	DATE	DESCRIPTION OF REVISION

SOUTH CAROLINA DEPARTMENT OF TRANSPORTATION ROAD DESIGN COLUMBIA, S.C.	
<b>WETLAND PERMIT</b>	
PLAN SHEET <span style="float: right;">23</span>	
STA. 104 + 56.39 TO STA. 111 + 28.41	
SCALE: HORIZ.	VERT. 1"=50'

FED. RD DIST. NO.	STATE	COUNTY	FILE NO.	ROAD NO.	SHEET NO.
3	S.C.	TRAF.	10-1085-D	S-24	24

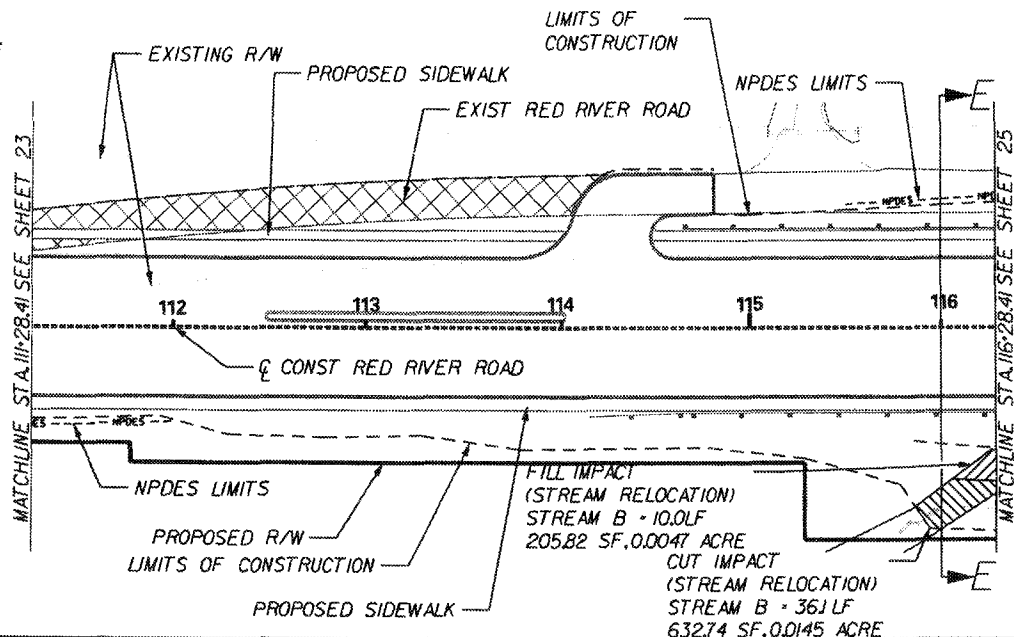

**CROSS SECTION**

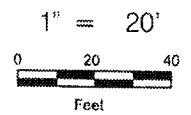
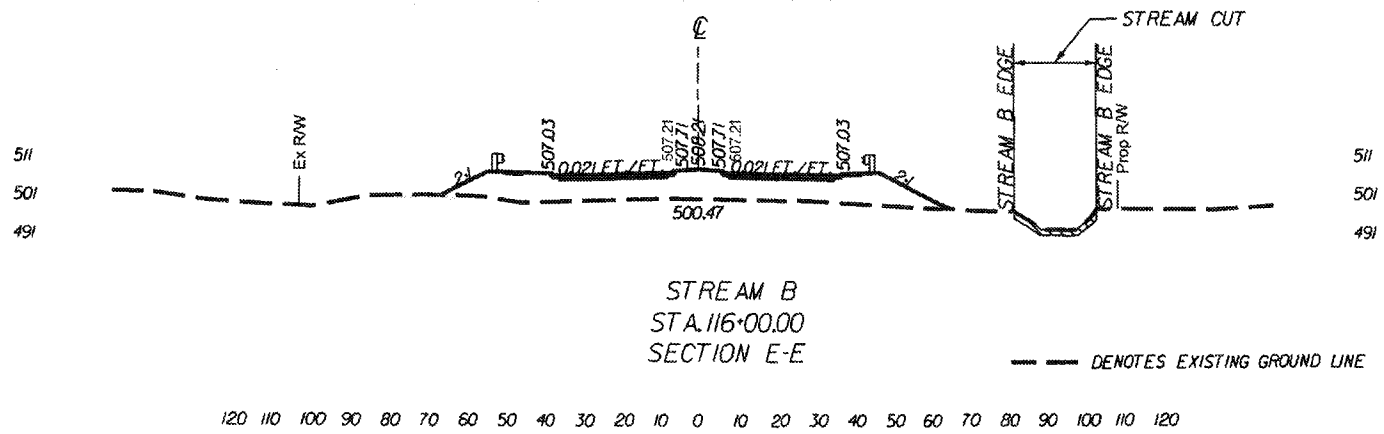

P/N 2010-01085-DS Sheet 24 of 35

**THIS SHEET**

PERM FILL	0.0047 AC
PERM CUT	80.0 LF
PERM CLEAR	0 AC
TEMP FILL	0 AC
TEMP CLEAR	0 AC

**JURISDICTIONAL WETLAND BARRIER FENCE PROTECTION**

SHEET TOTAL	0 LF
-------------	------



HDR Engineering Inc.  
157 E. Main St., Suite 400  
Rock Hill, SC 29730  
803-953-2000

**PRELIMINARY PLANS**  
DO NOT USE FOR CONSTRUCTION



REV.	BY	DATE	DESCRIPTION OF CHANGE
4			
3			
2			
1			

**SOUTH CAROLINA DEPARTMENT OF TRANSPORTATION ROAD DESIGN COLUMBIA, S.C.**

**WETLAND PERMIT**

PLAN AND CROSS SECTION SHEET 24  
STA. 111+28.41 TO STA. 116+28.41

SCALE: 1"=100' RTE. S-20

FED. RD. DIST. NO.	STATE	COUNTY	TRAC. NO.	POST-MILE	SHEET NO.
3	S.C.	WISSE	40-NB-10	5-40	25

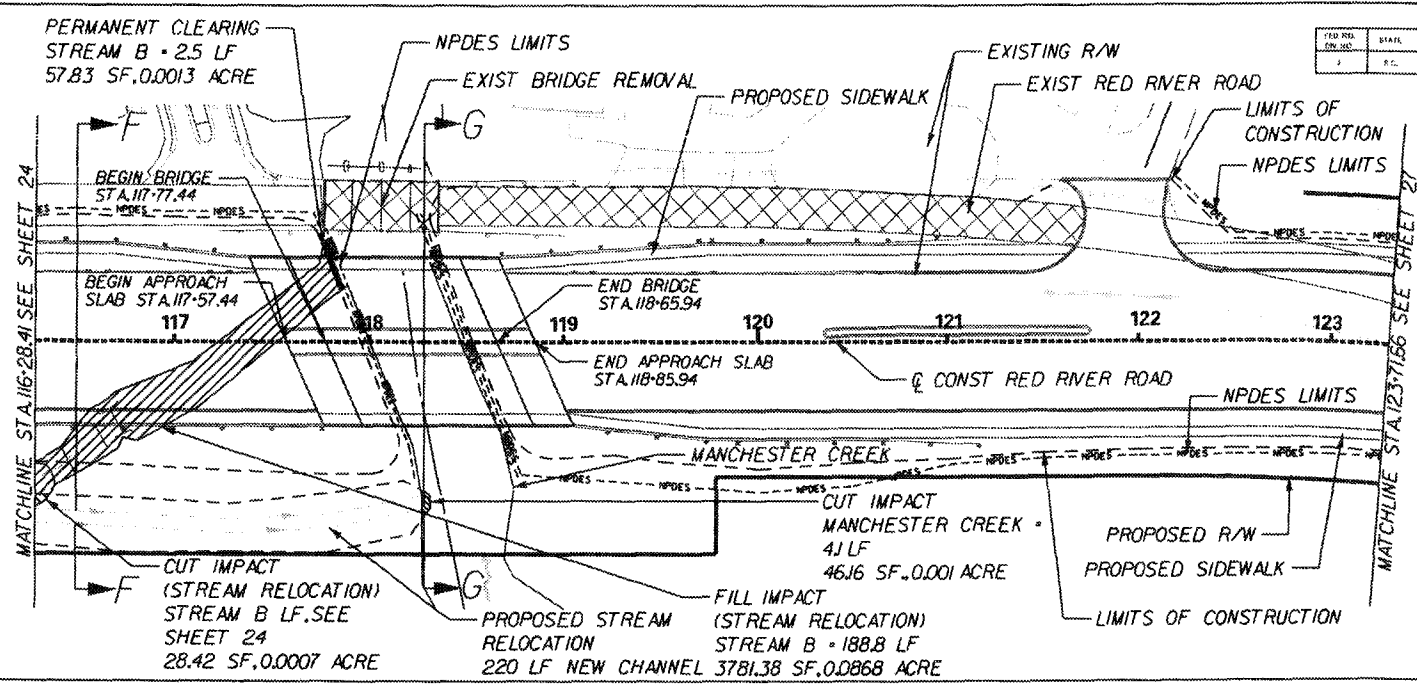

**CROSS SECTION**

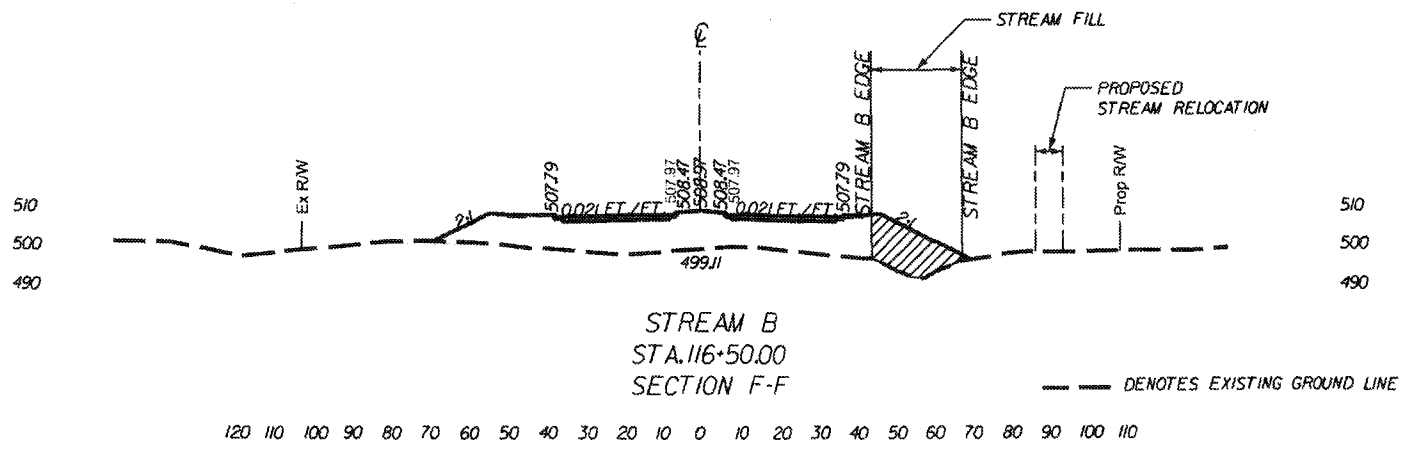

P/N 2010-01085-DS Sheet 25 of 35



PERM FILL =	0.0868 AC (388.8 LF)
PERM CUT =	0.0008 AC (4.1 LF)
PERM CLEAR =	0.0003 AC (2.5 LF)
TEMP FILL =	0 AC
TEMP CLEAR =	0 AC



HDR Engineering, Inc.  
40 years of experience  
157 E. Main St., Suite 400  
Riverside, SC 29176  
803-626-2900

**PRELIMINARY PLANS**  
DO NOT USE FOR CONSTRUCTION



REV.	BY	DATE	DESCRIPTION OF REVISION
4			
3			
2			
1			

SOUTH CAROLINA DEPARTMENT OF TRANSPORTATION ROAD DESIGN COLUMBIA, S.C.	
WETLAND PERMIT	
PLAN AND CROSS SECTION SHEET	25
STA 116 + 28.41 TO STA 123 + 71.66	
SCALE 1"=40'	RTG. 5-50

CROSS SECTION

FED. RD. DIST. NO.	STATE	COUNTY	FILE NO.	ROAD NO.	SHEET NO.
3	S.C.	YORK	AR-20947	540	26

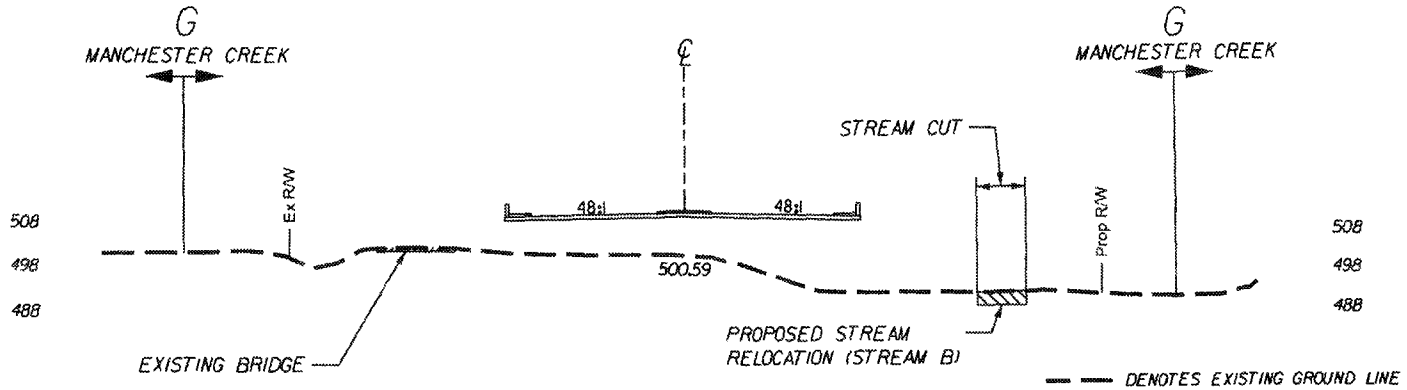

MANCHESTER CREEK  
STA. 118+28.41  
SECTION G-G

120 110 100 90 80 70 60 50 40 30 20 10 0 10 20 30 40 50 60 70 80 90 100 110

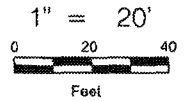

BRIDGE PROFILE

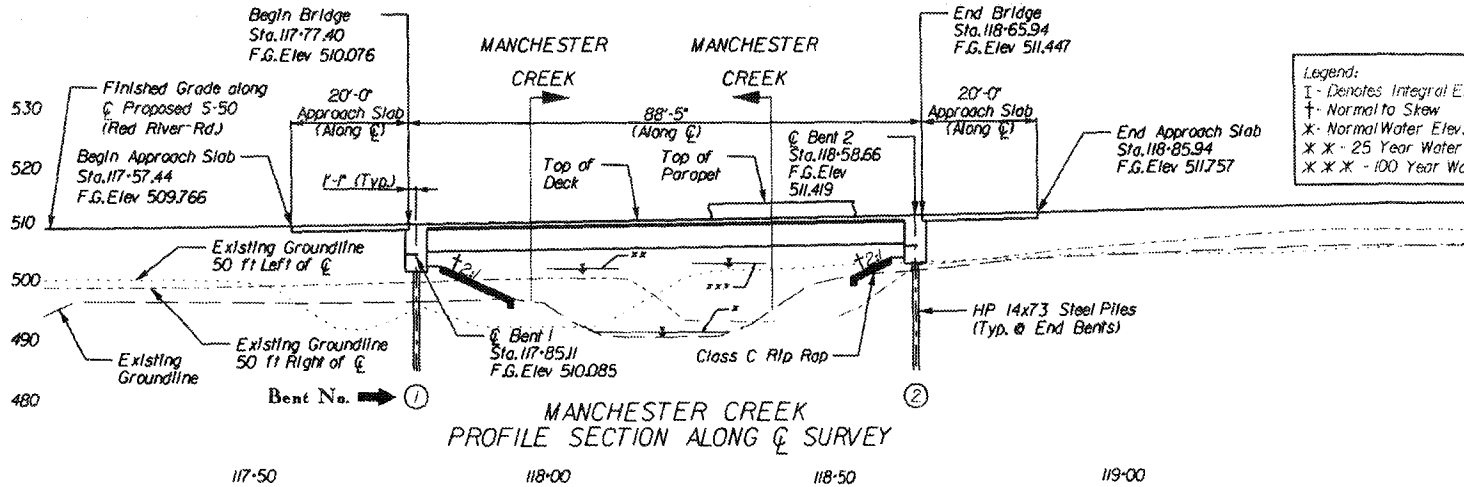

Legend:  
 † - Denotes Integral End Bent  
 † - Normal to Skew  
 \* - Normal Water Elev. = 491.60 (12/13/11)  
 \* \* - 25 Year Water Elev. = 502.40  
 \* \* \* - 100 Year Water Elev. = 503.32

HYDRAULIC DATA:  
 D.A. = 11.4 Sq. Mi.  
 0.25 = 4,203 CF'S  
 Area Furnished Under  
 502.40 = 472.24 Sq. Ft.  
 Vel. = 8.92 FPS  
 0100 = 5,112 CF'S  
 Area Furnished Under  
 503.32 = 519.03 Sq. Ft.  
 Vel. = 9.88 FPS  
 OVERTOPPING FLOOD  
 Q = 7,435  
 Probability = 0.002%

MANCHESTER CREEK  
PROFILE SECTION ALONG  $\hat{C}$  SURVEY

2025 RELEASE UNDER E.O. 14176

THIS SHEET		
PERM. FILL	0 AC	
PERM. CUT	0 AC	
PERM. CLEAR	0 AC	
TEMP. FILL	0 AC	
TEMP. CLEAR	0 AC	

JURISDICTIONAL WETLAND BARRIER FENCE PROTECTION	
SHEET TOTAL	0 LF



**PRELIMINARY PLANS**  
DO NOT USE FOR CONSTRUCTION

P/N 2010-01085-DS Sheet 26 of 35



3			
2			
1			
REV.	DATE	DATE	DESCRIPTION OF CHANGE

SOUTH CAROLINA  
DEPARTMENT OF TRANSPORTATION  
ROAD DESIGN COLUMBIA, S.C.  
WETLAND PERMIT  
CROSS SECTION AND PROFILE SHEET 26  
STA 118+28.41 TO STA 118+00.00  
SCALE: HORIZ. - 1" = 50'



FED. HQL. DISTRICT	STATE	COUNTY	PROJECT	ROAD NO.	SHEET NO.
1	S.C.	YORK	WETLAND	540	28

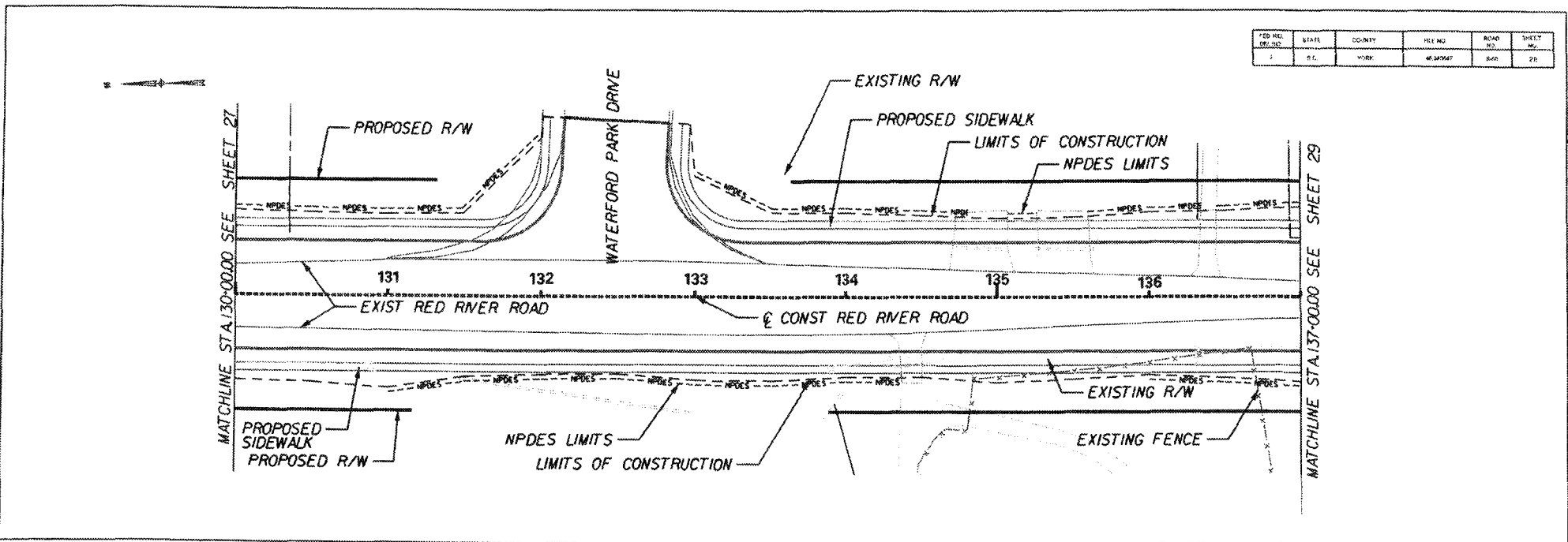

P/N 2010-01085-DS Sheet 28 of 35

8/20/10 10:58 AM 10/20/10 10:58 AM  
 8/20/10 10:58 AM 10/20/10 10:58 AM

THIS SHEET	
PERM FILL	0 AC
PERM CUT	0 AC
PERM CLEAR	0 AC
TEMP FILL	0 AC
TEMP CLEAR	0 AC

JURISDICTIONAL WETLAND BARRIER FENCE PROTECTION	
SHEET TOTAL	
0 LF	



HDR Engineering, Inc.  
 of the Carolinas  
 157 E. Main St., Suite 400  
 Rock Hill, SC 29730  
 803-961-2200

**PRELIMINARY PLANS**  
 DO NOT USE FOR CONSTRUCTION



4			
3			
2			
1			
REV.	BY	DATE	DESCRIPTION OF REVISION

SOUTH CAROLINA  
 DEPARTMENT OF TRANSPORTATION  
 ROAD DESIGN      COLUMBIA, S.C.

**WETLAND PERMIT**

PLAN SHEET      28  
 STA. 130+00.00 TO STA. 137+00.00

SCALE: 1"=100'      RTE. 5-50

FED. RD. DIST. NO.	STATE	COUNTY	FILE NO.	ROAD NO.	SHEET NO.
7	S.C.	YORK	46-07607	508	29

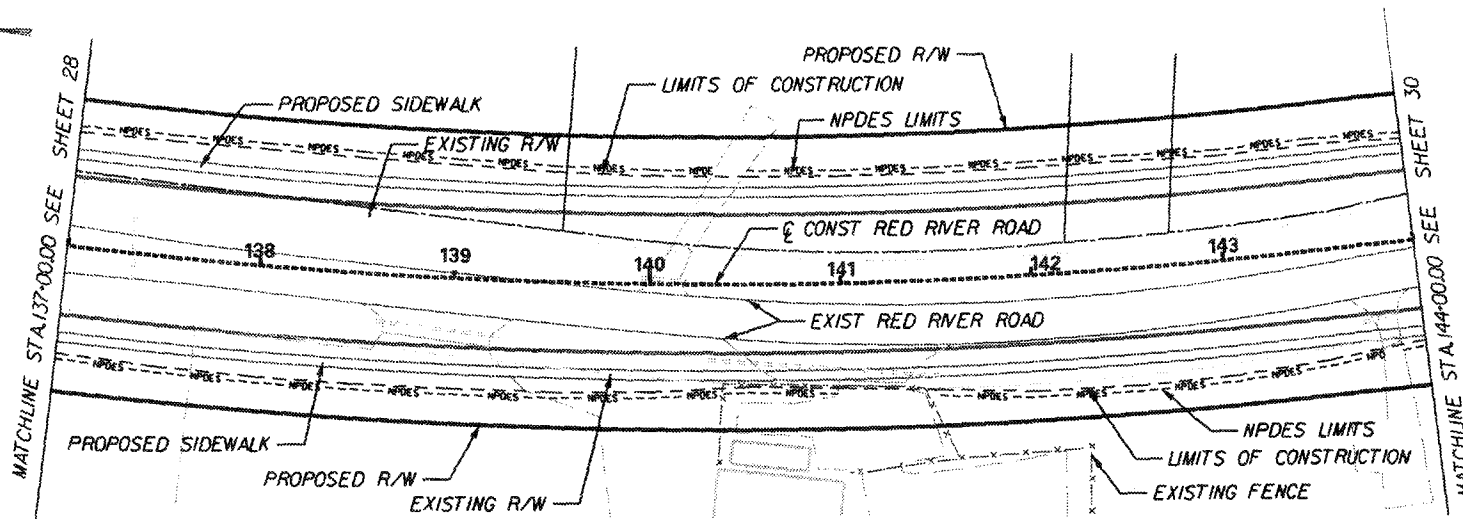

P/N 2010-01085-DS Sheet 29 of 35

THIS SHEET	
PERM FILL	0 AC
PERM CUT	0 AC
PERM CLEAR	0 AC
TEMP FILL	0 AC
TEMP CLEAR	0 AC

JURISDICTIONAL WETLAND	
BARRIER FENCE PROTECTION	
SHEET TOTAL	0 LF



HDR Engineering, Inc.  
 157 E. Main St., Suite 400  
 York, S.C. 29732  
 803-495-2200

**PRELIMINARY PLANS**  
 DO NOT USE FOR CONSTRUCTION



4			
3			
2			
1			
REV.	BY	DATE	DESCRIPTION OF REVISION

SOUTH CAROLINA	
DEPARTMENT OF TRANSPORTATION	
ROAD DESIGN COLUMBIA, S.C.	
WETLAND PERMIT	
PLAN SHEET	
STA. 137+00 TO STA. 144+00	
SCALE 1"=100'	RTE. 5-50

8:10/11/15  
 8:10/11/15  
 8:10/11/15  
 8:10/11/15



FED. RD. DIST. NO.	STATE	COUNTY	FILE NO.	ROAD NO.	SHEET NO.
4	S.C.	YORK	4610040	340	30

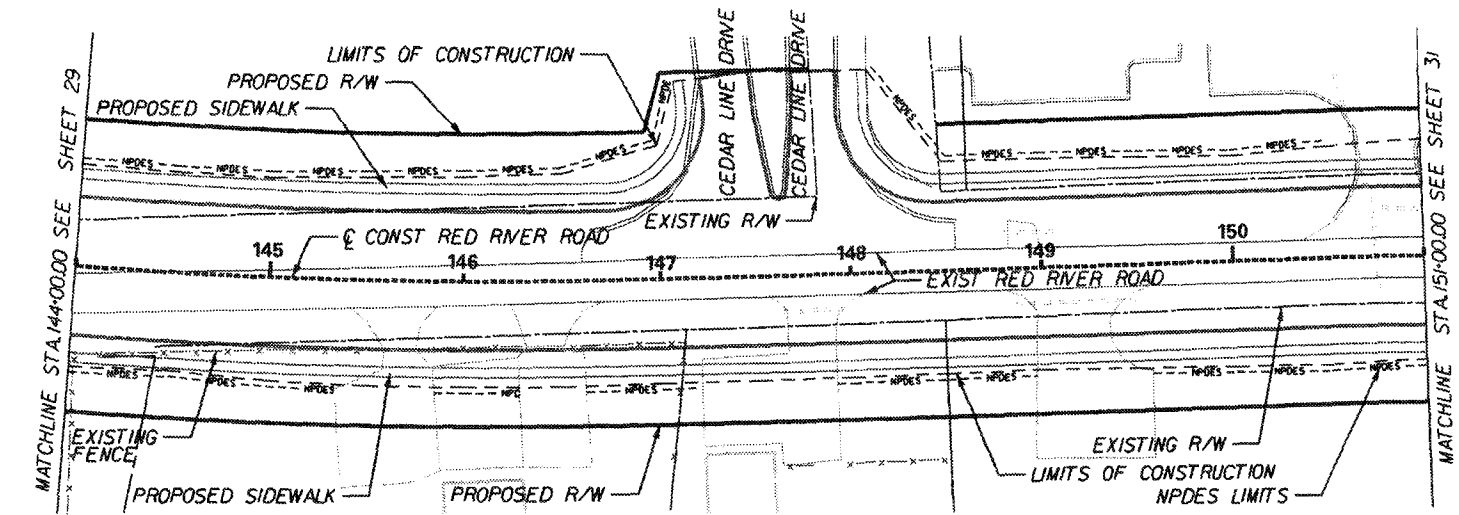

P/N 2010-01085-DS Sheet 30 of 35

15  
 14  
 13  
 12  
 11  
 10  
 9  
 8  
 7  
 6  
 5  
 4  
 3  
 2  
 1

THIS SHEET	
PERM FILL	0 AC
PERM CUT	0 AC
PERM CLEAR	0 AC
TEMP FILL	0 AC
TEMP CLEAR	0 AC

JURISDICTIONAL WETLAND BARRIER FENCE PROTECTION	
SHEET TOTAL	0 LF



HDR Engineering, Inc.  
 of the Carolinas  
 157 E. Main St., Suite 400  
 York, PA 17403  
 800-440-0900

**PRELIMINARY PLANS**  
 DO NOT USE FOR CONSTRUCTION



4			
3			
2			
1			
REV.	BY	DATE	DESCRIPTION OF REVISION

SOUTH CAROLINA  
 DEPARTMENT OF TRANSPORTATION  
 ROAD DESIGN COLUMBIA, S.C.  
**WETLAND PERMIT**  
 PLAN SHEET 30  
 STA. 144+00 TO STA. 151+00  
 SCALE: 1"=100' RTE. 5-50

FILE NO.	STATE	COUNTY	FILE NO.	ROAD NO.	SHEET NO.
2	S.C.	YORK	1010885	543	31

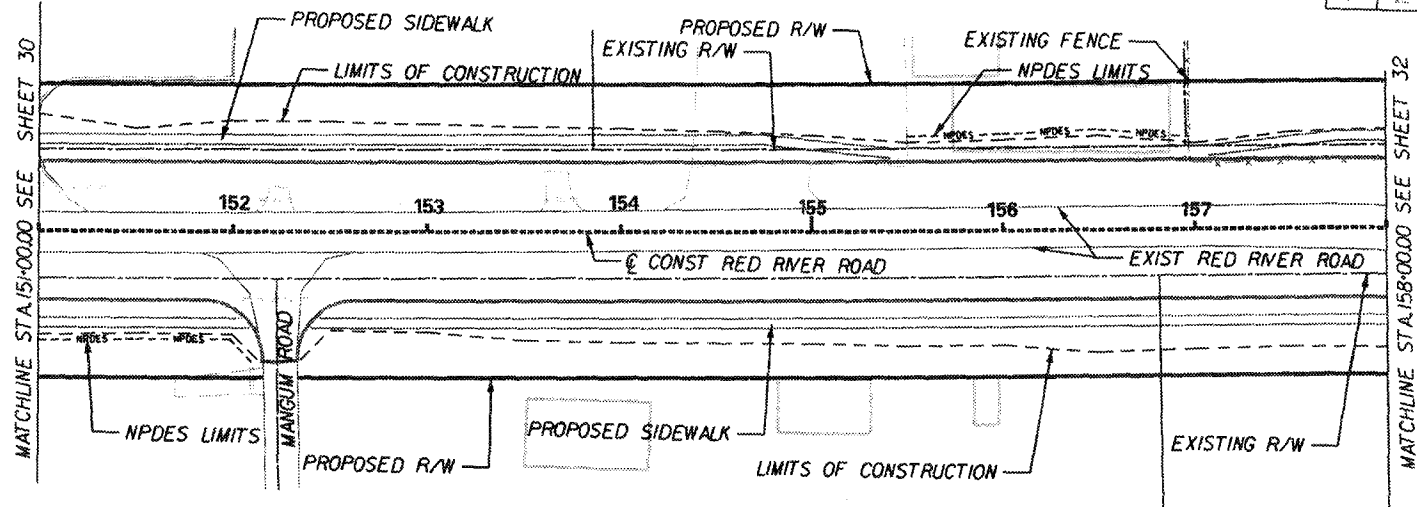

P/N 2010-01085-DS Sheet 31 of 35

THIS SHEET	
	PERM FILL = 0 AC
	PERM CUT = 0 AC
	PERM CLEAR = 0 AC
	TEMP FILL = 0 AC
	TEMP CLEAR = 0 AC

JURISDICTIONAL WETLAND BARRIER FENCE PROTECTION	
SHEET TOTAL 0 LF	



HDR Engineering, Inc.  
of ma Corridor  
157 E. Main St., Suite 400  
Rock Hill, SC 29730  
803-969-2600

**PRELIMINARY PLANS**  
DO NOT USE FOR CONSTRUCTION



4			
3			
2			
1			
NO.	BY	DATE	DESCRIPTION OF REVISION

SOUTH CAROLINA  
DEPARTMENT OF TRANSPORTATION  
ROAD DESIGN COLUMBIA, S.C.

**WETLAND PERMIT**

PLAN SHEET  
STA. 151+00 TO STA. 158+00

SCALE: 1"=400' RTE. S-50

31

800-451-1111  
 800-451-1111  
 800-451-1111

FED RD DISTRICT	STATE	COUNTY	FILE NO.	ROAD NO.	SHEET NO.
3	S.C.	YORK	44-04241	S-60	32

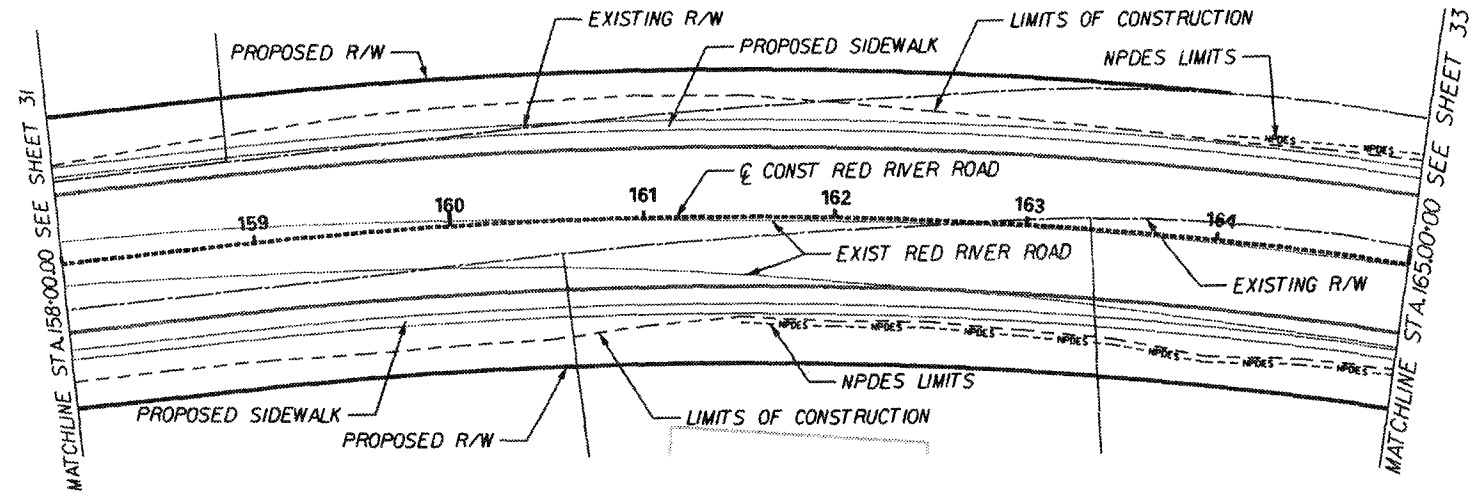

P/N 2010-01085-DS Sheet 32 of 35

10/10/10 10:00 AM 10/10/10 10:00 AM 10/10/10 10:00 AM 10/10/10 10:00 AM 10/10/10 10:00 AM 10/10/10 10:00 AM 10/10/10 10:00 AM 10/10/10 10:00 AM 10/10/10 10:00 AM 10/10/10 10:00 AM

THIS SHEET		JURISDICTIONAL WETLAND BARRIER FENCE PROTECTION
	PERM FILL : 0 AC	SHEET TOTAL 0 LF
	PERM CUT : 0 AC	
	PERM CLEAR : 0 AC	
	TEMP FILL : 0 AC	
	TEMP CLEAR : 0 AC	



HDR Engineering, Inc.  
of the Carolinas  
157 E. Main St., Suite 400  
Rock Hill, SC 29730  
803-498-2200

**PRELIMINARY PLANS**  
DO NOT USE FOR CONSTRUCTION



4			
3			
2			
1			
1			
DATE	BY	CHK	DESCRIPTION OF REVISION

SOUTH CAROLINA DEPARTMENT OF TRANSPORTATION ROAD DESIGN COLUMBIA, S.C.	
WETLAND PERMIT	
PLAN SHEET	32
STA 158+00 TO STA 165+00	
SCALE 1"=100'	RTS. S-50

FED. RD. DIST. NO.	STATE	COUNTY	FILE NO.	ROAD NO.	SHEET NO.
3	S.C.	WETA	4174287	545	33

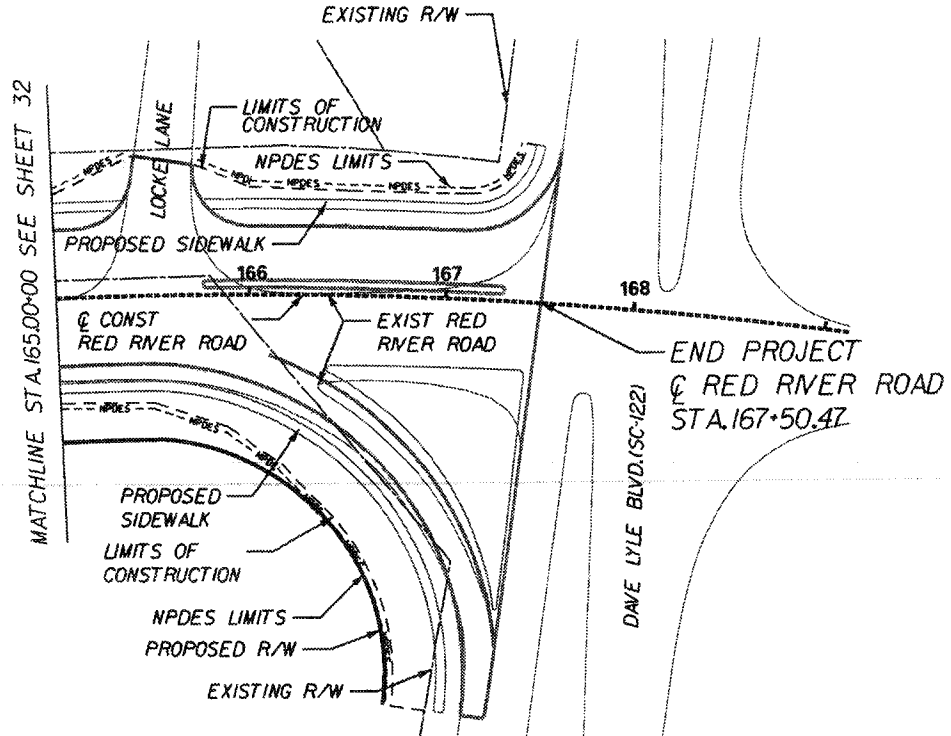

P/N 2010-01085-DS Sheet 33 of 35

THIS SHEET	
PERM FILL	0 AC
PERM CUT	0 AC
PERM CLEAR	0 AC
TEMP FILL	0 AC
TEMP CLEAR	0 AC

JURISDICTIONAL WETLAND BARRIER FENCE PROTECTION	
SHEET TOTAL	
0 LF	



HDR Engineering Inc.  
of the Carolinas  
157 E. Main St., Suite 400  
Raleigh, NC 27601  
803-809-2700

**PRELIMINARY PLANS**  
DO NOT USE FOR CONSTRUCTION



4			
3			
2			
1			
REV. NO.	BY	DATE	DESCRIPTION OF REVISION
TOPC			
DWG			
R/W			

SOUTH CAROLINA  
DEPARTMENT OF TRANSPORTATION  
ROAD DESIGN COLUMBIA, S.C.

**WETLAND PERMIT**

PLAN SHEET **33**  
STA. 165+00.00 TO STA. 168+00.00

SCALE 1"=100' RTE. S-50

861068-33  
 861068-01085-DS-33  
 11/20/10 10:53:53

FED. RD. DIST. NO.	STATE	COUNTY	FILE NO.	ROAD NO.	SHEET NO.
3	SC	YORK	43-00947	5-01	34

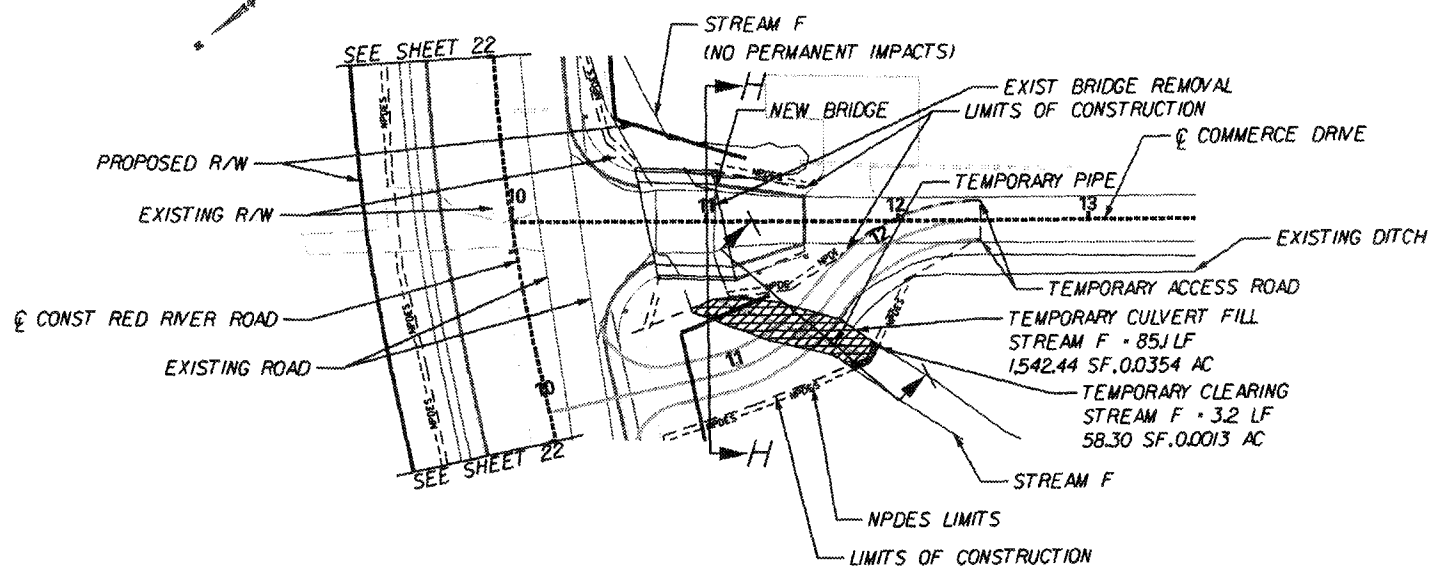

**CROSS SECTION**

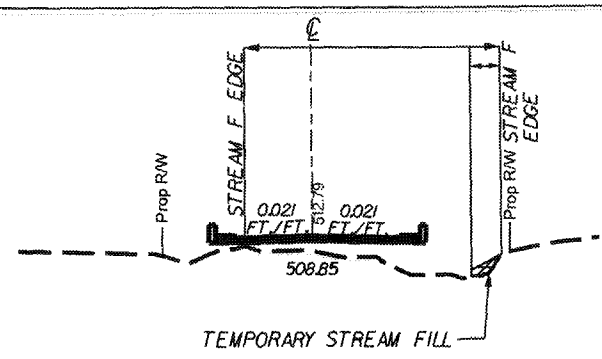

P/N 2010-01085-DS Sheet 34 of 35

STREAM F  
STA. 11+00.00  
SECTION H-H

--- DENOTES EXISTING GROUND LINE

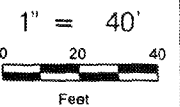

120 110 100 90 80 70 60 50 40 30 20 10 0 10 20 30 40 50 60 70 80 90 100 110

THIS SHEET

PERM FILL	= 0 AC
PERM CUT	= 0 AC
PERM CLEAR	= 0 AC
TEMP FILL	= 0.0354 AC (85.1 LF)
TEMP CLEAR	= 0.0013 AC (3.2 LF)

JURISDICTIONAL WETLAND BARRIER FENCE PROTECTION

SHEET TOTAL	0 LF
-------------	------



HDR Engineering, Inc.  
of the Conditions  
117 E. 44th St., Suite 400  
Rock Hill, SC 29730  
803-969-4200

**PRELIMINARY PLANS**  
DO NOT USE FOR CONSTRUCTION



4			
3			
2			
1			
REV.	DATE	BY	DESCRIPTION OF REVISION

SOUTH CAROLINA  
DEPARTMENT OF TRANSPORTATION  
ROAD DESIGN COLUMBIA, S.C.  
**WETLAND PERMIT**  
PLAN AND CROSS SECTION SHEET **34**  
COMMERCER DRIVE  
SCALE 1"=40' RTE. 5-50

6/14/2010 10:58:58 AM C:\Users\j\Documents\1010085\1010085.dwg

CROSS SECTION

FED. RD. DIST. NO.	STATE	COUNTY	PRJ. NO.	ROAD NO.	SHEET NO.
5	S.C.	YERN.	1010841	502	35

522  
512  
502

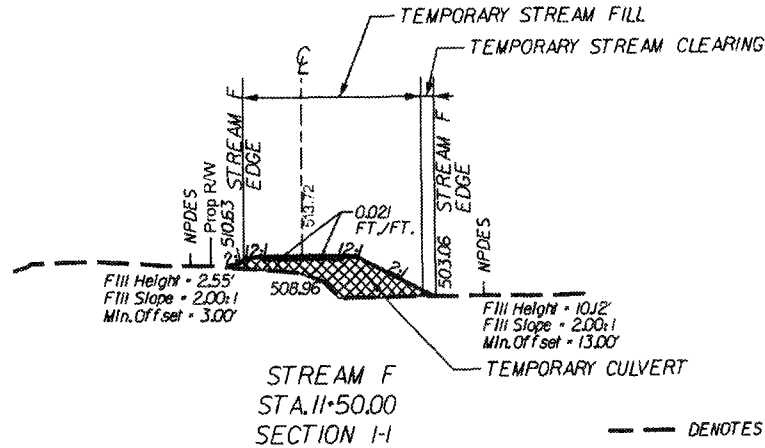

522  
512  
502

120 110 100 90 80 70 60 50 40 30 20 10 0 10 20 30 40 50 60 70 80 90 100 110

--- DENOTES EXISTING GROUND LINE

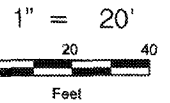

P/N 2010-01085-DS Sheet 35 of 35

THIS SHEET	
PERM FILL	0 AC
PERM CUT	0 AC
PERM CLEAR	0 AC
TEMP FILL	0 AC
TEMP CLEAR	0 AC

JURISDICTIONAL WETLAND BARRIER FENCE PROTECTION	
SHEET TOTAL	
0 LF	



HDR Engineering, Inc.  
167 E. Main St., Suite 400  
Rucka Hall, 97, 29730  
WV-910-2200

**PRELIMINARY PLANS**  
DO NOT USE FOR CONSTRUCTION



REV.	BY	DATE	DESCRIPTION OF REVISION
4			
3			
2			
1			

SOUTH CAROLINA DEPARTMENT OF TRANSPORTATION ROAD DESIGN COLUMBIA, S.C.	
WETLAND PERMIT	
CROSS SECTION SHEET	35
COMMERCE DRIVE	
SCALE 1"=40'	RTS. 5-50