

JOINT
PUBLIC NOTICE

CHARLESTON DISTRICT, CORPS OF ENGINEERS
1949 Industrial Park Road, Room 140
Conway, South Carolina 29526
and
THE S.C. DEPARTMENT OF HEALTH AND ENVIRONMENTAL CONTROL
Water Quality Certification and Wetlands Section
2600 Bull Street
Columbia, South Carolina 29201

REGULATORY DIVISION
Refer to: P/N SAC-2012-00274

DATE December 22, 2016

Pursuant to Section 10 of the Rivers and Harbors Act of 1899 (33 U.S.C. 403), Sections 401 and 404 of the Clean Water Act (33 U.S.C. 1344), the South Carolina Coastal Zone Management Act (48-39-10 et seq.), and the S.C. Construction in Navigable Waters Permit Program (R. 19-450, et seq., 1976 S.C. Code of Laws, as amended), an application has been submitted to the Department of the Army and the S.C. Department of Health and Environmental Control by

Dan Liu / Founders Development, LLC
The Earthworks Group
c/o Alan Wood
11655 Highway 707
Murrells Inlet, SC 29575

for a permit to construct a private use dock and dredge in the

ATLANTIC INTRACOASTAL WATERWAY (AIWW)

at 3860 Hobcaw Drive, Myrtle Beach, Horry County, South Carolina (Latitude: 33.7322 °N, Longitude: -78.8854 °W), Myrtle Beach Quad.

In order to give all interested parties an opportunity to express their views

NOTICE

is hereby given that written statements regarding the proposed work will be received by the **Corps** until

15 Days from the Date of this Notice,

and **SCDHEC** will receive written statements regarding the proposed work until

30 Days from the Date of this Notice

from those interested in the activity and whose interests may be affected by the proposed work.

The proposed work consists of the construction of a private use dock and associated dredging in the AIWW. In detail, a 16' x 32' covered pierhead will be attached to an existing bulkhead by a 4' x 56' walkway. On the northeast side of the pierhead will be a 3' X 16' ramp leading to an 8' X 32' floating dock. On the southwest side of the pierhead is a 14' X 14' four pile boatlift with a 16' X 32' roof. The proposed dredging envelope would encompass 7,020 SF of open water area in the AIWW and remove 600 CY of bottom material. The bottom would be excavated to a depth of -3.0' along the landward margin to -6.0' (elevations in NAVD88) along the AIWW channel. The landward and side margins of the dredged bottom would be graded at a 2:1 slope to the existing elevations to reduce backfilling. Dredging would be completed by a barge mounted long reach excavator and saturated spoil will be initially placed into a material barge until full. A full material barge will be transported by tug to the designated spoil disposal located site 6 miles south on the AIWW. Dredged material would be offloaded from barge onto the uplands at the disposal site and into the 50' X 100' double row silt fence spoil containment/dewatering basin by heavy equipment. The 5000 SF dewatering basin has a material capacity of 615 CY when filled to a height of 3' with 2:1 side slopes. Once placed in the basin, dewatering will occur through the silt fence fabric and out to the AIWW. The applicant has not proposed mitigation for this project due to the small size and nature of impacts to wetlands and/or waters of the United States. The project purpose is recreational access.

NOTE: This public notice and associated plans are available on the Corps' website at:
<http://www.sac.usace.army.mil/Missions/Regulatory/PublicNotices> .

The District Engineer has concluded that the discharges associated with this project, both direct and indirect, should be reviewed by the South Carolina Department of Health and Environmental Control in accordance with provisions of Section 401 of the Clean Water Act. As such, this notice constitutes a request, on behalf of the applicant, for certification that this project will comply with applicable effluent limitations and water quality standards. The work shown on this application must also be certified as consistent with applicable provisions of the Coastal Zone Management Program (15 CFR 930). This activity may also require evaluation for compliance with the S. C. Construction in Navigable Waters Permit Program. State review, permitting and certification is conducted by the S. C. Department of Health and Environmental Control. The District Engineer will not process this application to a conclusion until such certifications are received. The applicant is hereby advised that supplemental information may be required by the State to facilitate the review.

This notice initiates the Essential Fish Habitat (EFH) consultation requirements of the Magnuson-Stevens Fishery Conservation and Management Act. Implementation of the proposed project would impact **0.20** acres of estuarine substrates and emergent wetlands utilized by various life stages of species comprising the shrimp, and snapper-grouper management complexes. The District Engineer's initial determination is that the proposed action would not have a substantial individual or cumulative adverse impact on EFH or fisheries managed by the South Atlantic Fishery Management Council and the National Marine Fisheries Service (NMFS). The District Engineer's final determination relative to project impacts and the need for mitigation measures is subject to review by and coordination with the NMFS.

Pursuant to the Section 7 of the Endangered Species Act of 1973 (as amended), the Corps has reviewed the project area, examined all information provided by the applicant, and the District Engineer has determined that the project is not likely to adversely affect the West Indian Manatee, or result in the destruction or adverse modification of designated or proposed critical habitat. However, it has been determined that the project will have no effect on Shortnose Sturgeon

(*Acipenser brevirostrum*), Atlantic sturgeon (*Acipenser oxyrinchus oxyrinchus*) and will not result in the destruction or adverse modification of designated or proposed critical habitat. This public notice serves as a request for written concurrence from the U.S. Fish and Wildlife Service.

Pursuant to Section 106 of the National Historic Preservation Act (NHPA), this public notice also constitutes a request to Indian Tribes to notify the District Engineer of any historic properties of religious and cultural significance to them that may be affected by the proposed undertaking.

In accordance with Section 106 of the NHPA, the District Engineer has consulted South Carolina ArchSite (GIS), for the presence or absence of historic properties (as defined in 36 C.F.R. 800.16)(1)(1)), and has initially determined that no historic properties are present; therefore, there will be no effect on historic properties. To ensure that other historic properties that the District Engineer is not aware of are not overlooked, this public notice also serves as a request to the State Historic Preservation Office and any other interested parties to provide any information they may have with regard to historic properties. This public notice serves as a request for concurrence within 30 days from the SHPO (and/or Tribal Historic Preservation Officer).

The District Engineer's final eligibility and effect determination will be based upon coordination with the SHPO and/or THPO, as appropriate and required and with full consideration given to the proposed undertaking's potential direct and indirect effects on historic properties within the Corps-identified permit area.

Any person may request, in writing, within the comment period specified in this notice, that a public hearing be held to consider this application. Requests for a public hearing shall state, with particularity, the reasons for holding a public hearing.

The decision whether to issue a permit will be based on an evaluation of the probable impact including cumulative impacts of the activity on the public interest. The benefit which reasonably may be expected to accrue from the project must be balanced against its reasonably foreseeable detriments. All factors which may be relevant to the project will be considered including the cumulative effects thereof; among those are conservation, economics, aesthetics, general environmental concerns, wetlands, historic properties, fish and wildlife values, flood hazards, flood plain values, land use, navigation, shoreline erosion and accretion, recreation, water supply and conservation, water quality, energy needs, safety, food and fiber production and, in general, the needs and welfare of the people. A permit will be granted unless the District Engineer determines that it would be contrary to the public interest. In cases of conflicting property rights, the Corps cannot undertake to adjudicate rival claims.

The Corps is soliciting comments from the public; Federal, state, and local agencies and officials; Indian Tribes; and other interested parties in order to consider and evaluate the impacts of this activity. Any comments received will be considered by the Corps to determine whether to issue, modify, condition or deny a permit for this project. To make this decision, comments are used to assess impacts on endangered species, historic properties, water quality, general environmental effects, and the other public interest factors listed above. Comments are used in the preparation of an Environmental Assessment and/or an Environmental Impact Statement pursuant to the National Environmental Policy Act. Comments are also used to determine the need for a public hearing and to determine the overall public interest of the activity. **Please submit comments in writing, identifying the project of interest by public notice number,**

REGULATORY DIVISION
SAC-2012-00274

DATE December 22, 2016

to the following address:

**U.S. Army Corps of Engineers
ATTN: REGULATORY DIVISION
1949 Industrial Park Road, Room 140
Conway, South Carolina 29526**

If there are any questions concerning this public notice, please contact T. Brian Hardee, Project Manager, at (843) 365-4239.

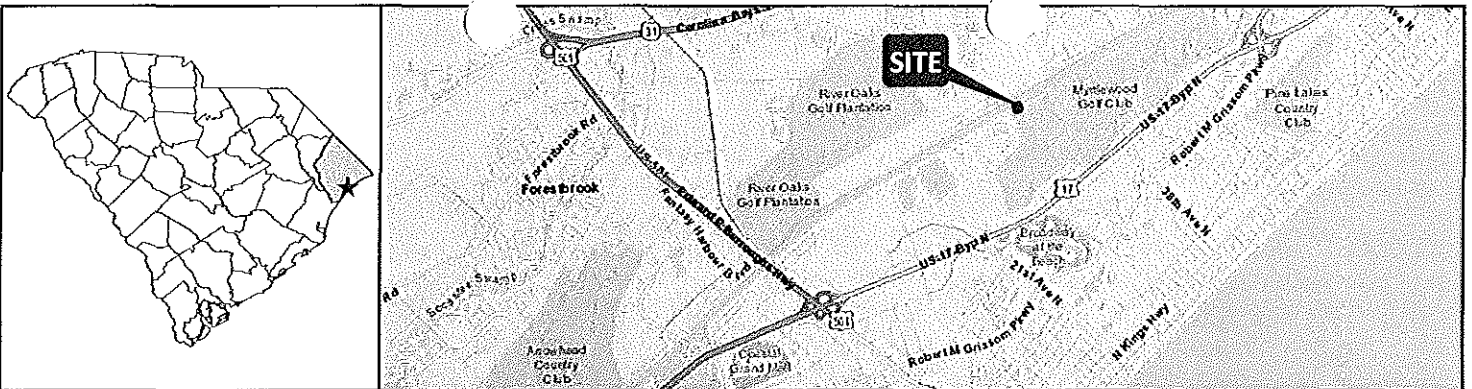

TMS	PIN	OWNER	ADDRESS	CITY, STATE, ZIP
A	173-06-01-004	41912030054 SAMUEL Y LAUREN	1000 S KINGS HWY	MYRTLE BEACH, SC 29577-4419
B	173-06-01-017	41912030047 STEVEN M & TERESA A CALLIHAN	1371 BROOKGREEN DR	MYRTLE BEACH, SC 29577-5822
C	173-06-01-016	41912030048 STEVEN M CALLIHAN ETAL	1371 BROOKGREEN DR	MYRTLE BEACH, SC 29577

EARTHWORKS
planning and design consultants

11655 HIGHWAY 707
 MURRELLS INLET, SC 29576
 phone - 843-651-7900
 fax - 843-651-7903
 www.earthworksgroup.com

SITE/VICINITY MAP

LOT 10 BLOCK D, PLANTATION POINT
 DOCK PERMIT

SCALE
 1" = 200'

APPLICANT: FOUNDERS DEVELOPMENT, LLC
 2000 WORLD TOUR BLVD
 MYRTLE BEACH, SC 29579
 TMS: 173-06-01-005 | PIN: 41912030053

LOCATION: 3860 HOBCAW DRIVE, MYRTLE BEACH
 Horry County, SOUTH CAROLINA

LAT/LONG: 33.732233 by -78.885432
 USGS QUAD: MYRTLE BEACH

DATE: 10/31/2016

SHEET
 1

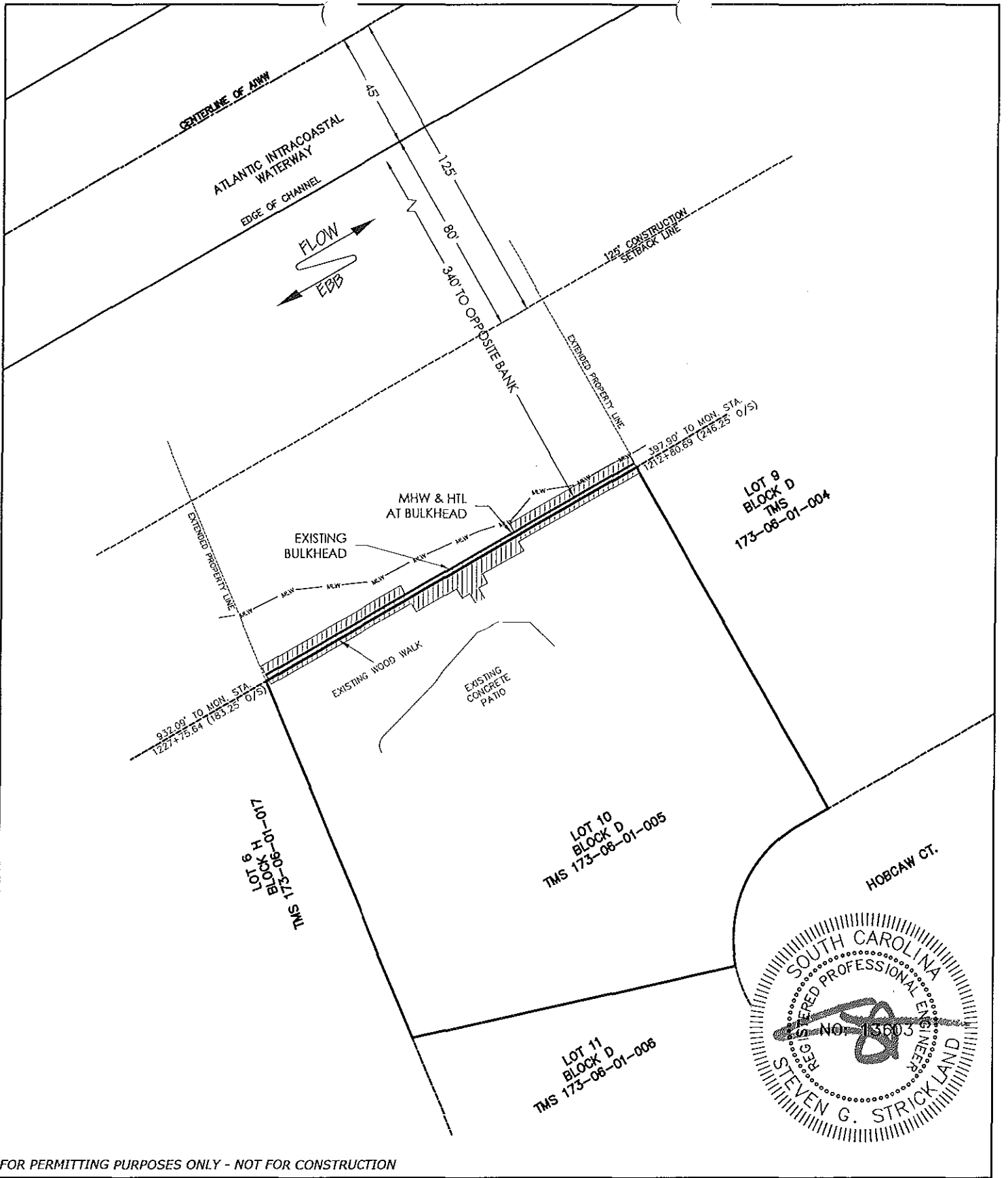

FOR PERMITTING PURPOSES ONLY - NOT FOR CONSTRUCTION

EARTHWORKS
planning and design consultants

11655 HIGHWAY 707
 MURRELLS INLET, SC 29576
 phone - 843.651.7900
 fax - 843.651.7903
 earthworksgroup.com

SITE - EXISTING

LOT 10 BLOCK D, PLANTATION POINT

DOCK PERMIT

0 25 50

SCALE 1" = 50'

↑

APPLICANT: FOUNDERS DEVELOPMENT, LLC
 2000 WORLD TOUR BLVD
 MYRTLE BEACH, SC 29579

LOCATION: 3860 HOBCAW DRIVE, MYRTLE BEACH
 HORRY COUNTY, SOUTH CAROLINA
 LAT/LONG: 33.732233, -78.885432
 USGS QUAD: MYRTLE BEACH

DATE: 12/1/16

TEG PN: 151104.001

SHEET 2

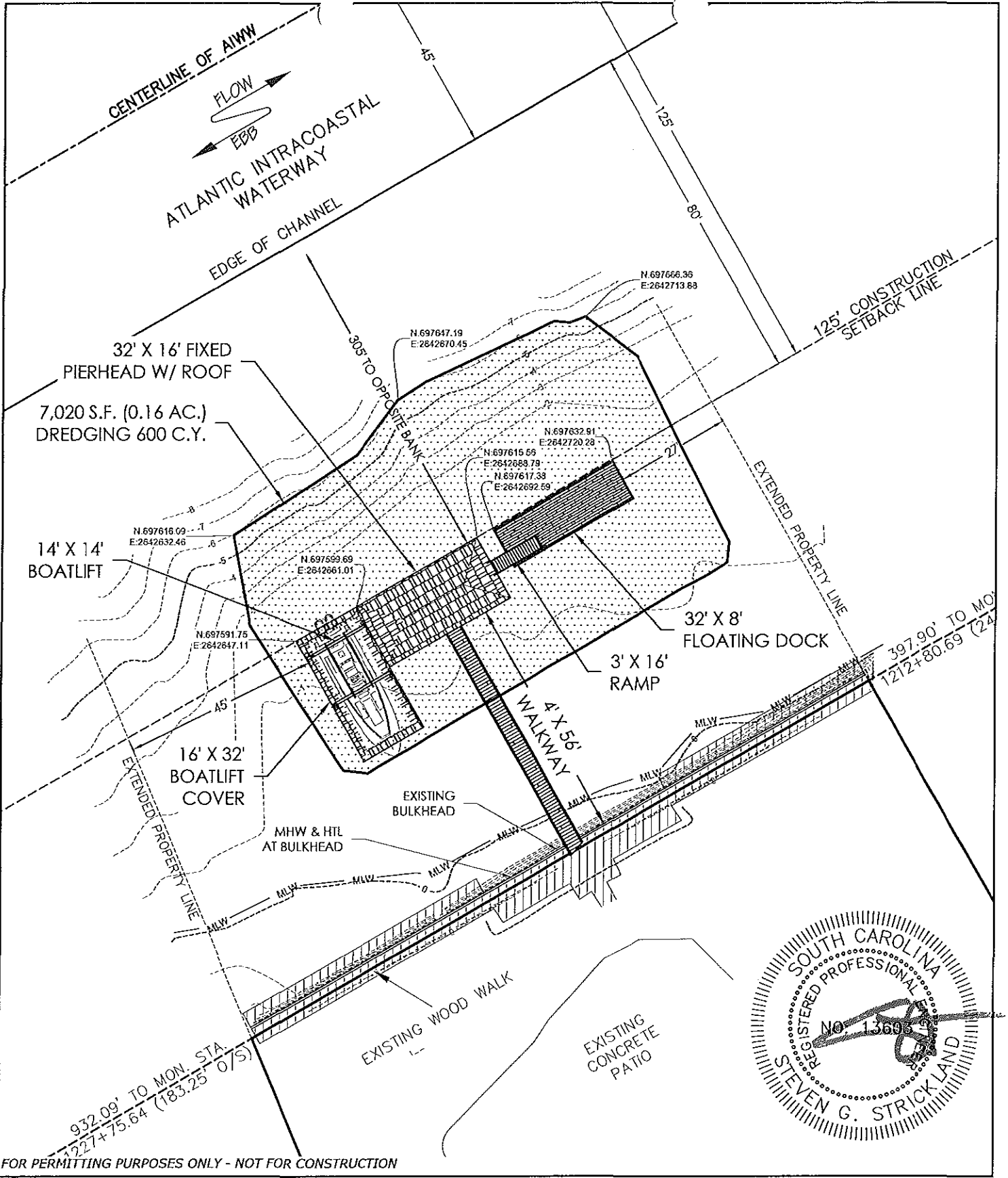

FOR PERMITTING PURPOSES ONLY - NOT FOR CONSTRUCTION

EARTHWORKS
planning and design consultants
 11655 HIGHWAY 707
 MURRELLS INLET, SC 29576
 phone - 843.651.7900
 fax - 843.651.7903
 earthworksgroup.com

PROPOSED DOCKAGE & DREDGING AREA
 LOT 10 BLOCK D, PLANTATION POINT
 DOCK PERMIT

0 15 30 SCALE 1" = 30'

APPLICANT: FOUNDERS DEVELOPMENT, LLC
 2000 WORLD TOUR BLVD
 MYRTLE BEACH, SC 29579

LOCATION: 3860 HOBCAW DRIVE, MYRTLE BEACH
 HORRY COUNTY, SOUTH CAROLINA
 LAT/LONG: 33.732233, -78.885432
 USGS QUAD: MYRTLE BEACH

DATE: 12/1/16

REGISTERED PROFESSIONAL ENGINEER
 STEVEN G. STRICKLAND
 No. 13693

SHEET 3

TEG PN: 151104.001

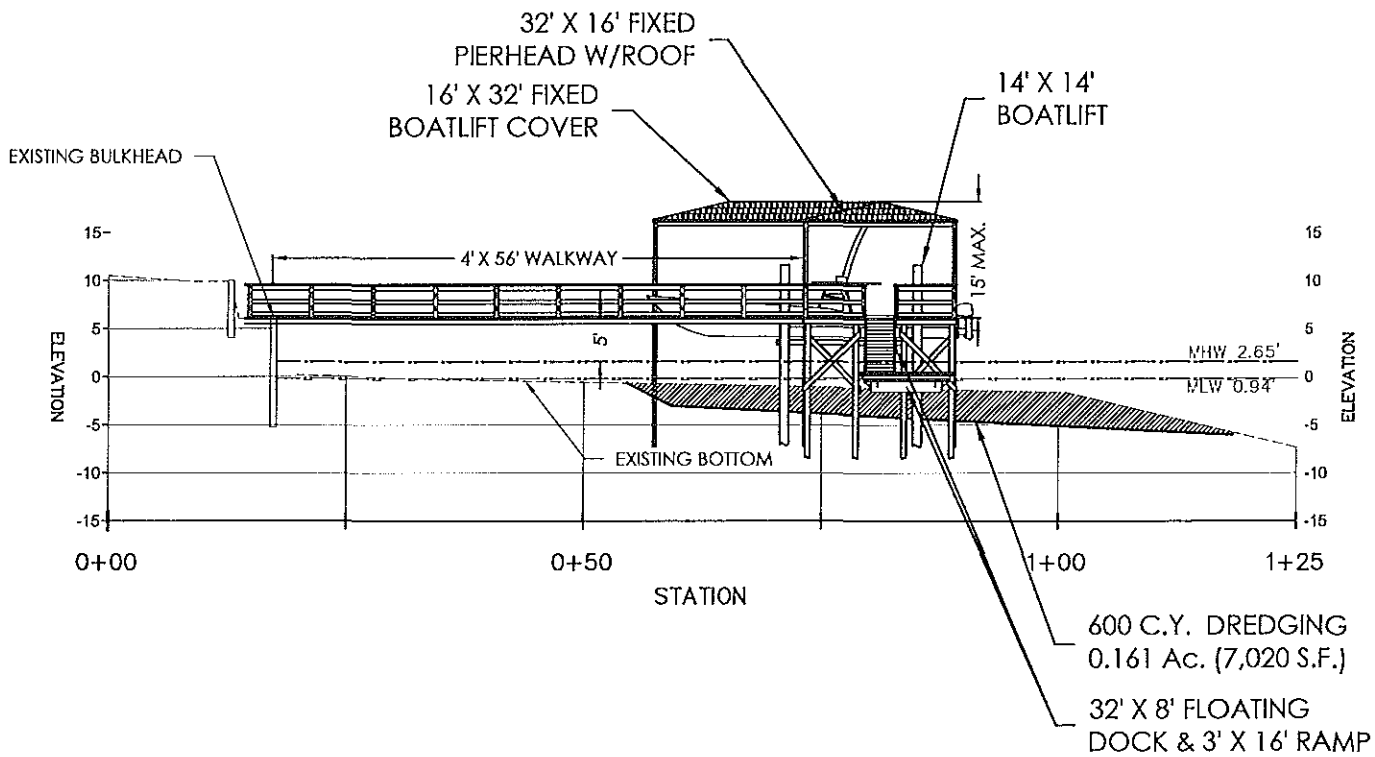

FOR PERMITTING PURPOSES ONLY - NOT FOR CONSTRUCTION

EARTHWORKS
planning and design consultants
 11655 HIGHWAY 707
 MURRELLS INLET, SC 29576
 phone - 843.651.7900
 fax - 843.651.7903
 earthworksgroup.com

PROPOSED - PROFILE VIEW
 LOT 10 BLOCK D, PLANTATION POINT
 DOCK PERMIT

SCALE
 1" = 20'

APPLICANT: FOUNDERS DEVELOPMENT, LLC
 2000 WORLD TOUR BLVD
 MYRTLE BEACH, SC 29579

LOCATION: 3860 HOBCAW DRIVE, MYRTLE BEACH
 Horry County, SOUTH CAROLINA
 LAT/LONG: 33.732233, -78.885432
 USGS QUAD: MYRTLE BEACH

DATE: 12/1/16

TEG PN: 151104.001

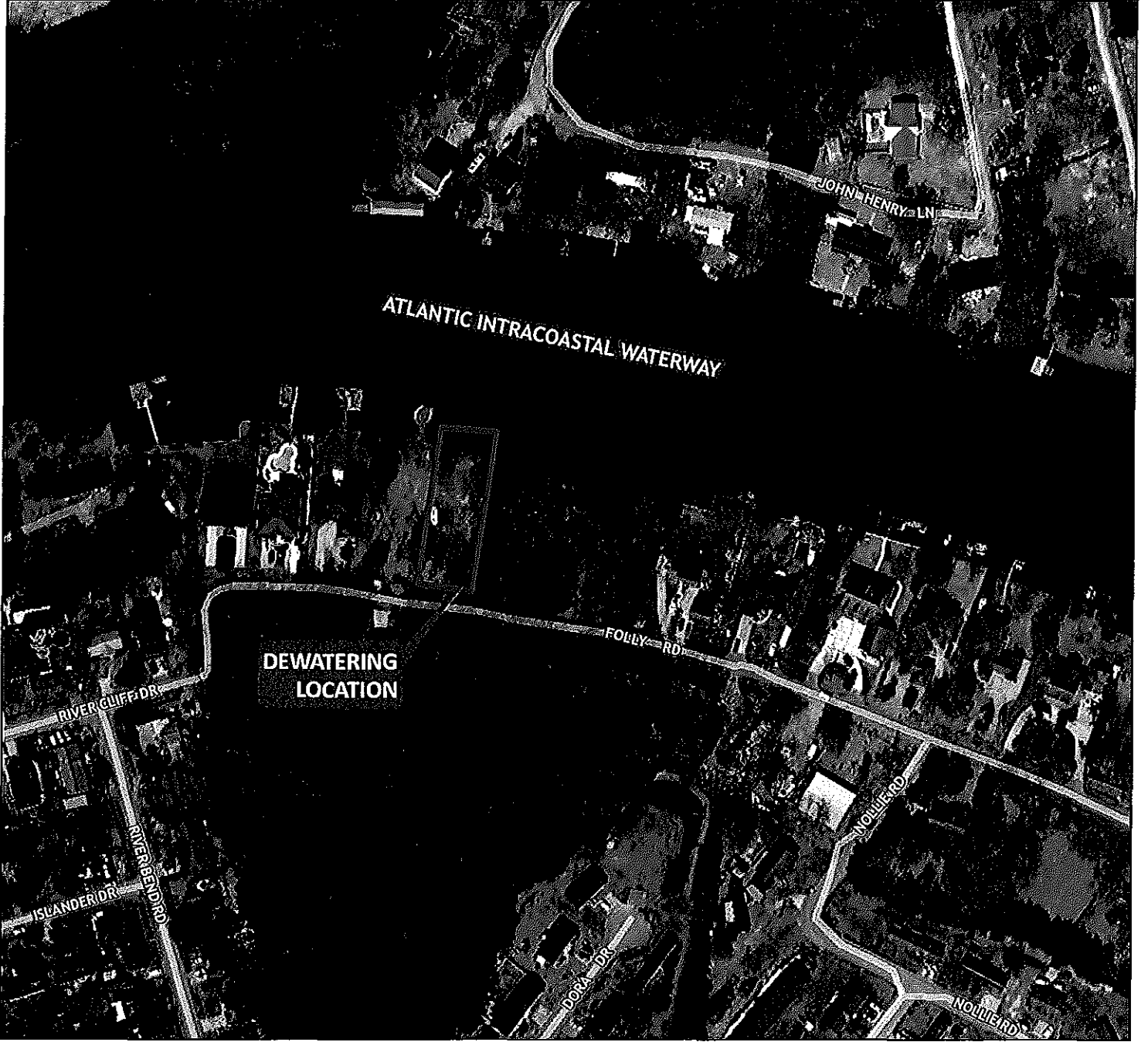
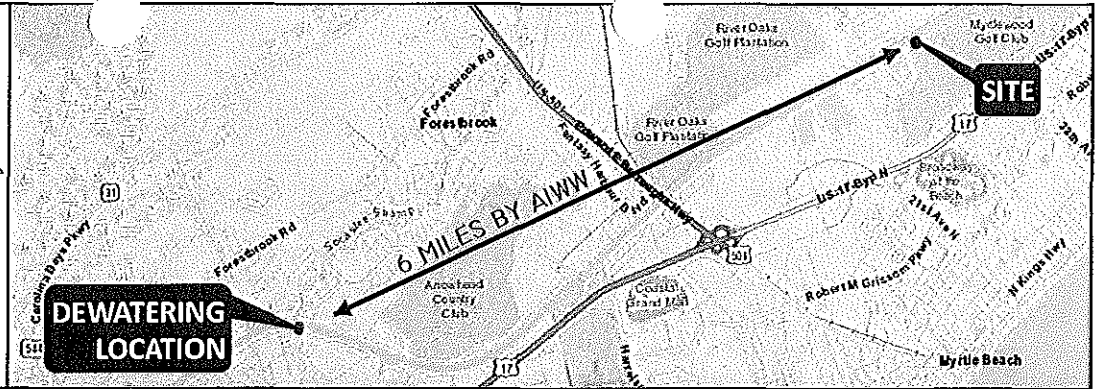

SHEET
4



EARTHWORKS
planning and design consultants

11655 HIGHWAY 707
 MURRELLS INLET, SC 29576
 phone - 843-651-7900
 fax - 843-651-7903
 www.earthworksgroup.com

SPOIL DEWATERING SITE
HORRY CO. TMS: 179-00-04-183
 LOT 10 BLOCK D, PLANTATION POINT
 DOCK PERMIT

SCALE
 1:2,400
 1" = 200'

APPLICANT: FOUNDERS DEVELOPMENT, LLC
 2000 WORLD TOUR BLVD
 MYRTLE BEACH, SC 29579
 TMS: 173-06-01-005 | PIN: 41912030053

LOCATION: 3860 HOBCAW DRIVE, MYRTLE BEACH
 HORRY COUNTY, SOUTH CAROLINA

LAT/LONG: 33.732233 by -78.885432
 USGS QUAD: MYRTLE BEACH

DATE: 11/7/2016

SHEET
5

**SPOIL DEWATERING BASIN
SECTION VIEW**

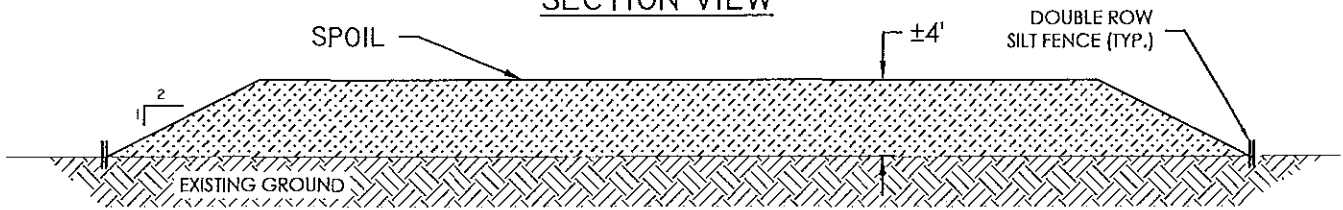

ATLANTIC INTRACOASTAL WATERWAY

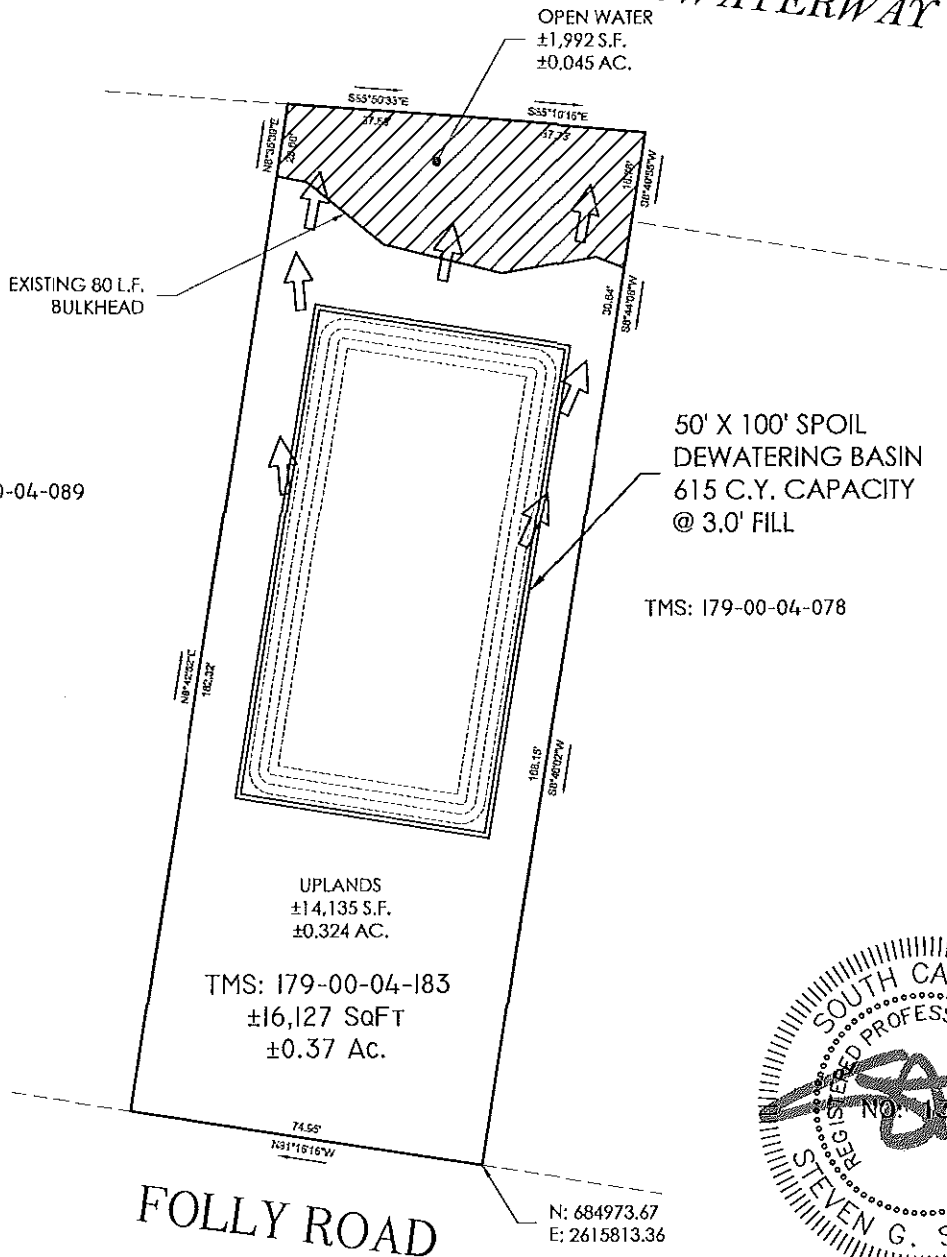

TMS: 179-00-04-089

50' X 100' SPOIL
DEWATERING BASIN
615 C.Y. CAPACITY
@ 3.0' FILL

TMS: 179-00-04-078

UPLANDS
±14,135 S.F.
±0.324 AC.

TMS: 179-00-04-183
±16,127 SqFT
±0.37 AC.

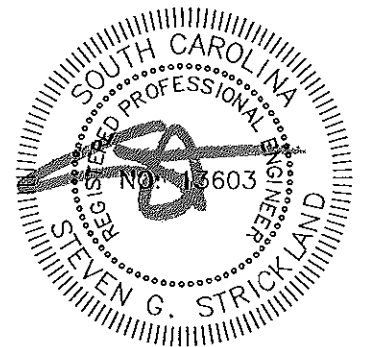

FOR PERMITTING PURPOSES ONLY - NOT FOR CONSTRUCTION

EARTHWORKS
planning and design consultants
11655 HIGHWAY 707
MURRELLS INLET, SC 29576
phone - 843.651.7900
fax - 843.651.7903
earthworksgroup.com

PROPOSED - PROFILE VIEW
LOT 10 BLOCK D, PLANTATION POINT
DOCK PERMIT
0 20 40 SCALE 1" = 40'
N
E

APPLICANT: FOUNDERS DEVELOPMENT, LLC
2000 WORLD TOUR BLVD
MYRTLE BEACH, SC 29579

LOCATION: 3860 HOBCAW DRIVE, MYRTLE BEACH
HORRY COUNTY, SOUTH CAROLINA
LAT/LONG: 33.732233, -78.885432
USGS QUAD: MYRTLE BEACH
DATE: 12/1/16
TEG PN: 151104.001