

**JOINT**  
**PUBLIC NOTICE**

**CHARLESTON DISTRICT, CORPS OF ENGINEERS**  
69A Hagood Avenue  
Charleston, SC 29403-5107  
and  
**THE S.C. DEPARTMENT OF HEALTH AND ENVIRONMENTAL CONTROL**  
Office of Ocean and Coastal Resource Management  
1362 McMillan Avenue, Suite 400  
Charleston, South Carolina 29405

REGULATORY DIVISION  
Refer to: P/N SAC-2016-00429

March 25, 2016

Pursuant to Section 10 of the Rivers and Harbors Act of 1899 (33 U.S.C. 403), Sections 401 and 404 of the Clean Water Act (33 U.S.C. 1344), and the South Carolina Coastal Zone Management Act (48-39-10 et.seq.), an application has been submitted to the Department of the Army and the S.C. Department of Health and Environmental Control by

**BEAUFORT JASPER HIGHER EDUCATION COMMISSION**  
C/O: JEFFREY WILLIAMS  
**SLIGH ENVIRONMENTAL CONSULTANTS, INC.**  
31 PARK OF COMMERCE WAY, SUITE 200B  
SAVANNAH, GEORGIA 31405

for a permit to expand the University of South Carolina- Bluffton campus in wetlands adjacent to the

**GREAT SWAMP/ NEW RIVER**

at the University of South Carolina- Bluffton Campus, south of and adjacent to US Highway 278, in Beaufort County, South Carolina (Latitude: 32.2998 °N, Longitude: -80.9772 °W), Jasper Quad Sheet .

In order to give all interested parties an opportunity to express their views

**NOTICE**

is hereby given that written statements regarding the proposed work will be received by the **Corps** until

**15 Days from the Date of this Notice,**

and **SCDHEC** will receive written statements regarding the proposed work until

**30 Days from the Date of this Notice**

from those interested in the activity and whose interests may be affected by the proposed work.

The proposed work consists of expanding the existing campus to include additional student housing, parking, roads, and athletic facilities. In detail, the applicant proposes to impact 1.62

acres of wetlands located within the BJHEC property. Of these wetlands impacts, 0.96 acres are jurisdictional, while the other 0.65 acres are non-jurisdictional, isolated wetlands. Wetland Fill #1 (0.21 acres) will allow for the construction of additional student housing. Wetland Fill #2 (0.28 acres) is necessary for a perimeter road that will be utilized for emergency access, campus connectivity, as well as additional parking associated with the proposed student housing. Wetland Fill #3 (0.15 acres) is for the construction of a proposed pump station. Wetland Fills #4 (0.12 acres) and #6 (0.20 acres) are for the proposed athletic fields, a perimeter road, and parking. Wetland Fills #5 (0.31 acres), Fill #7 (0.29 acres) and Fill #8 (0.06 acres) are all in isolated, non-jurisdictional wetlands. Specifically, Fill #5 will be required to construct the proposed softball field and soccer field, Fill #7 is required for the proposed campus entrance road improvements, and Fill #8 is proposed for the campus perimeter road.

The applicant has proposed to mitigate for impacts to wetlands and/or waters of the United States by purchasing 14.6 wetland mitigation credits from the Sweetleaf Wetland Mitigation Bank. The applicant has avoided and minimized impacts to wetlands to the maximum extent practicable. All development activities will be performed using best management practices (silt fencing, grass slopes, etc.). All BMPs will be inspected regularly, and maintained as necessary until final stabilization is established. Additional avoidance and minimization measures include minimal side slopes of the fill areas where the upland elevation will be increased adjacent to the remaining jurisdictional wetlands on-site. Furthermore, all discharge material will be clean material obtained from an upland source.

The project purpose is to provide additional amenities for enrolled and future students of the University of South Carolina Bluffton Campus.

**NOTE: This public notice and associated plans are available on the Corps' website at: <http://www.sac.usace.army.mil/Missions/Regulatory/PublicNotices> . For those unable to access the website, a copy of this notice and the associated plans will be provided, upon receipt of a written request. The request must identify the project of interest by public notice number and a self-addressed stamped envelope must also be provided. Your request should be addressed to the**

**U.S. Army Corps of Engineers  
ATTN: REGULATORY DIVISION  
69A Hagood Avenue  
Charleston, SC 29403-5107**

The District Engineer has concluded that the discharges associated with this project, both direct and indirect, should be reviewed by the South Carolina Department of Health and Environmental Control in accordance with provisions of Section 401 of the Clean Water Act. As such, this notice constitutes a request, on behalf of the applicant, for certification that this project will comply with applicable effluent limitations and water quality standards. The work shown on this application must also be certified as consistent with applicable provisions of the Coastal Zone Management Program (15 CFR 930). This activity may also require evaluation for compliance with the S. C. Construction in Navigable Waters Permit Program. State review, permitting and certification is conducted by the S. C. Department of Health and Environmental Control. The District Engineer will not process this application to a conclusion until such certifications are received. The applicant is hereby advised that supplemental information may be required by the State to facilitate the review.

This notice initiates the Essential Fish Habitat (EFH) consultation requirements of the

Magnuson-Stevens Fishery Conservation and Management Act. Implementation of the proposed project would impact 0.96 acres of freshwater jurisdictional wetlands and 0.65 acres of non-jurisdictional, isolated wetlands utilized by various life stages of species comprising the shrimp, and snapper-grouper management complexes. The District Engineer's initial determination is that the proposed action would not have a substantial individual or cumulative adverse impact on EFH or fisheries managed by the South Atlantic Fishery Management Council and the National Marine Fisheries Service (NMFS). The District Engineer's final determination relative to project impacts and the need for mitigation measures is subject to review by and coordination with the NMFS.

Pursuant to the Section 7 of the Endangered Species Act of 1973 (as amended), the Corps has reviewed the project area, examined all information provided by the applicant, and the District Engineer has determined, based on the most recently available information that the project will have no effect on any Federally endangered, threatened, or proposed species and will not result in the destruction or adverse modification of designated or proposed critical habitat. This public notice serves as a request to the U.S. Fish and Wildlife Service and the National Marine Fisheries Service for any additional information they may have on whether any listed or proposed endangered or threatened species or designated or proposed critical habitat may be present in the area which would be affected by the activity.

Pursuant to Section 106 of the National Historic Preservation Act (NHPA), this public notice also constitutes a request to Indian Tribes to notify the District Engineer of any historic properties of religious and cultural significance to them that may be affected by the proposed undertaking.

In accordance with Section 106 of the NHPA, the District Engineer has consulted South Carolina ArchSite (GIS), for the presence or absence of historic properties (as defined in 36 C.F.R. 800.16)(f)(1)), and has initially determined that no historic properties are present; therefore, there will be no effect on historic properties. To ensure that other historic properties that the District Engineer is not aware of are not overlooked, this public notice also serves as a request to the State Historic Preservation Office and any other interested parties to provide any information they may have with regard to historic properties. This public notice serves as a request for concurrence within 30 days from the SHPO (and/or Tribal Historic Preservation Officer).

The District Engineer's final eligibility and effect determination will be based upon coordination with the SHPO and/or THPO, as appropriate and required and with full consideration given to the proposed undertaking's potential direct and indirect effects on historic properties within the Corps-identified permit area.

Any person may request, in writing, within the comment period specified in this notice, that a public hearing be held to consider this application. Requests for a public hearing shall state, with particularity, the reasons for holding a public hearing.

The decision whether to issue a permit will be based on an evaluation of the probable impact including cumulative impacts of the activity on the public interest and will include application of the guidelines promulgated by the Administrator, Environmental Protection Agency (EPA), under authority of Section 404(b) of the Clean Water Act. That decision will reflect the national concern for both protection and utilization of important resources. The benefit which reasonably may be expected to accrue from the project must be balanced against its reasonably foreseeable

detriments. All factors which may be relevant to the project will be considered including the cumulative effects thereof; among those are conservation, economics, aesthetics, general environmental concerns, wetlands, historic properties, fish and wildlife values, flood hazards, flood plain values, land use, navigation, shoreline erosion and accretion, recreation, water supply and conservation, water quality, energy needs, safety, food and fiber production and, in general, the needs and welfare of the people. A permit will be granted unless the District Engineer determines that it would be contrary to the public interest. In cases of conflicting property rights, the Corps cannot undertake to adjudicate rival claims.

The Corps is soliciting comments from the public; Federal, state, and local agencies and officials; Indian Tribes; and other interested parties in order to consider and evaluate the impacts of this activity. Any comments received will be considered by the Corps to determine whether to issue, modify, condition or deny a permit for this project. To make this decision, comments are used to assess impacts on endangered species, historic properties, water quality, general environmental effects, and the other public interest factors listed above. Comments are used in the preparation of an Environmental Assessment and/or an Environmental Impact Statement pursuant to the National Environmental Policy Act. Comments are also used to determine the need for a public hearing and to determine the overall public interest of the activity.

If there are any questions concerning this public notice, please contact Chelsea B. Bowman, Project Manager, at 843-329-8044 or toll free at 1-866-329-8187.

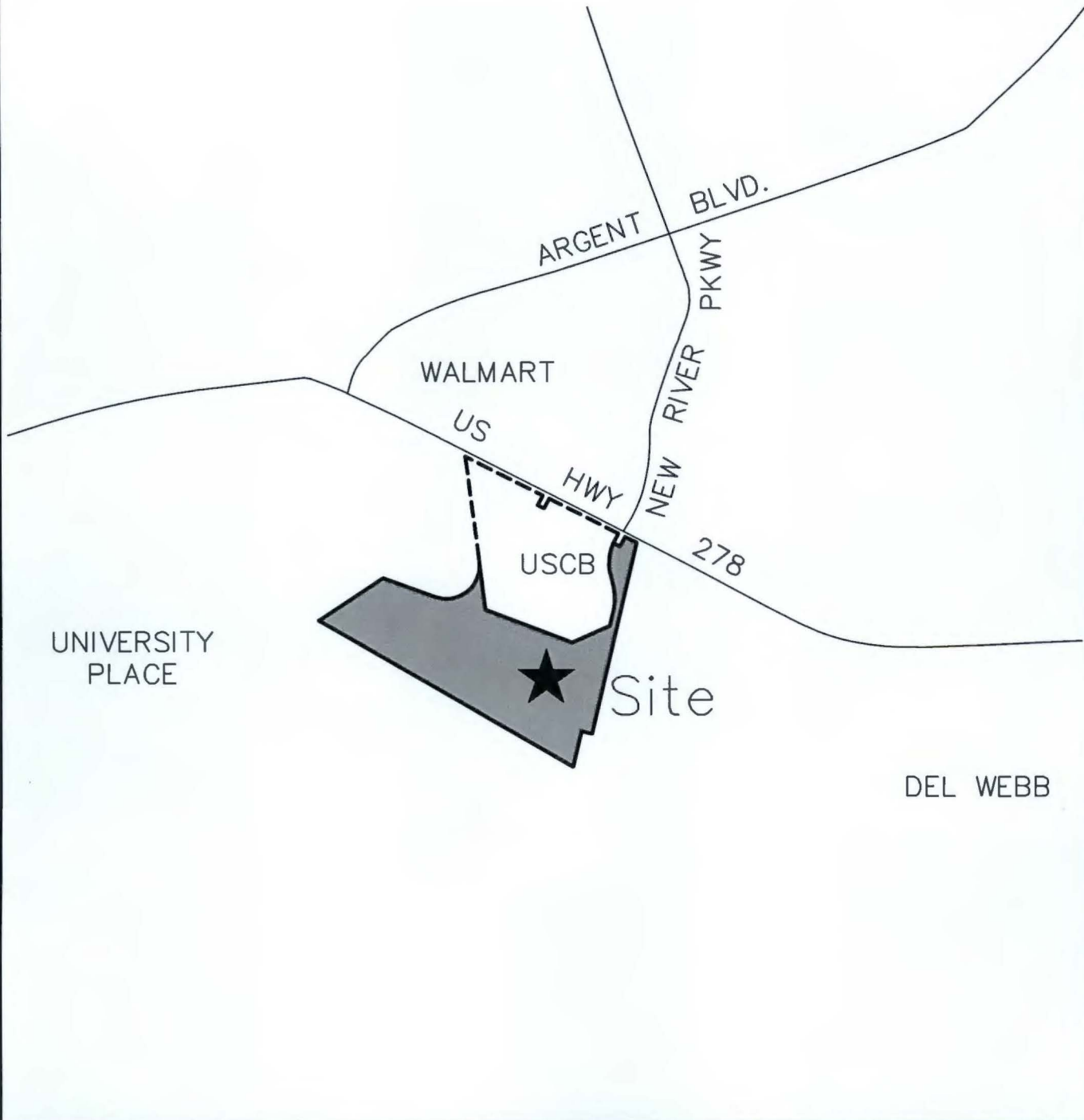
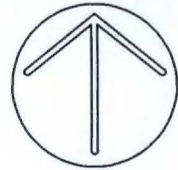

P.O. BOX 381  
BLUFFTON, SC 29910  
PH (843) 837-5250  
FAX (843) 837-2558  
WWW.WARDEDWARDS.COM

USCB CAMPUS EXPANSION

### VICINITY MAP

BEAUFORT COUNTY, SOUTH CAROLINA

DATE: 2-04-16  
SCALE: NONE  
PROJECT #130205G

SHEET 1 OF 9

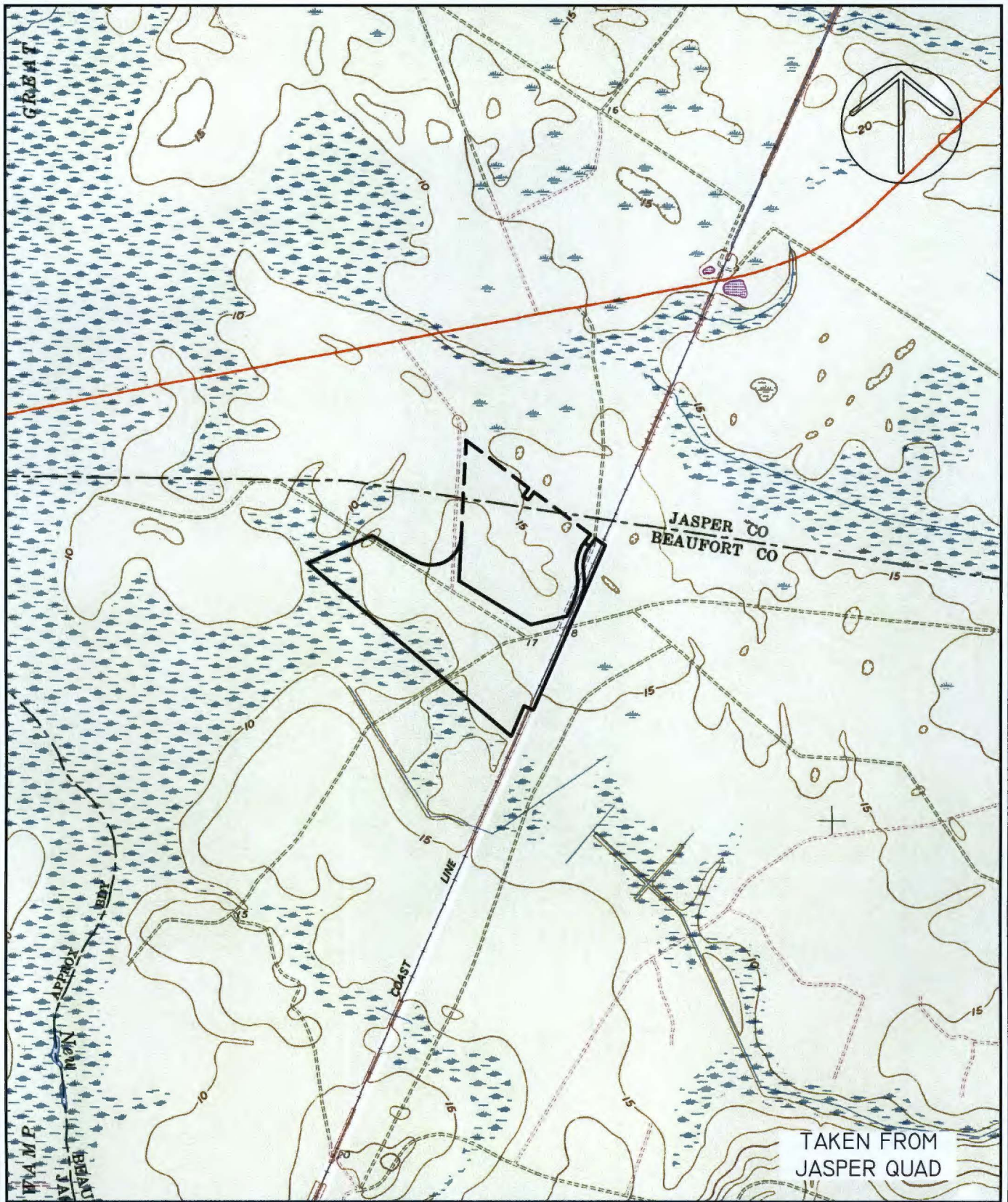

P.O. BOX 381  
BLUFFTON, SC 29910  
PH (843) 837-5250  
FAX (843) 837-2558  
WWW.WARDEDWARDS.COM

USCB CAMPUS EXPANSION

USGS MAP

BEAUFORT COUNTY, SOUTH CAROLINA

DATE: 2-04-16  
SCALE: 1"=2000'  
PROJECT #130205G

SHEET 2 OF 9

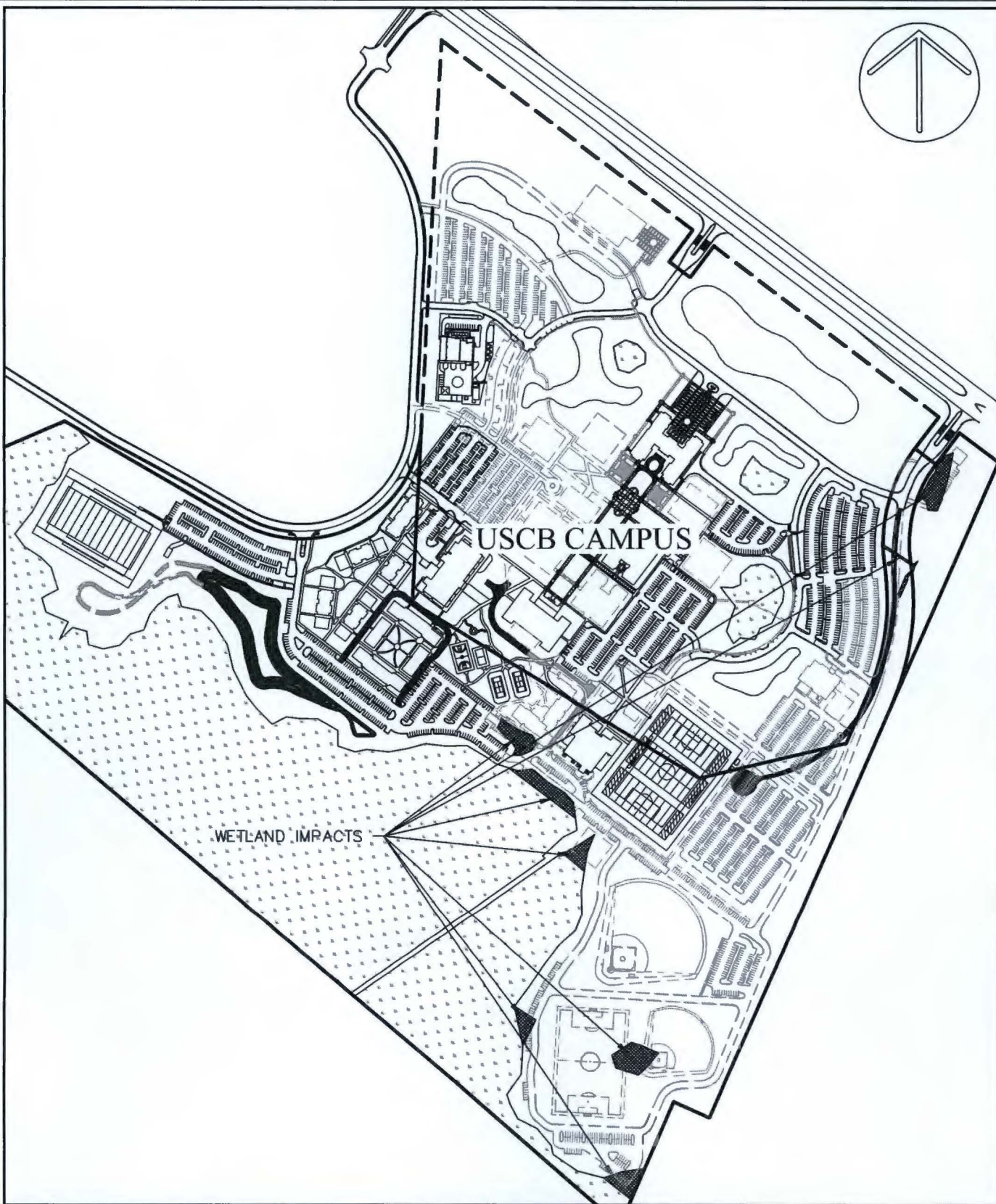
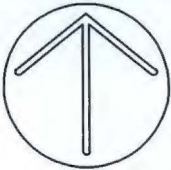

USCB CAMPUS

WETLAND IMPACTS



P.O. BOX 381  
BLUFFTON, SC 29910  
PH (843) 837-5250  
FAX (843) 837-2558  
WWW.WARDEDWARDS.COM

USCB CAMPUS EXPANSION  
**OVERALL CAMPUS**

BEAUFORT COUNTY, SOUTH CAROLINA

DATE: 2-04-16  
SCALE: 1"=500'  
PROJECT #130205G

SHEET 3 OF 9

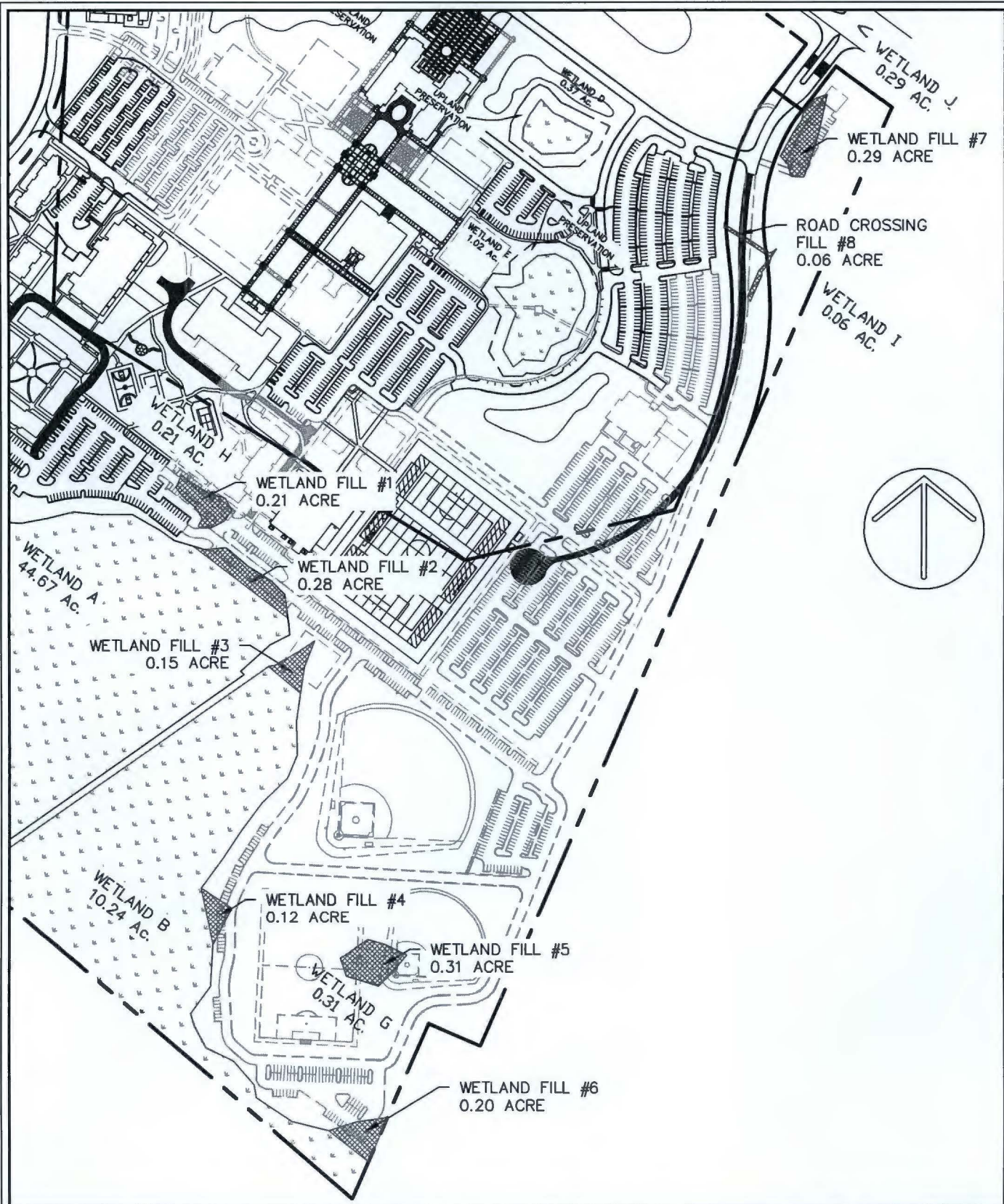

P.O. BOX 381  
 BLUFFTON, SC 29910  
 PH (843) 837-5250  
 FAX (843) 837-2558  
 WWW.WARDEDWARDS.COM

USCB CAMPUS EXPANSION  
**OVERALL SITE PLAN**

BEAUFORT COUNTY, SOUTH CAROLINA

DATE: 2-04-16  
 SCALE: 1"=350'  
 PROJECT #130205G

SHEET 4 OF 9



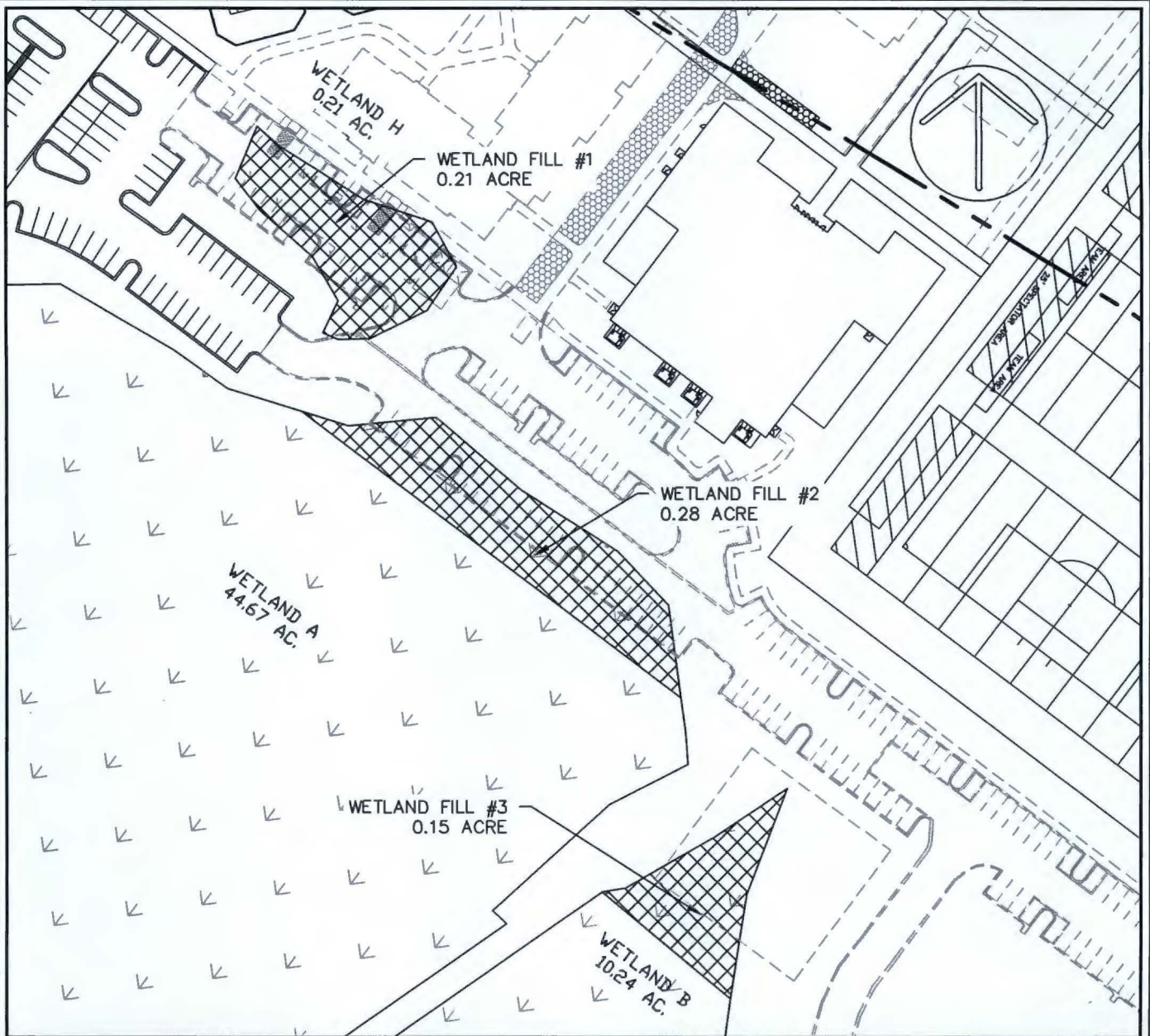

TOTAL SITE	199.28 AC	
<b>WETLANDS TO BE FILLED</b>		
FILL #1	0.21 AC	1,016 CU YD
FILL #2	0.28 AC	1,355 CU YD
FILL #3	0.15 AC	725 CU YD
FILL #4	0.12 AC	580 CU YD
FILL #5	0.31 AC	1,500 CU YD
FILL #6	0.20 AC	970 CU YD
FILL #7	0.29 AC	1,405 CU YD
ROAD CROSSING FILL #8	0.06 AC	300 CU YD
TOTAL WETLANDS TO BE FILLED	1.62 AC	7,851 CU YD
TOTAL WETLANDS UNDISTURBED	54.16 AC	
TOTAL WETLANDS	55.78 AC	
TOTAL UPLANDS	143.50 AC	



P.O. BOX 381  
 BLUFFTON, SC 29910  
 PH (843) 837-5250  
 FAX (843) 837-2558  
 WWW.WARDEDWARDS.COM

USCB CAMPUS EXPANSION  
**WETLAND IMPACTS**

BEAUFORT COUNTY, SOUTH CAROLINA

DATE: 2-04-16  
 SCALE: 1"=100'  
 PROJECT #130205G

SHEET 5 OF 9

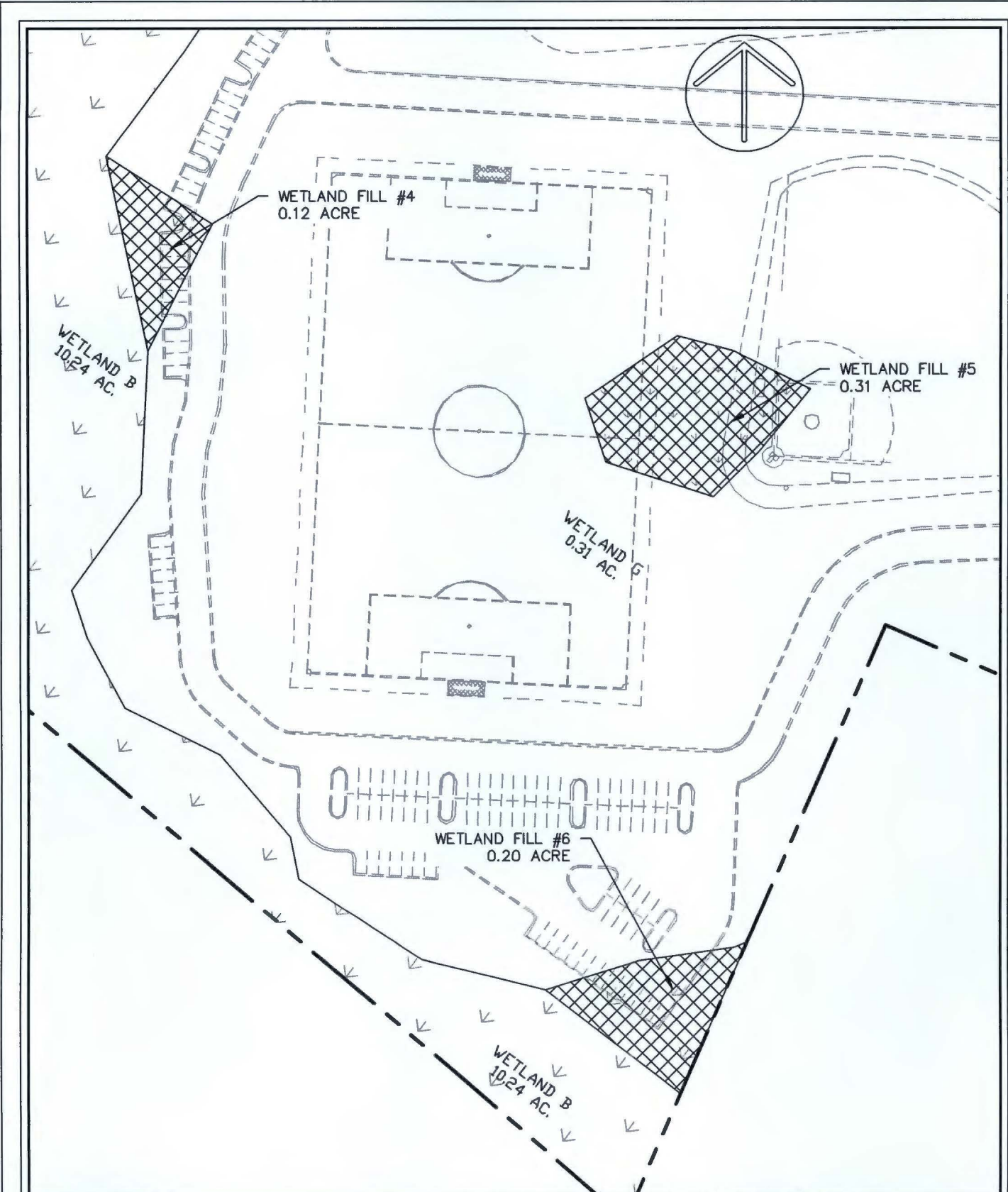

P.O. BOX 381  
 BLUFFTON, SC 29910  
 PH (843) 837-5250  
 FAX (843) 837-2558  
 WWW.WARDEDWARDS.COM

USCB CAMPUS EXPANSION  
**WETLAND IMPACTS**

BEAUFORT COUNTY, SOUTH CAROLINA

DATE: 2-04-16  
 SCALE: 1"=100'  
 PROJECT #130205G

SHEET 6 OF 9

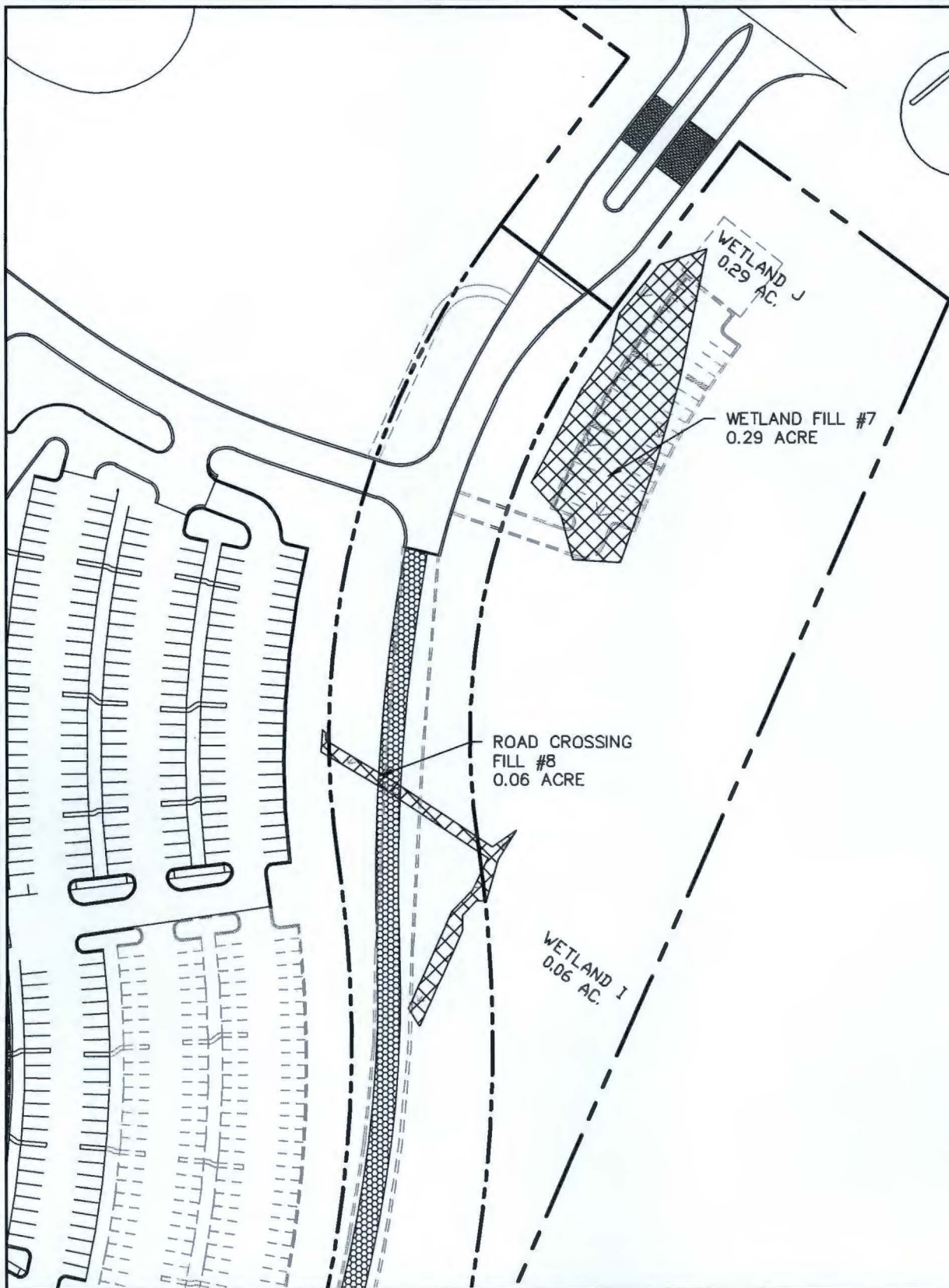
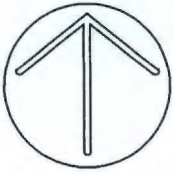

P.O. BOX 381  
BLUFFTON, SC 29910  
PH (843) 837-5250  
FAX (843) 837-2558  
WWW.WARDEDWARDS.COM

USCB CAMPUS EXPANSION  
**WETLAND IMPACTS**

BEAUFORT COUNTY, SOUTH CAROLINA

DATE: 2-04-16  
SCALE: 1"=100'  
PROJECT #130205G

SHEET 7 OF 9

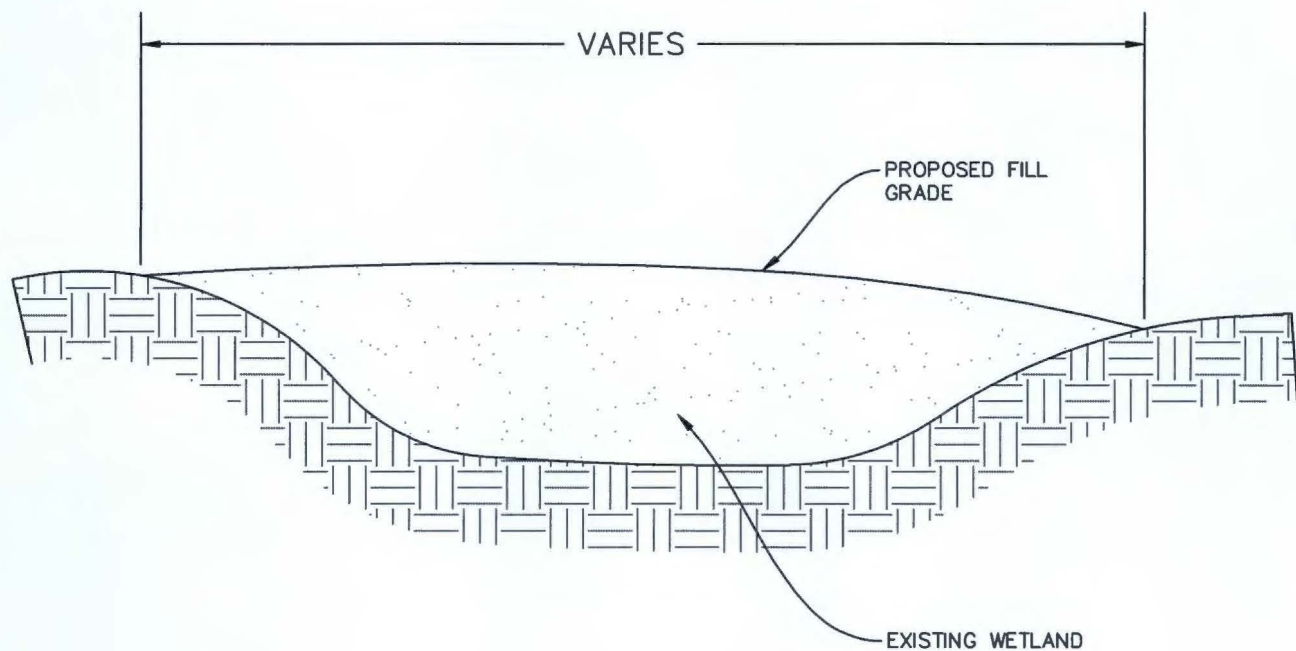

P.O. BOX 381  
 BLUFFTON, SC 29910  
 PH (843) 837-5250  
 FAX (843) 837-2558  
 WWW.WARDEDWARDS.COM

USCB CAMPUS EXPANSION  
 TYPICAL WETLAND FILL

BEAUFORT COUNTY, SOUTH CAROLINA

DATE: 2-04-16  
 SCALE: NONE  
 PROJECT #130205G

SHEET 8 OF 9

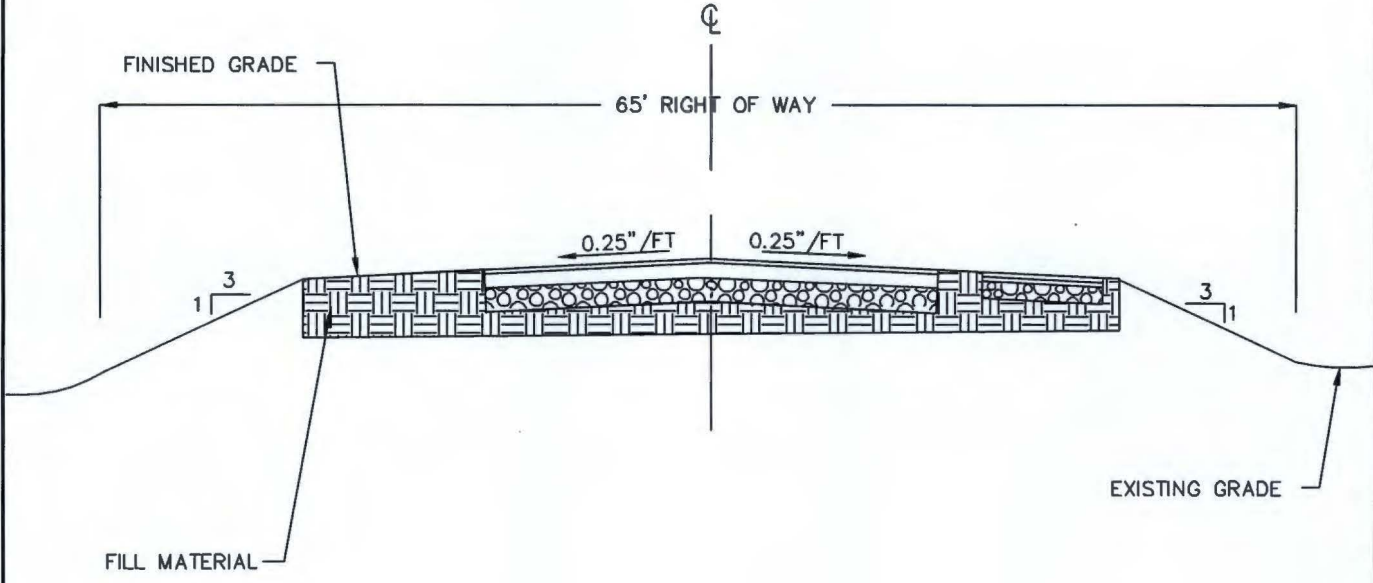

CROSS SECTION

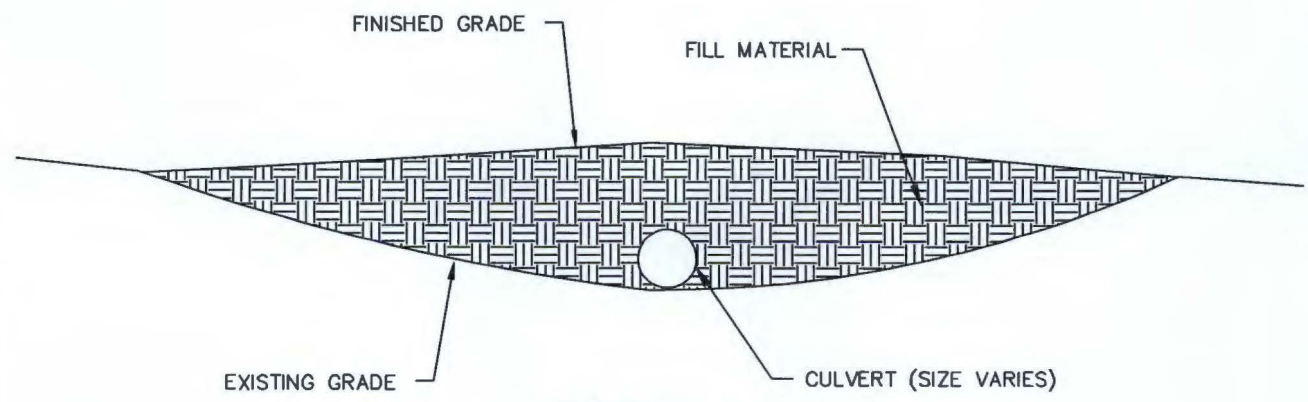

PROFILE

TYPICAL ROAD FILL IMPACT

NOT TO SCALE



P.O. BOX 381  
 BLUFFTON, SC 29910  
 PH (843) 837-5250  
 FAX (843) 837-2558  
 WWW.WARDEDWARDS.COM

USCB CAMPUS EXPANSION  
 TYPICAL ROAD CROSSING  
 BEAUFORT COUNTY, SOUTH CAROLINA

DATE: 2-04-16  
 SCALE: NONE  
 PROJECT #130205G  
 SHEET 9 OF 9