

JOINT
PUBLIC NOTICE

CHARLESTON DISTRICT, CORPS OF ENGINEERS
1949 INDUSTRIAL PARK ROAD, ROOM 140
CONWAY, SOUTH CAROLINA 29526

and

THE S.C. DEPARTMENT OF HEALTH AND ENVIRONMENTAL CONTROL
Water Quality Certification and Wetlands Section
2600 Bull Street
Columbia, South Carolina 29201

REGULATORY DIVISION

Refer to: P/N SAC-2013-01239

MARCH 9, 2018

Pursuant to Sections 401 and 404 of the Clean Water Act (33 U.S.C. 1341), an application has been submitted to the Department of the Army and the S.C. Department of Health and Environmental Control by

**MR. MARION SWINK
MCCALL FARMS
C/O MR. JOSEPH FLOYD
THE BRIGMAN COMPANY, INC.
PO BOX 1532
CONWAY, SOUTH CAROLINA 29528**

for a permit to place fill material within wetlands adjacent to an unnamed tributary of

CARTER CREEK

at a location west of US Highway 52, south of the City of Florence, Florence County, South Carolina (Latitude: 34.0582°N, Longitude: -79.7611°W), Effingham Quad.

In order to give all interested parties an opportunity to express their views

NOTICE

is hereby given that written statements regarding the proposed work will be received by the **Corps** until

15 Days from the Date of this Notice,

and **SCDHEC** will receive written statements regarding the proposed work until

30 Days from the Date of this Notice

from those interested in the activity and whose interests may be affected by the proposed work.

The proposed work consists of the placement of fill material within wetlands for the construction of an access road and expansion of existing warehousing at McCall Farms. In detail,

the work involves permanent impacts to 0.57 acre of jurisdictional wetlands for the construction of new warehouses and an access road. Previous authorizations for McCall Farms at this location consist of utilizing Nationwide Permits 18, 33, and 39 to authorize 0.514 acres of impacts to jurisdictional waters and an Individual Permit to authorize 0.035 acre of impacts to jurisdictional waters. The applicant states that complete avoidance of impacts to wetlands was not practicable due to the "location and distribution of wetlands in relation to the existing warehouse area and the site's only access". According to the applicant, "the proposed warehouse expansion impacts have been limited to the minimal amount possible to provide sufficient area to meet the expansion needs while providing required perimeter access to meet local fire codes". The applicant has proposed to mitigate for impacts to wetlands by purchasing 6.099 credits from Carter-Stilley Wetland and Stream Mitigation Bank. The project purpose is to construct an access road and warehouse expansion to accommodate increased demand for products at McCall Farms.

NOTE: This public notice and associated plans are available on the Corps' website at:
<http://www.sac.usace.army.mil/Missions/Regulatory/PublicNotices> .

The District Engineer has concluded that the discharges associated with this project, both direct and indirect, should be reviewed by the South Carolina Department of Health and Environmental Control in accordance with provisions of Section 401 of the Clean Water Act. As such, this notice constitutes a request, on behalf of the applicant, for certification that this project will comply with applicable effluent limitations and water quality standards. State review, permitting and certification is conducted by the S. C. Department of Health and Environmental Control. The District Engineer will not process this application to a conclusion until such certifications are received. The applicant is hereby advised that supplemental information may be required by the State to facilitate the review.

This notice initiates the Essential Fish Habitat (EFH) consultation requirements of the Magnuson-Stevens Fishery Conservation and Management Act. Implementation of the proposed project would impact 0.57 acres of freshwater wetlands upstream of estuarine substrates and emergent wetlands utilized by various life stages of species comprising the shrimp, and snapper-grouper management complexes. The District Engineer's initial determination is that the proposed action would not have a substantial individual or cumulative adverse impact on EFH or fisheries managed by the South Atlantic Fishery Management Council and the National Marine Fisheries Service (NMFS). The District Engineer's final determination relative to project impacts and the need for mitigation measures is subject to review by and coordination with the NMFS.

Pursuant to the Section 7 of the Endangered Species Act of 1973 (as amended), the Corps has reviewed the project area, examined all information provided by the applicant, and the District Engineer has determined, based on the most recently available information that the project will have no effect on any Federally endangered, threatened, or proposed species and will not result in the destruction or adverse modification of designated or proposed critical habitat. This public notice serves as a request to the U.S. Fish and Wildlife Service and the National Marine Fisheries Service for any additional information they may have on whether any listed or proposed endangered or threatened species or designated or proposed critical habitat may be present in the area which would be affected by the activity.

Pursuant to Section 106 of the National Historic Preservation Act (NHPA), this public notice also constitutes a request to Indian Tribes to notify the District Engineer of any historic

properties of religious and cultural significance to them that may be affected by the proposed undertaking.

In accordance with Section 106 of the NHPA, the District Engineer has consulted South Carolina ArchSite (GIS), for the presence or absence of historic properties (as defined in 36 C.F.R. 800.16)(f)(1)), and has initially determined that no historic properties are present; therefore, there will be no effect on historic properties. To ensure that other historic properties that the District Engineer is not aware of are not overlooked, this public notice also serves as a request to the State Historic Preservation Office and any other interested parties to provide any information they may have with regard to historic properties. This public notice serves as a request for concurrence within 30 days from the SHPO (and/or Tribal Historic Preservation Officer).

The District Engineer's final eligibility and effect determination will be based upon coordination with the SHPO and/or THPO, as appropriate and required and with full consideration given to the proposed undertaking's potential direct and indirect effects on historic properties within the Corps-identified permit area.

Any person may request, in writing, within the comment period specified in this notice, that a public hearing be held to consider this application. Requests for a public hearing shall state, with particularity, the reasons for holding a public hearing.

The decision whether to issue a permit will be based on an evaluation of the probable impact including cumulative impacts of the activity on the public interest and will include application of the guidelines promulgated by the Administrator, Environmental Protection Agency (EPA), under authority of Section 404(b) of the Clean Water Act and, as appropriate, the criteria established under authority of Section 102 of the Marine Protection, Research and Sanctuaries Act of 1972, as amended. That decision will reflect the national concern for both protection and utilization of important resources. The benefit which reasonably may be expected to accrue from the project must be balanced against its reasonably foreseeable detriments. All factors which may be relevant to the project will be considered including the cumulative effects thereof; among those are conservation, economics, aesthetics, general environmental concerns, wetlands, historic properties, fish and wildlife values, flood hazards, flood plain values, land use, navigation, shoreline erosion and accretion, recreation, water supply and conservation, water quality, energy needs, safety, food and fiber production and, in general, the needs and welfare of the people. A permit will be granted unless the District Engineer determines that it would be contrary to the public interest. In cases of conflicting property rights, the Corps cannot undertake to adjudicate rival claims.

The Corps is soliciting comments from the public; Federal, state, and local agencies and officials; Indian Tribes; and other interested parties in order to consider and evaluate the impacts of this activity. Any comments received will be considered by the Corps to determine whether to issue, modify, condition or deny a permit for this project. To make this decision, comments are used to assess impacts on endangered species, historic properties, water quality, general environmental effects, and the other public interest factors listed above. Comments are used in the preparation of an Environmental Assessment and/or an Environmental Impact Statement pursuant to the National Environmental Policy Act. Comments are also used to determine the need for a public hearing and to determine the overall public interest of the activity. **Please submit comments in writing, identifying the project of interest by public notice number, to the following address:**

REGULATORY DIVISION
SAC-2013-01239-4E

MARCH 9, 2018

**U.S. Army Corps of Engineers
ATTN: REGULATORY DIVISION
1949 INDUSTRIAL PARK ROAD, ROOM 140
CONWAY, SOUTH CAROLINA 29526**

If there are any questions concerning this public notice, please contact Ann Eaddy, Project Manager, at (843) 365-1709.



Vicinity Map

McCall Farms Expansion
 Florence County
 Date: 1-23-18
 Application No.

SAC 2013-01239
 McCall Farms Expansion Project
 Florence County, South Carolina
 Date: March 5, 2018 Sheet 1 of 6



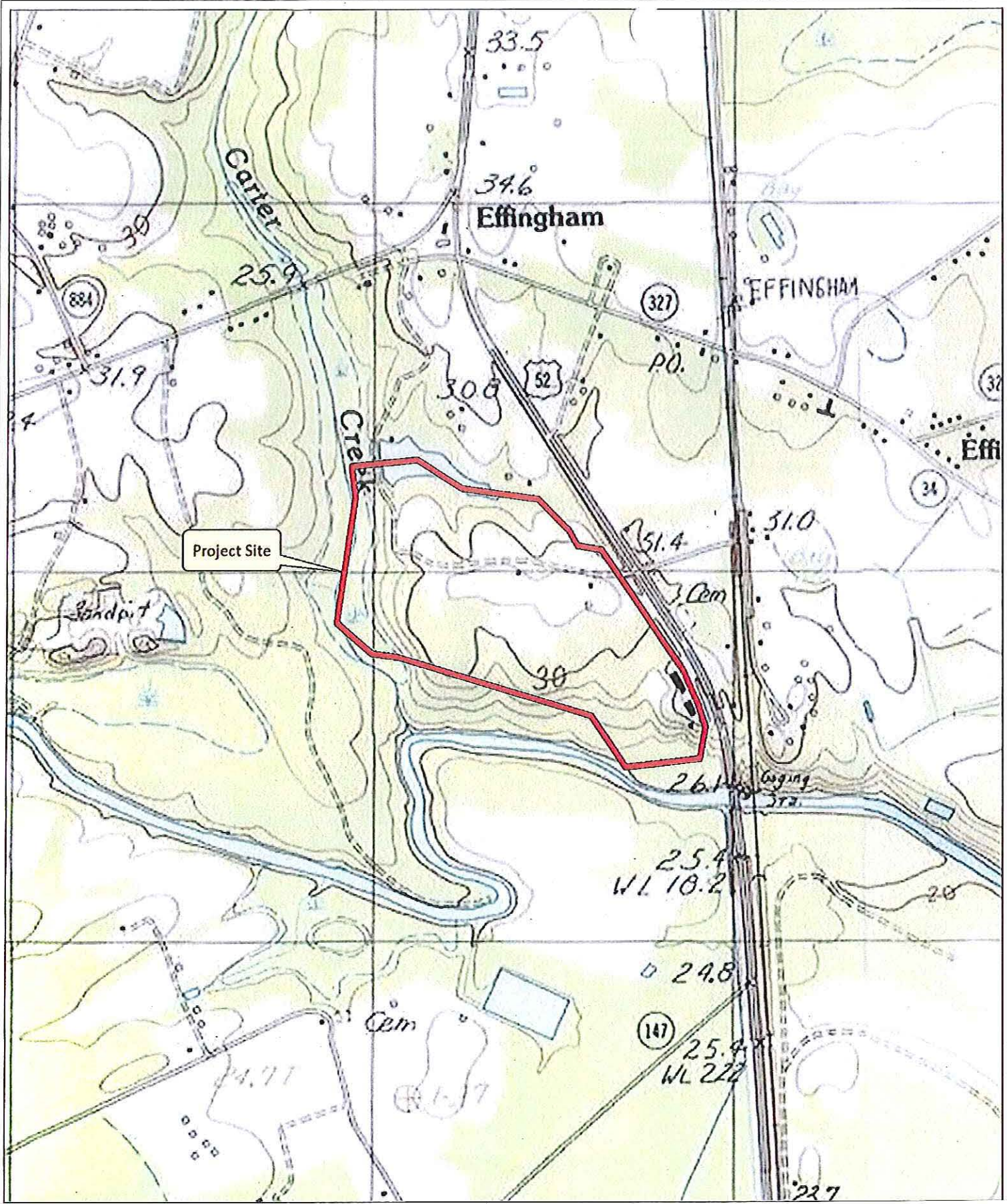

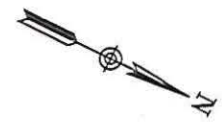

SAC 2013-01239-4E
 113.13 Ac. (total)
 17.09 Ac. (wetland)

Swamp Tract Trust
 6615 Irby Street
 Effingham, SC 29541

Swamp Tract Trust
 6615 Irby Street
 Effingham, SC 29541

McCall Farms Inc
 6615 Irby Street
 Effingham, SC 29541

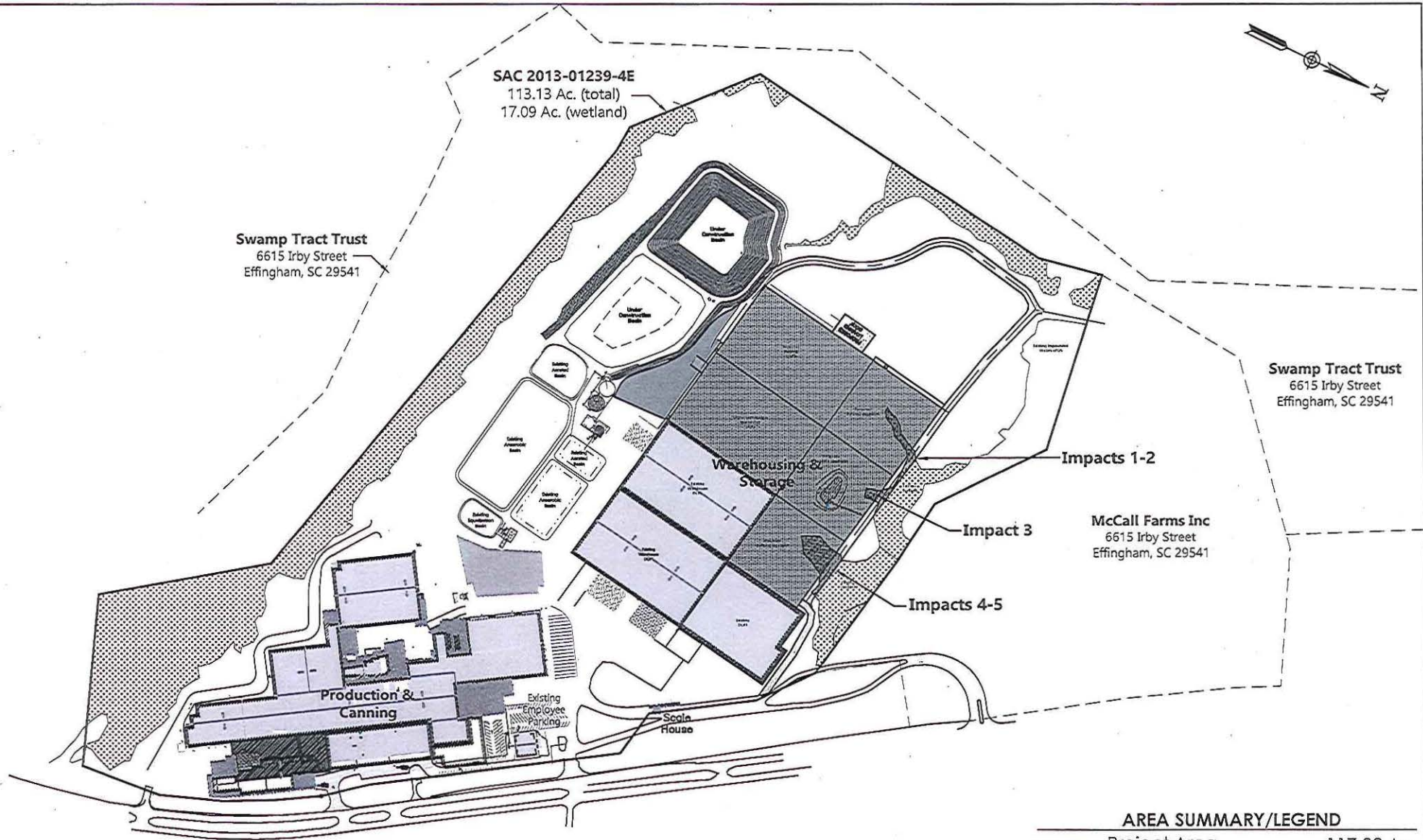

AREA SUMMARY/LEGEND

	Project Area	117.82 Ac.
	Warehouse Expansion	n/a
	Original Wetlands	15.59 Ac.
	Proposed Fill	0.57 Ac.

the
BRIGMAN
COMPANY
 wetland consulting - forest management - land surveying

SAC 2013-01239
 McCall Farms Expansion Project
 Florence County, South Carolina
 Date: March 5, 2018 Sheet 3 of 6

Proposed Activity: Wetland fill associated with road crossing and building pad
 Applicant: McCall Farms

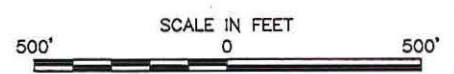

Proposed
Building Expansion

IMPACT 1

building pad (fill)
0.09 Acres 4061 sq.ft.

Proposed Fire Access-
Service Road

IMPACT 2

road crossing (fill)
0.11 Acres 4592 sq.ft.

Proposed
Building Expansion

IMPACT 3

building pad (fill)
0.04 Acres 1679 sq.ft.

30'

Existing Retention
(to be abandoned)

Existing
Wetland

AREA SUMMARY/LEGEND

	Project Area	117.82 Ac.
	Warehouse Expansion	n/a
	Original Wetlands	15.59 Ac.
	Proposed Fill	0.57 Ac.

Proposed Activity: Wetland fill associated with road crossing and building pad

Applicant: McCall Farms

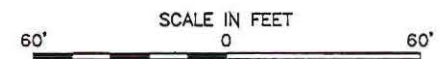

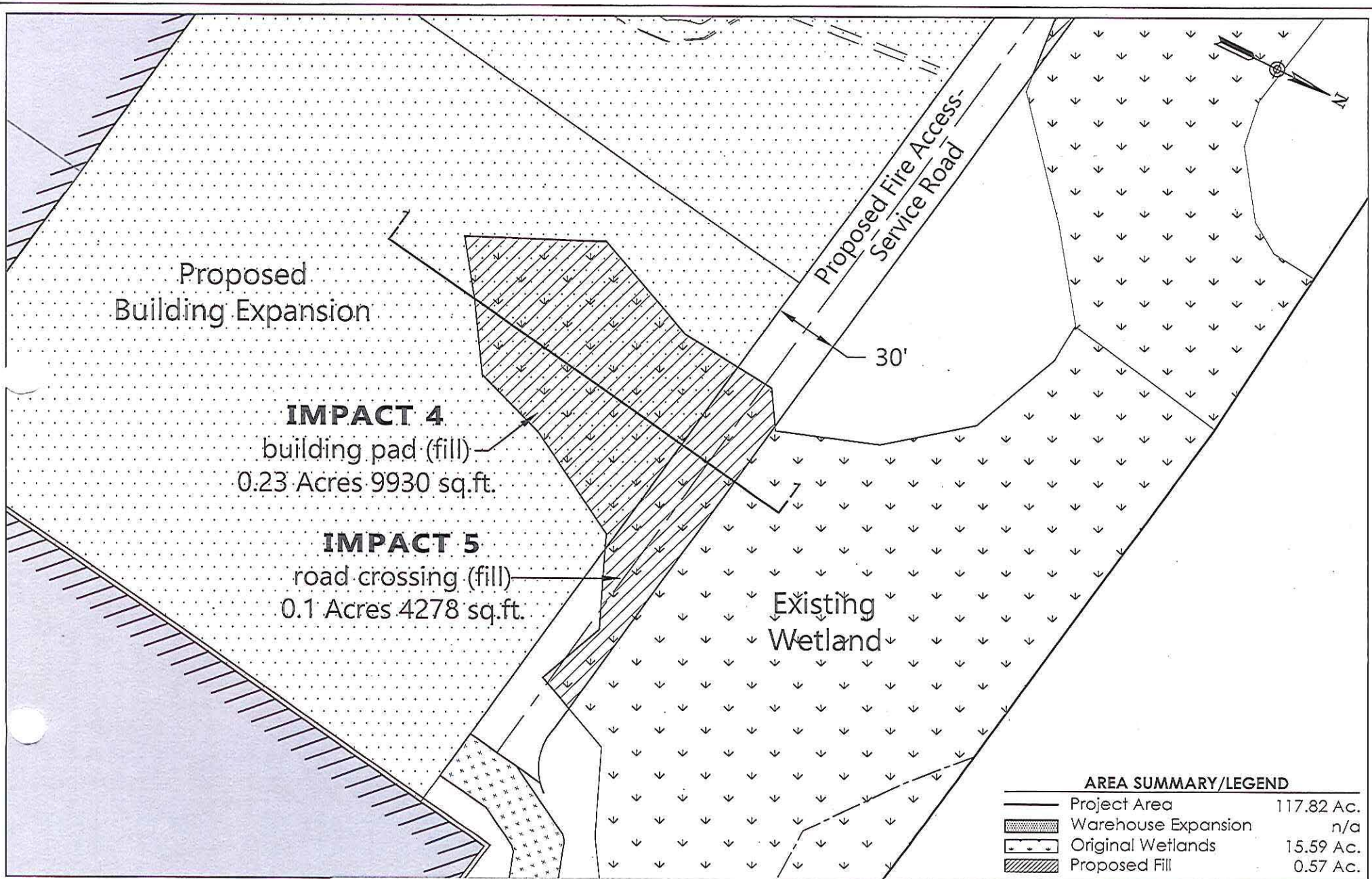

AREA SUMMARY/LEGEND

	Project Area	117.82 Ac.
	Warehouse Expansion	n/a
	Original Wetlands	15.59 Ac.
	Proposed Fill	0.57 Ac.



SAC 2013-01239
 McCall Farms Expansion Project
 Florence County, South Carolina
 Date: March 5, 2018 Sheet 5 of 6

Proposed Activity: Wetland fill associated with road crossing and building pad
 Applicant: McCall Farms
 SCALE IN FEET
 60' 0 60'

