

JOINT
PUBLIC NOTICE

CHARLESTON DISTRICT, CORPS OF ENGINEERS
1949 Industrial Park Road Room 140
Conway, South Carolina 29526
and
THE S.C. DEPARTMENT OF HEALTH AND ENVIRONMENTAL CONTROL
Water Quality Certification and Wetlands Section
2600 Bull Street
Columbia, South Carolina 29201

REGULATORY DIVISION
Refer to: P/N SAC-2020-01371

October 23, 2020

Pursuant to Section 10 of the Rivers and Harbors Act of 1899 (33 U.S.C. 403), the South Carolina Coastal Zone Management Act (48-39-10 et.seq.) and the S.C. Construction in Navigable Waters Permit Program (R. 19-450, et. seq., 1976 S.C. Code of Laws, as amended), an application has been submitted to the Department of the Army and the S.C. Department of Health and Environmental Control by

Mr. Cleve Reed
c/o Amanda Sacco
Spartina Land Surveying
802 Main Street
Conway, South Carolina 29526

for a permit to expand an existing marina in the

Atlantic Intracoastal Waterway (AIWW)

at a location described as Barefoot Marina, located at 2051 Bridge View Court, North Myrtle Beach, Horry County, South Carolina (Latitude: 33.802 °, Longitude: -78.747 °), **WAMPEE QUAD.**

In order to give all interested parties an opportunity to express their views

NOTICE

is hereby given that written statements regarding the proposed work will be received by the **Corps** until

15 Days from the Date of this Notice,

and **SCDHEC** will receive written statements regarding the proposed work until

30 Days from the Date of this Notice

from those interested in the activity and whose interests may be affected by the proposed work.

The proposed work consists of the expansion of an existing marina. In detail the proposed

work consists of constructing two (2) 1,859 square foot multi-slip floating boat docks. Each floating dock will be attached to the existing bulkhead by a 3'x 16' ramp. One dock will be located on the North side of the marina and one will be located on the South side of the marina. The applicant offered no compensatory mitigation for impacts associated with the project. It is understood that this work is to be conducted on/or adjacent to an area subject to a prism and/or disposal area held by the United States. Appropriate provisions will be included in the permit to ensure the interests of the Federal Government are understood. The project purpose as stated by the applicant is to provide additional storage for boaters along the AIWW accessing Barefoot Marina.

NOTE: This public notice and associated plans are available on the Corps' website at:
<http://www.sac.usace.army.mil/Missions/Regulatory/PublicNotices> .

The work shown on this application must also be certified as consistent with applicable provisions of the Coastal Zone Management Program (15 CFR 930). This activity may also require evaluation for compliance with the S. C. Construction in Navigable Waters Permit Program. State review, permitting and certification is conducted by the S. C. Department of Health and Environmental Control. The District Engineer will not process this application to a conclusion until such certifications are received. The applicant is hereby advised that supplemental information may be required by the State to facilitate the review.

This notice initiates the Essential Fish Habitat (EFH) consultation requirements of the Magnuson-Stevens Fishery Conservation and Management Act. Implementation of the proposed project would impact 0.02 acres of estuarine substrates and emergent wetlands utilized by various life stages of species comprising the shrimp, and snapper-grouper management complexes. The District Engineer's initial determination is that the proposed action would not have a substantial individual or cumulative adverse impact on EFH or fisheries managed by the South Atlantic Fishery Management Council and the National Marine Fisheries Service (NMFS). The District Engineer's final determination relative to project impacts and the need for mitigation measures is subject to review by and coordination with the NMFS.

Pursuant to the Section 7 of the Endangered Species Act of 1973 (as amended), the Corps has reviewed the project area, examined all information provided by the applicant, and the District Engineer has determined, based on the most recently available information, that West Indian Manatee (*Trichechus manatus*), Atlantic Sturgeon (*Acipenser oxyrinchus*), and Shortnose Sturgeon (*Acipenser brevirostrum*) are known to occur within the vicinity of the project area. However, it has been determined that the project will have no effect on Shortnose Sturgeon (*Acipenser brevirostrum*) and Atlantic Sturgeon (*Acipenser oxyrinchus*) and will not result in the destruction or adverse modification of their designated or proposed critical habitat. Additionally, the District Engineer has determined that the project is not likely to adversely affect the West Indian Manatee (*Trichechus manatus*) or result in the destruction or adverse modification of designated or proposed critical habitat. This public notice serves as a request for written concurrence from the U.S. Fish and Wildlife Service and/or the National Marine Fisheries Service on this determination.

Pursuant to Section 106 of the National Historic Preservation Act (NHPA), this public notice also constitutes a request to Indian Tribes to notify the District Engineer of any historic properties of religious and cultural significance to them that may be affected by the proposed undertaking.

In accordance with Section 106 of the NHPA, the District Engineer has consulted South Carolina ArchSite (GIS), for the presence or absence of historic properties (as defined in 36

C.F.R. 800.16)(1)), and has initially determined that no historic properties are present; therefore, there will be no effect on historic properties. To ensure that other historic properties that the District Engineer is not aware of are not overlooked, this public notice also serves as a request to the State Historic Preservation Office and any other interested parties to provide any information they may have with regard to historic properties. This public notice serves as a request for concurrence within 30 days from the SHPO (and/or Tribal Historic Preservation Officer).

The District Engineer's final eligibility and effect determination will be based upon coordination with the SHPO and/or THPO, as appropriate and required and with full consideration given to the proposed undertaking's potential direct and indirect effects on historic properties within the Corps-identified permit area.

Any person may request, in writing, within the comment period specified in this notice, that a public hearing be held to consider this application. Requests for a public hearing shall state, with particularity, the reasons for holding a public hearing.

The decision whether to issue a permit will be based on an evaluation of the probable impact including cumulative impacts of the activity on the public interest. The benefit which reasonably may be expected to accrue from the project must be balanced against its reasonably foreseeable detriments. All factors which may be relevant to the project will be considered including the cumulative effects thereof; among those are conservation, economics, aesthetics, general environmental concerns, wetlands, historic properties, fish and wildlife values, flood hazards, flood plain values, land use, navigation, shoreline erosion and accretion, recreation, water supply and conservation, water quality, energy needs, safety, food and fiber production and, in general, the needs and welfare of the people. A permit will be granted unless the District Engineer determines that it would be contrary to the public interest. In cases of conflicting property rights, the Corps cannot undertake to adjudicate rival claims.

The Corps is soliciting comments from the public; Federal, state, and local agencies and officials; Indian Tribes; and other interested parties in order to consider and evaluate the impacts of this activity. Any comments received will be considered by the Corps to determine whether to issue, modify, condition or deny a permit for this project. To make this decision, comments are used to assess impacts on endangered species, historic properties, water quality, general environmental effects, and the other public interest factors listed above. Comments are used in the preparation of an Environmental Assessment and/or an Environmental Impact Statement pursuant to the National Environmental Policy Act. Comments are also used to determine the need for a public hearing and to determine the overall public interest of the activity. **Please submit comments in writing, identifying the project of interest by public notice number, to the following e-mail address: SAC.RD.Conway@usace.army.mil, or via USPS at the address below:**

**U.S. Army Corps of Engineers
ATTN: REGULATORY DIVISION
1949 Industrial Park Road Room 140
Conway, South Carolina 29526**

If there are any questions concerning this public notice, please contact Megan N. Jackson, Project Manager, at (843) 365-4239, or by email at Megan.N.Jackson@usace.army.mil.

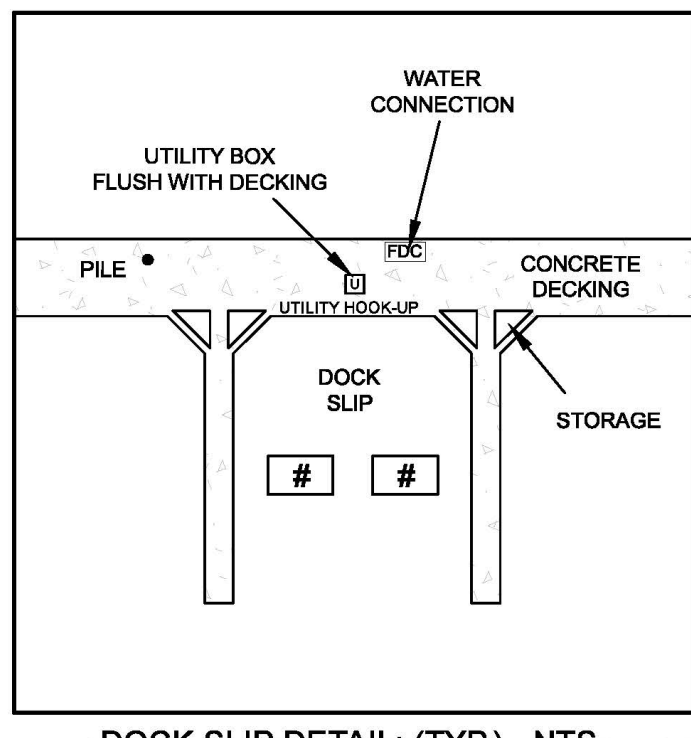
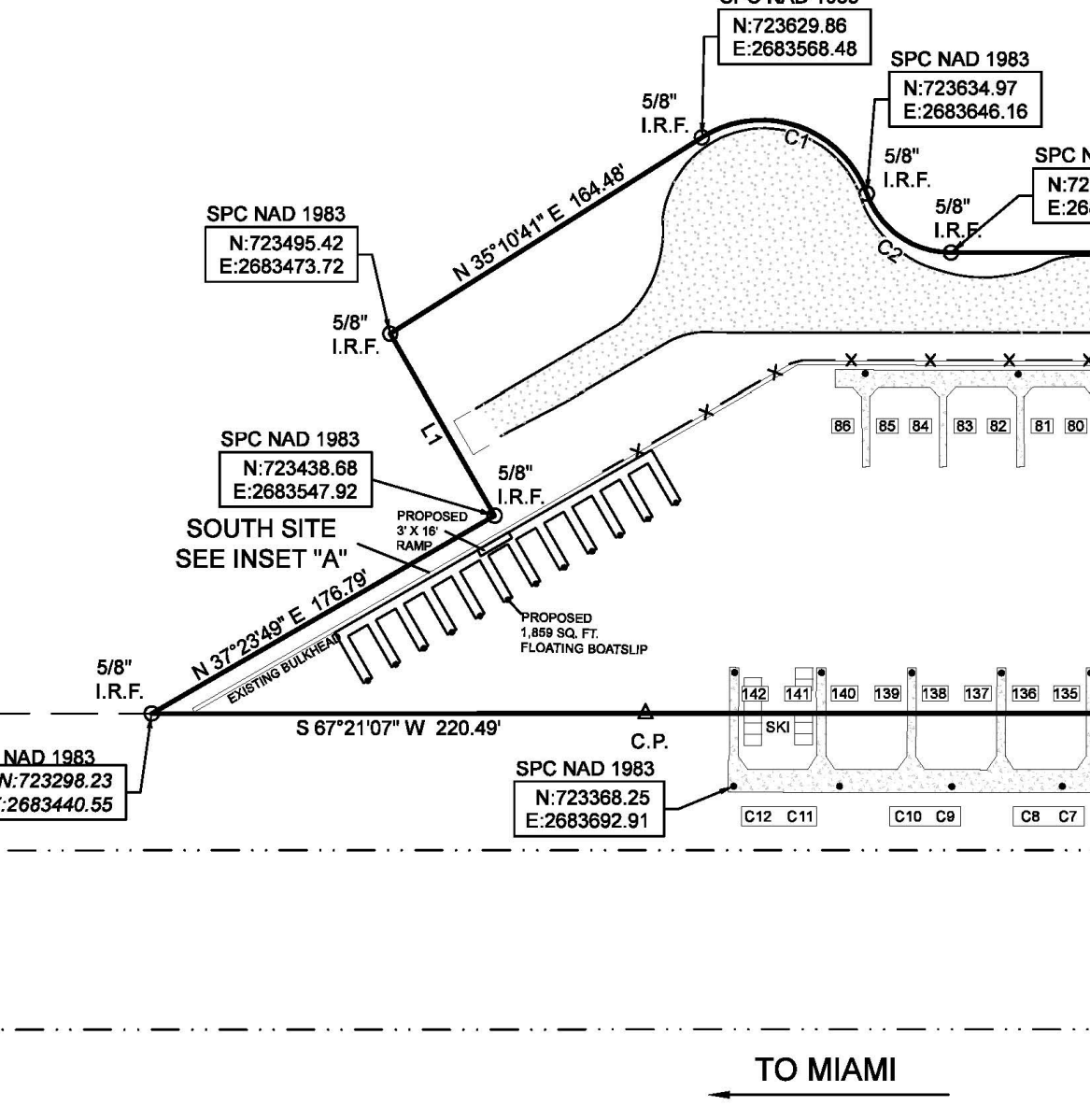
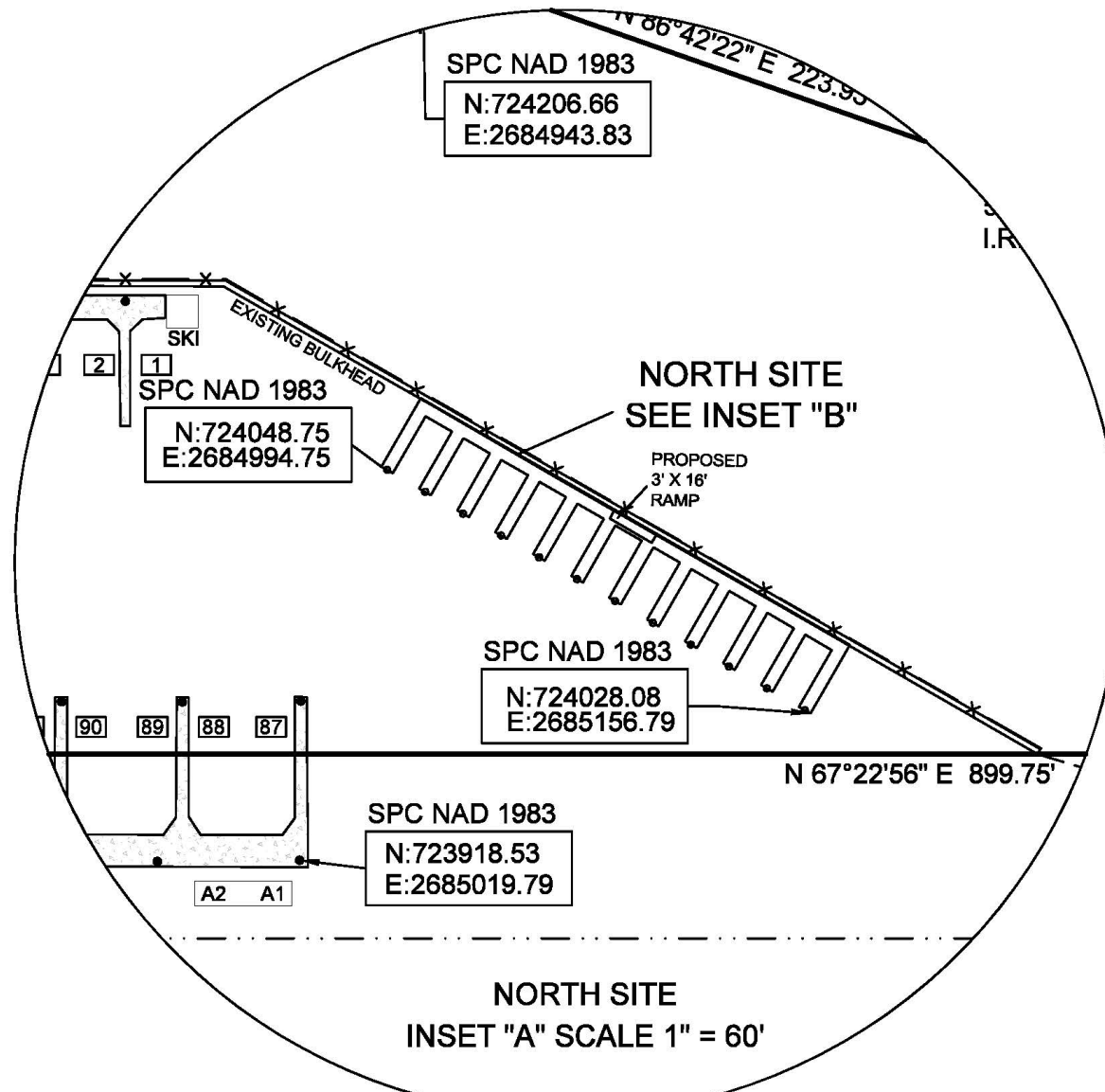
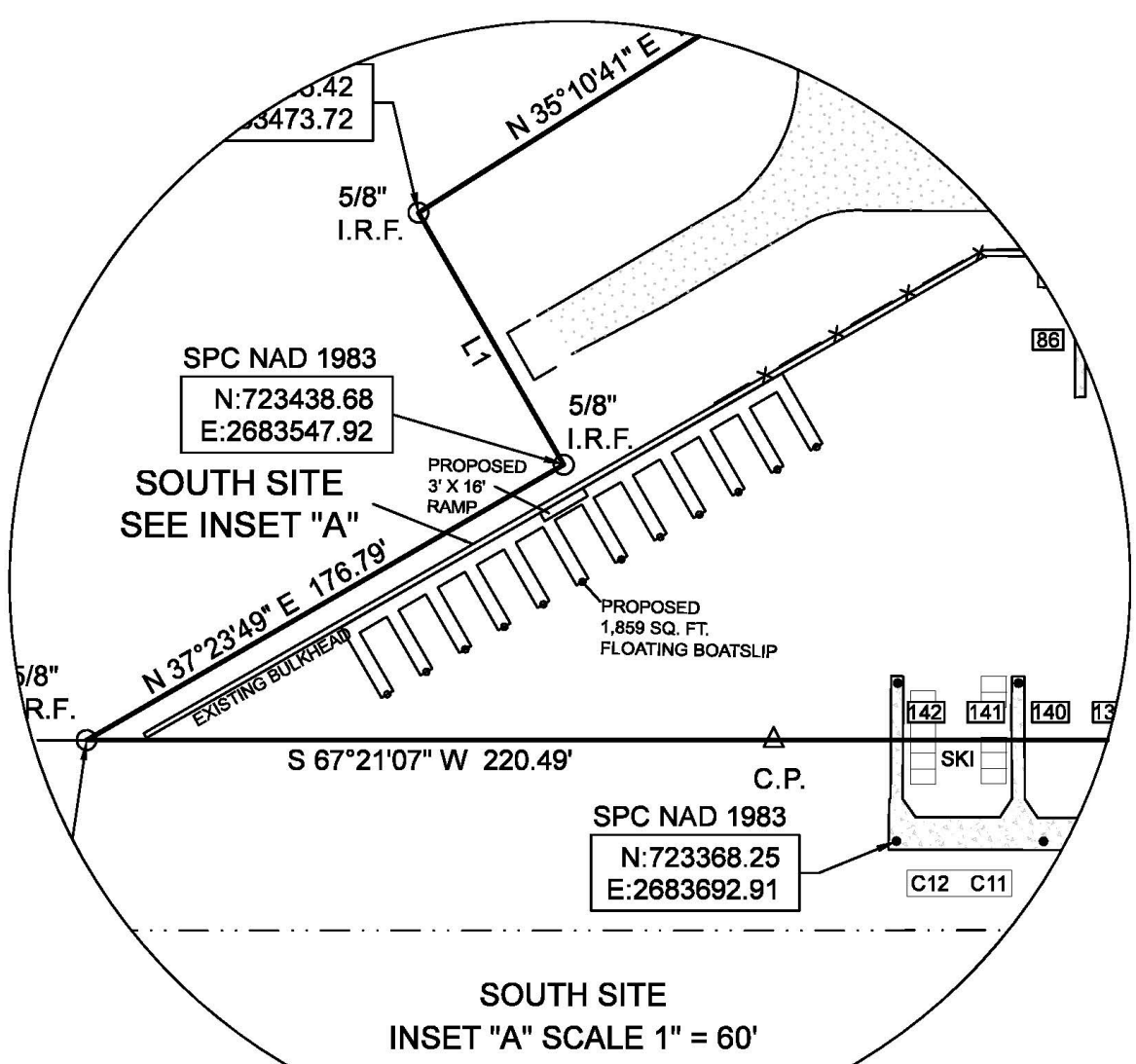

CURVE	ARC LENGTH	RADIUS	DELTA ANGLE	CHORD BEARING	CHORD LENGTH
C1	89.22	50.00	102°14'35"	N 88°14'11\" E	77.85
C2	48.78	40.00	89°52'31"	S 77°37'29\" E	45.81
C3	23.37	50.00	12°00'50"	N 88°19'17\" W	23.36
C4	11.66	50.00	13°21'26"	N 87°38'04\" W	11.63
C5	30.76	25.00	170°28'47"	N 57°49'31\" W	28.85

LINE	BEARING	DISTANCE
L1	N 52°35'43\" W	93.41
L2	N 02°41'48\" W	90.75
L3	S 67°02'28\" W	67.35
L4	N 23°07'56\" W	75.78
L5	N 67°09'31\" E	37.97
L6	N 65°41'49\" E	140.86
L7	N 23°00'10\" W	96.00
L8	N 40°47'08\" E	1102.48

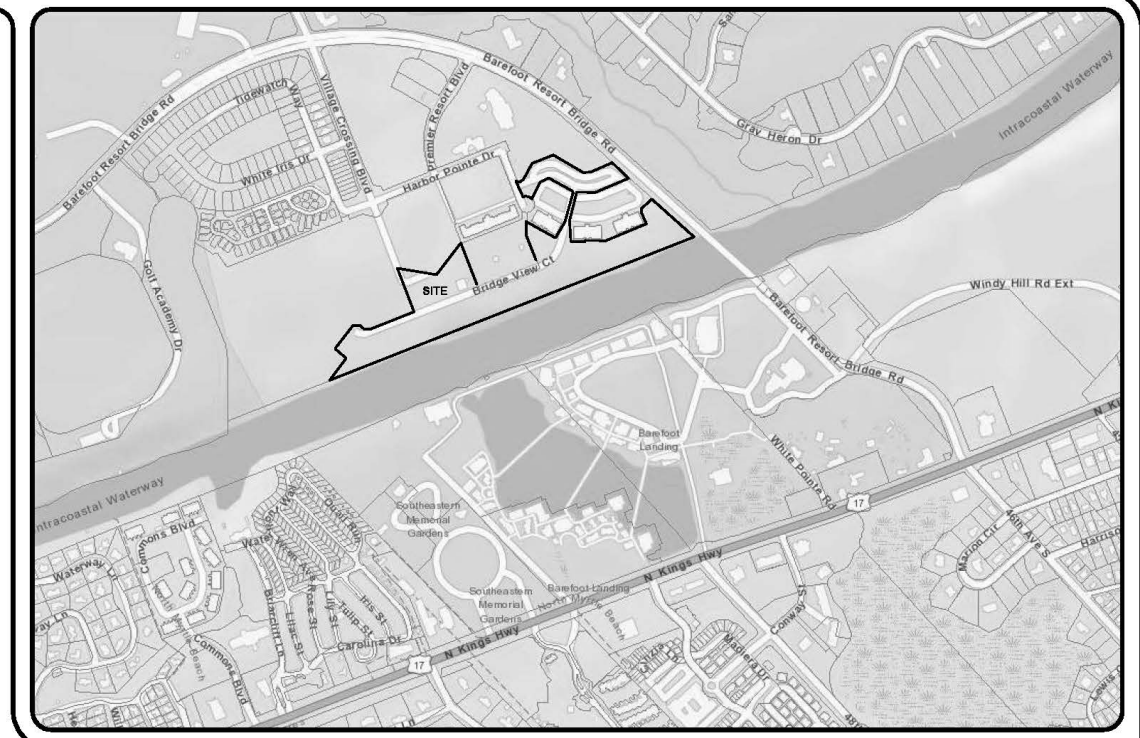
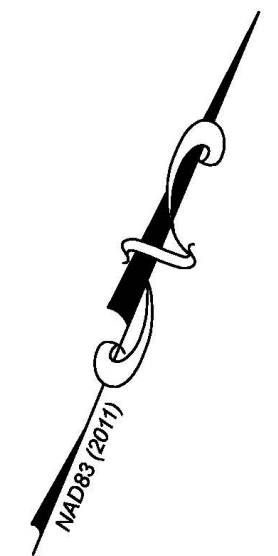

VICINITY MAP - NTS

THIS PLAT WAS PREPARED FOR THE EXCLUSIVE USE OF THE PERSON OR PERSONS SHOWN IN THE TITLE BLOCK AND THIS DOESN'T MAKE ANY CERTIFICATION TO ANY UNNAMED PARTIES WITHOUT A REVISION AND UPDATE TO THE CERTIFICATION WITH THE CLIENTS AUTHORIZATION. ADDITIONAL FEES.

LEGEND

- I.R.F. = IRON REBAR FOUND
- I.P.F. = IRON PIPE FOUND
- P.K.F. = PK NAIL FOUND
- P.K.S. = PK NAIL SET
- C.P. = CALCULATED POINT
- PP = POWER POLE
- LP = LIGHT POLE
- TR = TRANSFORMER BOX
- AC = AIR CONDITIONING
- TE = TELEPHONE PED.
- CT = CABLE TV
- WM = WATER METER
- WS = WATER SERVICE
- WV = WATER VALVE
- FH = FIRE HYD.
- SM = SEWER MANHOLE
- SC = SEWER CLEAN OUT
- SS = SEWER SERVICE
- ST = STORM MANHOLE
- CB = CATCH BASIN
- F = FENCE
- OP = OVERHEAD POWER
- UG = UNDERGROUND ELECTRIC
- UF = UNDERGROUND FIBER OPTIC
- WM = WATER LINE MAIN
- WF = WATER FORCE MAIN

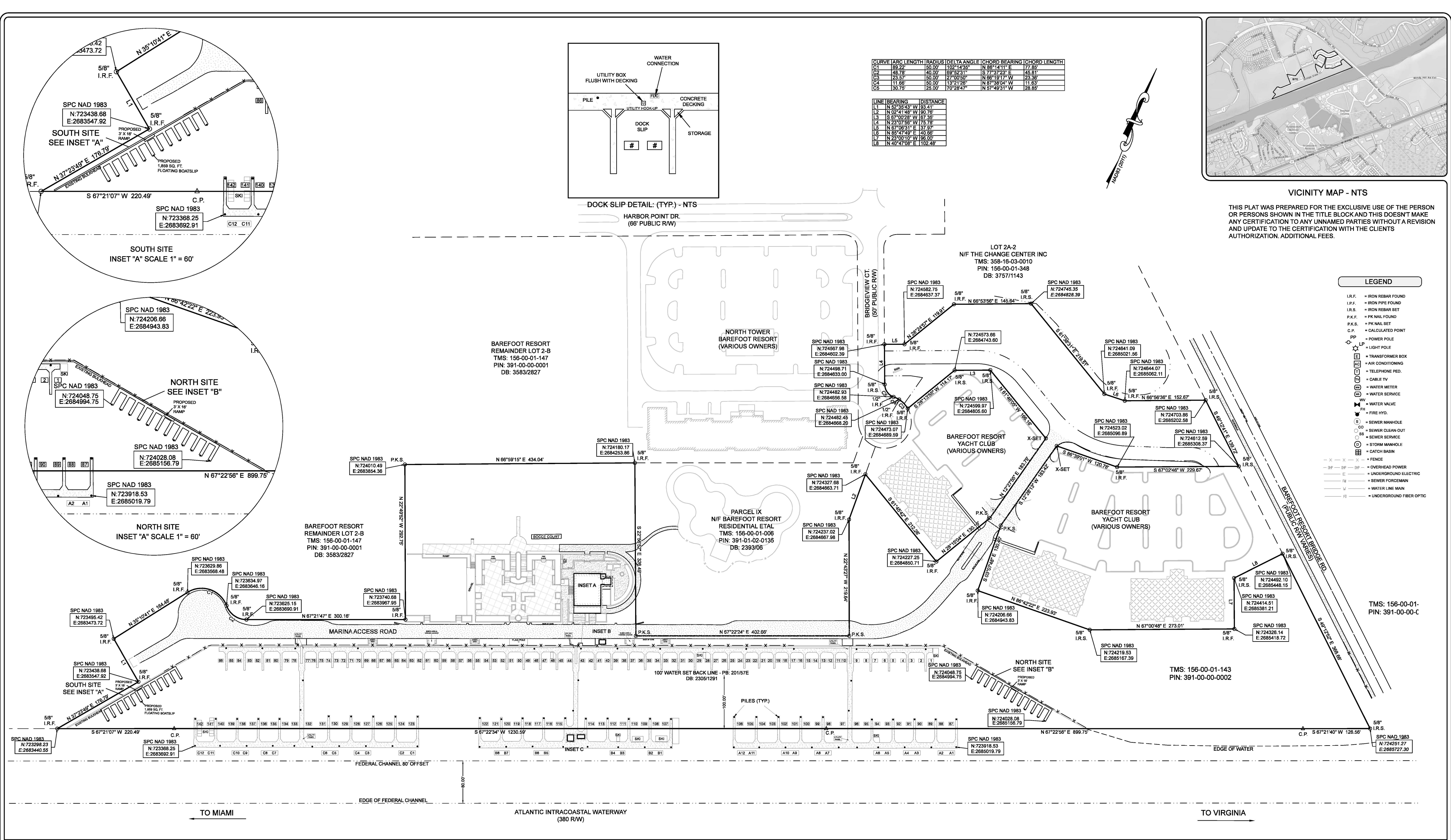

SURVEYOR'S CERTIFICATE

I HEREBY STATE THAT TO THE BEST OF MY KNOWLEDGE, INFORMATION, AND BELIEF, THE SURVEY SHOWN HEREON WAS MADE IN ACCORDANCE WITH THE REQUIREMENTS OF THE STANDARDS OF PRACTICE MANUAL FOR SURVEYING IN SOUTH CAROLINA, AND MEETS OR EXCEEDS THE REQUIREMENTS OF A CLASS B SURVEY AS THAT ALL NECESSARY MARKERS HAVE BEEN INSTALLED AND THERE ARE NO ENCROACHMENTS OTHER THAN SHOWN HEREON.

F. WILLIAM FAIREY IV, P.L.S. #27466

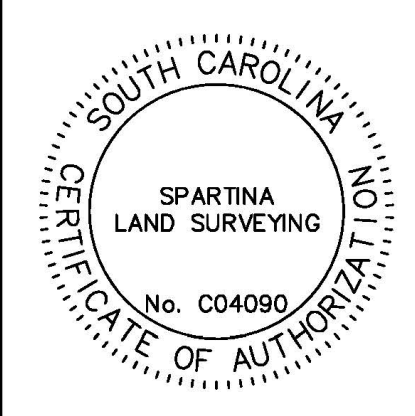

DOCK ASBUILT
PREPARED FOR
BFM LLC

TMS: 156-00-01-143 LOCATED IN THE CITY LIMITS OF NORTH MYRTLE BEACH
HORRY COUNTY, SOUTH CAROLINA
OCTOBER 2, 2020

NO.	DATE	REVISION	BY

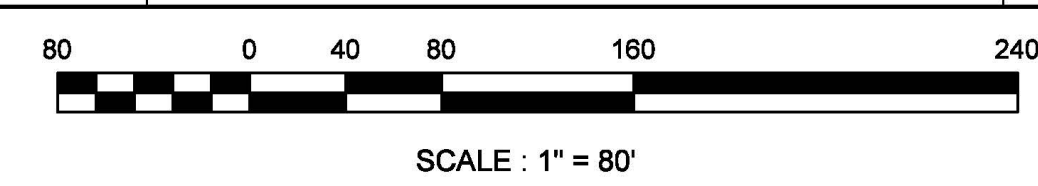

SHEET

1 OF 8



SURVEYED AND MAPPED BY
SPARTINA LAND SURVEYING
602 MAIN STREET, CONWAY SC 29526
PHONE: 843-340-0285 / OFFICE 843-488-1040

AJS BAREFOOT MARINA.DWG JOB# 2275-19103

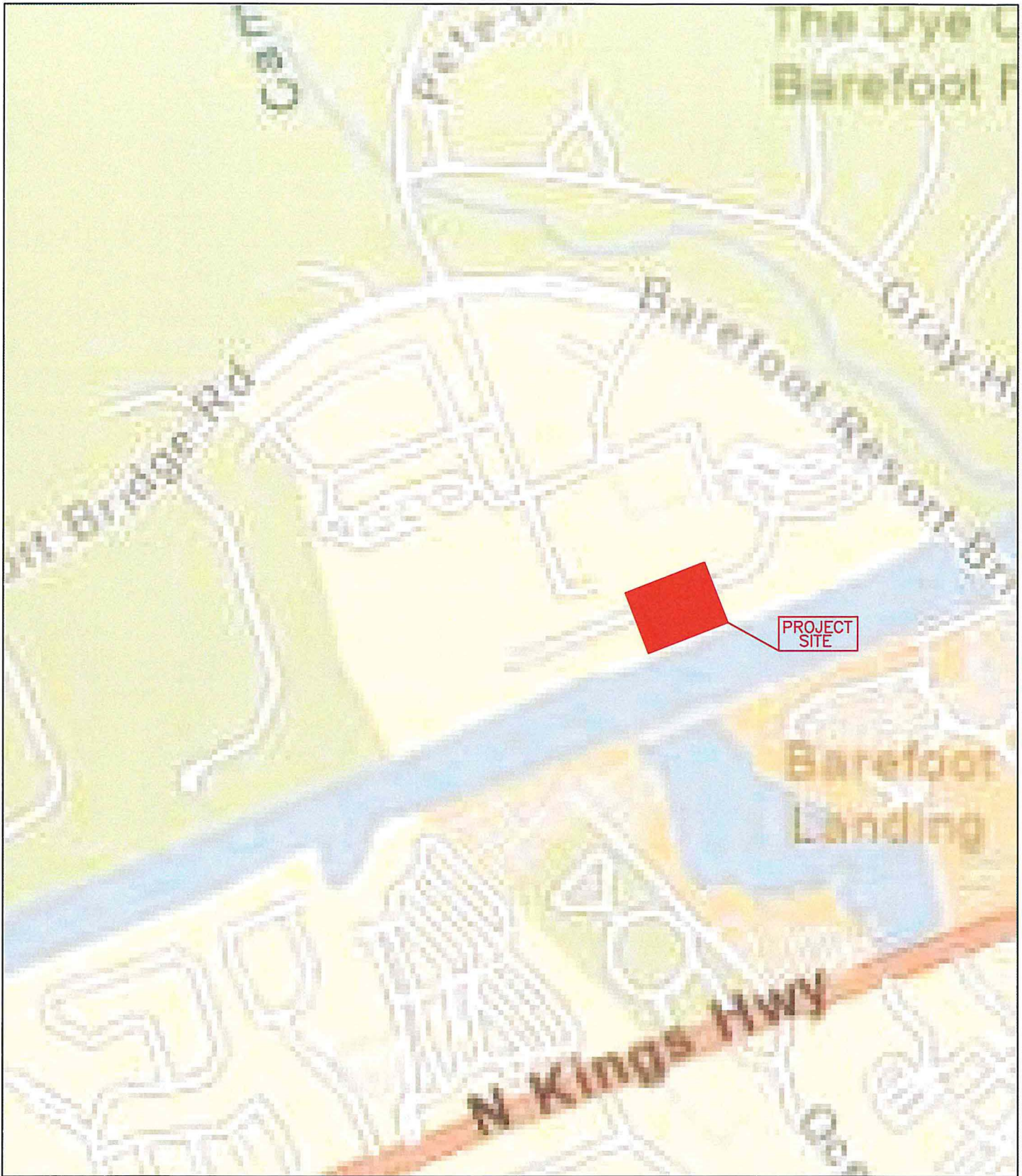

VICINITY MAP
DOCK SURVEY
TMS# 156-00-01-143
2051 BRIDGE VIEW CT
NORTH MYRTLE BEACH, SC 29576
HORRY COUNTY
OCTOBER 2, 2020

GRAPHIC SCALE



(IN FEET)
1 inch = 40 ft.

SPC NAD 1983

N:723495.42
E:2683473.72

5/8"
I.R.F.

N 35°10'41" E 164.48'

N/F
BFM LLC

TMS: 156-00-01-143
PIN: 391-00-00-0002

SPC NAD 1983

N:723438.68
E:2683547.92

5/8"
I.R.F.

N 37°23'49" E 176.79'

EXISTING BULKHEAD

S 67°21'07" W 220.49'

C.P.

SPC NAD 1983

N:723368.25
E:2683692.91

142 141 140

SKI

C12 C11

ASBUILT DOCK SURVEY FEDERAL CHANNEL 80' OFFSET
BAREFOOT MARINA
CLUB PARCEL 1
SOUTH SITE
HORRY COUNTY
TMS# 156-00-01-143

DATE: 10/02/2020

OWNER: BFM LLC
9845 ERMA RD
SAN DIEGO, CA 92131

EDGE OF FEDERAL CHANNEL

80.00'



SURVEYED & MAPPED BY
SPARTINA LAND SURVEYING
602 MAIN STREET CONWAY, SC 29526
MOBILE 843-340-0285 / OFFICE 843-488-1040

Handwritten signature in red ink.

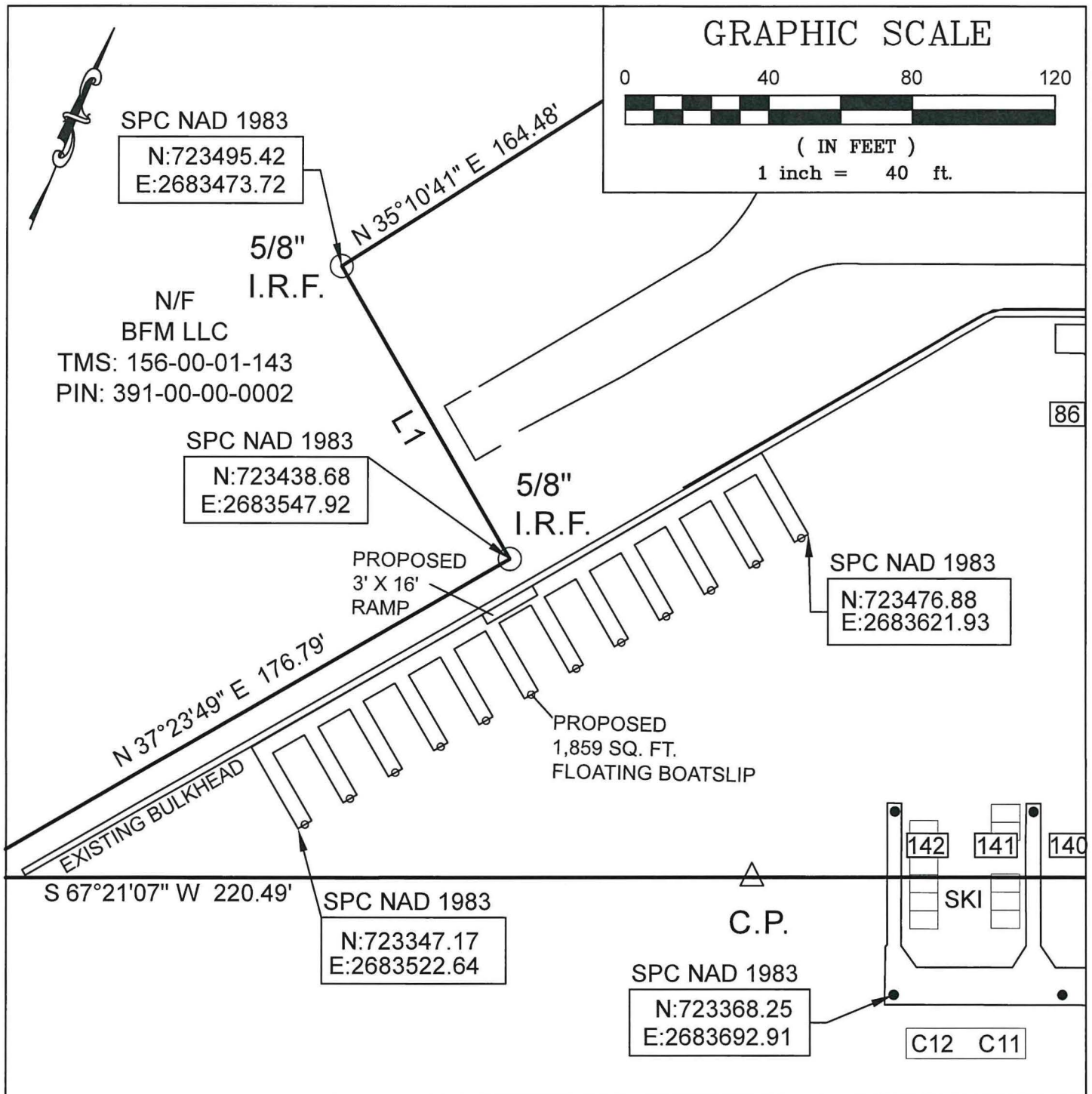

PLAN VIEW
 BAREFOOT MARINA
 CLUB PARCEL 1
 SOUTH SITE
 Horry County
 TMS# 156-00-01-143

DATE: 10/02/2020

OWNER: BFM LLC
 9845 ERMA RD
 SAN DIEGO, CA 92131

FEDERAL CHANNEL 80' OFFSET

80.00'



SURVEYED & MAPPED BY
 SPARTINA LAND SURVEYING
 602 MAIN STREET CONWAY, SC 29526
 MOBILE 843-340-0285 / OFFICE 843-488-1040

Handwritten signature in red ink.

GRAPHIC SCALE



(IN FEET)

1 inch = 10 ft.

ATLANTIC INTRACOASTAL WATERWAY

N/F
BFM LLC
TMS: 156-00-01-143
PIN: 391-00-00-0002

PROPOSED
3' X 16'
RAMP

PROPOSED
1859 SQ. FT.
FLOATING BOATSLIP

Mean High Water Line

Mean Low Water Line

EXIST. BULKHEAD

PROFILE VIEW
BAREFOOT MARINA

CLUB PARCEL 1
SOUTH SITE
HORRY COUNTY

TMS# 156-00-01-143

DATE: 10/02/2020

OWNER: BFM LLC
9845 ERMA RD
SAN DIEGO, CA 92131

Existing Grade
(approximate)

(Not to Scale)

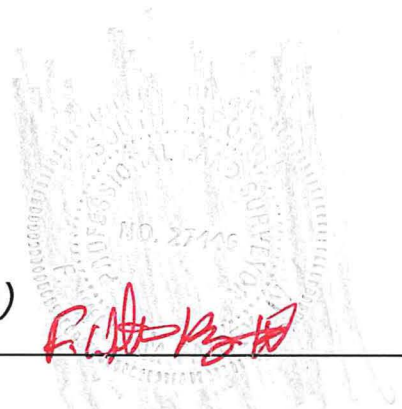

SURVEYED & MAPPED BY
SPARTINA LAND SURVEYING
802 MAIN STREET, CONWAY, SC 29628
MOBILE 843-340-0286 / OFFICE 843-488-1040

Red handwritten signature

GRAPHIC SCALE



(IN FEET)
1 inch = 40 ft.



N/F
BFM LLC
TMS: 156-00-01-143
PIN: 391-00-00-0002

EXISTING BULKHEAD

N 67°22'56" E 899.75'

88 87

SPC NAD 1983

N:723918.53
E:2685019.79

A2 A1

FEDERAL CHANNEL 80' OFFSET

100.08

80.08

ASBUILT DOCK SURVEY
BAREFOOT MARINA
CLUB PARCEL 1
NORTH SITE
HORRY COUNTY
TMS# 156-00-01-143

DATE: 10/02/2020

EDGE OF FEDERAL CHANNEL



OWNER: BFM LLC
9845 ERMA RD
SAN DIEGO, CA 92131

F. W. H. B. Smith

SURVEYED & MAPPED BY
SPARTINA LAND SURVEYING
602 MAIN STREET CONWAY, SC 29526
MOBILE 843-340-0285 / OFFICE 843-488-1040

GRAPHIC SCALE



(IN FEET)
1 inch = 40 ft.



N/F
BFM LLC

TMS: 156-00-01-143
PIN: 391-00-00-0002

SPC NAD 1983

N:724048.75
E:2684994.75

PROPOSED
3' X 16'
RAMP

PROPOSED
1,859 SQ. FT.
FLOATING BOATSLIP

SPC NAD 1983

N:724028.08
E:2685156.79

EXISTING BULKHEAD

N 67°22'56" E 899.75'

SPC NAD 1983

N:723918.53
E:2685019.79

88 87

A2 A1

FEDERAL CHANNEL 80' OFFSET

80.00'



PLAN VIEW
BAREFOOT MARINA
CLUB PARCEL 1
NORTH SITE
HORRY COUNTY
TMS# 156-00-01-143

DATE: 10/02/2020

OWNER: BFM LLC
9845 ERMA RD
SAN DIEGO, CA 92131

EDGE OF FEDERAL CHANNEL

Handwritten signature in red ink.

SURVEYED & MAPPED BY
SPARTINA LAND SURVEYING
602 MAIN STREET CONWAY, SC 29526
MOBILE 843-340-0285 / OFFICE 843-488-1040

GRAPHIC SCALE



(IN FEET)

1 inch = 10 ft.

ATLANTIC INTRACOASTAL WATERWAY

N/F
BFM LLC
TMS: 156-00-01-143
PIN: 391-00-00-0002

PROPOSED
3' X 16'
RAMP

PROPOSED
1859 SQ. FT.
FLOATING BOATSLIP

Mean High Water Line

Mean Low Water Line

EXIST. BULKHEAD

PROFILE VIEW
BAREFOOT MARINA
CLUB PARCEL 1
NORTH SITE
HORRY COUNTY

TMS# 156-00-01-143

DATE: 10/02/2020

OWNER: BFM LLC
9845 ERMA RD
SAN DIEGO, CA 92131

Existing Grade
(approximate)

(Not to Scale)

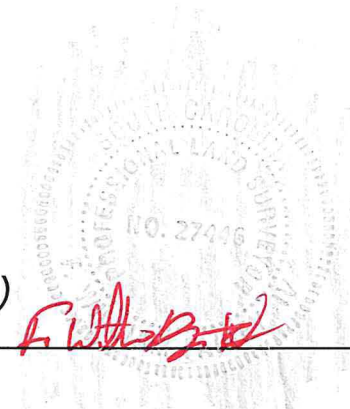

SURVEYED & MAPPED BY
SPARTINA LAND SURVEYING
802 MAIN STREET, CONWAY, SC 29528
MOBILE 843-340-0285 / OFFICE 843-488-1040

Handwritten signature in red ink.