

JOINT  
PUBLIC NOTICE

CHARLESTON DISTRICT, CORPS OF ENGINEERS  
69A Hagood Avenue  
Charleston, South Carolina 29403-5107  
and  
THE S.C. DEPARTMENT OF HEALTH AND ENVIRONMENTAL CONTROL  
Office of Environmental Quality Control  
Water Quality Certification and Wetlands Programs Section  
2600 Bull Street  
Columbia, South Carolina 29201

REGULATORY DIVISION

Refer to: P/N #2012-00170-2IR

25 June 2012

Pursuant to Section 10 of the Rivers and Harbors Act of 1899 (33 U.S.C. 403), Section 401 of the Clean Water Act (33 U.S.C. 1344), the South Carolina Coastal Zone Management Act (48-39-10 et seq.), and the S.C. Construction in Navigable Waters Permit Program (R. 19-450, et seq., 1976 S.C. Code of Laws, as amended), an application has been submitted to the Department of the Army and the S.C. Department of Health and Environmental Control by

COOPER RIVER PARTNERS, LLC  
C/O LARRY ARRINGTON  
1588 BUSHY PARK ROAD  
GOOSE CREEK, SOUTH CAROLINA 29445

for a permit to construct a dock in the

**COOPER RIVER**

at a site on the east side of Bushy Park Road approximately 1.9 miles north of the intersection with Red Bank Road in Berkeley County, South Carolina. Latitude: 32.98574 N; Longitude: -79.92546 W.

In order to give all interested parties an opportunity to express their views

**NOTICE**

is hereby given that written statements regarding the proposed work will be received by the **Corps** until

**15 Days from the Date of this Notice**

and **SCDHEC** will receive written statements regarding the proposed work until

**30 Days from the Date of this Notice**

from those interested in the activity and whose interests may be affected by the proposed work.

The proposed work consists of constructing a concrete, pile supported dock that will consist of a 71 foot x 20 foot wide pier attached to high land. At the waterward end of the pier, an approximately 300 foot long x 30 foot wide dock will be attached. The dock will include bull rails and a fender system and will be supported by pre-stressed concrete piles. It will be accessed by an existing road on the south side of the site so there will be no impacts to wetlands. The applicant considered various options and locations for the proposed dock including: Option 1) construction of a dock farther out into the river, Option 2) construction of a standalone wharf protruding into the Cooper River and connected to the upland by a pier suitable for vehicular traffic, and Option 3) construction of

a barge slip cut further in the highland. Option 1 was unacceptable due to navigation concerns. Option 2 was not selected because it would have required a bulkhead to stabilize the shoreline. Option 3 was not selected because of the operational challenges of handling vessels of varying sizes and the potential for this option to require periodic dredging which the applicant wants to avoid. Consequently, the applicant selected the currently proposed plan in order to minimize impacts to Waters of the U.S. Due to the nature of the project, mitigation is neither proposed nor required. The purpose of the dock, according to the applicant, is to serve as an import/export terminal to support the manufacturing operations at the Bushy Park Industrial Complex.

**NOTE: Plans depicting the work described in this notice are available and will be provided, upon receipt of a written request, to anyone that is interested in obtaining a copy of the plans for the specific project. The request must identify the project of interest by public notice number and a self-addressed stamped envelope must also be provided for mailing the drawings to you. Your request for drawings should be addressed to the**

**U.S. Army Corps of Engineers  
ATTN: REGULATORY DIVISION  
69A Hagood Avenue  
Charleston, South Carolina 29403-5107**

The District Engineer has concluded that the discharges associated with this project, both direct and indirect, should be reviewed by the South Carolina Department of Health and Environmental Control in accordance with provisions of Section 401 of the Clean Water Act. As such, this notice constitutes a request, on behalf of the applicant, for certification that this project will comply with applicable effluent limitations and water quality standards. The work shown on this application must also be certified as consistent with applicable provisions of the Coastal Zone Management Program (15 CFR 930). The District Engineer will not process this application to a conclusion until such certifications are received. This activity may also require evaluation for compliance with the S.C. Construction in Navigable Waters Permit Program. State review, permitting and certification is conducted by the S.C. Department of Health and Environmental Control. The applicant is hereby advised that supplemental information may be required by the State to facilitate the review. Persons wishing to comment or object to State certification or the navigable waters permit must submit all comments in writing to the S.C. Department of Health and Environmental Control at the above address within thirty (30) days of the date of this notice.

This notice initiates the Essential Fish Habitat (EFH) consultation requirements of the Magnuson-Stevens Fishery Conservation and Management Act. Implementation of the proposed project would result in 0.24 acres of shading impact of Waters of the U.S. upstream of estuarine substrates and emergent wetlands utilized by various life stages of species comprising the red drum, shrimp, and snapper-grouper management complexes. Our initial determination is that the proposed action would not have a substantial individual or cumulative adverse impact on EFH or fisheries managed by the South Atlantic Fishery Management Council and the National Marine Fisheries Service (NMFS). Our final determination relative to project impacts and the need for mitigation measures is subject to review by and coordination with the NMFS.

Pursuant to Section 7(c) of the Endangered Species Act of 1973 (as amended), the District Engineer has consulted the most recently available information and has determined that the project is not likely to adversely affect any Federally endangered, threatened, or proposed species or result in the destruction or adverse modification of designated or proposed critical habitat. This public notice serves as a request for written concurrence from the U.S. Fish and Wildlife Service and/or the National Marine Fisheries Service on this determination.

Pursuant to Section 106 of the National Historic Preservation Act (NHPA), this public notice also constitutes a request to Indian Tribes to notify the District Engineer of any historic properties of religious and cultural significance to them that may be affected by the proposed undertaking.

In accordance with the NHPA, the District Engineer has also consulted the latest published version of the National Register of Historic Places for the presence or absence of registered properties, or properties listed as being eligible for inclusion therein, and this worksite is not included as a registered property or property listed as being eligible for inclusion in the Register. To insure that other cultural resources that the District Engineer is not aware of are not overlooked, this public notice also serves as a request to the State Historic Preservation Office to provide any information it may have with regard to historic and cultural resources.

Any person may request, in writing, within the comment period specified in this notice, that a public hearing be held to consider this application. Requests for a public hearing shall state, with particularity, the reasons for holding a public hearing.

The decision whether to issue a permit will be based on an evaluation of the probable impact including cumulative impacts of the activity on the public interest. That decision will reflect the national concern for both protection and utilization of important resources. The benefit which reasonably may be expected to accrue from the project must be balanced against its reasonably foreseeable detriments. All factors which may be relevant to the project will be considered including the cumulative effects thereof; among those are conservation, economics, aesthetics, general environmental concerns, wetlands, historic properties, fish and wildlife values, flood hazards, flood plain values, land use, navigation, shoreline erosion and accretion, recreation, water supply and conservation, water quality, energy needs, safety, food and fiber production and, in general, the needs and welfare of the people. A permit will be granted unless the District Engineer determines that it would be contrary to the public interest. In cases of conflicting property rights, the Corps of Engineers cannot undertake to adjudicate rival claims.

The Corps of Engineers is soliciting comments from the public; Federal, state, and local agencies and officials; Indian Tribes; and other interested parties in order to consider and evaluate the impacts of this activity. Any comments received will be considered by the Corps of Engineers to determine whether to issue, modify, condition or deny a permit for this project. To make this decision, comments are used to assess impacts on endangered species, historic properties, water quality, general environmental effects, and the other public interest factors listed above. Comments are used in the preparation of an Environmental Assessment and/or an Environmental Impact Statement pursuant to the National Environmental Policy Act. Comments are also used to determine the need for a public hearing and to determine the overall public interest of the activity.

If there are any questions concerning this public notice, please contact Robin Coller-Socha at 843-329-8044 or toll free at 1-866-329-8187.

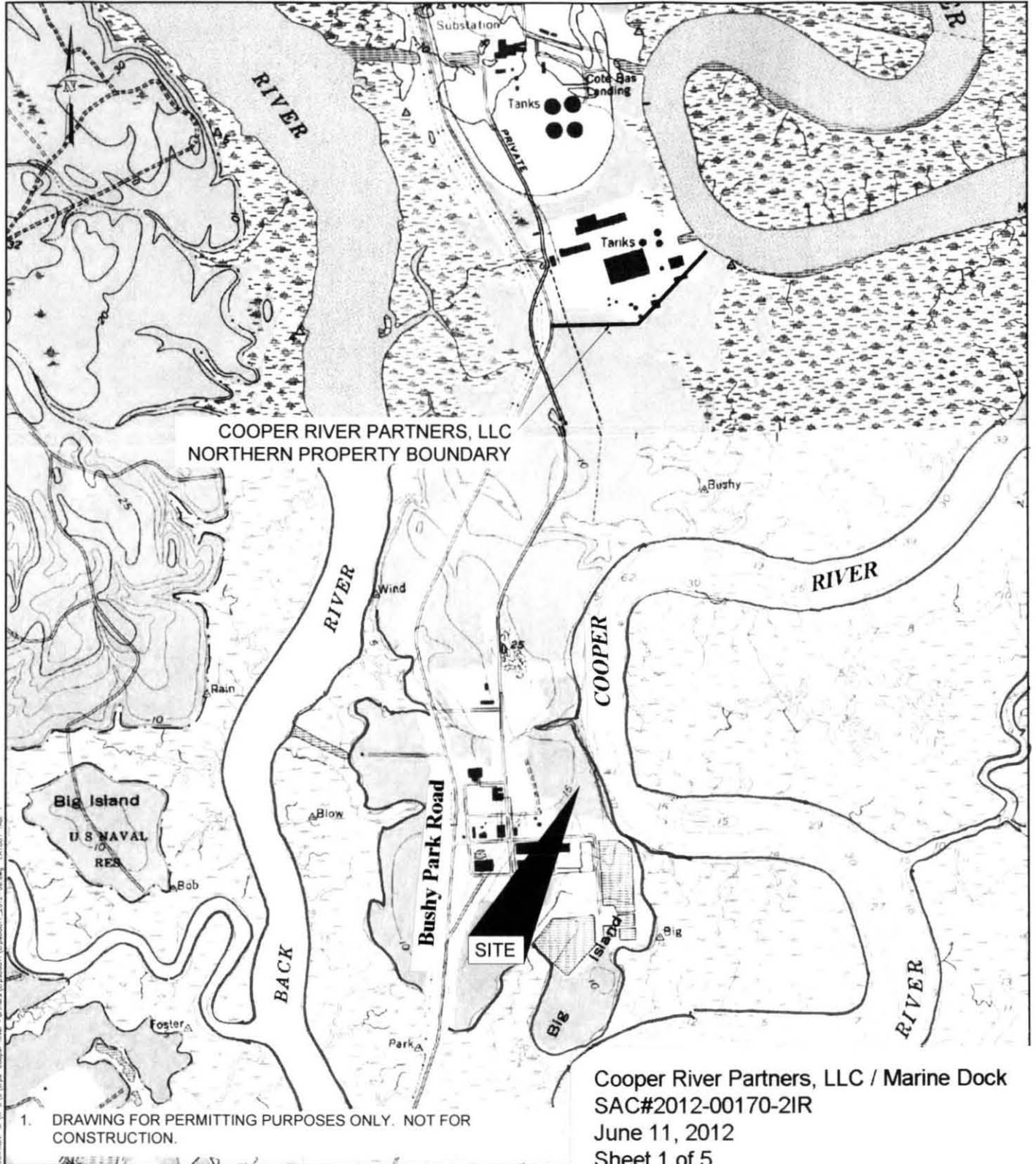

COOPER RIVER PARTNERS, LLC  
NORTHERN PROPERTY BOUNDARY

Cooper River Partners, LLC / Marine Dock  
SAC#2012-00170-2IR  
June 11, 2012  
Sheet 1 of 5

1. DRAWING FOR PERMITTING PURPOSES ONLY. NOT FOR CONSTRUCTION.

PURPOSE: INDUSTRIAL SITE DEVELOPMENT  
APPLICANT: COOPER RIVER PARTNERS, LLC

LATITUDE: 32°59'05.01"N  
LONGITUDE: 79°55'30.54"W

SURVEY DATUM: NAD 83

*Joseph L. Holt* 6/15/12

FIGURE 1  
LOCATION MAP

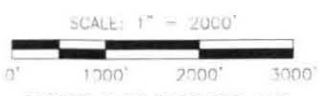

COOPER RIVER PARTNERS, LLC  
BUSHY PARK FACILITY  
BERKELEY COUNTY, SOUTH CAROLINA

AT: BUSHY PARK FACILITY

IN: COOPER RIVER

COUNTY OF: BERKELEY COUNTY,  
SOUTH CAROLINA

SHEET: 1 OF 5

DATE: 06/11/2012

PLOTTED: Jun 12, 2012 3:33PM BT: 18 FILE LOCATION: U:\-GIS\Draws - Cooper River Partners\Corp\00811\00170-06.dwg LAYOUT: A0



NEXANS HIGH VOLTAGE USA, INC.

COOPER RIVER



COOPER RIVER PARTNERS, LLC

PROPOSED DOCK

PROJECT AREA

BUSHY PARK RD

DUPONT WAY

Cooper River Partners, LLC / Marine Dock  
SAC#2012-00170-2IR

June 11, 2012

Sheet 2 of 5

1. DRAWING FOR PERMITTING PURPOSES ONLY. NOT FOR CONSTRUCTION.

PURPOSE: INDUSTRIAL SITE DEVELOPMENT  
APPLICANT: COOPER RIVER PARTNERS, LLC

LATITUDE: 32°59'05.01"N  
LONGITUDE: 79°55'30.54"W

SURVEY DATUM: NQVD 88

FIGURE 2  
SITE MAP

SCALE: 1" = 500'



COOPER RIVER PARTNERS, LLC  
BUSHY PARK FACILITY  
BERKELEY COUNTY, SOUTH CAROLINA

PROPOSED: DOCK CONSTRUCTION

AT: BUSHY PARK FACILITY

IN: COOPER RIVER

COUNTY OF: BERKELEY COUNTY,  
SOUTH CAROLINA

SHEET: 2 OF 5

DATE: 06/11/2012

PLOTTED: Jun 22, 2012 - 2:38pm BY: jlp FILE LOCATION: G:\A-D\CV\Cooper River Partners\cprp00811\cprp00811\_2012-07.dwg LAYOUT: TAB\_2



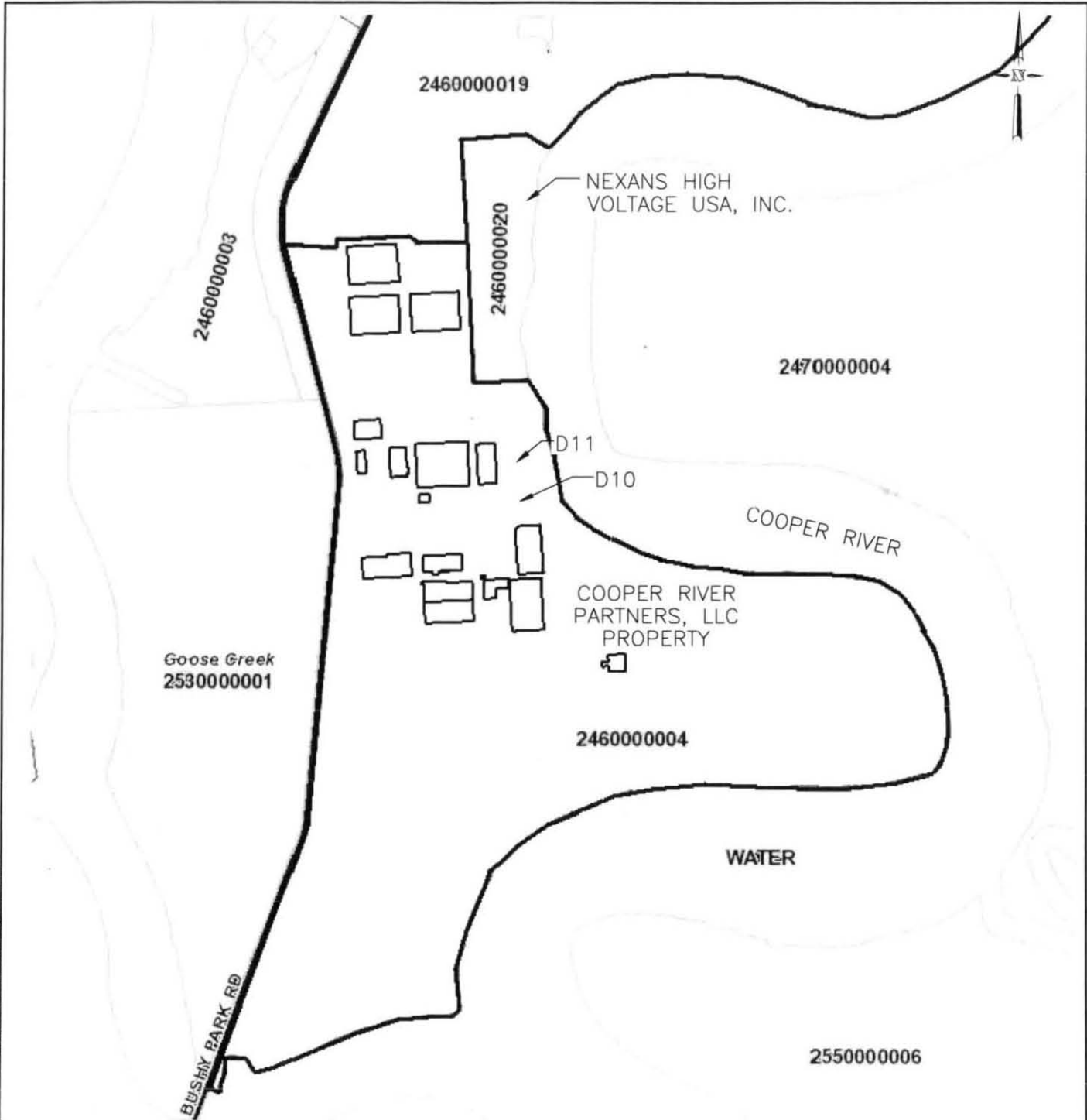

User: Rina\_Partners\crps00811\crps00811\_2012-07.dwg - LAYOUT 148 - 3

Cooper River Partners, LLC / Marine Dock  
 SAC#2012-00170-2IR  
 June 11, 2012  
 Sheet 3 of 5

**Berkeley County GIS - Copyright 2012**

COOPER RIVER PARTNERS, LLC  
 LATITUDE: 32°59'05.01"N  
 LONGITUDE: 79°55'30.54"W  
 SURVEY DATUM: NGVD 88

FIGURE 3  
LAN VIEW

NOT TO SCALE

COOPER RIVER PARTNERS, LLC  
 BUSHY PARK FACILITY  
 BERKELEY COUNTY, SOUTH CAROLINA

PROPOSED: DOCK CONSTRUCTION  
 AT: BUSHY PARK FACILITY  
 IN: COOPER RIVER  
 COUNTY OF: BERKELEY COUNTY,  
 SOUTH CAROLINA  
 SHEET: 3 OF 5

DATE: 06/11/2012

PLOTTED: Jun 22, 2012 - 2:38pm - BT

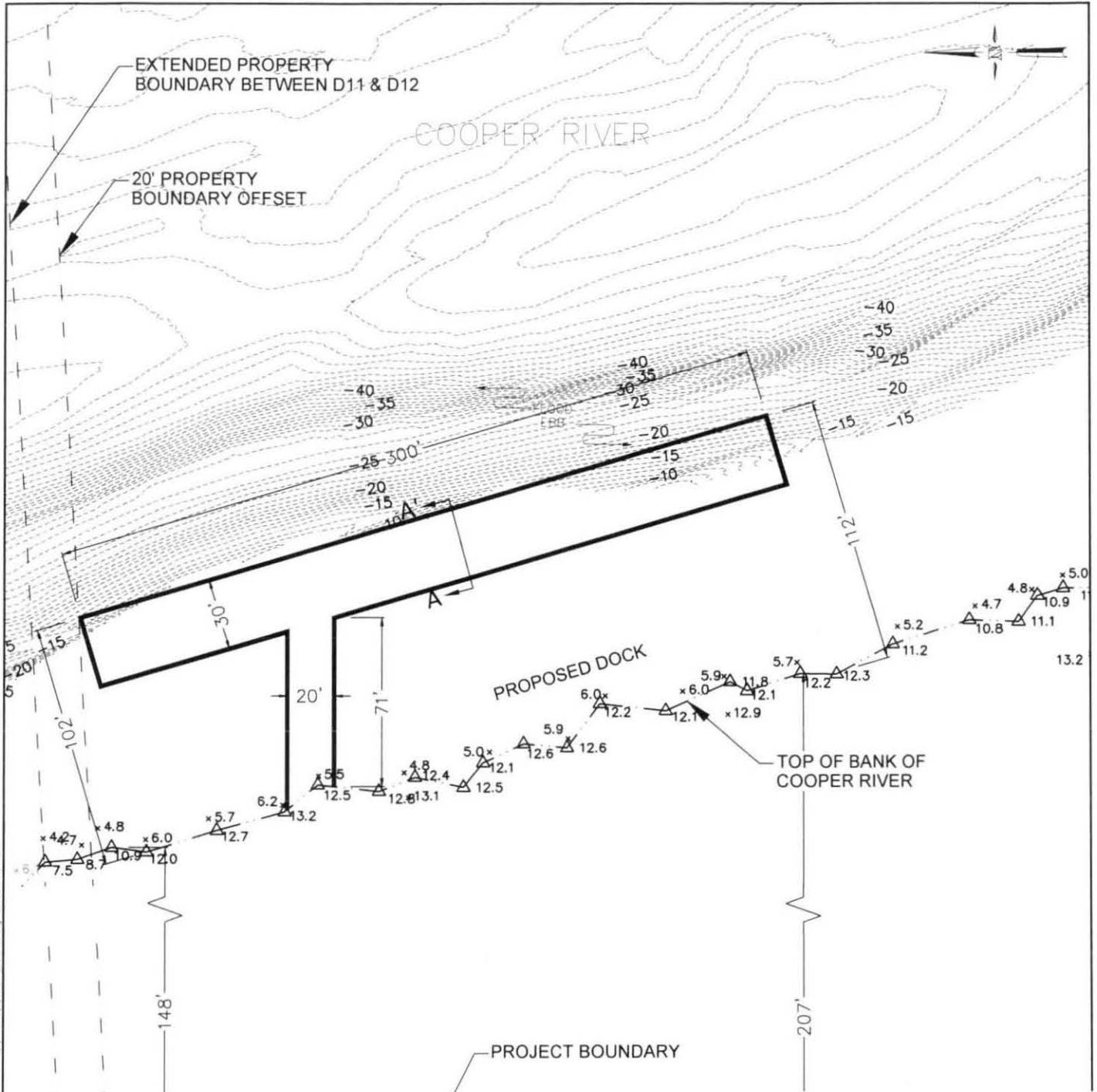

Cooper River Partners, LLC / Marine Dock  
 SAC#2012-00170-2IR  
 June 11, 2012  
 Sheet 4 of 5

PURPOSE: INDUSTRIAL SITE DEVELOPMENT  
 APPLICANT: COOPER RIVER PARTNERS, LLC  
 LATITUDE: 32°59'05.01"N  
 LONGITUDE: 79°55'30.54"W

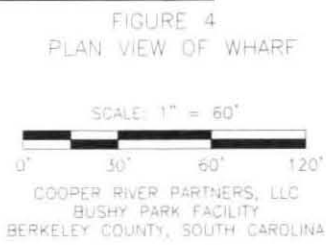

PROPOSED: DOCK CONSTRUCTION  
 AT: BUSHY PARK FACILITY  
 IN: COOPER RIVER  
 COUNTY OF: BERKELEY COUNTY,  
 SOUTH CAROLINA  
 SHEET: 4 OF 5  
 DATE: 06/11/2012

PLOTTED: 06/12/2012 3:09pm  
 FILE LOCATION: G:\M-20\COOPER\Cooper River Partners\2012-00170-2IR\2012-00170-2IR\_LAYOUT TAB 4  
 06/08/11

SURVEY DATUM: NCGD 88  
*Joseph P. [Signature]* 6/15/12

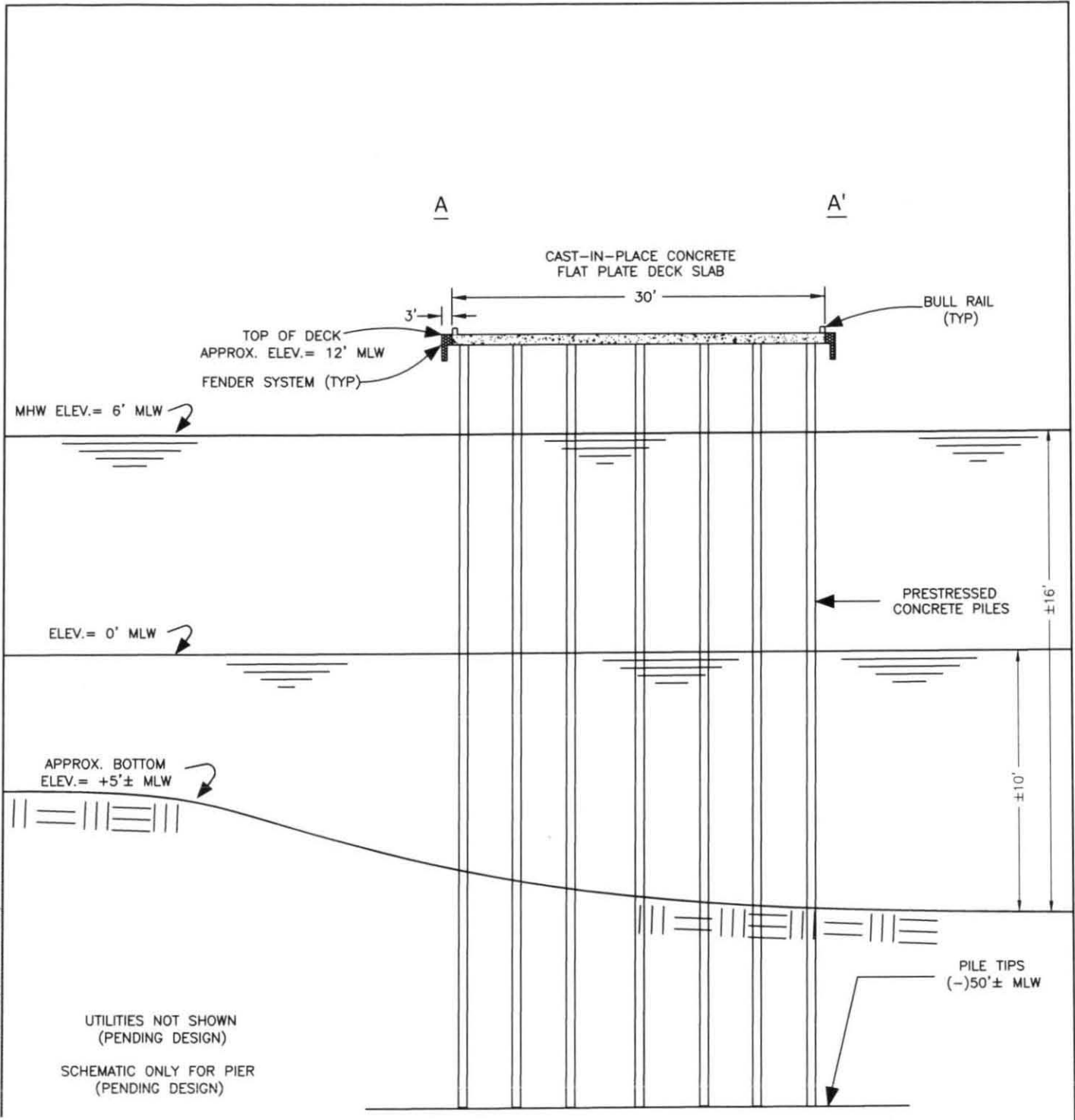

Cooper River Partners, LLC / Marine Dock  
 SAC#2012-00170-2IR  
 June 11, 2012  
 Sheet 5 of 5

FIGURE 5  
 CROSS SECTION  
 A-A'

PROPOSED DOCK CONSTRUCTION  
 AT BUSHY PARK FACILITY  
 IN COOPER RIVER  
 COUNTY OF BERKELEY COUNTY,  
 SOUTH CAROLINA

NOT TO SCALE

COOPER RIVER PARTNERS, LLC  
 BUSHY PARK FACILITY  
 BERKELEY COUNTY, SOUTH CAROLINA

SHEET: 5 OF 5

DATE: 06/11/2012

LATITUDE: 32°59'05.01"N  
 LONGITUDE: 79°55'30.54"W

SURVEY DATUM: NGVD 88

*James L. White*  
 6/15/12

GEL ENGINEERING, LLC

a Member of THE GEL GROUP, INC