

JOINT
PUBLIC NOTICE

CHARLESTON DISTRICT, CORPS OF ENGINEERS
1835 Assembly Street, RM 865 B1
Columbia, South Carolina 29201
and
THE S.C. DEPARTMENT OF HEALTH AND ENVIRONMENTAL CONTROL
Water Quality Certification and Wetlands Section
2600 Bull Street
Columbia, South Carolina 29201

REGULATORY DIVISION
Refer to: P/N SAC-2020-01274

September 30, 2020

Pursuant to Section 10 of the Rivers and Harbors Act of 1899 (33 U.S.C. 403), Sections 401 and 404 of the Clean Water Act (33 U.S.C. 1341), and the S.C. Construction in Navigable Waters Permit Program (R. 19-450, et. seq., 1976 S.C. Code of Laws, as amended), an application has been submitted to the Department of the Army and the South Carolina Department of Health and Environmental Control by

Mr. George Selfridge
Plum Branch Yacht Club
P.O. Box 370
Plum Branch, South Carolina 29845

for a permit to construct five seawalls and two docks in

J. Strom Thurmond Lake

at Plum Branch Yacht Club located at the end of State Road 33-179, Plum Branch, McCormick County, South Carolina (Latitude: 33.8152°, Longitude: -82.3057°), Plum Branch Quad.

In order to give all interested parties an opportunity to express their views

N O T I C E

is hereby given that written statements regarding the proposed work will be received by the **Corps** until

15 Days from the Date of this Notice,

and **SCDHEC** will receive written statements regarding the proposed work until

30 Days from the Date of this Notice

from those interested in the activity and whose interests may be affected by the proposed work.

The proposed work consists of constructing five seawalls with associated fill behind the walls as well as installing two public boating docks. All work is proposed to occur in the dry when the lakes water level have been lowered. In detail, the proposed five sea walls involve 1,014 linear feet of seawall around the peninsula at the 336' elevation. This also includes placing up to 16,224

cubic yards of clean fill placed behind the walls, over an area of 0.85 acre. Dock C is proposed to be 171' x 99', consisting of a 60' gangway leading to a covered dock of 24 (11' x 30') slips. The Pavilion Courtesy Dock is proposed to be 135' x 54' with a 40' gangway leading to an uncovered dock of 8 (20' x 25') slips. The applicant has not proposed any mitigation. The project purpose is to provide erosion control and shoreline protection as well as provide additional boat parking.

NOTE: This public notice and associated plans are available on the Corps' website at:
<http://www.sac.usace.army.mil/Missions/Regulatory/PublicNotices> .

The District Engineer has concluded that the discharges associated with this project, both direct and indirect, should be reviewed by the South Carolina Department of Health and Environmental Control in accordance with provisions of Section 401 of the Clean Water Act. As such, this notice constitutes a request, on behalf of the applicant, for certification that this project will comply with applicable effluent limitations and water quality standards. This activity may also require evaluation for compliance with the S. C. Construction in Navigable Waters Permit Program. State review, permitting and certification is conducted by the S. C. Department of Health and Environmental Control. The District Engineer will not process this application to a conclusion until such certifications are received. The applicant is hereby advised that supplemental information may be required by the State to facilitate the review.

This notice initiates the Essential Fish Habitat (EFH) consultation requirements of the Magnuson-Stevens Fishery Conservation and Management Act. Implementation of the proposed project would impact 0.85 acre of freshwater habitat well inland of estuarine substrates and emergent wetlands utilized by various life stages of species comprising the shrimp, and snapper-grouper management complexes. The District Engineer's initial determination is that the proposed action would not have a substantial individual or cumulative adverse impact on EFH or fisheries managed by the South Atlantic Fishery Management Council and the National Marine Fisheries Service (NMFS). The District Engineer's final determination relative to project impacts and the need for mitigation measures is subject to review by and coordination with the NMFS.

Pursuant to the Section 7 of the Endangered Species Act of 1973 (as amended), the Corps has reviewed the project area, examined all information provided by the applicant, and the District Engineer has determined, based on the most recently available information that the project will have no effect on any Federally endangered, threatened, or proposed species and will not result in the destruction or adverse modification of designated or proposed critical habitat. This public notice serves as a request to the U.S. Fish and Wildlife Service and the National Marine Fisheries Service for any additional information they may have on whether any listed or proposed endangered or threatened species or designated or proposed critical habitat may be present in the area which would be affected by the activity.

Pursuant to Section 106 of the National Historic Preservation Act (NHPA), this public notice also constitutes a request to Indian Tribes to notify the District Engineer of any historic properties of religious and cultural significance to them that may be affected by the proposed undertaking.

In accordance with Section 106 of the NHPA, the District Engineer has consulted South Carolina ArchSite (GIS), for the presence or absence of historic properties (as defined in 36 C.F.R. 800.16)(1)), and has initially determined that no historic properties are present; therefore, there will be no effect on historic properties. To ensure that other historic properties

that the District Engineer is not aware of are not overlooked, this public notice also serves as a request to the State Historic Preservation Office and any other interested parties to provide any information they may have with regard to historic properties. This public notice serves as a request for concurrence within 30 days from the SHPO (and/or Tribal Historic Preservation Officer).

The District Engineer's final eligibility and effect determination will be based upon coordination with the SHPO and/or THPO, as appropriate and required and with full consideration given to the proposed undertaking's potential direct and indirect effects on historic properties within the Corps-identified permit area.

Any person may request, in writing, within the comment period specified in this notice, that a public hearing be held to consider this application. Requests for a public hearing shall state, with particularity, the reasons for holding a public hearing.

The decision whether to issue a permit will be based on an evaluation of the probable impact including cumulative impacts of the activity on the public interest. The benefit which reasonably may be expected to accrue from the project must be balanced against its reasonably foreseeable detriments. All factors which may be relevant to the project will be considered including the cumulative effects thereof; among those are conservation, economics, aesthetics, general environmental concerns, wetlands, historic properties, fish and wildlife values, flood hazards, flood plain values, land use, navigation, shoreline erosion and accretion, recreation, water supply and conservation, water quality, energy needs, safety, food and fiber production and, in general, the needs and welfare of the people. A permit will be granted unless the District Engineer determines that it would be contrary to the public interest. In cases of conflicting property rights, the Corps cannot undertake to adjudicate rival claims.

The Corps is soliciting comments from the public; Federal, state, and local agencies and officials; Indian Tribes; and other interested parties in order to consider and evaluate the impacts of this activity. Any comments received will be considered by the Corps to determine whether to issue, modify, condition or deny a permit for this project. To make this decision, comments are used to assess impacts on endangered species, historic properties, water quality, general environmental effects, and the other public interest factors listed above. Comments are used in the preparation of an Environmental Assessment and/or an Environmental Impact Statement pursuant to the National Environmental Policy Act. Comments are also used to determine the need for a public hearing and to determine the overall public interest of the activity. **Please submit comments in writing, identifying the project of interest by public notice number, to the following address:**

**U.S. Army Corps of Engineers
ATTN: REGULATORY DIVISION
1835 Assembly Street, RM 865 B1
Columbia, South Carolina 29201**

If there are any questions concerning this public notice, please contact Jarrett B. Cellini, Project Manager, at (803) 253-3916, or by email at Jarrett.B.Cellini@usace.army.mil.

September 30, 2020



Project Title:

Seawalls and Docks

Project Location:

Plum Branch Yacht Club

Applicant:

Dr. George C. Selfridge, Jr.

Date: 8/28/20

Scale:

Application #

Sheet of

September 30, 2020

From Savannah, S.C.

Go east on I 20 toward Augusta

Exit 61- go North (left) towards Appling

- 18.3 - go approx. 5 miles to sign
 - turn right at sign
 - go approx. 17 miles (road ends)

SC & US Hwy 28/221- Turn left (north)

- go approx. 14 miles
 - pass Modoc & Parkville
 - watch for "Plum Branch Town Limit" sign

SC Road 33-179 - Turn left (west) on 33/179

- Watch for "Lake Thurmond Access" & "PBYC 4 ml." signs
 - Go 4 miles to end of road



**Plum Branch
Yacht Club**

Phone (864) 443-3000

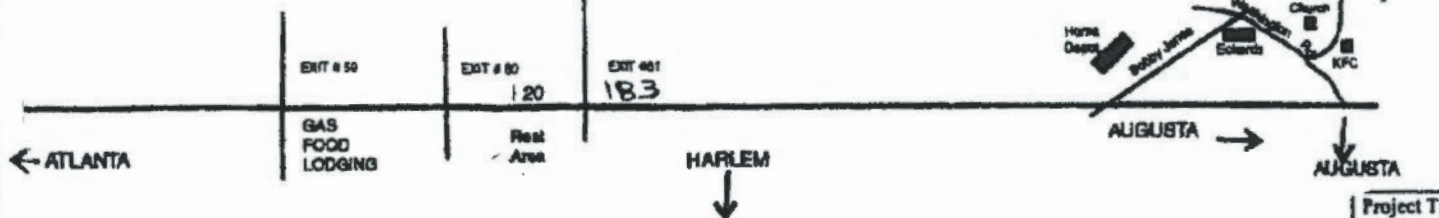

Project Title:

Seawalls and Docks

Project Location:

Plum Branch Yacht Club

Applicant:

Dr. George C. Selfridge, Jr.

Revisions

Date Initials

Date: 8/28/20

Scale:

Application #

Sheet of



Seawall's 2020
Dock C & Pavilion Courtesy Dock

Typical Gravity Seawall

 $\phi = 28^\circ$ | SILTY SAND or CLAYEY SAND**LOAD CONDITION A** | NO LIVE LOAD SURCHARGE, NO BACK SLOPE, NO TOE SLOPE**13.5-FOOT (4.11 m) HIGH SECTION**

- (3) 28" (710 mm) Blocks
- (2) 41" (1030 mm) Blocks
- (2) 72" (1830 mm) XL Blocks

PRELIMINARY
Professional Engineering Design
Required for Construction

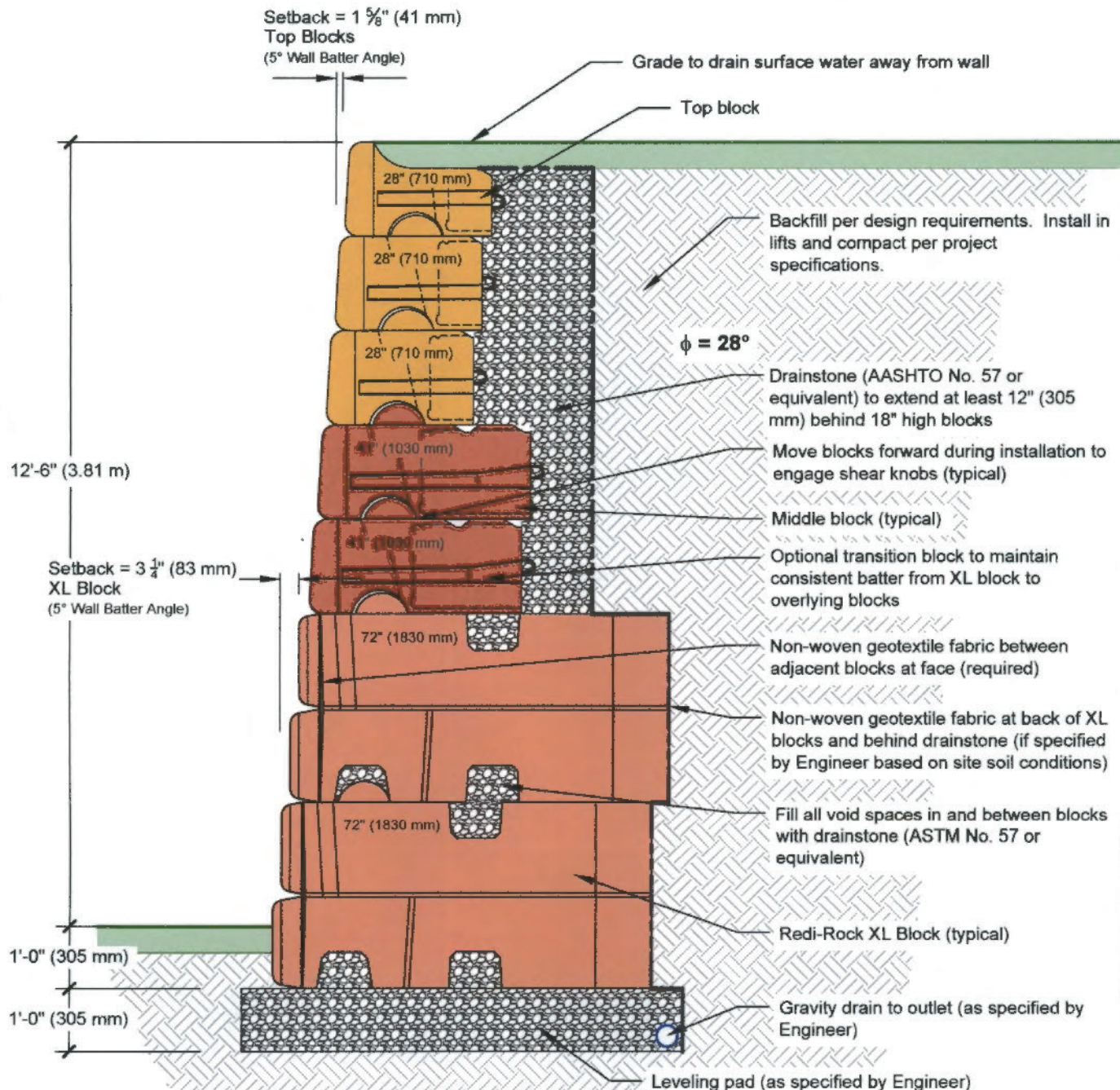

This drawing is for reference only. Determination of the suitability and/or manner of use of any details contained in this document is the sole responsibility of the design engineer of record. Final project designs, including all construction details, shall be prepared by a licensed professional engineer using the actual conditions of the proposed site. Final wall design must address both internal and external drainage and all modes of wall stability.

DRAWN BY: N. Lindwall

APPROVED BY: J. Johnson

DATE: May 7, 2019

SHEET: 1 of 1

TITLE:

Preliminary Wall Section

Silty Sand or Clayey Sand, $\phi = 28^\circ$
No Live Load Surcharge, No Back Slope, No Toe Slope

FILE: A_28_XL_162_cad.dwg

REDI-ROCK

05481 US 31 SOUTH, CHARLEVOIX, MI 49720
(866) 222-8400 ext 3010 • engineering@redi-rock.com
www.redi-rock.com

Dock C

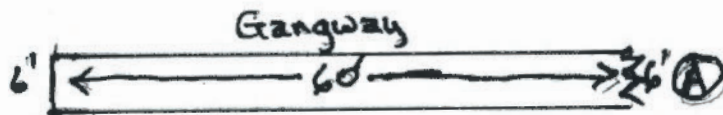
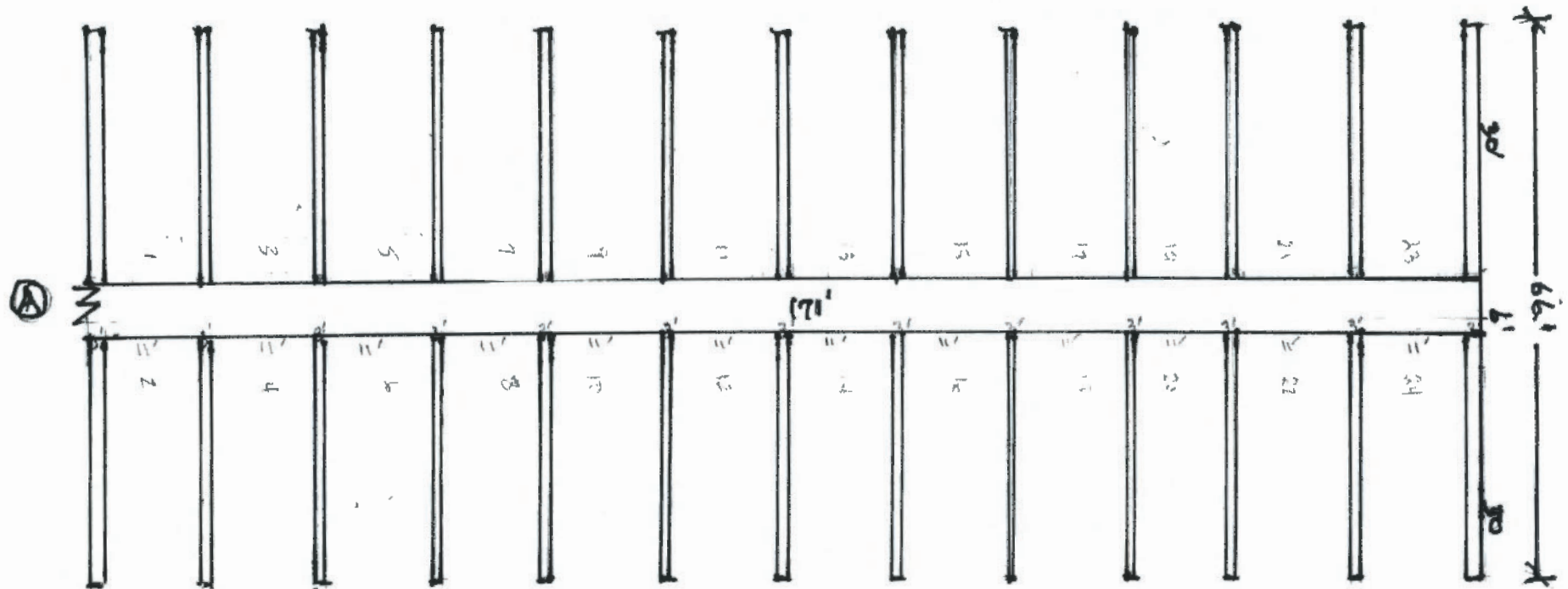

Legend:

Revisions	
Date	Initials

Project Title:	
Project Location: Plum Branch Yacht Club	
Applicant: Plum Branch Yacht Club, Inc.	
Date:	Scale: 1" = 20'
Application #:	Sheet of

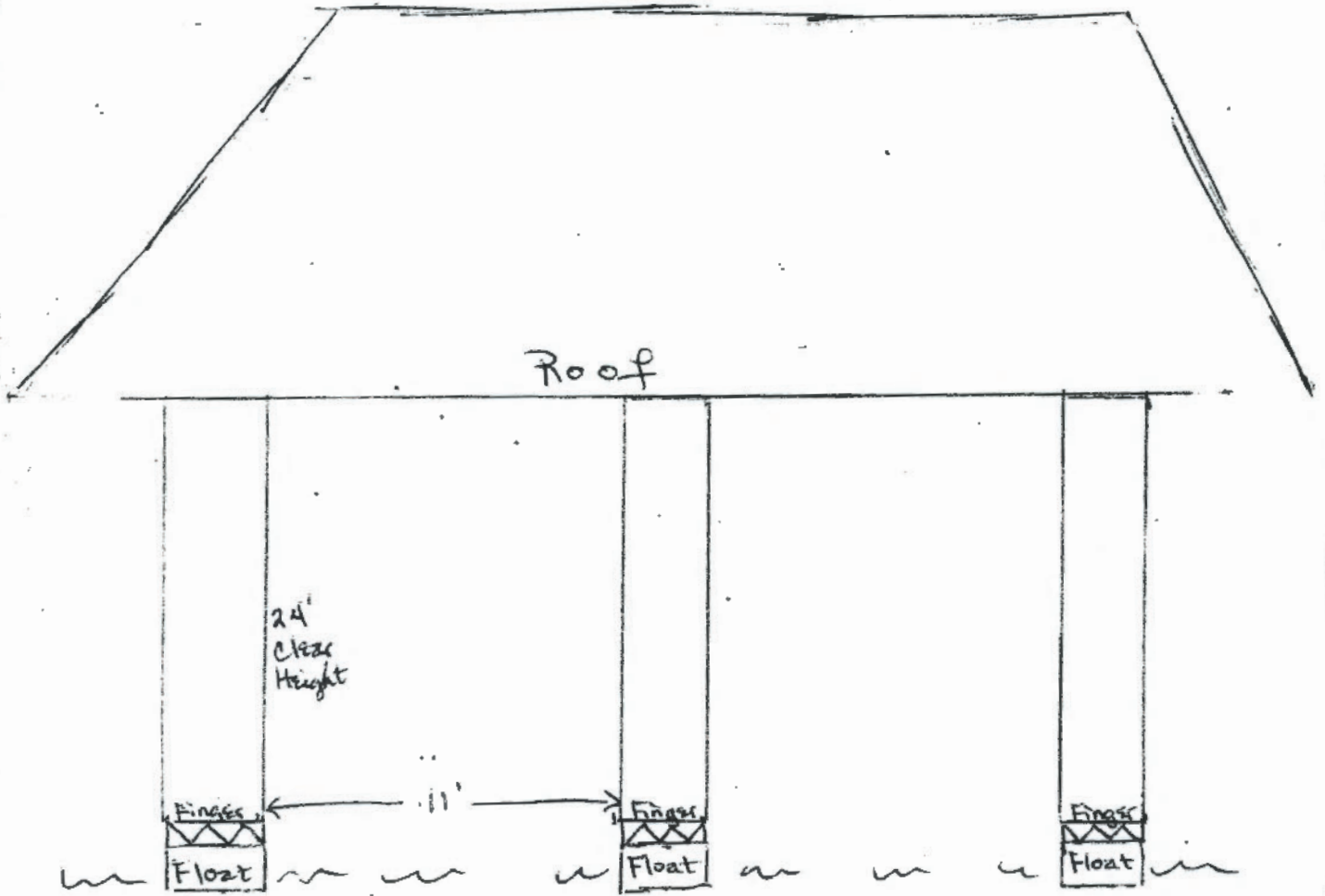

Cross Section

Project Title:		Roof of Dock C	
Project Location:		Plum Branch Yacht Club	
Applicant:		Plum Branch Yacht Club, Inc.	
Date:		Scale:	
Application #		Sheet of	

Revisions	
Date	Initials

Pavilion Courtesy Dock

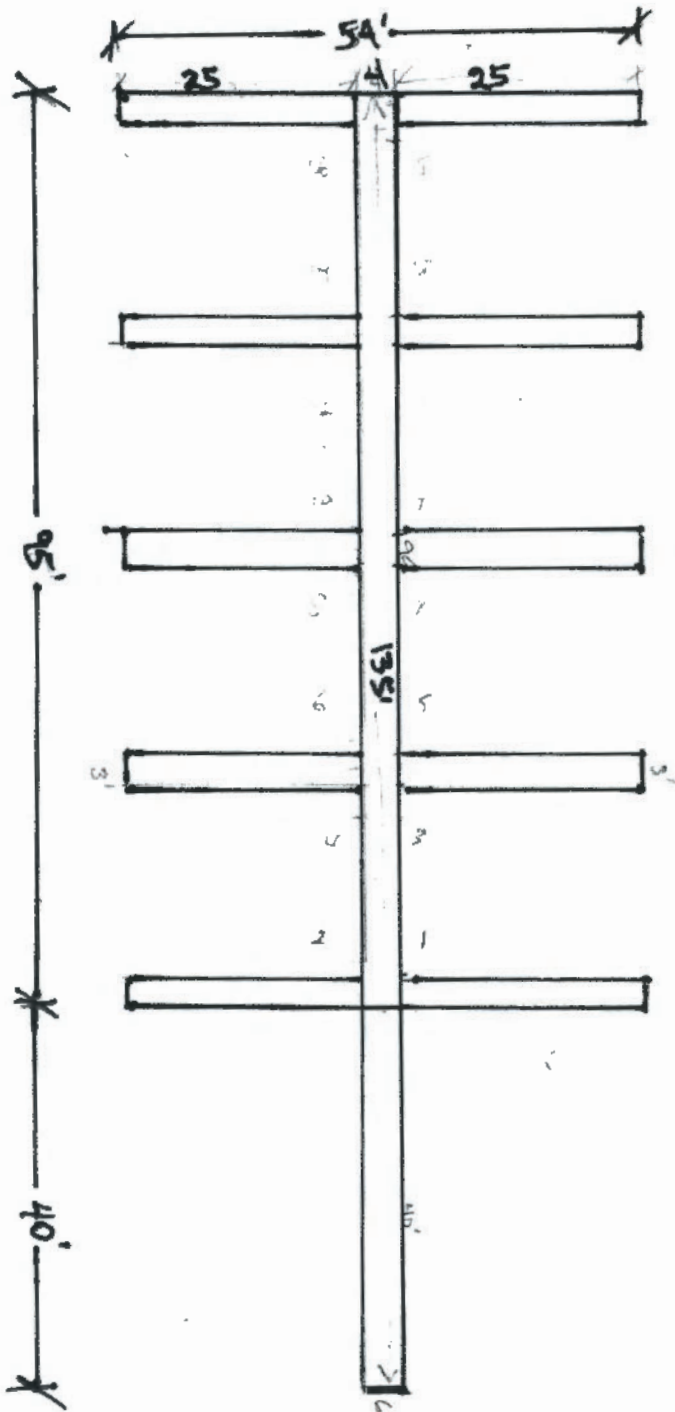

Legend:
 X = 20'

Project Title:	
Project Location:	
Applicant:	
Pum Branch Yacht Club, Inc.	
Date:	Scale: 1" = 20'
Application #:	Sheet of