

SHEET REFERENCE NUMBER
 C011
 Page of

Calabash Creek Channel
 The information depicted on this map represents the results of surveys made on the dates indicated and can only be considered as indicating the general conditions existing at that time.
 Concluded on: **24 JAN 2023**
 Calabash, North Carolina

U.S. ARMY ENGINEER DISTRICT CORPS OF ENGINEERS CHARLESTON, SOUTH CAROLINA SPATIAL DATA BRANCH 69A HAGOOD AVE. CHARLESTON, SC 29403 CESAC-GIS@USACE.ARMY.MIL	Designed By: eHydro Software v3.82 Reviewed By: CCW Reference Scale: 1 inch = 407 feet Projection: NAD 1983 StatePlane South Carolina FIPS 3900 Feet	Survey Date: 24 JAN 2023 Project Reference Number: CESAC-PRA-0007 Survey Type: CONDITION	Production Date: 22 FEB 2023
---	---	--	--

Shoalest Sounding

Sounding
 Sounding may cover several point areas and is calculated per reach quarter area
 "+ " indicates sounding above MLLW

USCG Beacon

Green
 Red
 White

USCG Buoy

Green
 Red
 Coast Guard Racon

USCG Light

White
 Yellow

Depth in feet

0-2
 2 to 4
 4 to 6
 6 to 7
 Greater Than 7

0 250 500 1,000 Feet

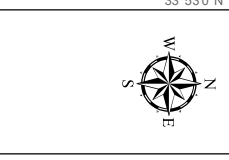

Production Notes:

- The information depicted on this product is for plotting purposes only
- Vector hydrographic data derived from surveys conducted by the USACE and approved partners
- Soundings are in feet and refer to Mean Lower Low Water (MLLW)
- Raster Background: NAD imagery dated 2013

In no event shall the U.S. Army Corps of Engineers, Charleston District Office, Spatial Data Branch be liable for direct, indirect, incidental, consequential or special damages of any kind, including, but not limited to, loss of anticipated profits or benefits arising out of use of or reliance on the data.

These data sets have been developed from the best available sources. Although efforts have been made to ensure that the database are accurate and reliable, errors and variable conditions originating from physical sources used to develop the data may be reflected in the data supplied.

This product is not intended to be used for navigation.
 Mariners are encouraged to use all prudent safety measures.

