

**JOINT**  
**PUBLIC NOTICE**

CHARLESTON DISTRICT, CORPS OF ENGINEERS  
1949 INDUSTRIAL PARK ROAD, ROOM 140  
CONWAY, SC 29526  
and  
S.C. DEPARTMENT OF HEALTH AND ENVIRONMENTAL CONTROL  
OFFICE OF OCEAN AND COASTAL RESOURCE MANAGEMENT  
1362 McMillan Avenue, Suite 400  
Charleston, South Carolina, 29405

**REGULATORY DIVISION**

Refer to: P/N # 2012-00838-3IY

August 17, 2012

Pursuant to Section 10 of the Rivers and Harbors Act of 1899 (33 U.S.C. 403), Sections 401 and 404 of the Clean Water Act (33 U.S.C. 1344), and the South Carolina Coastal Zone Management Act (48-39-10 et.seq.) an application has been submitted to the Department of the Army and the S.C. Department of Health and Environmental Control by

**Robert Attaway**  
**c/o Beam & Associates**  
**Dr. H. Wayne Beam**  
**PO Box 3238**  
**North Myrtle Beach, SC 29582**

for a permit to construct additions to an existing private use recreational dock and to perform associated dredging in the

**Atlantic Intracoastal Waterway**

located  
southeast of and adjacent to the terminus of Waterway Crossing Court,  
North Myrtle Beach, Horry County, South Carolina  
(Latitude: 33.85111; Longitude: -78.65857).

In order to give all interested parties an opportunity to express their views

**NOTICE**

is hereby given that written statements regarding the proposed work will be received by the **Corps** until

**15 Days from the Date of this Notice,**

and **SCDHEC** will receive written statements regarding the proposed work until

**30 Days from the Date of this Notice**

from those interested in the activity and whose interests may be affected by the proposed work.

The proposed work consists of the construction of multiple private use recreational docks, a jet ski lift, a boat lift, and the installation of rip rap. Specifically, the first structure labeled as "Dock A", consists of a 15' x 40' pierhead with a 15' x 24' covered portion to be constructed in the AIWW and attached to an existing bulkhead by a 4' x 16' walkway. The second structure labeled as "Dock B", positioned adjacent to the AIWW, will consist of a 14' x 17' covered pierhead attached to an existing bulkhead by a 4' x 42' walkway. A u shaped

8' x 28' float with two 5' x 30' finger docks will be attached to the south side proposed walkway by a 3' x 18' self adjusting ramp. A 6' x 16' floating dock and adjacent to a 12' x 20' boat lift positioned north of the walkway will be attached by a 3' x 18' self adjusting A covered 5' x 10' wide double jet ski lift will also be attached north of the walkway. Finally, the applicant is proposing to install 350 cubic yards (0.06 acres) of rip rap along the toe of the existing bulkhead for bank stabilization. The purpose of the proposed work, as stated by the applicant, is for enhance the enjoyment of residing on the AIWW, the enhancement of boating access to coastal waters, and toe protection for an existing bulkhead. The applicant offered no mitigation for the proposed work.

NOTE: Plans depicting the work described in this notice are available and will be provided, upon receipt of a written request, to anyone that is interested in obtaining a copy of the plans for the specific project. The request must identify the project of interest by public notice number and a self-addressed stamped envelope must also be provided for mailing the drawings to you. Your request for drawings should be addressed to the

**U.S. Army Corps of Engineers  
ATTN: REGULATORY DIVISION  
1949 INDUSTRIAL PARK ROAD  
ROOM 140  
CONWAY, SOUTH CAROLINA 29526**

The District Engineer has concluded that the discharges associated with this project, both direct and indirect, should be reviewed by the South Carolina Department of Health and Environmental Control in accordance with provisions of Section 401 of the Clean Water Act. As such, this notice constitutes a request, on behalf of the applicant, for certification that this project will comply with applicable effluent limitations and water quality standards. The work shown on this application must also be certified as consistent with applicable provisions of the Coastal Zone Management Program (15 CFR 930). The District Engineer will not process this application to a conclusion until such certifications are received. This activity may also require evaluation for compliance with the S.C. Construction in Navigable Waters Permit Program. State review, permitting and certification is conducted by the S.C. Department of Health and Environmental Control. The applicant is hereby advised that supplemental information may be required by the State to facilitate the review. Persons wishing to comment or object to State certification or the navigable waters permit must submit all comments in writing to the S.C. Department of Health and Environmental Control at the above address within thirty (30) days of the date of this notice.

This notice initiates the Essential Fish Habitat (EFH) consultation requirements of the Magnuson-Stevens Fishery Conservation and Management Act. Implementation of the proposed project would impact (0.36) acres of estuarine substrates and emergent wetlands utilized by various life stages of species comprising the red drum, shrimp, and snapper-grouper management complexes. Our initial determination is that the proposed action would not have a substantial individual or cumulative adverse impact on EFH or fisheries managed by the South Atlantic Fishery Management Council and the National Marine Fisheries Service (NMFS). Our final determination relative to project impacts and the need for mitigation measures is subject to review by and coordination with the NMFS.

The District Engineer has consulted the most recently available information and has determined that the project is not likely to adversely affect any Federally endangered, threatened, or proposed species and will not result in the destruction or adverse modification of designated or proposed critical habitat. This public notice serves as a request to the U.S. Fish and Wildlife Service and the National Marine Fisheries Service for any additional information they may have on whether any listed or proposed endangered or threatened species or designated or proposed critical habitat may be present in the area which would be affected by the activity, pursuant to Section 7(c) of the Endangered Species Act of 1973 (as amended).

Pursuant to Section 106 of the National Historic Preservation Act (NHPA), this public notice also constitutes a request to Indian Tribes to notify the District Engineer of any historic properties of religious and cultural significance to them that may be affected by the proposed undertaking.

In accordance with the NHPA, the District Engineer has also consulted the latest published version of the National Register of Historic Places for the presence or absence of registered properties, or properties listed as being eligible for inclusion therein, and this worksite is not included as a registered property or property listed as being eligible for inclusion in the Register. To insure that other cultural resources that the District Engineer is not aware of are not overlooked, this public notice also serves as a request to the State Historic Preservation Office to provide any information it may have with regard to historic and cultural resources.

Any person may request, in writing, within the comment period specified in this notice, that a public hearing be held to consider this application. Requests for a public hearing shall state, with particularity, the reasons for holding a public hearing.

The decision whether to issue a permit will be based on an evaluation of the probable impact including cumulative impacts of the activity on the public interest and will include application of the guidelines promulgated by the Administrator, Environmental Protection Agency (EPA), under authority of Section 404(b) of the Clean Water Act and, as appropriate, the criteria established under authority of Section 102 of the Marine Protection, Research and Sanctuaries Act of 1972, as amended. That decision will reflect the national concern for both protection and utilization of important resources. The benefit which reasonably may be expected to accrue from the project must be balanced against its reasonably foreseeable detriments. All factors which may be relevant to the project will be considered including the cumulative effects thereof; among those are conservation, economics, aesthetics, general environmental concerns, wetlands, historic properties, fish and wildlife values, flood hazards, flood plain values, land use, navigation, shoreline erosion and accretion, recreation, water supply and conservation, water quality, energy needs, safety, food and fiber production and, in general, the needs and welfare of the people. A permit will be granted unless the District Engineer determines that it would be contrary to the public interest. In cases of conflicting property rights, the Corps of Engineers cannot undertake to adjudicate rival claims.

The Corps of Engineers is soliciting comments from the public; Federal, state, and local agencies and officials; Indian Tribes; and other interested parties in order to consider and evaluate the impacts of this activity. Any comments received will be considered by the Corps of Engineers to determine whether to issue, modify, condition or deny a permit for this project. To make this decision, comments are used to assess impacts on endangered species, historic properties, water quality, general environmental effects, and the other public interest factors listed above. Comments are used in the preparation of an Environmental Assessment and/or an Environmental Impact Statement pursuant to the National Environmental Policy Act. Comments are also used to determine the need for a public hearing and to determine the overall public interest of the activity.

If there are any questions concerning this public notice, please contact T. Brian Hardee at 843-365-0848.

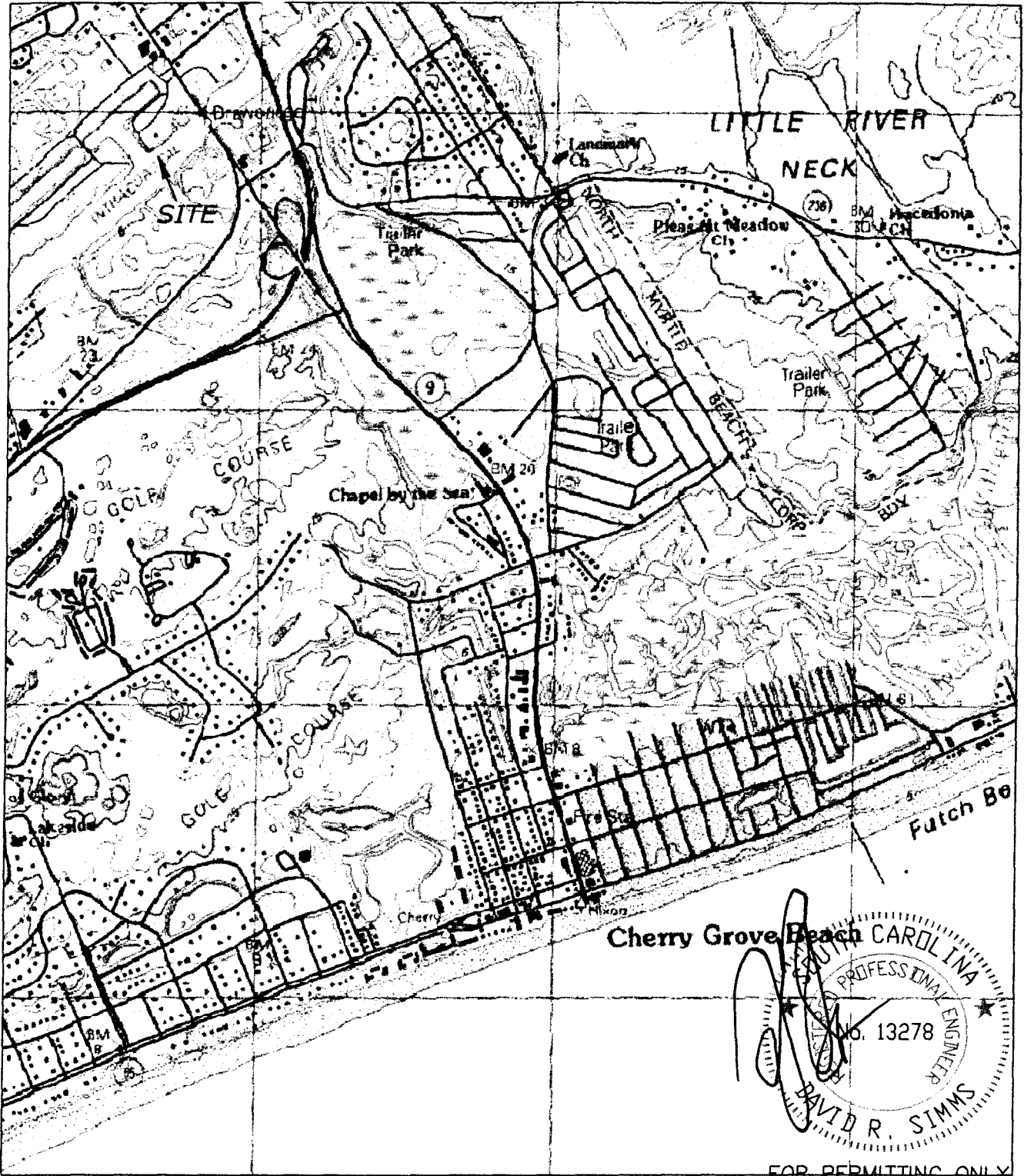

LOCATION MAP

FOR PERMITTING ONLY  
NOT FOR CONSTRUCTION

LITTLE RIVER QUAD

APPLICANT: **Robert Attaway**

ACTIVITY: Construct Walkways,  
Pier Heads, Floating Docks  
& Boat Lifts

P/N#

LOCATION:

Intracoastal Waterway  
North Myrtle Beach

COUNTY: Horry

DATE: 7/20/2012

SHEET 1 OF 10

TMS 130-25-01-311  
 PIN No. 35004040028  
 Current Owner:  
 Plantation Harbour HOA Inc.  
 Deed Book 1761, page 119

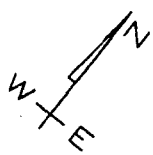

CHANNEL

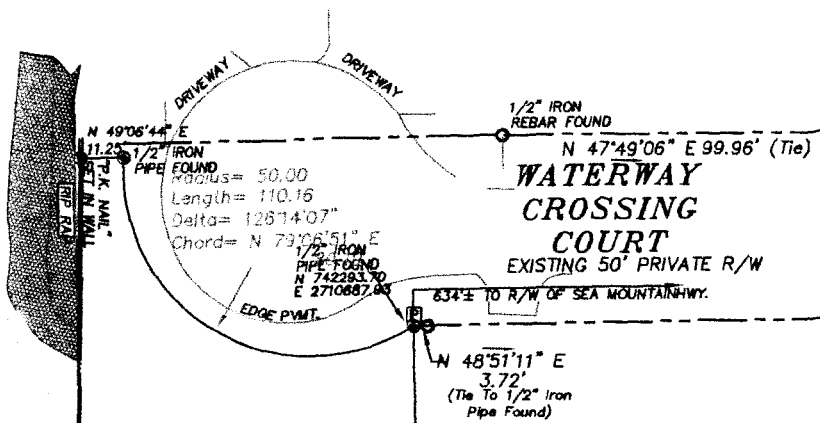

1/2" IRON REBAR FOUND  
 N 47°49'06" E 99.96' (Tie)  
**WATERWAY CROSSING COURT**  
 EXISTING 50' PRIVATE R/W  
 634'± TO R/W OF SEA MOUNTAIN HWY.

TMS 130-25-01-158  
 PIN No. 35004040029  
 Current Owner:  
 Robert Attaway  
 Deed Book 3511, Page 1938  
 12,118 sq.ft.  
 0.39 acres  
**TOTAL COMBINED**  
 21,246 sq.ft.  
 0.49 acres

TMS 130-25-01-178  
 PIN No. 3500404003  
 Current Owner:  
 Donald B. & Janice B. Haims  
 Deed Book 2347, Page 1100  
 Plat Book 165, Page 158

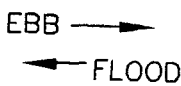
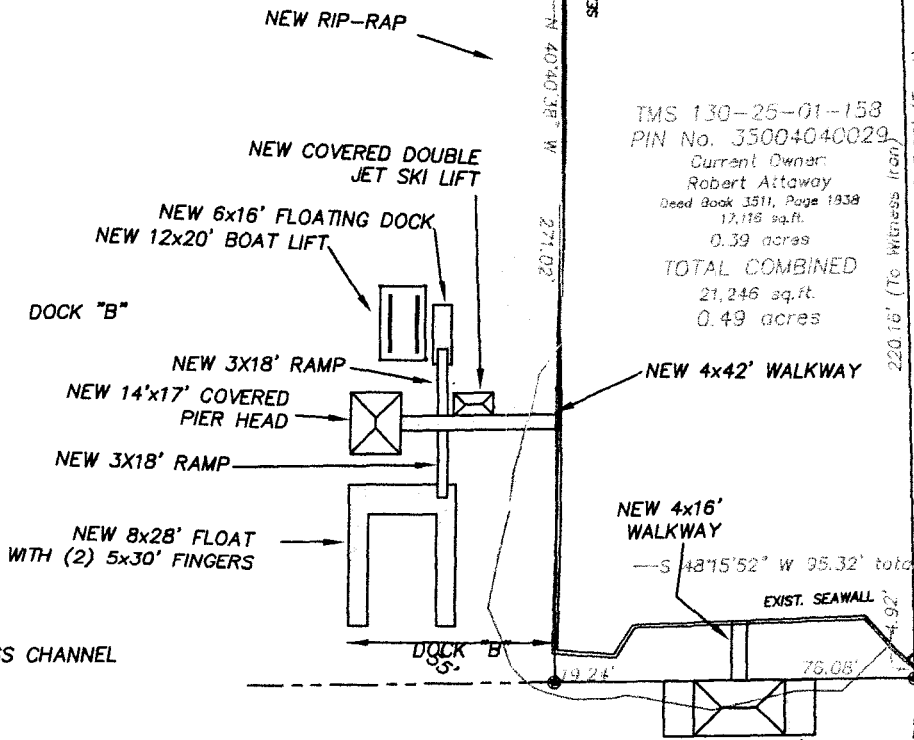

SITE PLAN

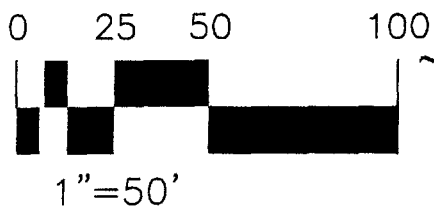

TO MIAMI 320' R/W TO MAINE

ATLANTIC INTRACOASTAL WATERWAY

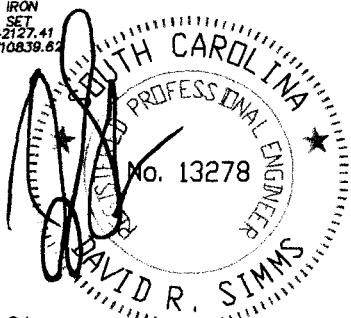

FOR PERMITTING ONLY  
 NOT FOR CONSTRUCTION

<p>APPLICANT: <b>Robert Attaway</b></p> <p>ACTIVITY: Construct Walkways, Pier Heads, Floating Docks &amp; Boat Lifts</p> <p>P/N#</p>	<p>LOCATION:        Intracoastal Waterway        North Myrtle Beach</p> <p>COUNTY: <b>Horry</b></p> <p>DATE: <b>7/20/2012</b></p>	<p>SHEET 2 OF 10</p>
--	---	----------------------

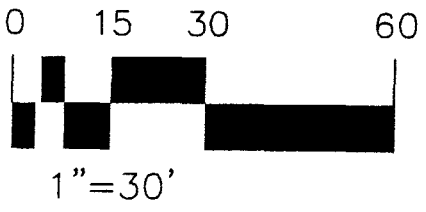
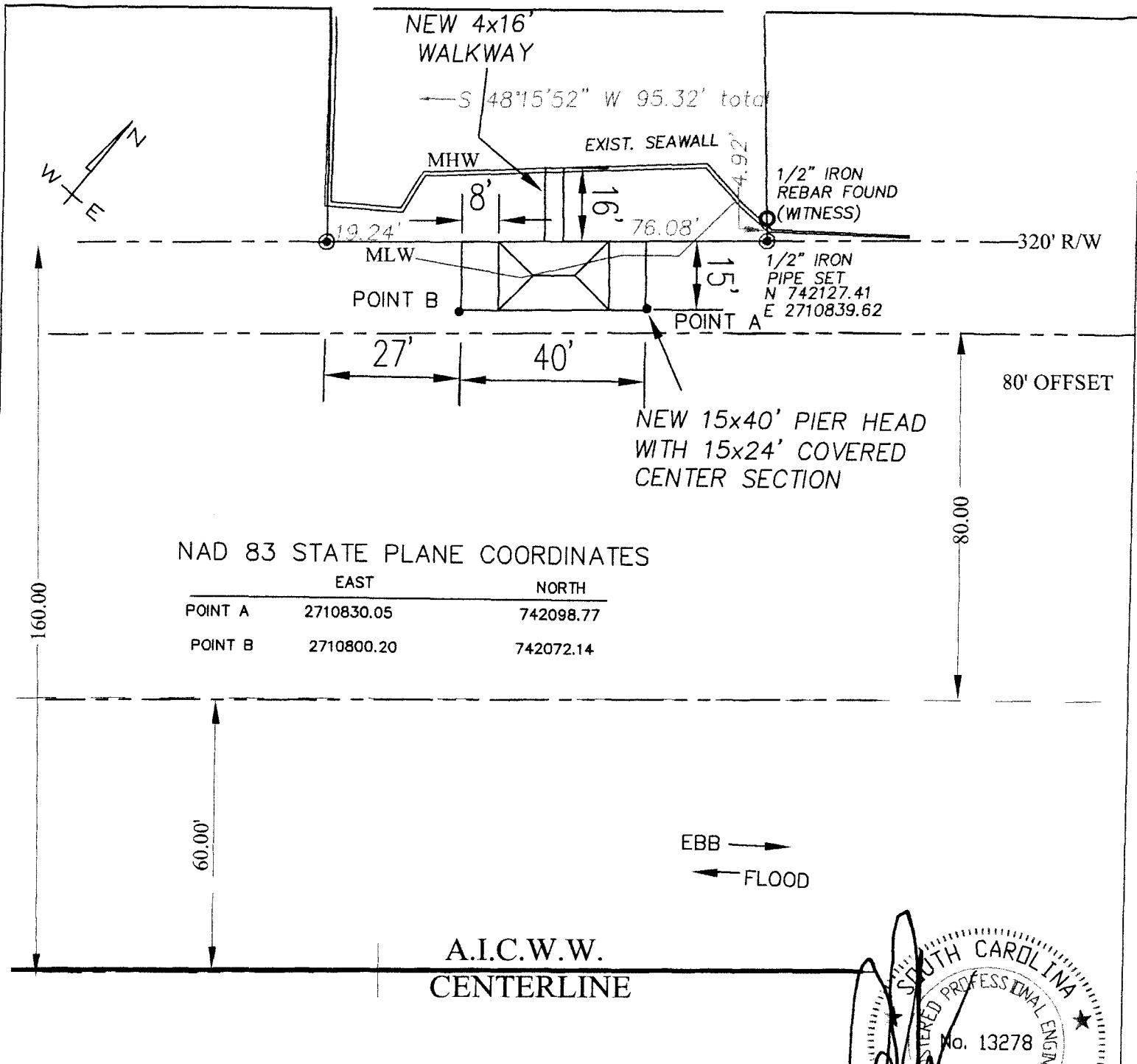

DOCK "A" DETAIL SITE PLAN

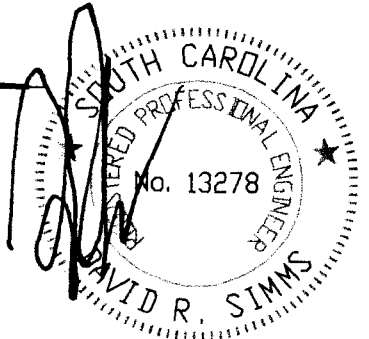

FOR PERMITTING ONLY  
 NOT FOR CONSTRUCTION

APPLICANT: <b>Robert Attaway</b> ACTIVITY: Construct Walkways, Pier Heads, Floating Docks & Boat Lifts P/N#	LOCATION: Intracoastal Waterway North Myrtle Beach COUNTY: <b>Horry</b> DATE: <b>7/20/2012</b>	SHEET 3 OF 10
---	--	---------------

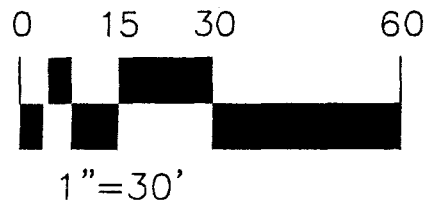
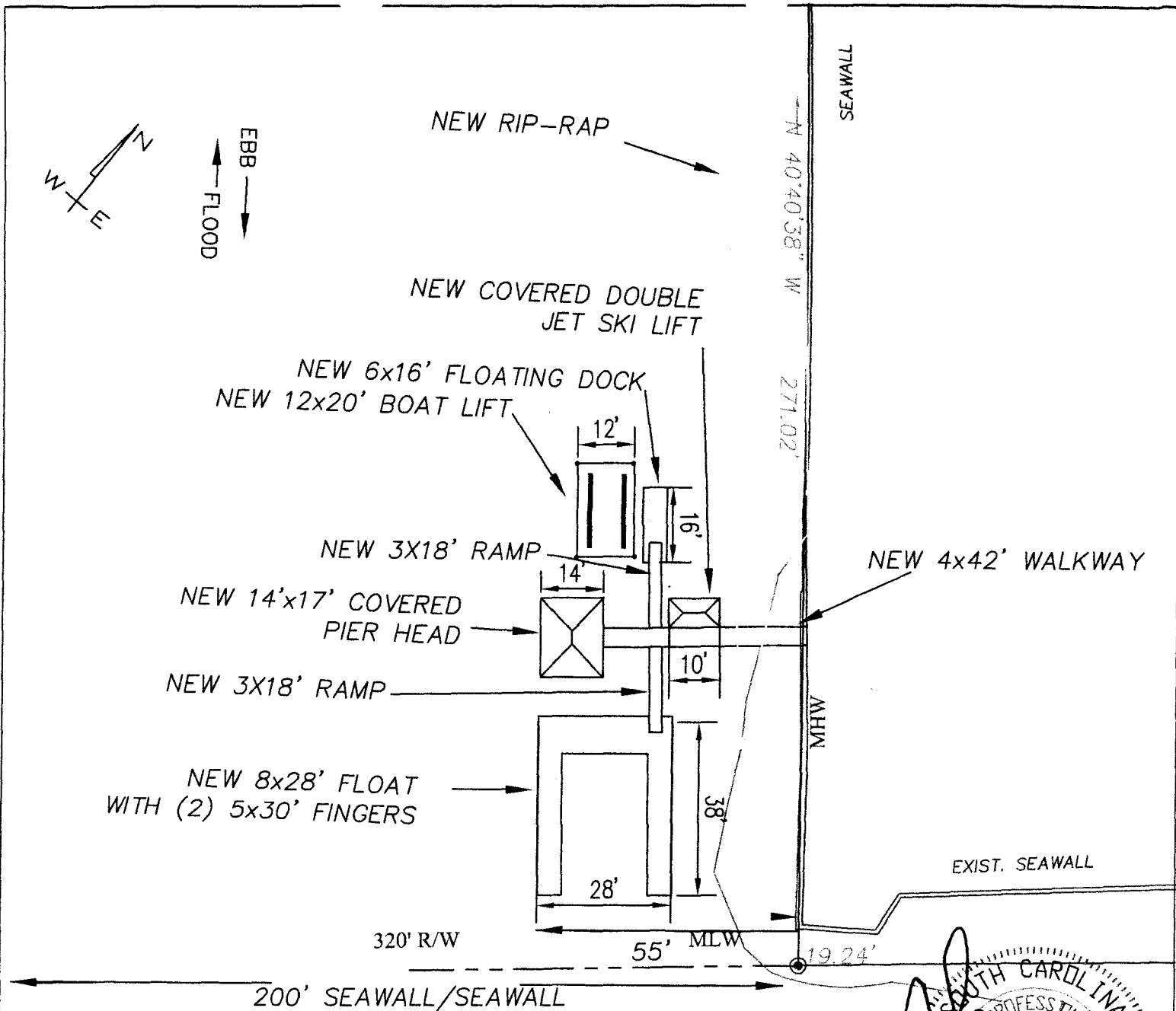

DOCK "B" DETAIL SITE PLAN

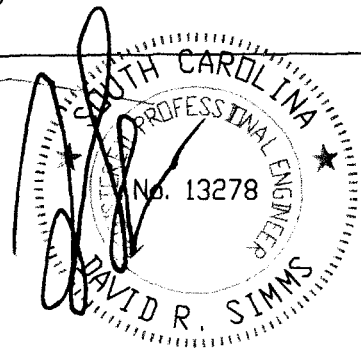

FOR PERMITTING ONLY  
NOT FOR CONSTRUCTION

<p>APPLICANT: <b>Robert Attaway</b></p> <p>ACTIVITY: Construct Walkways, Pier Heads, Floating Docks &amp; Boat Lifts</p> <p>P/N#</p>	<p>LOCATION: Intracoastal Waterway North Myrtle Beach</p> <p>COUNTY: Horry</p> <p>DATE: 7/20/2012</p>	<p>SHEET 4 OF 10</p>
--	---	----------------------

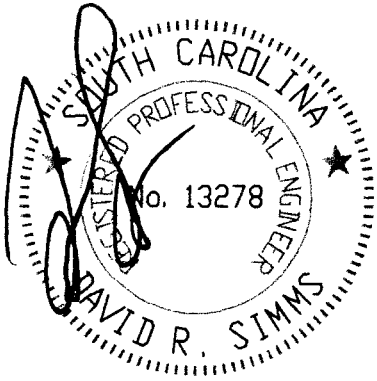

FOR PERMITTING ONLY  
NOT FOR CONSTRUCTION

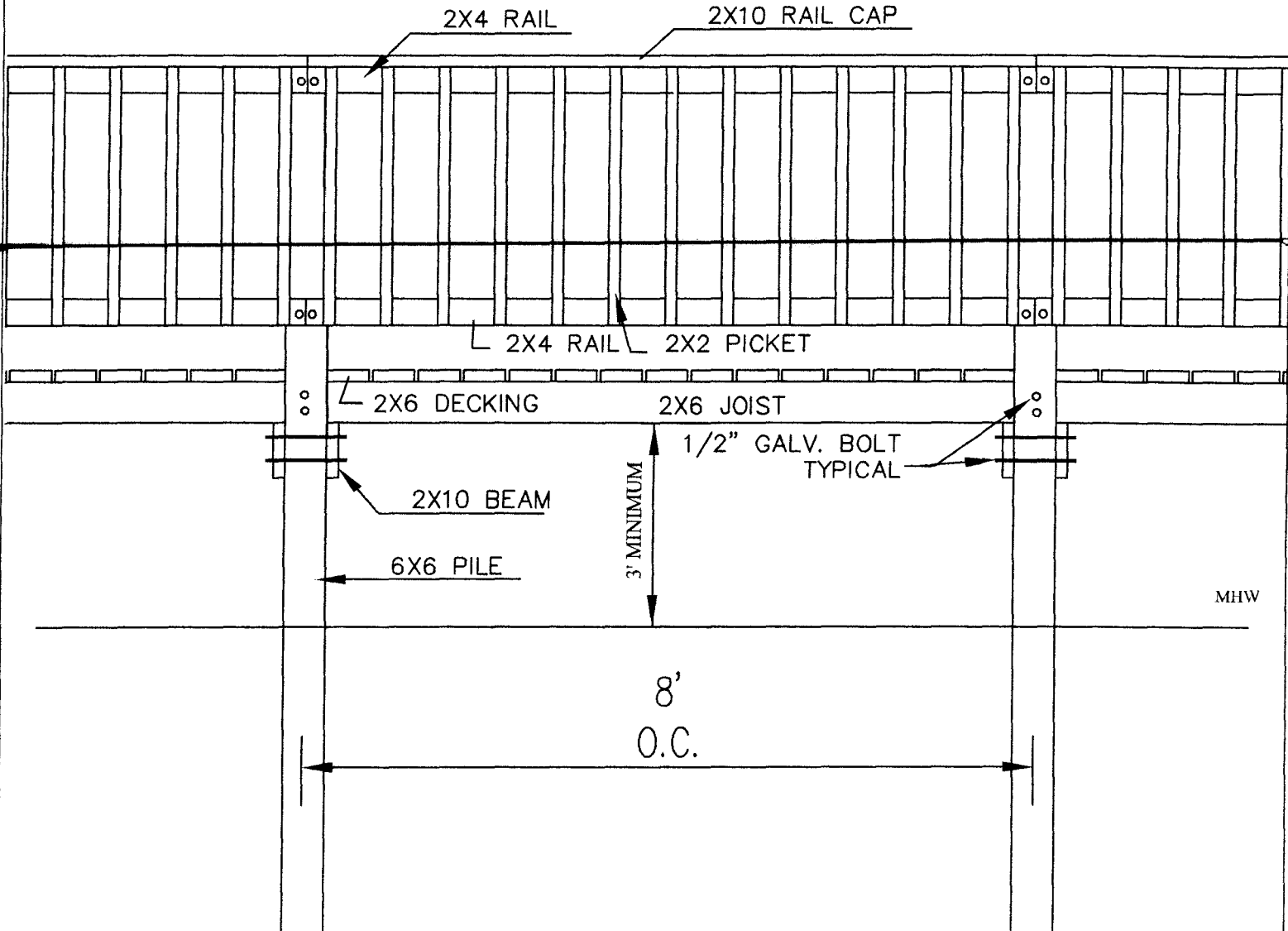

WALKWAY / PIER ELEVATION

NOT TO SCALE

<p>APPLICANT: <b>Robert Attaway</b></p> <p>ACTIVITY: Construct Walkways, Pier Heads, Floating Docks &amp; Boat Lifts</p> <p>P/N#</p>	<p>LOCATION: Intracoastal Waterway North Myrtle Beach</p> <p>COUNTY: Horry</p> <p>DATE: 7/20/2012</p>	<p>SHEET 5 OF 10</p>
--	---	----------------------



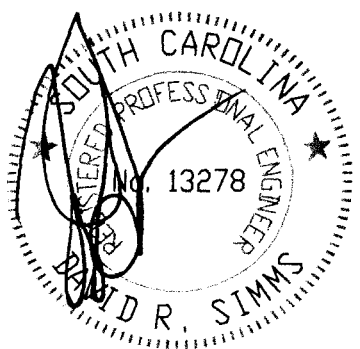
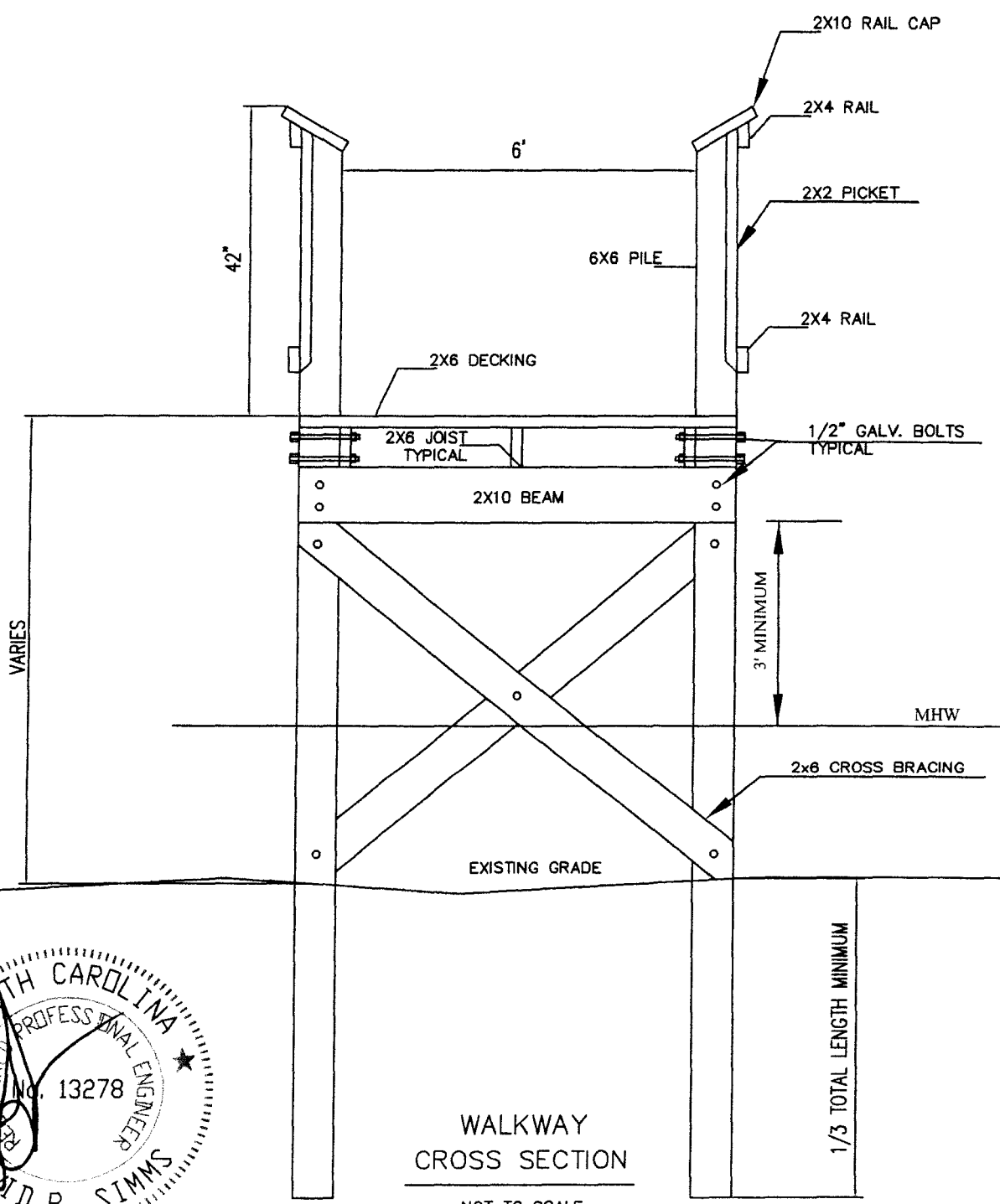

FOR PERMITTING ONLY  
NOT FOR CONSTRUCTION

WALKWAY  
CROSS SECTION  
NOT TO SCALE

<p>APPLICANT: <b>Robert Attaway</b></p> <p>ACTIVITY: Construct Walkways, Pier Heads, Floating Docks &amp; Boat Lifts</p> <p>P/N#</p>	<p>LOCATION: Intracoastal Waterway North Myrtle Beach</p> <p>COUNTY: Horry</p> <p>DATE: 7/20/2012</p>	<p>SHEET 6 OF 10</p>
--	---	----------------------

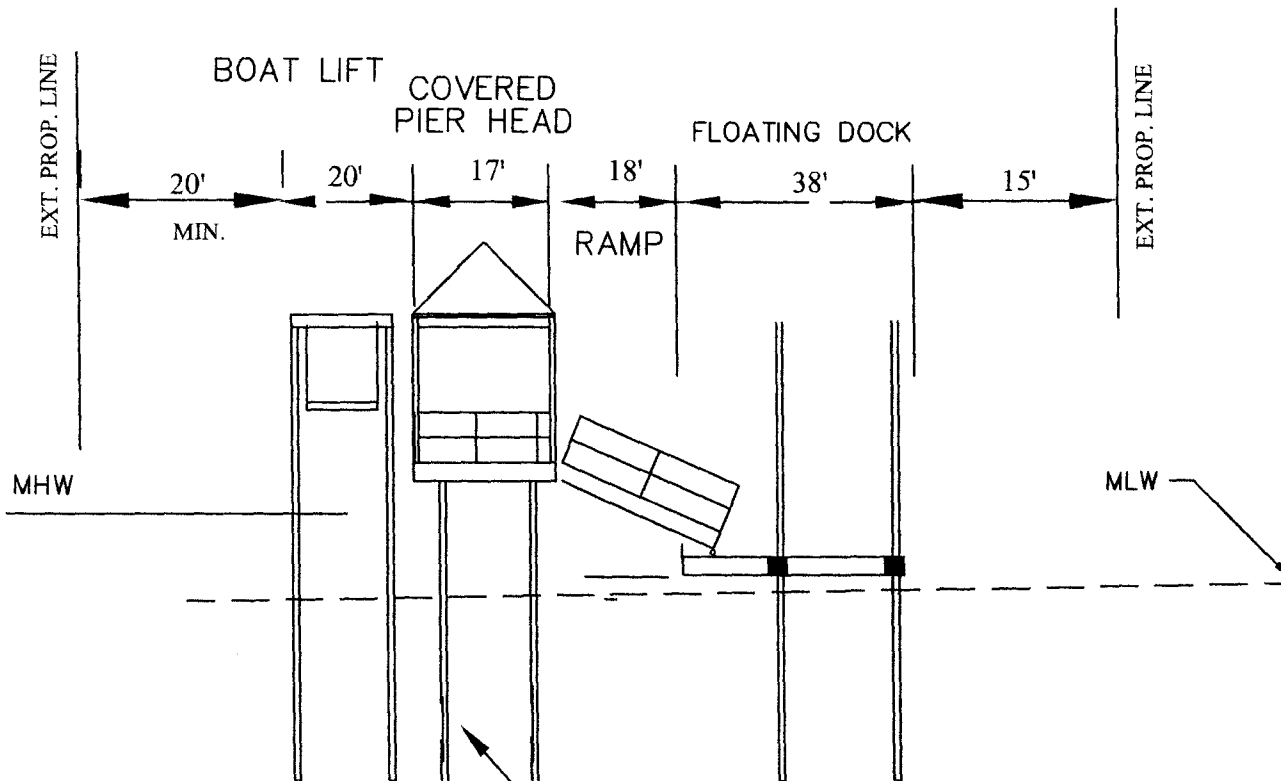

TREATED WOOD PILING (TYP.)

DOCK "B"  
SECTION - FLOATING DOCK/RAMP/PIER HEAD/LIFT

NTS

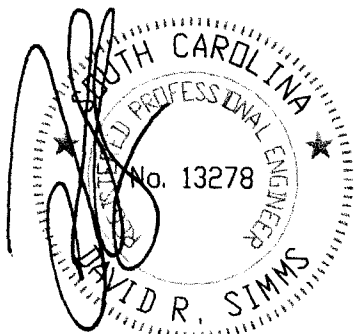

FOR PERMITTING ONLY  
NOT FOR CONSTRUCTION

APPLICANT: **Robert Attaway**

ACTIVITY: Construct Walkways,  
Pier Heads, Floating Docks  
& Boat Lifts

P/N#

LOCATION:

Intracoastal Waterway  
North Myrtle Beach

COUNTY: Horry

DATE: 7/20/2012

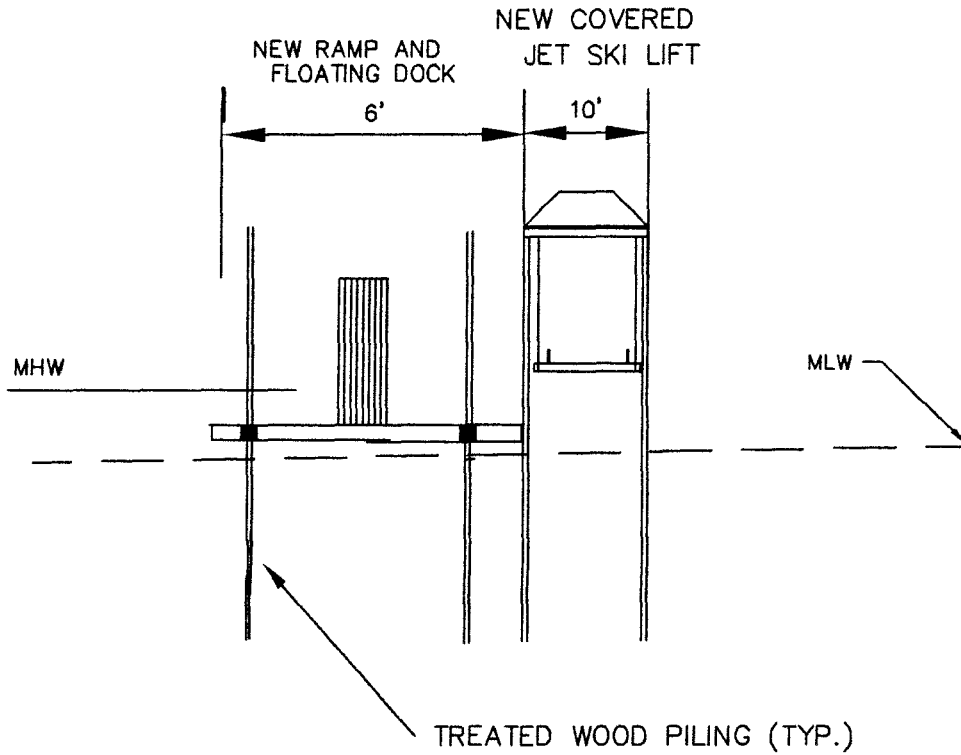

SECTION - FLOATING DOCK/RAMP/JET SKI LIFT

NTS

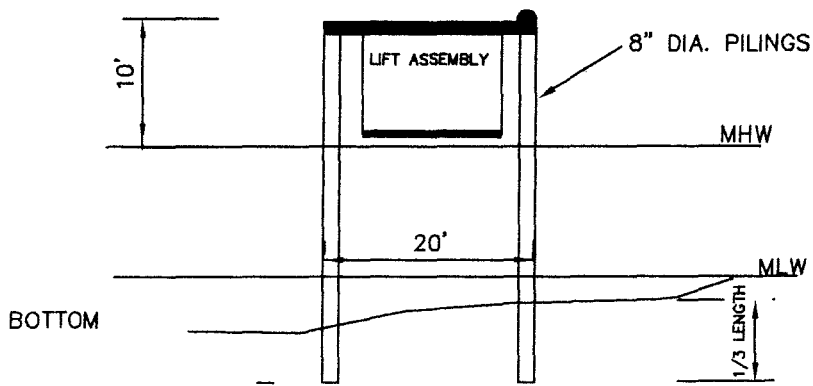

SECTION - BOAT LIFT

NTS

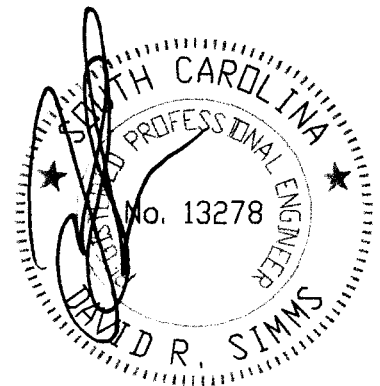

FOR PERMITTING ONLY  
NOT FOR CONSTRUCTION

APPLICANT: **Robert Attaway**

ACTIVITY: Construct Walkways,  
Pier Heads, Floating Docks  
& Boat Lifts

P/N#

LOCATION:

Intracoastal Waterway  
North Myrtle Beach

COUNTY: Horry

DATE: 7/20/2012

SHEET 8 OF 10

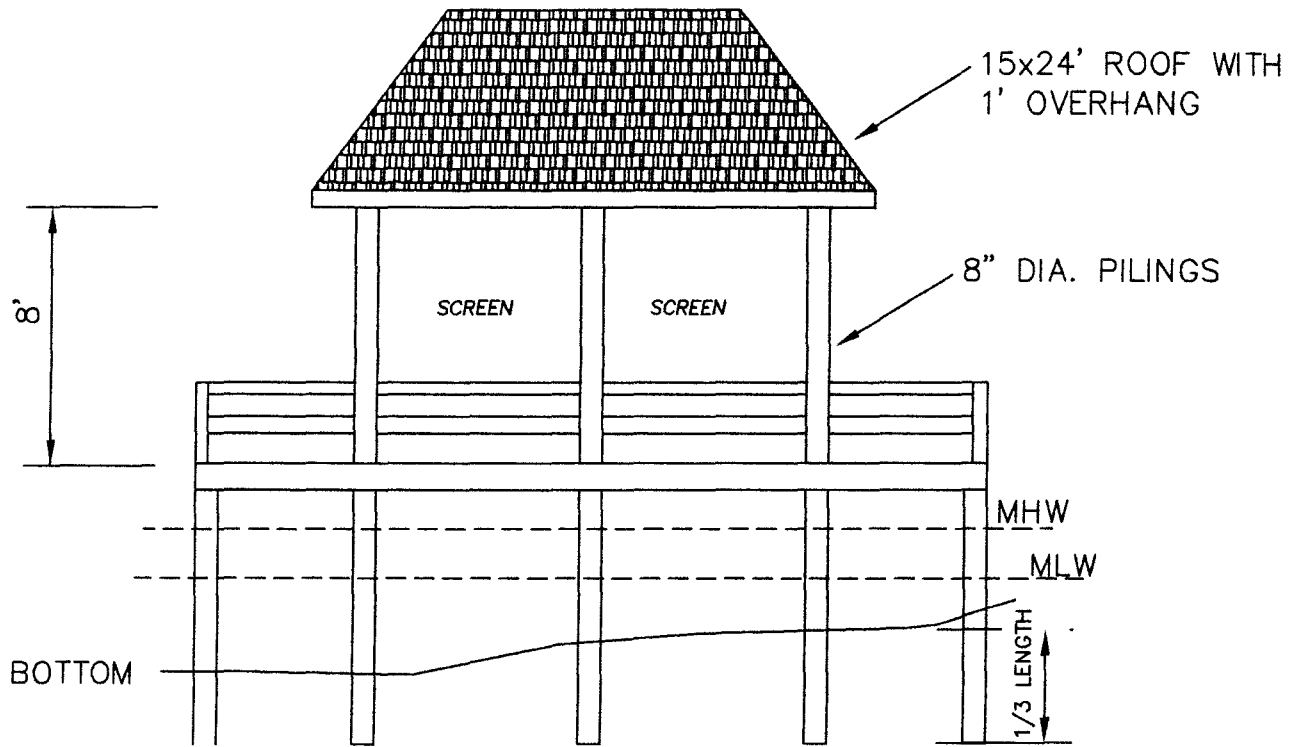

SECTION - DOCK "A"

NTS

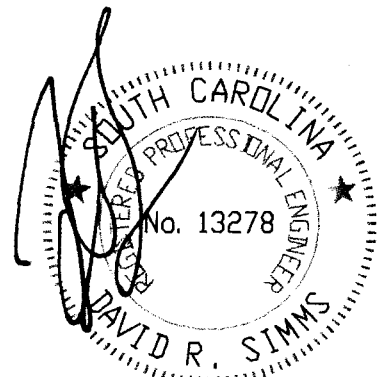

FOR PERMITTING ONLY  
NOT FOR CONSTRUCTION

<p>APPLICANT: <b>Robert Attaway</b></p> <p>ACTIVITY: Construct Walkways, Pier Heads, Floating Docks &amp; Boat Lifts</p> <p>P/N#</p>	<p>LOCATION: Intracoastal Waterway North Myrtle Beach</p> <p>COUNTY: Horry</p> <p>DATE: 7/20/2012</p>	<p>SHEET 9 OF 10</p>
--	---	----------------------

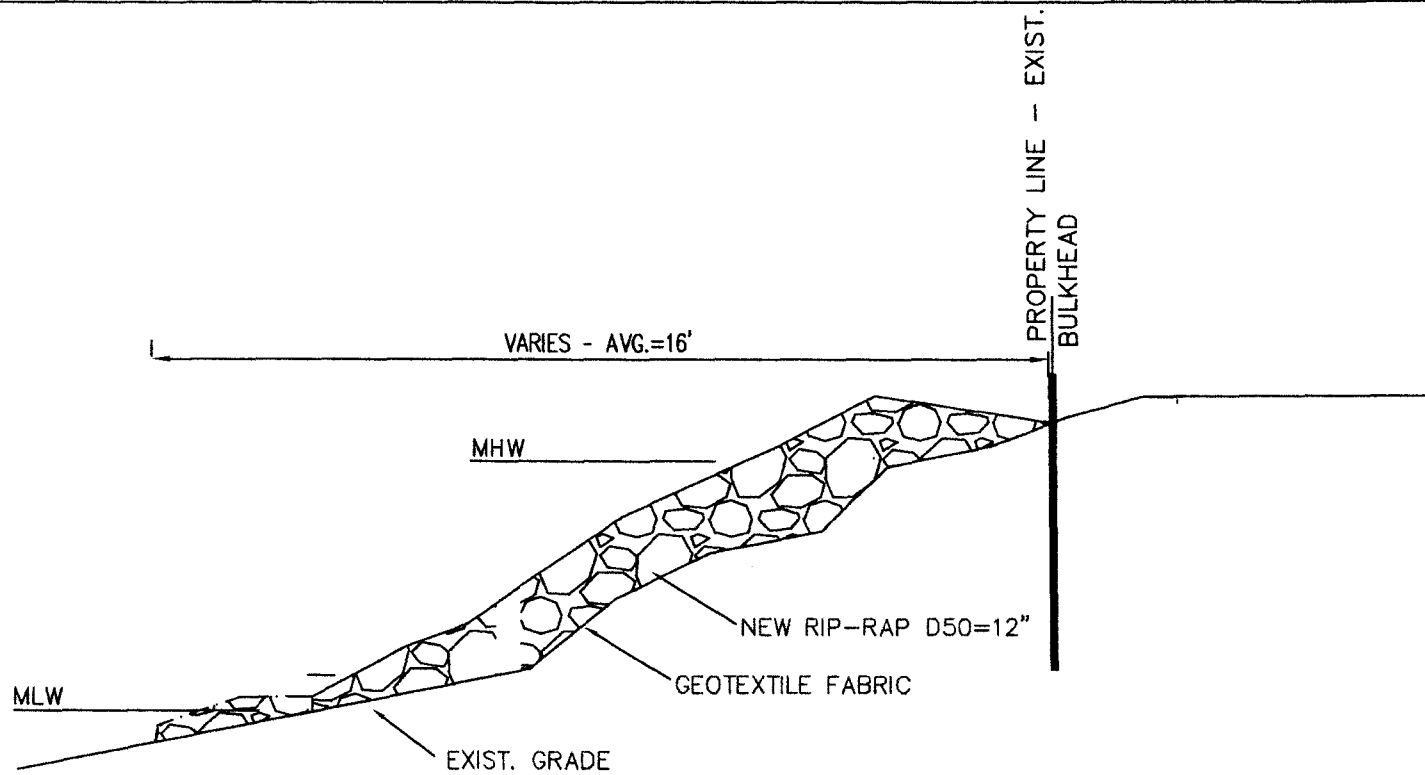

RIP RAP SECTION  
NTS

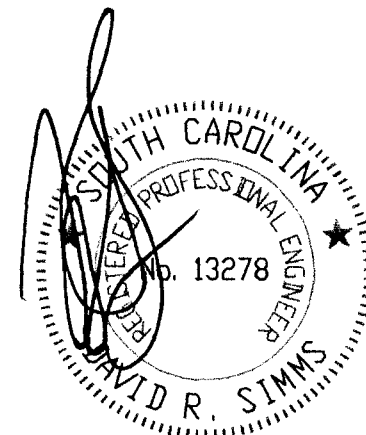

FOR PERMITTING ONLY  
NOT FOR CONSTRUCTION

APPLICANT: **Robert Attaway**

ACTIVITY: Construct Walkways,  
Pier Heads, Floating Docks  
& Boat Lifts

P/N#

LOCATION:

Intracoastal Waterway  
North Myrtle Beach

COUNTY: Horry

DATE: 7/20/2012