

JOINT
PUBLIC NOTICE

CHARLESTON DISTRICT, CORPS OF ENGINEERS
1949 INDUSTRIAL PARK ROAD, ROOM 140
CONWAY, SOUTH CAROLINA 29526

and

THE S.C. DEPARTMENT OF HEALTH AND ENVIRONMENTAL CONTROL
Water Quality Certification and Wetlands Section
2600 Bull Street
Columbia, South Carolina 29201

REGULATORY DIVISION

Refer to: P/N SAC-2017-01908

12 APRIL 2018

Pursuant to Sections 401 and 404 of the Clean Water Act (33 U.S.C. 1344), and the South Carolina Coastal Zone Management Act (48-39-10 et.seq.), an application has been submitted to the Department of the Army and the S.C. Department of Health and Environmental Control by

Horry County Government
c/o S&ME, Inc.
1330 Highway 501 Business
Conway, South Carolina 29526

for a permit to widen the existing two-lane Carolina Forest Boulevard to four-lanes. The proposed work includes the placement of fill material into freshwater wetlands and adjacent tributaries of the

ATLANTIC INTRACOASTAL WATERWAY (AIWW)

at a location within the existing road right-of-way for Carolina Forest Boulevard, starting at the intersection of Carolina Forest Boulevard and Gate Way Avenue and terminating at the intersection of River Oaks Drive, in the Carolina Forest Township, Horry County, South Carolina, (starting: Latitude: 33.759°N, Longitude: -78.943°W, ending: Latitude 33.754°N, Longitude: -78.868°W), Hand Quad.

In order to give all interested parties an opportunity to express their views

NOTICE

is hereby given that written statements regarding the proposed work will be received by the **Corps** until

15 Days from the Date of this Notice,

and **SCDHEC** will receive written statements regarding the proposed work until

30 Days from the Date of this Notice

from those interested in the activity and whose interests may be affected by the proposed work.

The proposed work consists of widening the existing two-lane Carolina Forest Boulevard to

four-lanes for approximately 4.75 miles. In detail, the proposed work will involve the placement of fill material into 2.08 acres freshwater wetlands and 95 linear feet of other waters of the United States (Black Creek). The applicant has proposed to provide compensatory mitigation for the proposed wetland and stream impacts by purchasing the required mitigation credits from an approved mitigation bank. The applicant stated the following in regards to wetland impacts associated with the project: *The proposed impacts to wetlands include the placement of fill material in five fully functional wetland areas totaling 2.08 acres. Utilizing the USACE Compensatory Mitigation Calculation Worksheets, the proposed wetland impacts will require 21.8 mitigation credits. The credit purchase will include 10.9 restoration / enhancement credits and 10.9 preservation credits.* In regards to stream impacts associated with the project, the applicant stated the following: *The proposed 95-foot impact to Black Creek (Perennial RPW) consist of the placement of fill material in order to extend the existing box culverts to accommodate the widening associated with the proposed project. The tributary has been previously culverted at this location for the existing paved, two-lane public road. This low gradient tributary has undergone extensive channel alterations over the years. This tributary has been channelized for a long distance with deep straight banks. The tributary is considered to be "impaired" in accordance with the Charleston District Mitigation SOP. Utilizing the USACE Compensatory Mitigation Calculation Worksheets, the proposed 95-foot stream impact will require 161.5 mitigation credits. The credit purchase will include 80.8 restoration credits and 80.7 preservation credits.* The project purpose is to relieve traffic congestion along Carolina Forest Boulevard.

NOTE: This public notice and associated plans are available on the Corps' website at: <http://www.sac.usace.army.mil/Missions/Regulatory/PublicNotices> .

The District Engineer has concluded that the discharges associated with this project, both direct and indirect, should be reviewed by the South Carolina Department of Health and Environmental Control in accordance with provisions of Section 401 of the Clean Water Act. As such, this notice constitutes a request, on behalf of the applicant, for certification that this project will comply with applicable effluent limitations and water quality standards. The work shown on this application must also be certified as consistent with applicable provisions of the Coastal Zone Management Program (15 CFR 930). This activity may also require evaluation for compliance with the S. C. Construction in Navigable Waters Permit Program. State review, permitting and certification is conducted by the S. C. Department of Health and Environmental Control. The District Engineer will not process this application to a conclusion until such certifications are received. The applicant is hereby advised that supplemental information may be required by the State to facilitate the review.

This notice initiates the Essential Fish Habitat (EFH) consultation requirements of the Magnuson-Stevens Fishery Conservation and Management Act. Implementation of the proposed project would impact 2.11 acres of waters upstream from estuarine substrates and emergent wetlands utilized by various life stages of species comprising the shrimp, and snapper-grouper management complexes. The District Engineer's initial determination is that the proposed action would not have a substantial individual or cumulative adverse impact on EFH or fisheries managed by the South Atlantic Fishery Management Council and the National Marine Fisheries Service (NMFS). The District Engineer's final determination relative to project impacts and the need for mitigation measures is subject to review by and coordination with the NMFS.

Pursuant to the Section 7 of the Endangered Species Act of 1973 (as amended), the Corps has reviewed the project area, examined all information provided by the applicant, and the District Engineer has determined that the project is not likely to adversely affect any Federally endangered, threatened, or proposed species or result in the destruction or adverse modification of designated or proposed critical habitat. This public notice serves as a request for written concurrence from the U.S. Fish and Wildlife Service and/or the National Marine Fisheries Service on this determination.

Pursuant to Section 106 of the National Historic Preservation Act (NHPA), this public notice also constitutes a request to Indian Tribes to notify the District Engineer of any historic properties of religious and cultural significance to them that may be affected by the proposed undertaking.

In accordance with Section 106 of the NHPA, the District Engineer has consulted South Carolina ArchSite (GIS), for the presence or absence of historic properties (as defined in 36 C.F.R. 800.16)(j)(1)), and has initially determined that no historic properties are present; therefore, there will be no effect on historic properties. To ensure that other historic properties that the District Engineer is not aware of are not overlooked, this public notice also serves as a request to the State Historic Preservation Office and any other interested parties to provide any information they may have with regard to historic properties. This public notice serves as a request for concurrence within 30 days from the SHPO (and/or Tribal Historic Preservation Officer).

The District Engineer's final eligibility and effect determination will be based upon coordination with the SHPO and/or THPO, as appropriate and required and with full consideration given to the proposed undertaking's potential direct and indirect effects on historic properties within the Corps-identified permit area.

Any person may request, in writing, within the comment period specified in this notice, that a public hearing be held to consider this application. Requests for a public hearing shall state, with particularity, the reasons for holding a public hearing.

The decision whether to issue a permit will be based on an evaluation of the probable impact including cumulative impacts of the activity on the public interest and will include application of the guidelines promulgated by the Administrator, Environmental Protection Agency (EPA), under authority of Section 404(b) of the Clean Water Act and, as appropriate, the criteria established under authority of Section 102 of the Marine Protection, Research and Sanctuaries Act of 1972, as amended. That decision will reflect the national concern for both protection and utilization of important resources. The benefit which reasonably may be expected to accrue from the project must be balanced against its reasonably foreseeable detriments. All factors which may be relevant to the project will be considered including the cumulative effects thereof; among those are conservation, economics, aesthetics, general environmental concerns, wetlands, historic properties, fish and wildlife values, flood hazards, flood plain values, land use, navigation, shoreline erosion and accretion, recreation, water supply and conservation, water quality, energy needs, safety, food and fiber production and, in general, the needs and welfare of the people. A permit will be granted unless the District Engineer determines that it would be contrary to the public interest. In cases of conflicting property rights, the Corps cannot undertake to adjudicate rival claims.

The Corps is soliciting comments from the public; Federal, state, and local agencies and officials; Indian Tribes; and other interested parties in order to consider and evaluate the impacts of this activity. Any comments received will be considered by the Corps to determine whether to

issue, modify, condition or deny a permit for this project. To make this decision, comments are used to assess impacts on endangered species, historic properties, water quality, general environmental effects, and the other public interest factors listed above. Comments are used in the preparation of an Environmental Assessment and/or an Environmental Impact Statement pursuant to the National Environmental Policy Act. Comments are also used to determine the need for a public hearing and to determine the overall public interest of the activity. **Please submit comments in writing, identifying the project of interest by public notice number, to the following address:**

**U.S. Army Corps of Engineers
ATTN: REGULATORY DIVISION
1949 INDUSTRIAL PARK ROAD, ROOM 140
CONWAY, SOUTH CAROLINA 29526**

If there are any questions concerning this public notice, please contact Rob Huff, Watershed Manager, at (843) 365-4239.

Z:\26688\26688.0000\Engineering\Drawings\Exhibits\Wetland Permit Drawings\Option B - Preferred Option\26688 - Location Map.dwg - Mar 27, 2018 - 2:18:35 PM

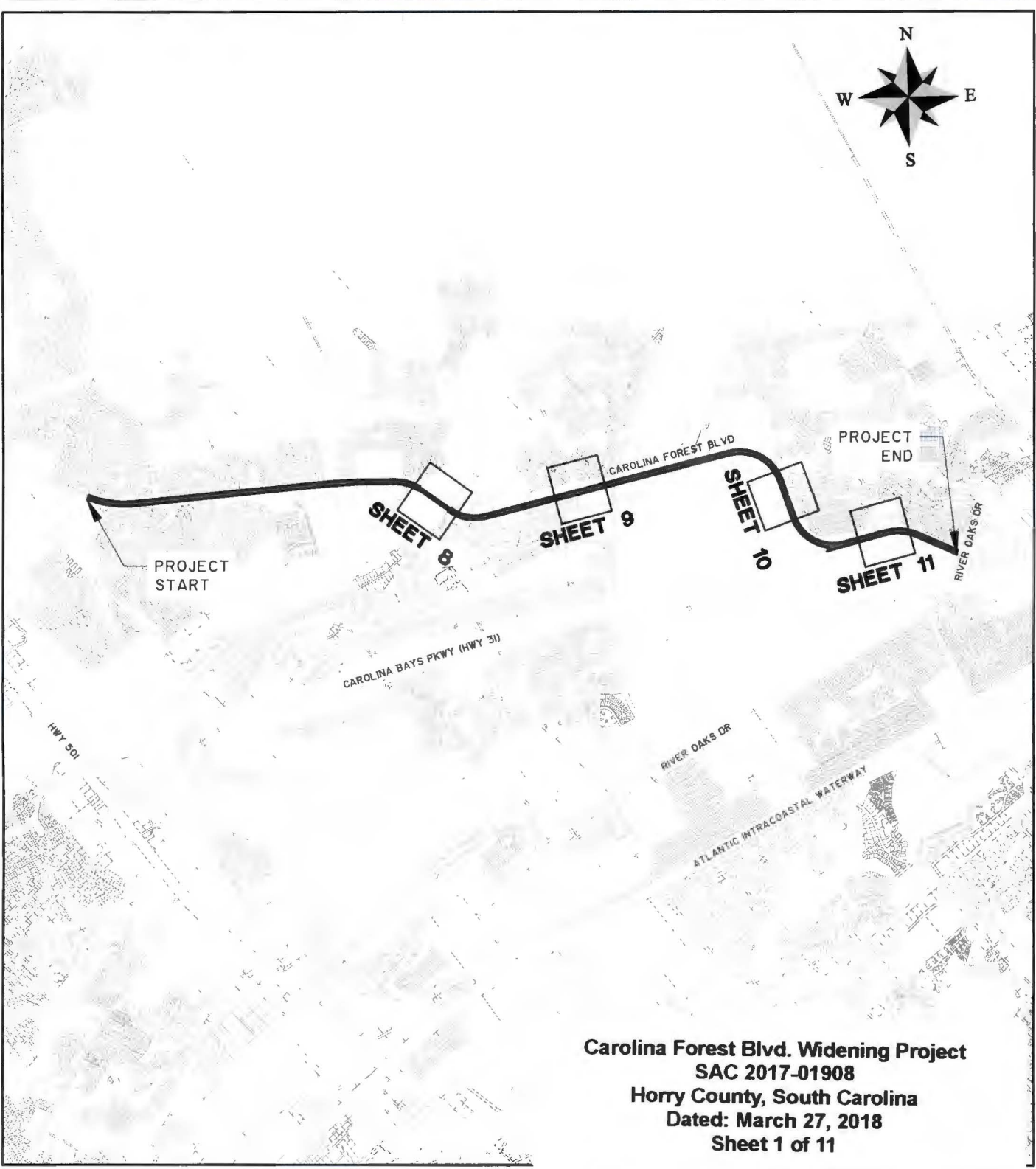
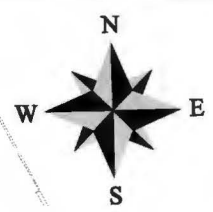

Carolina Forest Blvd. Widening Project
SAC 2017-01908
Horry County, South Carolina
Dated: March 27, 2018
Sheet 1 of 11

CAROLINA FOREST BLVD. WIDENING

OPTION B - PREFERRED OPTION

LOCATION MAP

CLIENT:
HORRY COUNTY

LOCATION: HORRY COUNTY, SOUTH CAROLINA
DATE: 3/27/18 DRAWN BY: CCR SHEET: 1
JOB NUMBER: J-26688.0000 REVIEWED BY: WAW SCALE: 1" = 4000'



611 Burroughs & Chapin Boulevard • Suite 202
Myrtle Beach, SC 29577 • 843.839.3545

www.thomasandhutton.com

Z:\26688\26688.0000\Engineering\Drawings\Exhibits\Welland Permitt Drawings\Option B - Preferred Option\26688 - USGS Vicinity Map.dwg - Mar 27, 2018 - 2:20:40 PM

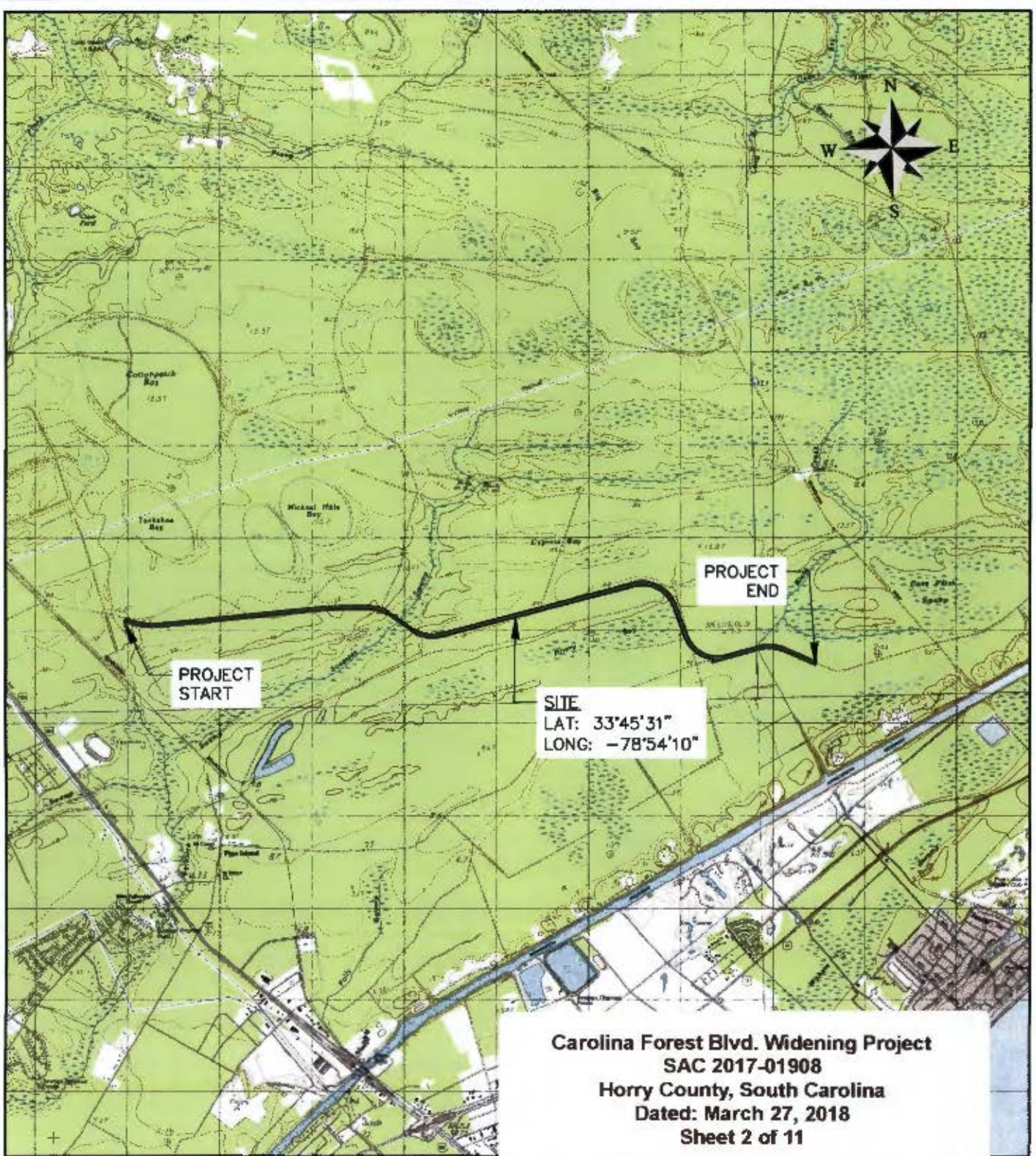

Carolina Forest Blvd. Widening Project
SAC 2017-01908
Horry County, South Carolina
Dated: March 27, 2018
Sheet 2 of 11

CAROLINA FOREST BLVD. WIDENING
OPTION B - PREFERRED OPTION

USGS MAP
 CLIENT:
HORRY COUNTY

LOCATION: HORRY COUNTY, SOUTH CAROLINA
 DATE: 3/27/18 DRAWN BY: CCR SHEET: 2
 JOB NUMBER: J-26688.0000 REVIEWED BY: WAW SCALE: 1" = 5000'



611 Burroughs & Chapin Boulevard • Suite 202
 Myrtle Beach, SC 29577 • 843.839.3545

www.thomasandhutton.com

Z:\26688\26688.0000\Engineering\Drawings\Exhibits\Wetland Permit Drawings\Option B - Preferred Option\26688 - Wetland Permit Drawings.dwg - Mar 27, 2018 - 2:09:55 PM

LEGEND

WETLANDS TO
REMAIN

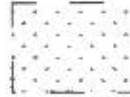

WETLANDS TO
BE IMPACTED



PRPW



PRPW TO BE
IMPACTED



UPLAND



Carolina Forest Blvd. Widening Project
SAC 2017-01908
Horry County, South Carolina
Dated: March 27, 2018
Sheet 3 of 11

CAROLINA FOREST BLVD. WIDENING OPTION B - PREFERRED OPTION

LEGEND

CLIENT:

HORRY COUNTY

LOCATION: HORRY COUNTY, SOUTH CAROLINA

DATE: 3/27/18

DRAWN BY: CCR

SHEET: 3

JOB NUMBER: J-26688.0000

REVIEWED BY: WAW

SCALE: 1" = 100'



611 Burroughs & Chapin Boulevard • Suite 202
Myrtle Beach, SC 29577 • 843.839.3545

www.thomasandhutton.com

Z:\26688\26688.0000\Engineering\Drawings\Exhibits\Wetland Permit Drawings\Option B - Preferred Option\26688 - Wetland Permit Drawings.dwg - Mar 27, 2018 - 2:09:55 PM

IMPACT SUMMARY

<u>IMPACT</u>	<u>TOTAL ACRES OF JURISDICTIONAL WETLAND IMPACT</u>	<u>TOTAL FILL VOLUME (C.Y.)</u>
F1	1.21 ACRES ±	15,982 ±
F2	0.12 ACRES ±	426 ±
F3	0.21 ACRES ±	967 ±
F4	0.07 ACRES ±	249 ±
F5	0.47 ACRES ±	1,668 ±
TOTALS	2.08 ACRES ±	19,292 ±

<u>IMPACT #</u>	<u>JURISDICTIONAL PRPW</u>	<u>TOTAL IMPACT (LF)</u>
PRPW #1		95
TOTALS		95

Carolina Forest Blvd. Widening Project
 SAC 2017-01908
 Horry County, South Carolina
 Dated: March 27, 2018
 Sheet 4 of 11

CAROLINA FOREST BLVD. WIDENING
 OPTION B - PREFERRED OPTION
 WETLAND IMPACT SUMMARY

CLIENT:
HORRY COUNTY

LOCATION: HORRY COUNTY, SOUTH CAROLINA
 DATE: 3/27/18 DRAWN BY: CCR SHEET: 4
 JOB NUMBER: J-26688.0000 REVIEWED BY: WAW SCALE: 1" = 100'



611 Burroughs & Chapin Boulevard • Suite 202
 Myrtle Beach, SC 29577 • 843.839.3545

www.thomasandhutton.com

<u>WETLANDS</u>	<u>AREA (ACRES)</u>	<u>WETLANDS TO BE IMPACTED (ACRES)</u>	<u>WETLANDS TO REMAIN (ACRES)</u>
W-1	1.21	1.21	0.00
W-2	0.12	0.12	0.00
W-3	0.07	0.07	0.00
W-4	0.21	0.21	0.00
W-5	0.47	0.47	0.00
<hr/>			
TOTAL	2.08	2.08	0.00

Carolina Forest Blvd. Widening Project
SAC 2017-01908
Horry County, South Carolina
Dated: March 27, 2018
Sheet 5 of 11

CAROLINA FOREST BLVD. WIDENING
OPTION B - PREFERRED OPTION
WETLAND IMPACT PRESERVATION SUMMARY

CLIENT:
HORRY COUNTY

LOCATION: HORRY COUNTY, SOUTH CAROLINA
DATE: 3/27/18 DRAWN BY: CCR SHEET: 5
JOB NUMBER: J-26688.0000 REVIEWED BY: WAW SCALE: 1" = 100'



611 Burroughs & Chapin Boulevard • Suite 202
Myrtle Beach, SC 29577 • 843.839.3545

www.thomasandhutton.com

JURISDICTIONAL
WETLAND AREA

WETLAND 1	1.21 AC.±
WETLAND 2	0.12 AC.±
WETLAND 3	0.07 AC.±
WETLAND 4	0.21 AC.±
WETLAND 5	0.47 AC.±
<u>TOTAL</u>	<u>2.08 AC.±</u>

JURISDICTIONAL PERENNIAL RELATIVELY
PERMANENT WATER (PRPW) AREA

JURISDICTIONAL (PRPW) 1	0.02 AC.±
JURISDICTIONAL (PRPW) 2	0.01 AC.±
JURISDICTIONAL (PRPW) 3	0.03 AC.±
JURISDICTIONAL (PRPW) 4	0.07 AC.±
<u>TOTAL</u>	<u>0.13 AC.±</u>

Carolina Forest Blvd. Widening Project
SAC 2017-01908
Horry County, South Carolina
Dated: March 27, 2018
Sheet 6 of 11

CAROLINA FOREST BLVD. WIDENING
OPTION B - PREFERRED OPTION

NOTES

CLIENT:
HORRY COUNTY

LOCATION: HORRY COUNTY, SOUTH CAROLINA
DATE: 3/27/18 DRAWN BY: CCR SHEET: 6
JOB NUMBER: J-26688.0000 REVIEWED BY: WAW SCALE: 1" = 100'



611 Burroughs & Chapin Boulevard • Suite 202
Myrtle Beach, SC 29577 • 843.839.3545

www.thomasandhutton.com

Z:\26688\26688.0000\Engineering\Drawings\Exhibits\Wetland Permit Drawings\Option B - Preferred Option\26688 - Wetland Permit Drawings.dwg - Mar 27, 2018 - 2:09:55 PM

Z:\26688\26688.0000\Engineering\Drawings\Exhibits\Welland Permit Drawings\Option B - Preferred Option\26688 - Welland Permit Drawings.dwg - Mar 27, 2018 - 2:09:55 PM

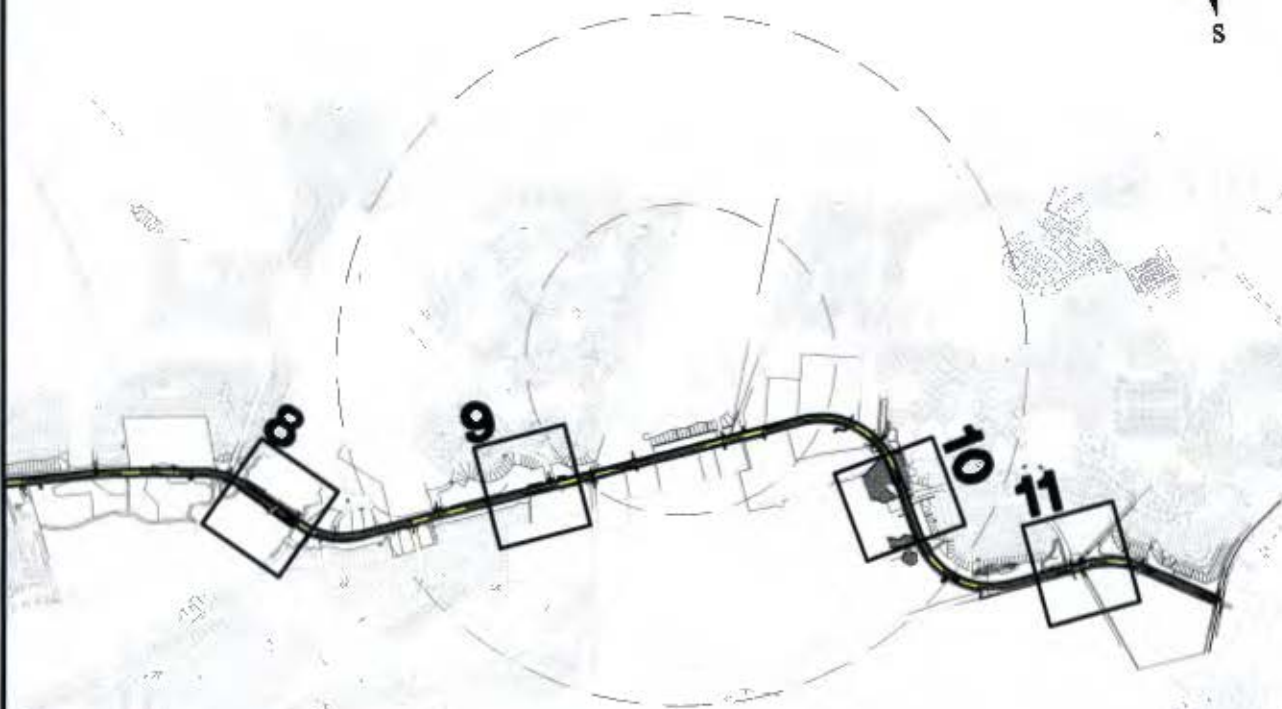
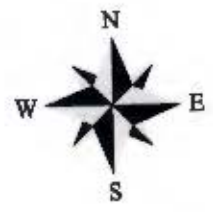

Carolina Forest Blvd. Widening Project
SAC 2017-01908
Horry County, South Carolina
Dated: March 27, 2018
Sheet 7 of 11

CAROLINA FOREST BLVD. WIDENING

OPTION B - PREFERRED OPTION

KEY

CLIENT:

HORRY COUNTY

LOCATION: HORRY COUNTY, SOUTH CAROLINA

DATE: 3/27/18

DRAWN BY: CCR

SHEET: 7

JOB NUMBER: J-26688.0000

REVIEWED BY: WAW

SCALE: 1" = 300'



611 Burroughs & Chapin Boulevard • Suite 202
Myrtle Beach, SC 29577 • 843.839.3545

www.thomasandhutton.com

Z:\26688\26688.0000\Engineering\Drawings\Options\Wetland Permit Drawing\Option B - Preferred Option\26688 - Wetland Permit Drawing.dwg - Mar 27, 2018 - 3:09:55 PM

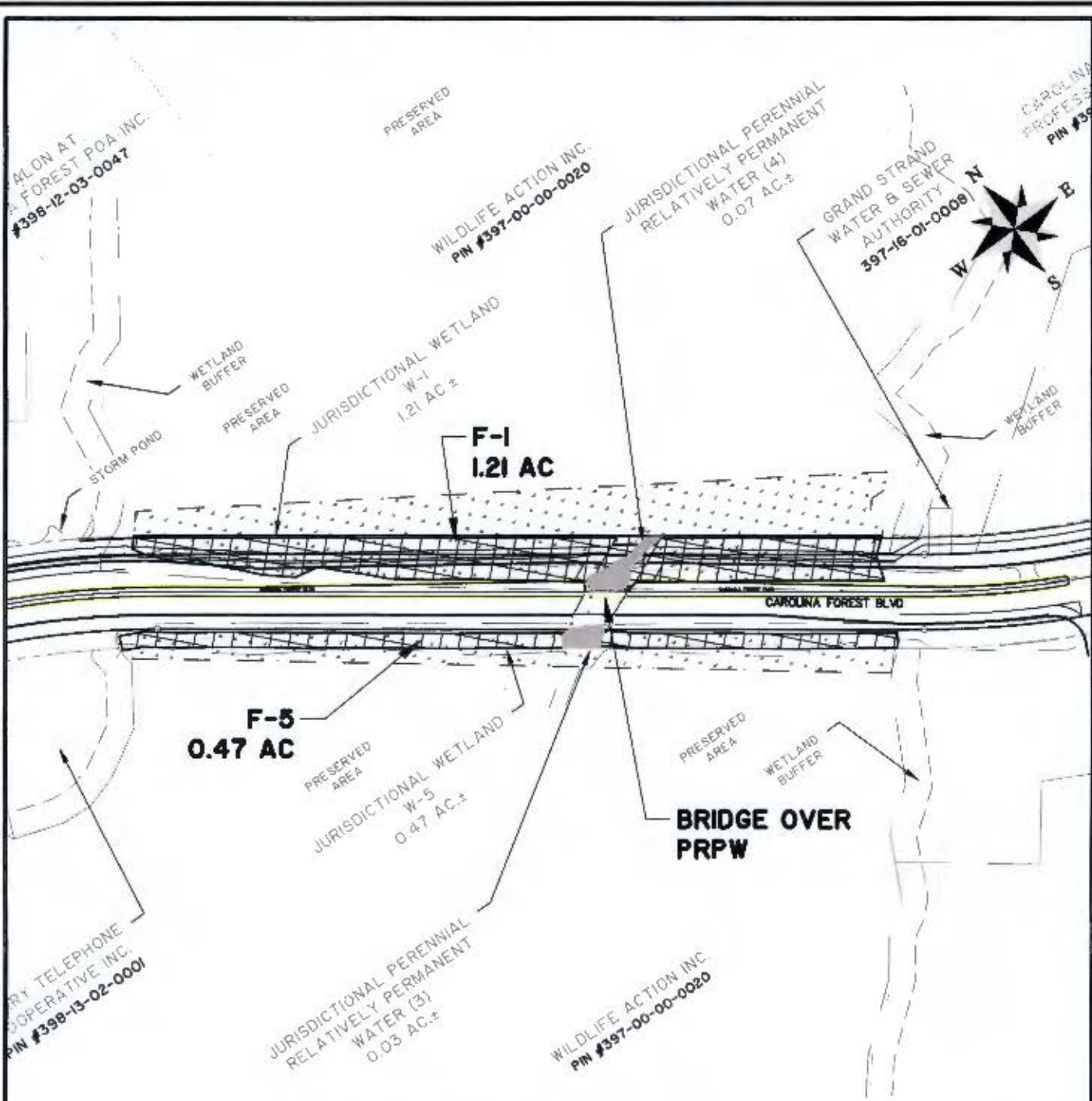

Carolina Forest Blvd. Widening Project
SAC 2017-01908
Horry County, South Carolina
Dated: March 27, 2018
Sheet 8 of 11

CAROLINA FOREST BLVD. WIDENING
OPTION B - PREFERRED OPTION

PLAN
CLIENT:
HORRY COUNTY

LOCATION: HORRY COUNTY, SOUTH CAROLINA
DATE: 3/27/18 **DRAWN BY:** CCR **SHEET:** 8
JOB NUMBER: J-26688.0000 **REVIEWED BY:** WAW **SCALE:** 1" = 200'



611 Burroughs & Chapin Boulevard • Suite 202
 Myrtle Beach, SC 29577 • 843.839.3545
www.thomasandhutton.com

Z:\26688\26688 0000\Engineering\Drawings\Exhibits\Wetland Permit Drawings\Option B - Preferred Option\26688 - Wetland Permit Drawings.dwg - Mar 27, 2018 - 2:09:55 PM

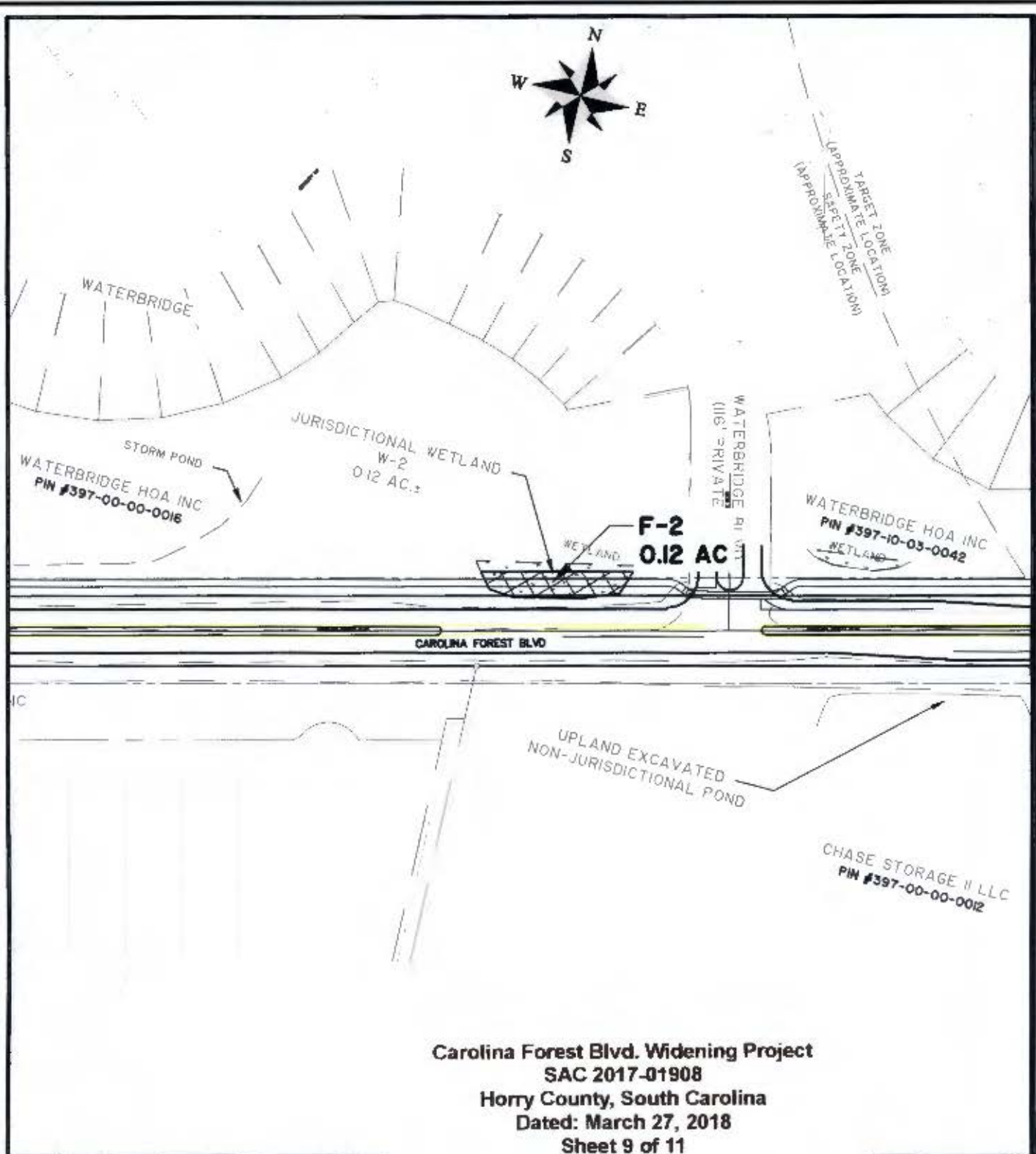

Carolina Forest Blvd. Widening Project
SAC 2017-01908
Horry County, South Carolina
Dated: March 27, 2018
Sheet 9 of 11

CAROLINA FOREST BLVD. WIDENING
OPTION B - PREFERRED OPTION

PLAN
CLIENT:
HORRY COUNTY

LOCATION: HORRY COUNTY, SOUTH CAROLINA
DATE: 3/27/18 **DRAWN BY:** CCR **SHEET:** 9
JOB NUMBER: J-26688.0000 **REVIEWED BY:** WAW **SCALE:** 1" = 200'

THOMAS & HUTTON

611 Burroughs & Chapin Boulevard • Suite 202
 Myrtle Beach, SC 29577 • 843.839.3545

www.thomasandhutton.com

Z:\26688\26688.0000\Engineering\Drawings\Exhibit\Wetland Permit Drawings\Option B - Preferred Option\26688 - Wetland Permit Drawings.dwg - Mar 27, 2018 - 2:09:55 PM

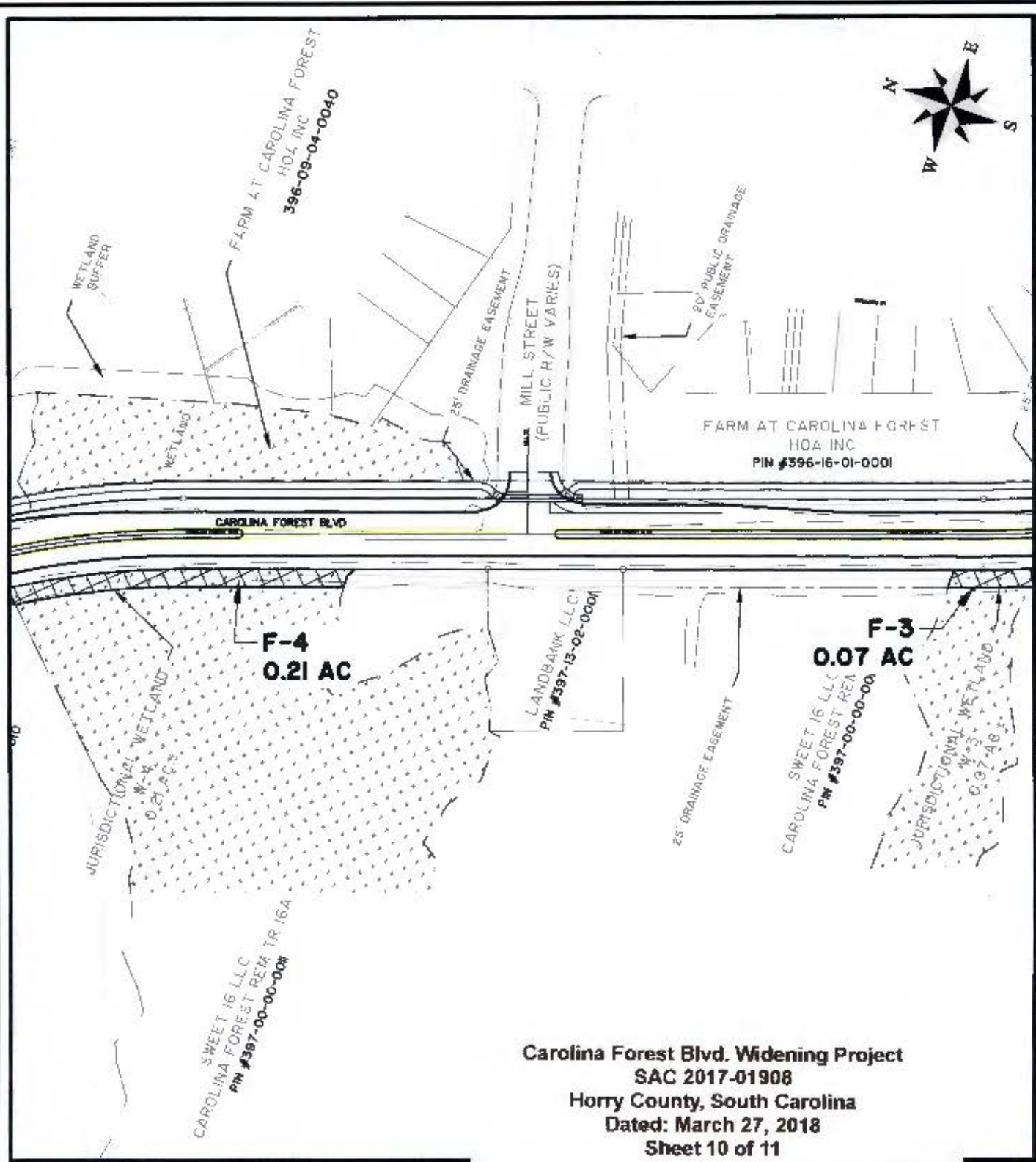

Carolina Forest Blvd. Widening Project
SAC 2017-01908
Horry County, South Carolina
Dated: March 27, 2018
Sheet 10 of 11

CAROLINA FOREST BLVD. WIDENING
OPTION B - PREFERRED OPTION

PLAN
CLIENT:
HORRY COUNTY

LOCATION: HORRY COUNTY, SOUTH CAROLINA
DATE: 3/27/18 **DRAWN BY:** CCR **SHEET:** 10
JOB NUMBER: J-26688.0000 **REVIEWED BY:** WAW **SCALE:** 1" = 200'



611 Burroughs & Chapin Boulevard • Suite 202
 Myrtle Beach, SC 29577 • 843.839.3545
www.thomasandhutton.com

Z:\26688\26688.0000\Engineering\Drawings\Exhibits\Wetland Permit Drawings\Option B - Preferred Option\26688 - Wetland Permit Drawings.dwg - Mar 27, 2018 - 2:09:55 PM

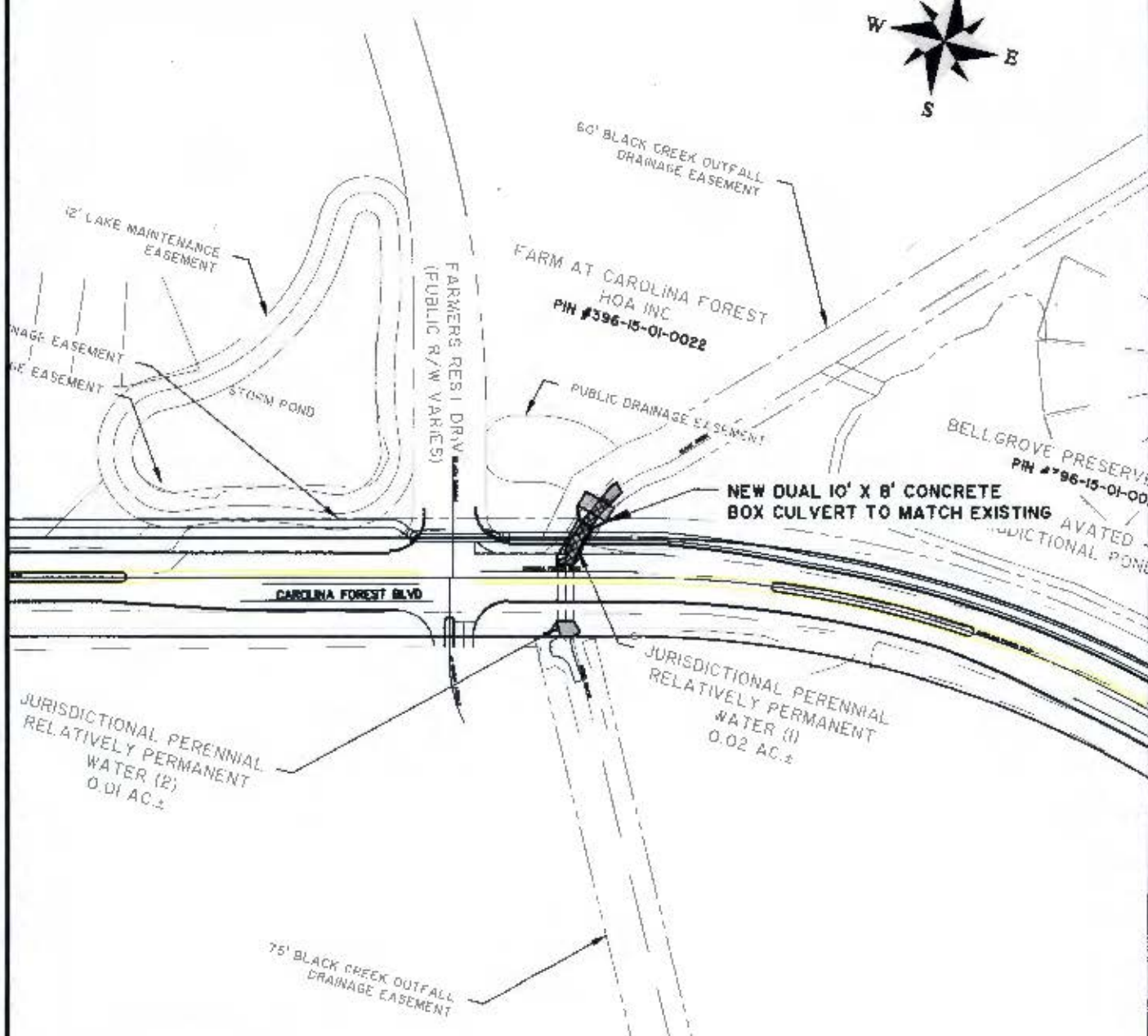
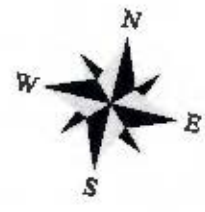

Carolina Forest Blvd. Widening Project
SAC 2017-01908
Horry County, South Carolina
Dated: March 27, 2018
Sheet 11 of 11

CAROLINA FOREST BLVD. WIDENING
OPTION B - PREFERRED OPTION

PLAN
 CLIENT:
HORRY COUNTY

LOCATION: HORRY COUNTY, SOUTH CAROLINA
 DATE: 3/27/18 DRAWN BY: CCR SHEET: 11
 JOB NUMBER: J-26688.0000 REVIEWED BY: WAW SCALE: 1" = 200'



611 Burroughs & Chapin Boulevard • Suite 202
 Myrtle Beach, SC 29577 • 843.839.3545

www.thomasandhutton.com