

JOINT
PUBLIC NOTICE

CHARLESTON DISTRICT, CORPS OF ENGINEERS
69A Hagood Avenue
Charleston, SC 29403-5107

and

THE S.C. DEPARTMENT OF HEALTH AND ENVIRONMENTAL CONTROL
Office of Ocean and Coastal Resource Management
1362 McMillan Avenue, Suite 400
North Charleston, South Carolina 29405

REGULATORY DIVISION

Refer to: P/N SAC-2002-12823

April 1, 2021

Pursuant to Section 10 of the Rivers and Harbors Act of 1899 (33 U.S.C. 403), Sections 401 and 404 of the Clean Water Act (33 U.S.C. 1344), and the South Carolina Coastal Zone Management Act (48-39-10 et.seq.), an application has been submitted to the Department of the Army and the S.C. Department of Health and Environmental Control by

Mr. Matt Moldenhauer
Charleston County Parks and Recreation Commission
861 Riverland Drive
Charleston, South Carolina 29412

for a permit modification to improve the Cooper River County Park & Marina on the

Cooper River/ Shipyard Creek

at the Cooper River Marina at 1010 Juneau Road in North Charleston, Charleston County, South Carolina (Latitude: 32.8318°, Longitude: -79.9350 °), Quad Sheet- Charleston.

In order to give all interested parties an opportunity to express their views

NOTICE

is hereby given that written statements regarding the proposed work will be received by the **Corps** until

15 Days from the Date of this Notice,

and **SCDHEC** will receive written statements regarding the proposed work until

30 Days from the Date of this Notice

from those interested in the activity and whose interests may be affected by the proposed work.

The proposed work consists of marine improvements associated with the proposed redevelopment of the Cooper River County Park & Marina. In detail, the applicant is proposing to construct a fishing/ crabbing dock, a pedestrian access boardwalk from the parking area to the existing grand pier, adding seating/ fishing platforms to the existing grand pier, adding a floating dock and gangway on the existing grand pier, expanding the grand pier deck, and constructing a

riprap revetment along the southern shoreline of the property. The fishing/ crabbing dock will be constructed on Shipyard Creek and consists of a 10' x 72' long access pier with a 15' x 18' covered pierhead with 17' x 10' uncovered decks on either side of the covered pier. The entire structure will be fixed with handrails. No floating docks or other in-water elements are proposed at the fishing/ crabbing dock. The purpose of the fishing/ crabbing dock is to provide passive recreational and educational opportunities for park patrons.

The pedestrian access boardwalk will consist of a 12' x 232' structure to provide direct, ADA-compliant access from the upland parking area to the grand pier. Given the shallow water depths in this area, the applicant has proposed a 20' wide temporary construction buffer located adjacent to the southern side of the pier. The temporary buffer will be returned to pre-construction conditions upon project completion. The purpose of this boardwalk is to provide direct, safe, and ADA-compliant public access from the parking lot and other park amenities to the grand pier.

The applicant also proposes to construct three 15' x 50' shaded seating/ fishing platforms located on the northern side of the grand pier in strategic locations. The purpose of these seating/ fishing platforms are to provide much needed shelter from the sun and elements for park patrons. They'll also provide space for active and passive recreation and leisure activities so that these patrons do not block the main walkway of the grand pier. The proposed floating dock will be 10' x 50' long with anchor piles. It will be attached to one of the seating/ fishing platforms with a 6' x 80' long ADA-compliant gangway. The floating dock will be the only park amenity providing direct access down to the water itself. It is envisioned that this dock would be utilized primarily for fishing, crabbing, and similar activities.

The applicant proposes to construct 6,280 square feet of new deck space at the waterward end of the grand pier which will supplement the existing smaller deck located in front of the marina building. It is envisioned that shade/ shelter will be provided on some, or all, of the platform, but the specific design of such elements has yet to be defined. However, in no case will the shade/ shelter elements extend past the proposed deck footprint. The purpose of the expanded deck is to provide a gathering area for visitors to take advantage of the views, fish, or simply relax. It will also provide marina patrons and visiting boaters to have direct access to the expanded dock area.

Lastly, the applicant proposes to construct a 700-foot long riprap revetment along the southern shoreline. The riprap will extend from the shoreline approximately 25' to 35' and will be 2' thick. Of the 1,375 cubic yards within the 0.30-acre footprint of the riprap, 601 cubic yards of material will be placed within 0.12 acre below the MHW line. The purpose of the riprap revetment is to address significant erosion as well as stabilizing the bank to allow a safe walking/ biking path along the waterfront. The applicant has not proposed mitigation as the majority of the impacts are over unconsolidated river bottom (as opposed to marshes or other critical habitat).

NOTE: This public notice and associated plans are available on the Corps' website at:
<http://www.sac.usace.army.mil/Missions/Regulatory/PublicNotices> .

The District Engineer has concluded that the discharges associated with this project, both direct and indirect, should be reviewed by the South Carolina Department of Health and Environmental Control in accordance with provisions of Section 401 of the Clean Water Act. As such, this notice constitutes a request, on behalf of the applicant, for certification that this project will comply with applicable effluent limitations and water quality standards. The work shown on this application must also be certified as consistent with applicable provisions of the Coastal Zone Management Program (15 CFR 930). This activity may also require evaluation for compliance with the S. C. Construction in Navigable Waters Permit Program. State review, permitting and

certification is conducted by the S. C. Department of Health and Environmental Control. The District Engineer will not process this application to a conclusion until such certifications are received. The applicant is hereby advised that supplemental information may be required by the State to facilitate the review.

This notice initiates the Essential Fish Habitat (EFH) consultation requirements of the Magnuson-Stevens Fishery Conservation and Management Act. Implementation of the proposed project would impact 0.66 acre of estuarine substrates utilized by various life stages of species comprising the shrimp, and snapper-grouper management complexes. The District Engineer's initial determination is that the proposed action would not have a substantial individual or cumulative adverse impact on EFH or fisheries managed by the South Atlantic Fishery Management Council and the National Marine Fisheries Service (NMFS). The District Engineer's final determination relative to project impacts and the need for mitigation measures is subject to review by and coordination with the NMFS.

Pursuant to the Section 7 of the Endangered Species Act of 1973 (as amended), the Corps has reviewed the project area, examined all information provided by the applicant, and the District Engineer has determined, based on the most recently available information that the West Indian manatee, Atlantic sturgeon, shortnose sturgeon, green sea turtle, Kemp's Ridley sea turtle, leatherback sea turtle, loggerhead sea turtle, American wood stork, and Eastern black rail Federally endangered or threatened species have the potential to inhabit the vicinity of the project. However, it has been determined that the project will have no effect on sturgeon, sea turtles, American wood stork and the Eastern black rail and will not result in the destruction or adverse modification of designated or proposed critical habitat. In addition, the District Engineer has determined the project may affect, but is not likely to adversely affect the West Indian manatee. This public notice serves as a request for written concurrence from the U.S. Fish and Wildlife Service and/or the National Marine Fisheries Service on this determination.

Pursuant to Section 106 of the National Historic Preservation Act (NHPA), this public notice also constitutes a request to Indian Tribes to notify the District Engineer of any historic properties of religious and cultural significance to them that may be affected by the proposed undertaking.

In accordance with Section 106 of the NHPA, the District Engineer has consulted South Carolina ArchSite (GIS), for the presence or absence of historic properties (as defined in 36 C.F.R. 800.16)(f)(1)), and has initially determined that no historic properties are present; therefore, there will be no effect on historic properties. To ensure that other historic properties that the District Engineer is not aware of are not overlooked, this public notice also serves as a request to the State Historic Preservation Office and any other interested parties to provide any information they may have with regard to historic properties. This public notice serves as a request for concurrence within 30 days from the SHPO (and/or Tribal Historic Preservation Officer).

The District Engineer's final eligibility and effect determination will be based upon coordination with the SHPO and/or THPO, as appropriate and required and with full consideration given to the proposed undertaking's potential direct and indirect effects on historic properties within the Corps-identified permit area.

Any person may request, in writing, within the comment period specified in this notice, that a public hearing be held to consider this application. Requests for a public hearing shall state, with

particularity, the reasons for holding a public hearing.

The decision whether to issue a permit will be based on an evaluation of the probable impact including cumulative impacts of the activity on the public interest and will include application of the guidelines promulgated by the Administrator, Environmental Protection Agency (EPA), under authority of Section 404(b) of the Clean Water Act. That decision will reflect the national concern for both protection and utilization of important resources. The benefit which reasonably may be expected to accrue from the project must be balanced against its reasonably foreseeable detriments. All factors which may be relevant to the project will be considered including the cumulative effects thereof; among those are conservation, economics, aesthetics, general environmental concerns, wetlands, historic properties, fish and wildlife values, flood hazards, flood plain values, land use, navigation, shoreline erosion and accretion, recreation, water supply and conservation, water quality, energy needs, safety, food and fiber production and, in general, the needs and welfare of the people. A permit will be granted unless the District Engineer determines that it would be contrary to the public interest. In cases of conflicting property rights, the Corps cannot undertake to adjudicate rival claims.

The Corps is soliciting comments from the public; Federal, state, and local agencies and officials; Indian Tribes; and other interested parties in order to consider and evaluate the impacts of this activity. Any comments received will be considered by the Corps to determine whether to issue, modify, condition or deny a permit for this project. To make this decision, comments are used to assess impacts on endangered species, historic properties, water quality, general environmental effects, and the other public interest factors listed above. Comments are used in the preparation of an Environmental Assessment and/or an Environmental Impact Statement pursuant to the National Environmental Policy Act. Comments are also used to determine the need for a public hearing and to determine the overall public interest of the activity. **Please submit comments in writing, identifying the project of interest by public notice number, to the following address:**

**U.S. Army Corps of Engineers
ATTN: REGULATORY DIVISION
69A Hagood Avenue
Charleston, SC 29403-5107**

If there are any questions concerning this public notice, please contact Chelsea B. Fannin, Project Manager, at (843) 329-8038, toll free at 1-866-329-8187, or by email at Chelsea.B.Fannin@usace.army.mil.

FOR PERMITTING PURPOSES ONLY
 "NOT FOR CONSTRUCTION"

NOAA Tide Station 8665530 (Charleston, SC)

Abbreviation	Datum	MLW (Feet)	NAVD88 (Feet)
MHHW	Mean Higher-High Water	5.58	2.62
MHW	Mean High Water	5.22	2.26
NAVD88	North American Vertical Datum of 1988	2.96	0
MTL	Mean Tide Level	2.61	-0.35
MSL	Mean Sea Level	2.74	-0.22
DTL	Mean Diurnal Tide Level	2.7	-0.26
MLW	Mean Low Water	0	-2.96
MLLW	Mean Lower-Low Water	-0.18	-3.14

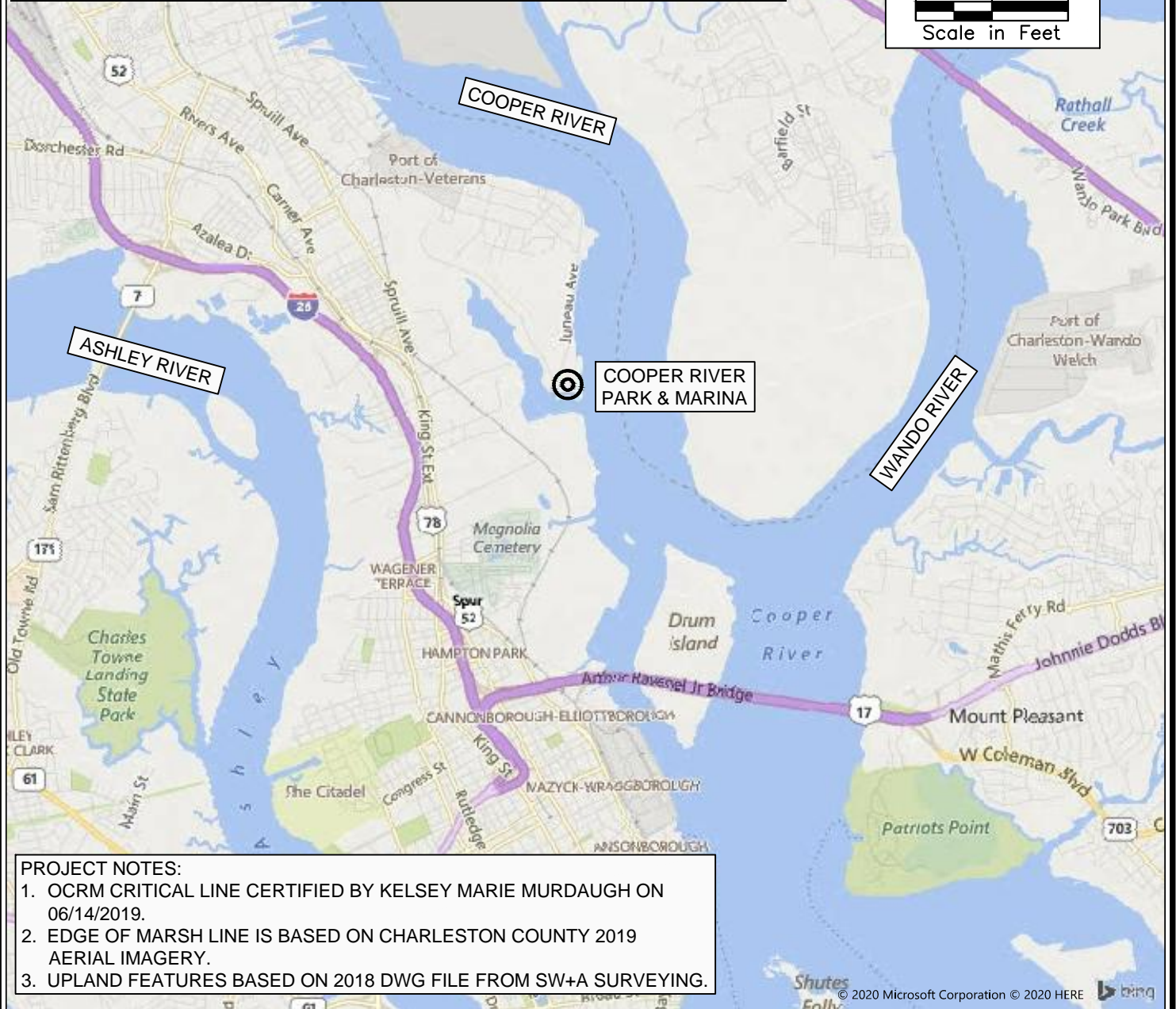
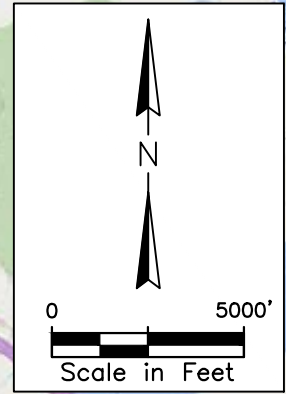

PROJECT NOTES:

1. OCRM CRITICAL LINE CERTIFIED BY KELSEY MARIE MURDAUGH ON 06/14/2019.
2. EDGE OF MARSH LINE IS BASED ON CHARLESTON COUNTY 2019 AERIAL IMAGERY.
3. UPLAND FEATURES BASED ON 2018 DWG FILE FROM SW+A SURVEYING.

PROJECT: Cooper River County Park
 Marine Improvements
 WATERBODY: Cooper River
 COUNTY: Charleston
 STATE: South Carolina
 LATITUDE: 32°49'54.50"N
 LONGITUDE: 79°56'16.63"W

LOCATION MAP

Owner: Charleston County Parks & Recreation

Address: 1010 Juneau Ave., N. Charleston, SC

Parcel ID: 4000000037



8-March-2021
 SHEET 1

FOR PERMITTING PURPOSES ONLY
 "NOT FOR CONSTRUCTION"

C:\Projects\17-3150 Cooper River Marina Assessment\3 - Phase 1 Upland Implementation\4.2 - Marine Elements Permitting\DWG_Permit\CooperRiverPermitDrawings_REV03.dwg 2 3/8/21
 NOTE: THESE DRAWINGS AND DESIGNS ARE STRICTLY CONFIDENTIAL AND PROTECTED BY INTERNATIONAL COPYRIGHT LAW. DETAILS MUST NOT BE DISCLOSED, REPRODUCED OR COMMUNICATED TO A 3rd PARTY IN ANY FORM OR MANNER WITHOUT THE PRIOR WRITTEN APPROVAL OF APPLIED TECHNOLOGY & MANAGEMENT.

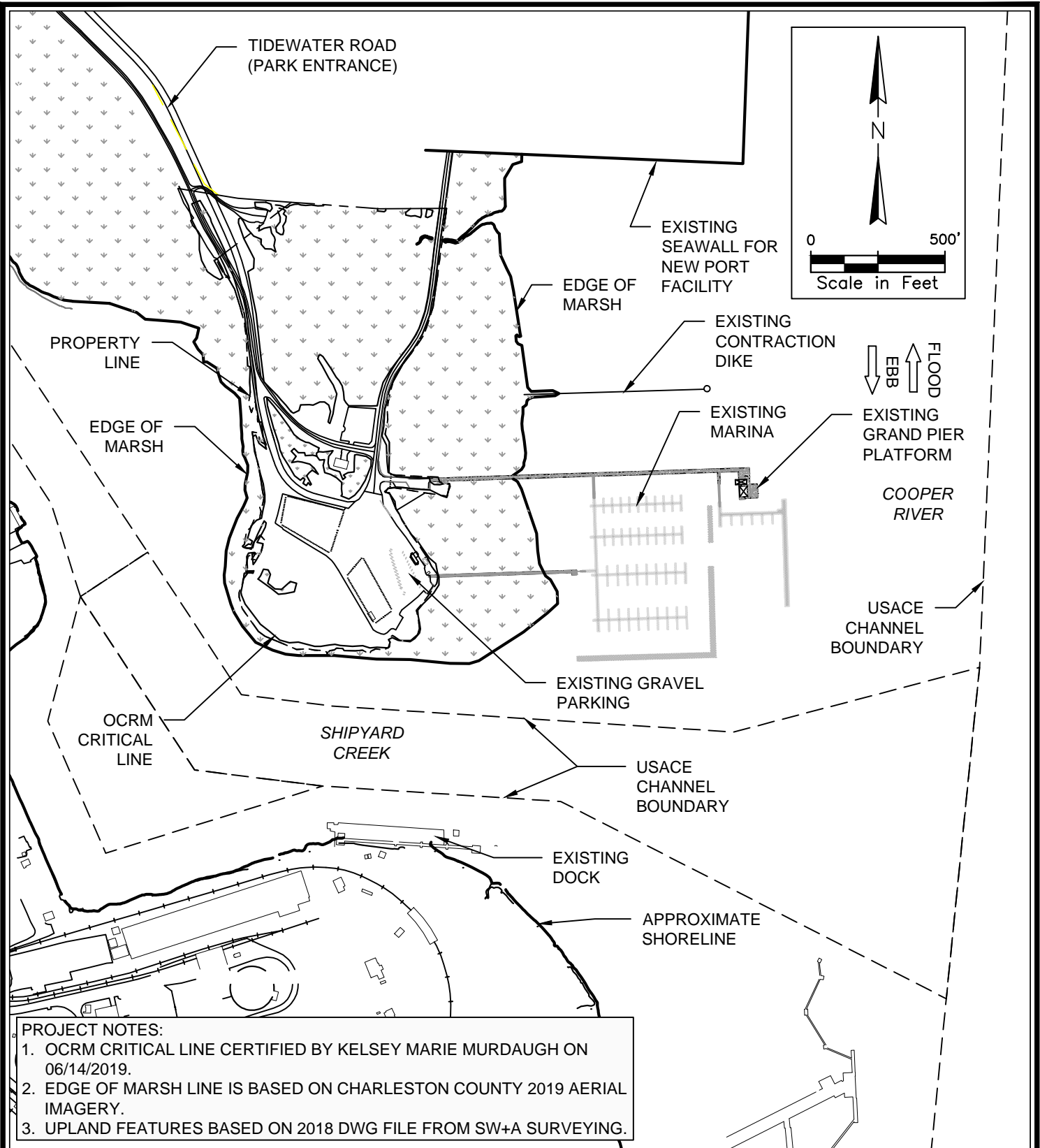

PROJECT NOTES:

1. OCRM CRITICAL LINE CERTIFIED BY KELSEY MARIE MURDAUGH ON 06/14/2019.
2. EDGE OF MARSH LINE IS BASED ON CHARLESTON COUNTY 2019 AERIAL IMAGERY.
3. UPLAND FEATURES BASED ON 2018 DWG FILE FROM SW+A SURVEYING.

PROJECT: Cooper River County Park Marine Improvements
WATERBODY: Cooper River
COUNTY: Charleston
STATE: South Carolina
LATITUDE: 32°49'54.50"N
LONGITUDE: 79°56'16.63"W

EXISTING CONDITIONS OVERVIEW

Owner: Charleston County Parks & Recreation
Address: 1010 Juneau Ave., N. Charleston, SC
Parcel ID: 4000000037



8-March-2021
 SHEET 2

FOR PERMITTING PURPOSES ONLY
 "NOT FOR CONSTRUCTION"

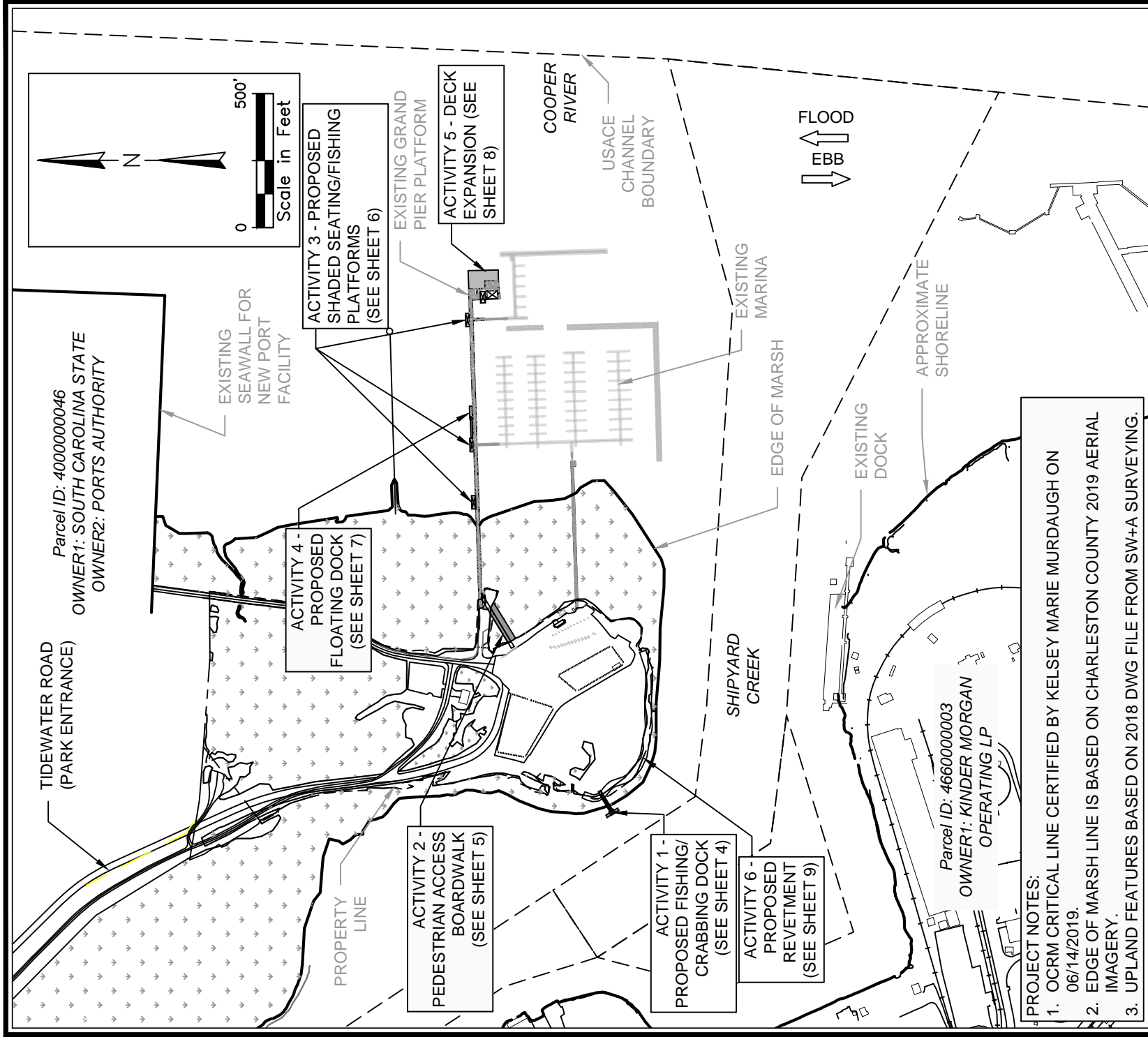

PROJECT NOTES:
 1. OCRM CRITICAL LINE CERTIFIED BY KELSEY MARIE MURDAUGH ON 06/14/2019.
 2. EDGE OF MARSH LINE IS BASED ON CHARLESTON COUNTY 2019 AERIAL IMAGERY.
 3. UPLAND FEATURES BASED ON 2018 DWG FILE FROM SW+A SURVEYING.

PROJECT: Cooper River County Park Marine Improvements Cooper River Charleston South Carolina 32°49'54.50"N 79°56'16.63"W		PROPOSED IMPROVEMENTS OVERVIEW Owner: Charleston County Parks & Recreation Address: 1010 Juneau Ave., N. Charleston, SC Parcel ID: 4000000037	
WATERBODY: Cooper River COUNTY: Charleston STATE: South Carolina LATITUDE: 32°49'54.50"N LONGITUDE: 79°56'16.63"W		ATM DESIGN ENGINEERING CONSULTING 8-March-2021 SHEET 3	

O:\Projects\17-3150 Cooper River Marina Assessments\3 - Phase 1 Upland Implementation\2 - Marine Elements Permitting\DWG_Permitting\PermitDrawings_REV02\CooperRiverPermitDrawings_REV03.dwg 3/8/21
 NOTE: THESE DRAWINGS AND DESIGNS ARE STRICTLY CONFIDENTIAL AND PROTECTED BY INTERNATIONAL COPYRIGHT LAW. DETAILS MUST NOT BE DISCLOSED, REPRODUCED OR COMMUNICATED TO A 3RD PARTY IN ANY FORM OR MANNER WITHOUT THE PRIOR WRITTEN APPROVAL OF APPLIED TECHNOLOGY & MANAGEMENT.

FOR PERMITTING PURPOSES ONLY
 "NOT FOR CONSTRUCTION"

C:\Projects\17-3150 Cooper River Marina Assessment\3 - Phase 1 Upland Implementation\4.2 - Marine Elements Permitting\DWG_Permit\CopperRiverPermitDrawings_REV05.dwg 4/3/21
 NOTE: THESE DRAWINGS AND DESIGNS ARE STRICTLY CONFIDENTIAL AND PROTECTED BY INTERNATIONAL COPYRIGHT LAW. DETAILS MUST NOT BE DISCLOSED, REPRODUCED OR COMMUNICATED TO A 3rd PARTY IN ANY FORM OR MANNER WITHOUT THE PRIOR WRITTEN APPROVAL OF ATM ENGINEERING & MANAGEMENT.

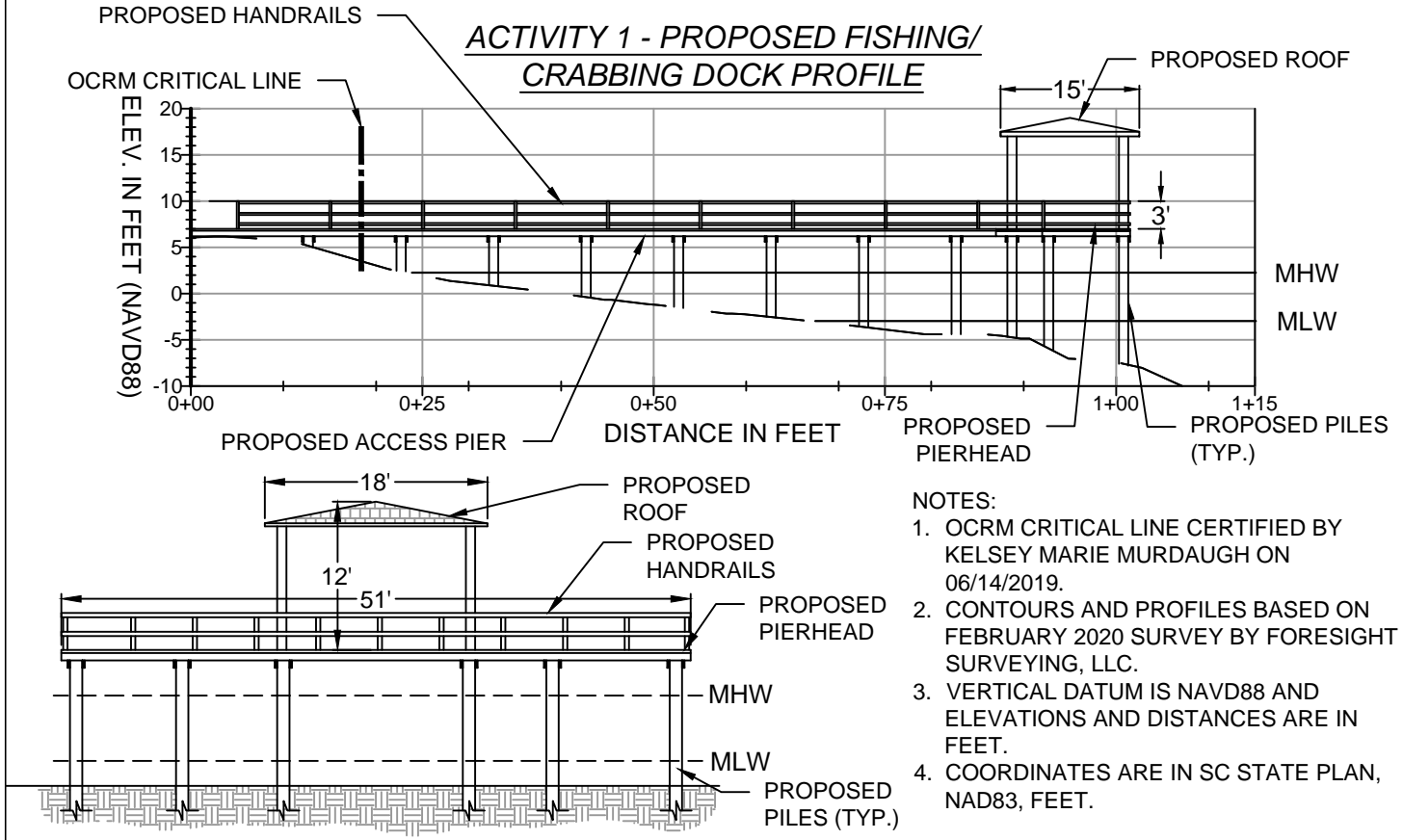
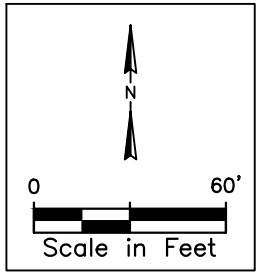
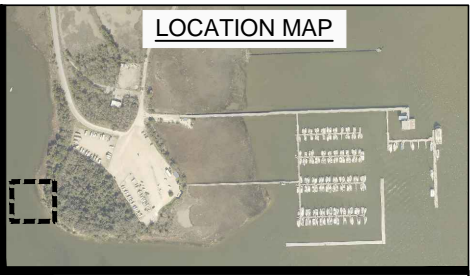
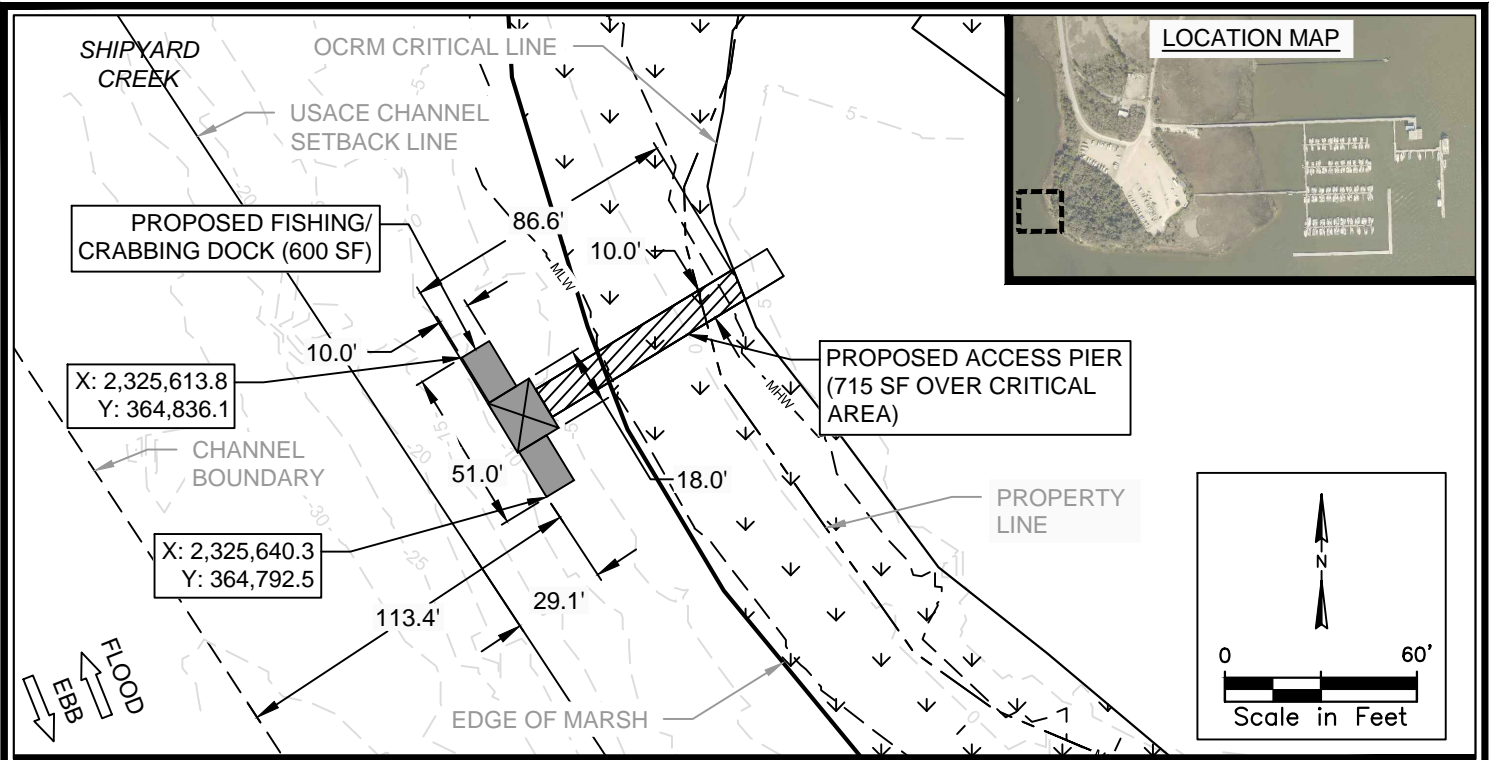

PROJECT:	Cooper River County Park Marine Improvements	ACTIVITY 1 - PROPOSED FISHING/CRABBING DOCK DETAILS	
WATERBODY:	Cooper River	Owner: Charleston County Parks & Recreation	
COUNTY:	Charleston	Address: 1010 Juneau Ave., N. Charleston, SC	
STATE:	South Carolina	Parcel ID: 4000000037	
LATITUDE:	32°49'54.50"N		8-March-2021
LONGITUDE:	79°56'16.63"W		SHEET 4

FOR PERMITTING PURPOSES ONLY
 "NOT FOR CONSTRUCTION"

C:\Projects\17-3150 Cooper River Marina Assessment\3 - Phase 1 Upland Implementation\4.2 - Marine Elements Permitting\DWG - Permit\CooperRiverPermitDrawings_REV03.dwg 5/3/21
 NOTE: THESE DRAWINGS AND DESIGNS ARE STRICTLY CONFIDENTIAL AND PROTECTED BY INTERNATIONAL COPYRIGHT LAW. DETAILS MUST NOT BE DISCLOSED, REPRODUCED OR COMMUNICATED TO A 3rd PARTY IN ANY FORM OR MANNER WITHOUT THE PRIOR WRITTEN APPROVAL OF APPLIED TECHNOLOGY & MANAGEMENT.

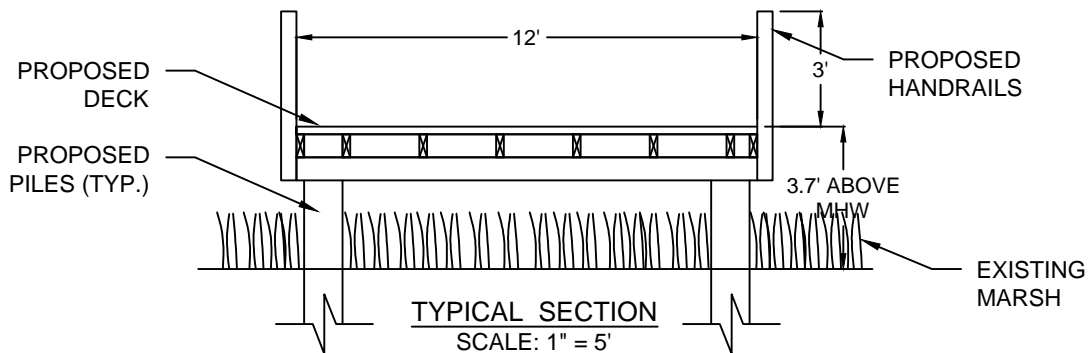
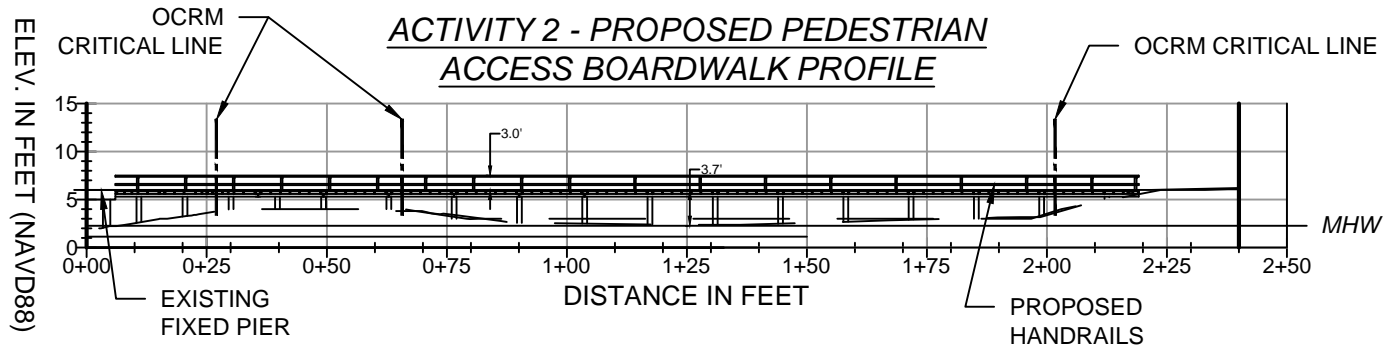
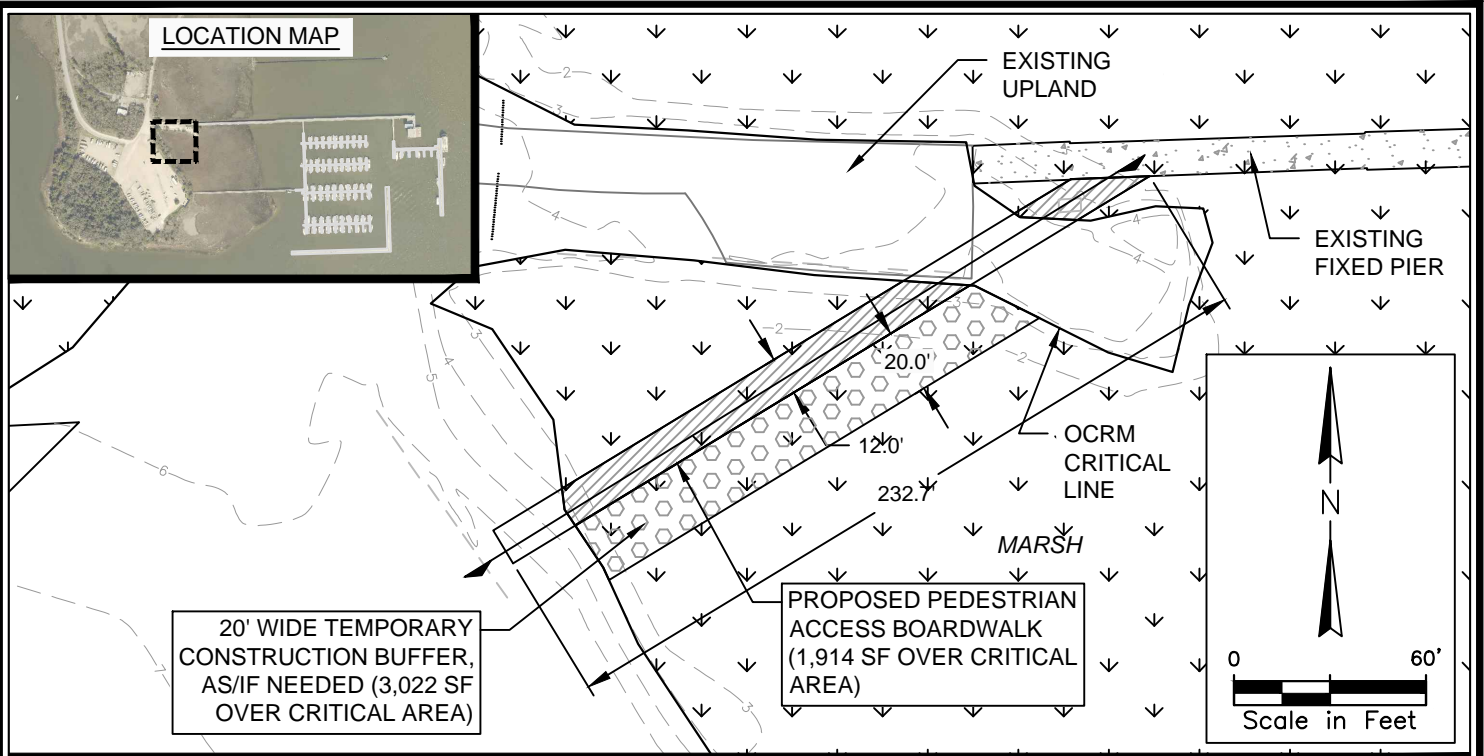

NOTES:

1. OCRM CRITICAL LINE CERTIFIED BY KELSEY MARIE MURDAUGH ON 06/14/2019.
2. CONTOURS AND PROFILES BASED ON 2018 SURVEY BY FORESIGHT SURVEYING, LLC.
3. VERTICAL DATUM IS NAVD88 AND ELEVATIONS AND DISTANCES ARE IN FEET.

PROJECT: Cooper River County Park
 Marine Improvements

WATERBODY: Cooper River

COUNTY: Charleston

STATE: South Carolina

LATITUDE: 32°49'54.50"N

LONGITUDE: 79°56'16.63"W

ACTIVITY 2 - PROPOSED PEDESTRIAN ACCESS BOARDWALK DETAILS

Owner: Charleston County Parks & Recreation

Address: 1010 Juneau Ave., N. Charleston, SC

Parcel ID: 4000000037



8-March-2021
 SHEET 5

FOR PERMITTING PURPOSES ONLY
 "NOT FOR CONSTRUCTION"

C:\Projects\17-3150 Cooper River Marina Assessment\3 - Phase 1 Upland Implementation\4.2 - Marine Elements Permitting\DWG_Permit\CooperRiverPermitDrawings_REV03.dwg 6/3/21
 NOTE: THESE DRAWINGS AND DESIGNS ARE STRICTLY CONFIDENTIAL AND PROTECTED BY INTERNATIONAL COPYRIGHT LAW. DETAILS MUST NOT BE DISCLOSED, REPRODUCED OR COMMUNICATED TO A 3rd PARTY IN ANY FORM OR MANNER WITHOUT THE PRIOR WRITTEN APPROVAL OF APPLIED TECHNOLOGY & MANAGEMENT.

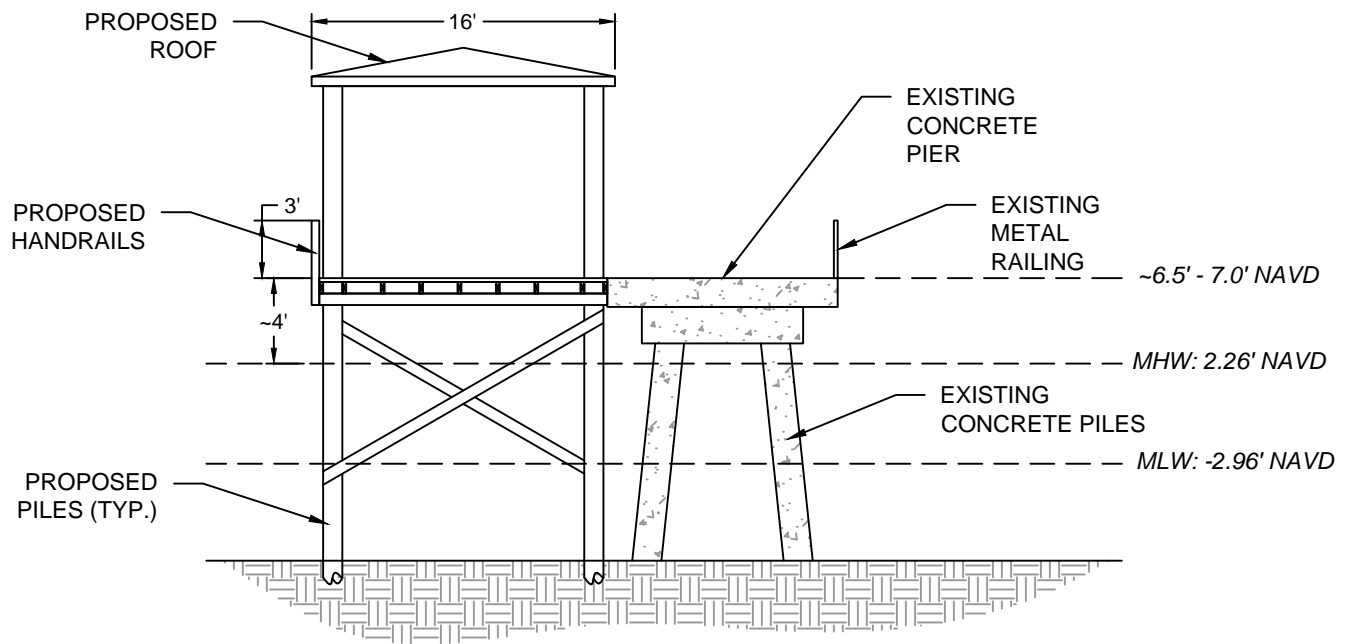
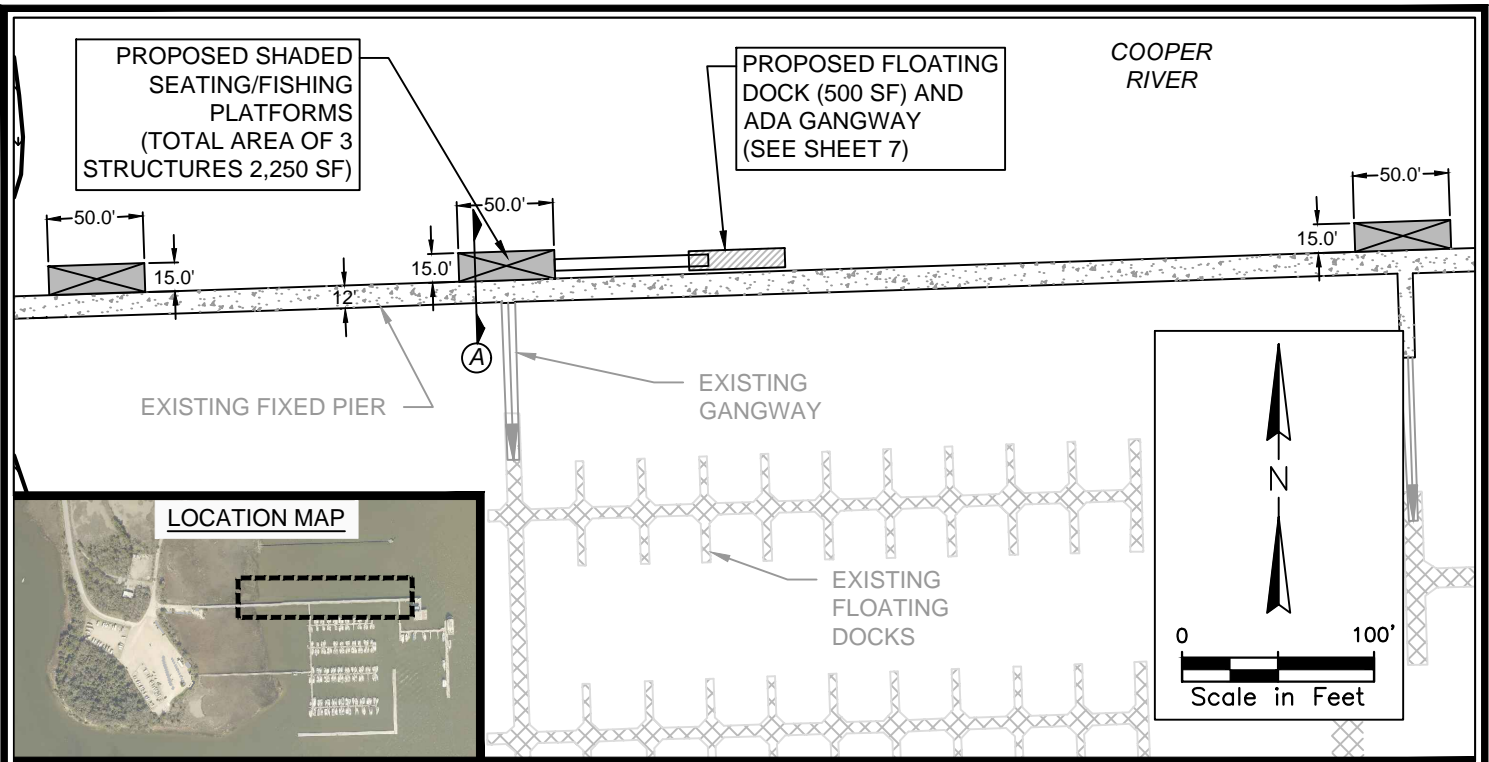

A TYPICAL SEATING/FISHING PLATFORM SECTION
 SCALE: 1" = 10'

PROJECT: Cooper River County Park Marine Improvements
WATERBODY: Cooper River
COUNTY: Charleston
STATE: South Carolina
LATITUDE: 32°49'54.50"N
LONGITUDE: 79°56'16.63"W

ACTIVITY 3-PROPOSED SHADED SEATING/FISHING PLATFORM DETAILS
 Owner: Charleston County Parks & Recreation
 Address: 1010 Juneau Ave., N. Charleston, SC
 Parcel ID: 4000000037



8-March-2021
 SHEET 6

FOR PERMITTING PURPOSES ONLY
 "NOT FOR CONSTRUCTION"

C:\Projects\17-3150 Cooper River Marina Assessment\3 - Phase 1 Upland Implementation\4.2 - Marine Elements Permitting\DWG_Permit\CooperRiverPermitDrawings_REV03.dwg 7/3/21
 NOTE: THESE DRAWINGS AND DESIGNS ARE STRICTLY CONFIDENTIAL AND PROTECTED BY INTERNATIONAL COPYRIGHT LAW. DETAILS MUST NOT BE DISCLOSED, REPRODUCED OR COMMUNICATED TO A 3rd PARTY IN ANY FORM OR MANNER WITHOUT THE PRIOR WRITTEN APPROVAL OF APPLIED TECHNOLOGY & MANAGEMENT.

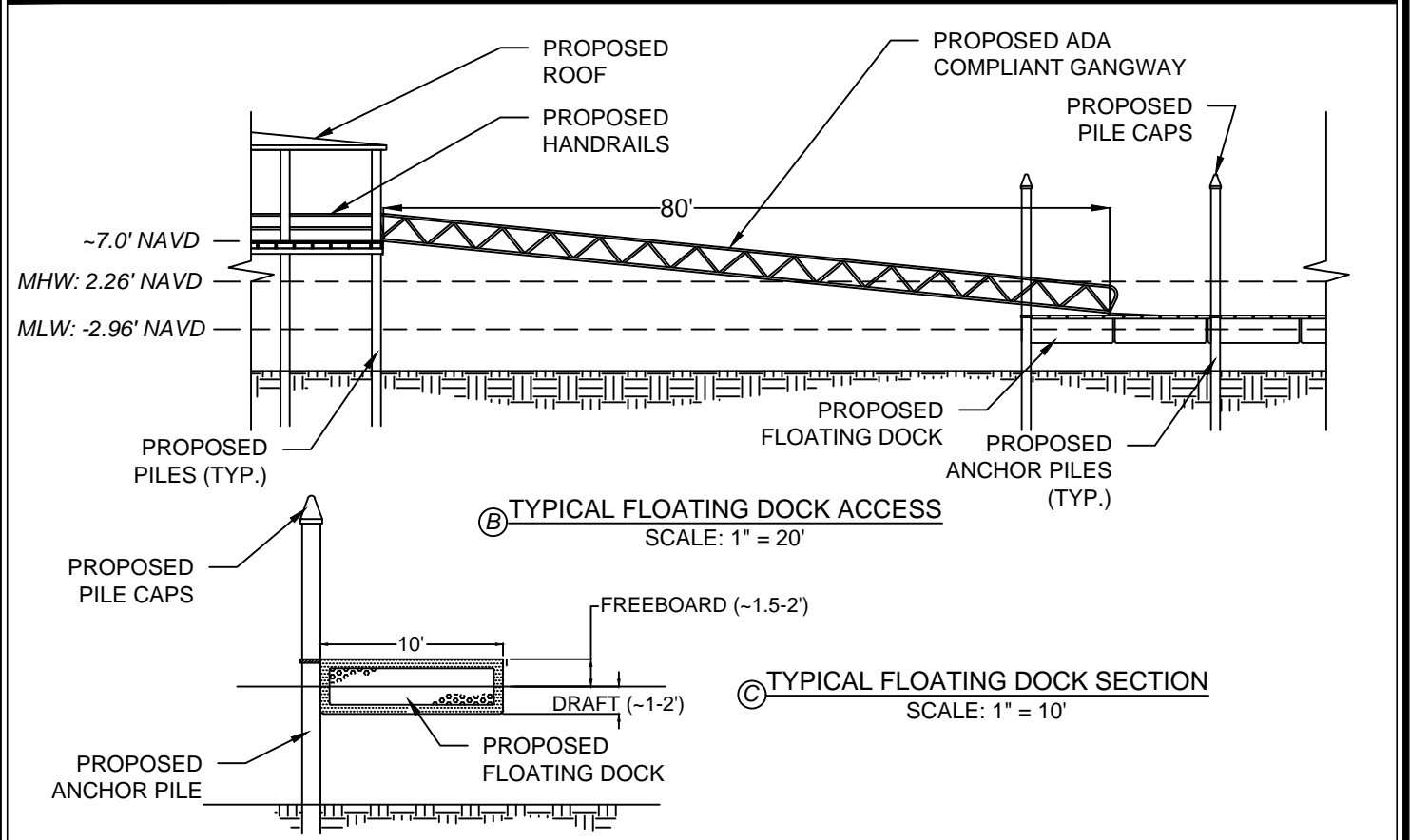
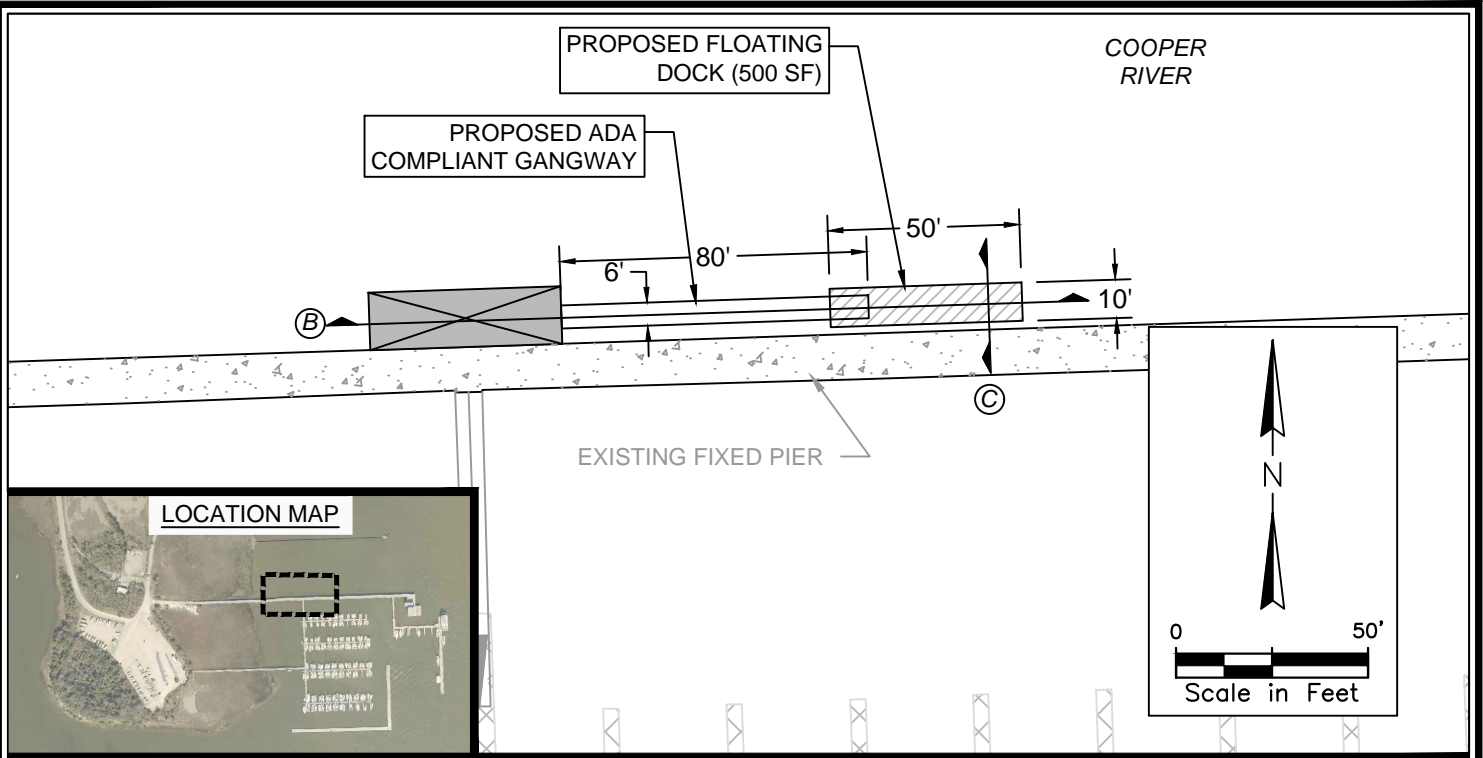

PROJECT: Cooper River County Park Marine Improvements WATERBODY: Cooper River COUNTY: Charleston STATE: South Carolina LATITUDE: 32°49'54.50"N LONGITUDE: 79°56'16.63"W	ACTIVITY 4 - PROPOSED FLOATING DOCK ACCESS AND DETAILS	
	Owner: Charleston County Parks & Recreation	
	Address: 1010 Juneau Ave., N. Charleston, SC	
	Parcel ID: 4000000037	
		8-March-2021 SHEET 7

FOR PERMITTING PURPOSES ONLY
 "NOT FOR CONSTRUCTION"

C:\Projects\17-3150 Cooper River Marina Assessment\3 - Phase 1 Upland Implementation\4.2 - Marine Elements Permitting\DWG - Permit\CooperRiverPermitDrawings_REV03.dwg 8/3/21
 NOTE: THESE DRAWINGS AND DESIGNS ARE STRICTLY CONFIDENTIAL AND PROTECTED BY INTERNATIONAL COPYRIGHT LAW. DETAILS MUST NOT BE DISCLOSED, REPRODUCED OR COMMUNICATED TO A 3rd PARTY IN ANY FORM OR MANNER WITHOUT THE PRIOR WRITTEN APPROVAL OF APPLIED TECHNOLOGY & MANAGEMENT.

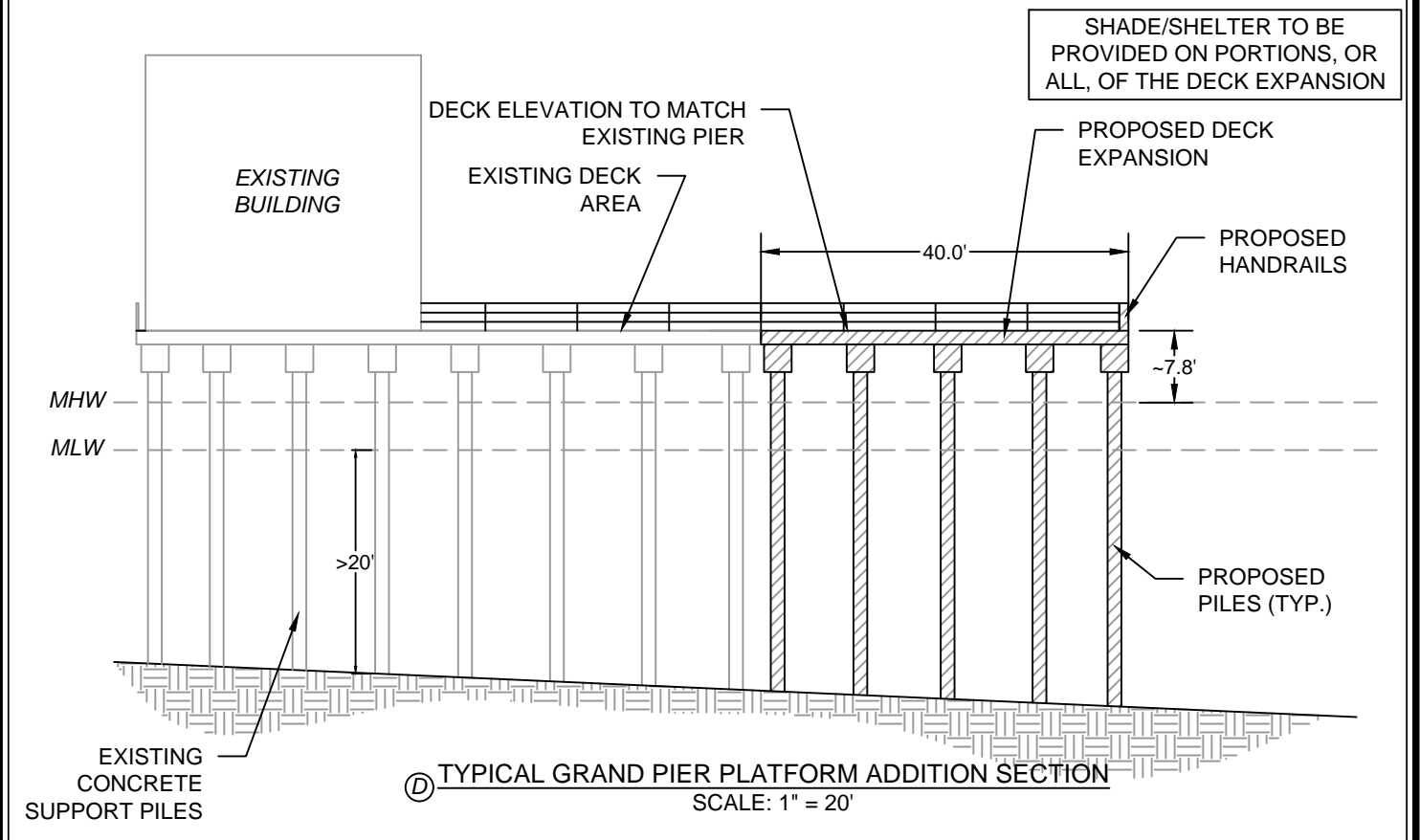
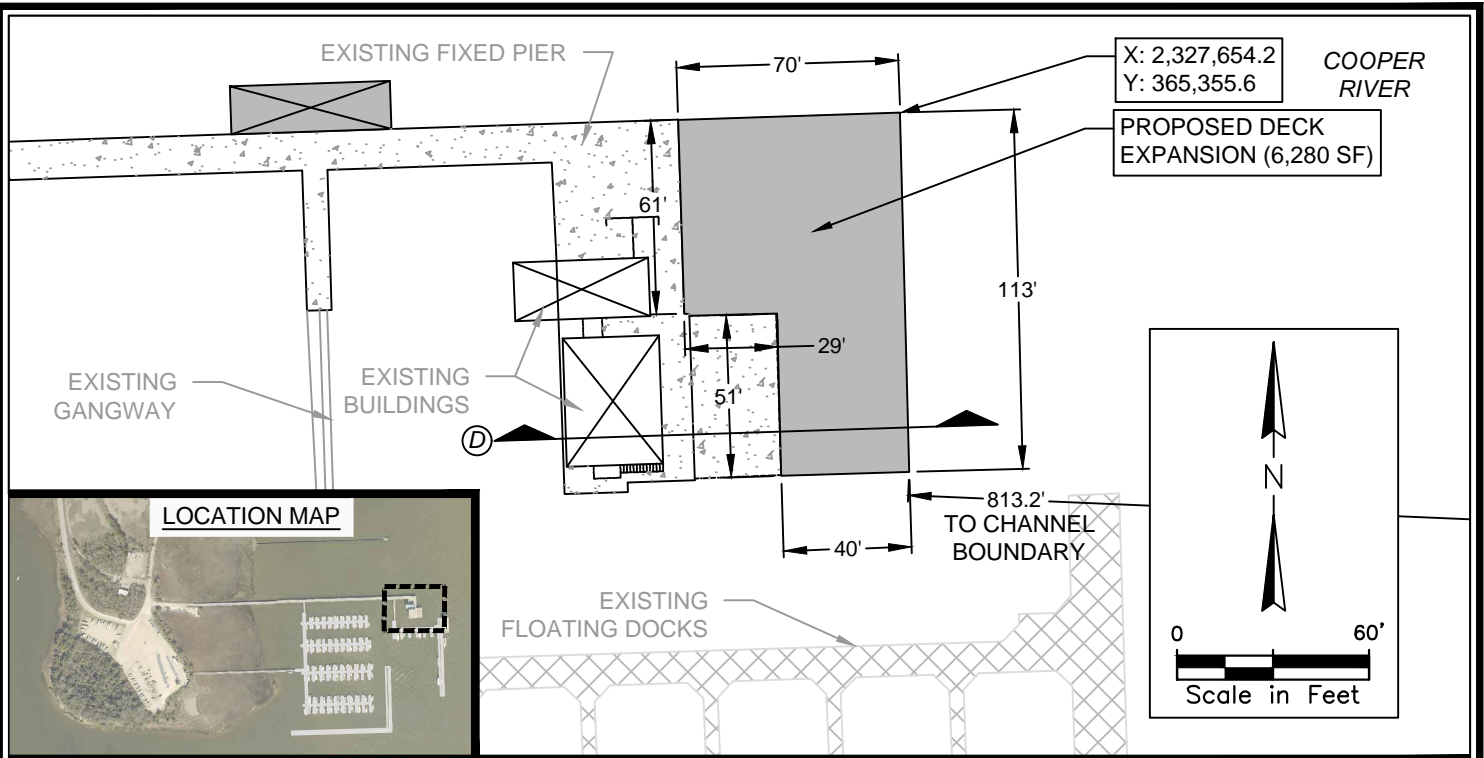

PROJECT: Cooper River County Park Marine Improvements WATERBODY: Cooper River COUNTY: Charleston STATE: South Carolina LATITUDE: 32°49'54.50"N LONGITUDE: 79°56'16.63"W	ACTIVITY 5 - PROPOSED DECK EXPANSION DETAILS	
	Owner: Charleston County Parks & Recreation	
	Address: 1010 Juneau Ave., N. Charleston, SC	
	Parcel ID: 4000000037	
		8-March-2021 SHEET 8

FOR PERMITTING PURPOSES ONLY
 "NOT FOR CONSTRUCTION"

O:\Projects\17-3150 Cooper River Marina Assessment\3 - Phase 1 Upland Implementation\4.2 - Marine Elements Permitting\DWG_Permit\CooperRiverPermitDrawings_REV05.dwg 9/3/21
 NOTE: THESE DRAWINGS AND DESIGNS ARE STRICTLY CONFIDENTIAL AND PROTECTED BY INTERNATIONAL COPYRIGHT LAW. DETAILS MUST NOT BE DISCLOSED, REPRODUCED OR COMMUNICATED TO A 3rd PARTY IN ANY FORM OR MANNER WITHOUT THE PRIOR WRITTEN APPROVAL OF APPLIED TECHNOLOGY & MANAGEMENT.

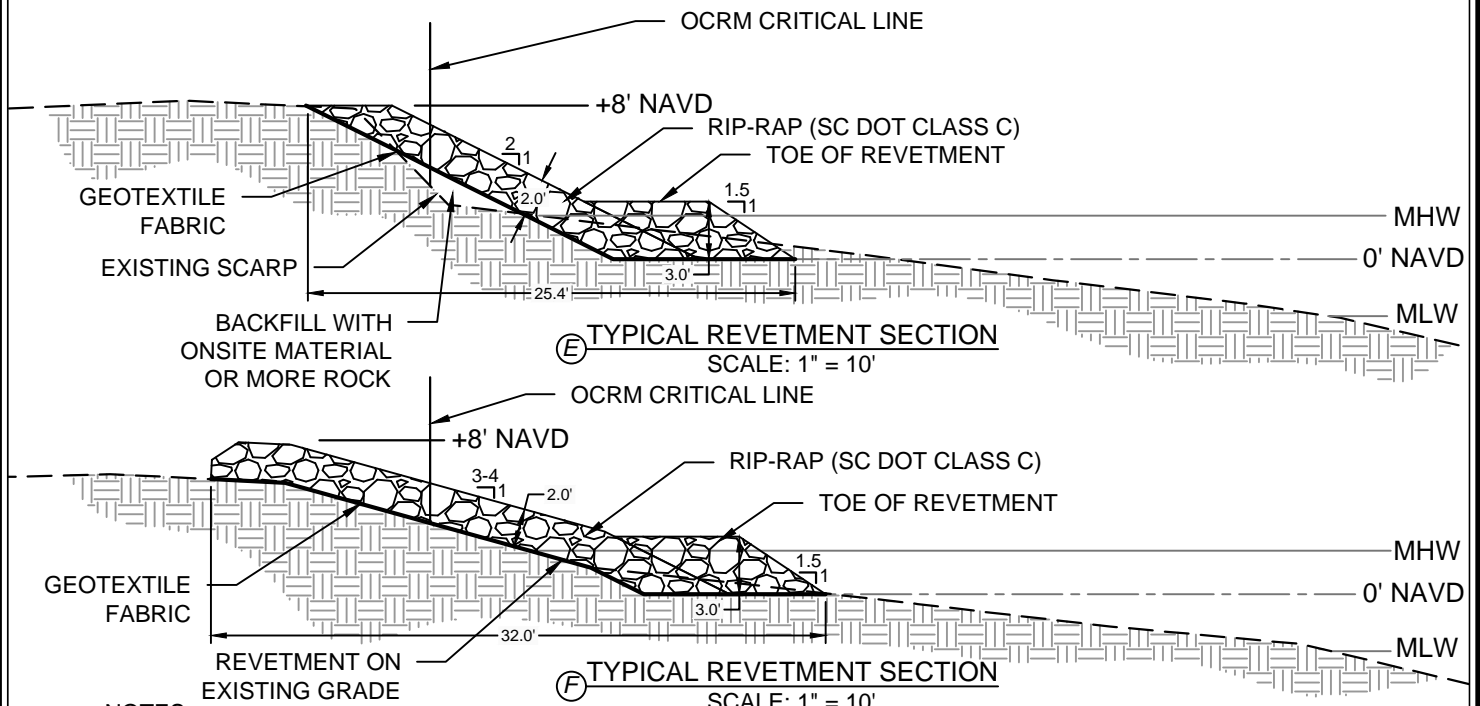
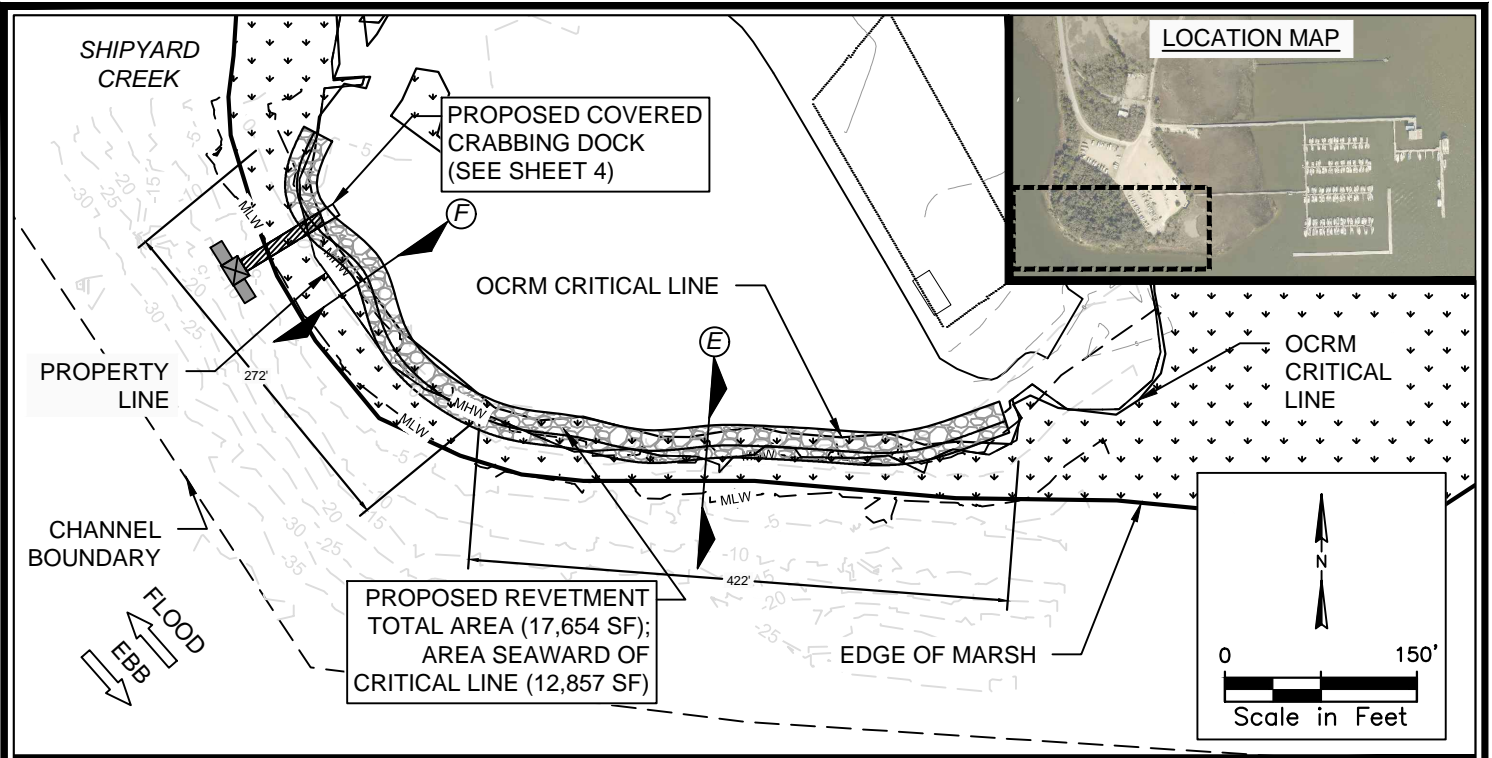

NOTES:

1. OCRM CRITICAL LINE CERTIFIED BY KELSEY MARIE MURDAUGH ON 06/14/2019.
2. CONTOURS AND PROFILES BASED ON FEBRUARY 2020 SURVEY BY FORESIGHT SURVEYING, LLC.
3. VERTICAL DATUM IS NAVD88 AND ELEVATIONS AND DISTANCES ARE IN FEET.

PROJECT: Cooper River County Park Marine Improvements
WATERBODY: Cooper River
COUNTY: Charleston
STATE: South Carolina
LATITUDE: 32°49'54.50"N
LONGITUDE: 79°56'16.63"W

ACTIVITY 6 - PROPOSED REVETMENT DETAILS

Owner: Charleston County Parks & Recreation

Address: 1010 Juneau Ave., N. Charleston, SC

Parcel ID: 4000000037



8-March-2021
 SHEET 9