

JOINT
PUBLIC NOTICE

CHARLESTON DISTRICT, CORPS OF ENGINEERS
69A Hagood Avenue
Charleston, South Carolina 29403-5107
and
THE S.C. DEPARTMENT OF HEALTH AND ENVIRONMENTAL CONTROL
Office of Ocean and Coastal Resource Management
1362 McMillan Avenue, Suite 400
Charleston, South Carolina 29405

REGULATORY DIVISION

Refer to: P/N # SAC-2015-00966-3IY

DATE

August 19, 2015

Pursuant to Section 10 of the Rivers and Harbors Act of 1899 (33 U.S.C. 403), and the South Carolina Coastal Zone Management Act (48-39-10 et.seq.), an application has been submitted to the Department of the Army and the South Carolina Department of Health and Environmental Control by

Kenneth Mincey
c/o Beam & Associates
Dr. H. Wayne Beam
PO Box 3238
North Myrtle Beach, SC 29582

for additions to an existing private use dock in the

ATLANTIC INTRACOASTAL WATERWAY

at 256 Park Street, Little River, Horry County, South Carolina (Latitude: 33.85662°N; Longitude: -78.65058°W / USGS-Wampee Quad).

In order to give all interested parties an opportunity to express their views

NOTICE

is hereby given that written statements regarding the proposed work will be received by the **Corps** until

15 Days from the Date of this Notice,

and **SCDHEC** will receive written statements regarding the proposed work until

30 Days from the Date of this Notice

from those interested in the activity and whose interests may be affected by the proposed work.

The proposed work consists of additions to an existing private use dock. In detail the project consists of the addition of a 4' x 45' walkway connecting a 12' x 12' covered pierhead to an existing structure. A 10' x 24' floating dock will be attached to the walkway by a 3' x 25' ramp. Finally, a 12' x 20' covered boat lift will be situated between the covered pierhead and floating

dock. The applicant stated that normal and customary practices, which include best management practices to minimize erosion and sediment migration, litter receptacles, and necessary measures to prevent oil, tar, debris, and other pollutants from entering Waters of the United States, would be employed by the contractor during construction. Furthermore the applicant stated that construction activities would avoid, to the maximum extent practicable, encroachment into any areas not designated as impact areas. The applicant offered no mitigation for the project. The project purpose is recreational access.

NOTE: This public notice and associated plans are available on the Corps' website at: <http://www.sac.usace.army.mil/Missions/Regulatory/PublicNotices> . For those unable to access the website, a copy of this notice and the associated plans will be provided, upon receipt of a written request. The request must identify the project of interest by public notice number and a self-addressed stamped envelope must also be provided. Your request should be addressed to the

**U.S. Army Corps of Engineers
ATTN: REGULATORY DIVISION
1949 Industrial Park Road, Room 140
Conway, South Carolina 29526**

The work shown on this application must also be certified as consistent with applicable provisions of the Coastal Zone Management Program (15 CFR 930). This activity may also require evaluation for compliance with the S. C. Construction in Navigable Waters Permit Program. State review, permitting and certification is conducted by the S. C. Department of Health and Environmental Control. The District Engineer will not process this application to a conclusion until such certifications are received. The applicant is hereby advised that supplemental information may be required by the State to facilitate the review.

This notice initiates the Essential Fish Habitat (EFH) consultation requirements of the Magnuson-Stevens Fishery Conservation and Management Act. Implementation of the proposed project would impact 0.018 acres of estuarine substrates and emergent wetlands utilized by various life stages of species comprising the shrimp, and snapper-grouper management complexes. The District Engineer's initial determination is that the proposed action would not have a substantial individual or cumulative adverse impact on EFH or fisheries managed by the South Atlantic Fishery Management Council and the National Marine Fisheries Service (NMFS). The District Engineer's final determination relative to project impacts and the need for mitigation measures is subject to review by and coordination with the NMFS.

Pursuant to the Section 7 of the Endangered Species Act of 1973 (as amended), the Corps has reviewed the project area, examined all information provided by the applicant, and the District Engineer has determined that the project is not likely to adversely affect any Federally endangered, threatened, or proposed species or result in the destruction or adverse modification of designated or proposed critical habitat. This public notice serves as a request for written concurrence from the U.S. Fish and Wildlife Service and/or the National Marine Fisheries Service on this determination.

Pursuant to Section 106 of the National Historic Preservation Act (NHPA), this public notice also constitutes a request to Indian Tribes to notify the District Engineer of any historic properties of religious and cultural significance to them that may be affected by the proposed undertaking.

In accordance with Section 106 of the NHPA, the District Engineer has consulted South Carolina ArchSite (GIS), for the presence or absence of historic properties (as defined in 36 C.F.R. 800.16)(1)(1)), and has initially determined that no historic properties are present; therefore, there will be no effect on historic properties. To ensure that other historic properties that the District Engineer is not aware of are not overlooked, this public notice also serves as a request to the State Historic Preservation Office and any other interested parties to provide any information they may have with regard to historic properties. This public notice serves as a request for concurrence within 30 days from the SHPO (and/or Tribal Historic Preservation Officer).

The District Engineer's final eligibility and effect determination will be based upon coordination with the SHPO and/or THPO, as appropriate and required and with full consideration given to the proposed undertaking's potential direct and indirect effects on historic properties within the Corps-identified permit area.

Any person may request, in writing, within the comment period specified in this notice, that a public hearing be held to consider this application. Requests for a public hearing shall state, with particularity, the reasons for holding a public hearing.

The decision whether to issue a permit will be based on an evaluation of the probable impact including cumulative impacts of the activity on the public interest and will include application of the guidelines promulgated by the Administrator, Environmental Protection Agency (EPA), under authority of Section 404(b) of the Clean Water Act and, as appropriate, the criteria established under authority of Section 102 of the Marine Protection, Research and Sanctuaries Act of 1972, as amended. That decision will reflect the national concern for both protection and utilization of important resources. The benefit which reasonably may be expected to accrue from the project must be balanced against its reasonably foreseeable detriments. All factors which may be relevant to the project will be considered including the cumulative effects thereof; among those are conservation, economics, aesthetics, general environmental concerns, wetlands, historic properties, fish and wildlife values, flood hazards, flood plain values, land use, navigation, shoreline erosion and accretion, recreation, water supply and conservation, water quality, energy needs, safety, food and fiber production and, in general, the needs and welfare of the people. A permit will be granted unless the District Engineer determines that it would be contrary to the public interest. In cases of conflicting property rights, the Corps cannot undertake to adjudicate rival claims.

The Corps is soliciting comments from the public; Federal, state, and local agencies and officials; Indian Tribes; and other interested parties in order to consider and evaluate the impacts of this activity. Any comments received will be considered by the Corps to determine whether to issue, modify, condition or deny a permit for this project. To make this decision, comments are used to assess impacts on endangered species, historic properties, water quality, general environmental effects, and the other public interest factors listed above. Comments are used in the preparation of an Environmental Assessment and/or an Environmental Impact Statement pursuant to the National Environmental Policy Act. Comments are also used to determine the need for a public hearing and to determine the overall public interest of the activity.

If there are any questions concerning this public notice, please contact **T. Brian Hardee** at 843-329-8044 or toll free at 1-866-329-8187.

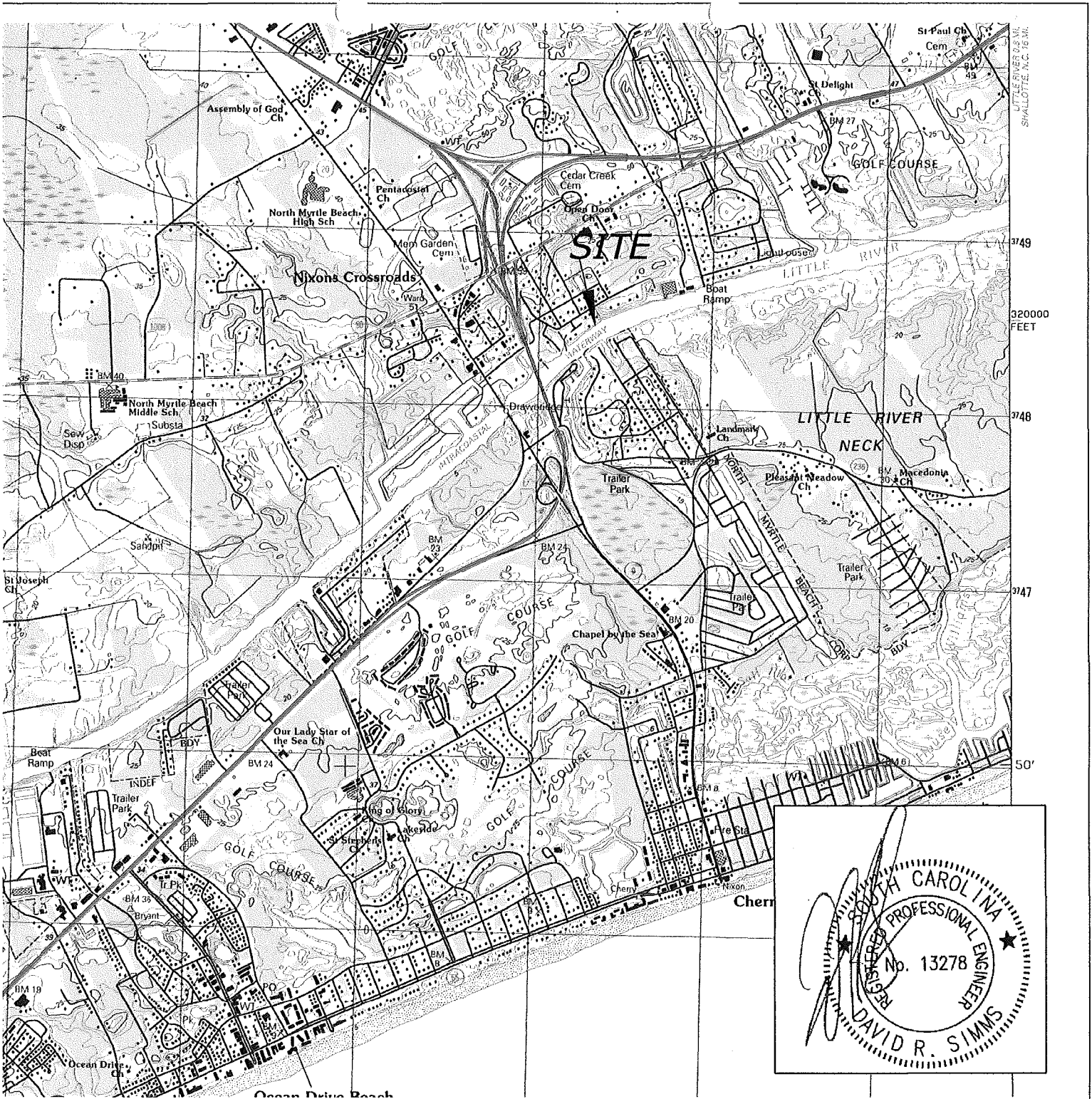

LOCATION MAP

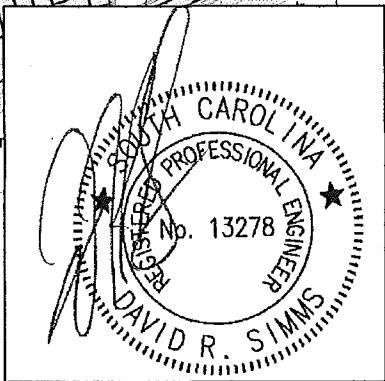

FOR PERMITTING ONLY
NOT FOR CONSTRUCTION

WAMPEE QUAD

<p>APPLICANT: DR. KEN MINCEY</p> <p>ACTIVITY: Construct Walkway, Pier Head Ramp, Floating Dock & Lift P/N#</p>	<p>LOCATION: Intracoastal Waterway North Myrtle Beach</p> <p>COUNTY: Horry</p> <p>DATE: 7/15/2015</p>	<p>SHEET 1 OF 6</p>
---	---	---------------------

PARK STREET
50' PUBLIC R/W

100.00 (PLAT)
98.3' (DEED)

RBS
N 744386.18
E 2713041.86

CMF
N 744332.24
E 2712957.65

#246
EXISTING RESIDENCE
& IMPROVEMENTS
NOT SHOWN

+/-29,125 SQ.FT.
0.66 ACRE

DRAINAGE CANAL
S32°38'34"E
294.50

PROPERTY LINE

LOT A & PT. LOT B
PIN#
351-01-01-0062
N/F STEPHEN R. PARKER
DB.2109 @ PG.926

"C.A. BURGDORFF"
PIN#

350-04-02-0037

N/F JAMES B. & GLADYS H. SESSOMS
DB.3499 @ PG.2343

260.40-PLATTED
N32°38'34"W
(288.01 TOTAL)

EXIST. RAMP, DOCK
& BULKHEAD

320' R/W (160' FROM CENTERLINE)

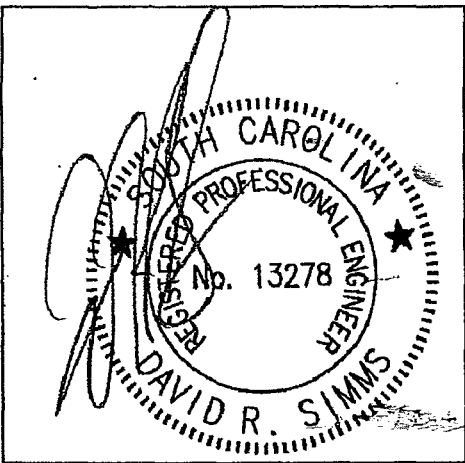

FOR PERMITTING ONLY
NOT FOR CONSTRUCTION

SITE PLAN

0 25 50 100



1"=50'

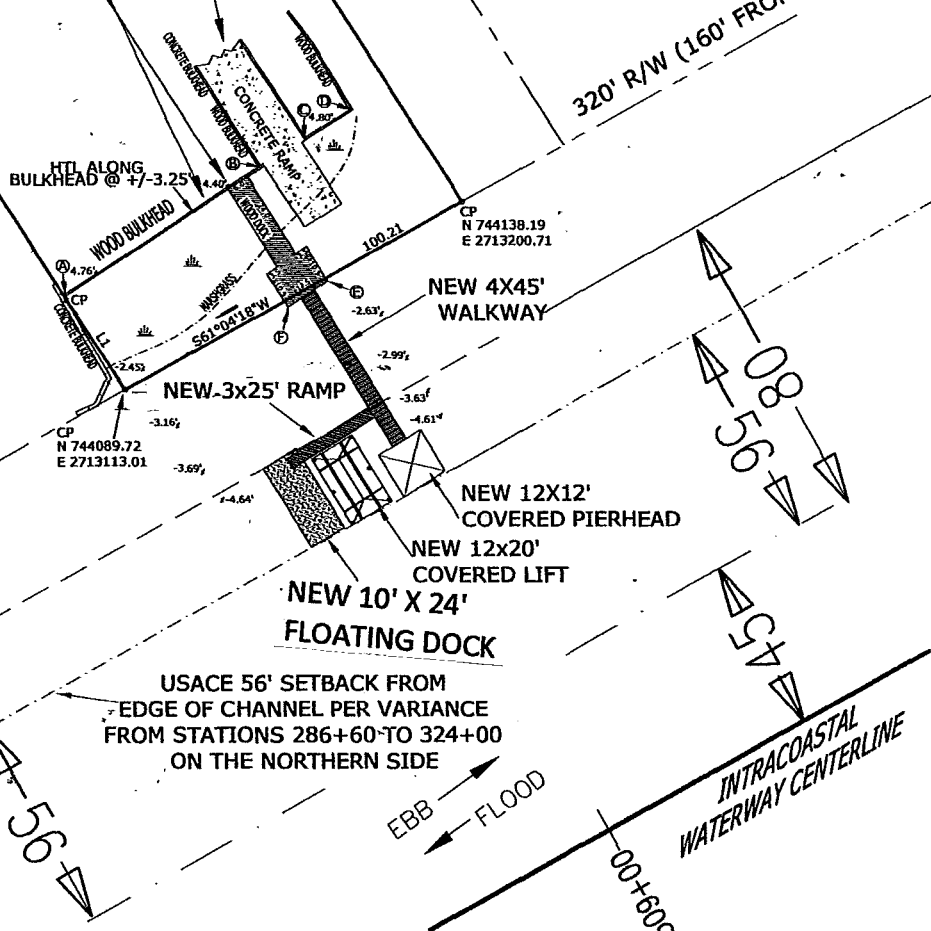

USACE 56' SETBACK FROM
EDGE OF CHANNEL PER VARIANCE
FROM STATIONS 286+60 TO 324+00
ON THE NORTHERN SIDE

EBB
FLOOD

INTRACOASTAL
WATERWAY CENTERLINE

APPLICANT: **DR. KEN MINCEY**

LOCATION:

Intracoastal Waterway

North Myrtle Beach

ACTIVITY:
Construct Walkway, Pier Head
Ramp, Floating Dock & Lift

COUNTY: Horry

DATE: 7/15/2015

P/N#

SHEET 2 OF 6

COORDINATE TABLE		
POINT	EAST	NORTH
1	2713161.36	744049.03
2	2713169.88	744054.27
3	2713171.88	744054.84
4	2713182.10	744061.13
5	2713185.28	744062.25
6	2713195.92	744068.80

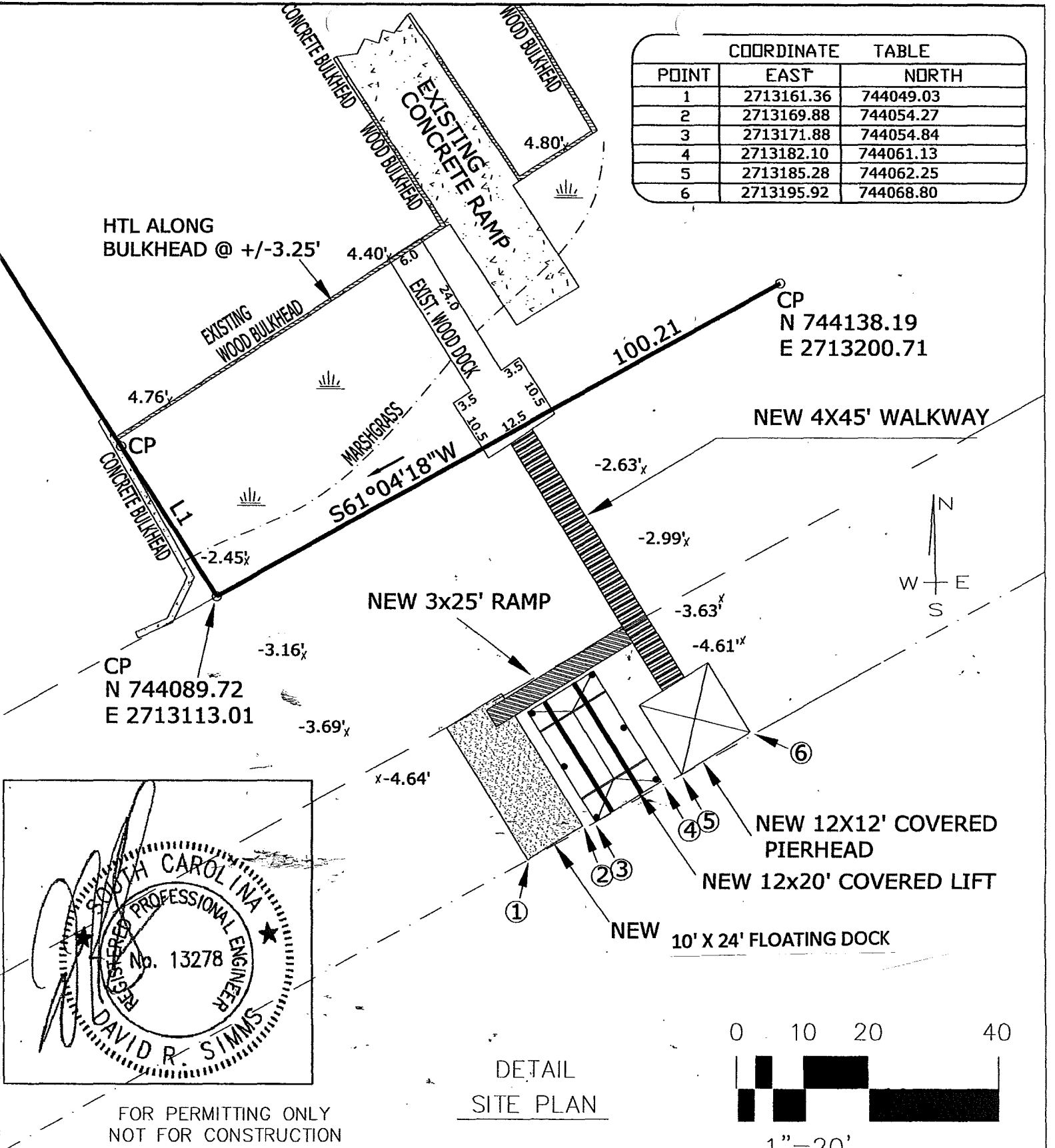

APPLICANT: **DR. KEN MINCEY**
 ACTIVITY:
 Construct Walkway, Pier Head
 Ramp, Floating Dock & Lift
 P/N#

LOCATION:
 Intracoastal Waterway
 North Myrtle Beach
 COUNTY: **Horry**
 DATE: **7/15/2015**

SHEET 3 OF 6

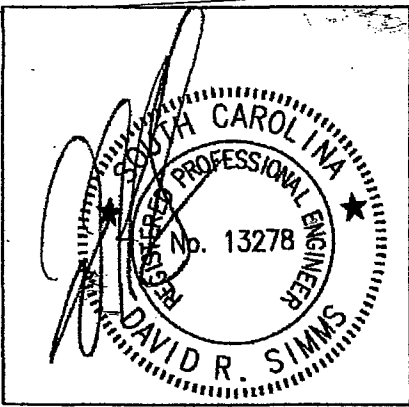
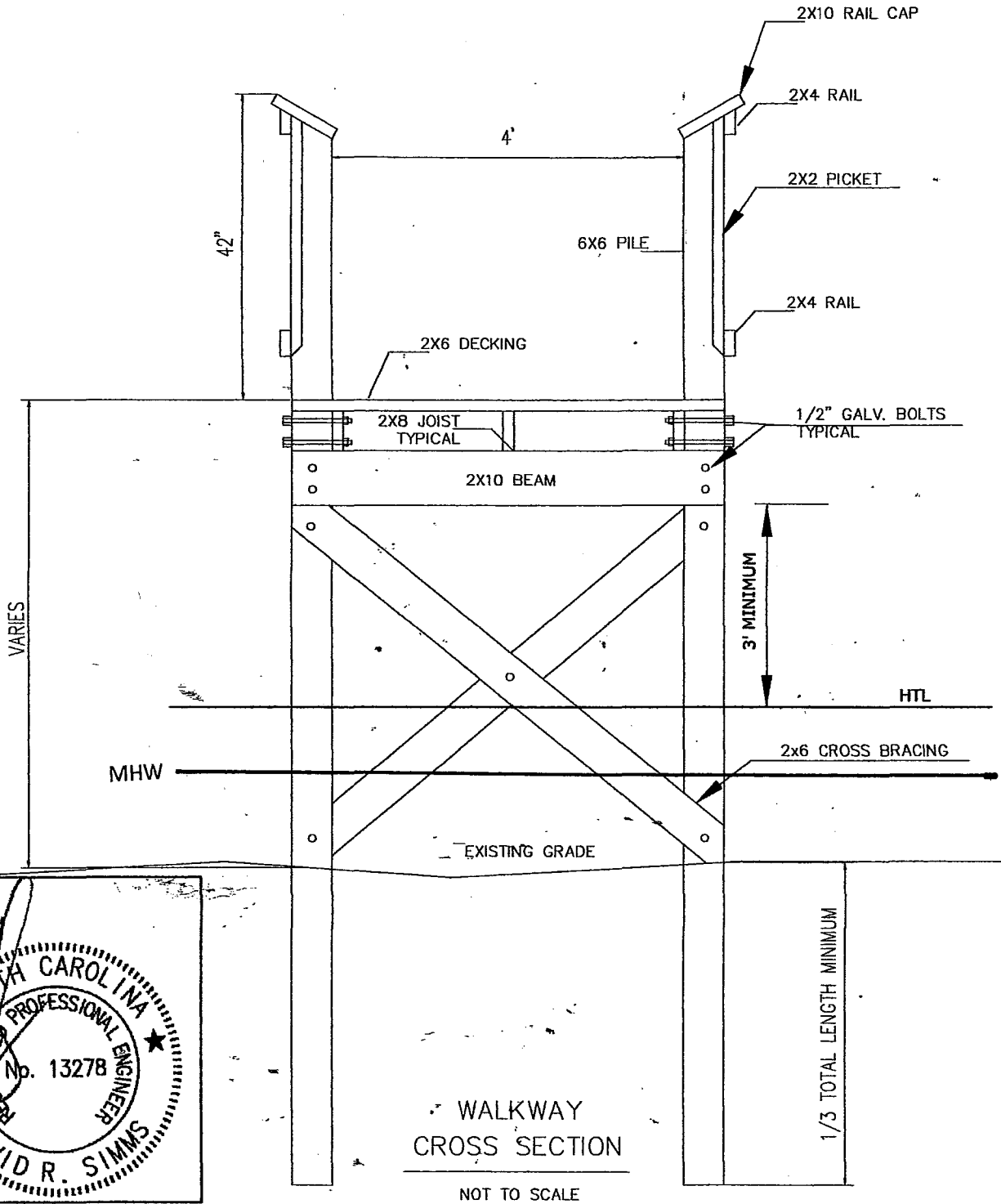

FOR PERMITTING ONLY
NOT FOR CONSTRUCTION

APPLICANT:
DR. KEN MINCEY

ACTIVITY:
Construct Walkway, Pier Head
Ramp, Floating Dock & Lift

P/N#

LOCATION:
Intracoastal Waterway
North Myrtle Beach

COUNTY: Horry
DATE: 7/15/2015

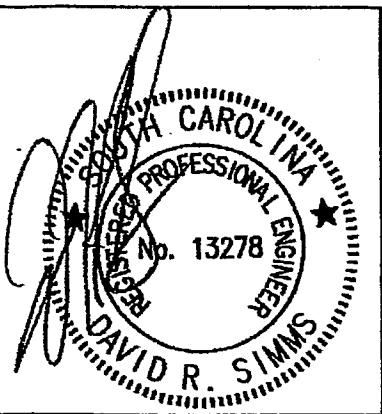

FOR PERMITTING ONLY
NOT FOR CONSTRUCTION

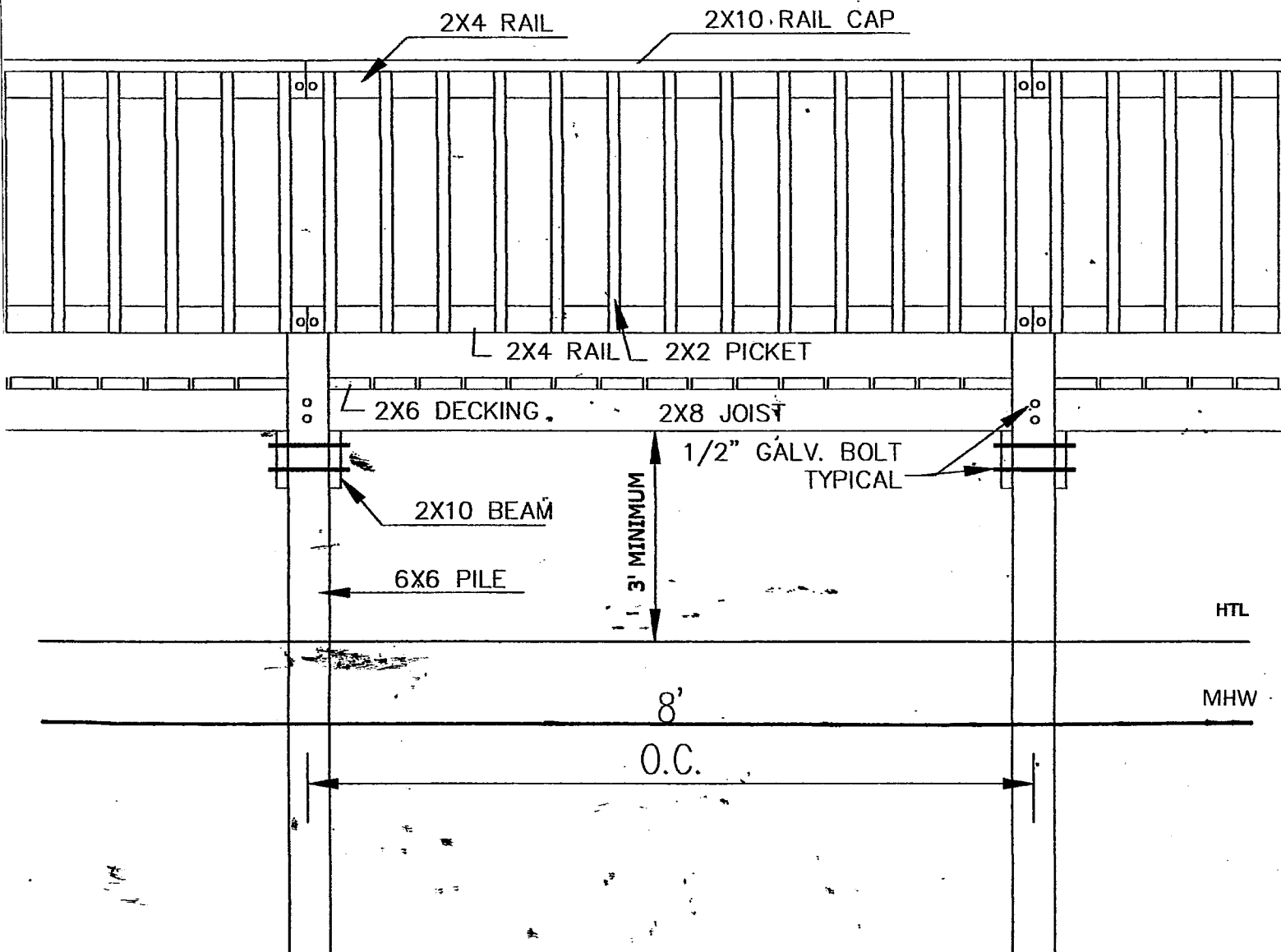

WALKWAY ELEVATION
NOT TO SCALE

<p>APPLICANT: DR. KEN MINCEY</p> <p>ACTIVITY: Construct Walkway, Pier Head Ramp, Floating Dock & Lift P/N#</p>	<p>LOCATION: Intracoastal Waterway North Myrtle Beach</p> <p>COUNTY: Horry</p> <p>DATE: 7/15/2015</p>	<p>SHEET 5 of 6</p>
---	---	---------------------

EXTENDED PROPERTY LINE

12X20' ROOF WITH 1' OVERHANG

12X12" ROOF WITH 1' OVERHANG

EXTENDED PROPERTY LINE

20' MINIMUM

FLOAT

10'

12'

LIFT

10'

PIER HEAD

12'

20' MINIMUM

HTL

LTL

MHW

BOTTOM

1/3 LENGTH

8" DIA. PILINGS

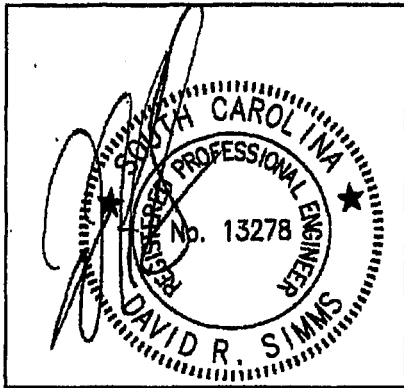

SECTION - FLOAT/LIFT/PIERHEAD

NTS

FOR PERMITTING ONLY
NOT FOR CONSTRUCTION

APPLICANT: **DR. KEN MINCEY**

ACTIVITY:
Construct Walkway, Pier Head
Ramp, Floating Dock & Lift

P/N#

LOCATION:
Intracoastal Waterway
North Myrtle Beach

COUNTY: Horry
DATE: 7/15/2015