

JOINT
PUBLIC NOTICE

CHARLESTON DISTRICT, CORPS OF ENGINEERS
1949 Industrial Park Road, Room 140
Conway, South Carolina 29526
and the

THE S.C. DEPARTMENT OF HEALTH AND ENVIRONMENTAL CONTROL
Office of Environmental Quality Control
Water Quality Certification and Wetlands Programs Section
2600 Bull Street
Columbia, South Carolina 29201

REGULATORY DIVISION

January 30, 2015

Refer to: P/N # 2012-00869-3I (REVISED)

Pursuant to Section 10 of the Rivers and Harbors Act of 1899 (33 U.S.C. 403), Sections 401 and 404 of the Clean Water Act (33 U.S.C. 1344), the South Carolina Coastal Zone Management Act (48-39-10 et seq.), and the S.C. Construction in Navigable Waters Permit Program (R. 19-450, et seq., 1976 S.C. Code of Laws, as amended), an application has been submitted to the Department of the Army and the S.C. Department of Health and Environmental Control by

Fourteenpointsix Acres, LLC / Brad Skidmore
c/o H. WAYNE BEAM
PO Box 3238
North Myrtle Beach, SC 29582

for a permit to construct a private recreational community dock in the

ATLANTIC INTRACOASTAL WATERWAY

located at terminus of Old Sanders Drive, Little River, Horry County, South Carolina
(Latitude: 33.835898°N; Longitude -78.683189°W).

In order to give all interested parties an opportunity to express their views

NOTICE

is hereby given that written statements regarding the proposed work will be received by the **Corps** until

15 Days from the Date of this Notice,

and **SCDHEC** will receive written statements regarding the proposed work until

30 Days from the Date of this Notice

from those interested in the activity and whose interests may be affected by the proposed work. The proposed work consists of the construction of a private recreational community dock and bank stabilization. In detail, the project consists of the construction of a 20' x 20' pierhead attached to the proposed bulkhead by a 10' x 38' walkway. Attached to both the upstream and downstream side of the pierhead will be two 8' x 50' sloped walkways. The sloped walkways will each connect to an L-shaped walkway and situated landward of the boat lifts. The upstream walkway will consist of a 5' x 198' section running parallel to the bank and a 5' x 32' section perpendicular to the bank. The downstream walkway will consist of a 5' x 525' section running parallel to

REGULATORY DIVISION

January 30, 2015

Refer to: P/N # 2012-00869-3I

the bank and a 5' x 23' section perpendicular to the bank. Additionally, the applicant proposed to construct 12 15' x 40' boat lifts upstream of the pierhead, separated by 6 3' x 40' finger docks and 39 12' x 30' boat lifts downstream of the pierhead, separated by 19 3' x 30' finger docks. Finally, the applicant proposes 1045 linear feet of bulkhead for bank stabilization. The applicant offered no compensatory mitigation for impacts associated with the proposed work. The applicant stated that necessary measures will be taken to prevent oil, tar, debris, and other pollutants from entering waters of the US and construction activities would avoid, to the maximum extent practicable, encroachment into any areas not designated as impact areas. The purpose of the proposed work, as stated by the applicant, is boating access.

NOTE: Plans depicting the work described in this notice are available and will be provided, upon receipt of a written request, to anyone that is interested in obtaining a copy of the plans for the specific project. The request must identify the project of interest by public notice number and a self-addressed stamped envelope must also be provided for mailing the drawings to you. Your request for drawings should be addressed to the

**U.S. Army Corps of Engineers
ATTN: REGULATORY DIVISION
1949 Industrial Park Road, Room 140
Conway, South Carolina 29526**

The work shown on this application must also be certified as consistent with applicable provisions of the Coastal Zone Management Program (15 CFR 930). The District Engineer will not process this application to a conclusion until such certification is received. The applicant is hereby advised that supplemental information may be required by the State to facilitate the review. Persons wishing to comment or object to State certification must submit all comments in writing to the South Carolina Department of Health and Environmental Control at the above address within thirty (30) days of the date of this notice.

This notice initiates the Essential Fish Habitat (EFH) consultation requirements of the Magnuson-Stevens Fishery Conservation and Management Act. Implementation of the proposed project would impact (0.64) acres of estuarine substrates and emergent wetlands utilized by various life stages of species comprising the red drum, shrimp, and snapper-grouper management complexes. Our initial determination is that the proposed action would not have a substantial individual or cumulative adverse impact on EFH or fisheries managed by the South Atlantic Fishery Management Council and the National Marine Fisheries Service (NMFS). Our final determination relative to project impacts and the need for mitigation measures is subject to review by and coordination with the NMFS.

The District Engineer has consulted the most recently available information and has determined that the project is not likely to adversely affect any Federally endangered, threatened, or proposed species and will not result in the destruction or adverse modification of designated or proposed critical habitat. This public notice serves as a request to the U.S. Fish and Wildlife Service and the National Marine Fisheries Service for any additional information they may have on whether any listed or proposed endangered or threatened species or designated or proposed critical habitat may be present in the area which would be affected by the activity, pursuant to Section 7(c) of the Endangered Species Act of 1973 (as amended).

Pursuant to Section 106 of the National Historic Preservation Act (NHPA), this public notice also constitutes a request to Indian Tribes to notify the District Engineer of any historic properties of religious and cultural significance to them that may be affected by the proposed undertaking.

January 30, 2015

In accordance with the NHPA, the District Engineer has also consulted the latest published version of the National Register of Historic Places for the presence or absence of registered properties, or properties listed as being eligible for inclusion therein, and this worksite is not included as a registered property or property listed as being eligible for inclusion in the Register. To insure that other cultural resources that the District Engineer is not aware of are not overlooked, this public notice also serves as a request to the State Historic Preservation Office to provide any information it may have with regard to historic and cultural resources.

Any person may request, in writing, within the comment period specified in this notice, that a public hearing be held to consider this application. Requests for a public hearing shall state, with particularity, the reasons for holding a public hearing.

The decision whether to issue a permit will be based on an evaluation of the probable impact including cumulative impacts of the activity on the public interest. That decision will reflect the national concern for both protection and utilization of important resources. The benefit which reasonably may be expected to accrue from the project must be balanced against its reasonably foreseeable detriments. All factors which may be relevant to the project will be considered including the cumulative effects thereof; among those are conservation, economics, aesthetics, general environmental concerns, wetlands, historic properties, fish and wildlife values, flood hazards, flood plain values, land use, navigation, shoreline erosion and accretion, recreation, water supply and conservation, water quality, energy needs, safety, food and fiber production and, in general, the needs and welfare of the people. A permit will be granted unless the District Engineer determines that it would be contrary to the public interest. In cases of conflicting property rights, the Corps of Engineers cannot undertake to adjudicate rival claims.

The Corps of Engineers is soliciting comments from the public; Federal, state, and local agencies and officials; Indian Tribes; and other interested parties in order to consider and evaluate the impacts of this activity. Any comments received will be considered by the Corps of Engineers to determine whether to issue, modify, condition or deny a permit for this project. To make this decision, comments are used to assess impacts on endangered species, historic properties, water quality, general environmental effects, and the other public interest factors listed above. Comments are used in the preparation of an Environmental Assessment and/or an Environmental Impact Statement pursuant to the National Environmental Policy Act. Comments are also used to determine the need for a public hearing and to determine the overall public interest of the activity.

If there are any questions concerning this public notice, please contact T. Brian Hardee at 843-365-0848.

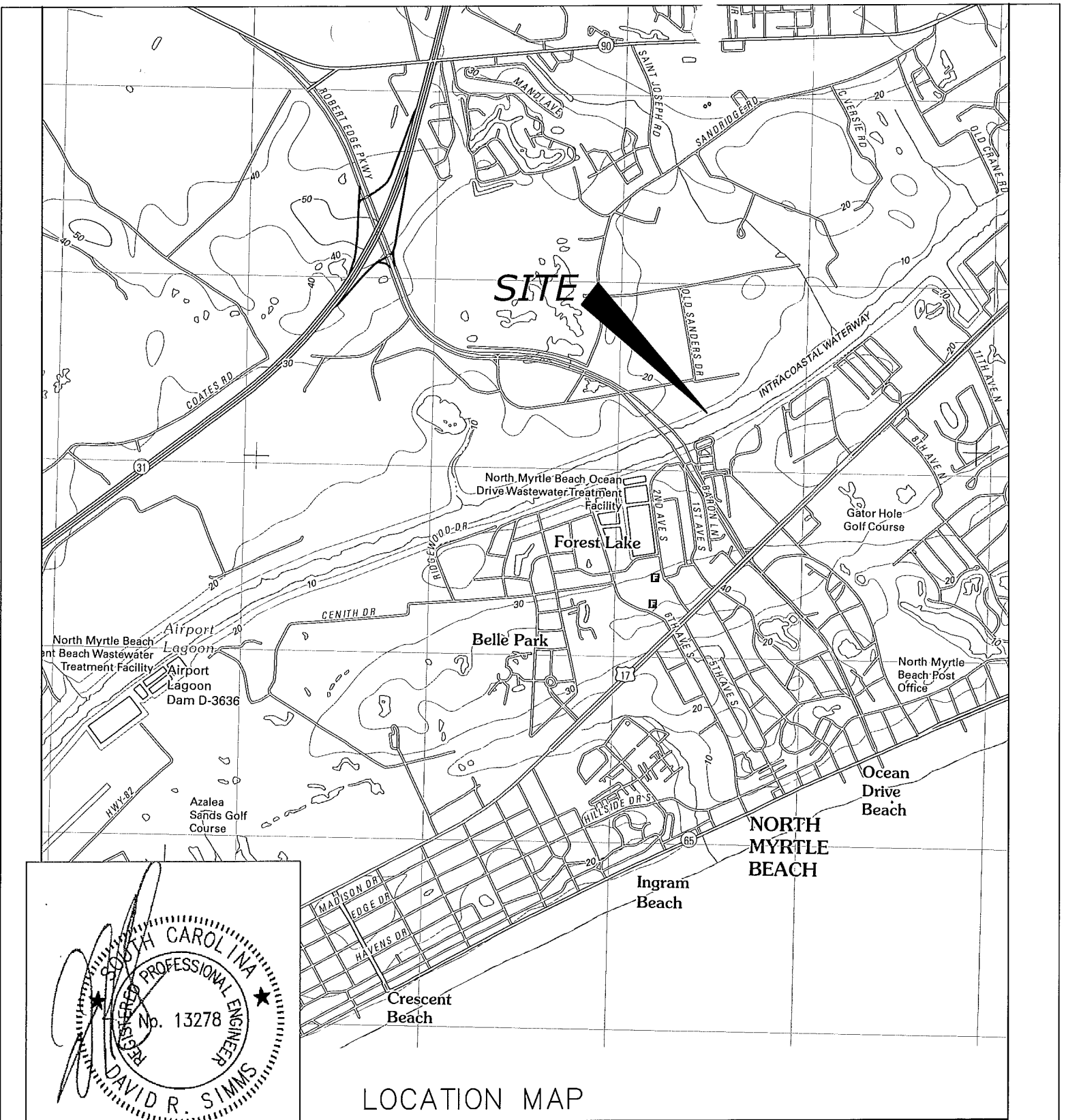

SITE

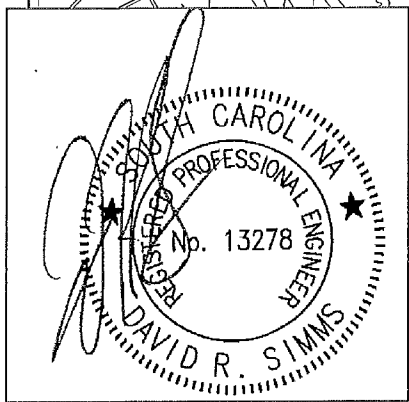
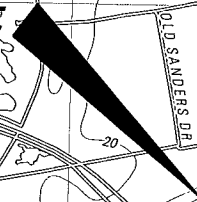

LOCATION MAP

FOR PERMITTING ONLY
NOT FOR CONSTRUCTION

WAMPEE QUAD

APPLICANT:
Fourteenpointsix Acres, LLC
ACTIVITY: Construct Fixed Piers,
Walkways, Lifts & Bulkhead
P/N#

LOCATION:
Intracoastal Waterway
North Myrtle Beach
COUNTY: Horry
DATE: 11/25/2014

SHEET 1 OF 8

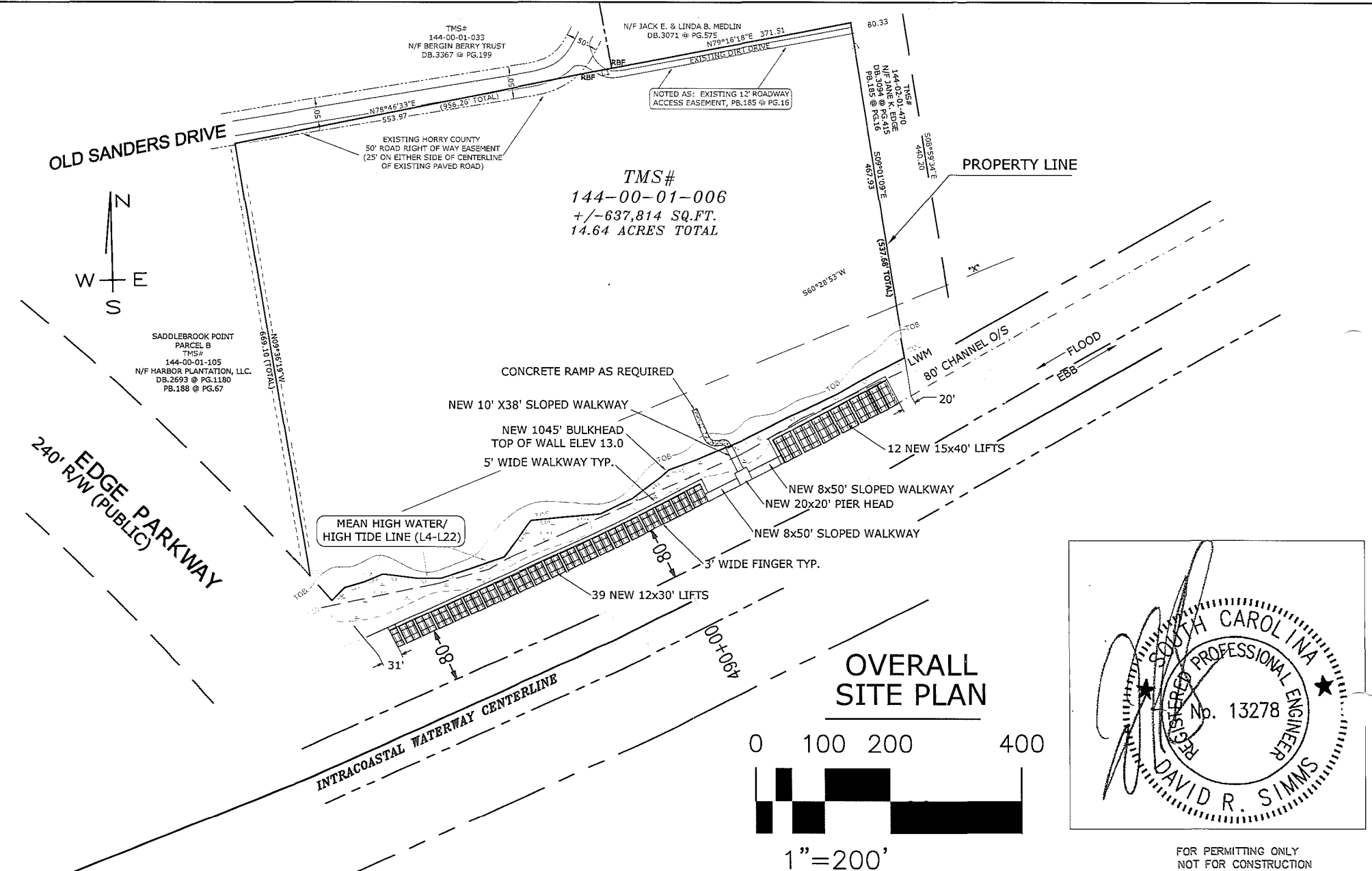

APPLICANT: **Fourteenpointsix Acres, LLC**

ACTIVITY: Construct Fixed Piers,
Walkways, Lifts & Bulkhead

P/N#

LOCATION:
Intracoastal Waterway
North Myrtle Beach
COUNTY: **Horry**
DATE: 11/25/2014

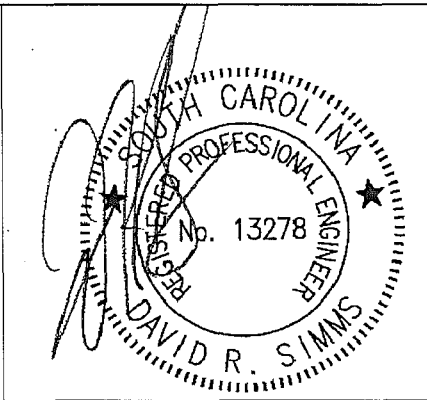

FOR PERMITTING ONLY
NOT FOR CONSTRUCTION

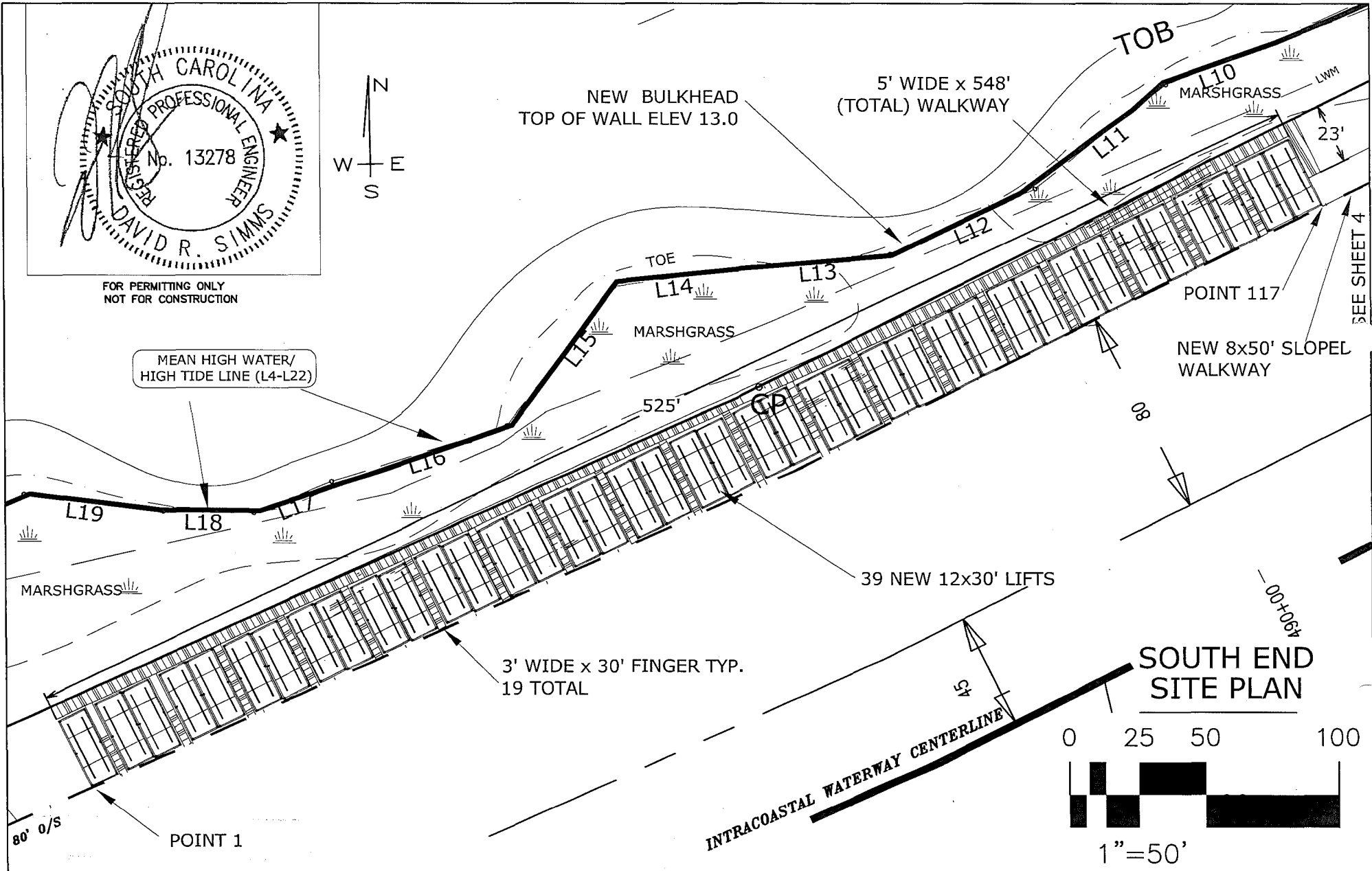

APPLICANT: Fourteenpointsix Acres, LLC

ACTIVITY: Construct Fixed Piers,
Walkways, Lifts & Bulkhead

P/N#

LOCATION:

Intracoastal Waterway
North Myrtle Beach

COUNTY: Horry

DATE: 11/25/2014

REV. 1/22/2015

SHEET 3 of 8

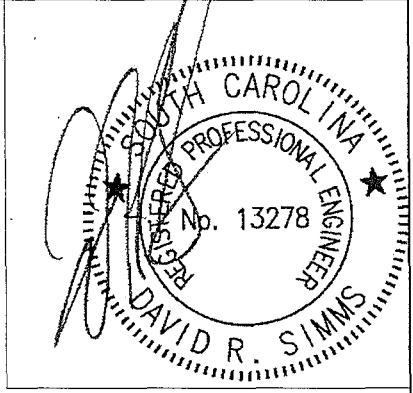
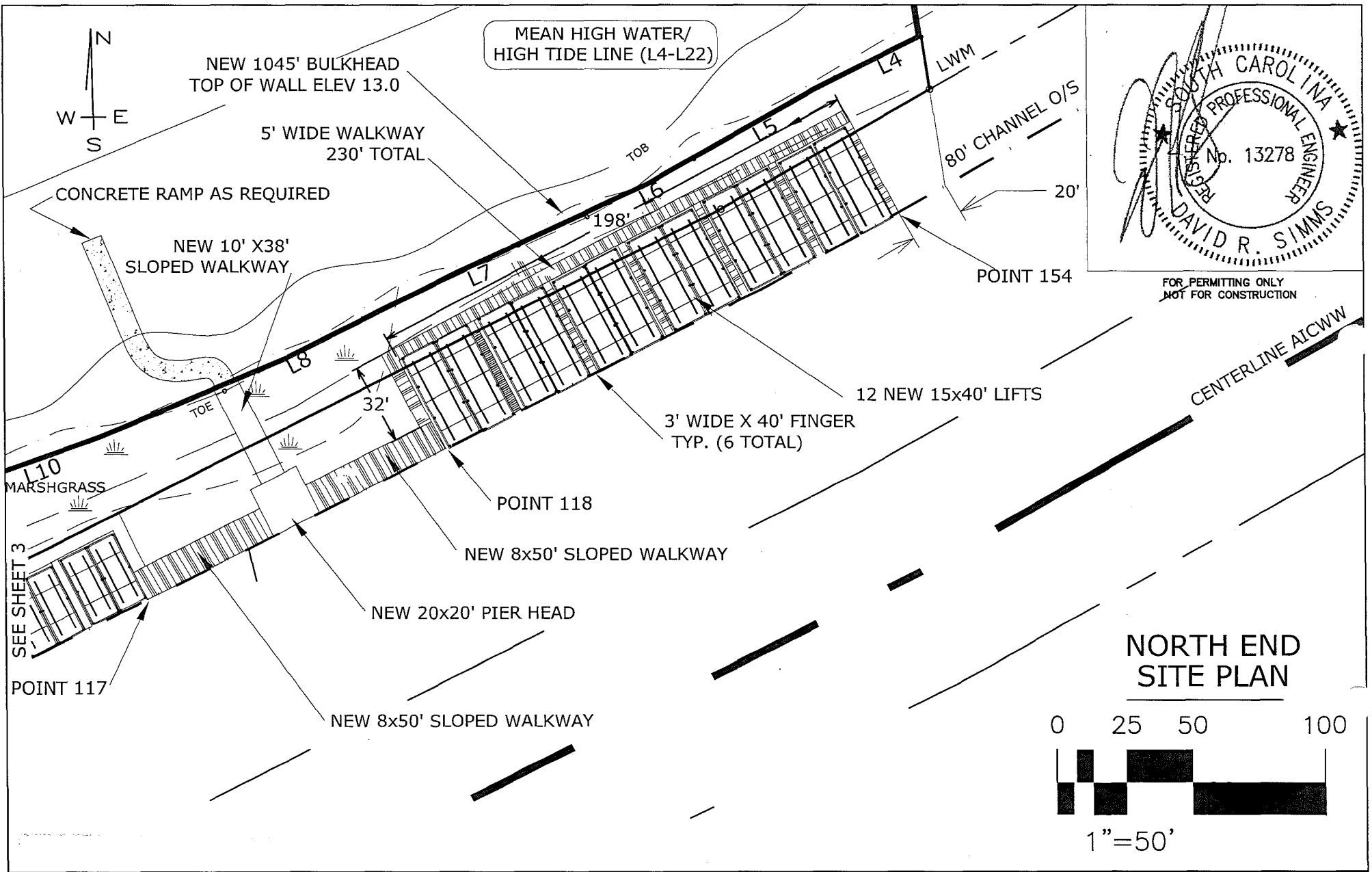

FOR PERMITTING ONLY
NOT FOR CONSTRUCTION

**NORTH END
SITE PLAN**

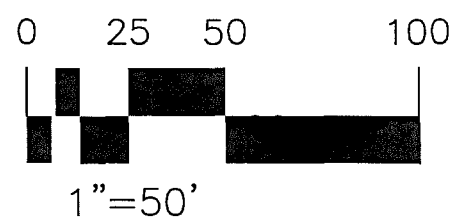

APPLICANT: Fourteenpointsix Acres, LLC
 ACTIVITY: Construct Fixed Piers,
 Walkways, Lifts & Bulkhead
 P/N#

LOCATION:
 Intracoastal Waterway
 North Myrtle Beach
 COUNTY: Horry
 DATE: 11/25/2014

REV. 1/22/2015

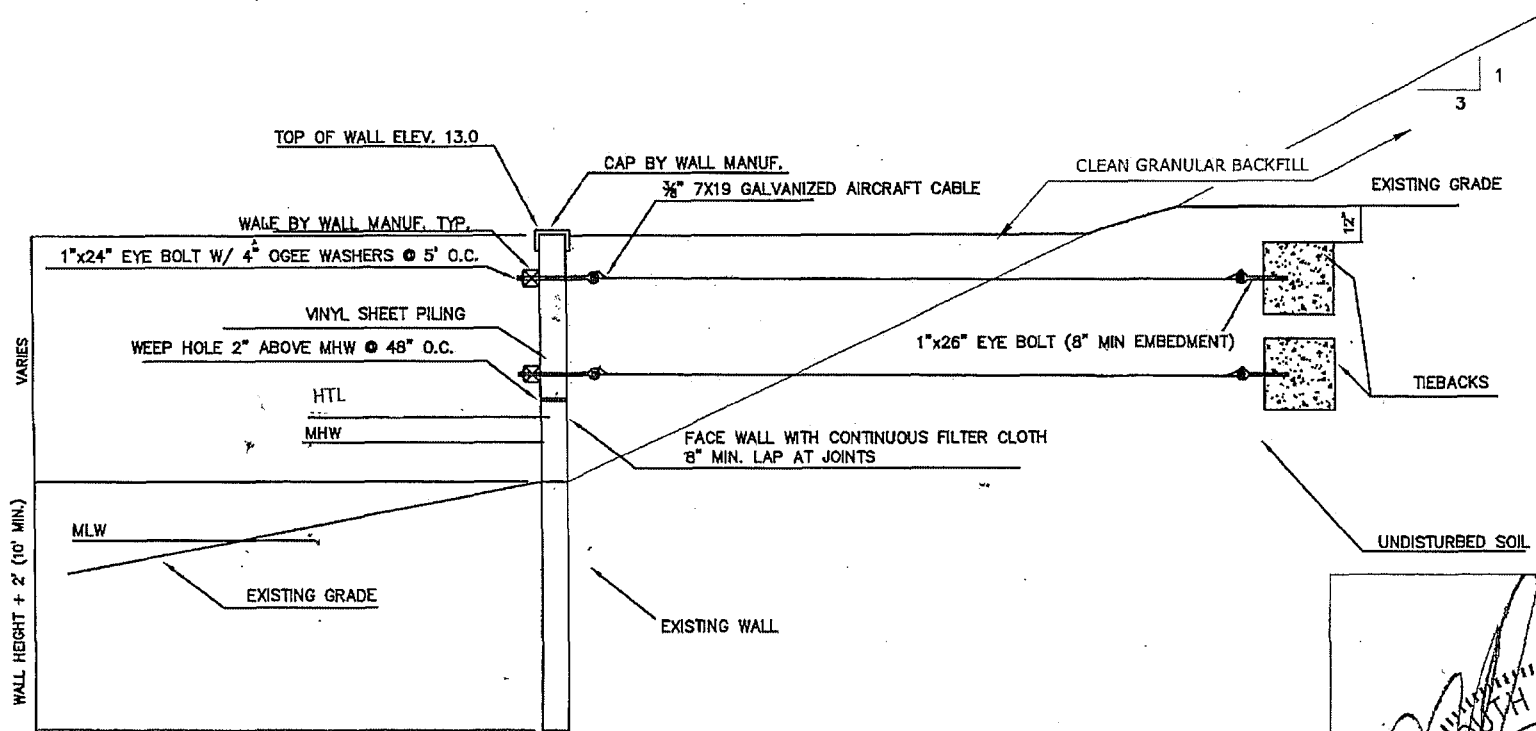

NEW BULKHEAD SECTION

NTS

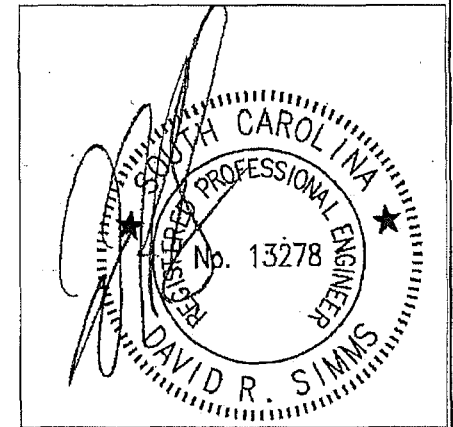

FOR PERMITTING ONLY
NOT FOR CONSTRUCTION

APPLICANT: Fourteenpointsix Acres, LLC

ACTIVITY: Construct Fixed Piers,
Walkways, Lifts & Bulkhead

P/N#

LOCATION:
Intracoastal Waterway
North Myrtle Beach
COUNTY: Horry
DATE: 11/25/2014

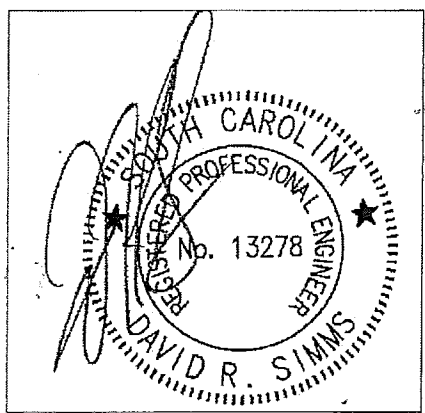
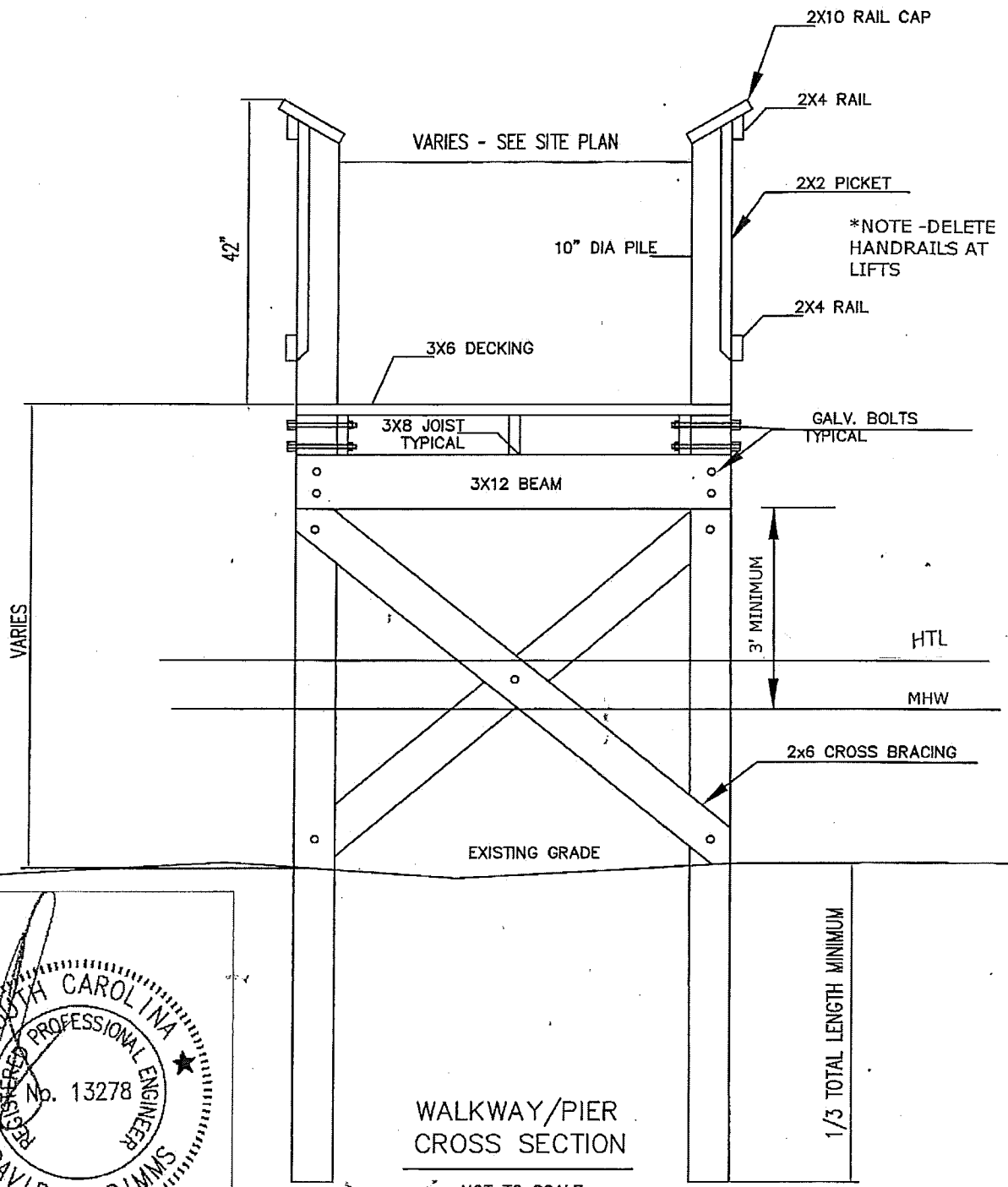

FOR PERMITTING ONLY
NOT FOR CONSTRUCTION

WALKWAY/PIER
CROSS SECTION

NOT TO SCALE

1/3 TOTAL LENGTH MINIMUM

APPLICANT:
Fourteenpointsix Acres, LLC
ACTIVITY: Construct Fixed Piers,
Walkways, Lifts & Bulkhead
P/N#

LOCATION:
Intracoastal Waterway
North Myrtle Beach
COUNTY: Horry
DATE: 11/25/2014

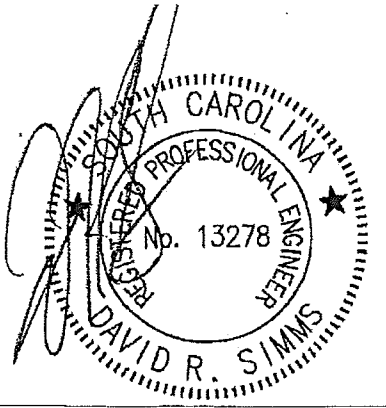

FOR PERMITTING ONLY
NOT FOR CONSTRUCTION

*NOTE -DELETE
HANDRAILS AT
LIFTS

2X4 RAIL

2X10 RAIL CAP

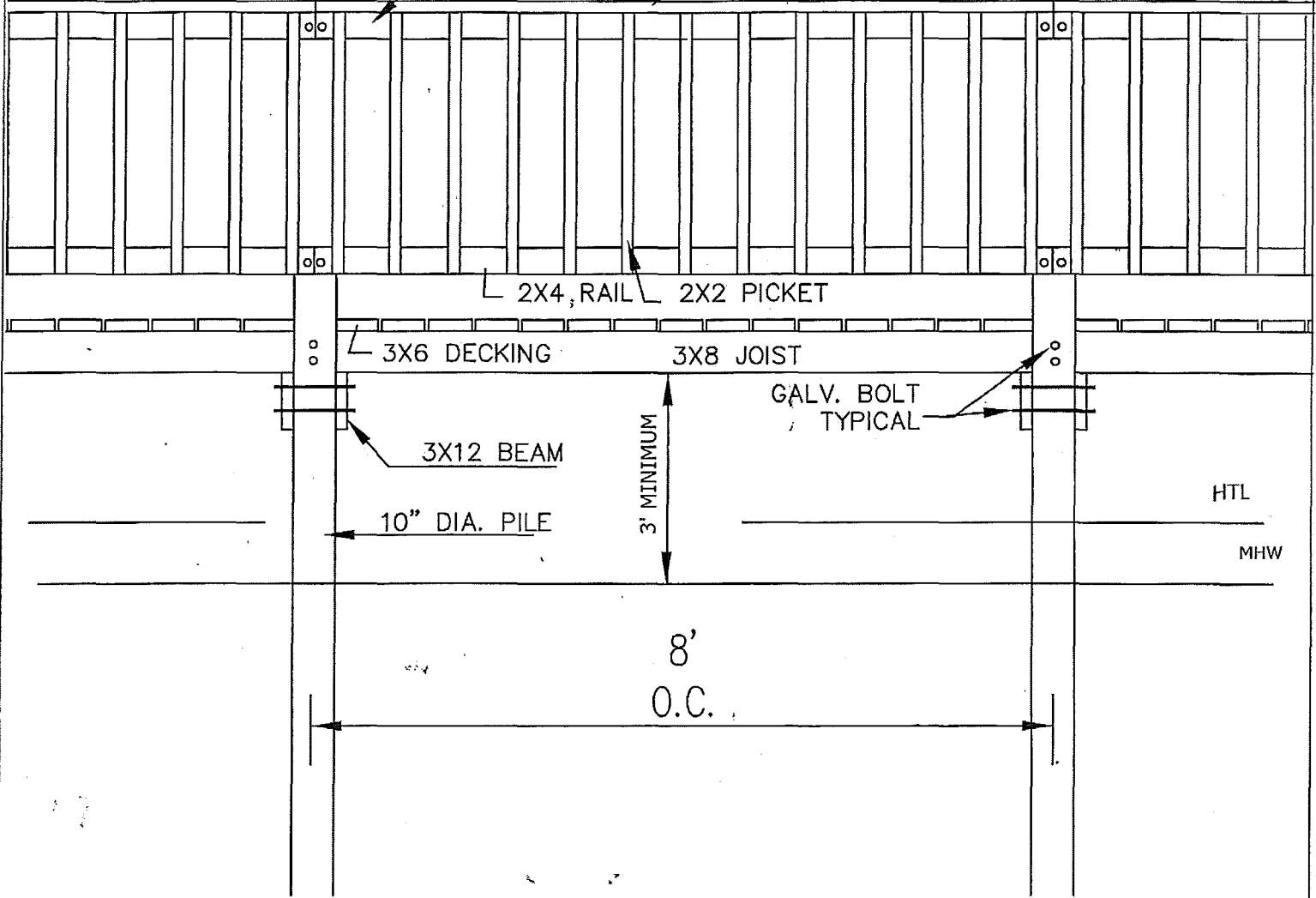

WALKWAY / PIER ELEVATION

NOT TO SCALE

APPLICANT:
Fourteenpointsix Acres, LLC

ACTIVITY: Construct Fixed Piers,
Walkways, Lifts & Bulkhead

P/N#

LOCATION:
Intracoastal Waterway
North Myrtle Beach

COUNTY: Horry

DATE: 11/25/2014

SHEET 7 of 8

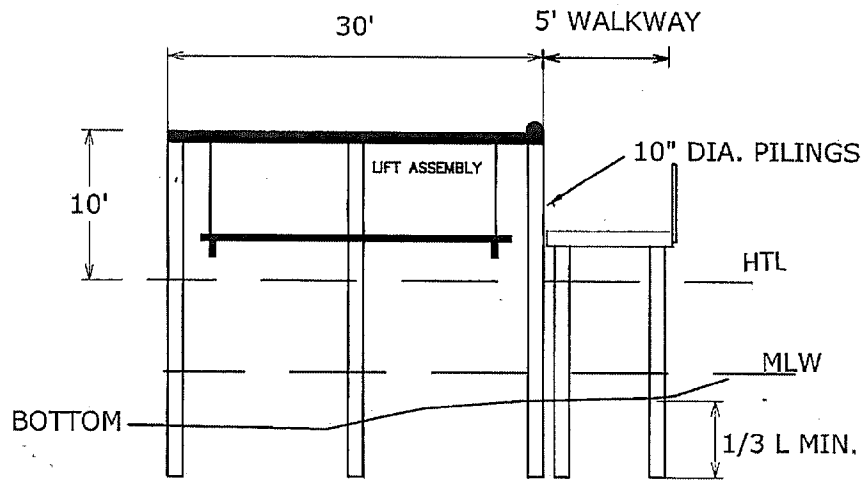

SECTION - 30' BOAT LIFT

NTS

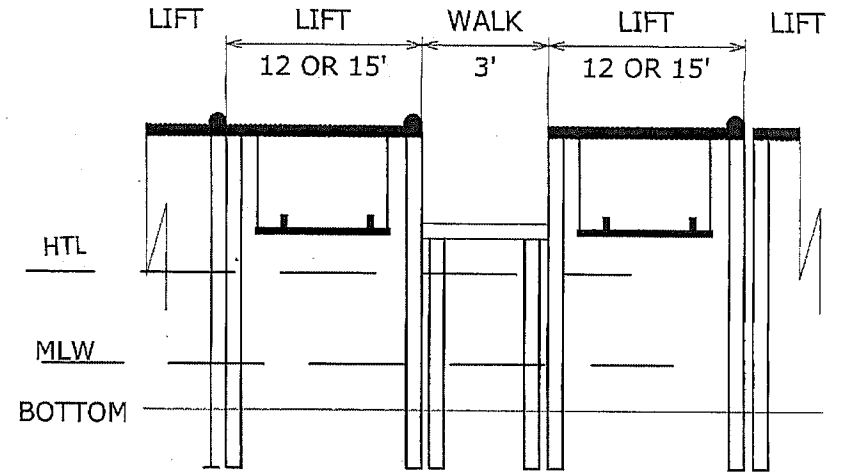

SECTION - WALKWAYS/ BOAT LIFTS

NTS

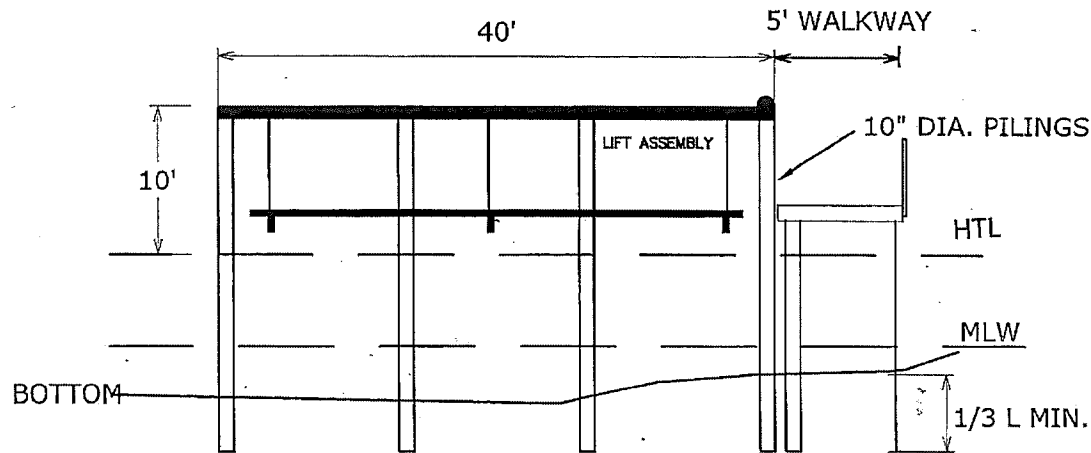

SECTION - 40' BOAT LIFT

NTS

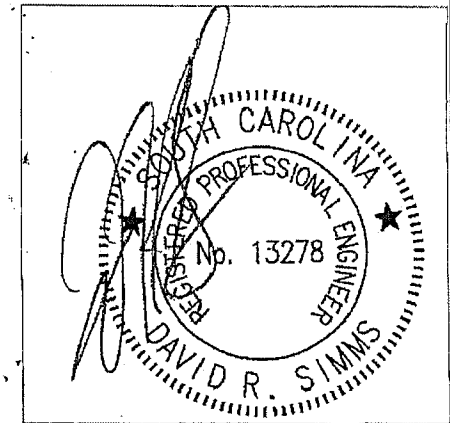

FOR PERMITTING ONLY
NOT FOR CONSTRUCTION

APPLICANT: Fourteenpointsix Acres, LLC

ACTIVITY: Construct Fixed Piers,
Walkways, Lifts & Bulkhead

P/N#

LOCATION:
Intracoastal Waterway
North Myrtle Beach

COUNTY: Horry

DATE: 11/25/2014

POINT	EAST	NORTH	DESCRIPTION	POINT	EAST	NORTH	DESCRIPTION
1	2703121.91	735939.04	LIFT (SOUTHERNMOST POINT)	81	2703452.05	736090.38	WALKWAY
2	2703132.10	735944.16	LIFT	82	2703454.73	736091.73	WALKWAY
3	2703132.92	735943.72	WALKWAY	83	2703455.23	736091.99	LIFT
4	2703135.66	735944.95	WALKWAY	84	2703465.42	736097.11	LIFT
5	2703135.99	735945.70	LIFT	85	2703465.65	736097.23	LIFT
6	2703146.12	735950.79	LIFT	86	2703475.84	736102.35	LIFT
7	2703146.31	735950.43	LIFT	87	2703476.17	736102.52	WALKWAY
8	2703156.49	735955.55	LIFT	88	2703478.85	736103.87	WALKWAY
9	2703157.57	735954.81	WALKWAY	89	2703479.52	736104.18	LIFT
10	2703160.31	735956.04	WALKWAY	90	2703489.70	736109.32	LIFT
11	2703160.54	735957.01	LIFT	91	2703489.79	736109.37	LIFT
12	2703170.73	735962.12	LIFT	92	2703499.97	736114.50	LIFT
13	2703170.97	735961.97	LIFT	93	2703500.18	736114.89	WALKWAY
14	2703181.16	735967.09	LIFT	94	2703502.86	736116.23	WALKWAY
15	2703182.21	735965.90	WALKWAY	95	2703503.47	736116.35	LIFT
16	2703184.95	735967.13	WALKWAY	96	2703513.65	736121.46	LIFT
17	2703185.18	735968.03	LIFT	97	2703513.78	736121.56	LIFT
18	2703195.36	735973.15	LIFT	98	2703523.97	736126.67	LIFT
19	2703195.89	735972.81	LIFT	99	2703524.30	736127.02	WALKWAY
20	2703206.08	735977.92	LIFT	100	2703526.98	736128.37	WALKWAY
21	2703206.86	735976.99	WALKWAY	101	2703527.49	736128.58	LIFT
22	2703209.60	735978.22	WALKWAY	102	2703537.68	736133.70	LIFT
23	2703209.84	735979.23	LIFT	103	2703537.81	736133.67	LIFT
24	2703220.03	735984.35	LIFT	104	2703548.00	736138.79	LIFT
25	2703220.40	735984.07	LIFT	105	2703548.41	736139.16	WALKWAY
26	2703230.59	735989.19	LIFT	106	2703551.09	736140.50	WALKWAY
27	2703231.50	735988.08	WALKWAY	107	2703551.67	736140.63	LIFT
28	2703234.24	735989.31	WALKWAY	108	2703561.86	736145.75	LIFT
29	2703234.36	735990.37	LIFT	109	2703562.11	736145.84	LIFT
30	2703244.54	735995.49	LIFT	110	2703572.29	736150.96	LIFT
31	2703245.16	735994.98	LIFT	111	2703572.53	736151.29	WALKWAY
32	2703255.35	736000.09	LIFT	112	2703575.21	736152.64	WALKWAY
33	2703256.15	735999.17	WALKWAY	113	2703575.46	736153.11	LIFT
34	2703258.89	736000.40	WALKWAY	114	2703585.64	736158.23	LIFT
35	2703258.91	736001.82	LIFT	115	2703585.90	736158.32	LIFT
36	2703269.10	736006.94	LIFT	116	2703596.01	736163.40	LIFT
37	2703269.59	736006.31	LIFT	117	2703596.23	736162.93	MAIN DOCK
38	2703279.77	736011.42	LIFT	118	2703712.21	736221.28	MAIN DOCK
39	2703280.79	736010.26	WALKWAY	119	2703713.21	736221.78	LIFT
40	2703283.53	736011.49	WALKWAY	120	2703725.94	736228.19	LIFT
41	2703283.55	736012.24	LIFT	121	2703726.24	736228.34	LIFT
42	2703293.73	736017.36	LIFT	122	2703738.98	736234.75	LIFT
43	2703294.10	736017.57	LIFT	123	2703739.01	736234.77	WALKWAY
44	2703304.29	736022.69	LIFT	124	2703741.69	736236.11	WALKWAY
45	2703305.44	736021.35	WALKWAY	125	2703743.06	736236.80	LIFT
46	2703308.18	736022.58	WALKWAY	126	2703755.51	736243.07	LIFT
47	2703308.32	736023.56	LIFT	127	2703755.79	736243.20	LIFT
48	2703318.51	736028.68	LIFT	128	2703768.24	736249.47	LIFT
49	2703318.88	736028.41	LIFT	129	2703768.51	736249.61	WALKWAY
50	2703329.07	736033.53	LIFT	130	2703771.16	736251.02	WALKWAY
51	2703330.08	736032.44	WALKWAY	131	2703771.75	736251.23	LIFT
52	2703332.82	736033.67	WALKWAY	132	2703784.31	736257.56	LIFT
53	2703332.71	736034.59	LIFT	133	2703784.48	736257.64	LIFT
54	2703342.90	736039.71	LIFT	134	2703796.96	736264.11	LIFT
55	2703343.40	736039.80	LIFT	135	2703797.65	736265.06	WALKWAY
56	2703353.58	736044.91	LIFT	136	2703800.31	736266.46	WALKWAY
57	2703354.73	736043.53	WALKWAY	137	2703801.13	736266.25	LIFT
58	2703357.47	736044.76	WALKWAY	138	2703813.72	736272.91	LIFT
59	2703357.38	736046.15	LIFT	139	2703813.95	736272.77	LIFT
60	2703367.52	736051.24	LIFT	140	2703826.54	736279.43	LIFT
61	2703367.70	736050.87	LIFT	141	2703826.83	736280.47	WALKWAY
62	2703377.89	736055.99	LIFT	142	2703829.48	736281.88	WALKWAY
63	2703379.37	736054.62	WALKWAY	143	2703830.39	736281.94	LIFT
64	2703382.11	736055.86	WALKWAY	144	2703842.99	736288.60	LIFT
65	2703381.90	736057.54	LIFT	145	2703843.21	736288.46	LIFT
66	2703392.08	736062.65	LIFT	146	2703855.81	736295.12	LIFT
67	2703392.34	736062.63	LIFT	147	2703856.01	736295.87	WALKWAY
68	2703402.52	736067.74	LIFT	148	2703858.66	736297.29	WALKWAY
69	2703403.82	736066.11	WALKWAY	149	2703859.81	736297.09	LIFT
70	2703406.50	736067.46	WALKWAY	150	2703872.21	736304.10	LIFT
71	2703406.56	736068.50	LIFT	151	2703873.00	736304.58	LIFT
72	2703416.74	736073.62	LIFT	152	2703885.12	736311.44	LIFT
73	2703416.75	736073.71	LIFT	153	2703885.39	736311.60	WALKWAY
74	2703426.94	736078.83	LIFT	154	2703887.70	736312.94	WALKWAY
75	2703427.93	736078.25	WALKWAY				
76	2703430.61	736079.60	WALKWAY				
77	2703430.59	736080.25	LIFT				
78	2703440.78	736085.37	LIFT				
79	2703441.02	736085.10	LIFT				
80	2703451.21	736090.22	LIFT				

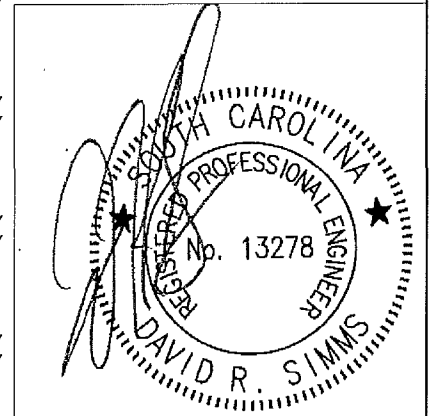

FOR PERMITTING ONLY
NOT FOR CONSTRUCTION

WALKWAY AND LIFT COORDINATES

APPLICANT:
Fourteenpointsix Acres, LLC
ACTIVITY: Construct Fixed Piers,
Walkways, Lifts & Bulkhead

LOCATION:
Intracoastal Waterway
North Myrtle Beach

COUNTY: Horry
DATE: 11/25/2014

P/N#