

JOINT
PUBLIC NOTICE

CHARLESTON DISTRICT, CORPS OF ENGINEERS
69A Hagood Avenue
Charleston, SC 29403-5107
and
THE S.C. DEPARTMENT OF HEALTH AND ENVIRONMENTAL CONTROL
Water Quality Certification and Wetlands Section
2600 Bull Street
Columbia, South Carolina 29201

REGULATORY DIVISION
Refer to: P/N SAC-2017-00852

July 7, 2017

Pursuant to Sections 401 and 404 of the Clean Water Act (33 U.S.C. 1344), and the South Carolina Coastal Zone Management Act (48-39-10 et.seq.), an application has been submitted to the Department of the Army and the S.C. Department of Health and Environmental Control by

Mr. Michael Czymbor
City of Hardeeville
c/o
Jeffrey Williams
Sligh Environmental Consultants, Inc.
31 Park of Commerce Way, Suite 200B
Savannah, Georgia 31405

for a permit to fill and excavate wetlands and waters associated with

New River

Located within a 5.353-acre project site near Carroll Street, Boyd Street, Martin Street, Heyward Street, Horton Street, Coburne Lane, Barker Street, Barker Court, Bush Avenue, Ulmer Street, Sunset Circle, Glover Street and Simmons Lane in the City of Hardeeville in, Jasper County, South Carolina (Latitude: 32.2774 °N, Longitude: -81.0786 °W), (Hardeeville Quad).

In order to give all interested parties an opportunity to express their views

NOTICE

is hereby given that written statements regarding the proposed work will be received by the **Corps** until

15 Days from the Date of this Notice,

and **SCDHEC** will receive written statements regarding the proposed work until

30 Days from the Date of this Notice

from those interested in the activity and whose interests may be affected by the proposed work.

The proposed work consists of discharge of fill material into 1.007 acres of wetlands and the excavation of 0.673 acres of waters for construction of maintenance access roads and drainage improvements. In detail, the proposed project involves the clearing of wetlands and the subsequent discharge of fill material into 1.007 acres of wetlands for the construction of maintenance access roads adjacent to existing drainage ditches. The maintenance access roads will be permanent and will provide the City of Hardeeville with access to properly maintain the drainage ditches. The maintenance access roads will be constructed at existing wetland elevation and will require mucking and back filling with suitable material. The proposed project also involves the excavation of 0.673 acres of existing drainage ditches to remove accumulated sediment from the ditches and the enlargement of portions of the ditches to accommodate storm water flow. The proposed work will be accomplished by trackhoe backhoe, and dump truck. All work will occur within the drainage easements from the ditch top of bank within the proposed maintenance road corridor. All excavated material will be hauled to and disposed of at an off-site location, likely in the City's Public Works Facility.

The drainage ditches within the project area have not been maintained in past years and have accumulated considerable sediment which has prohibited the surrounding area from draining properly. In addition, several drainage ditches within the project area are undersized and will require enlargement in order to handle the received storm water generated during storm events. The proposed access roads will allow the City of Hardeeville to properly maintain the drainage ditches as needed. The purpose of the proposed project is to improve drainage and provide maintenance access to the drainage ditches.

Avoidance and minimization of impacts have occurred by constructed the proposed maintenance access roads at the grade of the adjacent wetland elevations and designed at a minimum width to accomplish future maintenance of the drainage ditches. In addition, best management practices (BMPs) such as silt fencing and grades slopes will be constructed and maintained prior to and throughout the construction process.

The applicant is proposing to purchase 7.049 wetland credits (3.5 wetland restoration and 3.5 wetland preservation) from the Sweetleaf Swamp Wetland Mitigation Bank. The applicant is not proposing mitigation for the impacts associated with the excavation of the drainage ditches.

NOTE: This public notice and associated plans are available on the Corps' website at:
<http://www.sac.usace.army.mil/Missions/Regulatory/PublicNotices> .

The District Engineer has concluded that the discharges associated with this project, both direct and indirect, should be reviewed by the South Carolina Department of Health and Environmental Control in accordance with provisions of Section 401 of the Clean Water Act. As such, this notice constitutes a request, on behalf of the applicant, for certification that this project will comply with applicable effluent limitations and water quality standards (**DELETE THIS SENTENCE IF 401 WQC IS NOT REQUIRED**). The work shown on this application must also be certified as consistent with applicable provisions of the Coastal Zone Management Program (15 CFR 930) (**DELETE THIS SENTENCE IF A COASTAL ZONE PERMIT/CERTIFICATION IS NOT REQUIRED.**). This activity may also require evaluation for compliance with the S. C. Construction in Navigable Waters Permit Program. State review, permitting and certification is conducted by the S. C. Department of Health and Environmental Control. The District Engineer will not process this application to a conclusion until such certifications are received. The applicant is hereby advised that supplemental information may be required by the State to facilitate the review.

This notice initiates the Essential Fish Habitat (EFH) consultation requirements of the Magnuson-Stevens Fishery Conservation and Management Act. Implementation of the proposed project would impact 1.007 acres of freshwater wetlands upstream of estuarine substrates and emergent wetlands utilized by various life stages of species comprising the shrimp, and snapper-grouper management complexes. The District Engineer's initial determination is that the proposed action would not have a substantial individual or cumulative adverse impact on EFH or fisheries managed by the South Atlantic Fishery Management Council and the National Marine Fisheries Service (NMFS). The District Engineer's final determination relative to project impacts and the need for mitigation measures is subject to review by and coordination with the NMFS.

Pursuant to the Section 7 of the Endangered Species Act of 1973 (as amended), the Corps has reviewed the project area, examined all information provided by the applicant, and the District Engineer has determined, based on the most recently available information that the project will have no effect on any Federally endangered, threatened, or proposed species and will not result in the destruction or adverse modification of designated or proposed critical habitat. This public notice serves as a request to the U.S. Fish and Wildlife Service and the National Marine Fisheries Service for any additional information they may have on whether any listed or proposed endangered or threatened species or designated or proposed critical habitat may be present in the area which would be affected by the activity.

Pursuant to Section 106 of the National Historic Preservation Act (NHPA), this public notice also constitutes a request to Indian Tribes to notify the District Engineer of any historic properties of religious and cultural significance to them that may be affected by the proposed undertaking.

In accordance with Section 106 of the NHPA, the District Engineer has consulted South Carolina ArchSite (GIS), for the presence or absence of historic properties (as defined in 36 C.F.R. 800.16)(1)), and has initially determined that no historic properties are present; therefore, there will be no effect on historic properties. To ensure that other historic properties that the District Engineer is not aware of are not overlooked, this public notice also serves as a request to the State Historic Preservation Office and any other interested parties to provide any information they may have with regard to historic properties. This public notice serves as a request for concurrence within 30 days from the SHPO (and/or Tribal Historic Preservation Officer).

The District Engineer's final eligibility and effect determination will be based upon coordination with the SHPO and/or THPO, as appropriate and required and with full consideration given to the proposed undertaking's potential direct and indirect effects on historic properties within the Corps-identified permit area.

Any person may request, in writing, within the comment period specified in this notice, that a public hearing be held to consider this application. Requests for a public hearing shall state, with particularity, the reasons for holding a public hearing.

The decision whether to issue a permit will be based on an evaluation of the probable impact including cumulative impacts of the activity on the public interest. The benefit which reasonably may be expected to accrue from the project must be balanced against its reasonably foreseeable detriments. All factors which may be relevant to the project will be considered

including the cumulative effects thereof; among those are conservation, economics, aesthetics, general environmental concerns, wetlands, historic properties, fish and wildlife values, flood hazards, flood plain values, land use, navigation, shoreline erosion and accretion, recreation, water supply and conservation, water quality, energy needs, safety, food and fiber production and, in general, the needs and welfare of the people. A permit will be granted unless the District Engineer determines that it would be contrary to the public interest. In cases of conflicting property rights, the Corps cannot undertake to adjudicate rival claims.

The Corps is soliciting comments from the public; Federal, state, and local agencies and officials; Indian Tribes; and other interested parties in order to consider and evaluate the impacts of this activity. Any comments received will be considered by the Corps to determine whether to issue, modify, condition or deny a permit for this project. To make this decision, comments are used to assess impacts on endangered species, historic properties, water quality, general environmental effects, and the other public interest factors listed above. Comments are used in the preparation of an Environmental Assessment and/or an Environmental Impact Statement pursuant to the National Environmental Policy Act. Comments are also used to determine the need for a public hearing and to determine the overall public interest of the activity. **Please submit comments in writing, identifying the project of interest by public notice number, to the following address:**

**U.S. Army Corps of Engineers
ATTN: REGULATORY DIVISION
69A Hagood Avenue
Charleston, SC 29403-5107**

If there are any questions concerning this public notice, please contact Tracy D. Sanders, Project Manager, at (843) 329-8190 or toll free at 1-866-329-8187.

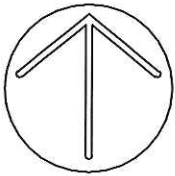
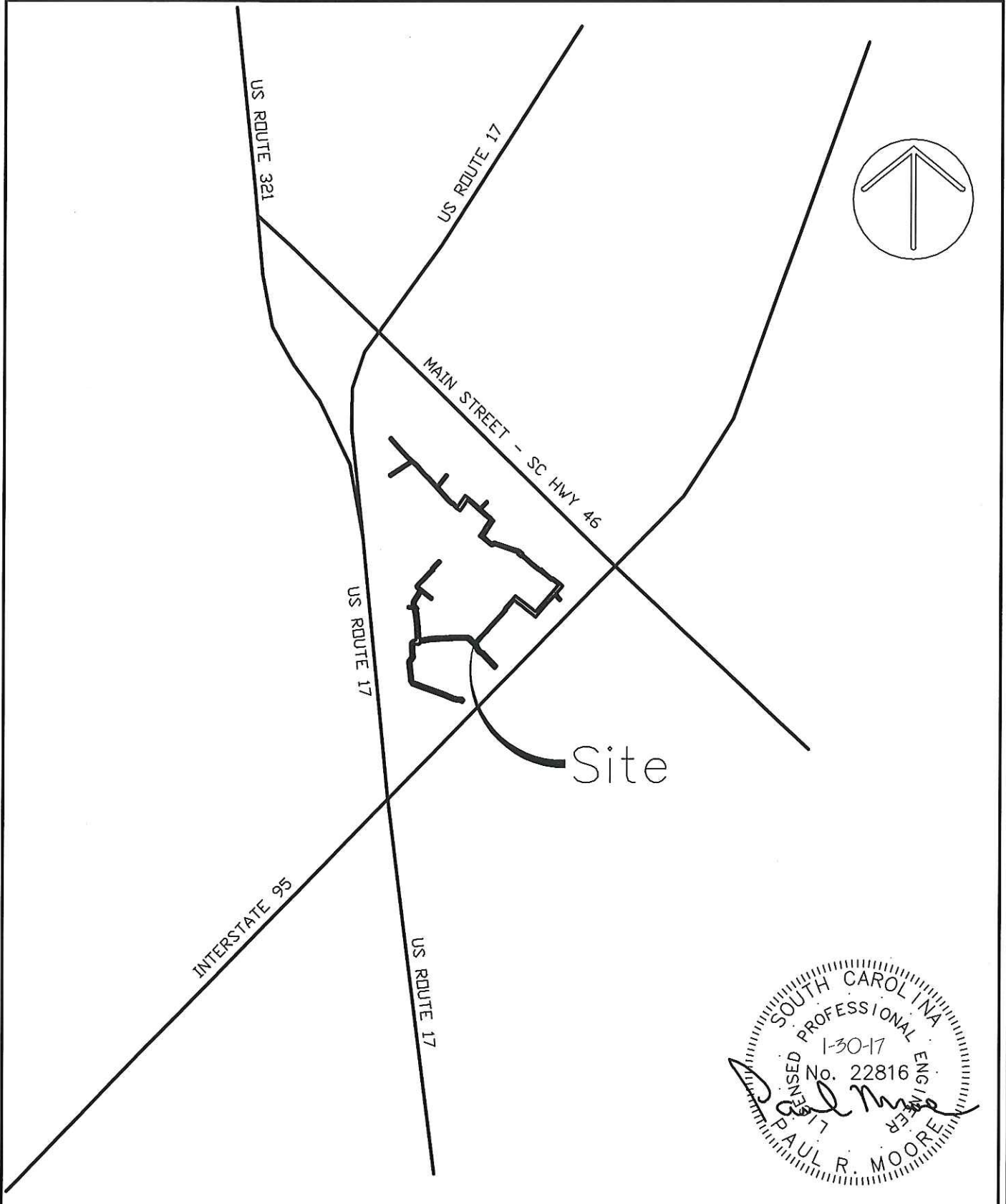

P.O. BOX 381
BLUFFTON, SC 29910
PH (843) 837-5250
FAX (843) 837-2558
WWW.WARDEDWARDS.COM

SERVICE AREA 2
DRAINAGE IMPROVEMENTS
VICINITY MAP

CITY OF HARDEEVILLE, SOUTH CAROLINA

DATE: 04-17-17
REVISED:
SCALE: NONE
PROJ. # 110202G

SHEET 1 OF 7

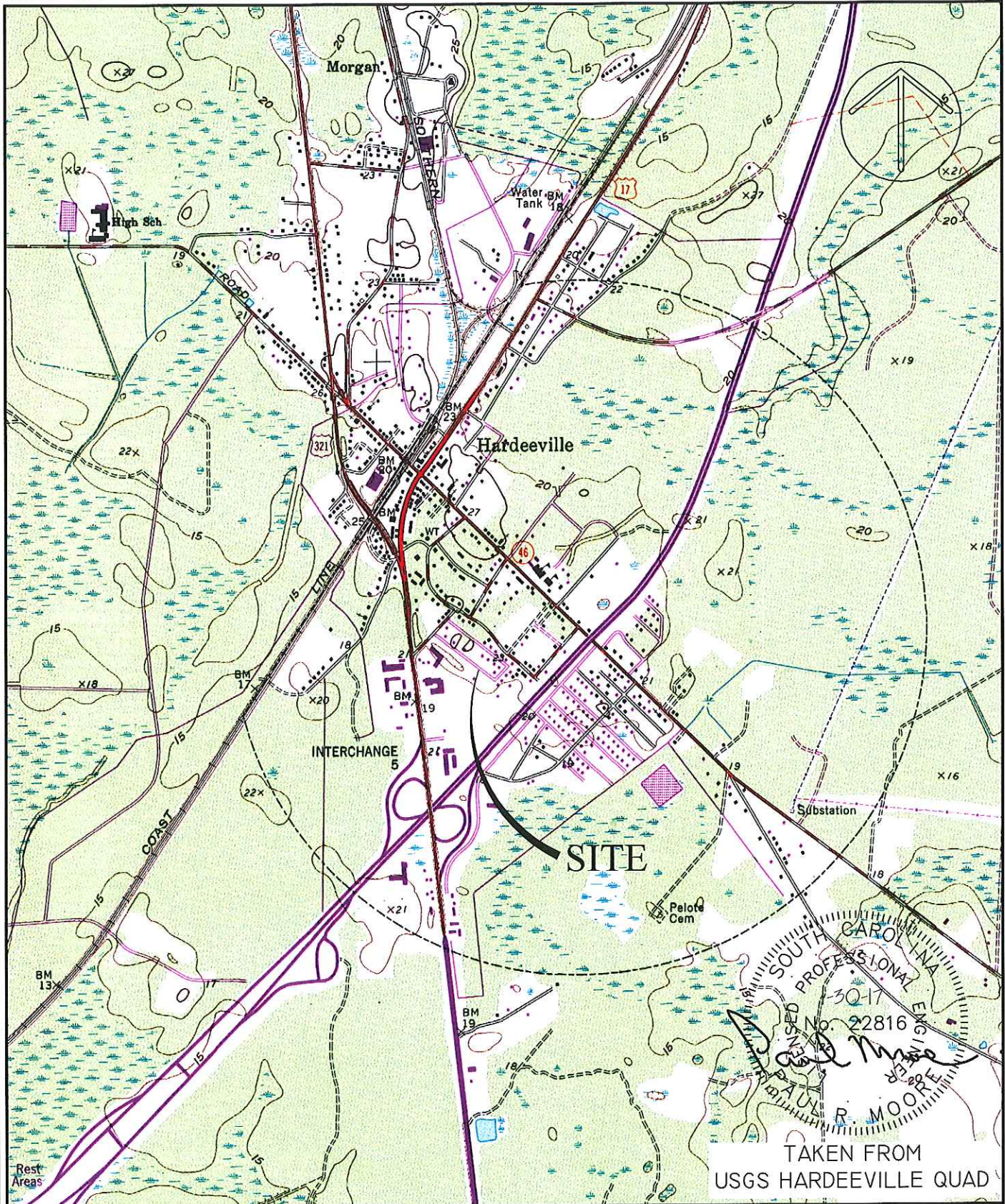

P.O. BOX 381
BLUFFTON, SC 29910
PH (843) 837-5250
FAX (843) 837-2558
WWW.WARDEDWARDS.COM

SERVICE AREA 2
DRAINAGE IMPROVEMENTS

USGS MAP

CITY OF HARDEEVILLE, SOUTH CAROLINA

DATE: 04-17-17
REVISED:
SCALE: 1"=2000'
PROJ. # 110202G

SHEET 2 OF 7

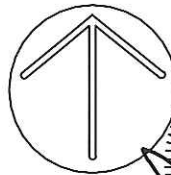

WETLAND IMPACT A: 0.165 ACRE
 DITCH EXCAVATION: 343 SY
 DITCH CLEANING: 300 LF
 MAINTENANCE ROAD: 456 SY

PROJECT LIMITS
 5.353 ACRES

PROJECT LIMITS

WETLAND IMPACT B: 0.032 ACRE
 DITCH EXCAVATION: 85 SY
 DITCH CLEANING: 110 LF
 MAINTENANCE ROAD: 70 SY

WETLAND IMPACT C: 0.034 ACRE
 DITCH EXCAVATION: 82 SY
 DITCH CLEANING: 100 LF
 MAINTENANCE ROAD: 82 SY

WETLAND IMPACT D: 0.831 ACRE
 DITCH EXCAVATION: 1,600 SY
 DITCH CLEANING: 1,040 LF
 MAINTENANCE ROAD: 2,422 SY

WETLAND IMPACT E: 0.618 ACRE
 DITCH EXCAVATION: 1,143 SY
 DITCH CLEANING: 860 LF
 MAINTENANCE ROAD: 1,849 SY

TOTAL PROJECT LIMITS:	5.353 AC
WETLAND IMPACTS:	
A:	0.071 AC DITCH EXCAVATION 0.094 AC MAINTENANCE ROAD
B:	0.018 AC DITCH EXCAVATION 0.014 AC MAINTENANCE ROAD
C:	0.017 AC DITCH EXCAVATION 0.017 AC MAINTENANCE ROAD
D:	0.331 AC DITCH EXCAVATION 0.500 AC MAINTENANCE ROAD
E:	0.236 AC DITCH EXCAVATION 0.382 AC MAINTENANCE ROAD

TOTAL WETLANDS: 1.680 AC
 TOTAL UPLANDS: 3.673 AC

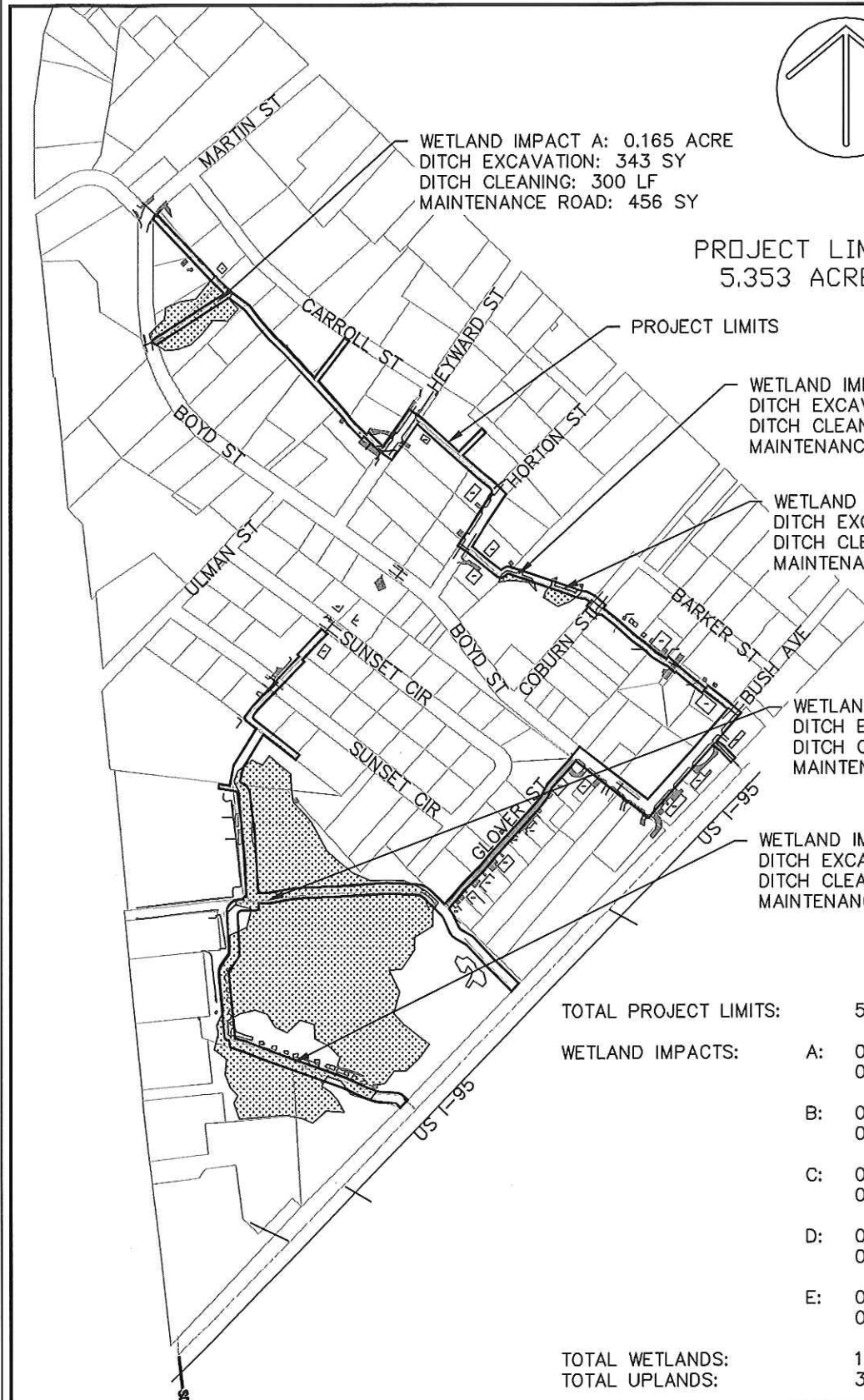

P.O. BOX 381
 BLUFFTON, SC 29910
 PH (843) 837-5250
 FAX (843) 837-2558
 WWW.WARDEDWARDS.COM

SERVICE AREA 2
 DRAINAGE IMPROVEMENTS
PROPOSED WETLAND IMPACTS
 CITY OF HARDEEVILLE, SOUTH CAROLINA

DATE: 04-17-17
 REVISED:
 SCALE: 1"=500'
 PROJ. # 110202G
 SHEET 3 OF 7

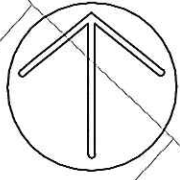

MARTIN ST

WETLAND IMPACT A: 0.165 ACRE
DITCH EXCAVATION: 343 SY
DITCH CLEANING: 300 LF
MAINTENANCE ROAD: 456 SY

PROJECT LIMITS

CARROLL ST

BOYD ST

KEYWARD ST

ULMAN ST



P.O. BOX 381
BLUFFTON, SC 29910
PH (843) 837-5250
FAX (843) 837-2558
WWW.WARDEDWARDS.COM

SERVICE AREA 2
DRAINAGE IMPROVEMENTS
IMPACTS

CITY OF HARDEEVILLE, SOUTH CAROLINA

DATE: 04-17-17
REVISED:
SCALE: 1"=150'
PROJECT # 110202G

SHEET 4 OF 7

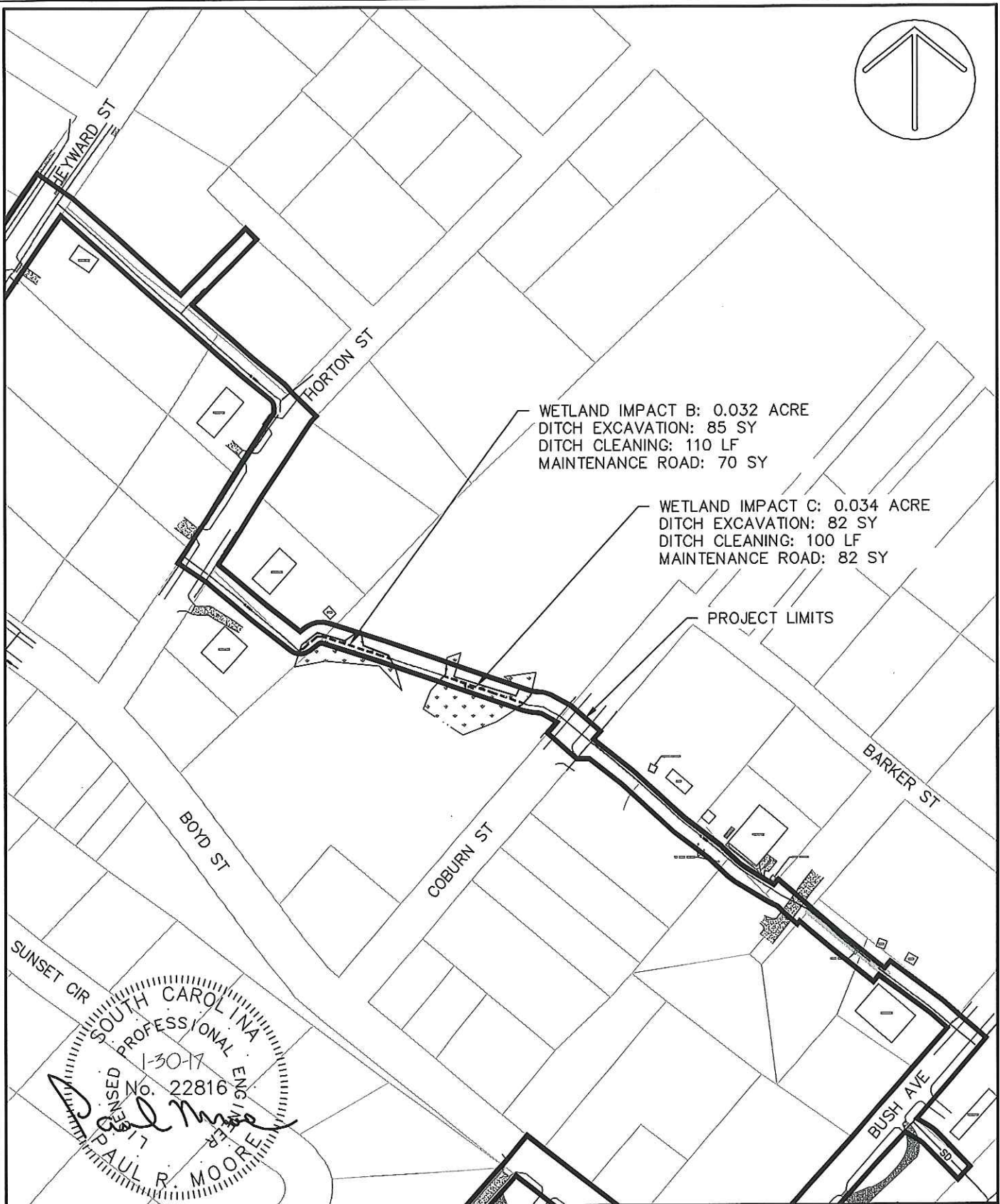
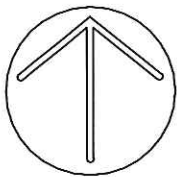

WETLAND IMPACT B: 0.032 ACRE
 DITCH EXCAVATION: 85 SY
 DITCH CLEANING: 110 LF
 MAINTENANCE ROAD: 70 SY

WETLAND IMPACT C: 0.034 ACRE
 DITCH EXCAVATION: 82 SY
 DITCH CLEANING: 100 LF
 MAINTENANCE ROAD: 82 SY

PROJECT LIMITS

SOUTH CAROLINA
 PROFESSIONAL ENGINEER
 1-30-17
 No. 22816
 PAUL R. MOORE



P.O. BOX 381
 BLUFFTON, SC 29910
 PH (843) 837-5250
 FAX (843) 837-2558
 WWW.WARDEDWARDS.COM

SERVICE AREA 2
 DRAINAGE IMPROVEMENTS
IMPACTS

CITY OF HARDEEVILLE, SOUTH CAROLINA

DATE: 04-17-17
 REVISED:
 SCALE: 1"=150'
 PROJECT # 110202G

SHEET 5 OF 7

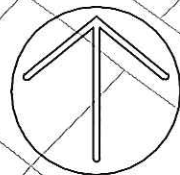

SUNSET CIR

WETLAND IMPACT D: 0.831 ACRE
DITCH EXCAVATION: 1,600 SY
DITCH CLEANING: 1,040 LF
MAINTENANCE ROAD: 2,422 SY

GLOVER ST

PROJECT LIMITS

WETLAND IMPACT E: 0.618 ACRE
DITCH EXCAVATION: 1,143 SY
DITCH CLEANING: 860 LF
MAINTENANCE ROAD: 1,849 SY

US 1-95



P.O. BOX 381
BLUFFTON, SC 29910
PH (843) 837-5250
FAX (843) 837-2558
WWW.WARDEDWARDS.COM

SERVICE AREA 2 DRAINAGE IMPROVEMENTS IMPACTS

CITY OF HARDEEVILLE, SOUTH CAROLINA

DATE: 04-17-17
REVISED:
SCALE: 1"=150'
PROJECT # 110202G

SHEET 6 OF 7

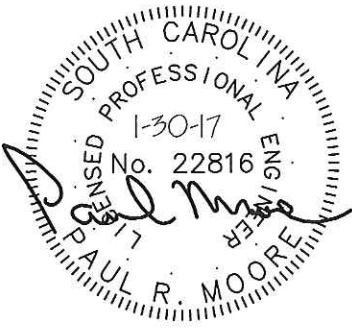
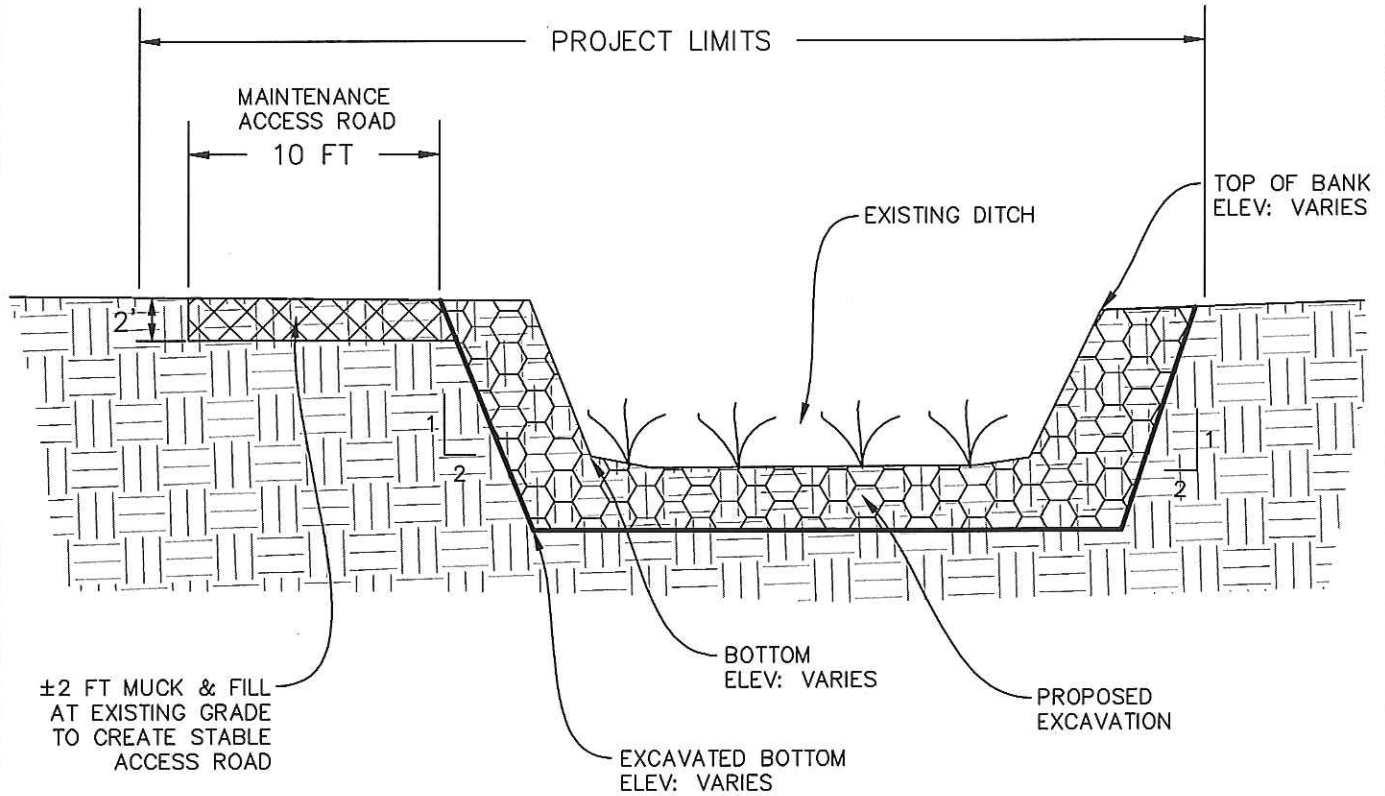

P.O. BOX 381
 BLUFFTON, SC 29910
 PH (843) 837-5250
 FAX (843) 837-2558
 WWW.WARDEDWARDS.COM

SERVICE AREA 2
 DRAINAGE IMPROVEMENTS
TYPICAL SECTION
 CITY OF HARDEEVILLE, SOUTH CAROLINA

DATE: 04-17-17
 REVISED:
 SCALE: NONE
 PROJECT # 110202G
 SHEET 7 OF 7