

JOINT
PUBLIC NOTICE

CHARLESTON DISTRICT, CORPS OF ENGINEERS
69A Hagood Avenue
Charleston, South Carolina 29403-5107
and
THE S.C. DEPARTMENT OF HEALTH AND ENVIRONMENTAL CONTROL
Office of Environmental Quality Control
Water Quality Certification and Wetlands Programs Section
2600 Bull Street
Columbia, South Carolina 29201

REGULATORY DIVISION

Refer to: P/N # SAC-2016-00830

June 7, 2016

Pursuant to Sections 401 and 404 of the Clean Water Act (33 U.S.C. 1344), and the South Carolina Coastal Zone Management Act (48-39-10 et.seq.), an application has been submitted to the Department of the Army and the S.C. Department of Health and Environmental Control by

JASPER COUNTY
ATTN: ANDY FULGHUM
358 3rd AVENUE
RIDGELAND, SC 29936

for a permit to construct a runway and associated landside development at an existing airfield

at a location described as Ridgeland Airport (3J1) in the Town of Ridgeland along US 278 E (Grays Highway). 32.4952°N, -80.9882°W. Ridgeland SC Quad Sheet.

In order to give all interested parties an opportunity to express their views

NOTICE

is hereby given that written statements regarding the proposed work will be received by the **Corps** until

15 Days from the Date of this Notice,

and **SCDHEC** will receive written statements regarding the proposed work until

30 Days from the Date of this Notice

from those interested in the activity and whose interests may be affected by the proposed work.

The proposed work consists of a new runway, parallel taxiway, and associated landside facilities. In detail, the applicant proposes to construct a 4,200 foot runway and parallel taxiway,

associated landside facilities including terminal building, apron, fuel farm, and hangars, construction of a relocated Wrong Road, construction of associated stormwater controls and the installation and temporary use of staging areas, haul roads, and sedimentation and erosion control features for construction of the Proposed Action. Impacts to Waters of the US total 1.85 acres of wetland fill for runway construction and road relocation, 0.99 acre of clearing for NPDES and FAA required fencing, 0.02 acre of excavation/cut for runway construction, and 0.04 acres of backfill and bedding for runway lighting. Additionally, 27.42 acres of no-impact wetland clearing is required for the surface approach. This clearing will be constructed with no land disturbance (i.e., stumps will remain, low tire-pressure equipment will be used, no grubbing will be required). The applicant has proposed to mitigate for impacts to wetlands and/or waters of the United States by purchasing 28.4 Wetland Mitigation Credits from Sweetleaf Swamp Mitigation Bank or another Corps approved mitigation bank whose Service Area falls within the proposed project boundary. The project purpose is to accommodate current and future aviation and support regional growth and development.

An Environmental Assessment for this project prepared by Michael Baker Jr., Inc., entitled "Environmental Assessment for a New Runway at Ridgeland Airport" and dated June 2014 was evaluated and signed by the Federal Aviation Administration (FAA) on August 26, 2014. The Jurisdictional Determination for this site is pending.

NOTE: This public notice and associated plans are available on the Corps' website at: <http://www.sac.usace.army.mil/Missions/Regulatory/PublicNotices> . For those unable to access the website, a copy of this notice and the associated plans will be provided, upon receipt of a written request. The request must identify the project of interest by public notice number and a self-addressed stamped envelope must also be provided. Your request should be addressed to the

**U.S. Army Corps of Engineers
ATTN: REGULATORY DIVISION
69A Hagood Avenue
Charleston, South Carolina 29403-5107**

The District Engineer has concluded that the discharges associated with this project, both direct and indirect, should be reviewed by the South Carolina Department of Health and Environmental Control in accordance with provisions of Section 401 of the Clean Water Act. As such, this notice constitutes a request, on behalf of the applicant, for certification that this project will comply with applicable effluent limitations and water quality standards. The work shown on this application must also be certified as consistent with applicable provisions of the Coastal Zone Management Program (15 CFR 930). This activity may also require evaluation for compliance with the S. C. Construction in Navigable Waters Permit Program. State review, permitting and certification is conducted by the S. C. Department of Health and Environmental Control. The District Engineer will not process this application to a conclusion until such certifications are received. The applicant is hereby advised that supplemental information may be required by the State to facilitate the review.

This notice initiates the Essential Fish Habitat (EFH) consultation requirements of the Magnuson-Stevens Fishery Conservation and Management Act. Implementation of the proposed project would not impact estuarine substrates and emergent wetlands utilized by various life stages of species comprising the shrimp, and snapper-grouper management complexes. The District Engineer's initial determination is that the proposed action would not have a substantial individual or cumulative adverse impact on EFH or fisheries managed by the

South Atlantic Fishery Management Council and the National Marine Fisheries Service (NMFS). The District Engineer's final determination relative to project impacts and the need for mitigation measures is subject to review by and coordination with the NMFS.

Pursuant to the Section 7 of the Endangered Species Act of 1973 (as amended), the applicant has provided a protected species survey for the property associated with the activity described above. Based upon this report, the District Engineer has determined that the project is not likely to adversely affect any Federally endangered, threatened, or proposed species or result in the destruction or adverse modification of designated or proposed critical habitat. This public notice serves as a request for written concurrence from the U.S. Fish and Wildlife Service and/or the National Marine Fisheries Service on this determination.

Pursuant to Section 106 of the National Historic Preservation Act (NHPA), this public notice also constitutes a request to Indian Tribes to notify the District Engineer of any historic properties of religious and cultural significance to them that may be affected by the proposed undertaking.

In accordance with Section 106 of the NHPA, the District Engineer has consulted South Carolina ArchSite (GIS), for the presence or absence of historic properties (as defined in 36 C.F.R. 800.16)(f)(1)), and has initially determined that there are historic properties present, but they will not be affected; therefore, there will be no effect on historic properties. To ensure that other historic properties that the District Engineer is not aware of are not overlooked, this public notice also serves as a request to the State Historic Preservation Office and other interested parties to provide any information they may have with regard to historic properties. This public notice serves as a request for concurrence within 30 days from the SHPO (and/or Tribal Historic Preservation Officer).

The District Engineer's final eligibility and effect determination will be based upon coordination with the SHPO and/or THPO, as appropriate and required and with full consideration given to the proposed undertaking's potential direct and indirect effects on historic properties within the Corps-identified permit area.

Any person may request, in writing, within the comment period specified in this notice, that a public hearing be held to consider this application. Requests for a public hearing shall state, with particularity, the reasons for holding a public hearing.

The decision whether to issue a permit will be based on an evaluation of the probable impact including cumulative impacts of the activity on the public interest. The benefit which reasonably may be expected to accrue from the project must be balanced against its reasonably foreseeable detriments. All factors which may be relevant to the project will be considered including the cumulative effects thereof; among those are conservation, economics, aesthetics, general environmental concerns, wetlands, historic properties, fish and wildlife values, flood hazards, flood plain values, land use, navigation, shoreline erosion and accretion, recreation, water supply and conservation, water quality, energy needs, safety, food and fiber production and, in general, the needs and welfare of the people. A permit will be granted unless the District Engineer determines that it would be contrary to the public interest. In cases of conflicting property rights, the Corps cannot undertake to adjudicate rival claims.

The Corps is soliciting comments from the public; Federal, state, and local agencies and officials; Indian Tribes; and other interested parties in order to consider and evaluate the impacts of

this activity. Any comments received will be considered by the Corps to determine whether to issue, modify, condition or deny a permit for this project. To make this decision, comments are used to assess impacts on endangered species, historic properties, water quality, general environmental effects, and the other public interest factors listed above. Comments are used in the preparation of an Environmental Assessment and/or an Environmental Impact Statement pursuant to the National Environmental Policy Act. Comments are also used to determine the need for a public hearing and to determine the overall public interest of the activity.

If there are any questions concerning this public notice, please contact David B. Wilson at 843-329-8044 or toll free at 1-866-329-8187.

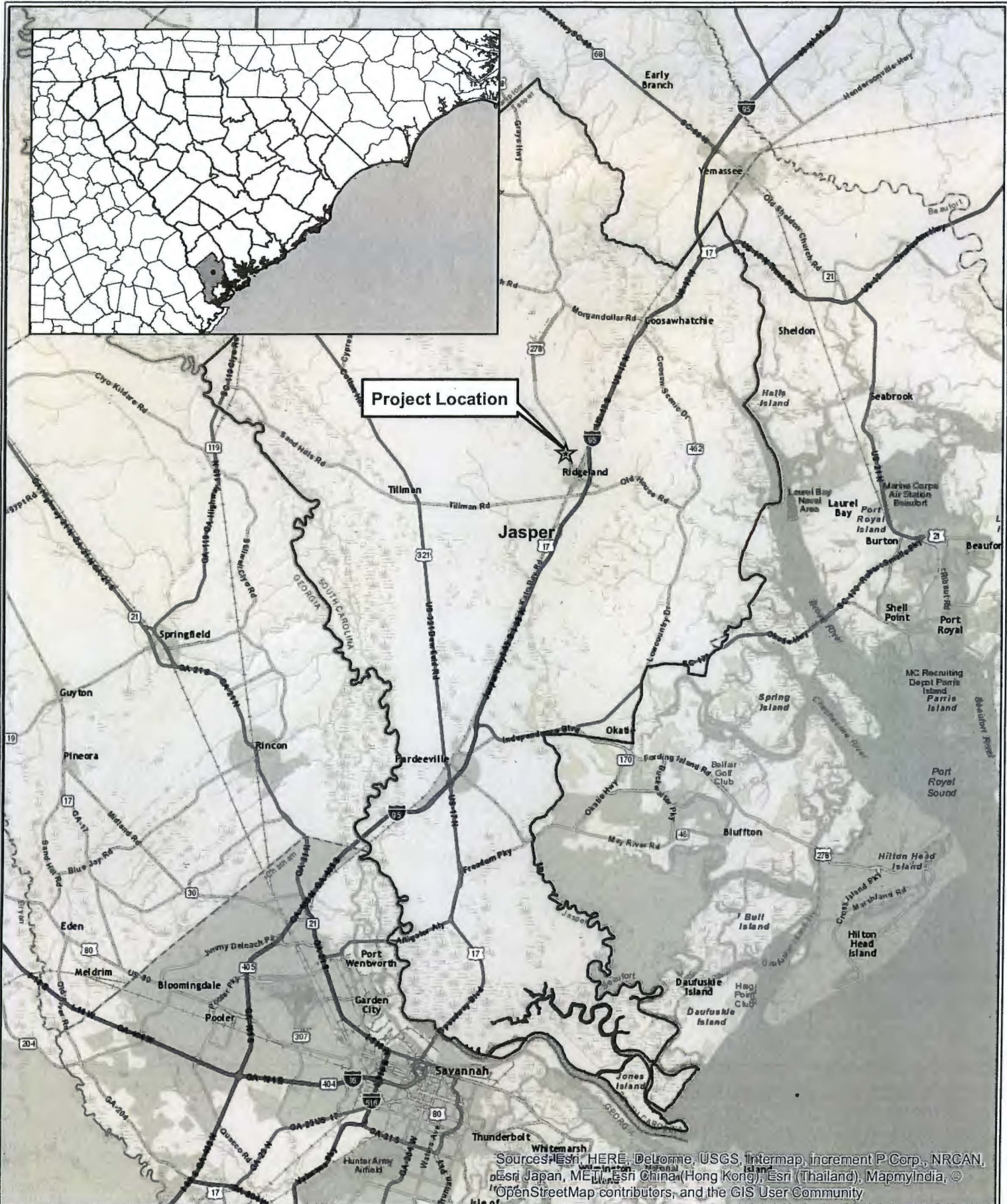

Sources: Esri, HERE, DeLorme, USGS, Intermap, increment P Corp., NRCAN, Esri Japan, METI, Esri China (Hong Kong), Esri (Thailand), MapmyIndia, © OpenStreetMap contributors, and the GIS User Community



952 Houston Northcutt Blvd., Suite 100
 Mount Pleasant, South Carolina 29464
 Ph: (843) 556-2624 Fx: (843) 556-4329
 www.tidewaterenvironmental.com

Sheet 1: Vicinity Map
 Runway 18-36 Program
 Ridgeland-Claude Dean Airport, Ridgeland, Jasper County, SC
 SAC 2008-00271-1Q
 Source: ESRI
 Date: April 2016

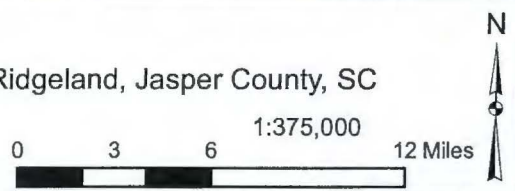

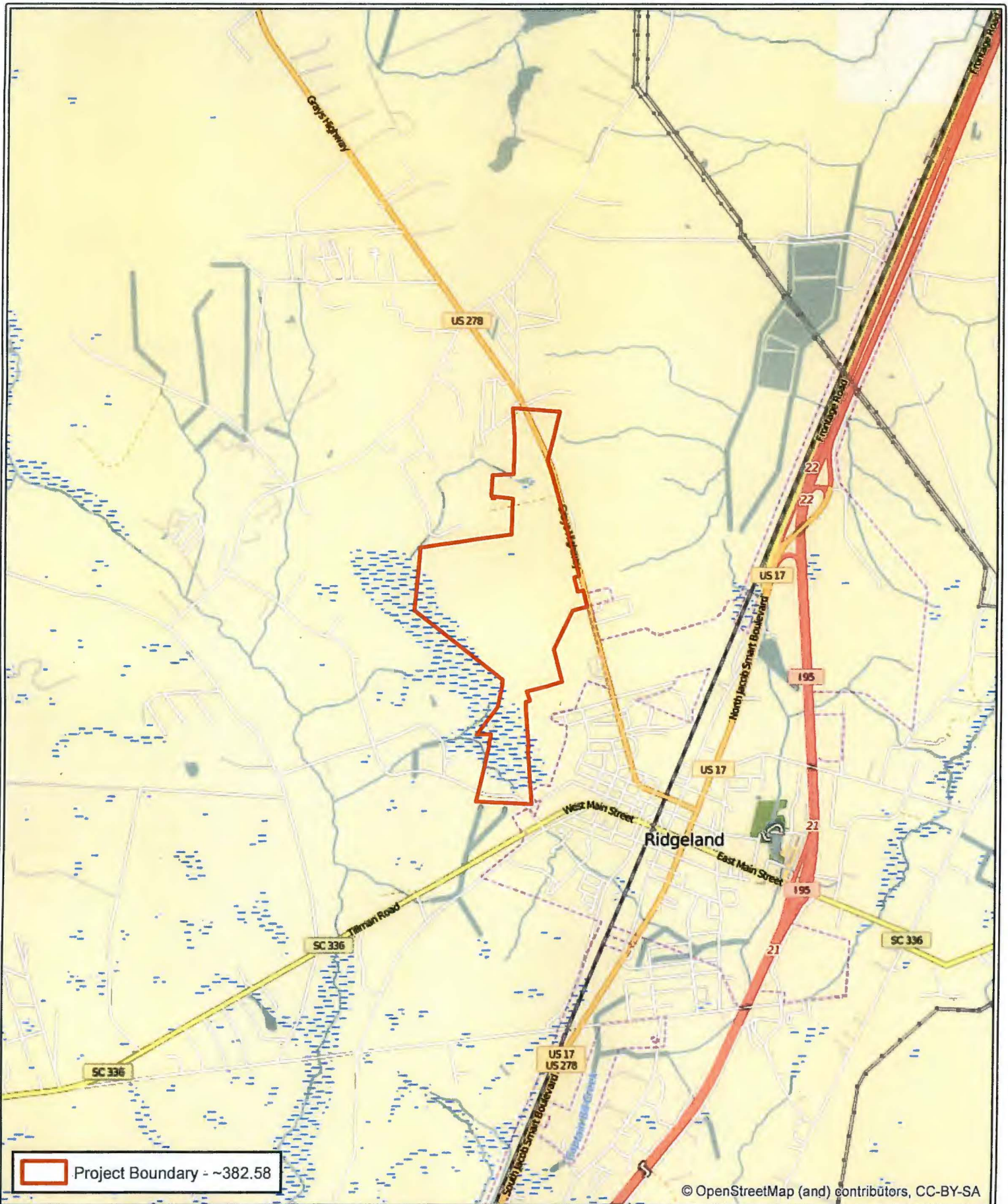

952 Houston Northcutt Blvd., Suite 100
 Mount Pleasant, South Carolina 29464
 Ph: (843) 556-2624 Fx: (843) 556-4329
 www.tidewaterenvironmental.com

Sheet 2. Location Map

Runway 18-36 Program

Ridgeland-Claude Dean Airport, Ridgeland, Jasper County, SC

SAC 2008-00271-1Q

Source: ESRI

Date: April 2016

1 inch = 3,000 feet



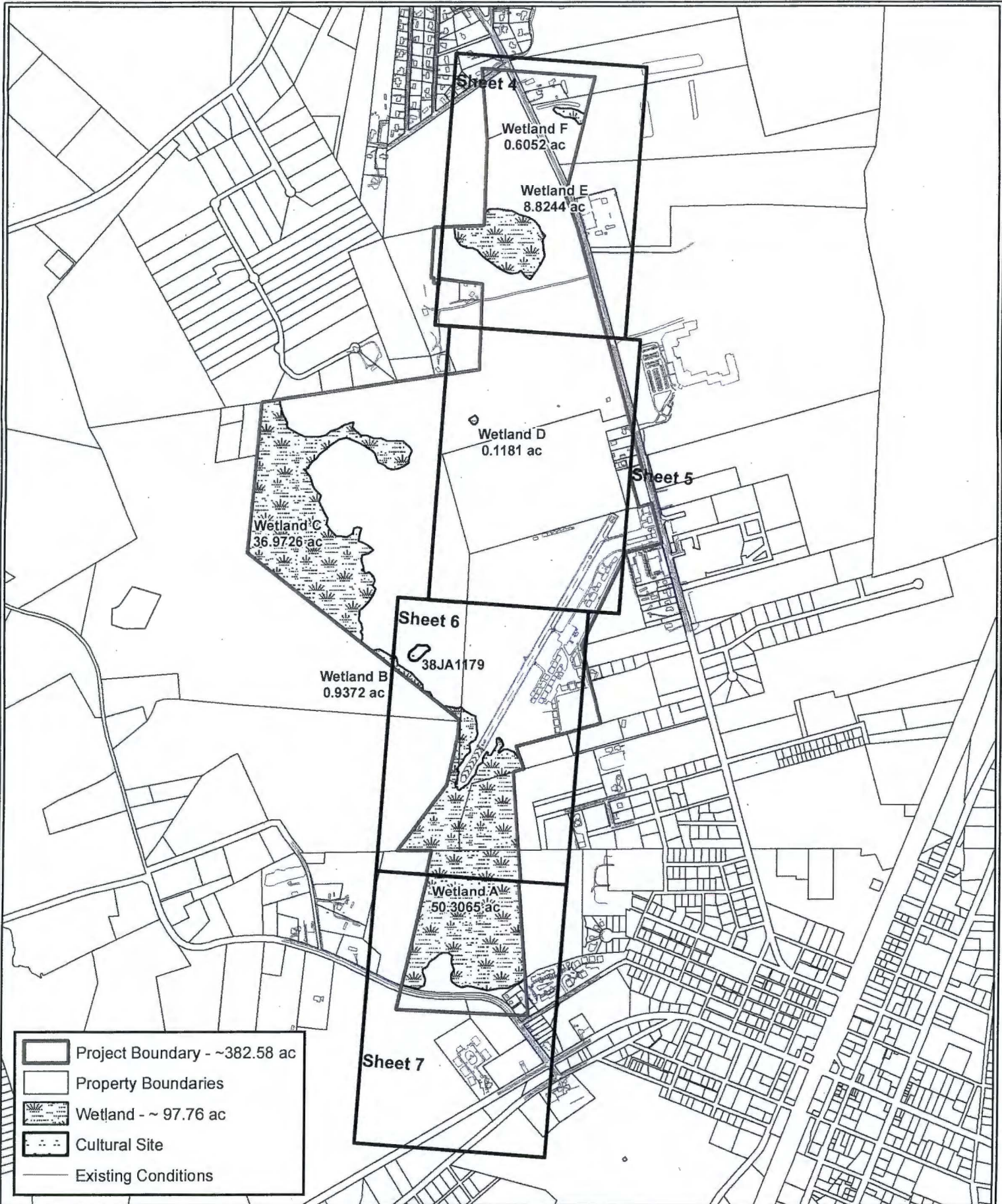

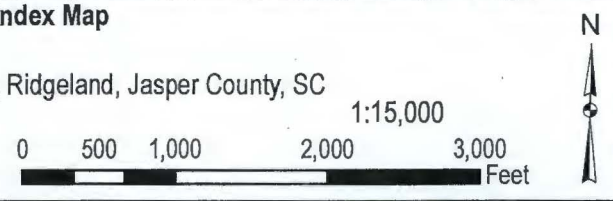

 952 Houston Northcutt Blvd., Suite 100
 Mount Pleasant, South Carolina 29464
 Ph: (843) 556-2624 Fx: (843) 556-4329
 www.jmt.com

Sheet 3. Existing Conditions Index Map
 Runway 18-36 Program
 Ridgeland-Claude Dean Airport, Ridgeland, Jasper County, SC
 SAC 2008-00271-1Q
 Source: ESRI
 Date: April 2016

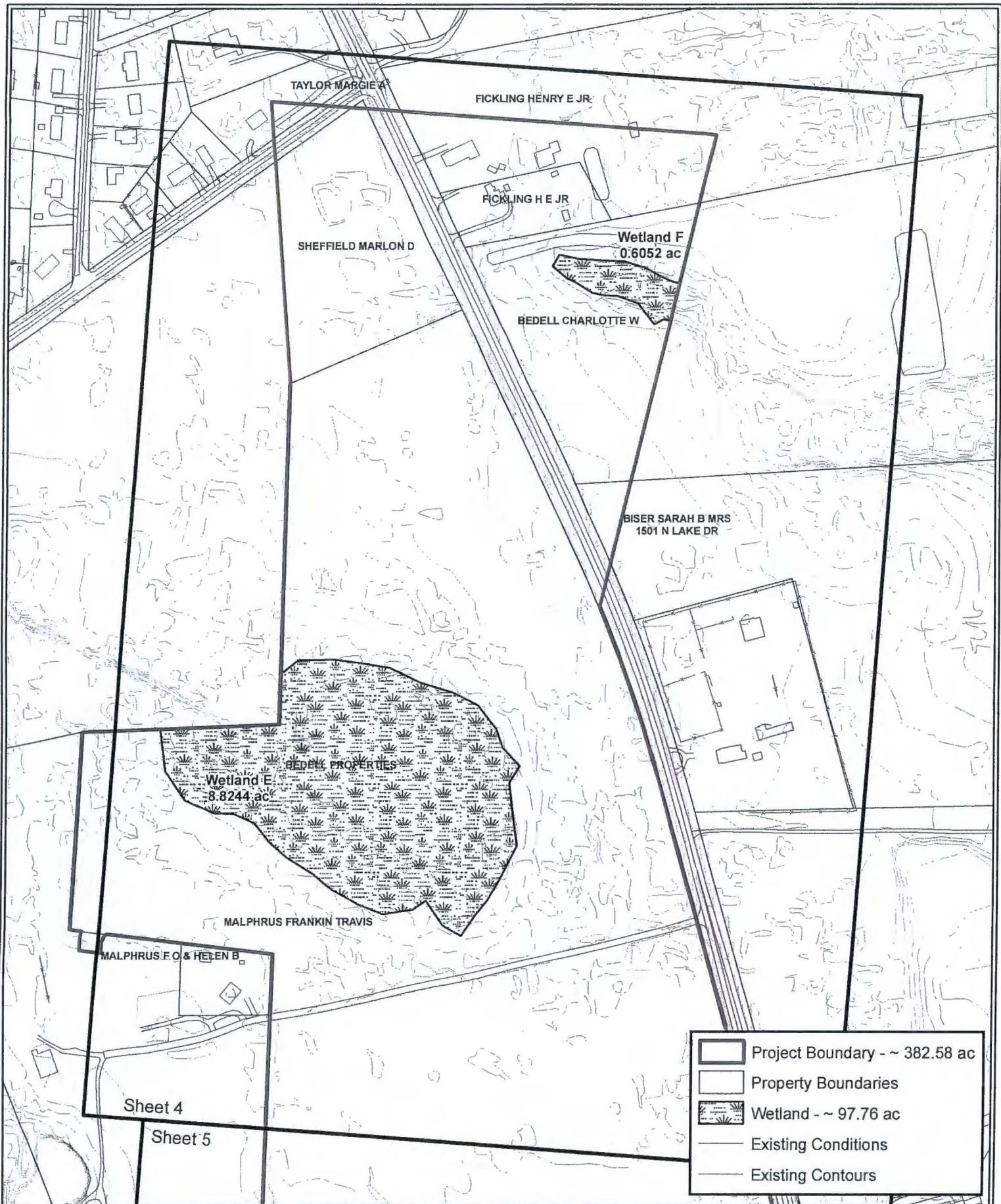



 952 Houston Northcutt Blvd., Suite 100
 Mount Pleasant, South Carolina 29464
 Ph: (843) 556-2624 Fx: (843) 556-4329
 www.jmt.com

Sheet 4. Existing Conditions Map
 Runway 18-36 Program
 Ridgeland-Claude Dean Airport, Ridgeland, Jasper County, SC
 SAC 2008-00271-1Q
 Source: ESRI
 Date: April 2016

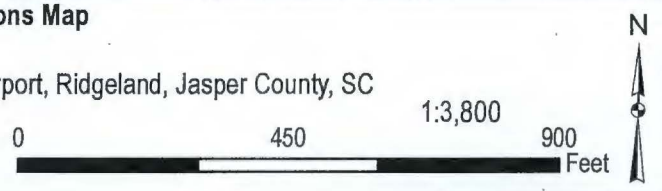

1:3,800

900 Feet

-  Project Boundary - ~ 382.58 ac
-  Property Boundaries
-  Wetland - ~ 97.76 ac
-  Existing Conditions
-  Existing Contours

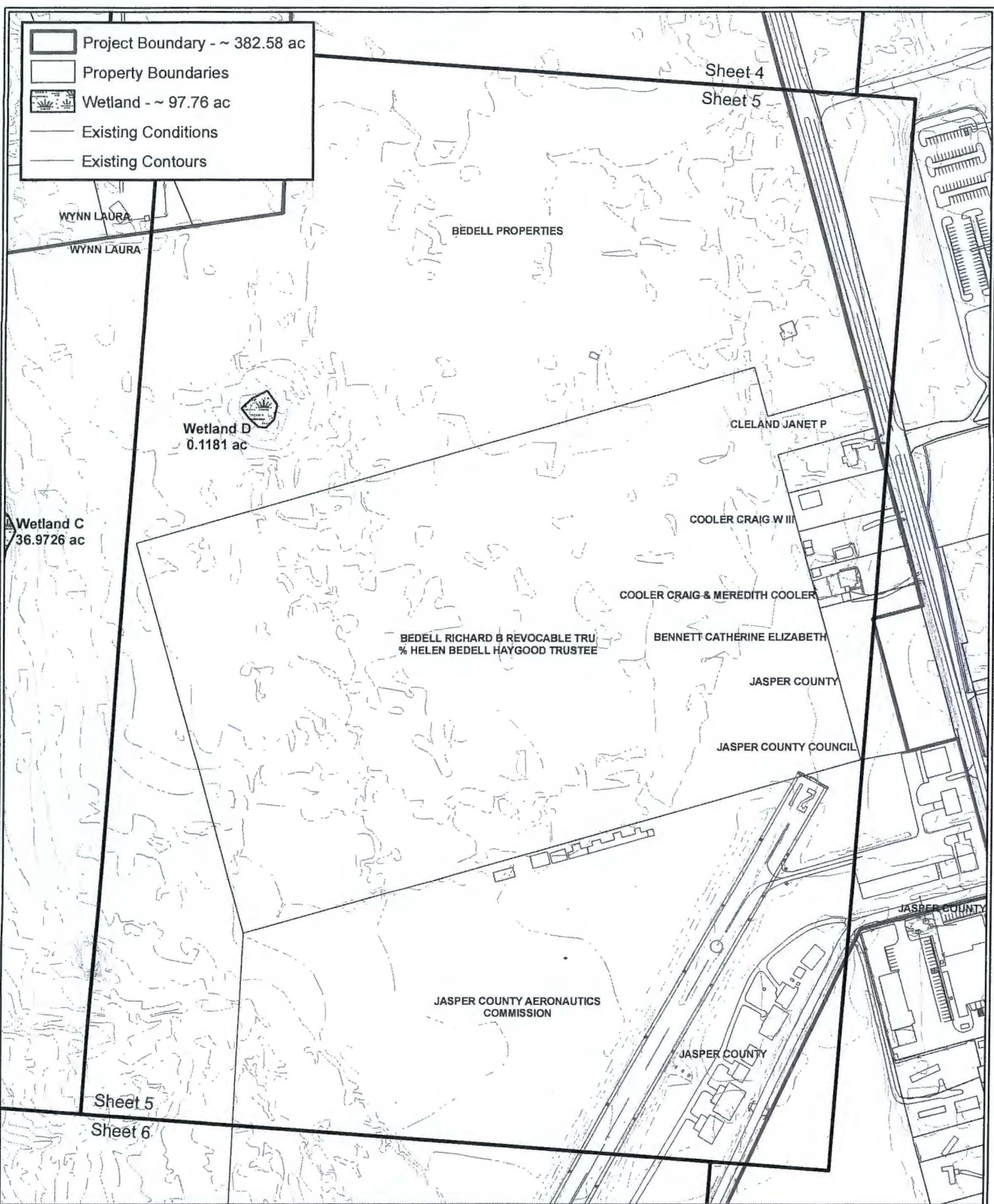





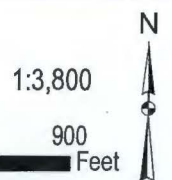
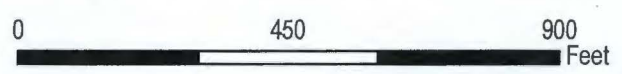

952 Houston Northcutt Blvd., Suite 100
 Mount Pleasant, South Carolina 29464
 Ph: (843) 556-2624 Fx: (843) 556-4329
 www.jmt.com

Sheet 5. Existing Conditions Map

Runway 18-36 Program.
 Ridgeland-Claude Dean Airport, Ridgeland, Jasper County, SC
 SAC 2008-00271-1Q
 Source: ESRI
 Date: April 2016



-  Project Boundary - ~382.58 ac
-  Property Boundaries
-  Wetland - ~ 97.76 ac
-  Cultural Site
-  Existing Conditions
-  Existing Contours

Sheet 5

Sheet 6

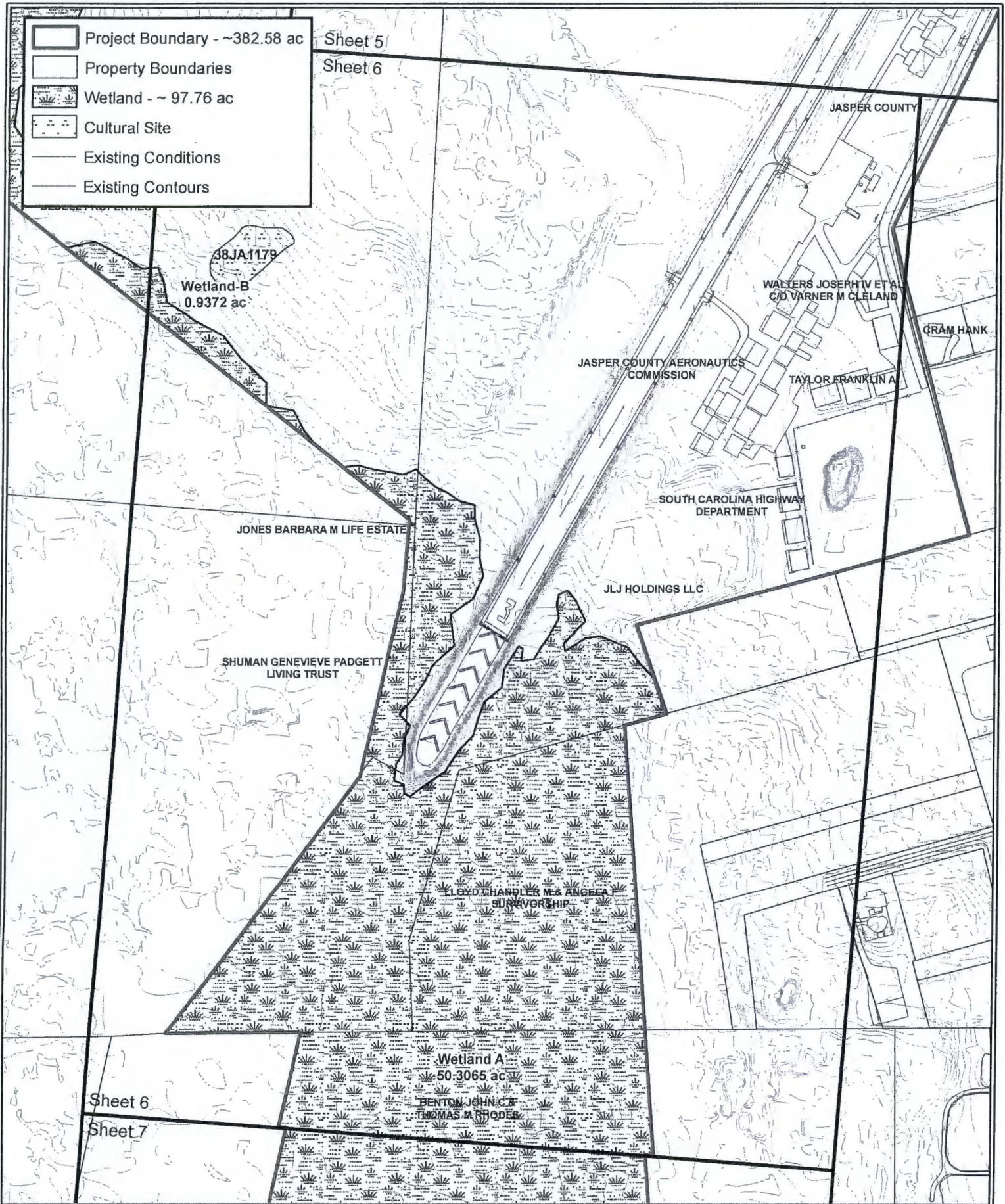

Sheet 6

Sheet 7



952 Houston Northcutt Blvd., Suite 100
 Mount Pleasant, South Carolina 29464
 Ph: (843) 556-2624 Fx: (843) 556-4329
 www.jmt.com

Sheet 6. Existing Conditions Map

Runway 18-36 Program
 Ridgeland-Claude Dean Airport, Ridgeland, Jasper County, SC

1:3,800

SAC 2008-00271-1Q

Source: ESRI

Date: April 2016

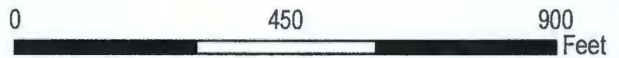

-  Project Boundary - ~382.58 ac
-  Property Boundaries
-  Wetland - ~ 97.76 ac
-  Existing Conditions
-  Existing Contours

Sheet 6
Sheet 7

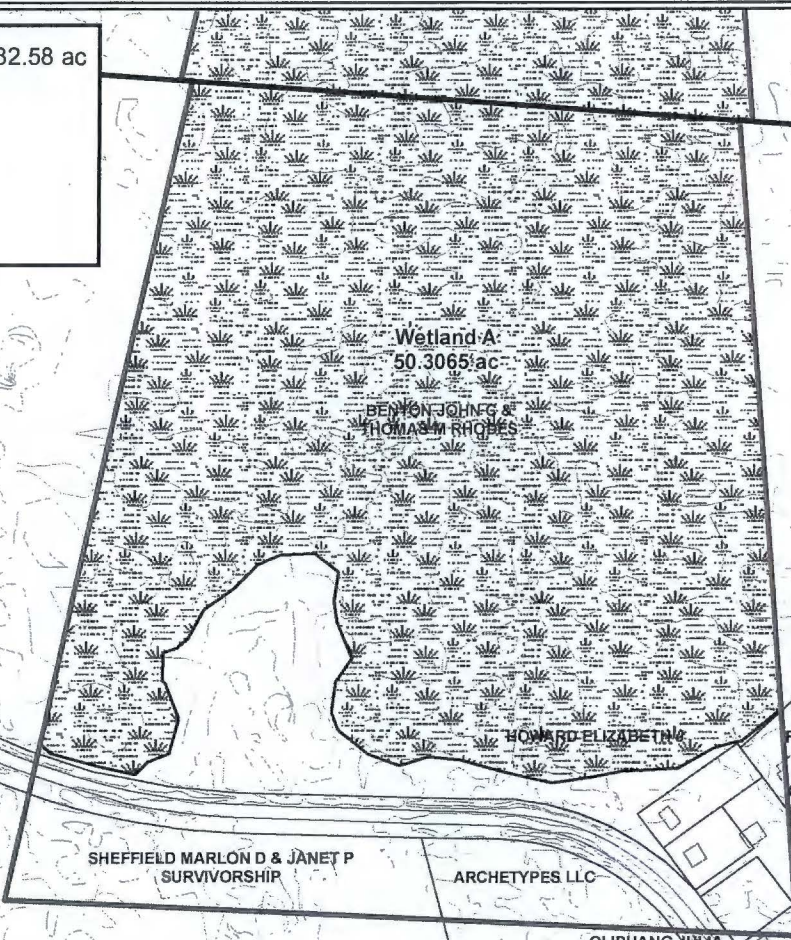

952 Houston Northcutt Blvd., Suite 100
Mount Pleasant, South Carolina 29464
Ph: (843) 556-2624 Fx: (843) 556-4329
www.jmt.com

Sheet 7. Existing Conditions Map
Runway 18-36 Program
Ridgeland-Claude Dean Airport, Ridgeland, Jasper County, SC
SAC 2008-00271-1Q
Source: ESRI
Date: April 2016

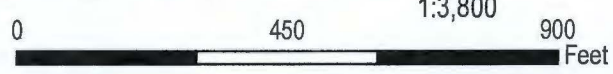

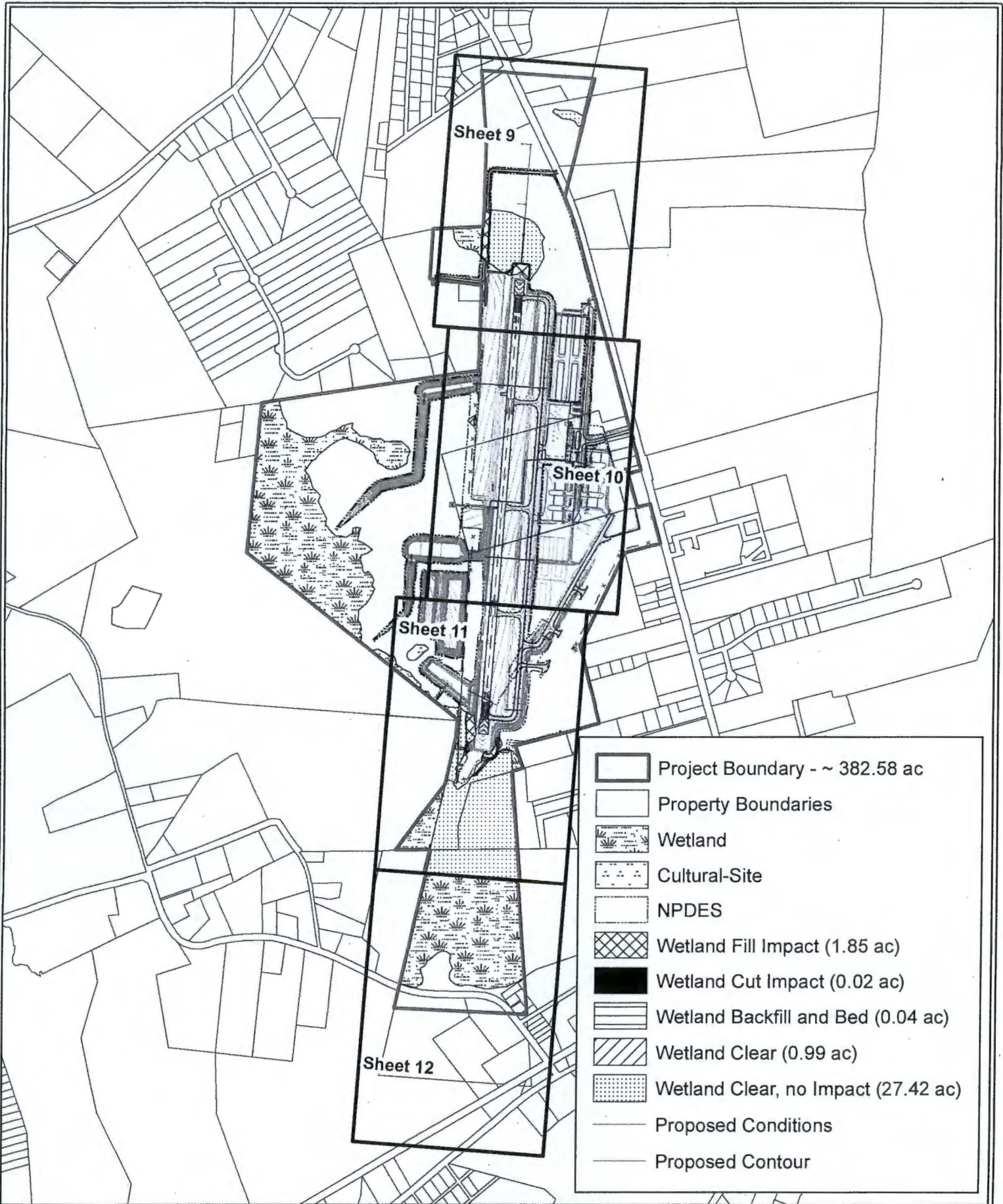

952 Houston Northcutt Blvd., Suite 100
 Mount Pleasant, South Carolina 29464
 Ph: (843) 556-2624 Fx: (843) 556-4329
 www.tidewaterenvironmental.com

Sheet 8. Proposed Conditions Index Map

Runway 18-36 Program
 Ridgeland-Claude Dean Airport, Ridgeland, Jasper County, SC

SAC 2008-00271-1Q

Source: ESRI

Date: April 2016

1:15,000

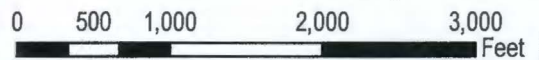

-  Project Boundary - ~382.58 ac
-  Property Boundaries
-  Wetland
-  NPDES
-  Wetland Fill Impacts (1.06 ac)
-  Wetland Cut Impacts (0.02 ac)
-  Backfill and Bed (0.04 ac)
-  Wetland Clear (0.30 ac)
-  Wetland Clear, no Impact (6.70 ac)
-  Proposed Conditions
-  Proposed Contour

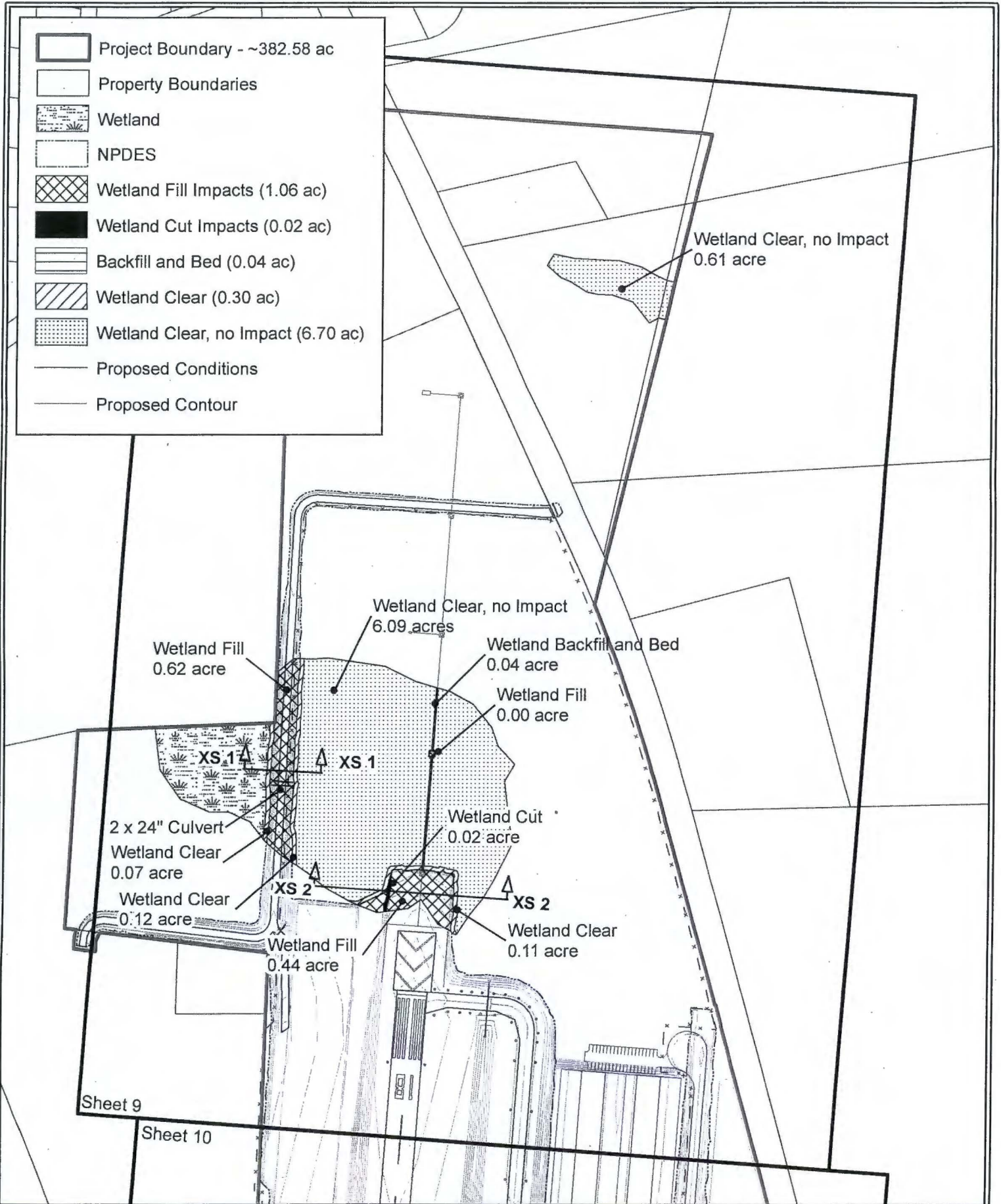

Sheet 9

Sheet 10



952 Houston Northcutt Blvd., Suite 100
 Mount Pleasant, South Carolina 29464
 Ph: (843) 556-2624 Fx: (843) 556-4329
 www.tidewaterenvironmental.com

Sheet 9. Proposed Conditions Map

Runway 18-36 Program
 Ridgeland-Claude Dean Airport, Ridgeland, Jasper County, SC

SAC 2008-00271-1Q

Source: ESRI

Date: April 2016

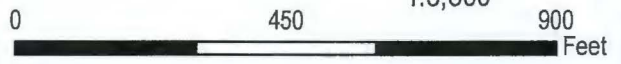

1:3,800



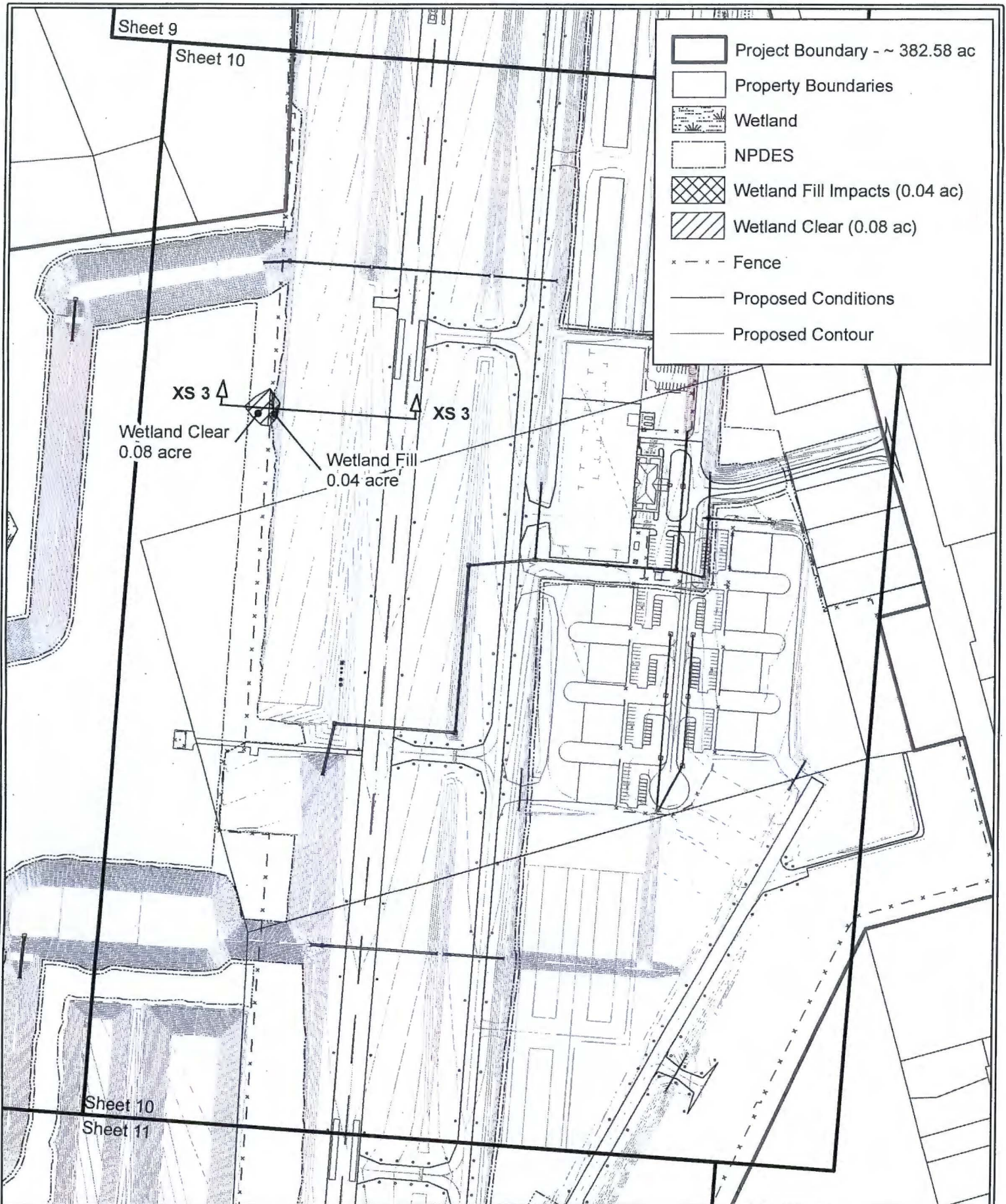

952 Houston Northcutt Blvd., Suite 100
 Mount Pleasant, South Carolina 29464
 Ph: (843) 556-2624 Fx: (843) 556-4329
www.tidewaterenvironmental.com

Sheet 10. Proposed Conditions Map

Runway 18-36 Program
 Ridgeland-Claude Dean Airport, Ridgeland, Jasper County, SC

SAC 2008-00271-1Q

Source: ESRI

Date: April 2016

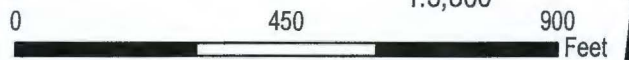

1:3,800

900 Feet

Sheet 10

Sheet 11

	Project Boundary - ~ 382.58 ac
	Property Boundaries
	Wetland
	Cultural Site
	NPDES
	Wetland Fill Impacts (0.75 ac)
	Wetland Clear (0.61 ac)
	Wetland Clear, no Impact (20.72 ac)
	Fence
	Proposed Conditions
	Proposed Contour

Wetland Fill
0.55 acre

Wetland Clear
0.43 acre

XS 4

XS 4

Wetland Fill
0.20 acre

Wetland Clear
0.18 acre

Wetland Clear, no Impact
20.72 acres

Sheet 11

Sheet 12



952 Houston Northcutt Blvd., Suite 100
Mount Pleasant, South Carolina 29464
Ph: (843) 556-2624 Fx: (843) 556-4329
www.tidewaterenvironmental.com

Sheet 11. Proposed Conditions Map

Runway 18-36 Program
Ridgeland-Claude Dean Airport, Ridgeland, Jasper County, SC
SAC 2008-00271-1Q
Source: ESRI
Date: April 2016

0 450 900 Feet

1:3,800

Sheet 11

Sheet 12

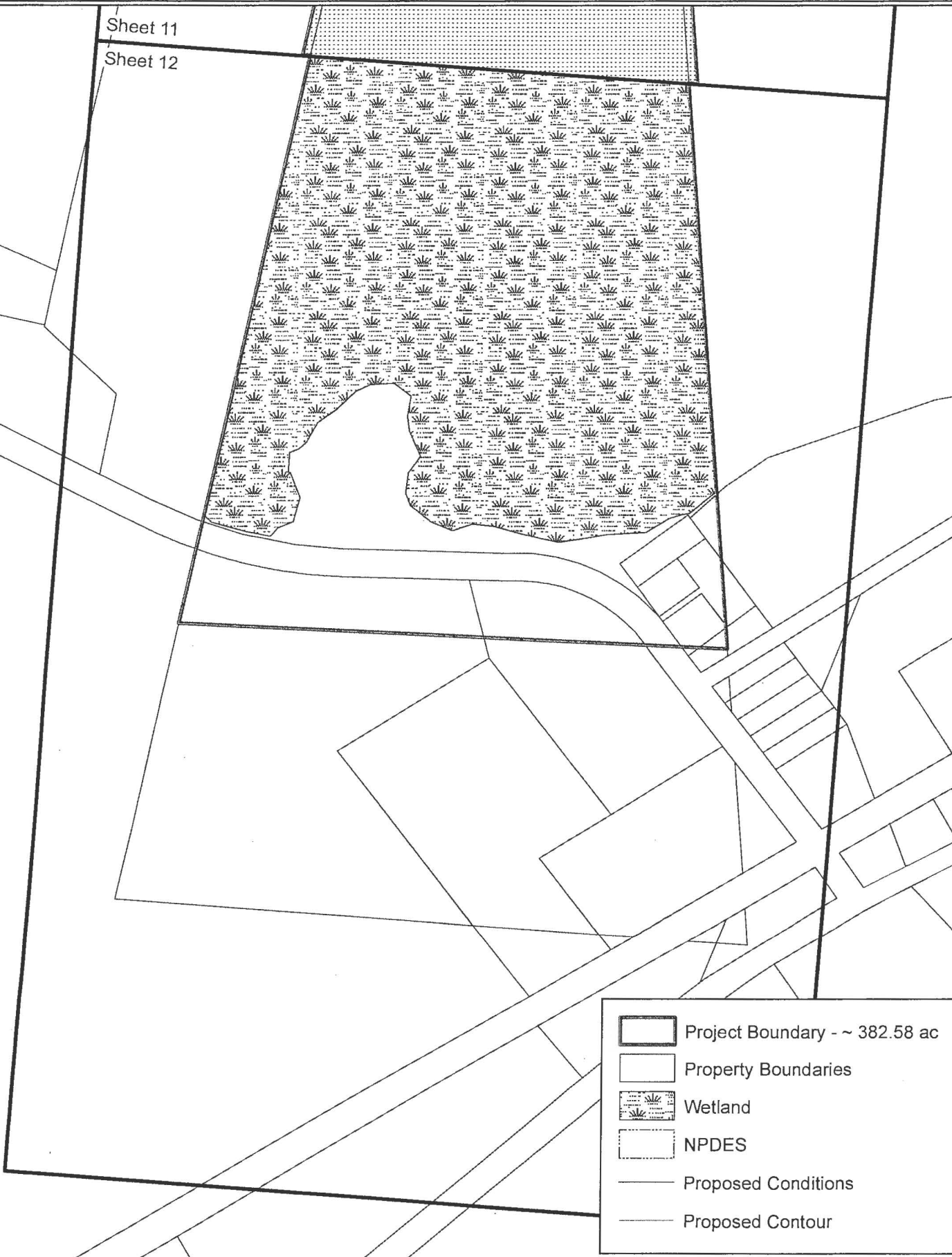

	Project Boundary - ~ 382.58 ac
	Property Boundaries
	Wetland
	NPDES
	Proposed Conditions
	Proposed Contour



952 Houston Northcutt Blvd., Suite 100
Mount Pleasant, South Carolina 29464
Ph: (843) 556-2624 Fx: (843) 556-4329
www.tidewaterenvironmental.com

Sheet 12. Proposed Conditions Map
Runway 18-36 Program
Ridgeland-Claude Dean Airport, Ridgeland, Jasper County, SC
SAC 2008-00271-1Q
Source: ESRI
Date: April 2016

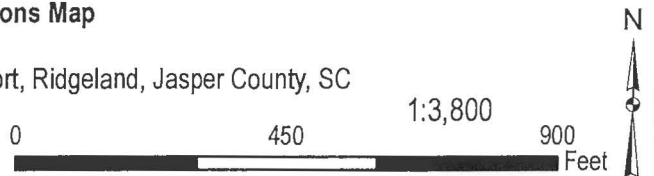

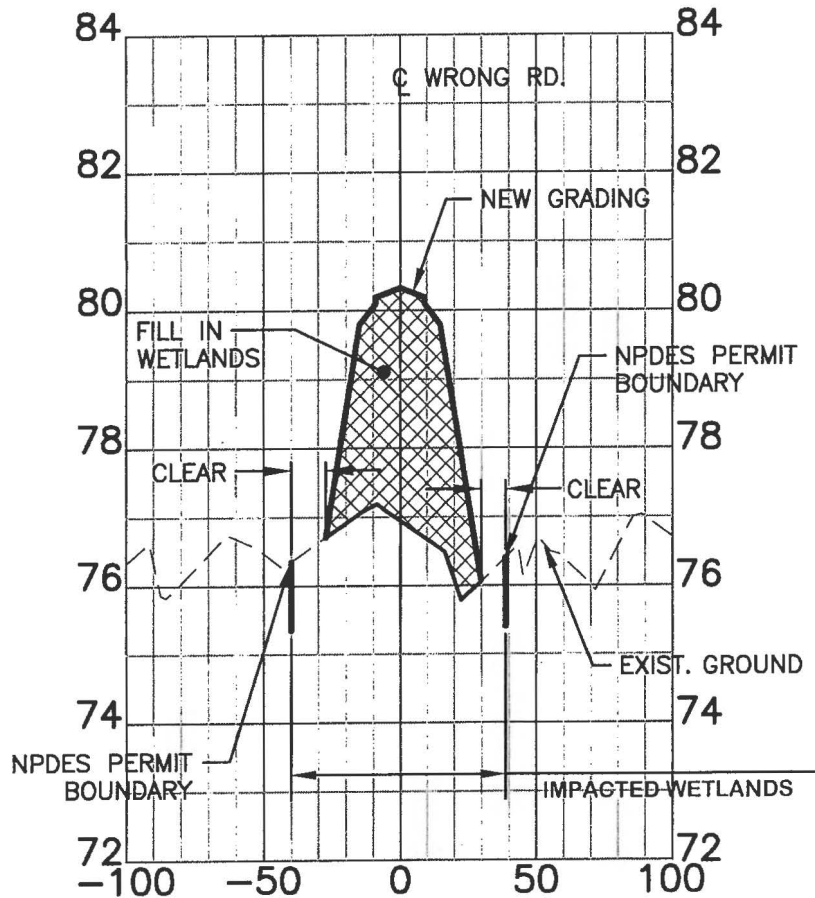

SECTION 1-1



952 Houston Northcutt Blvd., Suite 100
 Mount Pleasant, South Carolina 29464
 Ph: (843) 556-2624 Fx: (843) 556-4329
 www.tidewaterenvironmental.com

Sheet 13 Cross Sections

Runway 18-36 Program
 Ridgeland - Claude Dean Airport, Ridgeland, Jasper County, SC
 SAC 2008-00271-1Q
 Date: April 2016



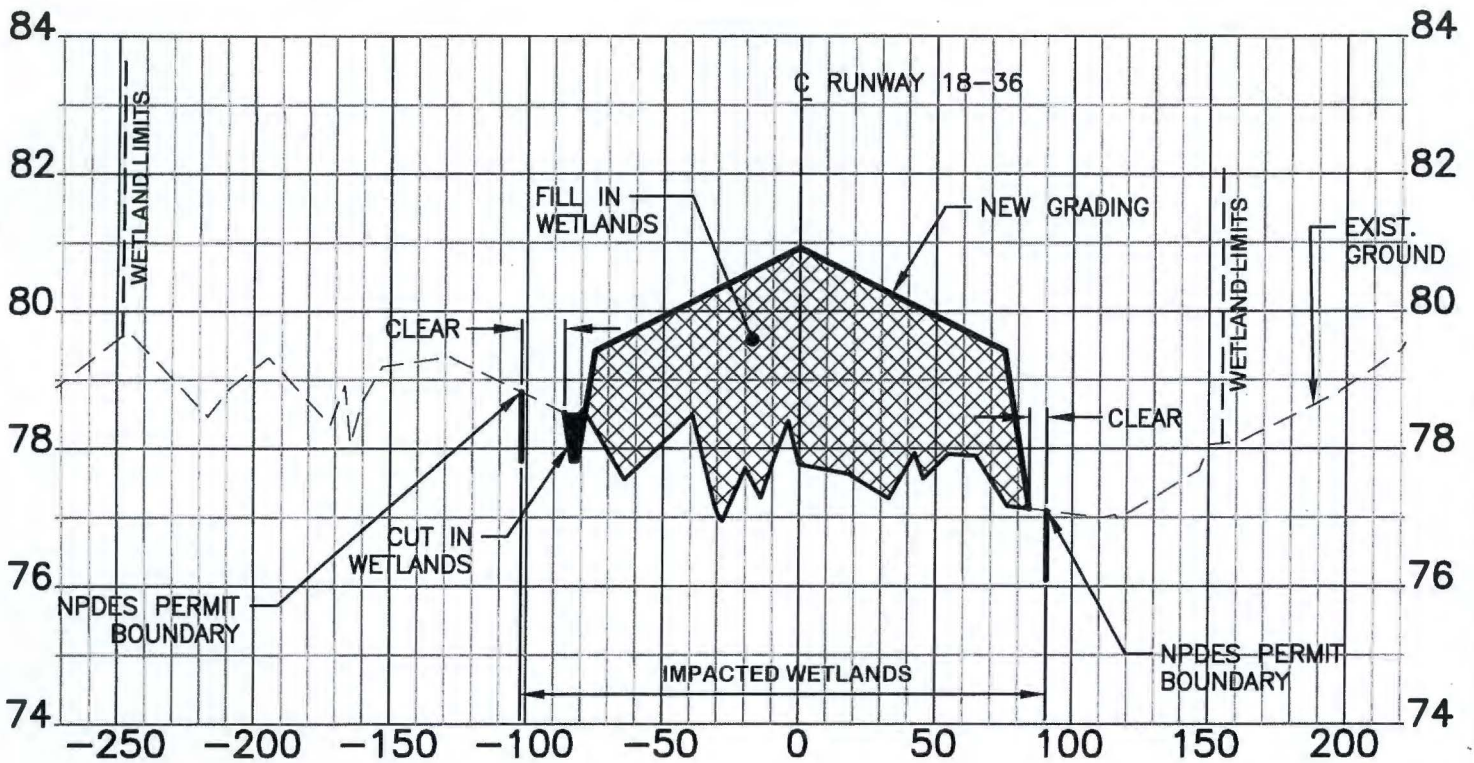

SECTION 2-2



952 Houston Northcutt Blvd., Suite 100
 Mount Pleasant, South Carolina 29464
 Ph: (843) 556-2624 Fx: (843)556-4329
 www.tidewaterenvironmental.com

Sheet 14 Cross Sections

Runway 18-36 Program
 Ridgeland - Claude Dean Airport, Ridgeland, Jasper County, SC

SAC 2008-00271-1Q

Date: April 2016

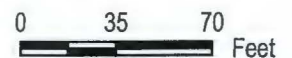

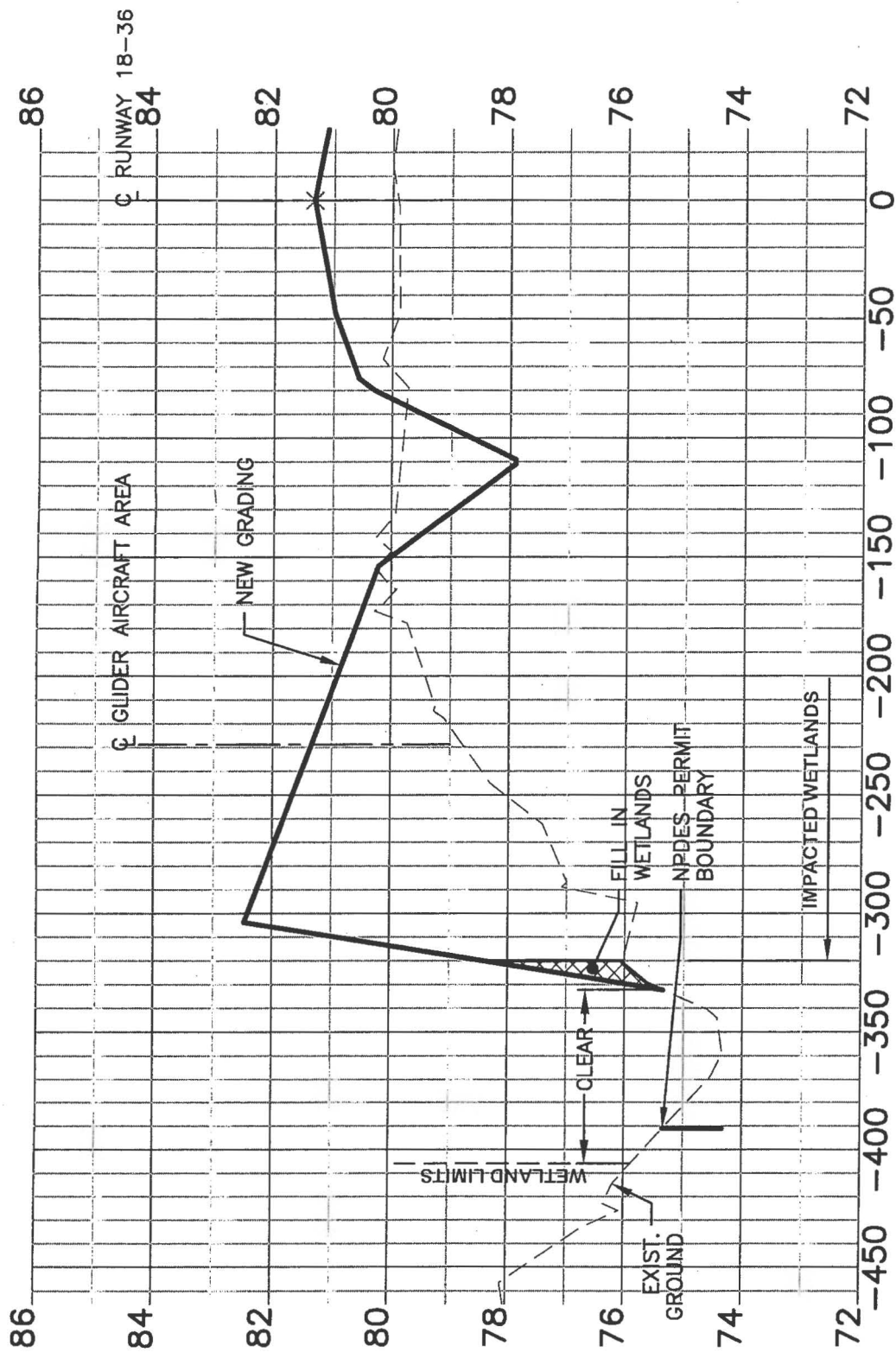

SECTION 3-3



952 Houston Northcutt Blvd., Suite 100
 Mount Pleasant, South Carolina 29464
 Ph: (843) 556-2624 Fx: (843)556-4329
 www.tidewaterenvironmental.com

Sheet 15 Cross Sections

Runway 18-36 Program
 Ridgeland - Claude Dean Airport, Ridgeland, Jasper County, SC
 SAC 2008-00271-1Q
 Date: April 2016



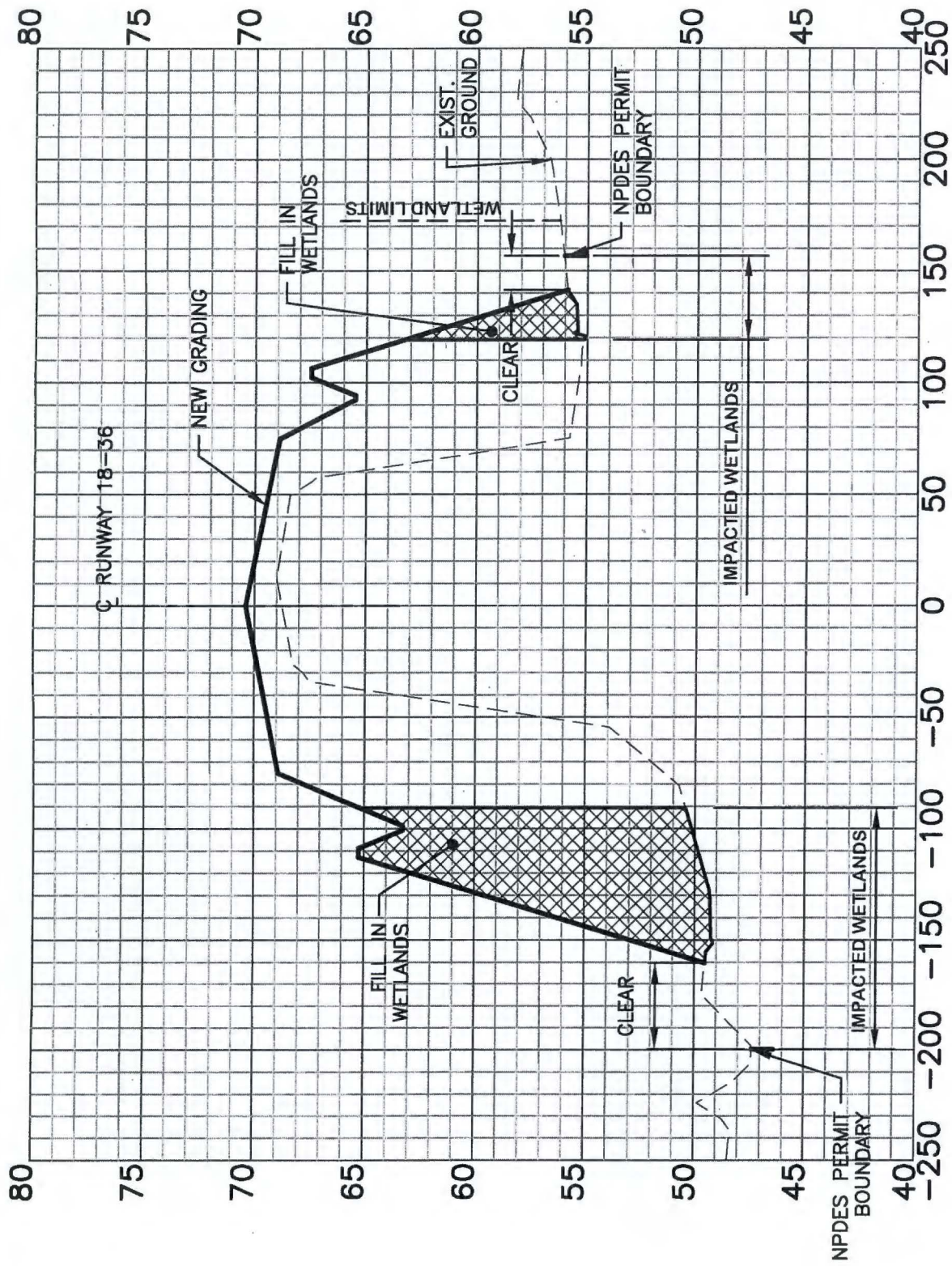

SECTION 4-4



952 Houston Northcutt Blvd., Suite 100
 Mount Pleasant, South Carolina 29464
 Ph: (843) 556-2624 Fx: (843)556-4329
 www.tidewaterenvironmental.com

Sheet 16 Cross Sections

Runway 18-36 Program
 Ridgeland - Claude Dean Airport, Ridgeland, Jasper County, SC
 SAC 2008-00271-1Q
 Date: April 2016

