

JOINT
PUBLIC NOTICE

CHARLESTON DISTRICT, CORPS OF ENGINEERS
69A Hagood Avenue
Charleston, SC 29403-5107

and

THE S.C. DEPARTMENT OF HEALTH AND ENVIRONMENTAL CONTROL
Office of Ocean and Coastal Resource Management
1362 McMillan Avenue, Suite 400
North Charleston, South Carolina 29405

REGULATORY DIVISION

Refer to: P/N SAC-2020-01477

June 30, 2021

Pursuant to Sections 401 and 404 of the Clean Water Act (33 U.S.C. 1344), and the South Carolina Coastal Zone Management Act (48-39-10 et.seq.), an application has been submitted to the Department of the Army and the S.C. Department of Health and Environmental Control by

Mr. Gabe Ebner
Lennar Carolinas LLC
1941 Savage Road
Charleston, South Carolina 29407

for a permit to construct a mixed-use development in

3.27 acres of jurisdictional wetlands

at a location near the intersection of US Hwy 176 and US Hwy 17A in Goose Creek, Berkeley County, South Carolina (Latitude: 33.0607°, Longitude: -80.1109°), USGS Quad Sheet - Mount Holly.

In order to give all interested parties an opportunity to express their views

NOTICE

is hereby given that written statements regarding the proposed work will be received by the **Corps** until

15 Days from the Date of this Notice,

and **SCDHEC** will receive written statements regarding the proposed work until

30 Days from the Date of this Notice

from those interested in the activity and whose interests may be affected by the proposed work.

The proposed work consists of constructing a mixed-use residential and commercial development within a 1,379.88-acre parcel, which will be part of the Carnes Crossroads Planned Unit District. In detail, 3.27 acres of jurisdictional non-tidal wetlands and 0.12 acre of jurisdictional tributaries will be filled to construct an access road network throughout the parcel. Furthermore, 10.39 acres of excluded non-jurisdictional wetlands will be filled to facilitate the development. The

applicant has proposed to mitigate for the impacts to 3.39 acres of jurisdictional waters of the United States by purchasing 35.6 wetland credits from an approved mitigation bank. The project purpose is to provide a mixed-use development within close proximity to current and planned infrastructure to include schools, hospitals, jobs, roadways, and utilities within the growing area of Berkeley County, South Carolina.

NOTE: This public notice and associated plans are available on the Corps' website at: <http://www.sac.usace.army.mil/Missions/Regulatory/PublicNotices> .

The District Engineer has concluded that the discharges associated with this project, both direct and indirect, should be reviewed by the South Carolina Department of Health and Environmental Control in accordance with provisions of Section 401 of the Clean Water Act. As such, this notice constitutes a request, on behalf of the applicant, for certification that this project will comply with applicable effluent limitations and water quality standards. The work shown on this application must also be certified as consistent with applicable provisions of the Coastal Zone Management Program (15 CFR 930). This activity may also require evaluation for compliance with the S. C. Construction in Navigable Waters Permit Program. State review, permitting and certification is conducted by the S. C. Department of Health and Environmental Control. The District Engineer will not process this application to a conclusion until such certifications are received. The applicant is hereby advised that supplemental information may be required by the State to facilitate the review.

This notice initiates the Essential Fish Habitat (EFH) consultation requirements of the Magnuson-Stevens Fishery Conservation and Management Act. Implementation of the proposed project would impact 3.27 acres of jurisdictional non-tidal wetlands upstream of estuarine substrates and emergent wetlands utilized by various life stages of species comprising the shrimp, and snapper-grouper management complexes. The District Engineer's initial determination is that the proposed action would not have a substantial individual or cumulative adverse impact on EFH or fisheries managed by the South Atlantic Fishery Management Council and the National Marine Fisheries Service (NMFS). The District Engineer's final determination relative to project impacts and the need for mitigation measures is subject to review by and coordination with the NMFS.

Pursuant to the Section 7 of the Endangered Species Act of 1973 (as amended), the Corps has reviewed the project area, examined all information provided by the applicant, and the District Engineer has determined that the project will have no effect on the frosted flatwoods salamander, American wood stork, red-cockaded woodpecker, Atlantic sturgeon, shortnose sturgeon, West Indian manatee, American Chaffseed, and Canby's dropwort. Furthermore, the District Engineer has determined that the project is not likely to adversely affect the Northern long-eared bat and the pondberry; and will not result in the destruction or adverse modification of designated or proposed critical habitat. This public notice serves as a request for written concurrence from the U.S. Fish and Wildlife Service and/or the National Marine Fisheries Service on this determination.

Pursuant to Section 106 of the National Historic Preservation Act (NHPA), this public notice also constitutes a request to Indian Tribes to notify the District Engineer of any historic properties of religious and cultural significance to them that may be affected by the proposed undertaking.

In accordance with Section 106 of the NHPA, the District Engineer has consulted South Carolina ArchSite (GIS), for the presence or absence of historic properties (as defined in 36 C.F.R. 800.16)(1)), and has initially determined that no historic properties are present;

therefore, there will be no effect on historic properties. To ensure that other historic properties that the District Engineer is not aware of are not overlooked, this public notice also serves as a request to the State Historic Preservation Office and any other interested parties to provide any information they may have with regard to historic properties. This public notice serves as a request for concurrence within 30 days from the SHPO (and/or Tribal Historic Preservation Officer).

The District Engineer's final eligibility and effect determination will be based upon coordination with the SHPO and/or THPO, as appropriate and required and with full consideration given to the proposed undertaking's potential direct and indirect effects on historic properties within the Corps-identified permit area.

Any person may request, in writing, within the comment period specified in this notice, that a public hearing be held to consider this application. Requests for a public hearing shall state, with particularity, the reasons for holding a public hearing.

The decision whether to issue a permit will be based on an evaluation of the probable impact including cumulative impacts of the activity on the public interest and will include application of the guidelines promulgated by the Administrator, Environmental Protection Agency (EPA), under authority of Section 404(b) of the Clean Water Act. That decision will reflect the national concern for both protection and utilization of important resources. The benefit which reasonably may be expected to accrue from the project must be balanced against its reasonably foreseeable detriments. All factors which may be relevant to the project will be considered including the cumulative effects thereof; among those are conservation, economics, aesthetics, general environmental concerns, wetlands, historic properties, fish and wildlife values, flood hazards, flood plain values, land use, navigation, shoreline erosion and accretion, recreation, water supply and conservation, water quality, energy needs, safety, food and fiber production and, in general, the needs and welfare of the people. A permit will be granted unless the District Engineer determines that it would be contrary to the public interest. In cases of conflicting property rights, the Corps cannot undertake to adjudicate rival claims.

The Corps is soliciting comments from the public; Federal, state, and local agencies and officials; Indian Tribes; and other interested parties in order to consider and evaluate the impacts of this activity. Any comments received will be considered by the Corps to determine whether to issue, modify, condition or deny a permit for this project. To make this decision, comments are used to assess impacts on endangered species, historic properties, water quality, general environmental effects, and the other public interest factors listed above. Comments are used in the preparation of an Environmental Assessment and/or an Environmental Impact Statement pursuant to the National Environmental Policy Act. Comments are also used to determine the need for a public hearing and to determine the overall public interest of the activity. **Please submit comments in writing, identifying the project of interest by public notice number, to the following address:**

**U.S. Army Corps of Engineers
ATTN: REGULATORY DIVISION
69A Hagood Avenue
Charleston, SC 29403-5107**

If there are any questions concerning this public notice, please contact Leslie Estill, Project Manager, at 843-329-8039, or by email at Leslie.A.Estill@usace.army.mil.

Z:\18717\18717.000\Engineering\Drawings\Wetland\Permit_Drawings\West Tract\WP\18717.0001 - Quad Map.dwg - Mar 30, 2021 - 5:17:37 PM

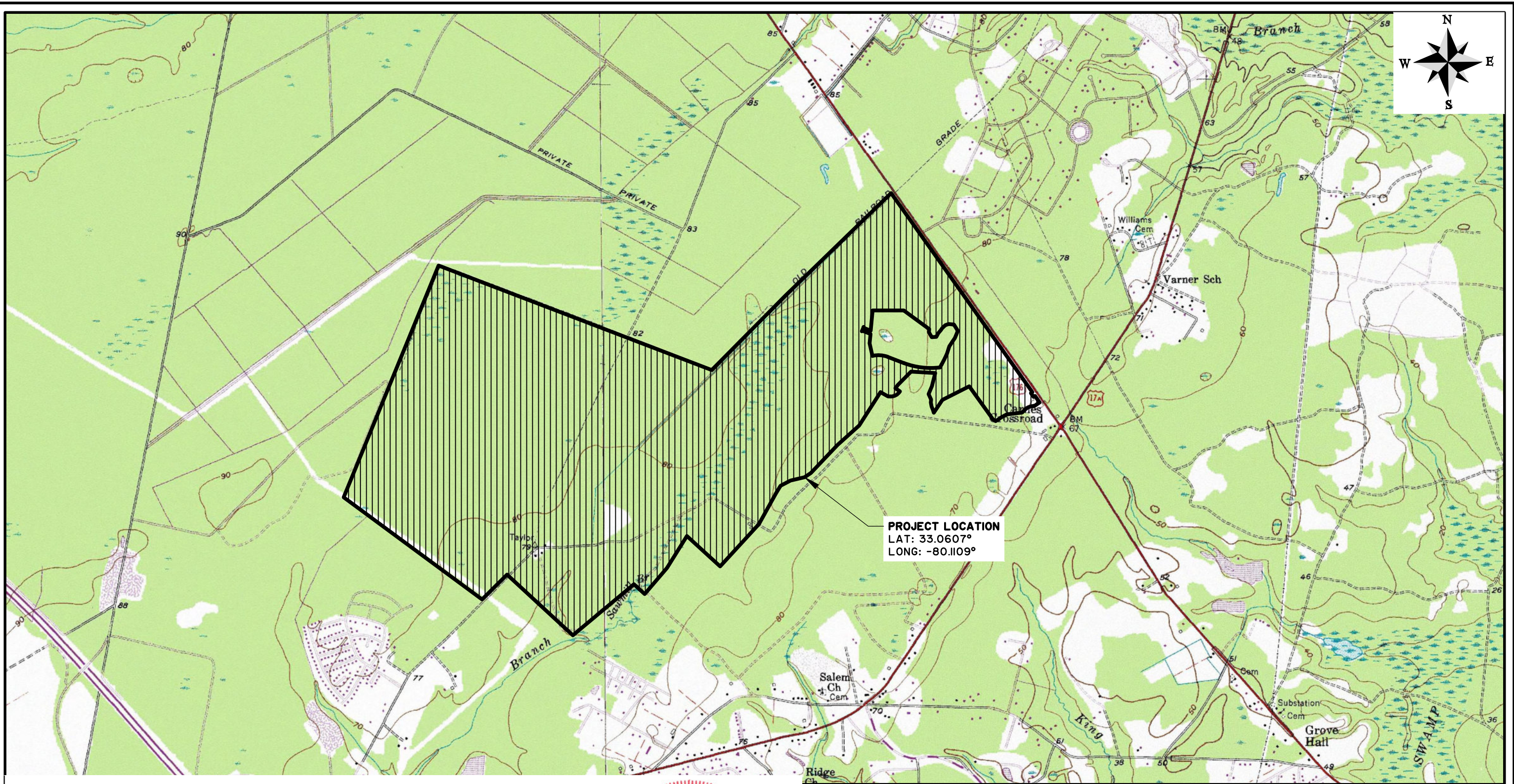

PROJECT LOCATION
LAT: 33.0607°
LONG: -80.1109°

GRAPHIC SCALE



(IN FEET)
1 inch = 2000ft.



CARNES CROSSROADS - WEST TRACT

INDIVIDUAL WETLAND PERMIT

QUAD MAP

CLIENT:
LENNAR CAROLINAS, LLC

LOCATION: BERKELY COUNTY, SC

DATE: 04/28/2021

JOB NUMBER: J-18717.0001

DRAWN BY: BAL

REVIEWED BY: BDR

SHEET: 1

SCALE: 1" = 2000'

THOMAS & HUTTON
Engineering | Surveying | Planning | GIS | Consulting

682 Johnnie Dodds Blvd. • Suite 100
Mt. Pleasant, SC 29464 • 843.849.0200

www.thomasandhutton.com

Z:\18717\18717.0001\Engineering\Drawings\Wetland Permit Drawings\West Tract\WP\18717.0001 - Impact Summary.dwg - Apr. 1, 2021 - 11:09:42 AM

Wetland Impact / Preservation Summary

Carnes Crossroads - West Tract

Berkeley County, SC

Prepared For: Lennar Carolinas, LLC

Prepared By: Thomas & Hutton

Item	Wetland Number	Wetland Size (acres)	FILL (acres)	PRESERVE (acres)	BUFFER (acres)	FILL (CY)	RIPRAP (CY)
1	A (J.F.W)	37.98	0.38	37.60	6.60	1226.14	8.33
2	P (J.F.W)	8.50	0.00	8.50	1.49	0.00	0.00
3	Q (J.F.W)	0.65	0.00	0.65	0.36	0.00	0.00
4	R (J.F.W)	101.46	0.79	100.67	9.51	2549.08	20.67
5	U (J.F.W)	34.97	0.74	34.23	4.08	2387.75	11.11
6	W (J.F.W)	1.83	0.00	1.83	0.50	0.00	0.00
7	X (J.F.W)	0.17	0.00	0.17	0.12	0.00	0.00
8	Y (J.F.W)	2.41	0.00	2.41	1.49	0.00	0.00
9	BB (J.F.W)	22.22	0.85	21.37	5.85	2742.68	5.56
10	HH (J.F.W)	12.70	0.51	12.19	4.33	1645.61	11.93
Total		222.89	3.27	219.62	34.33	10551.26	57.60

LEGEND

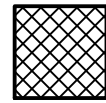

SITE DEVELOPMENT
WETLAND FILL

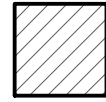

PROPOSED WETLAND BUFFER
TO BE PROVIDED

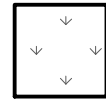

WETLANDS (J.F.W.) & (E.F.W.)
TO BE PRESERVED

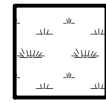

JURISDICTIONAL TRIBUTARY (J.T.)
TO BE PRESERVED

EXISTING SITE CHARACTERISTICS

UPLAND AREA = 1,090.36 ACRES

WETLAND AREA = 287.50 ACRES

JURISDICTIONAL TRIBUTARY AREA* = 2.02 ACRES

TOTAL PROJECT AREA = 1,379.88 ACRES

*EXCLUDES TRIBUTARIES LOCATED WITHIN WETLANDS

ABBREVIATIONS

J.F.W.	JURISDICTIONAL FRESHWATER WETLAND
E.F.W.	EXCLUDED FRESHWATER WETLAND
J.T.	JURISDICTIONAL TRIBUTARY

Excluded Wetland Impact / Preservation Summary

Carnes Crossroads - West Tract

Berkeley County, SC

Prepared For: Lennar Carolinas, LLC

Prepared By: Thomas & Hutton

Item	Wetland Number	Wetland Size (acres)	FILL (acres)	PRESERVE (acres)	BUFFER (acres)	FILL (CY)	RIPRAP (CY)
1	B (E.F.W)	1.05	1.05	0.00	0.00	3391.25	0.00
2	C (E.F.W)	1.79	1.79	0.00	0.00	5788.67	0.00
3	D (E.F.W)	3.08	0.00	3.08	0.84	0.00	0.00
4	E (E.F.W)	2.27	0.00	2.27	0.82	0.00	0.00
5	F (E.F.W)	16.77	0.00	16.77	1.26	0.00	0.00
6	G (E.F.W)	2.35	0.00	2.35	0.86	0.00	0.00
7	H (E.F.W)	2.39	0.00	2.39	1.04	0.00	0.00
8	i (E.F.W)	0.58	0.58	0.00	0.00	1881.16	0.00
9	J (E.F.W)	1.00	1.00	0.00	0.00	3233.14	0.00
10	K (E.F.W)	20.74	0.79	19.95	2.64	2549.08	11.91
11	L (E.F.W)	0.71	0.71	0.00	0.00	2281.27	0.00
12	M (E.F.W)	0.85	0.85	0.00	0.00	2745.91	0.00
13	N (E.F.W)	1.82	0.00	1.82	0.30	0.00	0.00
14	O (E.F.W)	1.10	1.10	0.00	0.00	3546.13	0.00
15	S (E.F.W)	0.57	0.00	0.57	0.23	0.00	0.00
16	T (E.F.W)	0.40	0.40	0.00	0.00	1284.22	0.00
17	V (E.F.W)	0.66	0.00	0.66	0.48	0.00	0.00
18	Z (E.F.W)	0.38	0.38	0.00	0.00	1222.91	0.00
19	AA (E.F.W)	0.35	0.00	0.35	0.15	0.00	0.00
20	CC (E.F.W)	0.34	0.00	0.34	0.19	0.00	0.00
21	DD (E.F.W)	0.26	0.26	0.00	0.00	838.94	0.00
22	EE (E.F.W)	3.66	0.00	3.66	1.81	0.00	0.00
23	GG (E.F.W)	1.48	1.48	0.00	0.00	4775.50	0.00
Total		64.61	10.39	54.22	10.62	33538.17	11.91

Jurisdictional Tributary Impact / Preservation Summary

Carnes Crossroads - West Tract

Berkeley County, SC

Prepared For: Lennar Carolinas, LLC

Prepared By: Thomas & Hutton

Item	Jurisdictional Tributary Number	Existing Jurisdictional Tributary Size (acres)	Jurisdictional Tributary Length (LF)	FILL (acres)	FILL (LF)	PRESERVE (acres)	PRESERVE (LF)	FILL (CY)	RIPRAP (CY)
1	A (J.T.)	0.12	285.00	0.00	0.00	0.12	285.00	0.00	0.00
2	B (J.T.)	0.39	1420.00	0.00	0.00	0.39	1420.00	0.00	0.00
3	C (J.T.)	1.80	3955.00	0.12	220.00	1.68	3735.00	387.20	16.67
4	D (J.T.)	0.40	1470.00	0.00	0.00	0.40	1470.00	0.00	0.00
5	E (J.T.)	0.48	1730.00	0.00	0.00	0.48	1730.00	0.00	0.00
6	F (J.T.)	0.18	960.00	0.00	0.00	0.18	960.00	0.00	0.00
7	G (J.T.)	0.05	124.00	0.00	0.00	0.05	124.00	0.00	0.00
8	H (J.T.)	0.87	1902.00	0.00	0.00	0.87	1902.00	0.00	0.00
9	i (J.T.)	0.14	510.00	0.00	0.00	0.14	510.00	0.00	0.00
10	J (J.T.)	0.21	455.00	0.00	0.00	0.21	455.00	0.00	0.00
Total		4.13	11106.00	0.12	220.00	4.01	10886.00	387.20	16.67



CARNES CROSSROADS - WEST TRACT

INDIVIDUAL WETLAND PERMIT

IMPACT SUMMARY

CLIENT:

LENNAR CAROLINAS, LLC

LOCATION: BERKELY COUNTY, SC

DATE: 04/28/2021

JOB NUMBER: J-18717.0001

DRAWN BY: BAL

REVIEWED BY: BDR

SHEET: 2

SCALE: N.T.S.



682 Johnnie Dodds Blvd. • Suite 100
Mt. Pleasant, SC 29464 • 843.849.0200

www.thomasandhutton.com

Z:\18717\18717.000\Engineering\Drawings\Wetland Permit Drawings\West Tract\WP-18717.0001 - Overall Site Plan.dwg - Apr 1, 2021 - 1:55:51 PM

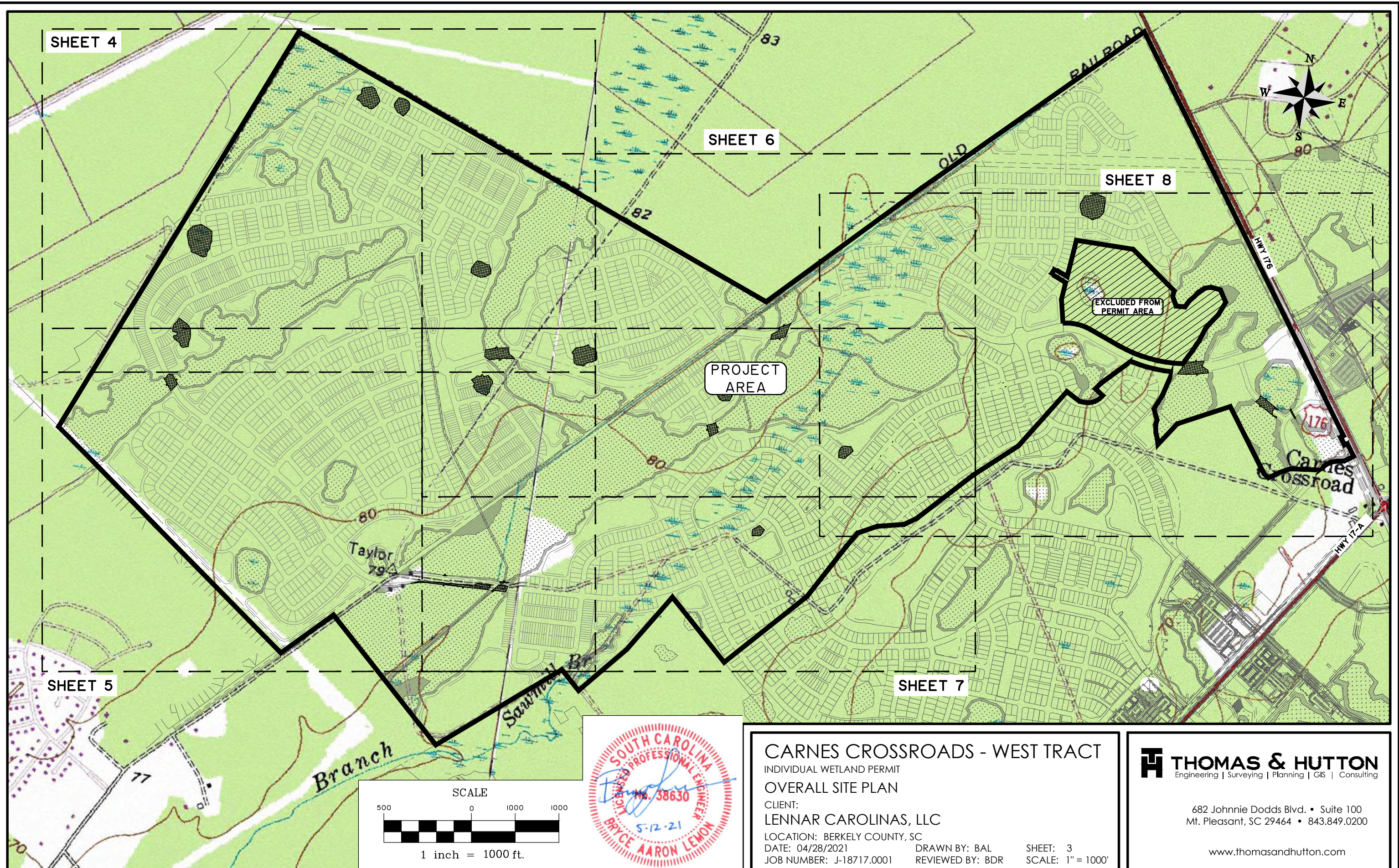

PROJECT AREA

EXCLUDED FROM PERMIT AREA

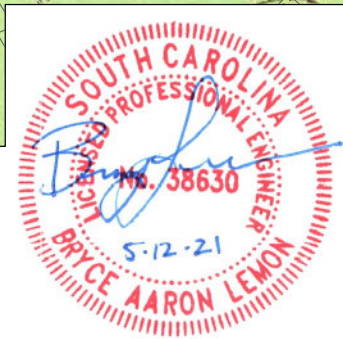
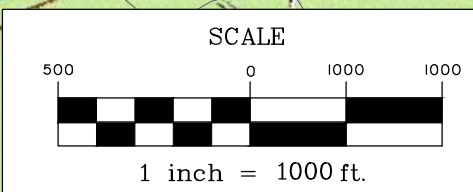

CARNES CROSSROADS - WEST TRACT
 INDIVIDUAL WETLAND PERMIT
OVERALL SITE PLAN
 CLIENT:
LENNAR CAROLINAS, LLC
 LOCATION: BERKELY COUNTY, SC
 DATE: 04/28/2021 DRAWN BY: BAL SHEET: 3
 JOB NUMBER: J-18717.0001 REVIEWED BY: BDR SCALE: 1" = 1000'

THOMAS & HUTTON
 Engineering | Surveying | Planning | GIS | Consulting

682 Johnnie Dodds Blvd. • Suite 100
 Mt. Pleasant, SC 29464 • 843.849.0200

www.thomasandhutton.com

Z:\18717\18717.000\Engineering\Drawings\Wetland Permit Drawings\West Tract\WP\18717.0001 - Site Plan.dwg - Jul 31, 2020 - 10:51:2 AM

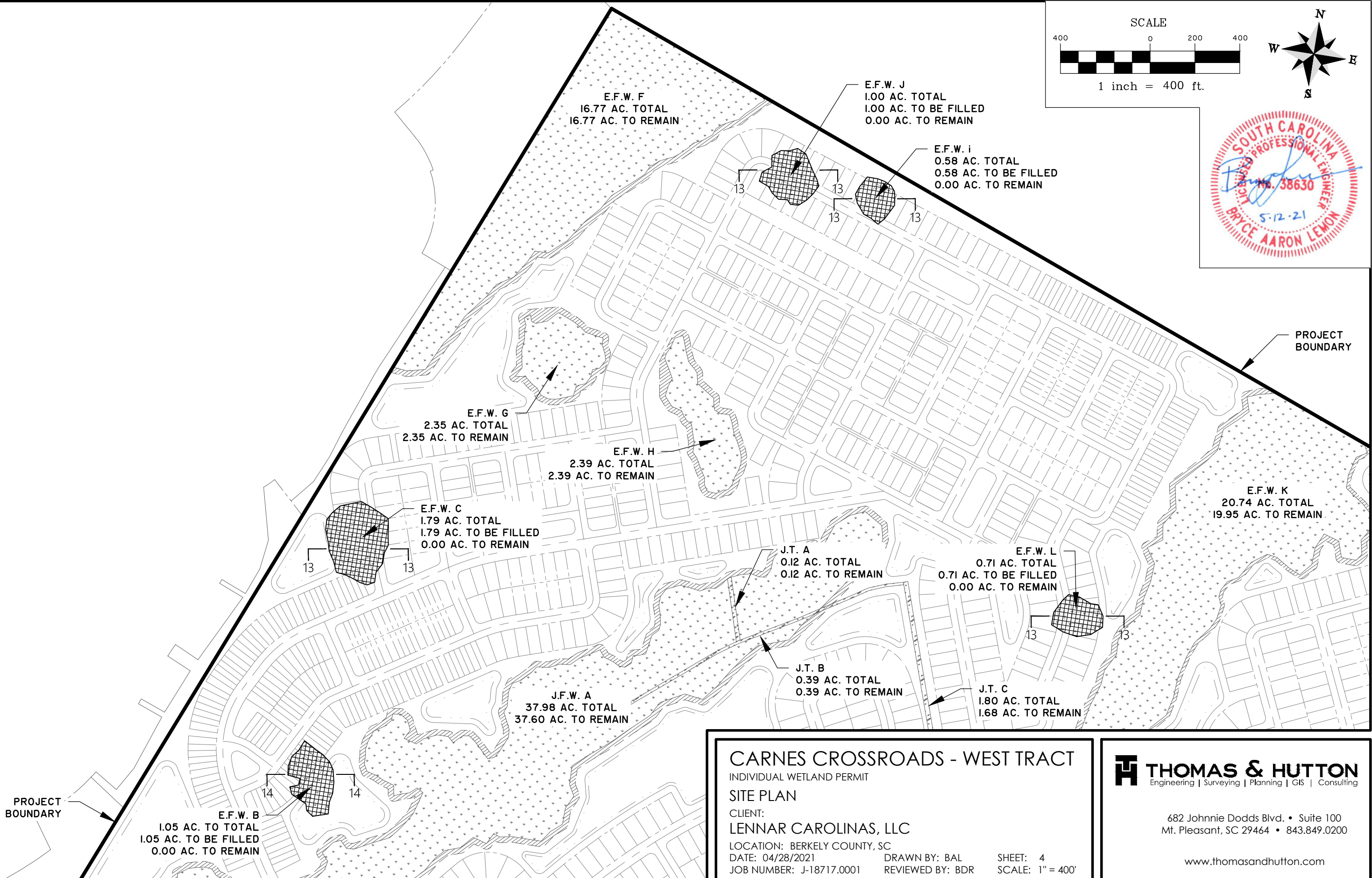
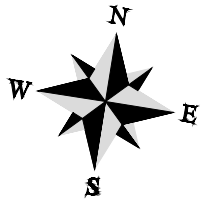
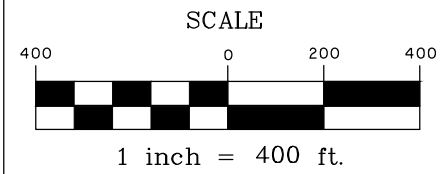

E.F.W. F
16.77 AC. TOTAL
16.77 AC. TO REMAIN

E.F.W. J
1.00 AC. TOTAL
1.00 AC. TO BE FILLED
0.00 AC. TO REMAIN

E.F.W. i
0.58 AC. TOTAL
0.58 AC. TO BE FILLED
0.00 AC. TO REMAIN

E.F.W. G
2.35 AC. TOTAL
2.35 AC. TO REMAIN

E.F.W. H
2.39 AC. TOTAL
2.39 AC. TO REMAIN

E.F.W. C
1.79 AC. TOTAL
1.79 AC. TO BE FILLED
0.00 AC. TO REMAIN

E.F.W. K
20.74 AC. TOTAL
19.95 AC. TO REMAIN

J.T. A
0.12 AC. TOTAL
0.12 AC. TO REMAIN

E.F.W. L
0.71 AC. TOTAL
0.71 AC. TO BE FILLED
0.00 AC. TO REMAIN

J.T. B
0.39 AC. TOTAL
0.39 AC. TO REMAIN

J.T. C
1.80 AC. TOTAL
1.68 AC. TO REMAIN

J.F.W. A
37.98 AC. TOTAL
37.60 AC. TO REMAIN

E.F.W. B
1.05 AC. TO TOTAL
1.05 AC. TO BE FILLED
0.00 AC. TO REMAIN

CARNES CROSSROADS - WEST TRACT
INDIVIDUAL WETLAND PERMIT
SITE PLAN
CLIENT:
LENNAR CAROLINAS, LLC
LOCATION: BERKELY COUNTY, SC
DATE: 04/28/2021 DRAWN BY: BAL SHEET: 4
JOB NUMBER: J-18717.0001 REVIEWED BY: BDR SCALE: 1" = 400'

THOMAS & HUTTON
Engineering | Surveying | Planning | GIS | Consulting
682 Johnnie Dodds Blvd. • Suite 100
Mt. Pleasant, SC 29464 • 843.849.0200
www.thomasandhutton.com

Z:\18717\18717.000\Engineering\Drawings\Wetland Permit Drawings\West Tract\WP\18717.0001 - Site Plan.dwg - Jul 31, 2020 - 10:51:21 AM

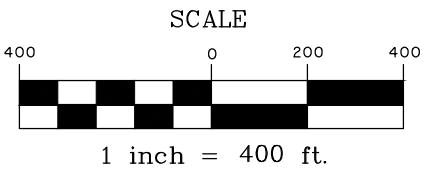
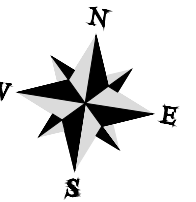
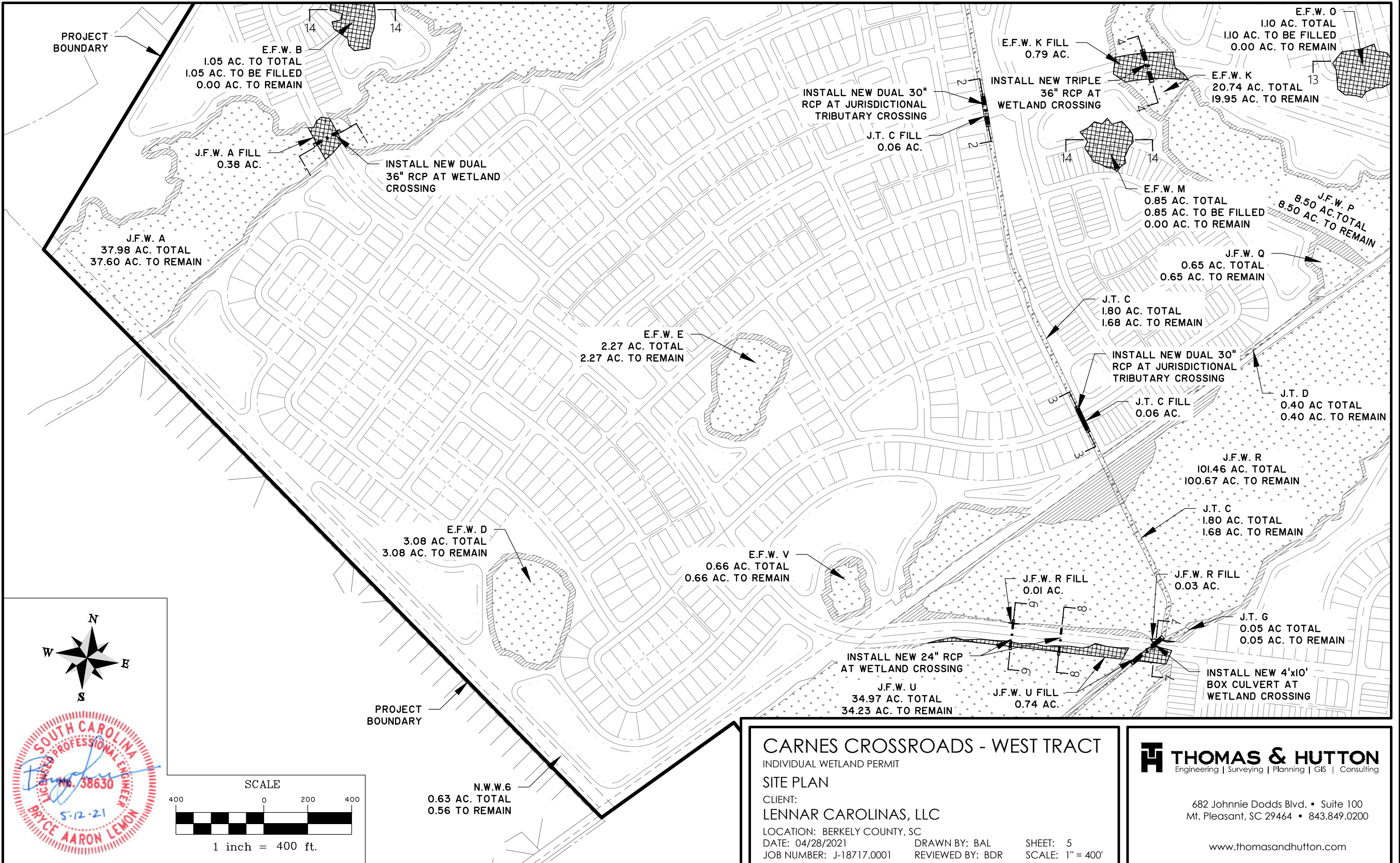

CARNES CROSSROADS - WEST TRACT
 INDIVIDUAL WETLAND PERMIT
SITE PLAN
 CLIENT:
LENNAR CAROLINAS, LLC
 LOCATION: BERKELY COUNTY, SC
 DATE: 04/28/2021 DRAWN BY: BAL SHEET: 5
 JOB NUMBER: J-18717.0001 REVIEWED BY: BDR SCALE: 1" = 400'

THOMAS & HUTTON
 Engineering | Surveying | Planning | GIS | Consulting
 682 Johnnie Dodds Blvd. • Suite 100
 Mt. Pleasant, SC 29464 • 843.849.0200
 www.thomasandhutton.com

Z:\18717\18717.000\Engineering\Drawings\Wetland Permit Drawings\West Tract\WP\18717.0001 - Site Plan.dwg - Jul 31, 2020 - 10:51:21 AM

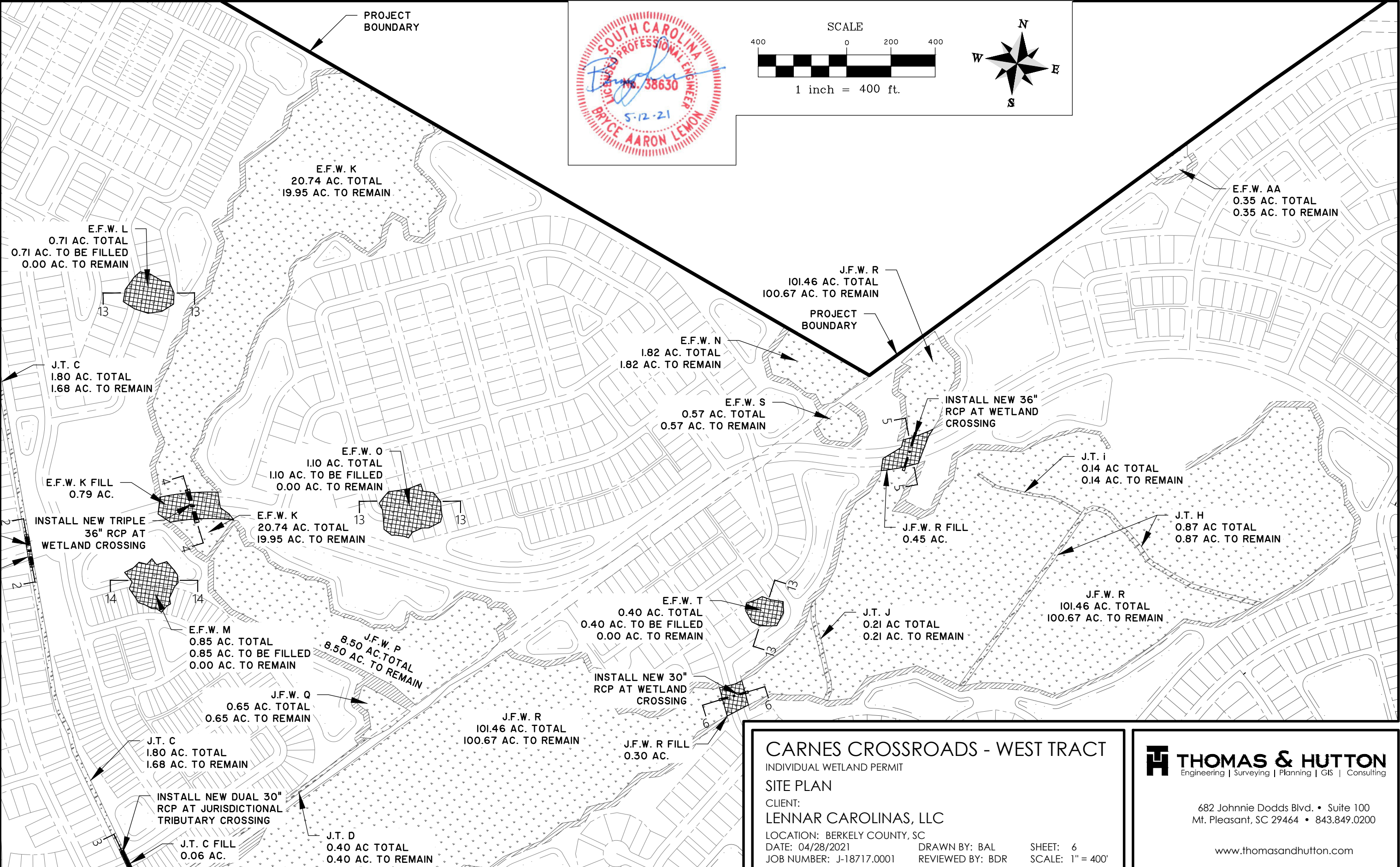
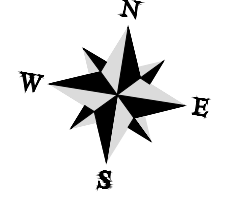
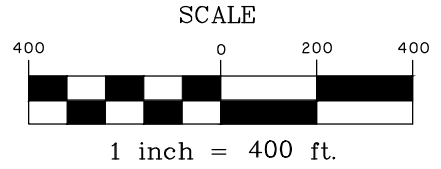

CARNES CROSSROADS - WEST TRACT
 INDIVIDUAL WETLAND PERMIT
SITE PLAN
 CLIENT:
LENNAR CAROLINAS, LLC
 LOCATION: BERKELY COUNTY, SC
 DATE: 04/28/2021 DRAWN BY: BAL SHEET: 6
 JOB NUMBER: J-18717.0001 REVIEWED BY: BDR SCALE: 1" = 400'



682 Johnnie Dodds Blvd. • Suite 100
Mt. Pleasant, SC 29464 • 843.849.0200

www.thomasandhutton.com

Z:\18717\18717.000\Engineering\Drawings\Wetland Permit Drawings\West Tract\18717.0001 - Site Plan.dwg - Jul 31, 2020 - 10:51:21 AM

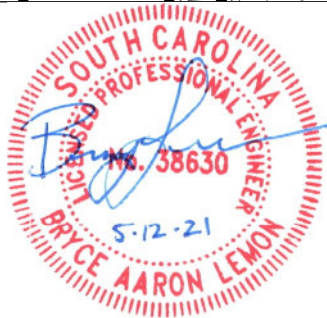
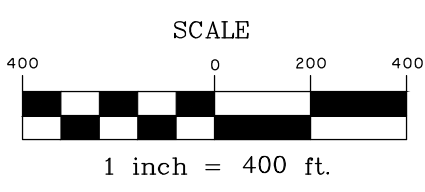
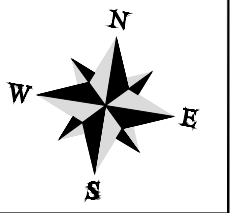
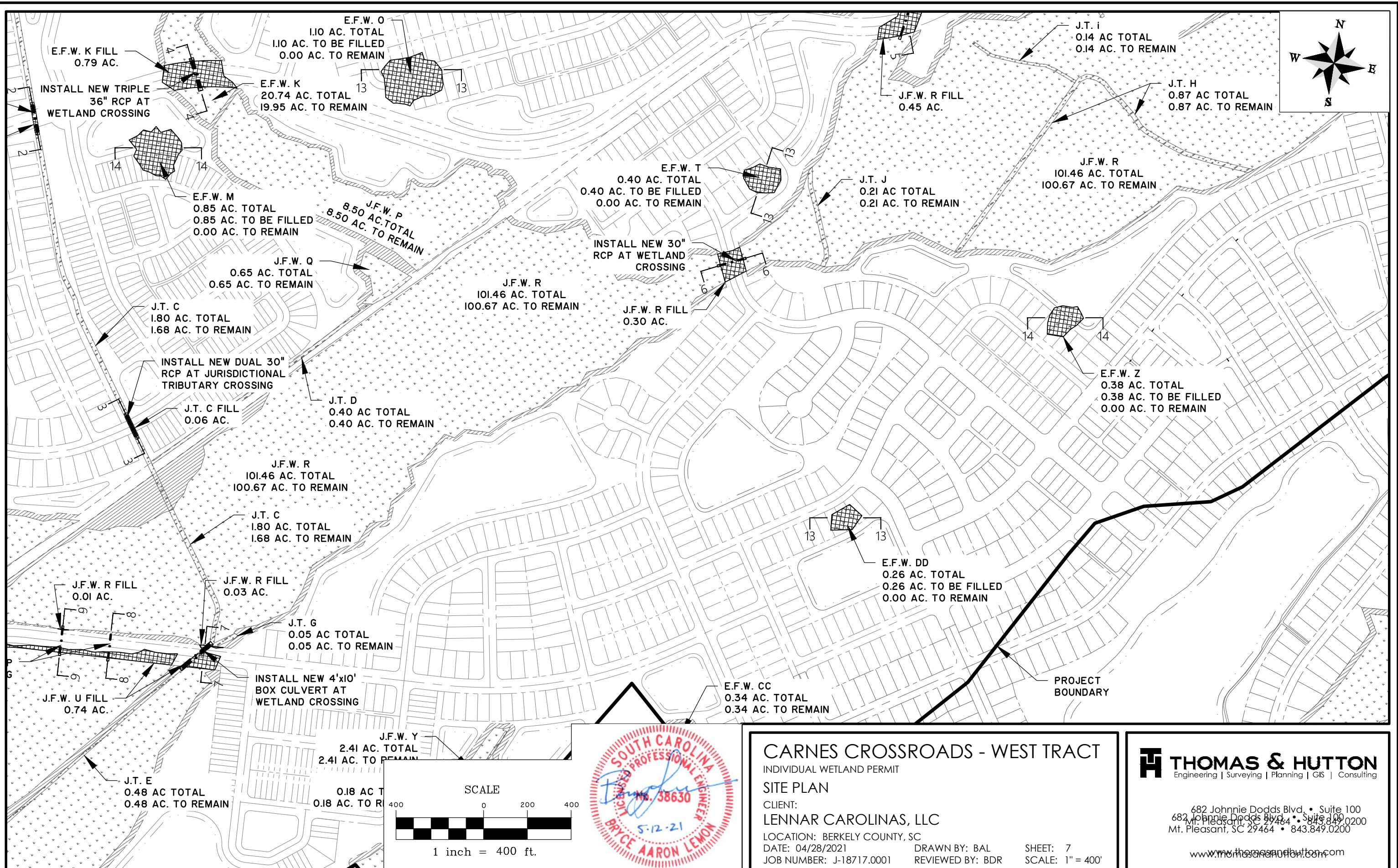

CARNES CROSSROADS - WEST TRACT
 INDIVIDUAL WETLAND PERMIT
SITE PLAN
 CLIENT:
LENNAR CAROLINAS, LLC
 LOCATION: BERKELY COUNTY, SC
 DATE: 04/28/2021 DRAWN BY: BAL SHEET: 7
 JOB NUMBER: J-18717.0001 REVIEWED BY: BDR SCALE: 1" = 400'

THOMAS & HUTTON
 Engineering | Surveying | Planning | GIS | Consulting
 682 Johnnie Dodds Blvd., Suite 100
 Mt. Pleasant, SC 29464 • 843.849.0200
 www.thomasandhutton.com

Z:\18717\18717.000\Engineering\Drawings\Wetland Permit Drawings\West Tract\WP\18717.000 - Site Plan.dwg - Jul 31, 2020 - 10:51:21 AM

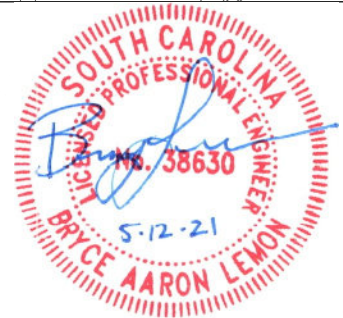
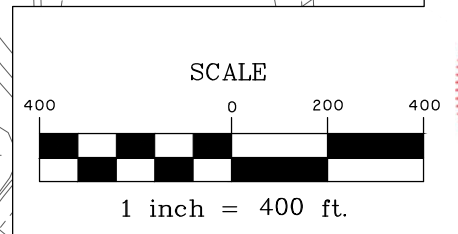
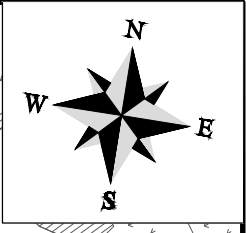
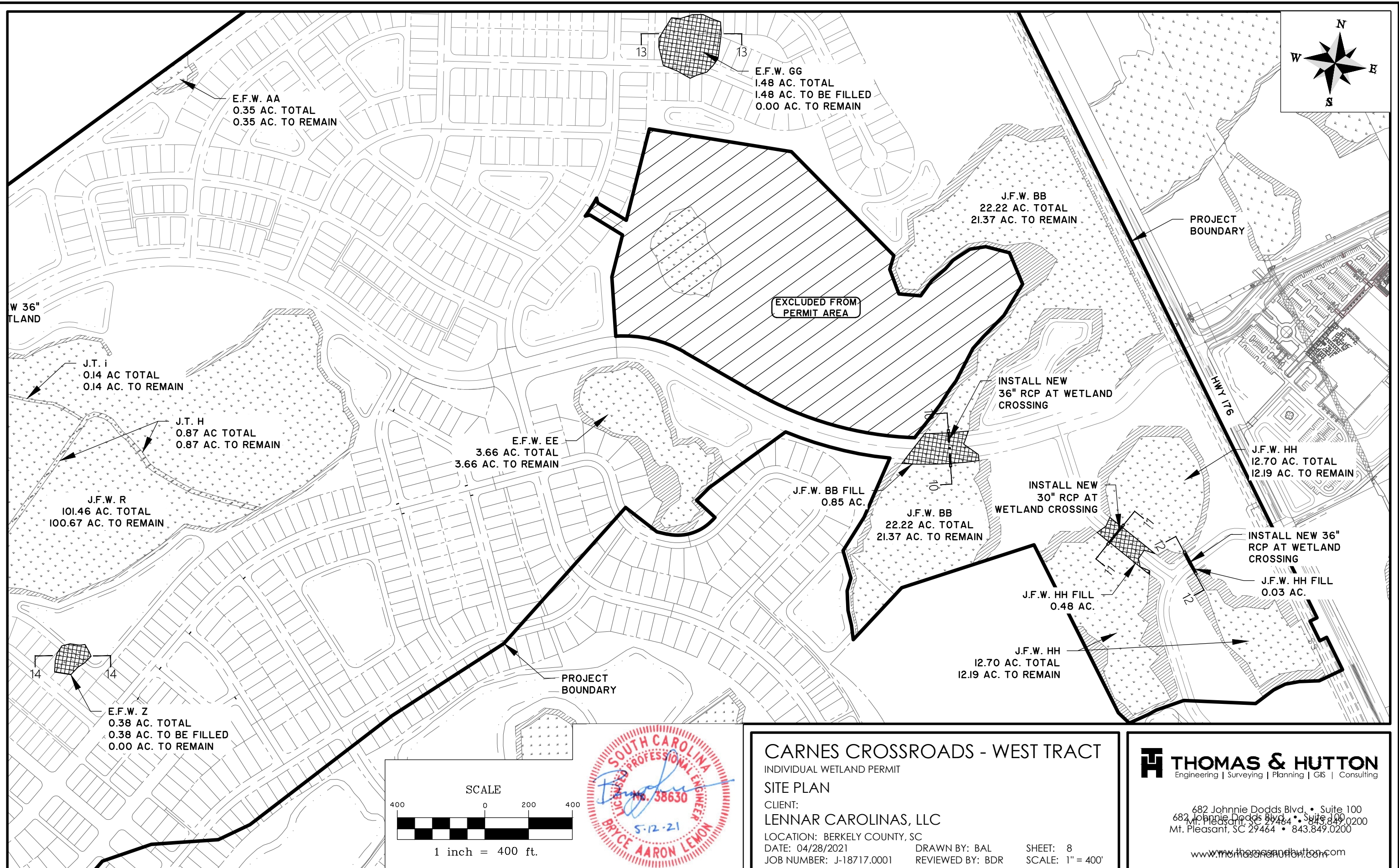

CARNES CROSSROADS - WEST TRACT
 INDIVIDUAL WETLAND PERMIT
SITE PLAN
 CLIENT:
LENNAR CAROLINAS, LLC
 LOCATION: BERKELY COUNTY, SC
 DATE: 04/28/2021 DRAWN BY: BAL SHEET: 8
 JOB NUMBER: J-18717.0001 REVIEWED BY: BDR SCALE: 1" = 400'

THOMAS & HUTTON
 Engineering | Surveying | Planning | GIS | Consulting
 682 Johnnie Dodds Blvd., Suite 100
 Mt. Pleasant, SC 29464 • 843.849.0200
 www.thomasandhutton.com

Z:\18717\18717.000\Engineering\Drawings\Wetland Permits\Drawings\West Tract\WP\18717.0001 - Cross Sections.dwg - Apr. 1, 2021 - 11:25:57 AM

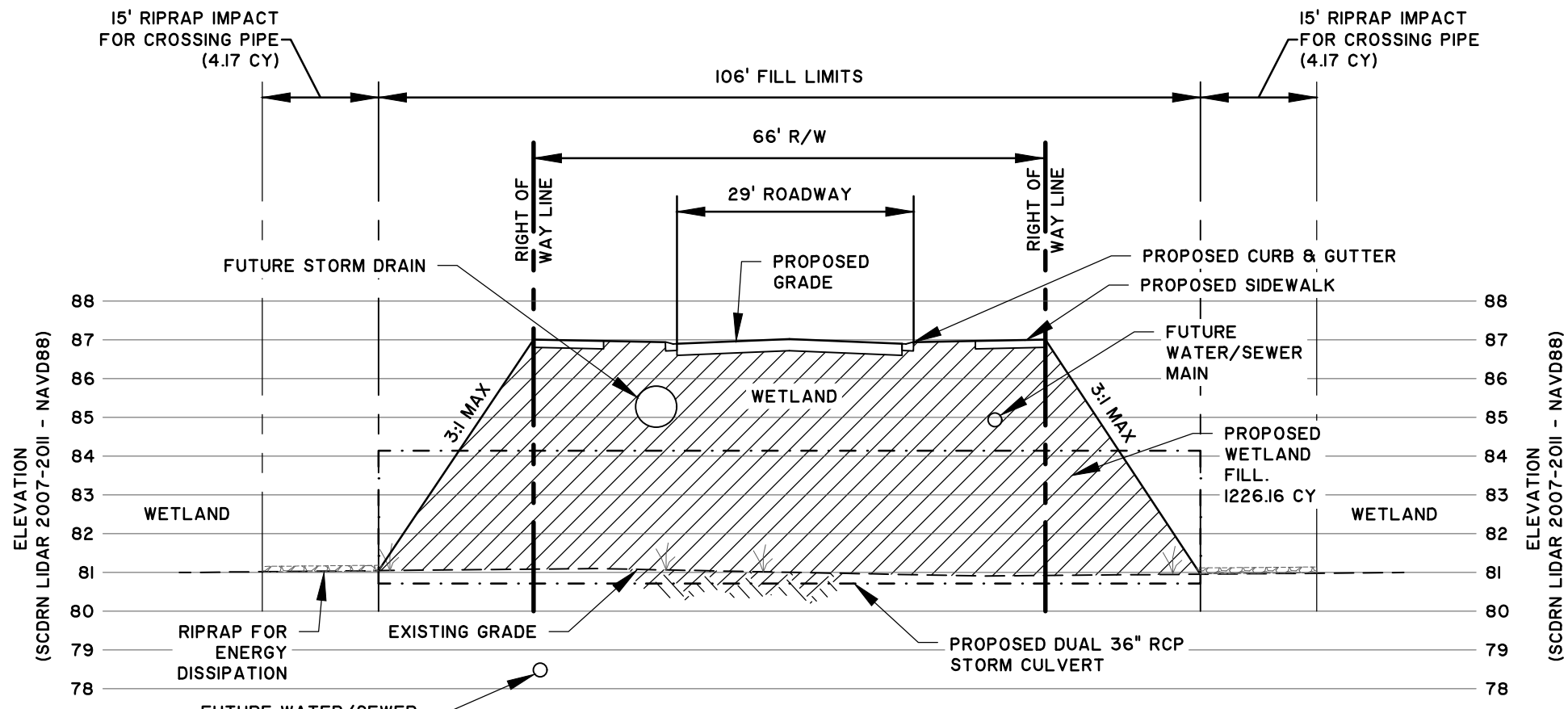

CROSS SECTION I

SCALE: N.T.S.



CARNES CROSSROADS - WEST TRACT
 INDIVIDUAL WETLAND PERMIT
CROSS SECTIONS
 CLIENT:
LENNAR CAROLINAS, LLC
 LOCATION: BERKELY COUNTY, SC
 DATE: 04/28/2021 DRAWN BY: BAL SHEET: 9
 JOB NUMBER: J-18717.0001 REVIEWED BY: BDR SCALE: N.T.S.

THOMAS & HUTTON
 Engineering | Surveying | Planning | GIS | Consulting

682 Johnnie Dodds Blvd. • Suite 100
 Mt. Pleasant, SC 29464 • 843.849.0200

www.thomasandhutton.com

Z:\18717\18717.000\Engineering\Drawings\Wetland Permits\Drawings\West Tract\18717.0001 - Cross Sections.dwg - May 18, 2021 - 9:48:57 AM

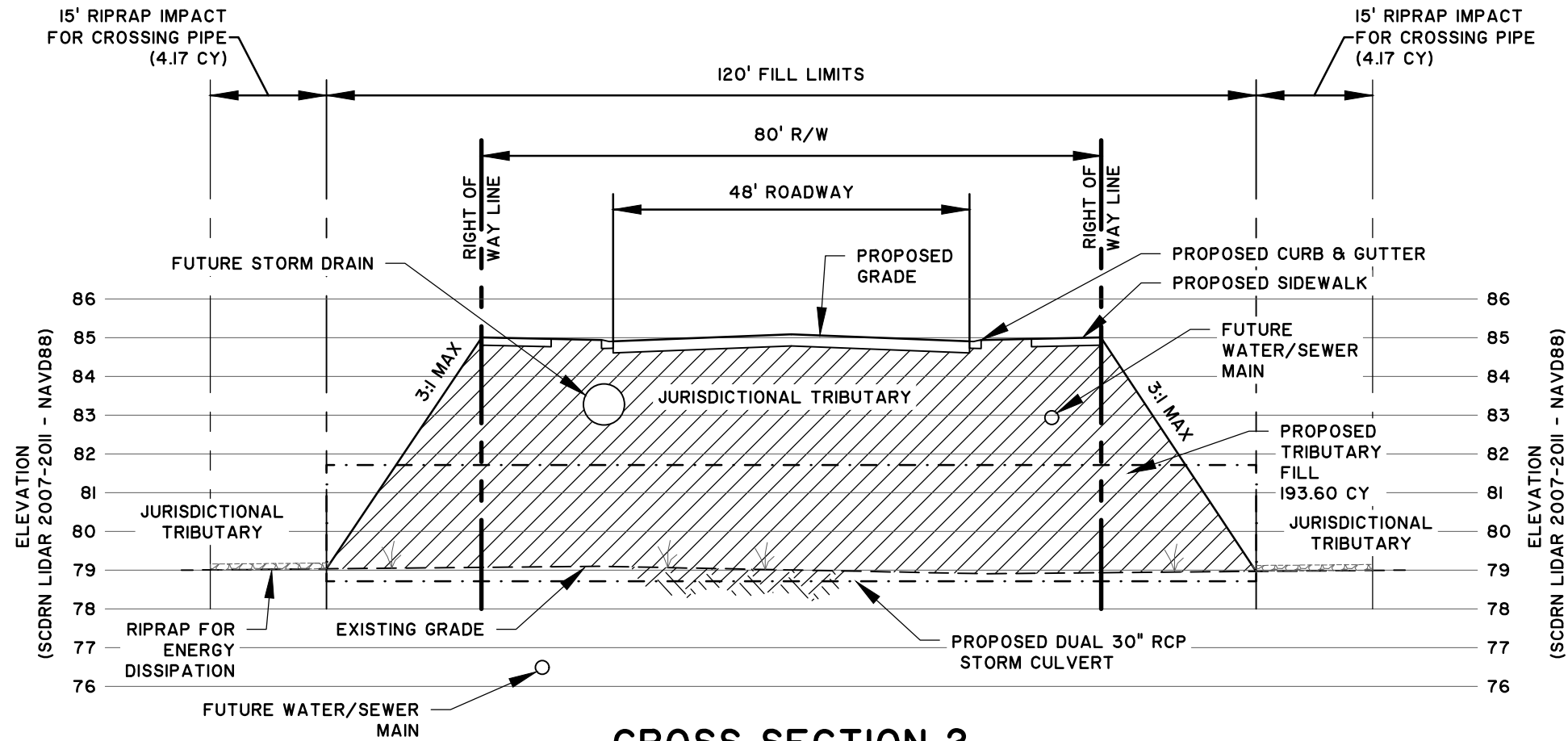

CROSS SECTION 2

SCALE: N.T.S.



CARNES CROSSROADS - WEST TRACT

INDIVIDUAL WETLAND PERMIT

CROSS SECTIONS

CLIENT:

LENNAR CAROLINAS, LLC

LOCATION: BERKELY COUNTY, SC

DATE: 04/28/2021

DRAWN BY: BAL

SHEET: 10

JOB NUMBER: J-18717.0001

REVIEWED BY: BDR

SCALE: N.T.S.



682 Johnnie Dodds Blvd. • Suite 100
Mt. Pleasant, SC 29464 • 843.849.0200

www.thomasandhutton.com

Z:\18717\18717.000\Engineering\Drawings\Wetland Permits\Drawings\West Tract\WP\18717.0001 - Cross Sections.dwg - May 18, 2021 - 9:49:33 AM

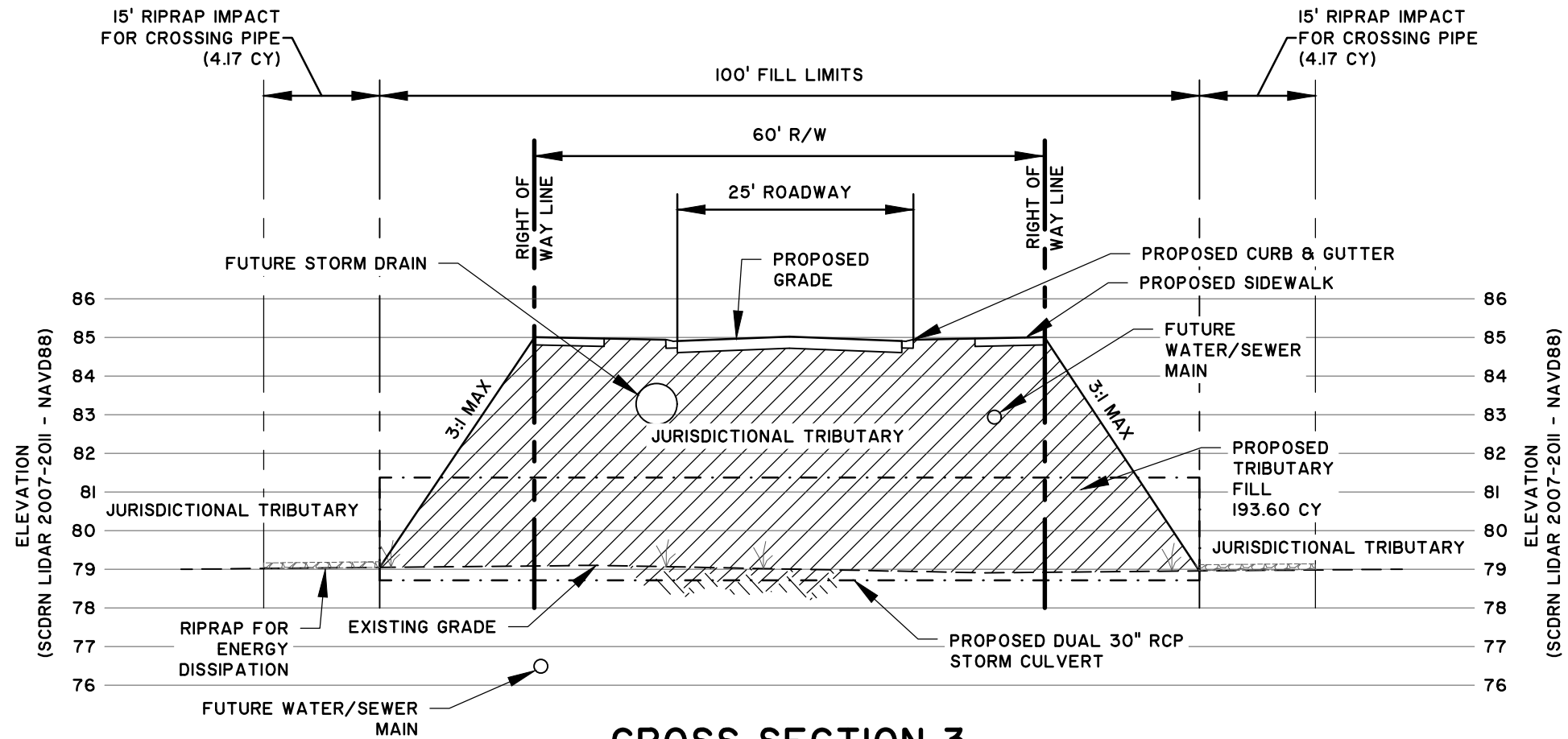

CROSS SECTION 3

SCALE: N.T.S.



CARNES CROSSROADS - WEST TRACT

INDIVIDUAL WETLAND PERMIT

CROSS SECTIONS

CLIENT:

LENNAR CAROLINAS, LLC

LOCATION: BERKELY COUNTY, SC

DATE: 04/28/2021

DRAWN BY: BAL

SHEET: 11

JOB NUMBER: J-18717.0001

REVIEWED BY: BDR

SCALE: N.T.S.



682 Johnnie Dodds Blvd. • Suite 100
Mt. Pleasant, SC 29464 • 843.849.0200

www.thomasandhutton.com

Z:\18717\18717.000\Engineering\Drawings\Wetland_Permit_Drawings\West Tract_IWP\18717.0001 - Cross Sections.dwg - Apr. 1, 2021 - 11:25:57 AM

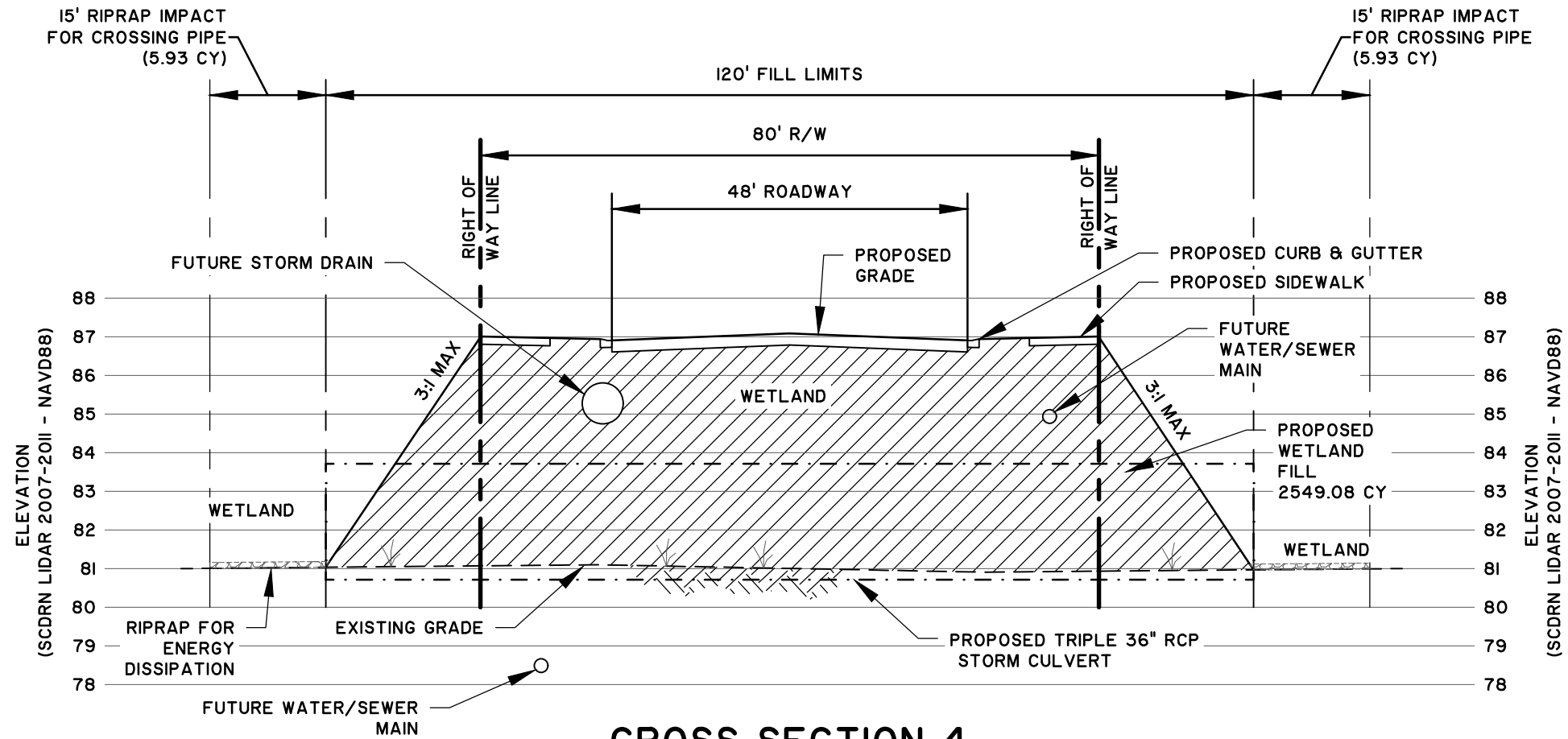

CROSS SECTION 4

SCALE: N.T.S.



CARNES CROSSROADS - WEST TRACT

INDIVIDUAL WETLAND PERMIT

CROSS SECTIONS

CLIENT:
LENNAR CAROLINAS, LLC

LOCATION: BERKELY COUNTY, SC
 DATE: 04/28/2021 DRAWN BY: BAL SHEET: 12
 JOB NUMBER: J-18717.0001 REVIEWED BY: BDR SCALE: N.T.S.



682 Johnnie Dodds Blvd. • Suite 100
 Mt. Pleasant, SC 29464 • 843.849.0200

www.thomasandhutton.com

Z:\18717\18717.000\Engineering\Drawings\Wetland Permits\Drawings\West Tract\WP\18717.0001 - Cross Sections.dwg - Apr. 1, 2021 - 11:25:57 AM

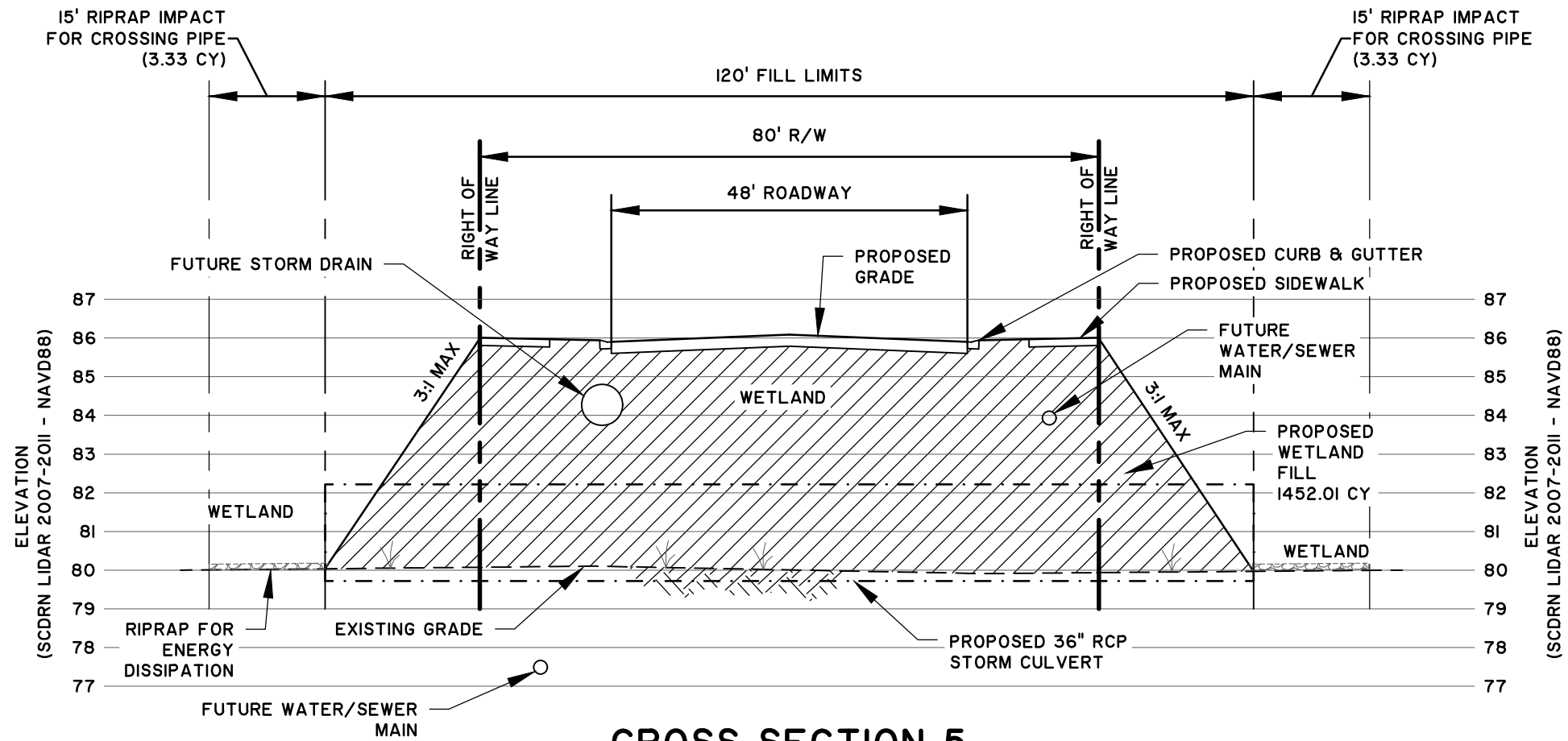

CROSS SECTION 5

SCALE: N.T.S.



CARNES CROSSROADS - WEST TRACT

INDIVIDUAL WETLAND PERMIT

CROSS SECTIONS

CLIENT:

LENNAR CAROLINAS, LLC

LOCATION: BERKELY COUNTY, SC

DATE: 04/28/2021

DRAWN BY: BAL

SHEET: 13

JOB NUMBER: J-18717.0001

REVIEWED BY: BDR

SCALE: N.T.S.



682 Johnnie Dodds Blvd. • Suite 100
Mt. Pleasant, SC 29464 • 843.849.0200

www.thomasandhutton.com

Z:\18717\18717.000\Engineering\Drawings\Wetland Permits\Drawings\West Tract\WP\18717.0001 - Cross Sections.dwg - Apr. 1, 2021 - 11:25:57 AM

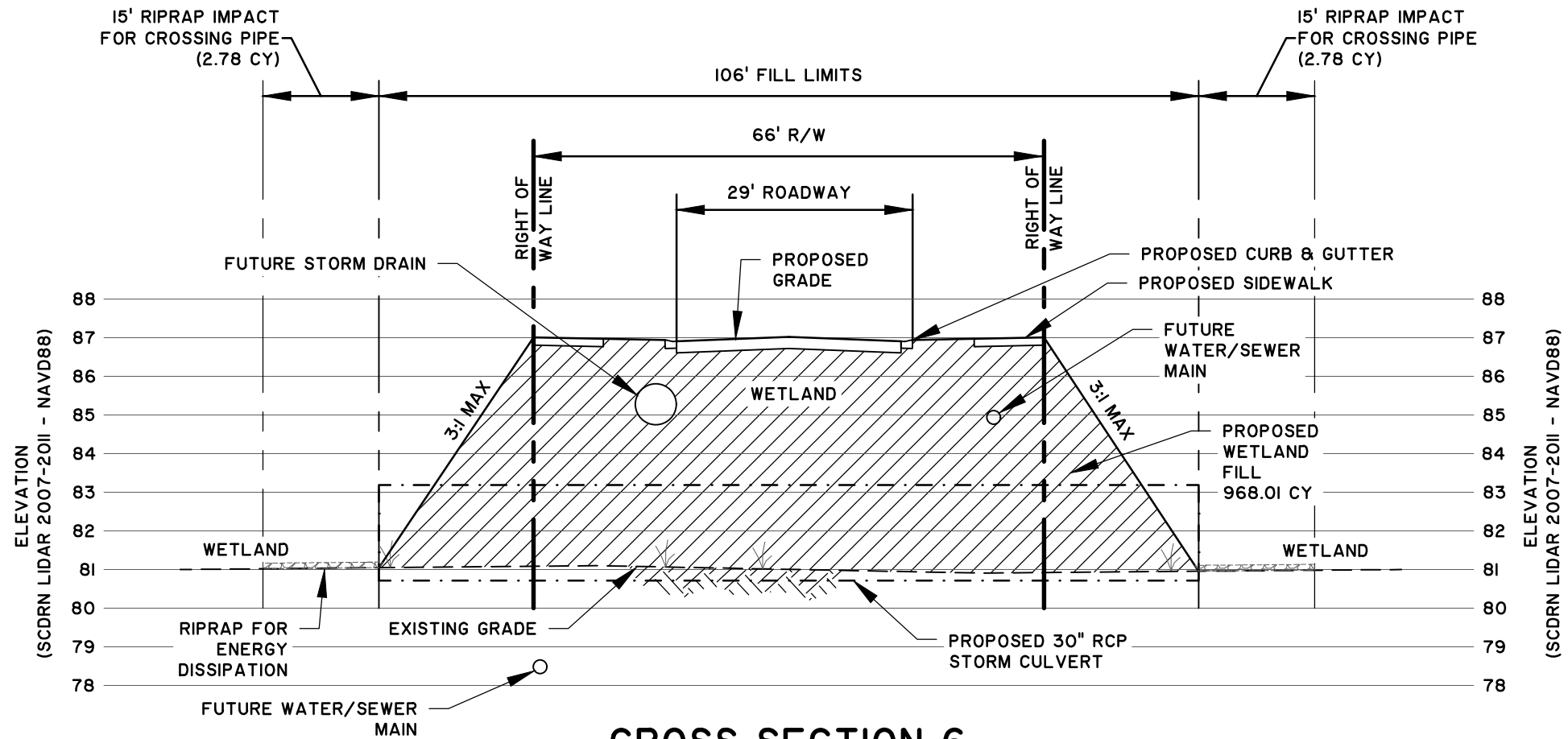

CROSS SECTION 6

SCALE: N.T.S.



CARNES CROSSROADS - WEST TRACT

INDIVIDUAL WETLAND PERMIT

CROSS SECTIONS

CLIENT:

LENNAR CAROLINAS, LLC

LOCATION: BERKELY COUNTY, SC

DATE: 04/28/2021

DRAWN BY: BAL

SHEET: 14

JOB NUMBER: J-18717.0001

REVIEWED BY: BDR

SCALE: N.T.S.



682 Johnnie Dodds Blvd. • Suite 100
Mt. Pleasant, SC 29464 • 843.849.0200

www.thomasandhutton.com

Z:\18717\18717.000\Engineering\Drawings\Wetland Permits\Drawings\West Tract\WP\18717.0001 - Cross Sections.dwg - Apr. 1, 2021 - 11:25:57 AM

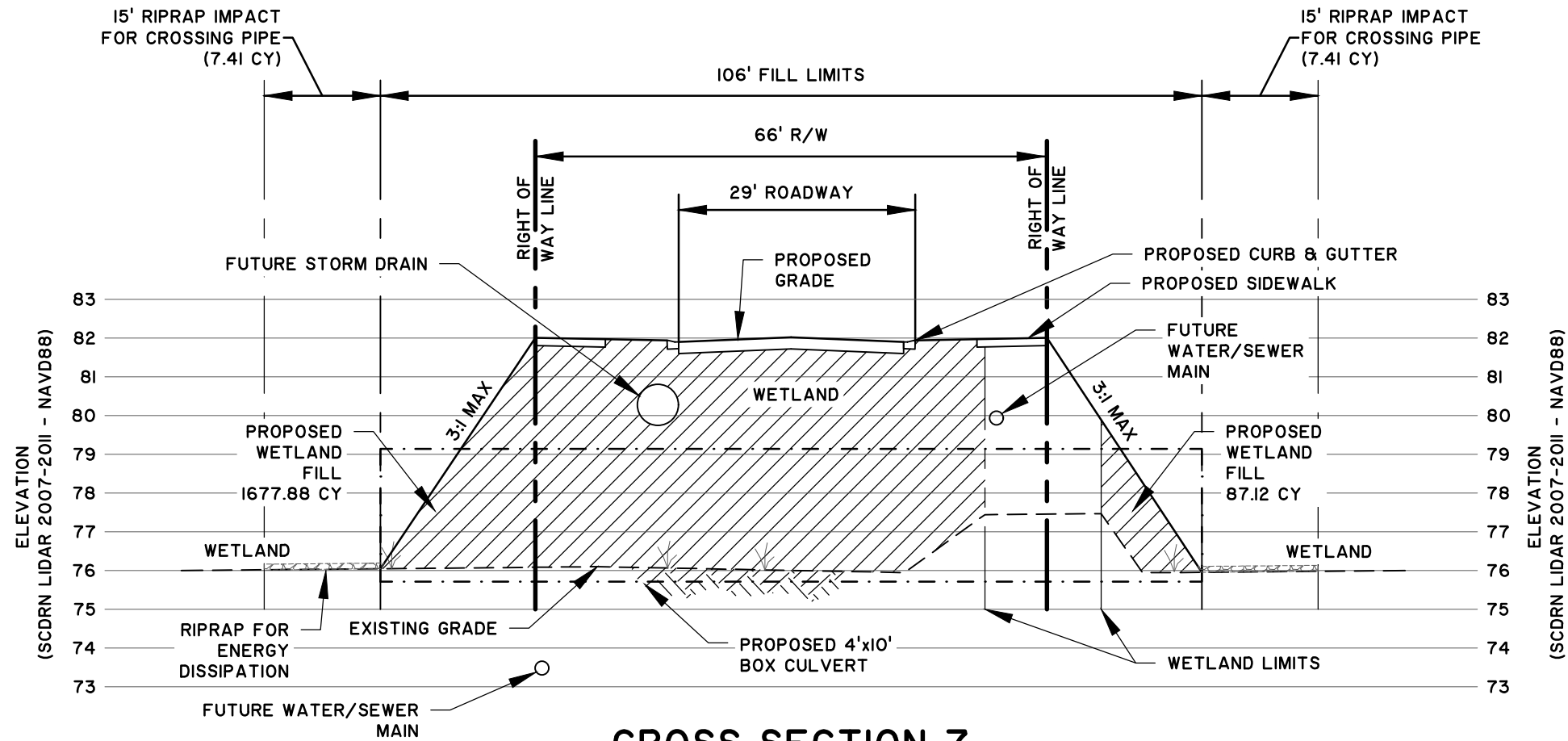

CROSS SECTION 7

SCALE: N.T.S.



CARNES CROSSROADS - WEST TRACT

INDIVIDUAL WETLAND PERMIT

CROSS SECTIONS

CLIENT:

LENNAR CAROLINAS, LLC

LOCATION: BERKELY COUNTY, SC

DATE: 04/28/2021

DRAWN BY: BAL

SHEET: 15

JOB NUMBER: J-18717.0001

REVIEWED BY: BDR

SCALE: N.T.S.



682 Johnnie Dodds Blvd. • Suite 100
Mt. Pleasant, SC 29464 • 843.849.0200

www.thomasandhutton.com

Z:\18717\18717.000\Engineering\Drawings\Wetland Permits\Drawings\West Tract\WP\18717.0001 - Cross Sections.dwg - Apr. 1, 2021 - 11:25:57 AM

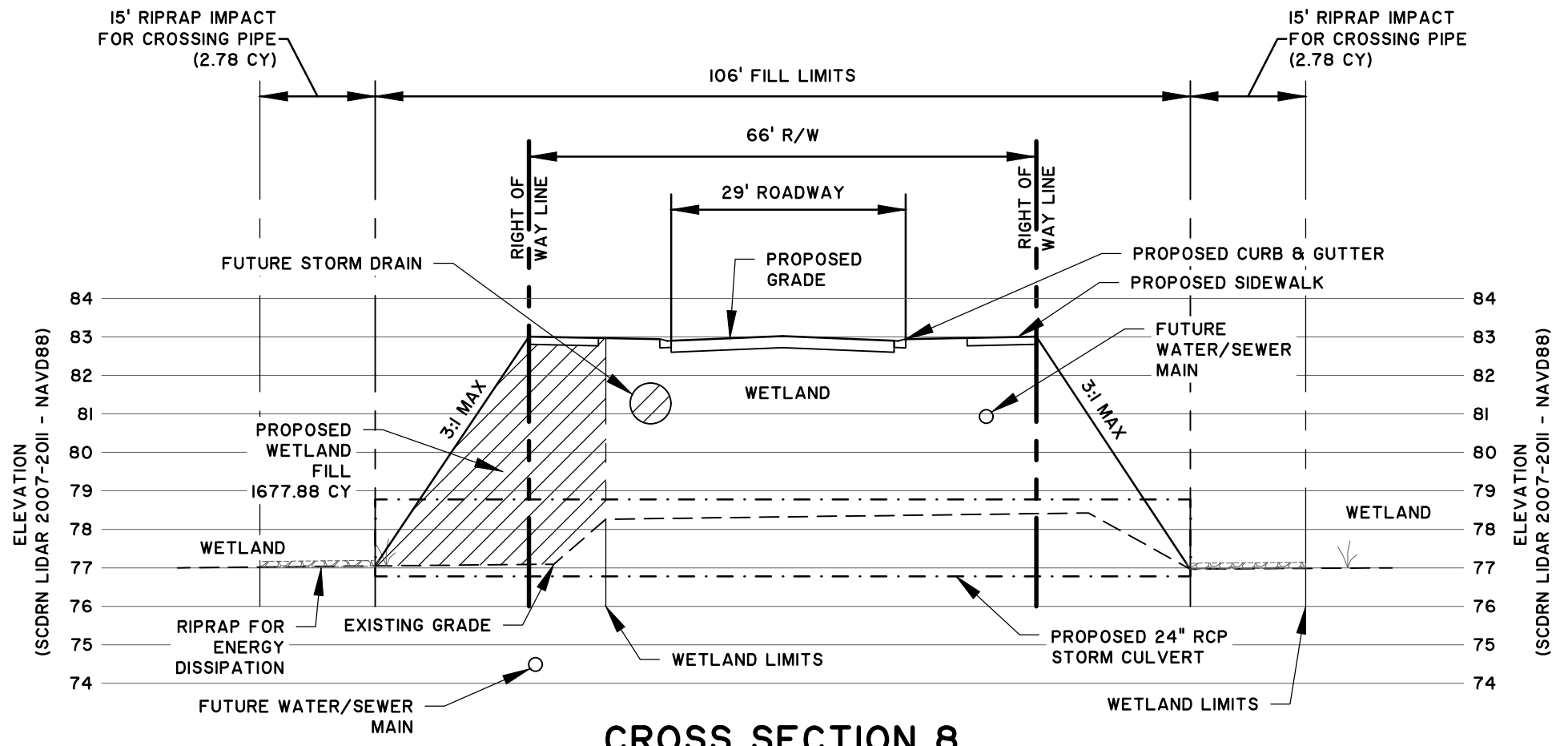

CROSS SECTION 8

SCALE: N.T.S.



CARNES CROSSROADS - WEST TRACT
 INDIVIDUAL WETLAND PERMIT
CROSS SECTIONS
 CLIENT:
LENNAR CAROLINAS, LLC
 LOCATION: BERKELY COUNTY, SC
 DATE: 04/28/2021 DRAWN BY: BAL SHEET: 16
 JOB NUMBER: J-18717.0001 REVIEWED BY: BDR SCALE: N.T.S.

THOMAS & HUTTON
 Engineering | Surveying | Planning | GIS | Consulting

682 Johnnie Dodds Blvd. • Suite 100
 Mt. Pleasant, SC 29464 • 843.849.0200

www.thomasandhutton.com

Z:\18717\18717.000\Engineering\Drawings\Wetland Permits\Drawings\West Tract\WP\18717.0001 - Cross Sections.dwg - Apr. 1, 2021 - 11:25:57 AM

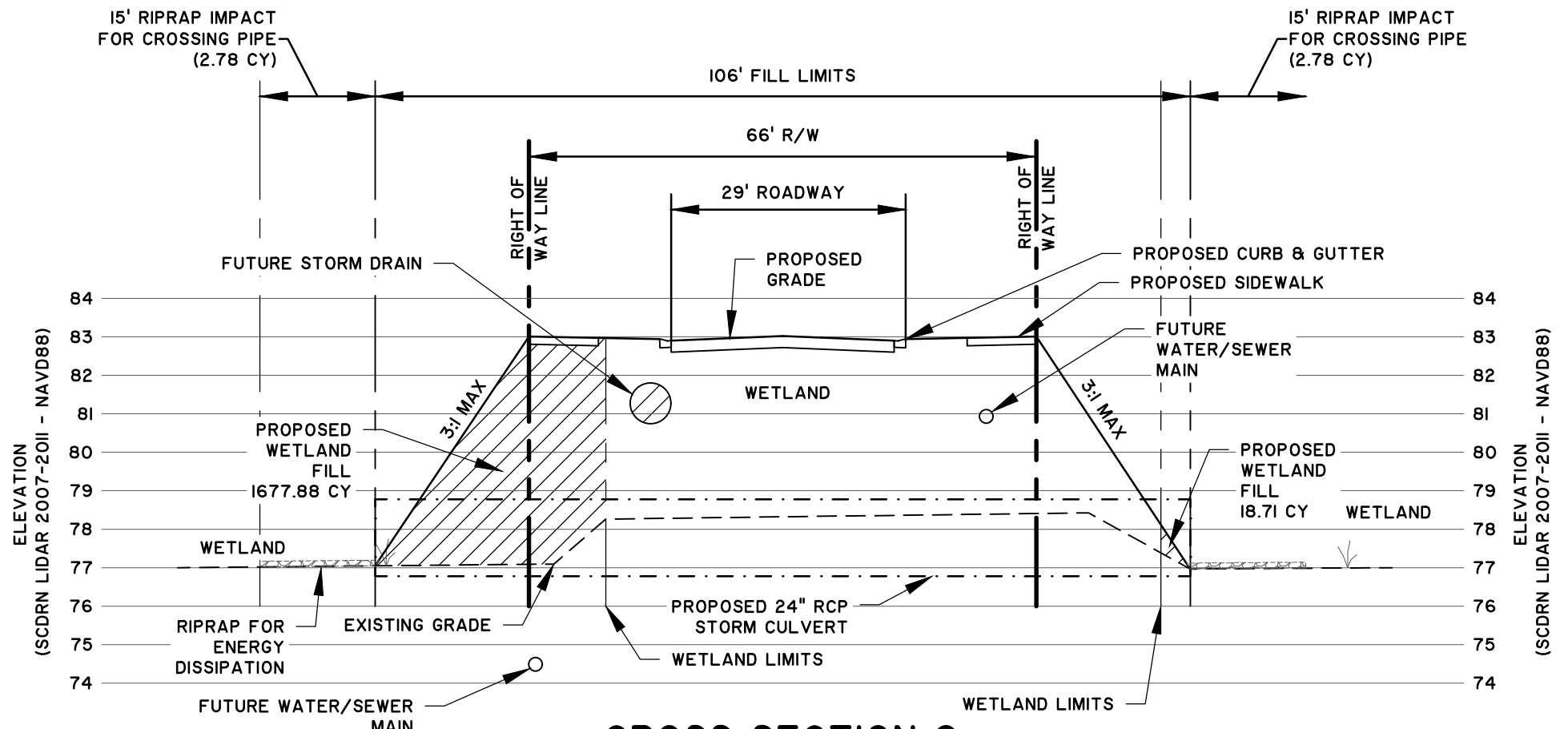

CROSS SECTION 9

SCALE: N.T.S.



CARNES CROSSROADS - WEST TRACT

INDIVIDUAL WETLAND PERMIT

CROSS SECTIONS

CLIENT:
LENNAR CAROLINAS, LLC

LOCATION: BERKELY COUNTY, SC
 DATE: 04/28/2021 DRAWN BY: BAL SHEET: 17
 JOB NUMBER: J-18717.0001 REVIEWED BY: BDR SCALE: N.T.S.



682 Johnnie Dodds Blvd. • Suite 100
 Mt. Pleasant, SC 29464 • 843.849.0200

www.thomasandhutton.com

Z:\18717\18717.000\Engineering\Drawings\Wetland_Permit_Drawings\West Tract\WP\18717.0001 - Cross Sections.dwg - Apr. 1, 2021 - 10:57 AM

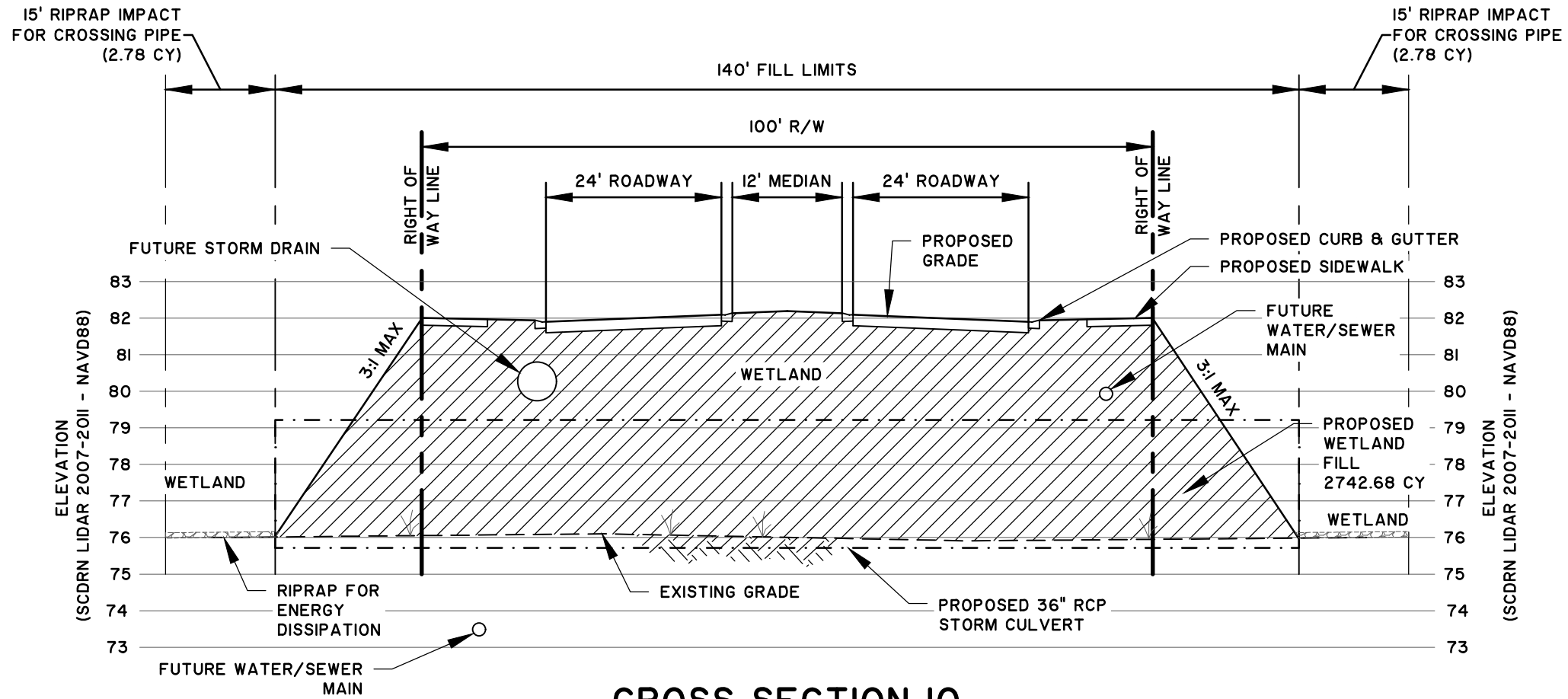

CROSS SECTION 10

SCALE: N.T.S.



CARNES CROSSROADS - WEST TRACT
 INDIVIDUAL WETLAND PERMIT
CROSS SECTIONS
 CLIENT:
LENNAR CAROLINAS, LLC
 LOCATION: BERKELY COUNTY, SC
 DATE: 04/28/2021 DRAWN BY: BAL SHEET: 18
 JOB NUMBER: J-18717.0001 REVIEWED BY: BDR SCALE: N.T.S.

THOMAS & HUTTON
 Engineering | Surveying | Planning | GIS | Consulting

682 Johnnie Dodds Blvd. • Suite 100
 Mt. Pleasant, SC 29464 • 843.849.0200

www.thomasandhutton.com

Z:\18717\18717.000\Engineering\Drawings\Wetland Permits\Drawings\West Tract\WP\18717.0001 - Cross Sections.dwg - Apr. 1, 2021 - 11:25:57 AM

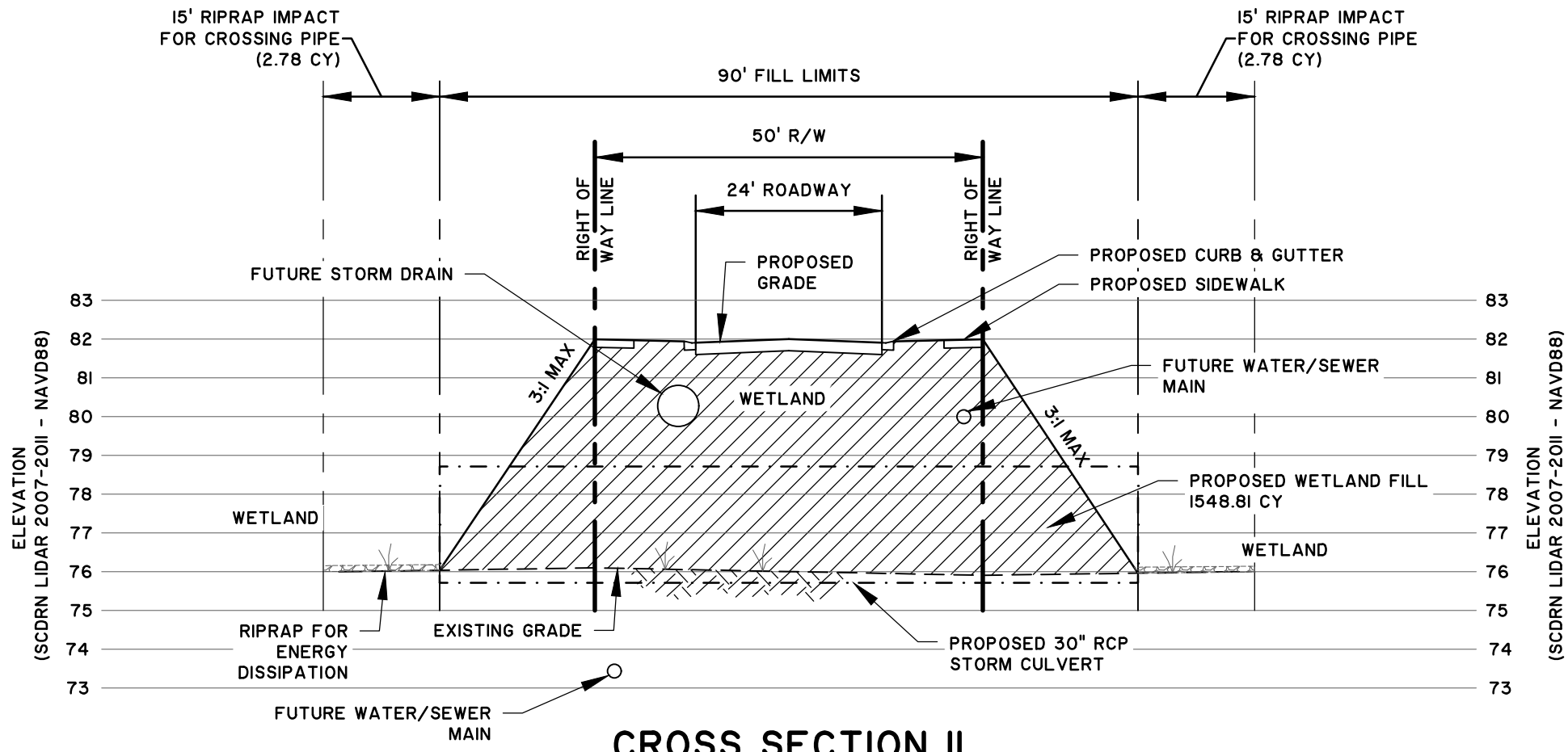

CROSS SECTION II

SCALE: N.T.S.



CARNES CROSSROADS - WEST TRACT

INDIVIDUAL WETLAND PERMIT

CROSS SECTIONS

CLIENT:
LENNAR CAROLINAS, LLC

LOCATION: BERKELY COUNTY, SC
 DATE: 04/28/2021 DRAWN BY: BAL SHEET: 19
 JOB NUMBER: J-18717.0001 REVIEWED BY: BDR SCALE: N.T.S.



682 Johnnie Dodds Blvd. • Suite 100
 Mt. Pleasant, SC 29464 • 843.849.0200

www.thomasandhutton.com

Z:\18717\18717.000\Engineering\Drawings\Wetland_Permit_Drawings\West Tract\WP\18717.0001 - Cross Sections.dwg - Apr. 1, 2021 - 11:25:57 AM

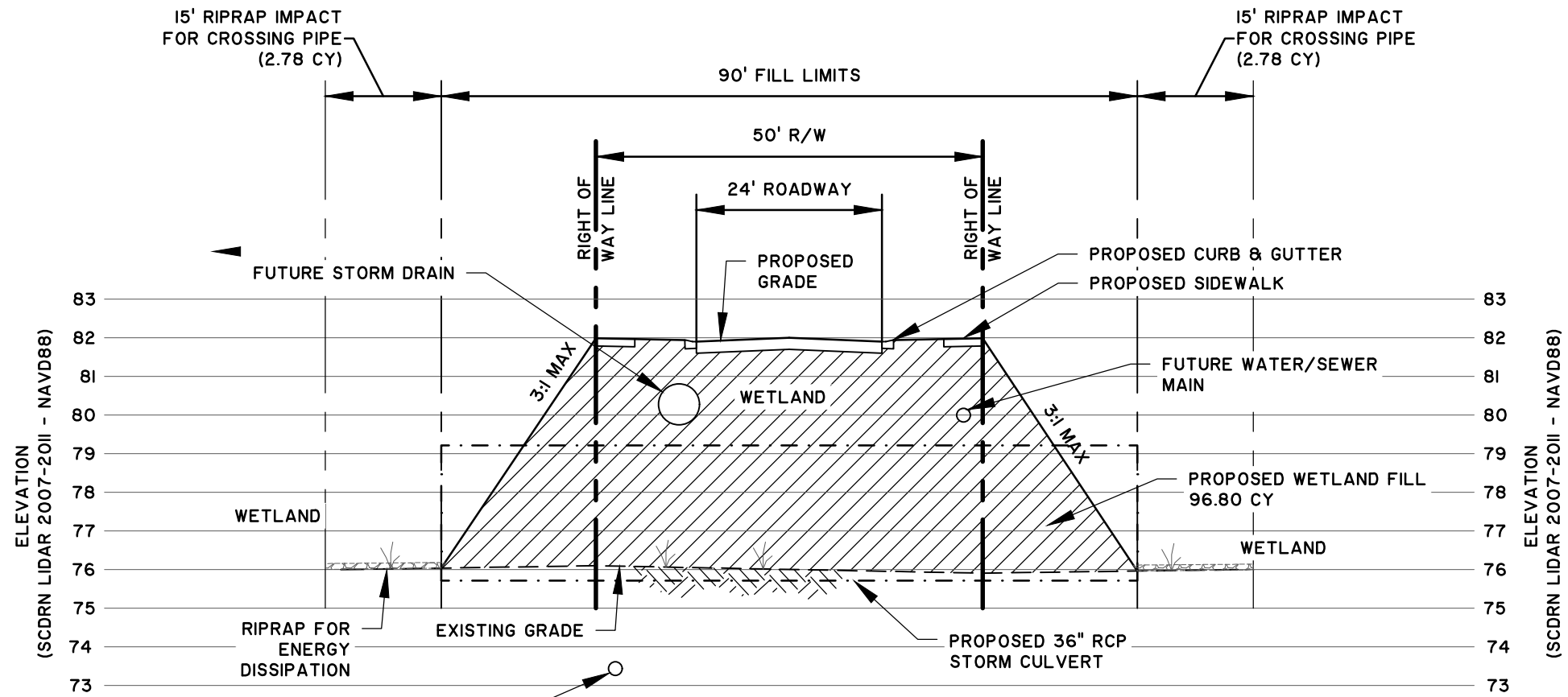

CROSS SECTION 12

SCALE: N.T.S.



CARNES CROSSROADS - WEST TRACT

INDIVIDUAL WETLAND PERMIT

CROSS SECTIONS

CLIENT:
LENNAR CAROLINAS, LLC

LOCATION: BERKELY COUNTY, SC
 DATE: 04/28/2021 DRAWN BY: BAL SHEET: 20
 JOB NUMBER: J-18717.0001 REVIEWED BY: BDR SCALE: N.T.S.



682 Johnnie Dodds Blvd. • Suite 100
 Mt. Pleasant, SC 29464 • 843.849.0200

www.thomasandhutton.com

Z:\18717\18717.000\Engineering\Drawings\Wetland Permits\Drawings\West Tract\WP\18717.0001 - Cross Sections.dwg - Apr. 1, 2021 - 11:25:57 AM

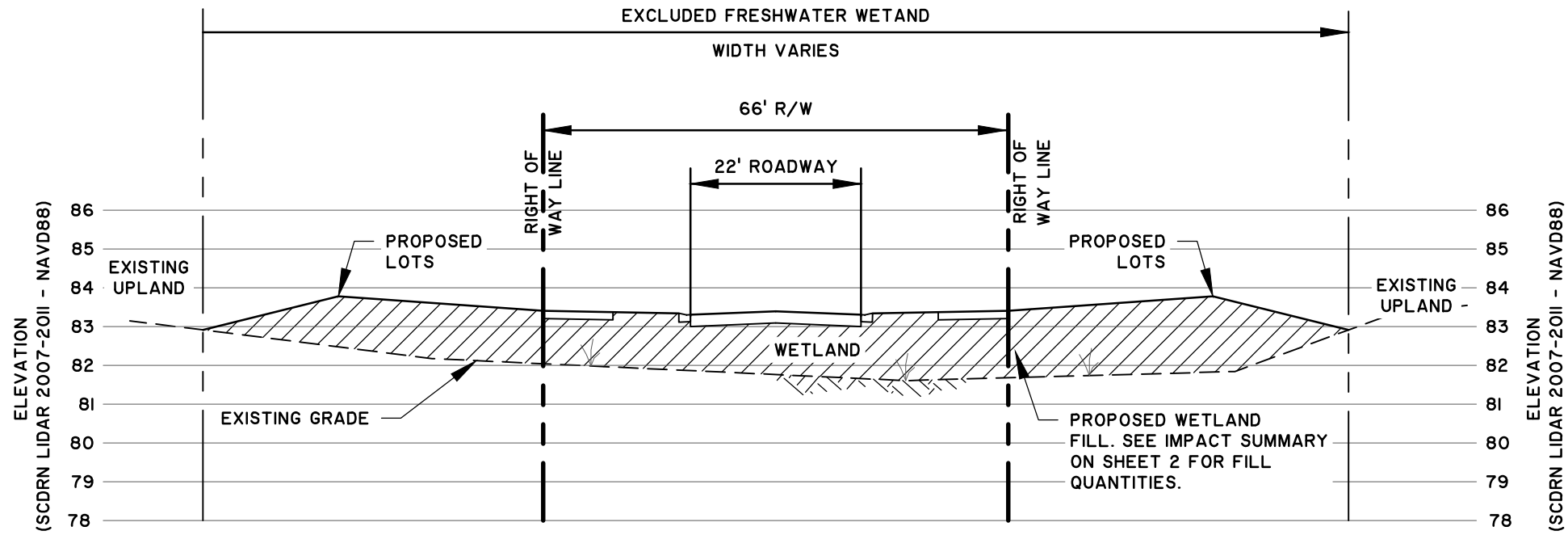

**CROSS SECTION 13
(TYPICAL EXCLUDED WETLAND FILL)**

SCALE: N.T.S.



CARNES CROSSROADS - WEST TRACT

INDIVIDUAL WETLAND PERMIT

CROSS SECTIONS

CLIENT:

LENNAR CAROLINAS, LLC

LOCATION: BERKELY COUNTY, SC

DATE: 04/28/2021

JOB NUMBER: J-18717.0001

DRAWN BY: BAL

REVIEWED BY: BDR

SHEET: 21

SCALE: N.T.S.



682 Johnnie Dodds Blvd. • Suite 100
Mt. Pleasant, SC 29464 • 843.849.0200

www.thomasandhutton.com

Z:\18717\18717.000\Engineering\Drawings\Wetland Permits\Drawings\West Tract\WP\18717.0001 - Cross Sections.dwg - Apr. 1, 2021 - 11:25:57 AM

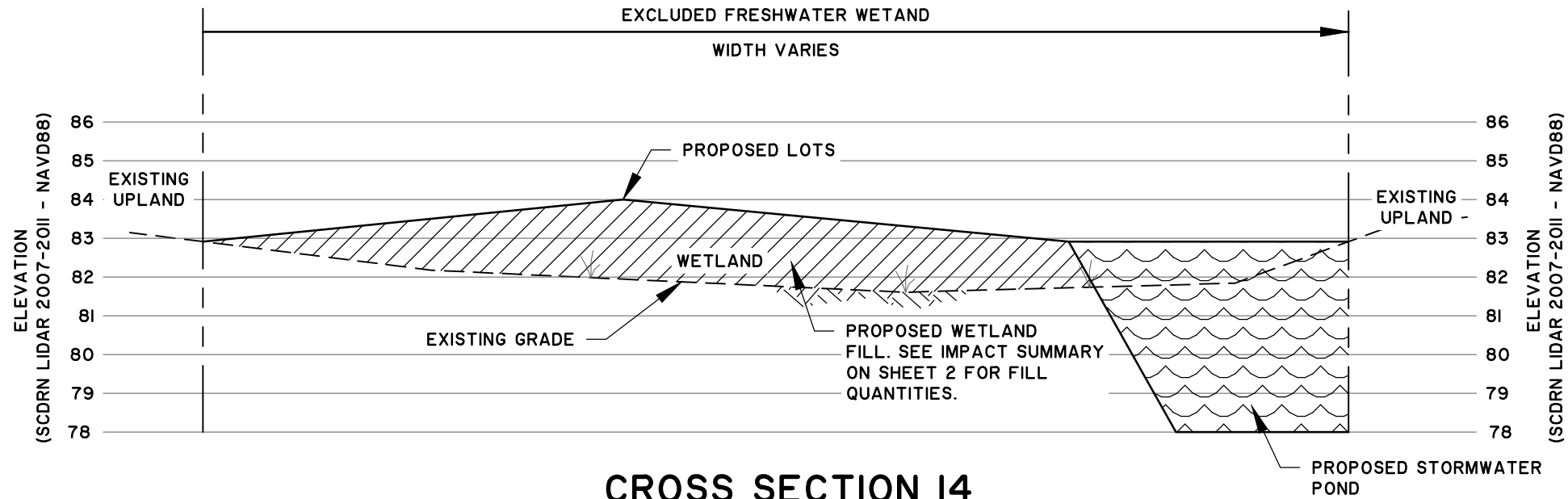

**CROSS SECTION 14
(TYPICAL EXCLUDED WETLAND FILL)**

SCALE: N.T.S.



CARNES CROSSROADS - WEST TRACT

INDIVIDUAL WETLAND PERMIT

CROSS SECTIONS

CLIENT:

LENNAR CAROLINAS, LLC

LOCATION: BERKELY COUNTY, SC

DATE: 04/28/2021

JOB NUMBER: J-18717.0001

DRAWN BY: BAL

REVIEWED BY: BDR

SHEET: 22

SCALE: N.T.S.



682 Johnnie Dodds Blvd. • Suite 100
Mt. Pleasant, SC 29464 • 843.849.0200

www.thomasandhutton.com