

JOINT
PUBLIC NOTICE

CHARLESTON DISTRICT, CORPS OF ENGINEERS
69A Hagood Avenue
Charleston, South Carolina 29403-5107
and
THE S.C. DEPARTMENT OF HEALTH AND ENVIRONMENTAL CONTROL
Office of Ocean and Coastal Resource Management
1362 McMillan Avenue, Suite 400
North Charleston, South Carolina 29405

REGULATORY DIVISION
Refer to: P/N SAC-2021-00598

May 28, 2021

Pursuant to Sections 401 and 404 of the Clean Water Act (33 U.S.C. 1344) and the South Carolina Coastal Zone Management Act (48-39-10 et.seq.), an application has been submitted to the Department of the Army and the S.C. Department of Health and Environmental Control by

Mr. Scott Utsey
True Homes
2649 Brekonridge Centre Drive
Monroe, North Carolina 28110

for a permit to fill 0.99 acre of jurisdictional freshwater wetlands to construct a residential development in

wetlands adjacent to Fishburne Creek

at a location off Delmar Highway in Dorchester County, South Carolina (Latitude: 32.8938°, Longitude: -80.2663°), Clubhouse Crossroads, SC quad.

In order to give all interested parties an opportunity to express their views

NOTICE

is hereby given that written statements regarding the proposed work will be received by the **Corps** until

15 Days from the Date of this Notice,

and **SCDHEC** will receive written statements regarding the proposed work until

30 Days from the Date of this Notice

from those interested in the activity and whose interests may be affected by the proposed work.

The proposed work consists of constructing a master-planned residential community. In detail, 0.81 acre of jurisdictional freshwater wetlands will be filled to construct access roads and 0.18 acre of jurisdictional freshwater wetland will be temporarily impacted to trench utility lines in place. The 0.18 acre of jurisdictional wetland within the utility easement will be converted and maintained from a forested vegetative community to an emergent vegetative community. 2.33

acres of non-jurisdictional freshwater wetlands will be filled to construct access roads and for residential lots. The applicant has proposed to mitigate for impacts to the jurisdictional wetlands by purchasing 8.2 in-kind credits from a Corps approved mitigation bank. The project purpose is to construct a residential development that will meet the rising housing needs in the Charleston Tri-County Area (Berkeley, Charleston, and Dorchester Counties).

NOTE: This public notice and associated plans are available on the Corps' website at: <http://www.sac.usace.army.mil/Missions/Regulatory/PublicNotices> .

The District Engineer has concluded that the discharges associated with this project, both direct and indirect, should be reviewed by the South Carolina Department of Health and Environmental Control in accordance with provisions of Section 401 of the Clean Water Act. As such, this notice constitutes a request, on behalf of the applicant, for certification that this project will comply with applicable effluent limitations and water quality standards. The work shown on this application must also be certified as consistent with applicable provisions of the Coastal Zone Management Program (15 CFR 930). This activity may also require evaluation for compliance with the S. C. Construction in Navigable Waters Permit Program. State review, permitting and certification is conducted by the S. C. Department of Health and Environmental Control. The District Engineer will not process this application to a conclusion until such certifications are received. The applicant is hereby advised that supplemental information may be required by the State to facilitate the review.

This notice initiates the Essential Fish Habitat (EFH) consultation requirements of the Magnuson-Stevens Fishery Conservation and Management Act. Implementation of the proposed project would impact 0.99 acre of jurisdictional freshwater wetlands located upstream of estuarine substrates and emergent wetlands utilized by various life stages of species comprising the shrimp, and snapper-grouper management complexes. The District Engineer's initial determination is that the proposed action would not have a substantial individual or cumulative adverse impact on EFH or fisheries managed by the South Atlantic Fishery Management Council and the National Marine Fisheries Service (NMFS). The District Engineer's final determination relative to project impacts and the need for mitigation measures is subject to review by and coordination with the NMFS.

Pursuant to the Section 7 of the Endangered Species Act of 1973 (as amended), the Corps has reviewed the project area, examined all information provided by the applicant, and the District Engineer has determined, based on the most recently available information that the project will have no effect on the American wood stork (*Mycteria americana*), red-cockaded woodpecker (*Picoides borealis*), Atlantic sturgeon (*Acipenser oxyrinchus*), shortnose sturgeon (*Acipenser brevirostrum*), American chaffseed (*Schwalbea americana*), Canby's dropwort (*Oxypolis canbyi*), and pondberry (*Lindera melissifolia*); and will not result in the destruction or adverse modification of designated or proposed critical habitat. Furthermore, the District Engineer has determined that the project is not likely to adversely affect the Northern long-eared bat (*Myotis septentrionalis*).

Pursuant to Section 106 of the National Historic Preservation Act (NHPA), this public notice also constitutes a request to Indian Tribes to notify the District Engineer of any historic properties of religious and cultural significance to them that may be affected by the proposed undertaking.

In accordance with Section 106 of the NHPA, the District Engineer has consulted South Carolina ArchSite (GIS), for the presence or absence of historic properties (as defined in 36 C.F.R. 800.16)(l)(1)), and has initially determined that there are historic properties present, but they will not be affected; therefore, there will be no effect on historic properties. This public notice serves to notify the State Historic Preservation Office that the Corps plans to initiate Section 106 consultation on these historic properties. To ensure that other historic properties that the District Engineer is not aware of are not overlooked, this public notice also serves as a request to the State Historic Preservation Office and other interested parties to provide any information they may have with regard to historic properties.

The District Engineer's final eligibility and effect determination will be based upon coordination with the SHPO and/or THPO, as appropriate and required and with full consideration given to the proposed undertaking's potential direct and indirect effects on historic properties within the Corps-identified permit area.

Any person may request, in writing, within the comment period specified in this notice, that a public hearing be held to consider this application. Requests for a public hearing shall state, with particularity, the reasons for holding a public hearing.

The decision whether to issue a permit will be based on an evaluation of the probable impact including cumulative impacts of the activity on the public interest and will include application of the guidelines promulgated by the Administrator, Environmental Protection Agency (EPA), under authority of Section 404(b) of the Clean Water Act. That decision will reflect the national concern for both protection and utilization of important resources. The benefit which reasonably may be expected to accrue from the project must be balanced against its reasonably foreseeable detriments. All factors which may be relevant to the project will be considered including the cumulative effects thereof; among those are conservation, economics, aesthetics, general environmental concerns, wetlands, historic properties, fish and wildlife values, flood hazards, flood plain values, land use, navigation, shoreline erosion and accretion, recreation, water supply and conservation, water quality, energy needs, safety, food and fiber production and, in general, the needs and welfare of the people. A permit will be granted unless the District Engineer determines that it would be contrary to the public interest. In cases of conflicting property rights, the Corps cannot undertake to adjudicate rival claims.

The Corps is soliciting comments from the public; Federal, state, and local agencies and officials; Indian Tribes; and other interested parties in order to consider and evaluate the impacts of this activity. Any comments received will be considered by the Corps to determine whether to issue, modify, condition or deny a permit for this project. To make this decision, comments are used to assess impacts on endangered species, historic properties, water quality, general environmental effects, and the other public interest factors listed above. Comments are used in the preparation of an Environmental Assessment and/or an Environmental Impact Statement pursuant to the National Environmental Policy Act. Comments are also used to determine the need for a public hearing and to determine the overall public interest of the activity. **Please submit comments in writing, identifying the project of interest by public notice number, to Leslie.A.Estill@usace.army.mil or to the following address:**

**U.S. Army Corps of Engineers
ATTN: REGULATORY DIVISION
69A Hagood Avenue
Charleston, South Carolina 29403-5107**

If there are any questions concerning this public notice, please contact Leslie Estill, Project Manager, at (843) 329-8039, or by email at Leslie.A.Estill@usace.army.mil.

HOMECOMING

DORCHESTER COUNTY, SOUTH CAROLINA

WETLAND PERMIT PROJECT DRAWINGS

VICINITY MAP	01
USGS MAP	02
PROJECT SUMMARY	03
WETLAND IMPACT AREAS	04
WETLAND IMPACTS PLAN A-H	05 - 12
WETLAND IMPACTS CROSS SECTION A-H	13 - 20
TYPICAL WETLAND ROAD CROSSING IMPACT SECTION	21
TYPICAL WETLAND EXCAVATION IMPACT SECTION	22
TYPICAL WETLAND FILL IMPACT SECTION	23
TYPICAL PARTIAL WETLAND FILL IMPACT SECTION	24

May 10, 2021



HOMECOMING

APPLICANT: EAST EDISTO HOLDINGS LLC.

DORCHESTER COUNTY, SC

PROJECT #: 8640

DATE: 5/10/2021



SITE
 LAT: N032°53'38"
 LON: W080°15'59"



HOMECOMING

APPLICANT: EAST EDISTO HOLDINGS LLC.
 DORCHESTER COUNTY, SC
 PROJECT #: 8640
 DATE: 5/10/2021

VICINITY MAP

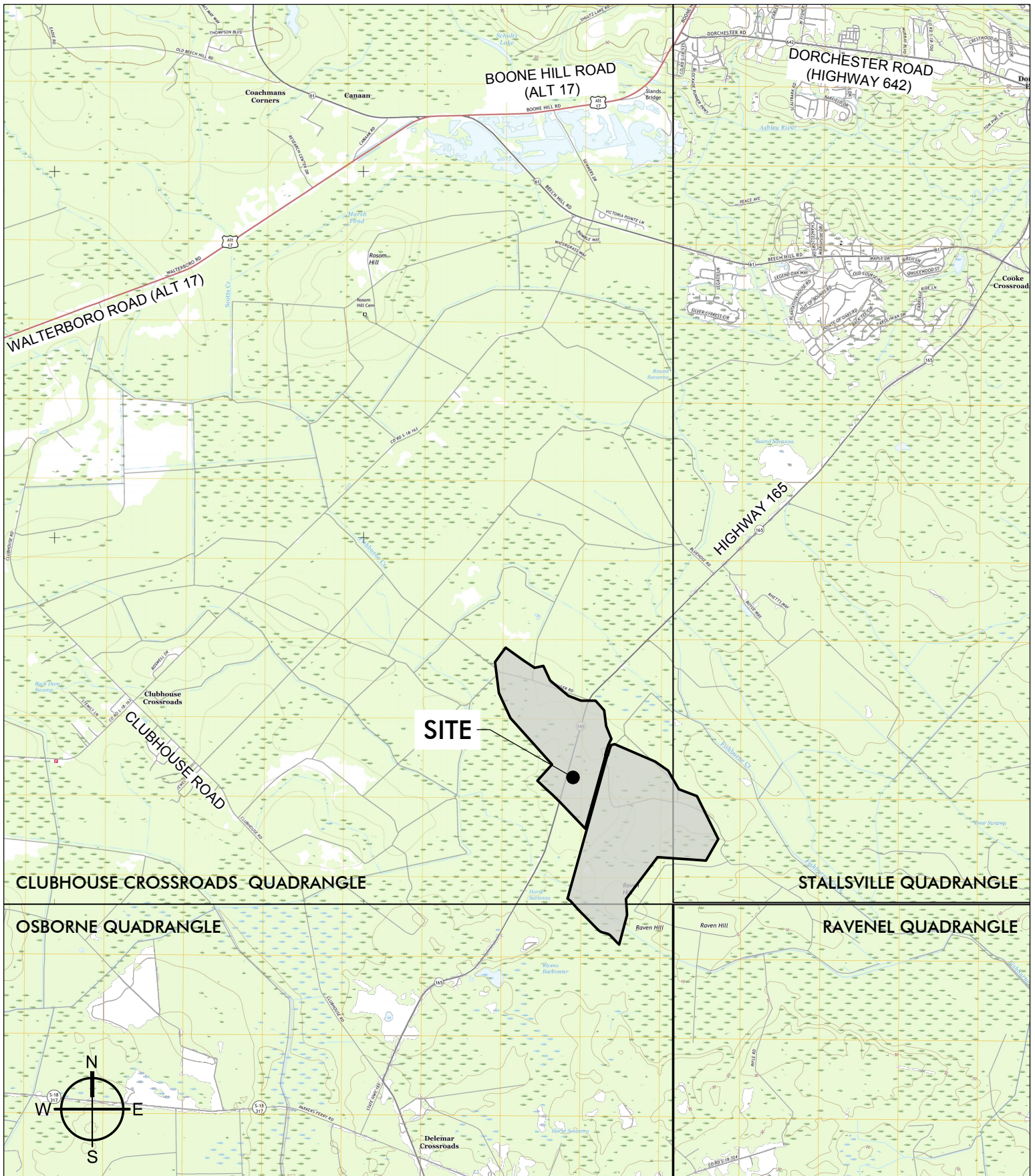

HOMECOMING

APPLICANT: EAST EDISTO HOLDINGS LLC.
 DORCHESTER COUNTY, SC
 PROJECT #: 8640
 DATE: 5/10/2021

USGS MAP
 CLUBHOUSE CROSSROADS
 QUADRANGLE

PROJECT TOTALS		
PROJECT AREA		861.42 ac.
	TOTAL UPLAND	557.38 ac.
	TOTAL FRESHWATER WETLAND	304.04 ac.
TOTAL JURISDICTIONAL IMPACTS		0.99 ac.
WETLAND IMPACTS A, B, D, & H	ROAD/UTILITY CROSSING FILL	0.81 ac.
	TEMPORARY UTILITY IMPACT	0.18 ac.
TOTAL EXCLUDED WATERS (NON-JURISDICTIONAL) IMPACTS		2.33 ac.
WETLAND IMPACTS C, E, F, & G	DEVELOPMENT FILL	1.01 ac.
	ROAD/UTILITY CROSSING FILL	1.32 ac.
TOTAL WETLAND PRESERVATION		300.32 ac.
WETLAND BUFFER (25' AVERAGE WIDTH)		51.11 ac.
WETLANDS WITHIN EXISTING UTILITY EASEMENTS		2.89 ac.

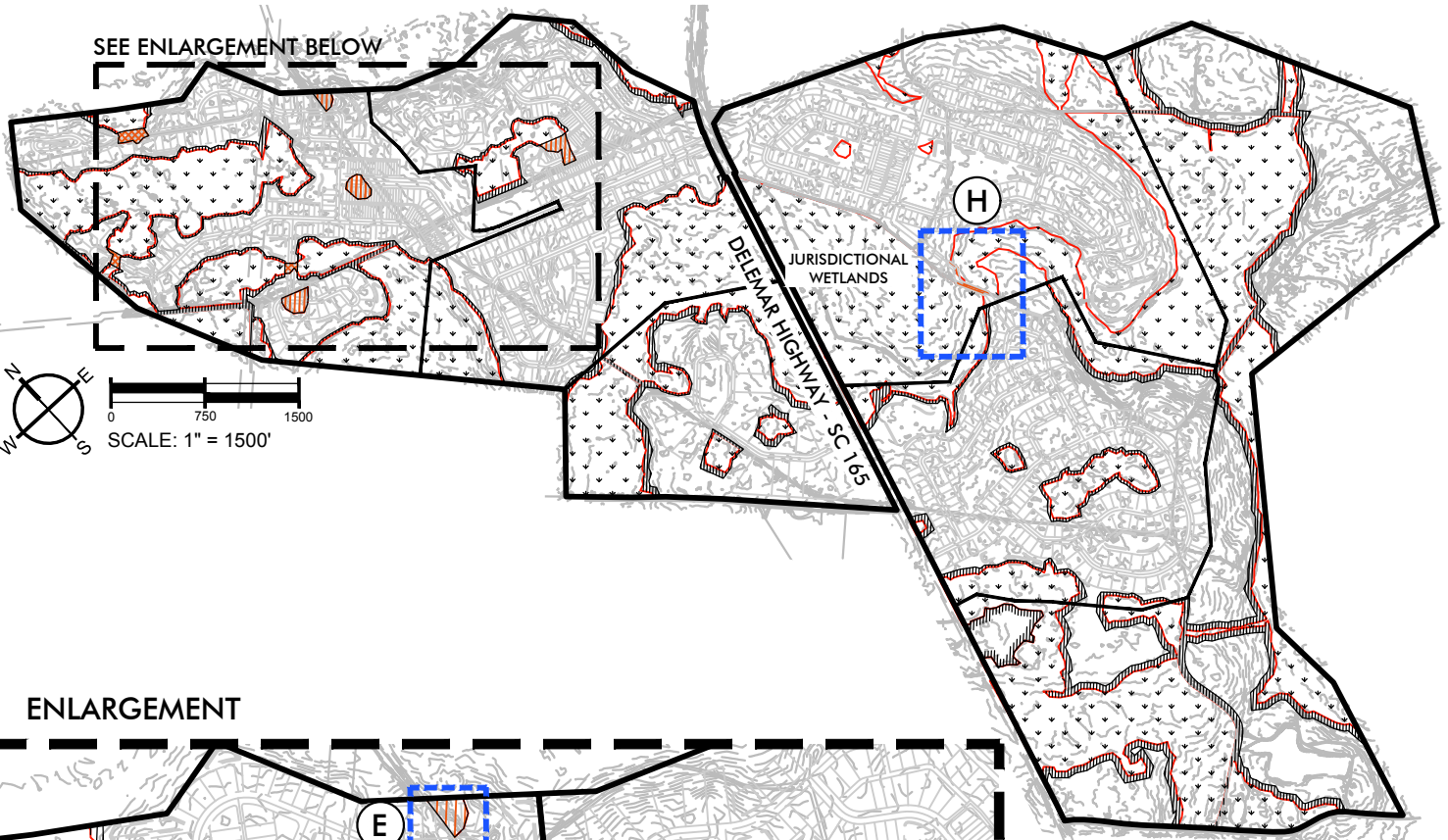

ENLARGEMENT

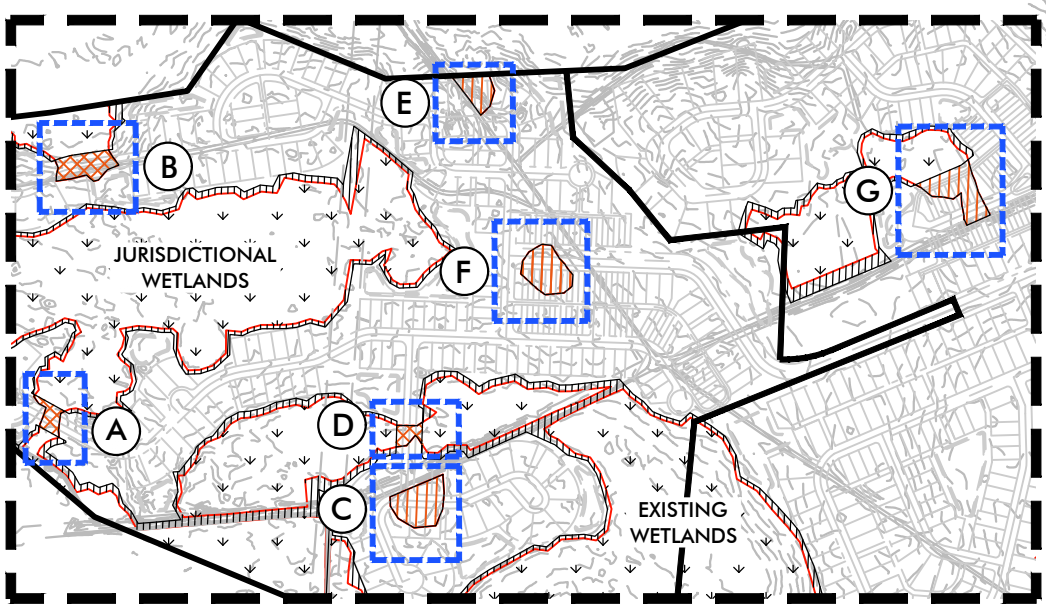

WETLAND IMPACTS

- (A) 0.19 AC. - SEE SHEET 05
- (B) 0.46 AC. - SEE SHEET 06
- (C) 0.68 AC. - SEE SHEET 07
- (D) 0.16 AC. - SEE SHEET 08
- (E) 0.35 AC. - SEE SHEET 09
- (F) 0.63 AC. - SEE SHEET 10
- (G) 0.67 AC. - SEE SHEET 11
- (H) 0.18 AC. - SEE SHEET 12

TOTAL IMPACT ACREAGE: 3.32 ACRES

LEGEND

WETLAND	
JURISDICTIONAL WETLAND FILL	
EXCLUDED WATERS FILL (NON-JURISDICTIONAL WETLAND)	
WETLAND IMPACT AREA	



HOMECOMING
 APPLICANT: EAST EDISTO HOLDINGS LLC.
 DORCHESTER COUNTY, SC
 PROJECT #: 8640
 DATE: 5/10/2021

WETLAND IMPACT AREAS

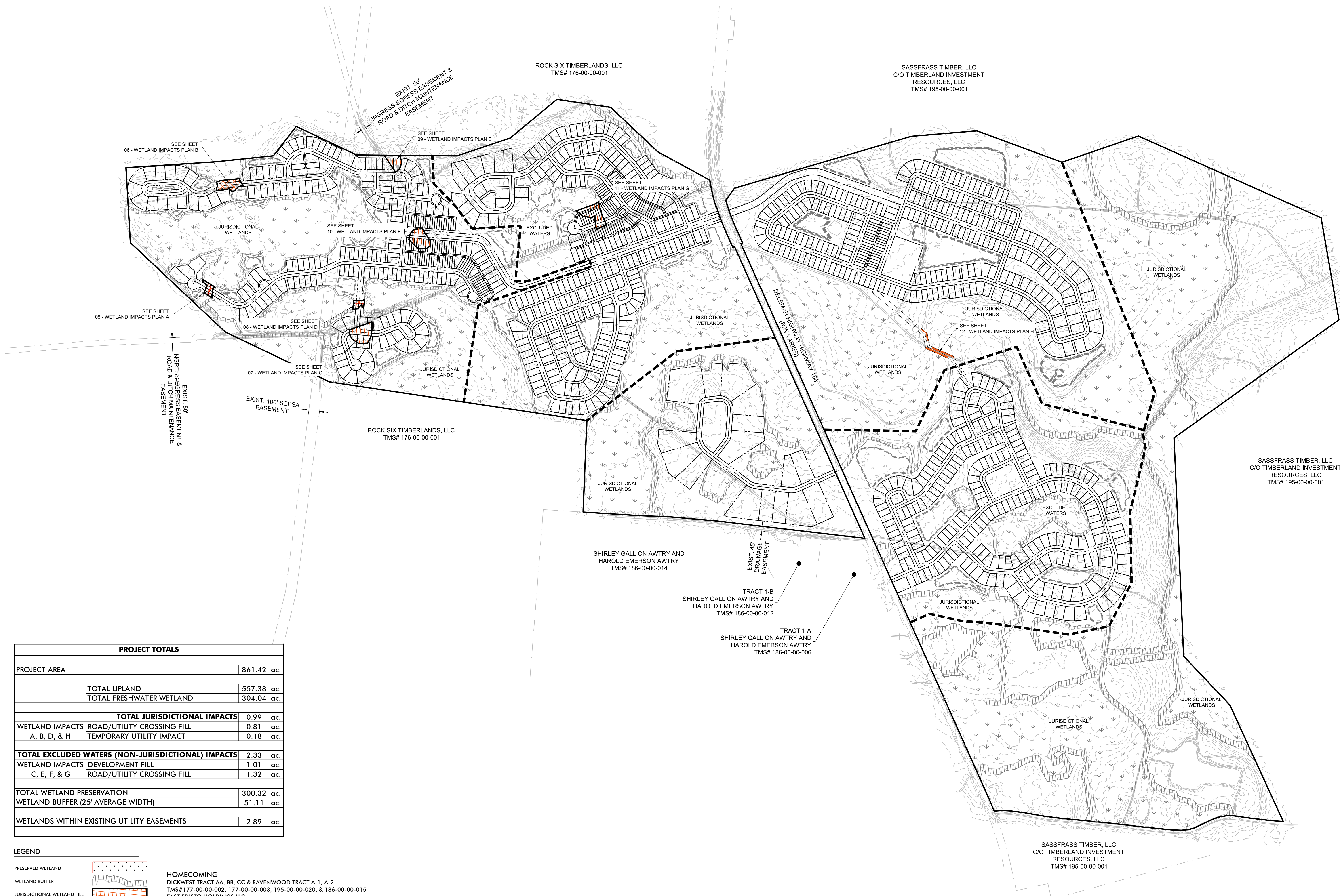

PROJECT TOTALS	
PROJECT AREA	861.42 ac.
TOTAL UPLAND	557.38 ac.
TOTAL FRESHWATER WETLAND	304.04 ac.
TOTAL JURISDICTIONAL IMPACTS	0.99 ac.
WETLAND IMPACTS ROAD/UTILITY CROSSING FILL	0.81 ac.
A, B, D, & H TEMPORARY UTILITY IMPACT	0.18 ac.
TOTAL EXCLUDED WATERS (NON-JURISDICTIONAL) IMPACTS	2.33 ac.
WETLAND IMPACTS DEVELOPMENT FILL	1.01 ac.
C, E, F, & G ROAD/UTILITY CROSSING FILL	1.32 ac.
TOTAL WETLAND PRESERVATION	300.32 ac.
WETLAND BUFFER (25' AVERAGE WIDTH)	51.11 ac.
WETLANDS WITHIN EXISTING UTILITY EASEMENTS	2.89 ac.

LEGEND

PRESERVED WETLAND		HOMECOMING DICKWEST TRACT AA, BB, CC & RAVENWOOD TRACT A-1, A-2 TMS# 177-00-00-002, 177-00-00-003, 195-00-00-020, & 186-00-00-015 EAST EDISTO HOLDINGS LLC.
WETLAND BUFFER		
JURISDICTIONAL WETLAND FILL		
EXCLUDED WATERS WETLAND FILL (NON-JURISDICTIONAL)		

NOTE: THIS PLAN IS CONCEPTUAL IN NATURE AND SUBJECT TO CHANGE.

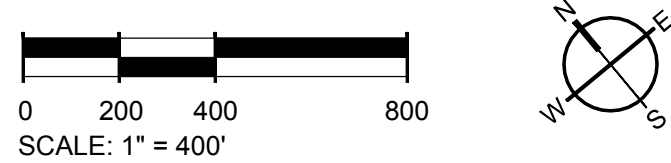

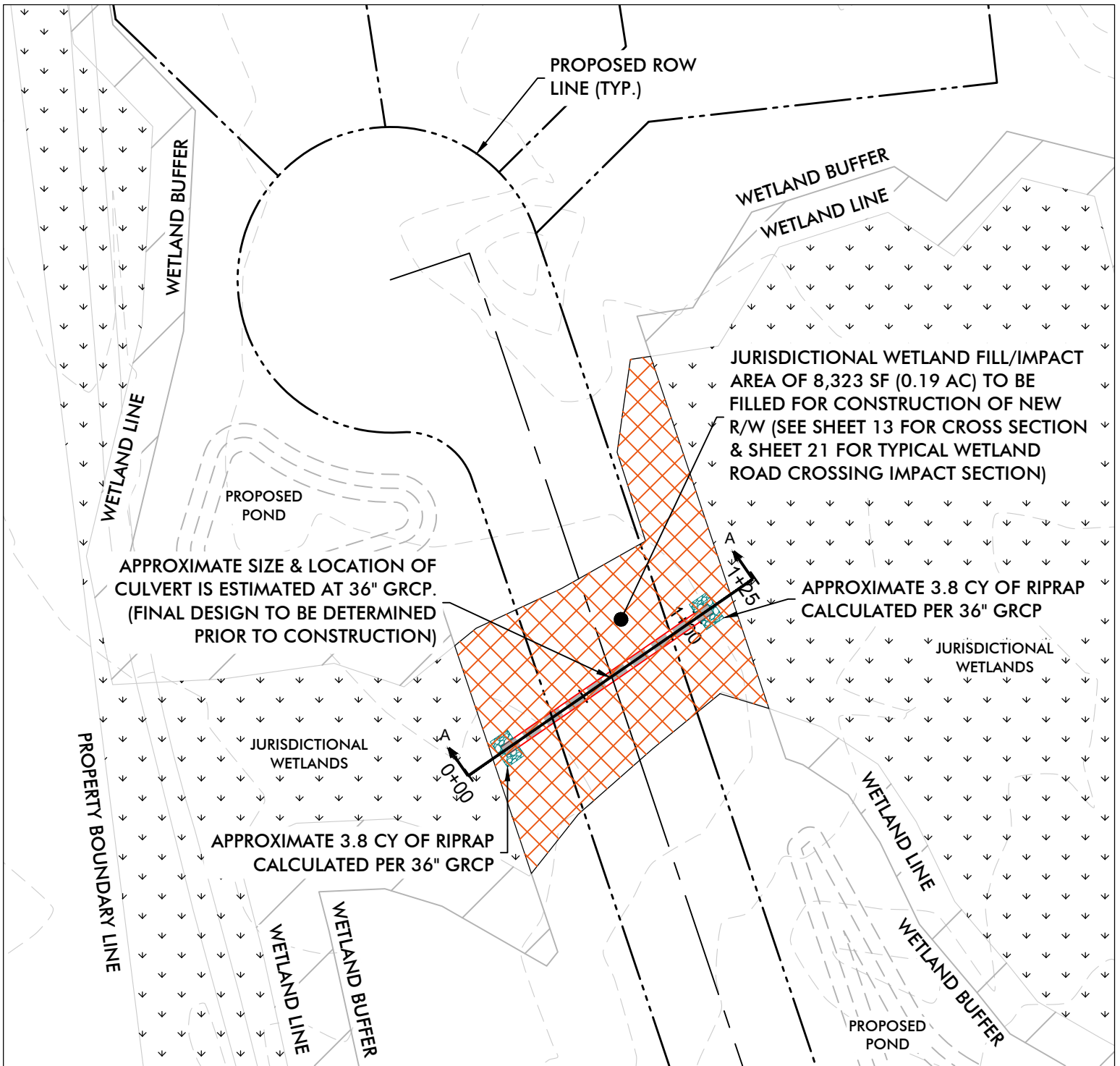

APPROXIMATE SIZE & LOCATION OF CULVERT IS ESTIMATED AT 36" GRCP. (FINAL DESIGN TO BE DETERMINED PRIOR TO CONSTRUCTION)

JURISDICTIONAL WETLAND FILL/IMPACT AREA OF 8,323 SF (0.19 AC) TO BE FILLED FOR CONSTRUCTION OF NEW R/W (SEE SHEET 13 FOR CROSS SECTION & SHEET 21 FOR TYPICAL WETLAND ROAD CROSSING IMPACT SECTION)

APPROXIMATE 3.8 CY OF RIPRAP CALCULATED PER 36" GRCP

APPROXIMATE 3.8 CY OF RIPRAP CALCULATED PER 36" GRCP

WETLAND IMPACT TO JURISDICTIONAL WETLAND
TOTAL IMPACT ACREAGE: 8,323 SF (0.19 AC.)

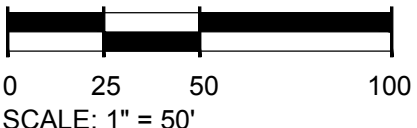

LEGEND			
DEVELOPMENT IMPACT		WETLAND	
EXCLUDED WATERS IMPACT		RIGHT-OF-WAY	
JURISDICTIONAL WETLAND IMPACT		LOT LINE	
TEMPORARY IMPACT		ROAD CENTERLINE	



HOMECOMING
 APPLICANT: EAST EDISTO HOLDINGS LLC.
 DORCHESTER COUNTY, SC
 PROJECT #: 8640
 DATE: 5/10/2021

WETLAND IMPACTS PLAN A

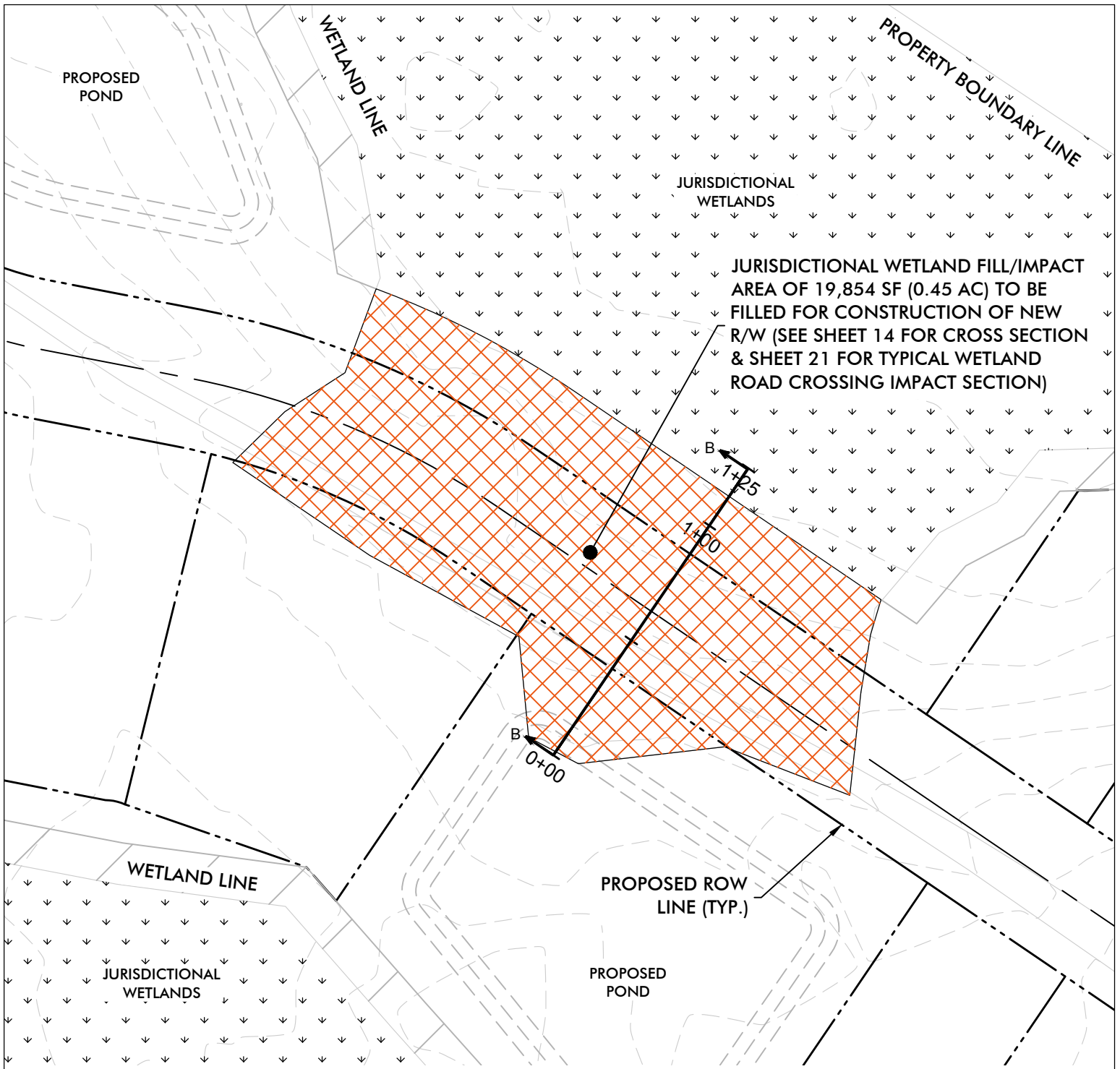

JURISDICTIONAL WETLAND FILL/IMPACT AREA OF 19,854 SF (0.45 AC) TO BE FILLED FOR CONSTRUCTION OF NEW R/W (SEE SHEET 14 FOR CROSS SECTION & SHEET 21 FOR TYPICAL WETLAND ROAD CROSSING IMPACT SECTION)

WETLAND IMPACT TO JURISDICTIONAL WETLAND
TOTAL IMPACT ACREAGE: 20,205 SF (0.46 AC.)

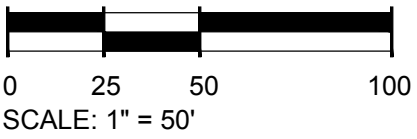

LEGEND			
DEVELOPMENT IMPACT		WETLAND	
EXCLUDED WATERS IMPACT		RIGHT-OF-WAY	
JURISDICTIONAL WETLAND IMPACT		LOT LINE	
TEMPORARY IMPACT		ROAD CENTERLINE	



HOMECOMING
 APPLICANT: EAST EDISTO HOLDINGS LLC.
 DORCHESTER COUNTY, SC
 PROJECT #: 8640
 DATE: 5/10/2021

WETLAND IMPACTS PLAN B

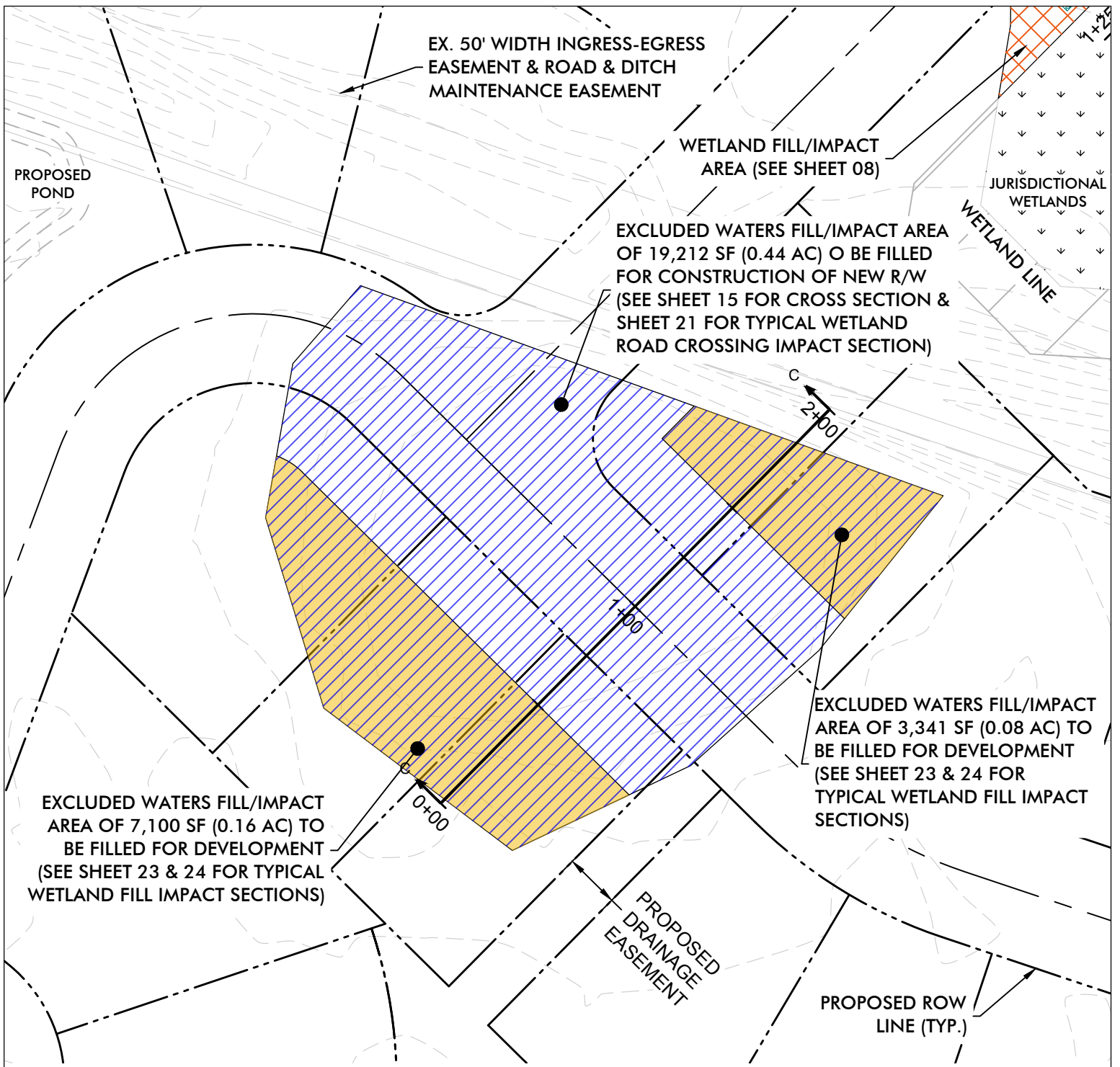

EX. 50' WIDTH INGRESS-EGRESS
EASEMENT & ROAD & DITCH
MAINTENANCE EASEMENT

PROPOSED
POND

WETLAND FILL/IMPACT
AREA (SEE SHEET 08)

JURISDICTIONAL
WETLANDS

WETLAND LINE

EXCLUDED WATERS FILL/IMPACT AREA
OF 19,212 SF (0.44 AC) O BE FILLED
FOR CONSTRUCTION OF NEW R/W
(SEE SHEET 15 FOR CROSS SECTION &
SHEET 21 FOR TYPICAL WETLAND
ROAD CROSSING IMPACT SECTION)

EXCLUDED WATERS FILL/IMPACT
AREA OF 3,341 SF (0.08 AC) TO
BE FILLED FOR DEVELOPMENT
(SEE SHEET 23 & 24 FOR
TYPICAL WETLAND FILL IMPACT
SECTIONS)

EXCLUDED WATERS FILL/IMPACT
AREA OF 7,100 SF (0.16 AC) TO
BE FILLED FOR DEVELOPMENT
(SEE SHEET 23 & 24 FOR TYPICAL
WETLAND FILL IMPACT SECTIONS)

PROPOSED
DRAINAGE
EASEMENT







PROPOSED ROW
LINE (TYP.)

WETLAND IMPACT TO EXCLUDED WATERS (NON-JURISDICTIONAL WETLAND)
TOTAL IMPACT ACREAGE: 29,653 SF (0.68 AC.)

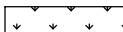

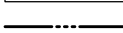
SCALE: 1" = 50'

LEGEND

DEVELOPMENT IMPACT		WETLAND	
EXCLUDED WATERS IMPACT		RIGHT-OF-WAY	
JURISDICTIONAL WETLAND IMPACT		LOT LINE	
TEMPORARY IMPACT		ROAD CENTERLINE	



HOMECOMING

APPLICANT: EAST EDISTO HOLDINGS LLC.
DORCHESTER COUNTY, SC
PROJECT #: 8640
DATE: 5/10/2021

WETLAND IMPACTS PLAN C

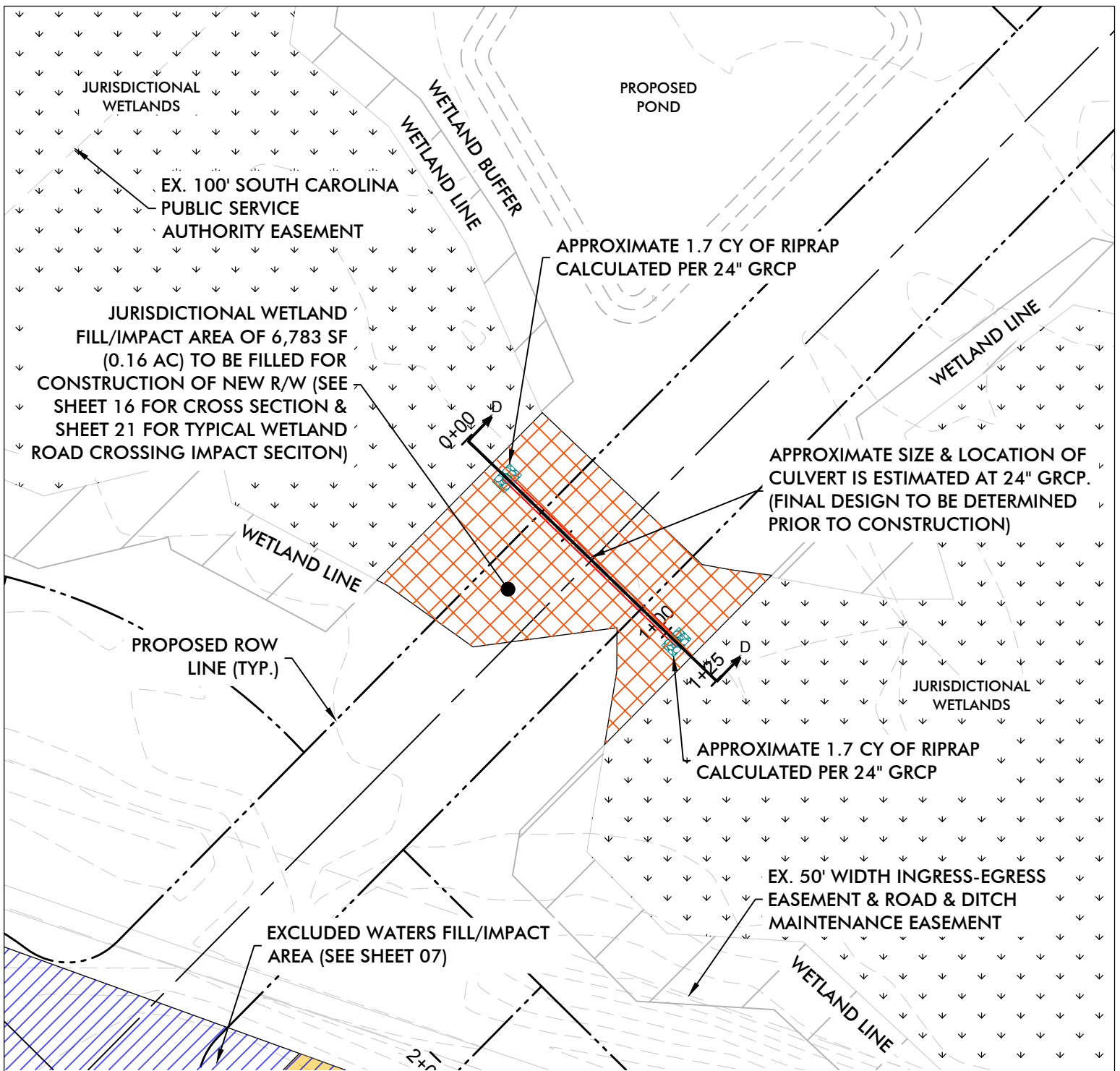

WETLAND IMPACT TO JURISDICTIONAL WETLAND
TOTAL IMPACT ACREAGE: 6,783 SF (0.16 AC.)



0 25 50 100
 SCALE: 1" = 50'

LEGEND			
DEVELOPMENT IMPACT	Yellow solid box	WETLAND	Downward arrow pattern box
EXCLUDED WATERS IMPACT	Blue diagonal lines box	RIGHT-OF-WAY	Dashed line
JURISDICTIONAL WETLAND IMPACT	Orange cross-hatch box	LOT LINE	Dotted line
TEMPORARY IMPACT	Grey solid box	ROAD CENTERLINE	Long-dashed line



HOMECOMING

APPLICANT: EAST EDISTO HOLDINGS LLC.
 DORCHESTER COUNTY, SC
 PROJECT #: 8640
 DATE: 5/10/2021

WETLAND IMPACTS PLAN D

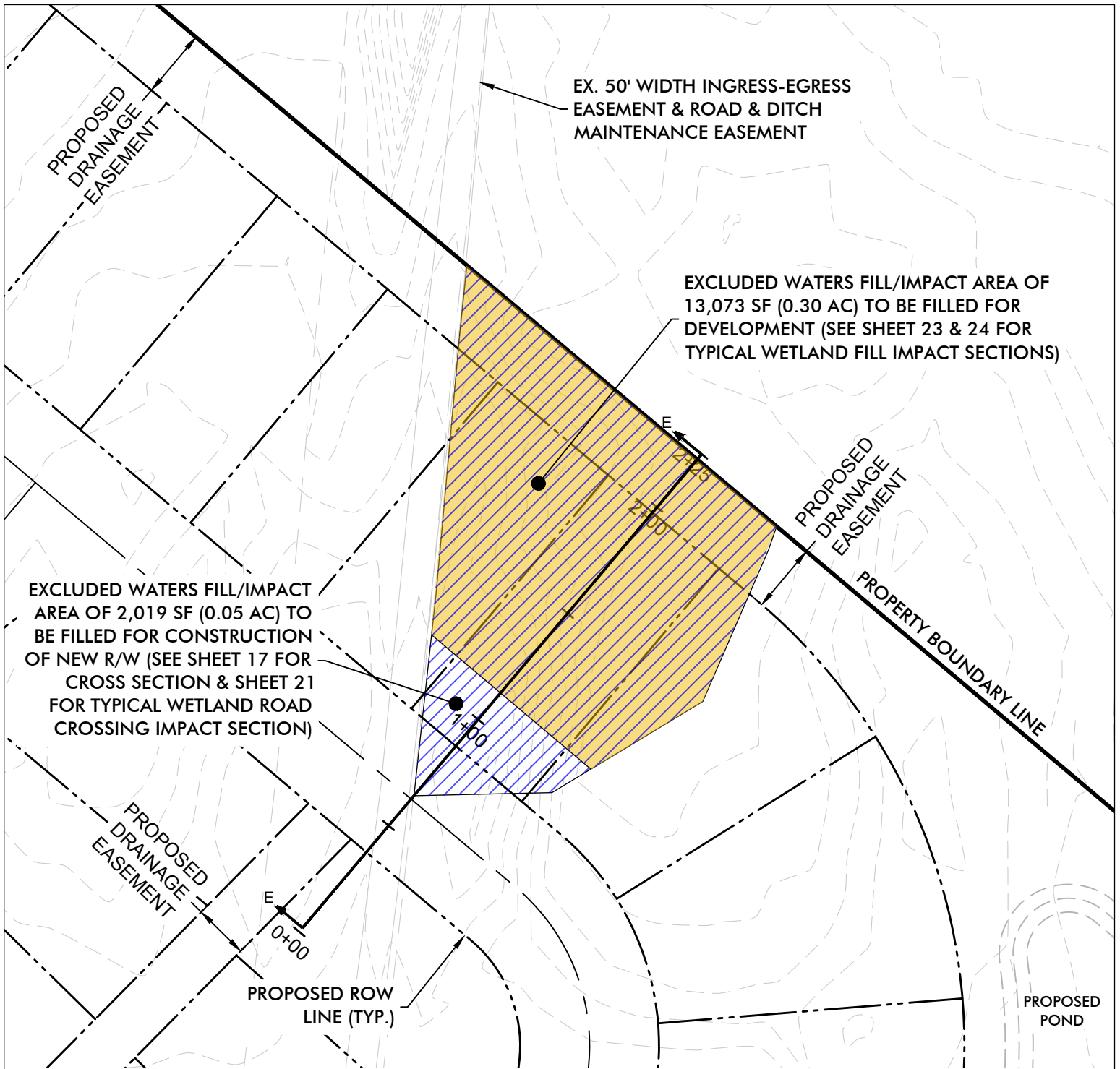

WETLAND IMPACT TO EXCLUDED WATERS (NON-JURISDICTIONAL WETLAND)
TOTAL IMPACT ACREAGE: 15,092 SF (0.35 AC.)



SCALE: 1" = 50'

LEGEND

DEVELOPMENT IMPACT		WETLAND	
EXCLUDED WATERS IMPACT		RIGHT-OF-WAY	
JURISDICTIONAL WETLAND IMPACT		LOT LINE	
TEMPORARY IMPACT		ROAD CENTERLINE	



HOMECOMING

APPLICANT: EAST EDISTO HOLDINGS LLC.
 DORCHESTER COUNTY, SC
 PROJECT #: 8640
 DATE: 5/10/2021

WETLAND IMPACTS PLAN E

CIVIC/OPEN SPACE

EX. 50' WIDTH INGRESS-EGRESS EASEMENT & ROAD & DITCH MAINTENANCE EASEMENT

EXCLUDED WATERS FILL/IMPACT AREA OF 13,204 SF (0.31 AC) TO BE FILLED FOR CONSTRUCTION OF NEW R/W (SEE SHEET 18 FOR CROSS SECTION & SHEET 21 FOR TYPICAL WETLAND ROAD CROSSING IMPACT SECTION)

PROPOSED ROW LINE (TYP.)

F
2+25

2+50

7+50

F
0+50

GREENWAY

GREENWAY

EXCLUDED WATERS FILL/IMPACT AREA OF 14,013 SF (0.32 AC) TO BE FILLED FOR DEVELOPMENT (SEE SHEET 23 & 24 FOR TYPICAL WETLAND FILL IMPACT SECTIONS)

WETLAND IMPACT TO EXCLUDED WATERS (NON-JURISDICTIONAL WETLAND)

TOTAL IMPACT ACREAGE: 27,217 SF (0.63 AC.)



SCALE: 1" = 50'

LEGEND

DEVELOPMENT IMPACT		WETLAND	
EXCLUDED WATERS IMPACT		RIGHT-OF-WAY	
JURISDICTIONAL WETLAND IMPACT		LOT LINE	
TEMPORARY IMPACT		ROAD CENTERLINE	



HOMECOMING

APPLICANT: EAST EDISTO HOLDINGS LLC.
DORCHESTER COUNTY, SC
PROJECT #: 8640
DATE: 5/10/2021

WETLAND IMPACTS PLAN F

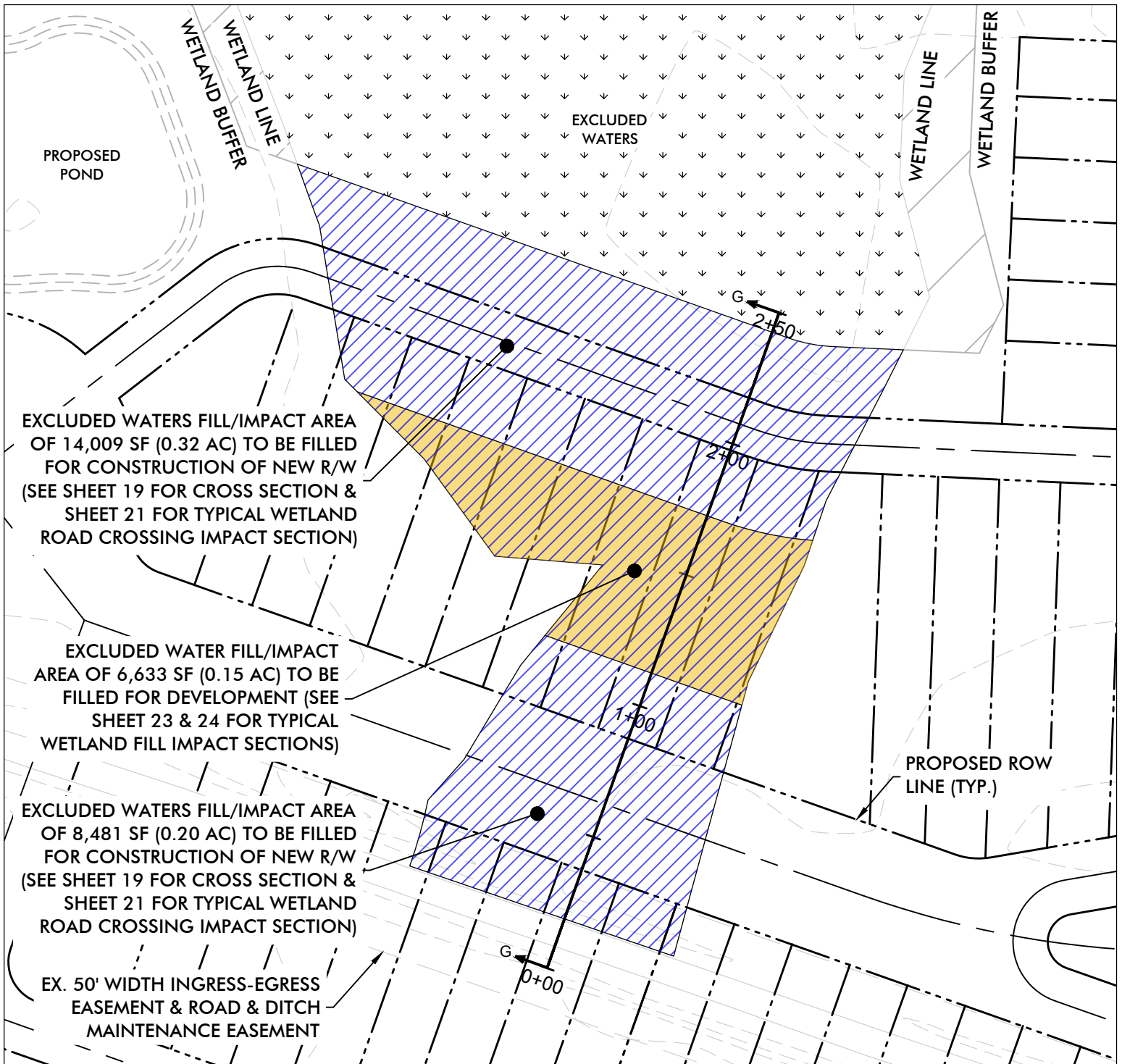

EXCLUDED WATERS FILL/IMPACT AREA OF 14,009 SF (0.32 AC) TO BE FILLED FOR CONSTRUCTION OF NEW R/W (SEE SHEET 19 FOR CROSS SECTION & SHEET 21 FOR TYPICAL WETLAND ROAD CROSSING IMPACT SECTION)

EXCLUDED WATER FILL/IMPACT AREA OF 6,633 SF (0.15 AC) TO BE FILLED FOR DEVELOPMENT (SEE SHEET 23 & 24 FOR TYPICAL WETLAND FILL IMPACT SECTIONS)

EXCLUDED WATERS FILL/IMPACT AREA OF 8,481 SF (0.20 AC) TO BE FILLED FOR CONSTRUCTION OF NEW R/W (SEE SHEET 19 FOR CROSS SECTION & SHEET 21 FOR TYPICAL WETLAND ROAD CROSSING IMPACT SECTION)

EX. 50' WIDTH INGRESS-EGRESS EASEMENT & ROAD & DITCH MAINTENANCE EASEMENT

WETLAND IMPACT TO EXCLUDED WATERS (NON-JURISDICTIONAL WETLAND)
TOTAL IMPACT ACREAGE: 29,123 SF (0.67 AC.)

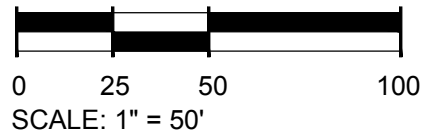

LEGEND			
DEVELOPMENT IMPACT		WETLAND	
EXCLUDED WATERS IMPACT		RIGHT-OF-WAY	
JURISDICTIONAL WETLAND IMPACT		LOT LINE	
TEMPORARY IMPACT		ROAD CENTERLINE	



HOMECOMING
 APPLICANT: EAST EDISTO HOLDINGS LLC.
 DORCHESTER COUNTY, SC
 PROJECT #: 8640
 DATE: 5/10/2021

WETLAND IMPACTS PLAN G

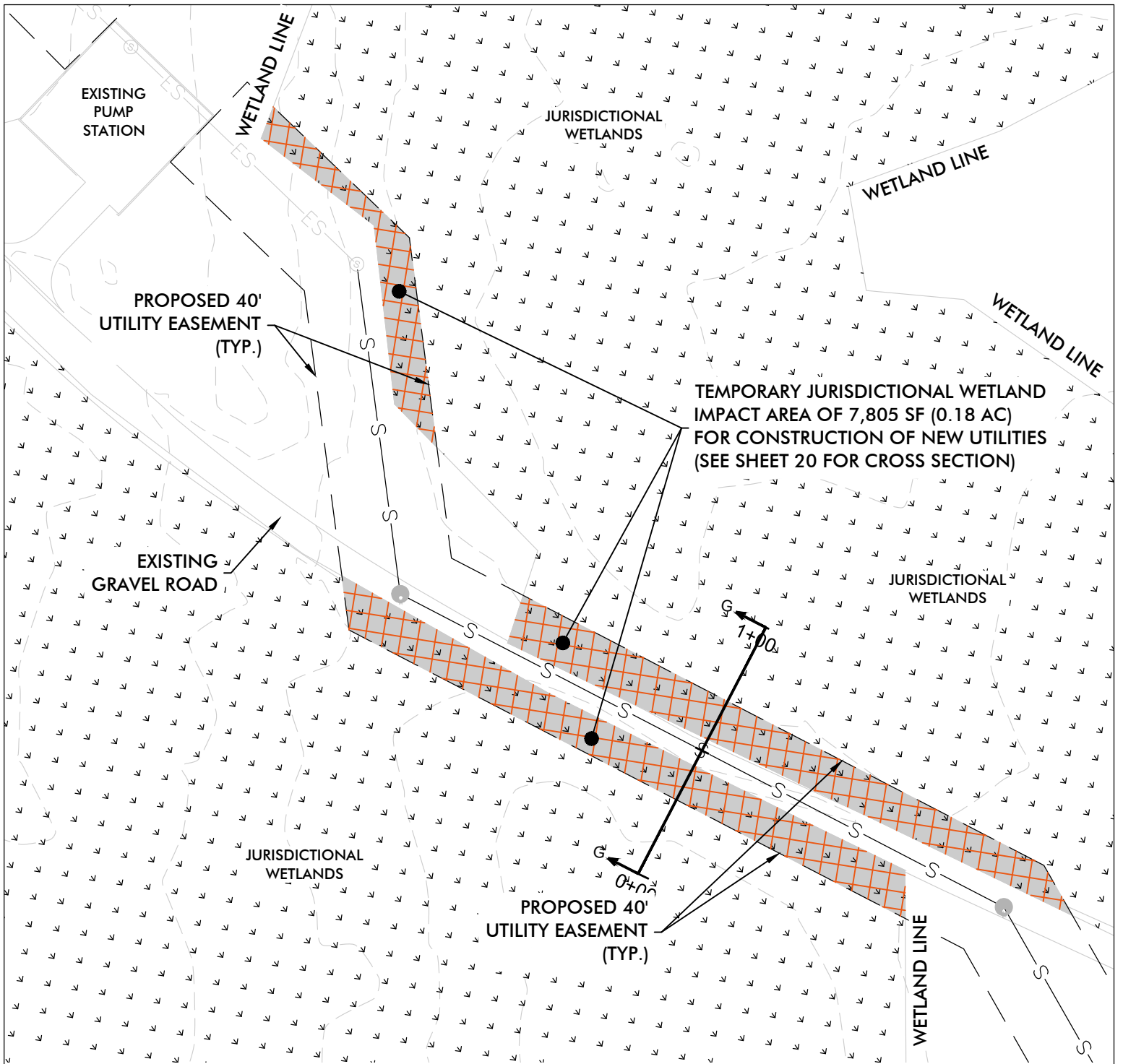

TEMPORARY WETLAND IMPACT TO JURISDICTIONAL WETLAND
TOTAL IMPACT ACREAGE: 7,805 SF (0.18 AC.)

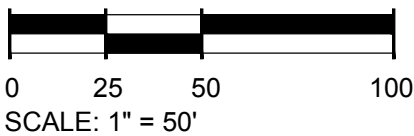

LEGEND			
DEVELOPMENT IMPACT		WETLAND	
EXCLUDED WATERS IMPACT		RIGHT-OF-WAY	
JURISDICTIONAL WETLAND IMPACT		LOT LINE	
TEMPORARY IMPACT		ROAD CENTERLINE	



HOMECOMING

APPLICANT: EAST EDISTO HOLDINGS LLC.
 DORCHESTER COUNTY, SC
 PROJECT #: 8640
 DATE: 5/10/2021

WETLAND IMPACTS PLAN H

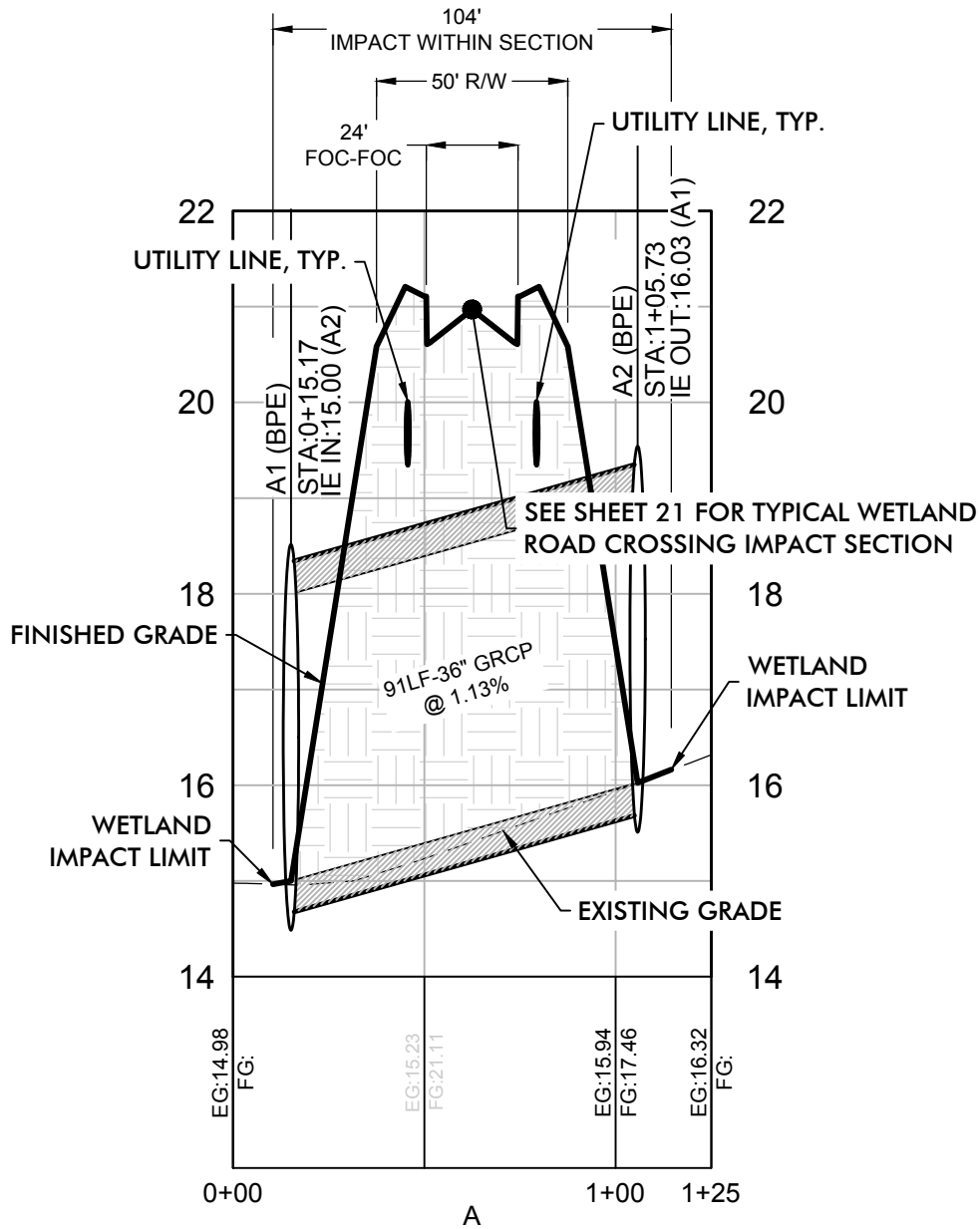

WETLAND IMPACT TO JURISDICTIONAL WETLAND
 TOTAL IMPACT ACREAGE: 8,323 SF (0.19 AC.)
 TOTAL APPROX. FILL VOLUME: 37.9 CU. YD.

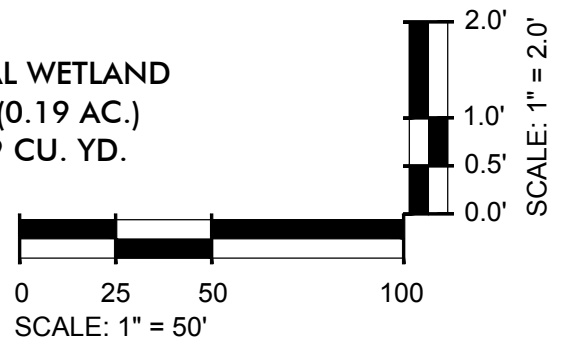

NOTE:
 DRAINAGE PIPE IS ESTIMATED AT 36" GRCP. SIZE AND NUMBER OF PIPES SHALL BE DETERMINED WITH FINAL DRAINAGE ANALYSIS.



HOMECOMING

WETLAND IMPACTS CROSS SECTION A

APPLICANT: EAST EDISTO HOLDINGS LLC.
 DORCHESTER COUNTY, SC
 PROJECT #: 8640
 DATE: 5/10/2021

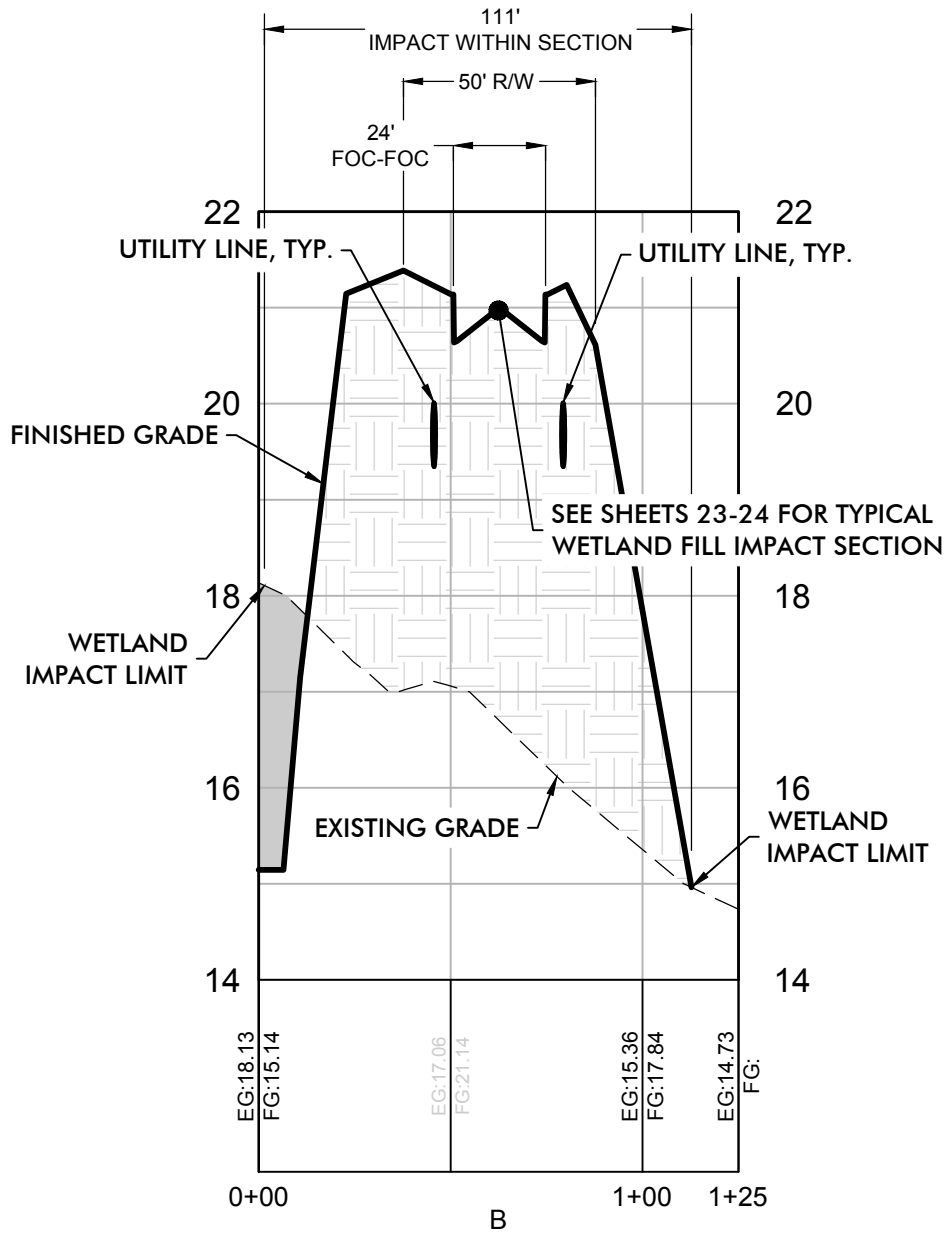

WETLAND IMPACT TO JURISDICTIONAL WETLAND
TOTAL IMPACT ACREAGE: 20,205 SF (0.46 AC.)
TOTAL APPROX. CUT VOLUME: 197.9 CU. YD.

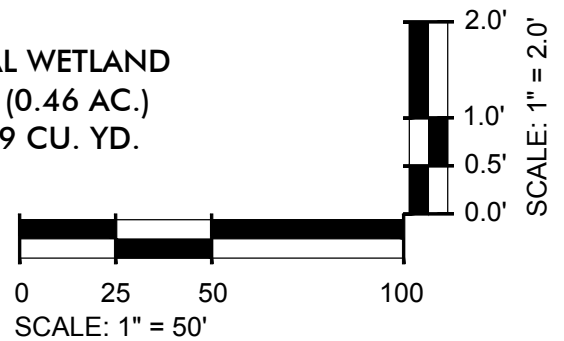

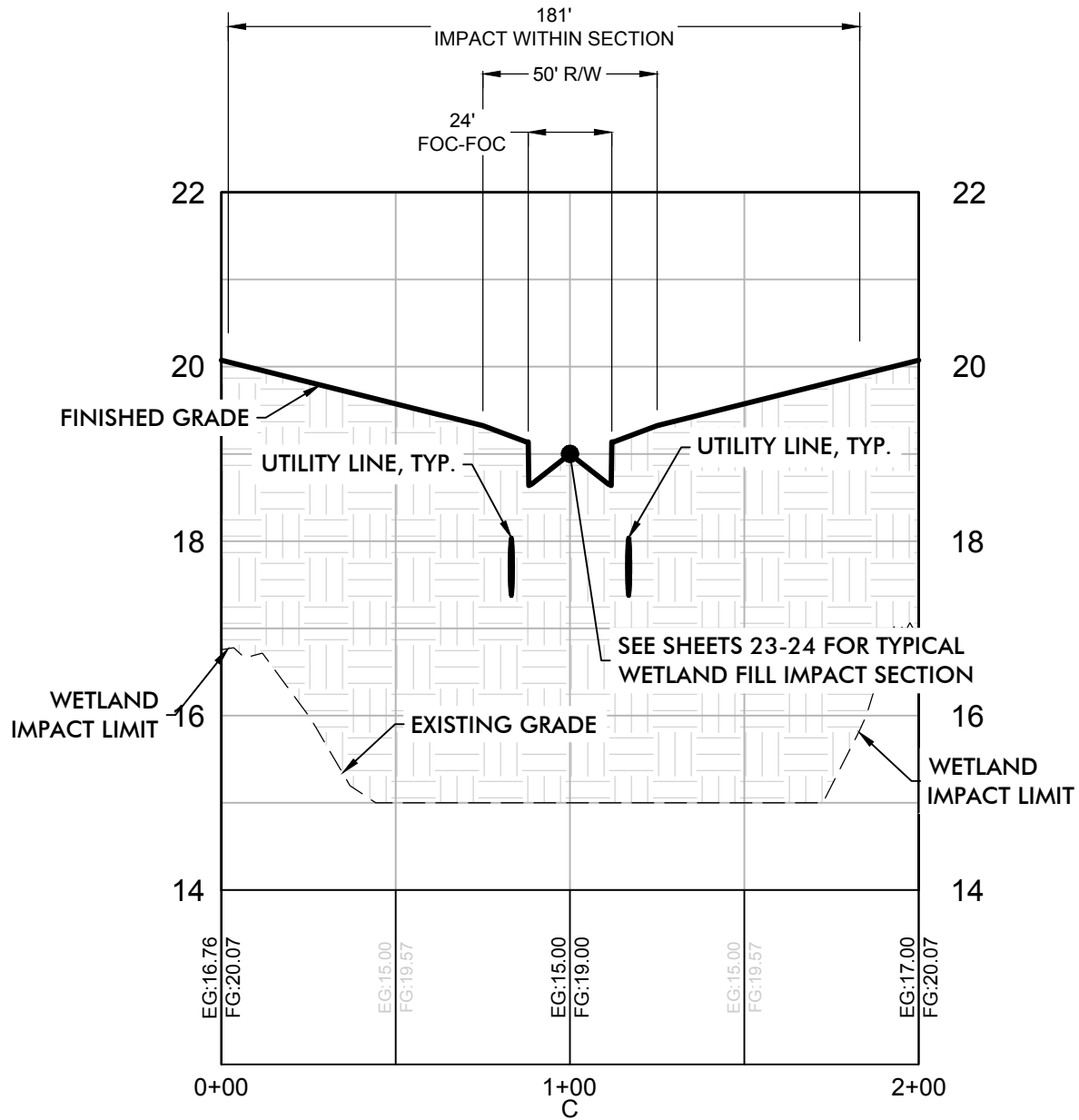

WETLAND IMPACT TO EXCLUDED WATERS (NON-JURISDICTIONAL WETLAND)
 TOTAL IMPACT ACREAGE: 29,653 SF (0.68 AC.)
 TOTAL APPROX. FILL VOLUME: 899.6 CU. YD.

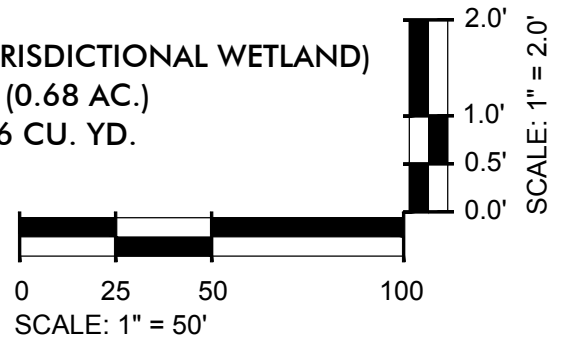

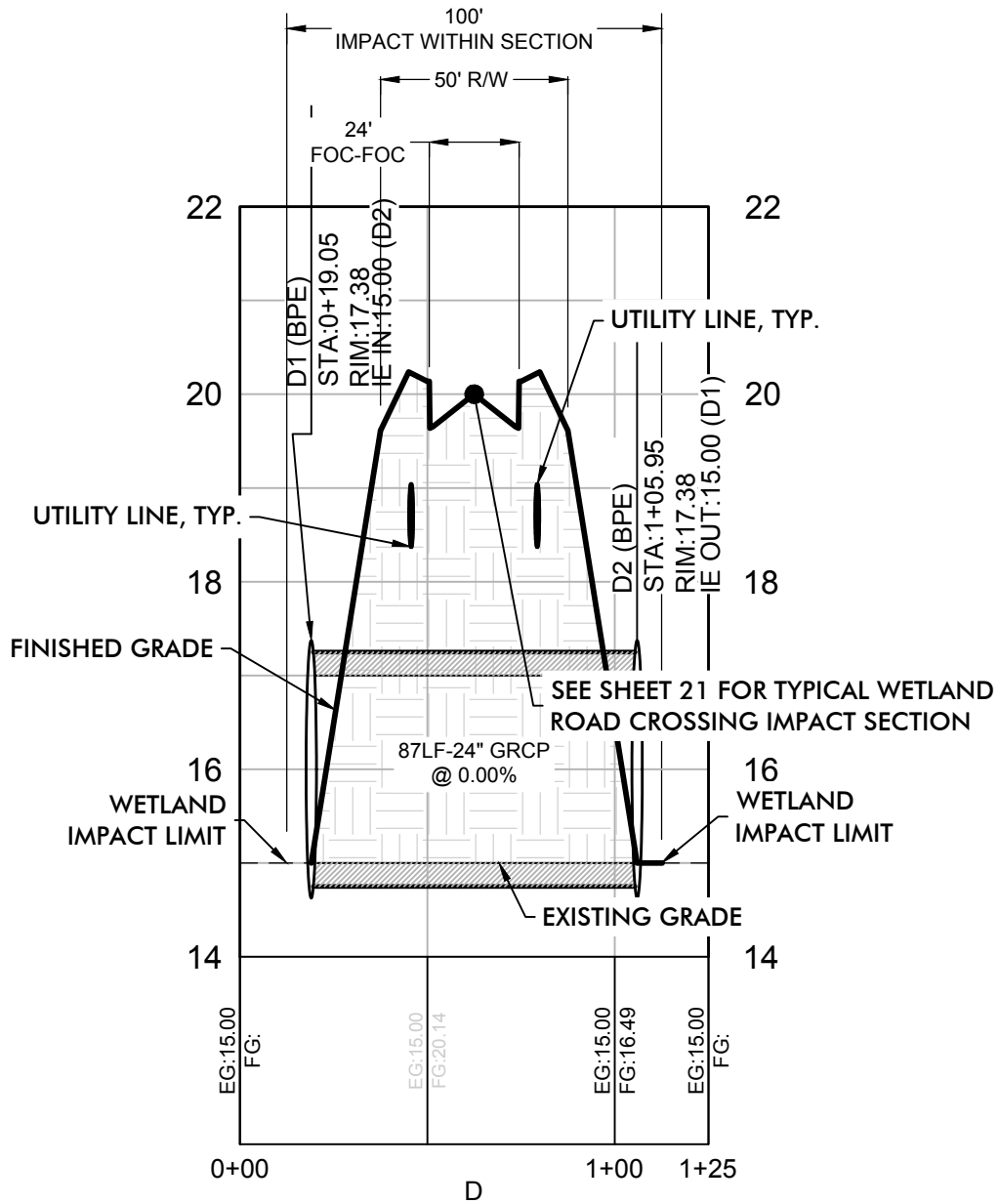

WETLAND IMPACT TO JURISDICTIONAL WETLAND
 TOTAL IMPACT ACREAGE: 6,783 SF (0.16 AC.)
 TOTAL APPROX. FILL VOLUME: 2.2 CU. YD.

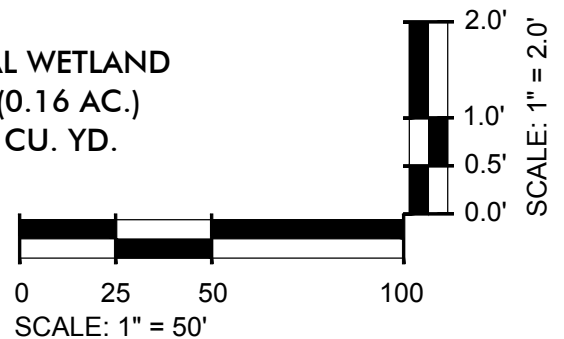

NOTE:
 DRAINAGE PIPE IS ESTIMATED AT 24" GRCP. SIZE AND NUMBER OF PIPES SHALL BE DETERMINED WITH FINAL DRAINAGE ANALYSIS.

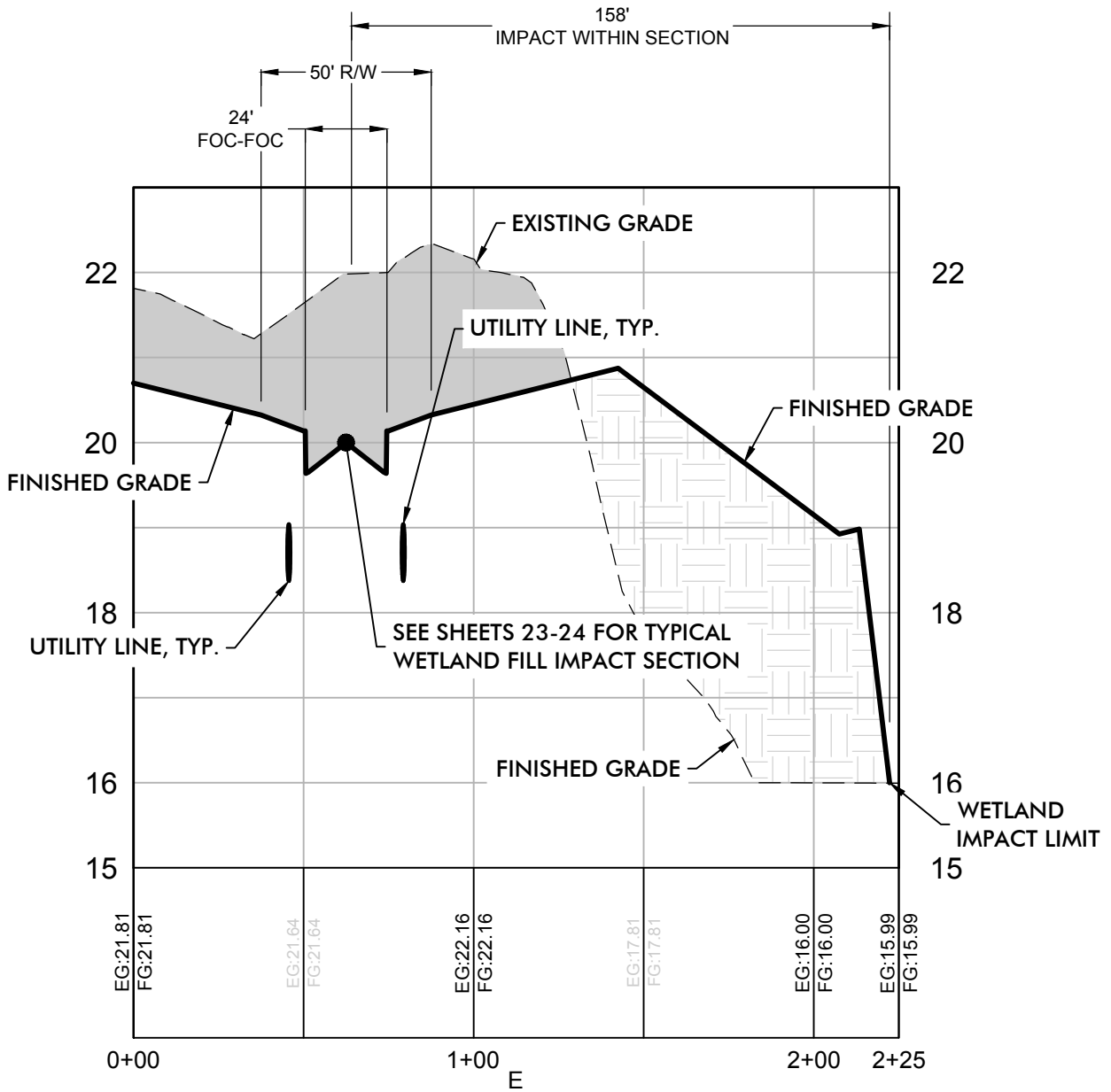

WETLAND IMPACT TO EXCLUDED WATERS (NON-JURISDICTIONAL WETLAND)
TOTAL IMPACT ACREAGE: 15,092 SF (0.35 AC.)
TOTAL APPROX. FILL VOLUME: 127.2 CU. YD.

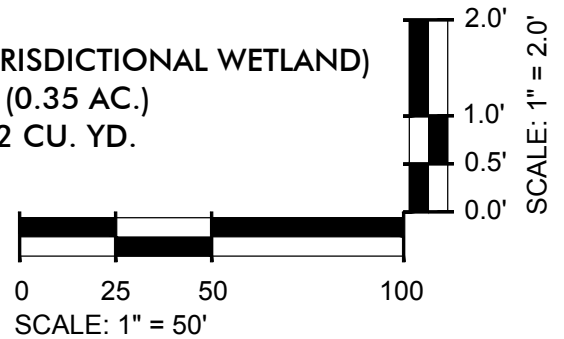

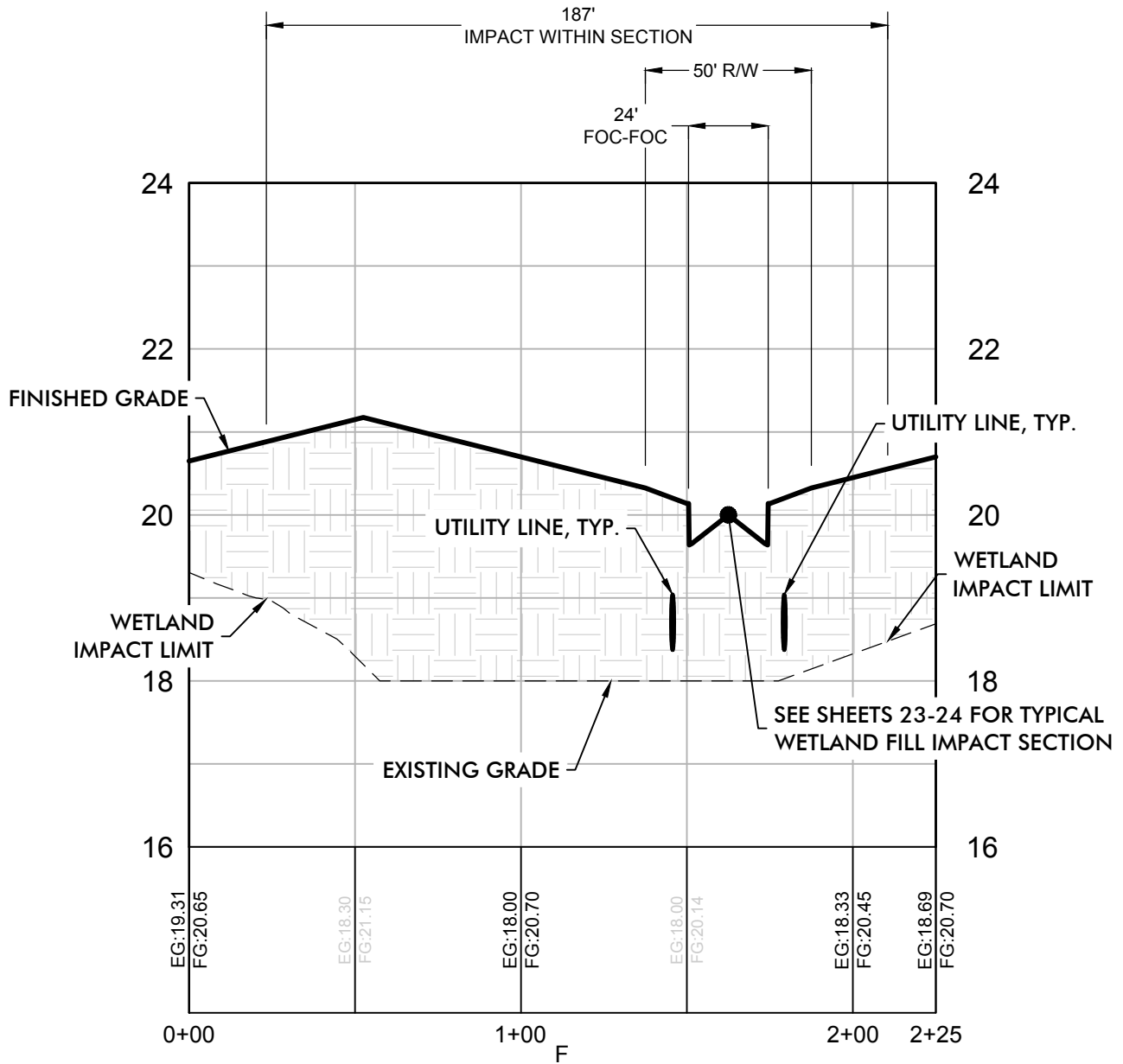

WETLAND IMPACT TO EXCLUDED WATERS (NON-JURISDICTIONAL WETLAND)
 TOTAL IMPACT ACREAGE: 27,217 SF (0.63 AC.)
 TOTAL APPROX. FILL VOLUME: 410.4 CU. YD.

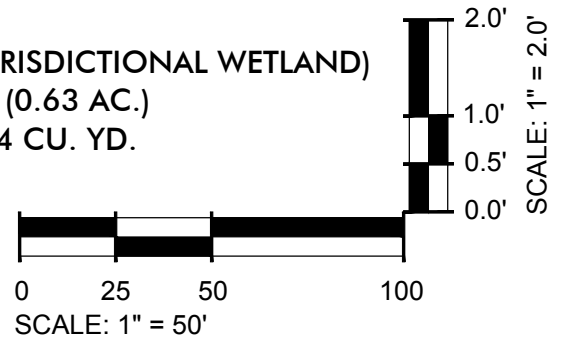

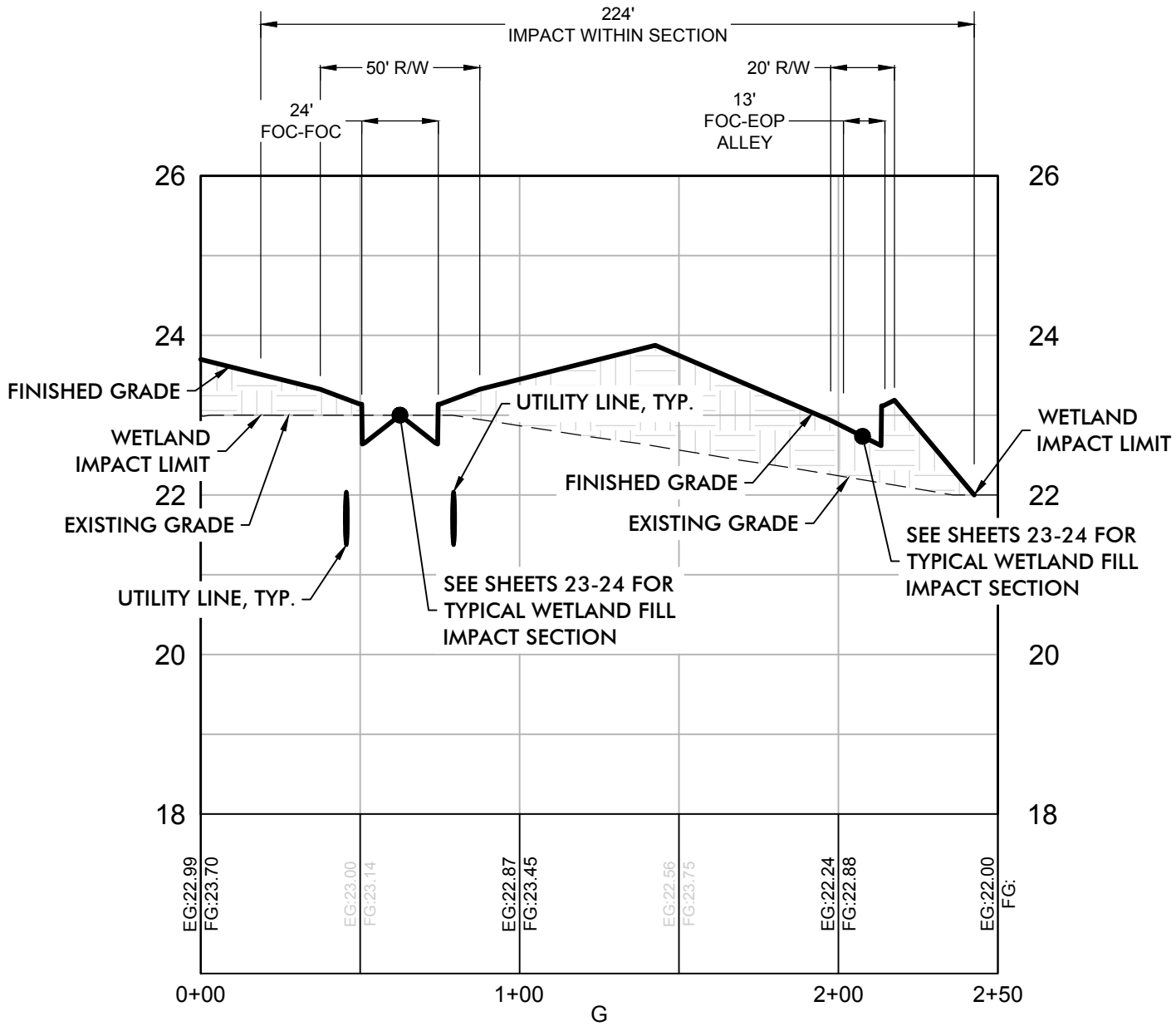

WETLAND IMPACT TO EXCLUDED WATERS (NON-JURISDICTIONAL WETLAND)
TOTAL IMPACT ACREAGE: 29,123 SF (0.67 AC.)
TOTAL APPROX. FILL VOLUME: 51 CU. YD.

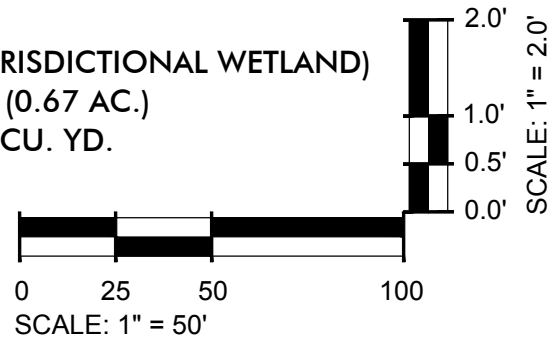

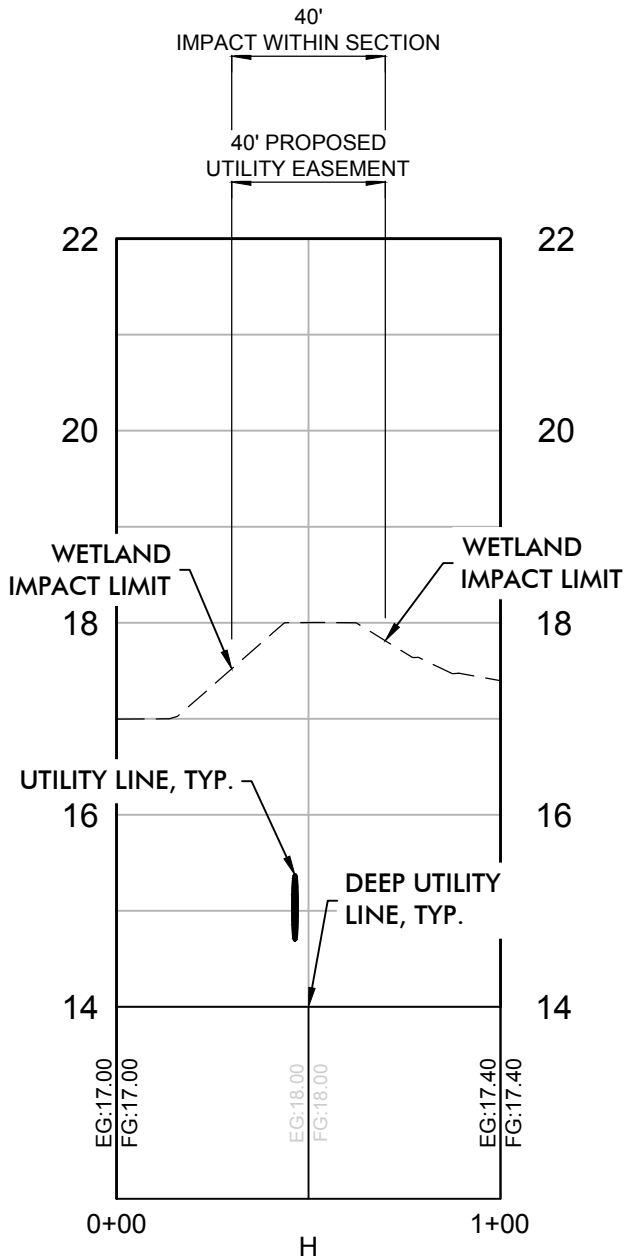

TEMPORARY WETLAND IMPACT TO JURISDICTIONAL WETLAND
 TOTAL IMPACT ACREAGE: 7,805 SF (0.18 AC.)

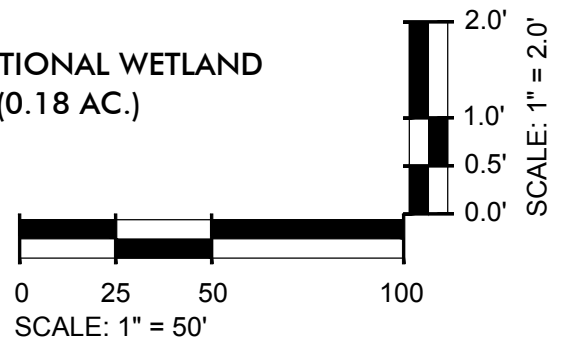

WETLAND CROSSING WIDTH VARIES
(SEE PLAN & CROSS SECTION)

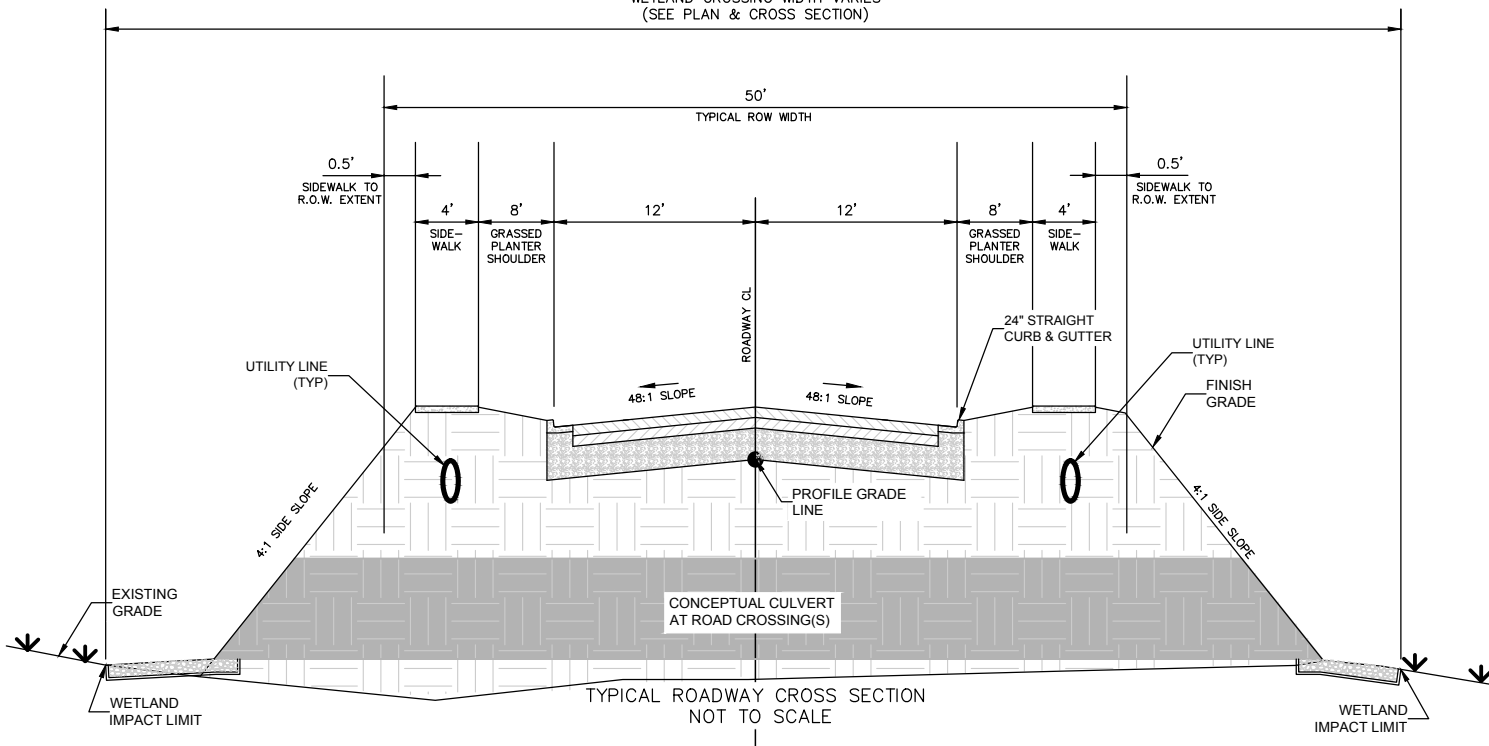

TYPICAL WETLAND ROAD CROSSING WITH CULVERT
(NOT TO SCALE)

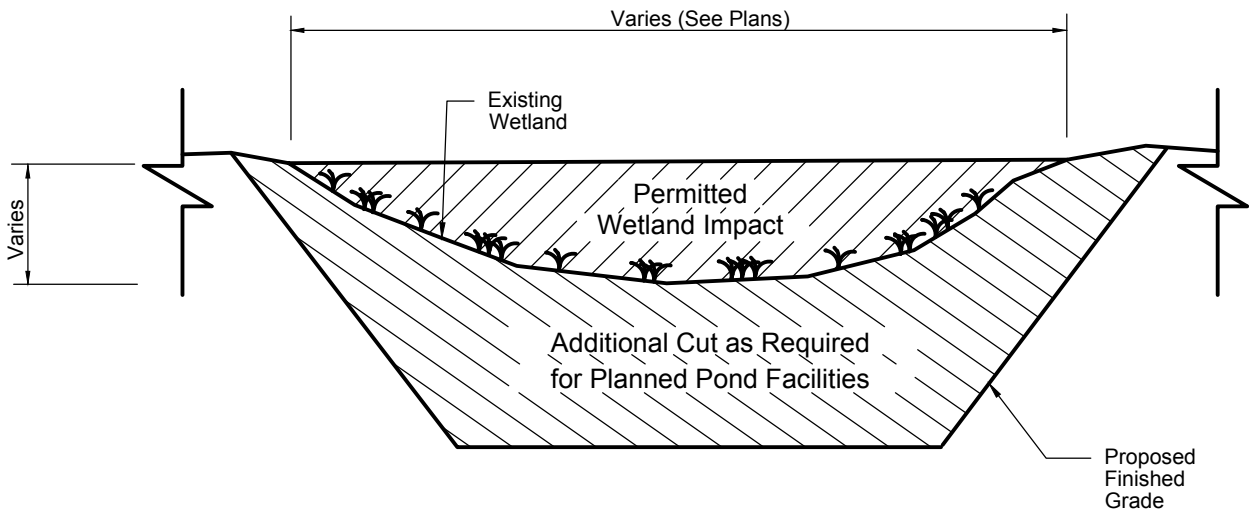

TYPICAL WETLAND CUT FOR STORMWATER POND
(NOT TO SCALE)

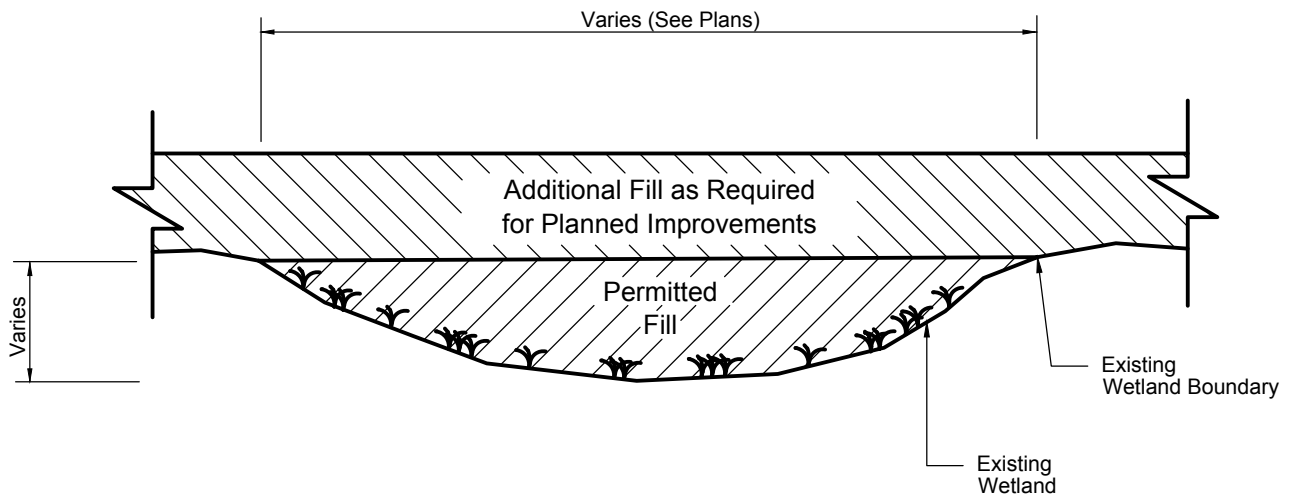

TYPICAL WETLAND FILL
(NOT TO SCALE)

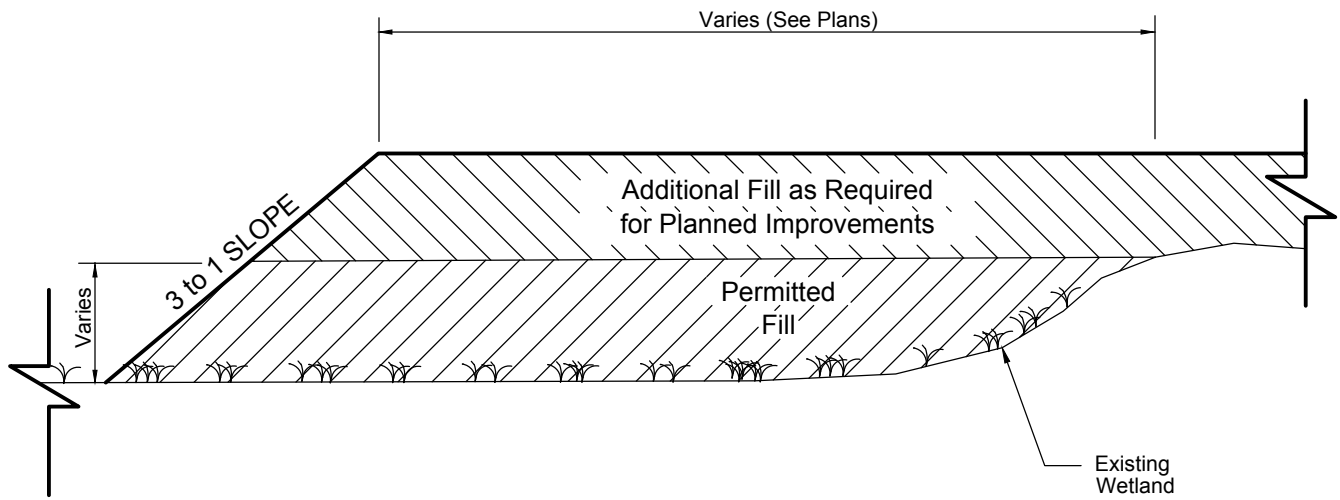

TYPICAL PARTIAL WETLAND FILL
(NOT TO SCALE)