

JOINT
PUBLIC NOTICE

CHARLESTON DISTRICT, CORPS OF ENGINEERS
69A Hagood Avenue
Charleston, South Carolina 29403
and
THE S.C. DEPARTMENT OF HEALTH AND ENVIRONMENTAL CONTROL
Office of Ocean and Coastal Resource Management
1362 McMillan Avenue, Suite 400
Charleston, South Carolina 29405

REGULATORY DIVISION
Refer to: P/N SAC-2017-01712

November 3, 2017

Pursuant to Section 10 of the Rivers and Harbors Act of 1899 (33 U.S.C. 403), Sections 401 and 404 of the Clean Water Act (33 U.S.C. 1344), and the South Carolina Coastal Zone Management Act (48-39-10 et.seq.), an application has been submitted to the Department of the Army and the S.C. Department of Health and Environmental Control by

MR. JAMES VAN NESS
SOUTH CAROLINA PORTS AUTHORITY
POST OFFICE BOX 22287
CHARLESTON, SOUTH CAROLINA 29413

for a permit to dredge and install structures in navigable waters of the U.S. in the

WANDO RIVER

at the existing Wando Welch Terminal (WWT) at 400 Longpoint Road in Mount Pleasant, Charleston County, South Carolina (Latitude: 32.83269 °N, Longitude: -79.89218 °W), Charleston and Fort Moultrie, South Carolina USGS Quadrangle maps.

In order to give all interested parties an opportunity to express their views

NOTICE

is hereby given that written statements regarding the proposed work will be received by the **Corps** until

15 Days from the Date of this Notice,

and **SCDHEC** will receive written statements regarding the proposed work until

30 Days from the Date of this Notice

from those interested in the activity and whose interests may be affected by the proposed work.

The proposed work consists of conducting new work and maintenance dredging to improve navigation access, installing a sheet pile toe wall to protect the adjacent shoreline, and installing new fender piles so barges can be safely loaded and unloaded at WWT. In detail, the applicant has proposed to dredge approximately 160,000 cubic yards of new work material in order to

deepen the existing berth at WWT from -52 feet Mean Low Water (MLW) to -58 feet Mean Lower Low Water (MLLW). The proposed depth is 2 feet deeper than the previously authorized Charleston Harbor navigation channel (-52 feet MLLW+ 2 feet of advanced maintenance + 2 feet of allowable overdepth). The 2 foot difference between the depth of the berth and the adjacent Wando Turning Basin is consistent with existing dredging practices in Charleston Harbor and is required to address extreme low tidal variation. In addition, approximately 90,000 cubic yards of maintenance material would be dredged each year to maintain the depth of the berth.

Department of the Army (DA) permit # SAC-2011-01147 authorizes the South Carolina Ports Authority to maintain the existing 4,000-foot long by 125-foot wide berth at WWT at a depth of -52 feet MLW through December 31, 2022. Deepening the existing berths at WWT and North Charleston Terminal, and deepening the berth and access channel at the Hugh K. Leatherman, Sr. Terminal were identified as cumulative impacts in the Charleston Harbor Post 45 Final Integrated Feasibility Report and Final Environmental Impact Statement dated June 2015 (Post 45). However, the SCPA is required to obtain the necessary DA permits prior to conducting any new work or maintenance dredging at their existing marine container terminals.

The proposed project includes new work dredging to deepen the berth at WWT and installing an approximately 4,000-foot long toe wall to protect the shoreline and the base of the existing pile supported wharf. As shown on drawing sheet 5 of 6, the proposed toe wall and 1,200 linear feet of new fender piles (three 400-foot sections) would be located below the existing fender panels and would not change the footprint of the existing wharf. However, the footprint of the existing 4,000-foot long berth would be widened from 125 feet to 160 feet in order to address the increase in the beam (width) of vessels that call on the Port of Charleston over the past 30 years. This change is primarily administrative because the additional acreage is part of the Wando Turning Basin and is maintained as part of Charleston Harbor.

The proposed new-work and maintenance dredging would be conducted using a cutterhead dredge and hydraulically pumped to an existing Dredged Material Containment Area (DMCA), or conducted using a mechanical dredge and placed in a scow before being transported and pumped into an existing DMCA (i.e., Clouter Island, Daniel Island, or Drum Island). The SCPA has not proposed to conduct compensatory mitigation for the modifications to the existing berth, the installation of the new toe wall, or the modifications to the existing fender system because the WWT site has been developed as a marine container terminal for more than 30 years. According to the applicant, the purpose of the proposed project is to deepen the berth to support larger vessels (e.g., Neo-Panamax) that have already begun to call on the Port of Charleston.

NOTE: This public notice and associated plans are available on the Corps' website at:
<http://www.sac.usace.army.mil/Missions/Regulatory/PublicNotices> .

The District Engineer has concluded that the discharges associated with this project, both direct and indirect, should be reviewed by the South Carolina Department of Health and Environmental Control in accordance with provisions of Section 401 of the Clean Water Act. As such, this notice constitutes a request, on behalf of the applicant, for certification that this project will comply with applicable effluent limitations and water quality standards. The work shown on this application must also be certified as consistent with applicable provisions of the Coastal Zone Management Program (15 CFR 930). State review, permitting and certification is conducted by the S. C. Department of Health and Environmental Control. The District Engineer will not process this application to a conclusion until such certifications are received. The applicant is hereby advised that supplemental information may be required by the State to facilitate the review.

This notice initiates the Essential Fish Habitat (EFH) consultation requirements of the Magnuson-Stevens Fishery Conservation and Management Act. Implementation of the proposed project would impact approximately 14.69 acres of estuarine substrates and emergent wetlands utilized by various life stages of species comprising the shrimp, and snapper-grouper management complexes. The District Engineer's initial determination is that the proposed action would not have a substantial individual or cumulative adverse impact on EFH or fisheries managed by the South Atlantic Fishery Management Council and the National Marine Fisheries Service (NMFS). The District Engineer's final determination relative to project impacts and the need for mitigation measures is subject to review by and coordination with the NMFS.

Pursuant to the Section 7 of the Endangered Species Act of 1973 (as amended), the Corps has reviewed the project area, examined all information provided by the applicant, and the District Engineer has determined, based on the most recently available information that the project may affect, but is not likely to adversely affect the Federally endangered Atlantic sturgeon (*Acipenser oxyrinchus*), shortnose sturgeon (*Acipenser brevirostrum*), or West Indian manatee (*Trichechus manatus*). A biological assessment (or other similar document) detailing our analysis of the potential effects of the action will be provided to the U.S. Fish and Wildlife Service and the National Marine Fisheries Service for their review.

Pursuant to Section 106 of the National Historic Preservation Act (NHPA), this public notice also constitutes a request to Indian Tribes to notify the District Engineer of any historic properties of religious and cultural significance to them that may be affected by the proposed undertaking.

In accordance with Section 106 of the NHPA, the District Engineer has consulted South Carolina ArchSite (GIS), for the presence or absence of historic properties (as defined in 36 C.F.R. 800.16)(f)(1)), and has initially determined that no historic properties are present; therefore, there will be no effect on historic properties. To ensure that other historic properties that the District Engineer is not aware of are not overlooked, this public notice also serves as a request to the State Historic Preservation Office and any other interested parties to provide any information they may have with regard to historic properties. This public notice serves as a request for concurrence within 30 days from the SHPO (and/or Tribal Historic Preservation Officer).

The District Engineer's final eligibility and effect determination will be based upon coordination with the SHPO and/or THPO, as appropriate and required and with full consideration given to the proposed undertaking's potential direct and indirect effects on historic properties within the Corps-identified permit area.

Any person may request, in writing, within the comment period specified in this notice, that a public hearing be held to consider this application. Requests for a public hearing shall state, with particularity, the reasons for holding a public hearing.

The decision whether to issue a permit will be based on an evaluation of the probable impact including cumulative impacts of the activity on the public interest and will include application of the guidelines promulgated by the Administrator, Environmental Protection Agency (EPA), under authority of Section 404(b) of the Clean Water Act. That decision will reflect the national concern for both protection and utilization of important resources. The benefit which reasonably may be expected to accrue from the project must be balanced against its reasonably foreseeable

detriments. All factors which may be relevant to the project will be considered including the cumulative effects thereof; among those are conservation, economics, aesthetics, general environmental concerns, wetlands, historic properties, fish and wildlife values, flood hazards, flood plain values, land use, navigation, shoreline erosion and accretion, recreation, water supply and conservation, water quality, energy needs, safety, food and fiber production and, in general, the needs and welfare of the people. A permit will be granted unless the District Engineer determines that it would be contrary to the public interest. In cases of conflicting property rights, the Corps cannot undertake to adjudicate rival claims.

The Corps is soliciting comments from the public; Federal, state, and local agencies and officials; Indian Tribes; and other interested parties in order to consider and evaluate the impacts of this activity. Any comments received will be considered by the Corps to determine whether to issue, modify, condition or deny a permit for this project. To make this decision, comments are used to assess impacts on endangered species, historic properties, water quality, general environmental effects, and the other public interest factors listed above. Comments are used in the preparation of an Environmental Assessment and/or an Environmental Impact Statement pursuant to the National Environmental Policy Act. Comments are also used to determine the need for a public hearing and to determine the overall public interest of the activity. **Please submit comments in writing, identifying the project of interest by public notice number, to the following address:**

**U.S. Army Corps of Engineers
ATTN: REGULATORY DIVISION
69A Hagood Avenue
Charleston, South Carolina 29403**

If there are any questions concerning this public notice, please contact Nat Ball, Project Manager, at (843) 329-8047 or toll free at 1-866-329-8187.

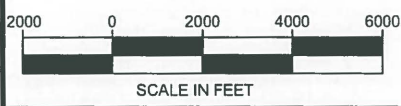
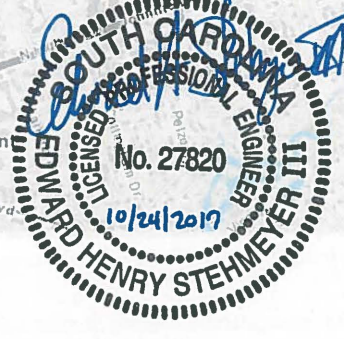
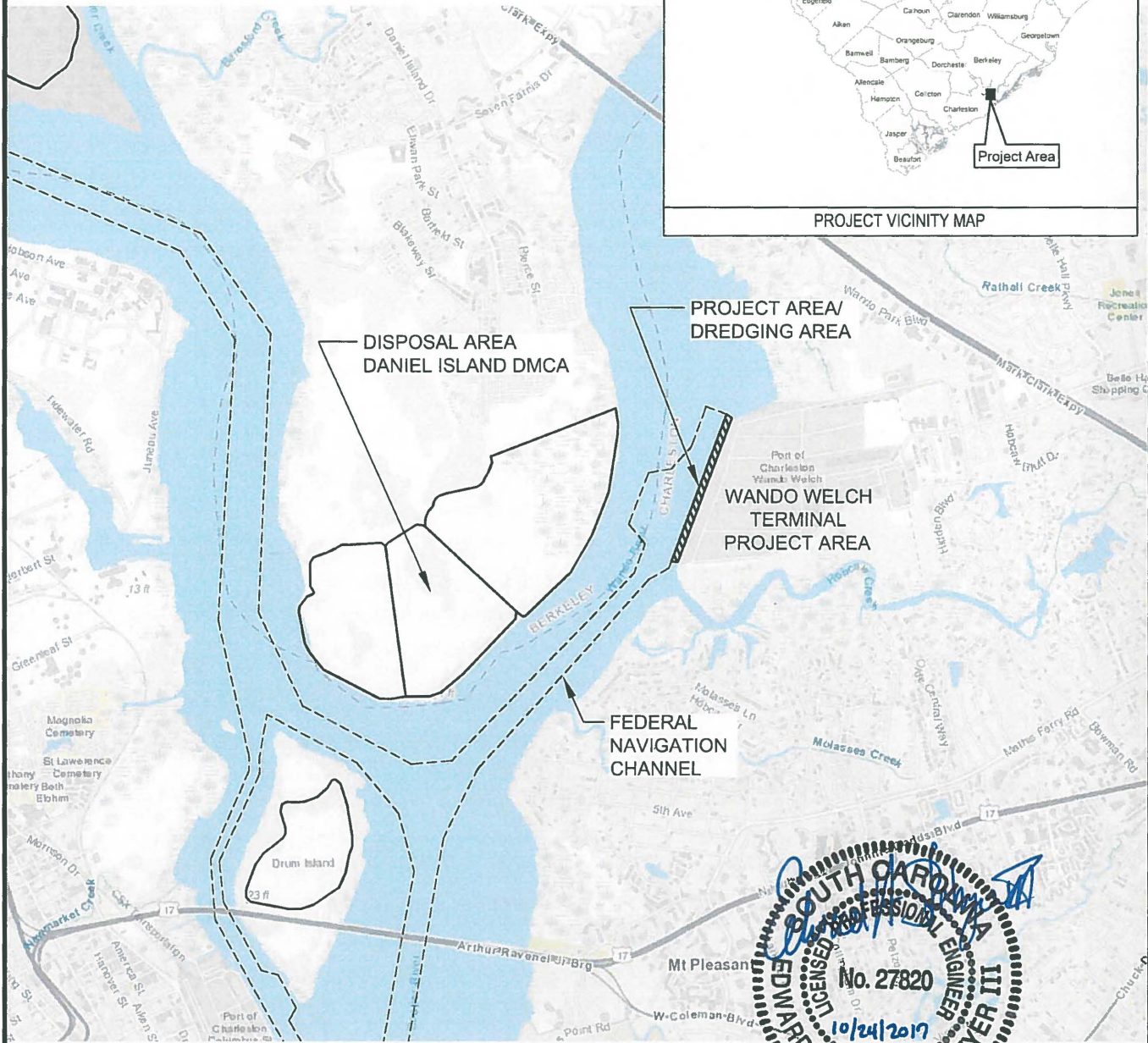
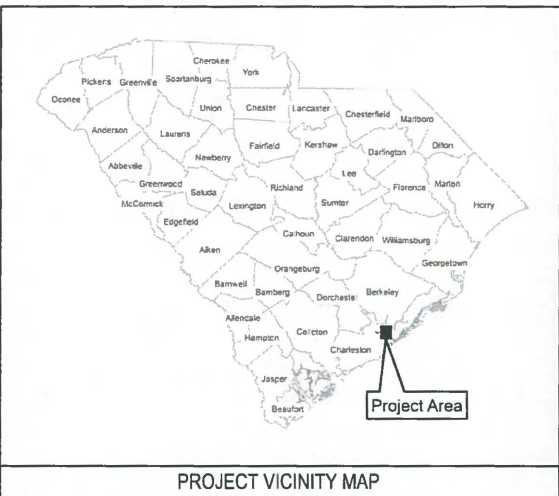

NOTES:
 1. DMCA - DREDGE MATERIAL CONTAINMENT AREA
 REFERENCE:
 • United States Geological Survey (USGS) topographic maps.
 Copyright. © 2011 National Geographic Society, Inc. cubed.

VERTICAL DATUM: MLLW (FEET)
 0 FEET (MLLW) = -3.18 FEET (NAVD88)
 COORDINATE SYSTEM: S.C. STATE PLANE
 (NAD83 in US FEET)

P/N # -

PROJECT LOCATION MAP
SOUTH CAROLINA PORTS AUTHORITY
 176 CONCORD STREET
 P.O. BOX 22287
 CHARLESTON, S.C. 29413-2287

PROPOSED: WANDO WELCH TERMINAL
 WHARF TOE WALL AND BERTH DEEPENING
 IN: MOUNT PLEASANT
 AT: CHARLESTON COUNTY, SOUTH CAROLINA
 APPLICATION BY: SC PORTS AUTHORITY
 SHEET: 1 OF 6 DATE: November, 2017

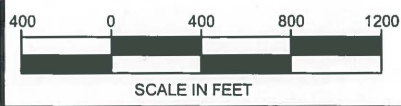
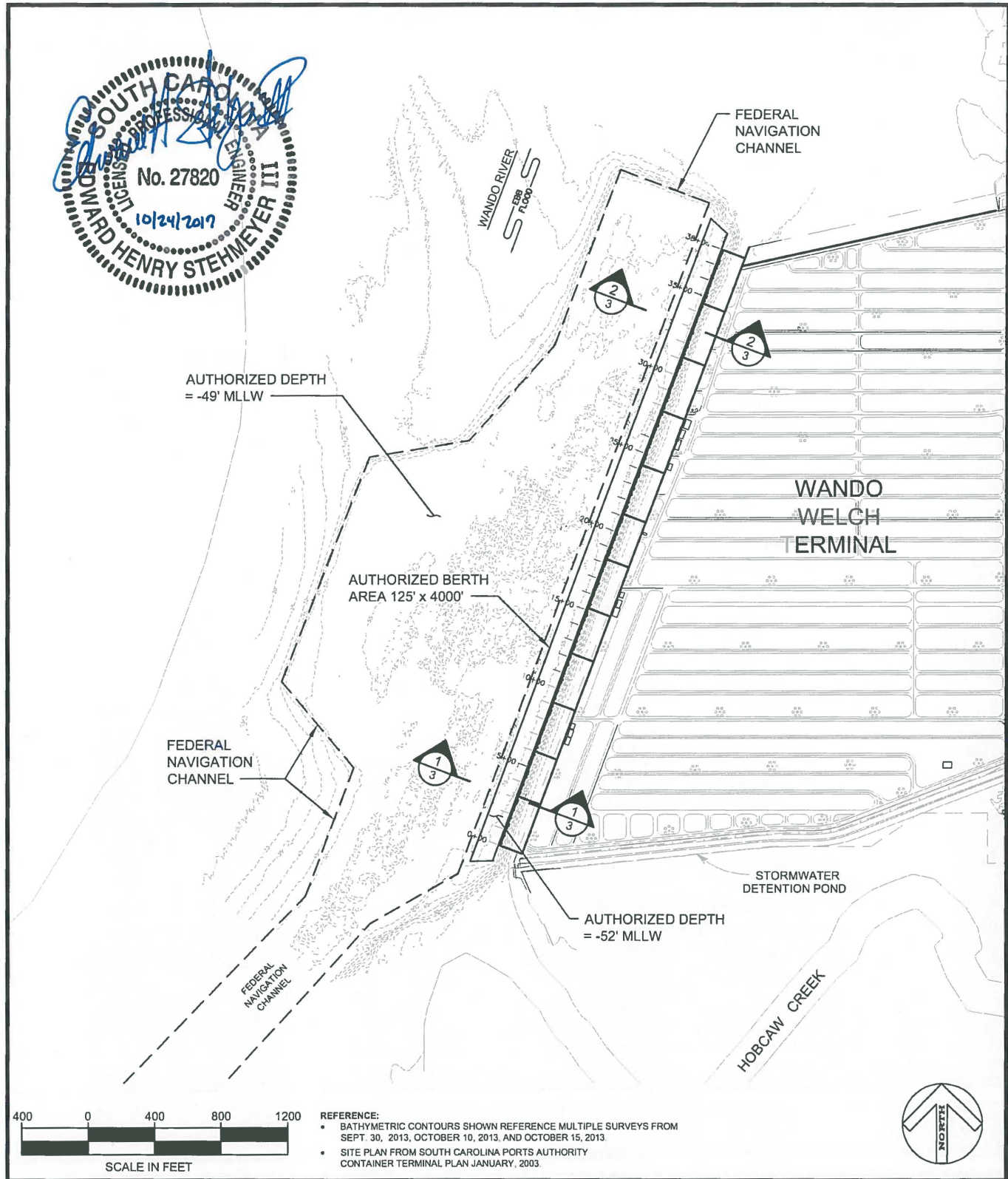
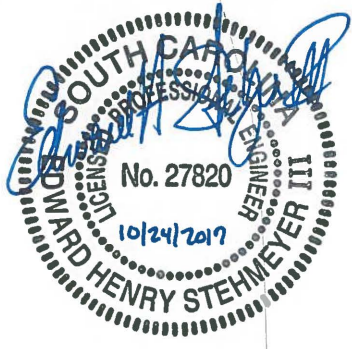

- REFERENCE:
- BATHYMETRIC CONTOURS SHOWN REFERENCE MULTIPLE SURVEYS FROM SEPT. 30, 2013, OCTOBER 10, 2013, AND OCTOBER 15, 2013
 - SITE PLAN FROM SOUTH CAROLINA PORTS AUTHORITY CONTAINER TERMINAL PLAN JANUARY, 2003.



VERTICAL DATUM: MLLW (FEET)
 0 FEET (MLLW) = -3.18 FEET (NAVD88)
COORDINATE SYSTEM: S.C. STATE PLANE
 (NAD83 in US FEET)

P/N # -

**EXISTING CONDITIONS
 PLAN VIEW**

SOUTH CAROLINA PORTS AUTHORITY
 176 CONCORD STREET
 P.O. BOX 22287
 CHARLESTON, S.C. 29413-2287

PROPOSED: WANDO WELCH TERMINAL
 WHARF TOE WALL AND BERTH DEEPENING

IN: MOUNT PLEASANT
 AT: CHARLESTON COUNTY, SOUTH CAROLINA
 APPLICATION BY: SC PORTS AUTHORITY
 SHEET: 2 OF 6 DATE: November, 2017

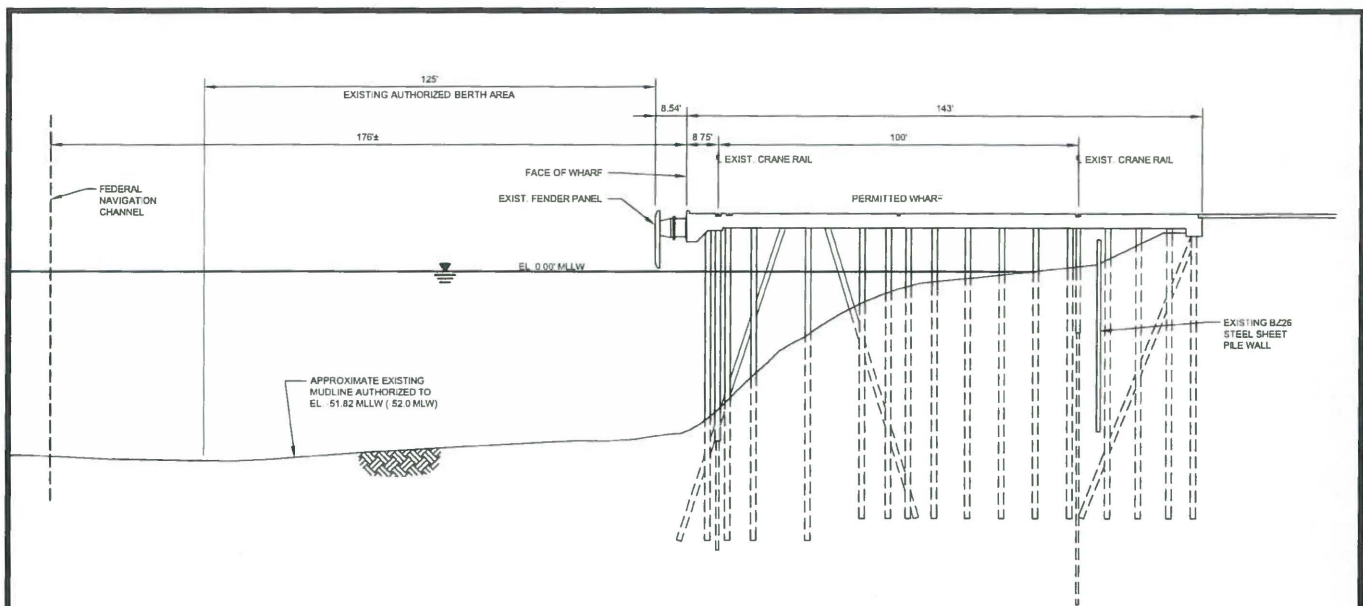

1
3 TYPICAL WHARF SECTION
STA. 0+00 TO 24+27

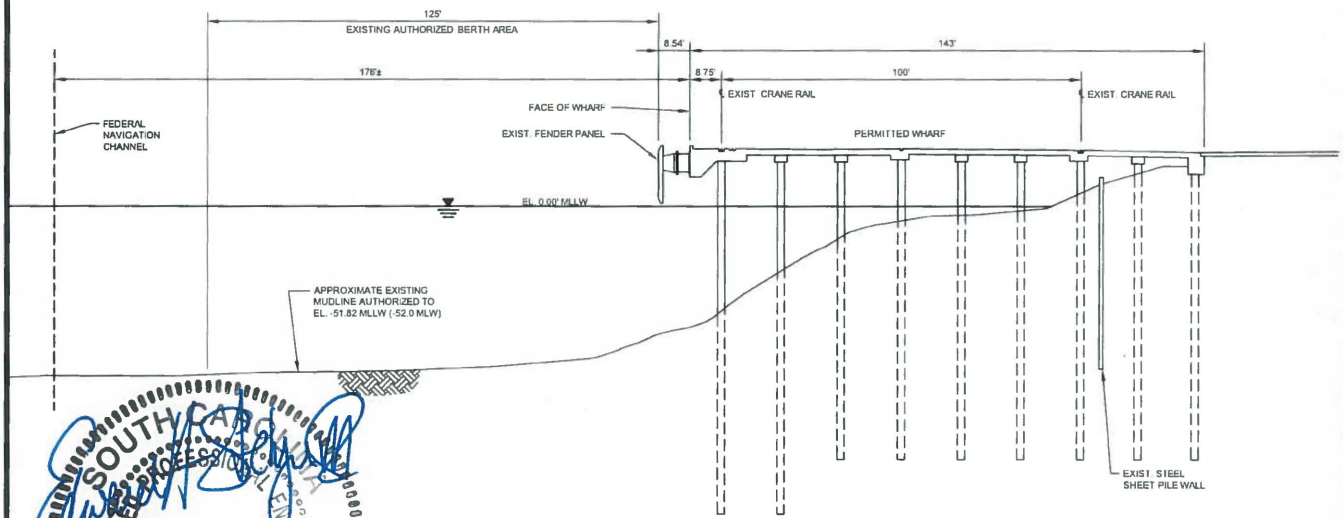

2
3 TYPICAL WHARF SECTION
STA. 24+27 TO 38+00

SOUTH CAROLINA
EDWARD HENRY STEHMEYER III
 LICENSED PROFESSIONAL ENGINEER
 No. 27820
 10/24/2017



VERTICAL DATUM: MLLW (FEET)
 0 FEET (MLLW) = -3.18 FEET (NAVD88)
COORDINATE SYSTEM: S.C. STATE PLANE
 (NAD83 in US FEET)

P/N # -

**EXISTING CONDITIONS
 PROFILE VIEW**
SOUTH CAROLINA PORTS AUTHORITY
 176 CONCORD STREET
 P.O. BOX 22287
 CHARLESTON, S.C. 29413-2287

PROPOSED: WANDO WELCH TERMINAL
 WHARF TOE WALL AND BERTH DEEPENING
IN: MOUNT PLEASANT
AT: CHARLESTON COUNTY, SOUTH CAROLINA
APPLICATION BY: SC PORTS AUTHORITY
SHEET: 3 OF 6 **DATE:** November, 2017

ADJACENT PROPERTIES

- ① TMS 514-00-00-050 REDFISH LAKE HOLDINGS, LLC.
- ② TMS 537-00-00-042 SOUTH CAROLINA PORTS, AUTHORITY

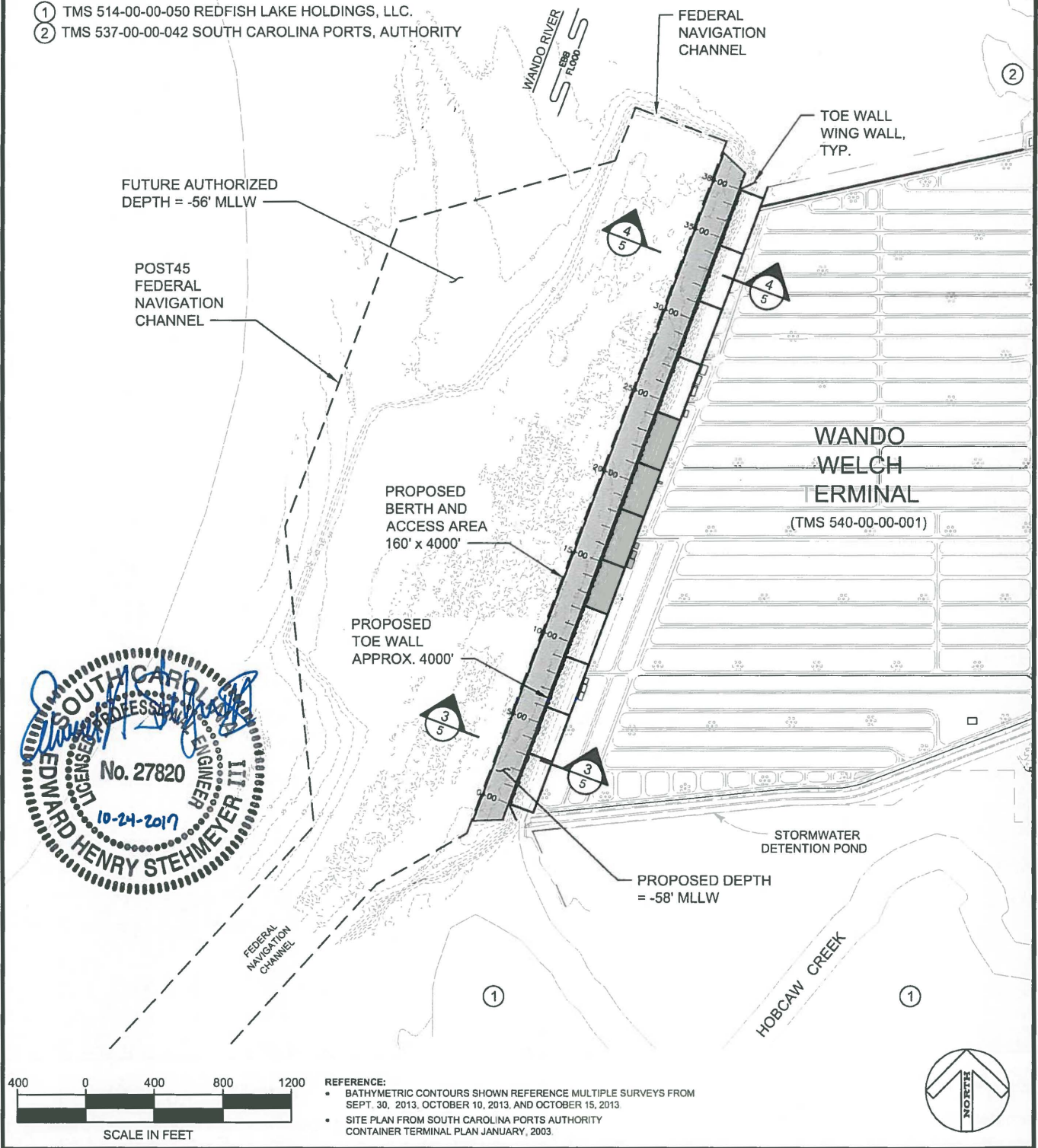

REFERENCE:

- BATHYMETRIC CONTOURS SHOWN REFERENCE MULTIPLE SURVEYS FROM SEPT. 30, 2013, OCTOBER 10, 2013, AND OCTOBER 15, 2013
- SITE PLAN FROM SOUTH CAROLINA PORTS AUTHORITY CONTAINER TERMINAL PLAN JANUARY, 2003.

VERTICAL DATUM: MLLW (FEET)
 0 FEET (MLLW) = -3.18 FEET (NAVD88)
COORDINATE SYSTEM: S.C. STATE PLANE
 (NAD83 in US FEET)

**PROPOSED CONDITIONS
 PLAN VIEW**
SOUTH CAROLINA PORTS AUTHORITY
 176 CONCORD STREET
 P.O. BOX 22287
 CHARLESTON, S.C. 29413-2287

PROPOSED: WANDO WELCH TERMINAL
 WHARF TOE WALL AND BERTH DEEPENING
IN: MOUNT PLEASANT
AT: CHARLESTON COUNTY, SOUTH CAROLINA
APPLICATION BY: SC PORTS AUTHORITY
SHEET: 4 OF 6 **DATE:** November, 2017

P/N # -

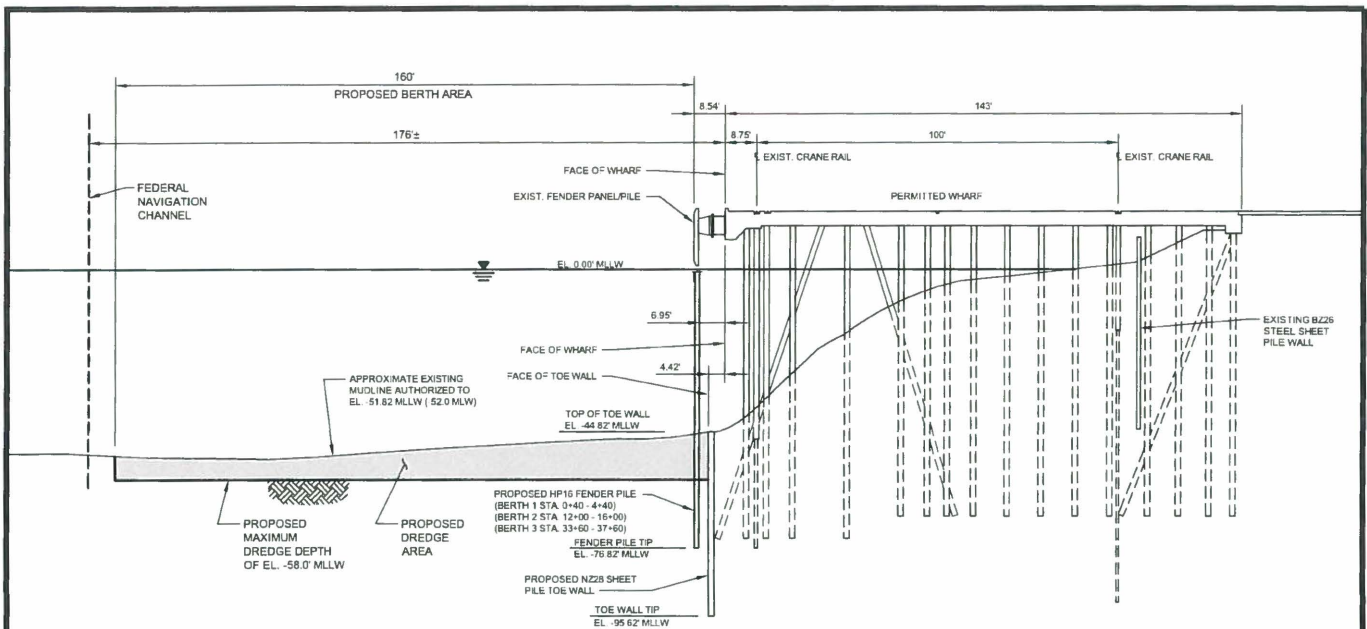

3
5 TYPICAL WHARF SECTION
STA. 0+00 TO 24+27

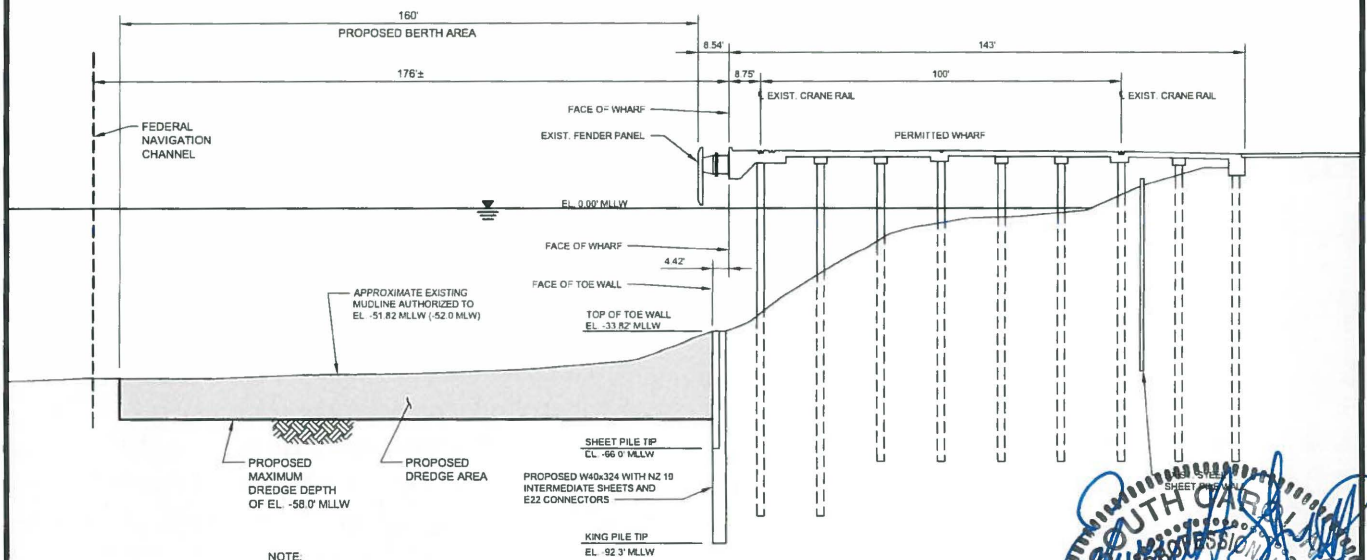

4
5 TYPICAL WHARF SECTION
STA. 24+27 TO 38+00

NOTE:
APPROXIMATE DREDGE VOLUME FOR
PROPOSED DREDGE AREA = 160,000 yd³

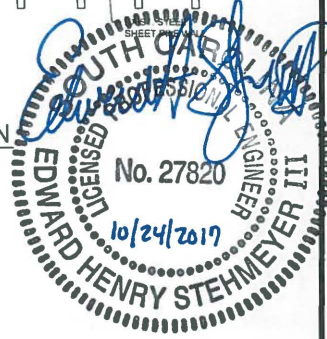

VERTICAL DATUM: MLLW (FEET)
0 FEET (MLLW) = -3.18 FEET (NAVD88)
COORDINATE SYSTEM: S.C. STATE PLANE
(NAD83 in US FEET)

P/N # -

**PROPOSED CONDITIONS
PROFILE VIEW**
SOUTH CAROLINA PORTS AUTHORITY
176 CONCORD STREET
P.O. BOX 22287
CHARLESTON, S.C. 29413-2287

PROPOSED: WANDO WELCH TERMINAL
WHARF TOE WALL AND BERTH DEEPENING
IN: MOUNT PLEASANT
AT: CHARLESTON COUNTY, SOUTH CAROLINA
APPLICATION BY: SC PORTS AUTHORITY
SHEET: 5 OF 6 **DATE:** November, 2017

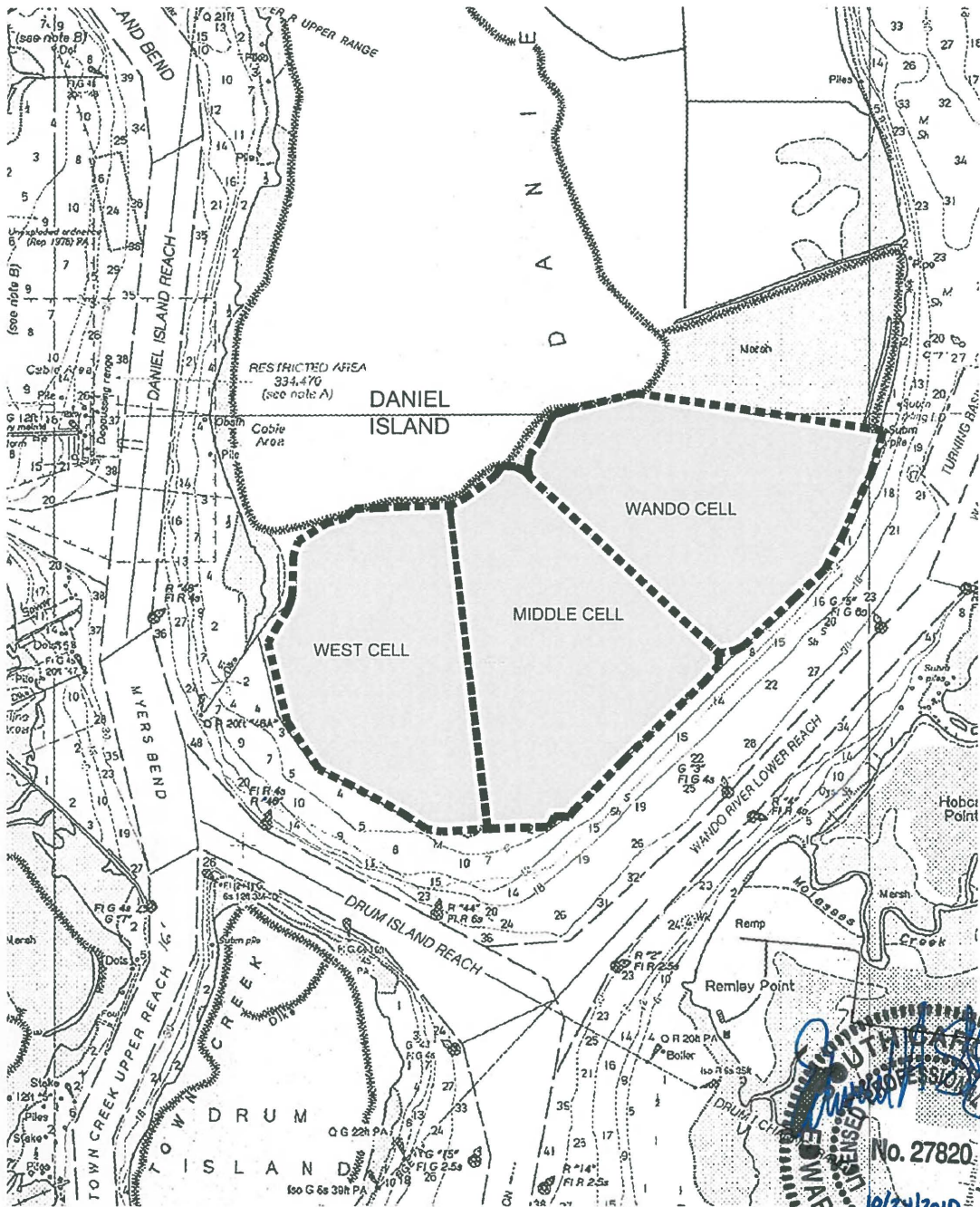

VERTICAL DATUM: MLLW (FEET)
 0 FEET (MLLW) = -3.18 FEET (NAVD88)
 COORDINATE SYSTEM: S.C. STATE PLANE
 (NAD83 in US FEET)

P/N # -

DISPOSAL SITE
SOUTH CAROLINA PORTS AUTHORITY
 176 CONCORD STREET
 P.O. BOX 22287
 CHARLESTON, S.C. 29413-2287

PROPOSED: WANDO WELCH TERMINAL
 WHARF TOE WALL AND BERTH DEEPENING
 IN: MOUNT PLEASANT
 AT: CHARLESTON COUNTY, SOUTH CAROLINA
 APPLICATION BY: SC PORTS AUTHORITY
 SHEET: 6 OF 6 DATE: November, 2017