

**PUBLIC NOTICE**

**CHARLESTON DISTRICT, CORPS OF ENGINEERS  
1949 INDUSTRIAL PARK ROAD, ROOM 140  
CONWAY, SOUTH CAROLINA 29526**

REGULATORY DIVISION

Refer to: P/N SAC-2004-02988

November 19, 2021

Pursuant to Section 10 of the Rivers and Harbors Act of 1899 (33 U.S.C. 403) and Section 404 of the Clean Water Act (33 U.S.C. 1344) an application has been submitted to the Department of the Army by

**City of North Myrtle Beach  
c/o Dr. H. Wayne Beam  
Beam & Associates  
P.O. Box 3238  
North Myrtle Beach, SC 29582**

for a permit to perform maintenance dredging within

**House Creek/Minor Channel and Cherry Grove Canals**

at a location extending from 39<sup>th</sup> Avenue North through 62<sup>nd</sup> Avenue North within portions of House Creek and the Cherry Grove Canals in the Cherry Grove Section of North Myrtle Beach, Horry County, South Carolina (Latitude: 33.8401 °, Longitude: -78.6144 °), Little River Quad.

In order to give all interested parties an opportunity to express their views

**NOTICE**

is hereby given that written statements regarding the proposed work will be received by the **Corps** until

**15 Days from the Date of this Notice,**

from those interested in the activity and whose interests may be affected by the proposed work.

The proposed work consists of conducting maintenance dredging in portions of House Creek/Minor Channel extending from 39<sup>th</sup> Avenue North to 46<sup>th</sup> Avenue North, and Cherry Groves Canal extending from 42<sup>nd</sup> Avenue North through 62<sup>nd</sup> Avenue North. In detail, the project involves dredging approximately 180,000 cubic yards (CY) of material from approximately 24 acres of the existing Cherry Grove man-made canals and portions of House Creek/Minor Channel. Dredged material will be removed by hydraulic dredge

and pumped to the Horry County-owned spoil basin (CDF320; Tidewater Disposal Basin) located north of Little River Neck Road near Tidewater Plantation on the Atlantic Intracoastal Waterway (AIWW). House Creek/Minor Channel will be dredged to a 34 feet wide dredge path and to a minimum depth of -3.0 feet (ft) Mean Low Water (MLW) with a -1-ft allowable overdepth. Access Canals (Cherry Grove Canals) will be generally dredged to a 24 ft wide dredge path (with a few variations to provide improved access and better flushing) to minimum depth of -3 ft MLW for approximately two-thirds of their length and -2.5 ft MLW with an allowable overdepth of -1 MLW for the remaining one-third length in order to avoid creating a pocket for stagnant and allow proper flushing. Dredged slide slopes will be 4(h):1(v) except in close proximity to marsh vegetation where the dredge cut will be vertical. An additional 1-ft depth for advanced maintenance dredging is also proposed throughout the project limits; resulting in max project depths of -3.0-ft MLW + 1-ft + 1-ft = -5.0ft MLW and -2.5-ft MLW + 1-ft + 1-ft MLW = -4.5ft MLW, for locations noted above. The applicant offered no compensatory mitigation for impacts associated with the proposed project. The project purpose, as stated by the applicant, is to provide sufficient water depths in the canals to provide local property owners and the general public recreational boating access to navigable coastal waters.

**NOTE: This public notice and associated plans are available on the Corps' website at: <http://www.sac.usace.army.mil/Missions/Regulatory/PublicNotices> .**

Prior to the issuance of this notice, the District Engineer coordinated the project with the South Carolina Department of Health and Environmental Control and has concluded that the discharges associated with this project do not require review by their office in accordance with provisions of Section 401 of the Clean Water Act or Coastal Zone Management Program (15 CFR 930). The following information was provided by the South Carolina Department of Health and Environmental Control regarding the activities described in this notice: In accordance with the South Carolina Coastal Tidelands and Wetlands Act (Section 48-39-10 et. seq) "Dredging in existing navigational canal community developments by individuals, counties, or municipalities of manmade, predominately armored, recreational use canals and essential access canals conveyed to the State or dedicated to the public for that purpose between 1965 and the effective date of this act if the maintenance dredging is authorized by a permit from the United States Army Corps of Engineers pursuant to the Federal Clean Water Act, as amended, or the Rivers and Harbors Act of 1899. All other department administered certifications for such dredging are deemed waived."

This notice initiates the Essential Fish Habitat (EFH) consultation requirements of the Magnuson-Stevens Fishery Conservation and Management Act. Implementation of the proposed project would impact 24 acres of estuarine substrates and emergent wetlands utilized by various life stages of species comprising the shrimp, and snapper-grouper management complexes. The District Engineer's initial determination is that the proposed action would not have a substantial individual or cumulative adverse impact on EFH or fisheries managed by the South Atlantic Fishery Management Council and the National Marine Fisheries Service (NMFS). The District Engineer's final determination relative to project impacts and the need for mitigation measures is subject

to review by and coordination with the NMFS.

Pursuant to the Section 7 of the Endangered Species Act of 1973 (as amended), the Corps has reviewed the project area, examined all information provided by the applicant, and the District Engineer has determined, based on the most recently available information, that West Indian Manatee (*Trichechus manatus*), Atlantic sturgeon (*Acipenser oxyrinchus oxyrinchus*), and Shortnose Sturgeon (*Acipenser brevirostrum*) have the potential to occur within the vicinity of the project area. However, it has been determined that the project will have no effect on Shortnose Sturgeon (*Acipenser brevirostrum*) and Atlantic sturgeon (*Acipenser oxyrinchus oxyrinchus*) and will not result in the destruction or adverse modification of their designated or proposed critical habitat. Additionally, the District Engineer has determined that the project is not likely to adversely affect the West Indian Manatee (*Trichechus manatus*) or result in the destruction or adverse modification of designated or proposed critical habitat. This public notice serves as a request for written concurrence from the U.S. Fish and Wildlife Service and/or the National Marine Fisheries Service on this determination.

Pursuant to Section 106 of the National Historic Preservation Act (NHPA), this public notice also constitutes a request to Indian Tribes to notify the District Engineer of any historic properties of religious and cultural significance to them that may be affected by the proposed undertaking.

In accordance with Section 106 of the NHPA, the District Engineer has consulted South Carolina ArchSite (GIS), for the presence or absence of historic properties (as defined in 36 C.F.R. 800.16)(1)(1)), and has initially determined that no historic properties are present; therefore, there will be no effect on historic properties. To ensure that other historic properties that the District Engineer is not aware of are not overlooked, this public notice also serves as a request to the State Historic Preservation Office and any other interested parties to provide any information they may have with regard to historic properties. This public notice serves as a request for concurrence within 30 days from the SHPO (and/or Tribal Historic Preservation Officer).

The District Engineer's final eligibility and effect determination will be based upon coordination with the SHPO and/or THPO, as appropriate and required and with full consideration given to the proposed undertaking's potential direct and indirect effects on historic properties within the Corps-identified permit area.

Any person may request, in writing, within the comment period specified in this notice, that a public hearing be held to consider this application. Requests for a public hearing shall state, with particularity, the reasons for holding a public hearing.

The decision whether to issue a permit will be based on an evaluation of the probable impact including cumulative impacts of the activity on the public interest and will include application of the guidelines promulgated by the Administrator, Environmental Protection Agency (EPA), under authority of Section 404(b) of the Clean Water Act and, as appropriate, the criteria established under authority of Section 102 of the Marine

Protection, Research and Sanctuaries Act of 1972, as amended. That decision will reflect the national concern for both protection and utilization of important resources. The benefit which reasonably may be expected to accrue from the project must be balanced against its reasonably foreseeable detriments. All factors which may be relevant to the project will be considered including the cumulative effects thereof; among those are conservation, economics, aesthetics, general environmental concerns, wetlands, historic properties, fish and wildlife values, flood hazards, flood plain values, land use, navigation, shoreline erosion and accretion, recreation, water supply and conservation, water quality, energy needs, safety, food and fiber production and, in general, the needs and welfare of the people. A permit will be granted unless the District Engineer determines that it would be contrary to the public interest. In cases of conflicting property rights, the Corps cannot undertake to adjudicate rival claims.

The Corps is soliciting comments from the public; Federal, state, and local agencies and officials; Indian Tribes; and other interested parties in order to consider and evaluate the impacts of this activity. Any comments received will be considered by the Corps to determine whether to issue, modify, condition or deny a permit for this project. To make this decision, comments are used to assess impacts on endangered species, historic properties, water quality, general environmental effects, and the other public interest factors listed above. Comments are used in the preparation of an Environmental Assessment and/or an Environmental Impact Statement pursuant to the National Environmental Policy Act. Comments are also used to determine the need for a public hearing and to determine the overall public interest of the activity. **Please submit comments in writing, identifying the project of interest by public notice number, to the following address:**

**U.S. Army Corps of Engineers  
ATTN: REGULATORY DIVISION  
1949 INDUSTRIAL PARK ROAD, ROOM 140  
CONWAY, SOUTH CAROLINA 29526**

If there are any questions concerning this public notice, please contact Rob Huff, Team Lead, at (843) 365-4316, or by email at [Robert.C.Huff@usace.army.mil](mailto:Robert.C.Huff@usace.army.mil).

# CHERRY GROVE BEACH CANAL DREDGING PERMIT 2021 FOR CITY OF NORTH MYRTLE BEACH

LOCATED IN: Horry County, SC  
ISSUE DATE: OCTOBER 29, 2021

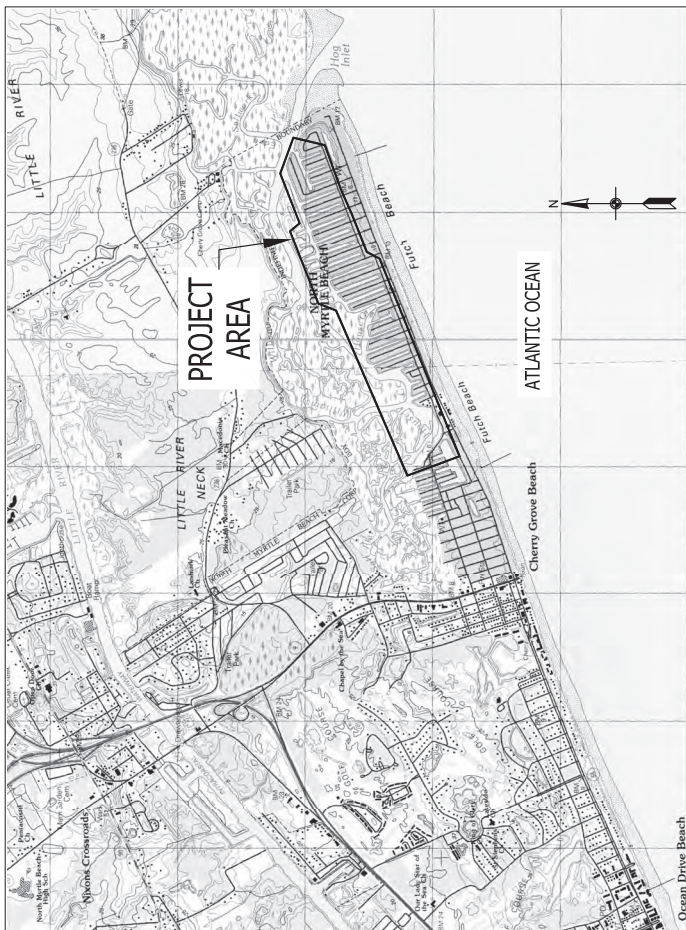

USGA QUAD MAP / LOCATION MAP  
GRAPHIC SCALE 1" = 1,000'

## PERMIT DRAWING INDEX

USGS QUAD SHEET / LOCATION MAP & COVER SHEET	P-1
PROPOSED OVERALL PROJECT AREA & KEY SHEET	P-2
ENLARGED VIEW #1	P-3
ENLARGED VIEW #2	P-4
ENLARGED VIEW #3	P-5
ENLARGED VIEW #4	P-6
ENLARGED VIEW #5	P-7
ENLARGED VIEW #6	P-8
ENLARGED VIEW #7	P-9
ENLARGED VIEW #8	P-10
TYPICAL CROSS-SECTION VIEWS FOR ACCESS CANALS & MINOR CHANNEL	P-11
PROPOSED DREDGE PIPELINE ROUTE & DISPOSAL BASIN	P-12
PROPOSED DISPOSAL BASIN LAYOUT PLAN (TIDENWATER BASIN; CDF 320)	P-13

**SAC-2004-02988**  
**Cherry Grove Canal 2021 Maintenance Dredge**  
**Horry County, SC**  
**Sheet 1 of 13**  
**Date: October 19, 2021**

**PROPOSED ACTIVITY:** The project involves maintenance dredging of up to approximately 180,000 cubic yards (CY) of material from approximately 24 acres of the existing man-made canals in Cherry Grove. Dredged material will be removed by hydraulic dredge and pumped to the Horry County-owned spot basin (CDF 320; Tidewater Disposal Basin) near Tidewater Plantation on the Atlantic Intracoastal Waterway. Minor Channel to be dredged 34 feet wide, dredge path and to a minimum required depth of -3.0 ft. MLW, with 1:4 allowable overdepth. Access Canals will be generally dredged 24 feet wide, dredge path, with a few variations to provide improved access and flushing, to a minimum required depth of -3.0 ft. MLW for approx. 23% of their length and -2.5 ft. MLW for the remaining 13% of their length in order to avoid creating a pocket for stagnant water, with 1:4 allowable overdepth. Dredged side slopes will be 40% (V):(H), except in close proximity to marsh vegetation where dredge cut will be vertical. An additional 1-ft. depth for advanced maintenance dredging is also proposed throughout the project, resulting in max. project depths of -3.0 ft. MLW + 1' = -5.0-ft. MLW and -2.5-ft. MLW + 1' = -4.5-ft. MLW, for locations noted above.

**PROJECT NAME:** Cherry Grove Beach Canal Dredging Permit 2021  
**PROJECT LOCATION:** North Myrtle Beach (Cherry Grove Canals)  
**ADJACENT WATERBODY:** House Creek -6- Hog Inlet  
**COUNTY:** Horry **STATE:** South Carolina



**APPLICANT:**  
City of North Myrtle Beach  
1018 Second Avenue South  
North Myrtle Beach, SC 29582  
Contact: Mike Mahoney; City Manager  
mmahoney@cmh.us (email)  
(843) 280-5555 (phone)



**AGENT:**  
H. Wayne Beam, P.E.  
Beam & Associates  
P. O. Box 3238  
North Myrtle Beach, SC 29582  
w.beam@att.net (email)  
(843) 814-7145 (cell)

**SHEET:** P-1 of 13  
**DATE:** October 29, 2021  
**REV. DATE 01:**  
**REV. DATE 02:**  
**SCALE:** AS SHOWN  
**FILE:**  
CHERRY GROVE 2021 P-1.dwg

FOR PERMITTING PURPOSES ONLY - DO NOT USE FOR CONSTRUCTION

- SURVEY NOTES:**
1. HYDROGRAPHIC SURVEY DATA COLLECTED BY GSI ENGINEERS, LLC, LOCATED IN CHARLESTON, SC. PHONE: (843) 769-3738. HYDROGRAPHIC SURVEY FIELD DATA COLLECTED ON THE FOLLOWING DATES: 10-29-2018, 10-30-2018, 10-31-2018, 11-02-2018, & 11-03-2018.
  2. SOUNDINGS WERE TAKEN BY SONARLOGIC.COM, OBTAINING HIGH FREQUENCY SOUNDINGS AND ARE EXPRESSED IN FEET AND TENTHS BELOW MLLW.
  3. PROPOSED DREDGE DEPTHS: MIN. REQUIRED -3.0' & -2.5' M.L.W. WITH 1-F.T. ALLOWABLE OVERDEPTH (1.0' & -2.5' M.L.W.); WITH AN ADDITIONAL 1-F.T. OF ADVANCED MAINTENANCE DREDGING (1.0' & -4.5' M.L.W.).
  4. MEAN TIDAL RANGE = 4.7'.
  5. THE AREAS SHOWN ON THIS SURVEY ARE SUBJECT TO SLIDING. THE ACTUAL DEPTH FOLLOWING THE DATE OF THE SURVEY MAY BE LESS THAN THE DEPTHS SHOWN.
  6. HORIZONTAL COORDINATES SYSTEM: REFERENCE TO SOUTH CAROLINA STATE GRID (NAD 83).
7. ALL INFORMATION SHOWN OUTSIDE OF SURVEY AREA IS FOR INFORMATIONAL PURPOSES ONLY AND WAS PROVIDED TO GSI BY BEAM AND ASSOCIATES.
8. SOME DEPTHS HAVE BEEN OMITTED FOR CLARITY PURPOSES BASED UPON THE SCALE OF THE DRAWING. VOLUME CALCULATIONS UTILIZE ALL AVAILABLE DATA POINTS FROM SURVEY INFORMATION.
9. VERTICAL DATUM (MEAN LOW WATER (MLW)) WAS ESTABLISHED BY A TRIMBLE PPS SURVEY GRADE OPS ON THE SOUTH CAROLINA VRS NETWORK BASED ON NAVD 83 AND WAS CONVERTED USING NOAA VANTUM PROGRAM.
10. GEOGRAPHIC COORDINATES ARE BASED ON NAD 83 AND WERE ESTABLISHED BY TRIMBLE PPS SURVEY GRADE OPS ON THE SOUTH CAROLINA VRS NETWORK.
11. DUE TO MOVEMENT OF DOCKS BY TIDAL INFLUENCE, SOME DEPTHS MAY APPEAR ON DOCKS.
12. ALL INFORMATION SHOWN OUTSIDE OF THE SURVEY AREA IS FOR INFORMATIONAL PURPOSES ONLY.
13. NOTES REGARDING THE COLLECTION OF THE FIELD DATA CAN BE FOUND IN: FIELDBOOK-11-17.

PROJECT ORIGINALLY PERMITTED UNDER P/N: SAC 2004-02988-3I.  
PERMIT ISSUE DATE: JULY 11, 2013

**DREDGE PIPELINE NOTE:**  
DREDGE PIPELINE TO BE ROUTED ALONG THE MINOR & MAJOR CANALS (HOUSE CREEK) FROM THE PROPOSED DREDGING TO THE LOCATION WHERE THE DREDGE PIPES WILL BE ANCHORED OR OTHERWISE SECURED SO THAT IT IS PREVENTED FROM MOVING AND CAUSING DAMAGE TO THE OYSTER BEDS THROUGHOUT ITS ENTIRE LENGTH FOR THE DURATION OF THE PROJECT.

DREDGE PIPELINE ROUTE FROM CANAL DREDGE AREAS TO THE TREATMENT BASIN. REFER TO SHEET 10 OF 13 FOR DETAILED ROUTE OF DREDGE PIPELINE ROUTE.

ALL ELEVATIONS AND SOUNDINGS FOR THE PROJECT ARE REFERENCED TO MEAN LOW WATER (MLW) VERTICAL DATUM. SEE TIDE CHART ON THIS SHEET FOR DATUM RELATIONSHIPS.

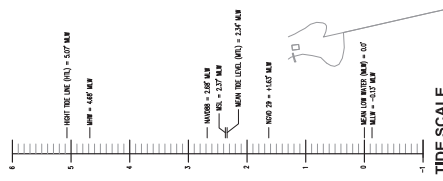

TIDE SCALE

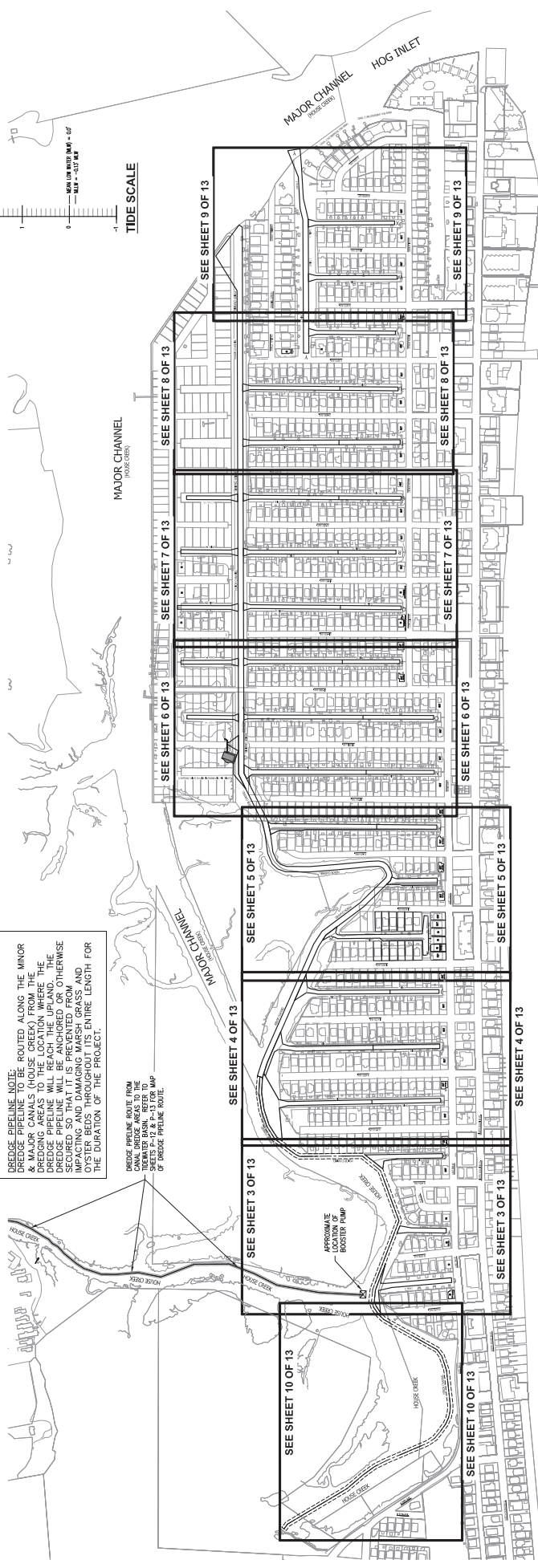

SAC-2004-02988  
Dredge  
Chery Grove Canal 2021 Maintenance  
Horry County, SC  
Sheet 2 of 13  
Date: October 19, 2021

OVERALL PLAN VIEW  
GRAPHIC SCALE: 1" = 300'

PROPOSED OVERALL DREDGING PROJECT AREA & KEY SHEET  
CHERY GROVE CANAL DREDGING

**PROPOSED ACTIVITY:** The project involves maintenance dredging of up to approximately 180,000 cubic yards (CY) of material from approximately 24 acres of the existing man-made canals in Chery Grove. Dredged material will be removed by hydraulic dredge and pumped to the Horry County-owned spoil basin (CDF-320). Tidewater Disposal Basin near Tidewater Plantation on the Atlantic Intracoastal Waterway. Minor Channel to be dredged 34 feet wide dredge path and to a minimum required depth of -3.0 ft. M.L.W. with 1-ft. allowable overdepth. Access Canals will be generally dredged 24 feet wide dredge path, with a few variations to provide improved access and flushing, to a minimum required depth of -3.0 ft. M.L.W. for approx. 2.3<sup>mi</sup> of their length and -2.5 ft. M.L.W. for the remaining 1.3<sup>mi</sup> of their length in order to avoid creating a pocket for stagnant water, with 1-ft. allowable overdepth. Dredged side slopes will be 4H:1(V), except in close proximity to marsh vegetation where dredge cut will be vertical. An additional 1-ft. depth for advanced maintenance dredging is also proposed throughout the project, resulting in max. project depths of -3.0 M.L.W + 1' + 1' = -5.0-ft. M.L.W. and -2.5-ft. M.L.W + 1' + 1' = -4.5-ft. M.L.W. for locations noted above.

**PROJECT NAME:** Chery Grove Beach Canal Dredging Permit, 2021  
**PROJECT LOCATION:** North Myrtle Beach (Chery Grove Canals)  
**ADJACENT WATERBODY:** House Creek -&- Hog Inlet  
**COUNTY:** Horry **STATE:** South Carolina



**APPLICANT:**  
City of North Myrtle Beach  
1018 Second Avenue South  
North Myrtle Beach, SC 29582  
Contact: Mike Mahoney; City Manager  
mmahoney@cityofnm.com (email)  
(843) 280-5555 (phone)



**AGENT:**  
H. Wayne Beam, P.E.  
Beam & Associates  
P. O. Box 3238  
North Myrtle Beach, SC 29582  
w.beam@beam.net (email)  
(843) 814-7145 (cell)

**SHEET:** P-2 of 13  
**DATE:** October 19, 2021  
**REV. DATE/ID:**  
**REV. DATE/ID:**  
**SCALE:** AS SHOWN  
**FILE:** CHERY GROVE 2021 P-08e

ALL DEPTHS ARE REFERENCED TO MEAN LOW WATER (MLW) VERTICAL DATUM.  
LATITUDES: 33° 52' 28.287" N  
LONGITUDES: -78° 36' 54.907" W

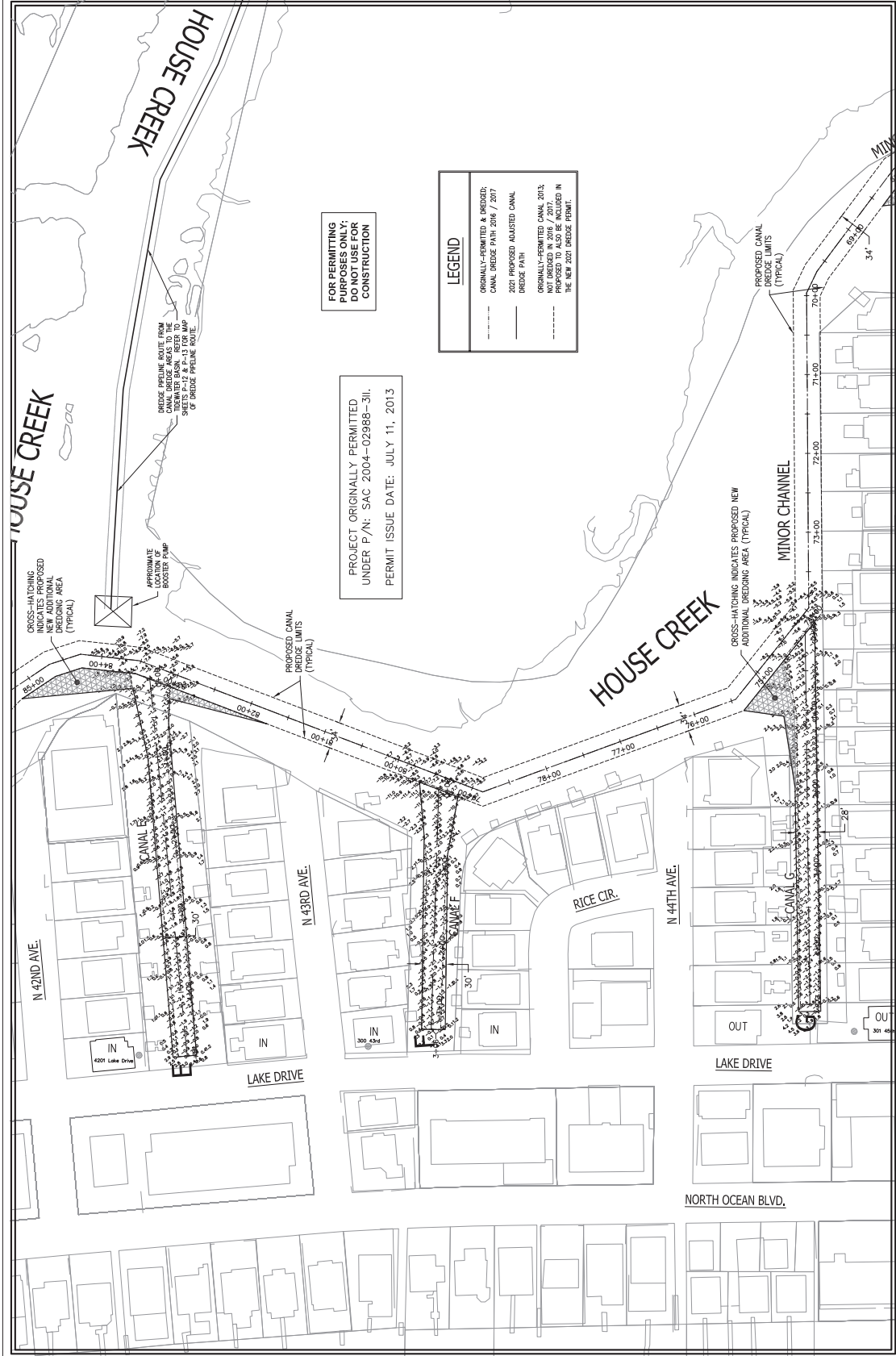

FOR PERMITTING PURPOSES ONLY; DO NOT USE FOR CONSTRUCTION

PROJECT ORIGINALLY PERMITTED UNDER P/N: SAC 2004-02988-3II. PERMIT ISSUE DATE: JULY 11, 2013.

LEGEND	
(Cross-hatched area)	ORIGINALLY PERMITTED & PROPOSED CANAL DREDGE PERMITS 2017
(Dashed line)	2021 PROPOSED ADJUSTED CANAL DREDGE PATH
(Solid line)	ORIGINALLY PERMITTED CANAL 2013; NOT DREDGED IN 2017 / 2018 / 2019 / 2020 / 2021. TO BE DREDGED IN THE NEW 2021 DREDGE PERMIT.

SAC-2004-02988  
 Cherry Grove Canal 2021 Maintenance Dredge  
 Horry County, SC  
 Sheet 3 of 13  
 Date: October 19, 2021



APPLICANT:  
 City of North Myrtle Beach  
 1018 Second Avenue South  
 North Myrtle Beach, SC 29582  
 Contact: Mike Mahaney; City Manager  
 mmahaney@nmb.us (email)  
 (843) 280-5555 (phone)

PROJECT NAME: Cherry Grove Beach Canal Dredging Permit, 2021  
 PROJECT LOCATION: North Myrtle Beach (Cherry Grove Canals)  
 ADJACENT WATERBODY: House Creek -&- Hog Inlet  
 COUNTY: Horry STATE: South Carolina

PROPOSED ACCESS CANAL / MINOR CHANNEL LAYOUTS FOR MAINTENANCE DREDGING

**PROPOSED ACTIVITY:** The project involves maintenance dredging of up to approximately 180,000 cubic yards (CY) of material from approximately 24 acres of the existing man-made canals in Cherry Grove. Dredged material will be removed by hydraulic dredge and pumped to the Horry County-owned spoil basin (CDF-320; Tidewater Disposal Basin) near Tidewater Plantation on the Atlantic Intracoastal Waterway. Minor Channel will be dredged 34 feet wide dredge path and to a minimum required depth of 3.0 ft. MLW, with 1:4 allowable overdepth. Access Canals will be generally dredged 24 feet wide dredge path, with a few variations to provide improved access and flushing, to a minimum required depth of 3.0 ft. MLW, for approx. 25% of their length and 2.5 ft. MLW for the remaining 75% of their length in order to avoid creating a pocket for stagnant water, with 1:4 allowable overdepth. Dredged side slopes will be 4H:1V, except in close proximity to marsh vegetation where dredge cut will be vertical. An additional 1:4 depth for advanced maintenance dredging is also proposed throughout the project, resulting in max. project depths of 3.0' MLW + 1' + 1' = -5.0'-ft. MLW and -2.5'-ft. MLW + 1' + 1' = -4.5'-ft. MLW, for locations noted above.

(ACCESS CANALS: E, F, & G, -and- Minor Channel- Station 85+00 through 88+50)

ENLARGED PLAN VIEW #1

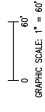

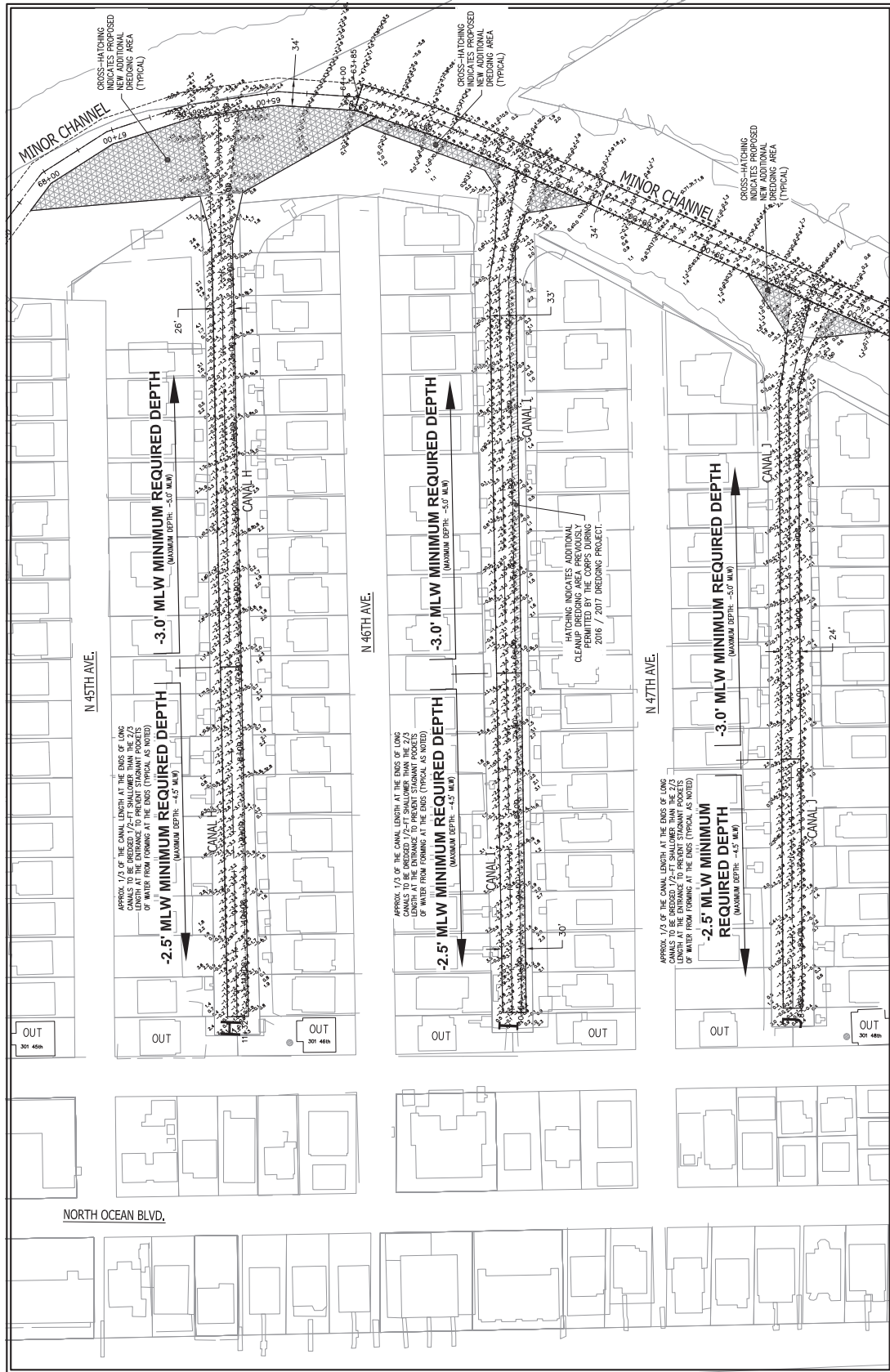

FOR PERMITTING PURPOSES ONLY; DO NOT USE FOR CONSTRUCTION

**LEGEND**

- ORIGINALY-PERMITTED & DREDGED CANAL UNDER PAH 2016 / 2017
- 2021 PROPOSED ADJUSTED CANAL
- DREDGE PATH
- ORIGINALY-PERMITTED CANAL 2016; NOT DREDGED IN 2016 / 2017; PROPOSED TO ALSO BE INCLUDED IN THE NEW 2021 DREDGE PERMIT.

PROJECT ORIGINALLY PERMITTED UNDER P/N: SAC 2004-02988-3R  
 PERMIT ISSUE DATE: JULY 11, 2013

ALL POINTS ARE REFERENCED TO NEW VERTICAL DATUM

LATITUDE: 33° 50' 26.820" N  
 LONGITUDE: 79° 36' 54.600" W

GRAPHIC SCALE: 1" = 60'

(ACCESS CANALS: H, I, & J) - and - Minor Channel - Station 68+50 through 57+00

**PROPOSED ACCESS CANAL / MINOR CHANNEL LAYOUTS FOR MAINTENANCE DREDGING**

**PROPOSED ACTIVITY:** The project involves maintenance dredging of up to approximately 180,000 cubic yards (CY) of material from approximately 24 acres of the existing man-made canals in Cherry Grove. Dredged material will be removed by hydraulic dredge and pumped to the Horry County-owned spoil basin (CDF-320; Tidewater Disposal Basin) near Tidewater Plantation on the Atlantic Intracoastal Waterway. Minor Channel to be dredged 34 feet wide dredge path and to a minimum required depth of 3.0 ft. MLW; with 1:4 allowable overdepth. Access Canals will be generally dredged 24 feet wide dredge path, with a few variations to provide improved access and flushing, to a minimum required depth of 3.0 ft. MLW for approx. 2.3% of their length and 2.5 ft. MLW for the remaining 1.3% of their length in order to avoid creating a pocket for stagnant water, with 1:4 allowable overdepth. Dredged side slopes will be 4H:1V, except in close proximity to marsh vegetation where dredge cut will be vertical. An additional 1-ft. depth for advanced maintenance dredging is also proposed throughout the project, resulting in max. project depths of 3.0' MLW + 1' + 1' = 5.0-ft. MLW and 2.5-ft. MLW + 1' + 1' = 4.5-ft. MLW for locations noted above.

**PROJECT NAME:** Cherry Grove Beach Canal Dredging Permit, 2021  
**PROJECT LOCATION:** North Myrtle Beach (Cherry Grove Canals)  
**ADJACENT WATERBODY:** House Creek -&- Hog Inlet  
**COUNTY:** Horry **STATE:** South Carolina



**APPLICANT:**  
 City of North Myrtle Beach  
 1018 Second Avenue South  
 North Myrtle Beach, SC 29582  
 Contact: Mike Mahaney; City Manager  
 mmahaney@citymb.us (email)  
 (843) 280-5555 (phone)

**SAC-2004-02988**  
**Dredge**  
**Cherry Grove Canal 2021 Maintenance**  
**Horry County, SC**  
**Sheet 4 of 13**  
**Date: October 19, 2021**



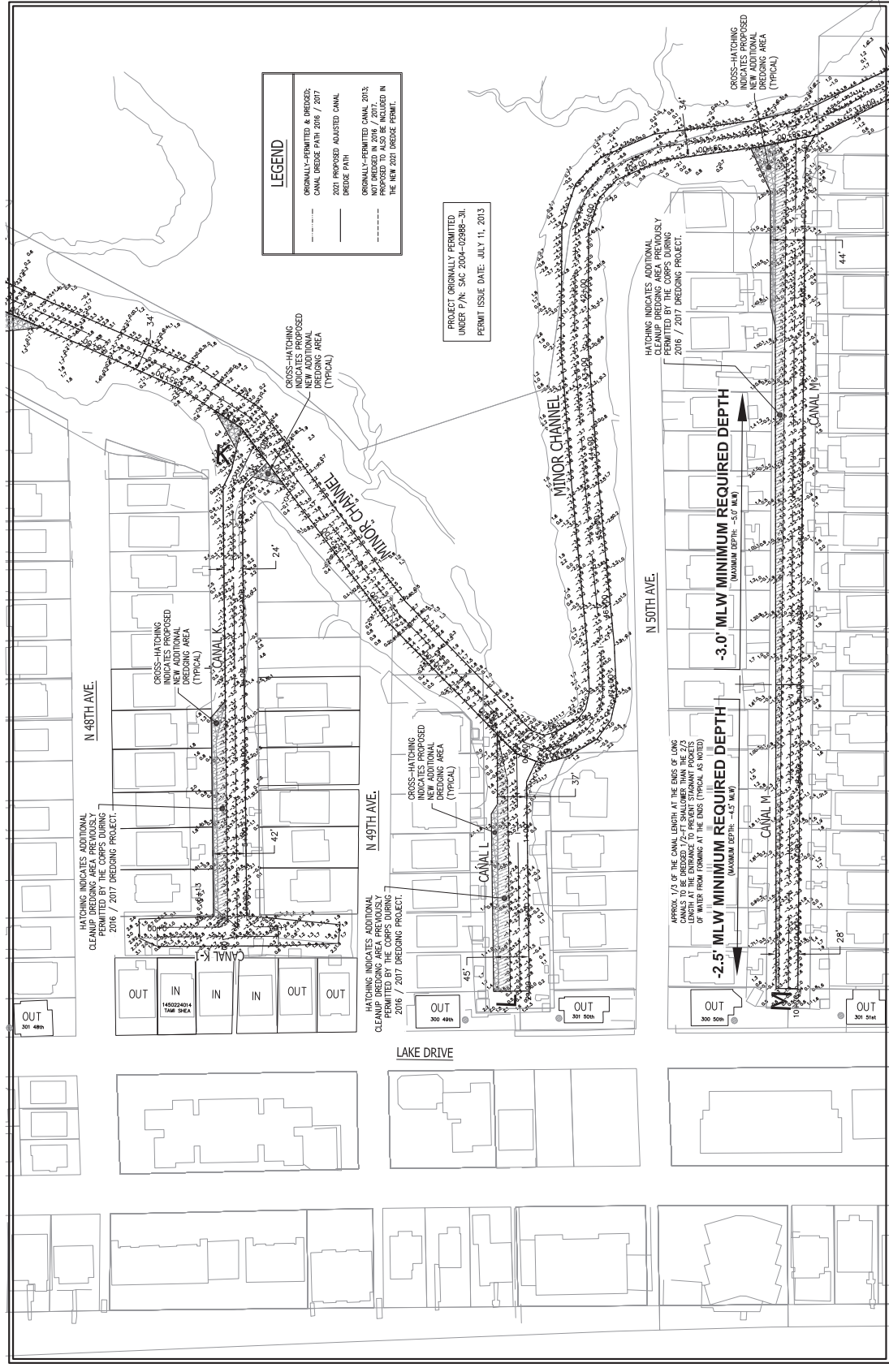

FOR PERMITTING PURPOSES ONLY. DO NOT USE FOR CONSTRUCTION

ALL DEPTHS ARE REFERENCED TO MEAN TIDAL WATER

LATITUDE: 33° 02' 26.87" N

GRAPHIC SCALE: 1" = 60'

**LEGEND**

ORIGINALY-PERMITTED & DREDGES CANAL DREDGE PATH: 2016 / 2017 DREDGING PROJECT

2021 PROPOSED ADJUSTED CANAL DREDGE PATH

ORIGINALY-PERMITTED CANAL 2013; PROPOSED TO ALSO BE INCLUDED IN THE NEW 2021 DREDGE PERMIT

PROJECT ORIGINALY-PERMITTED UNDER P.A.N. SAC 2004-02988-3II. PERMIT ISSUE DATE: JULY 11, 2013

**SAC-2004-02988**  
**Cherry Grove Canal 2021 Maintenance Dredge**  
**Horry County, SC**  
**Sheet 5 of 13**  
**Date: October 19, 2021**

**APPLICANT:**  
 City of North Myrtle Beach  
 1018 Second Avenue South  
 North Myrtle Beach, SC 29582  
 Contact: Mike Mahaney; City Manager  
 mmahaney@citymb.us (email)  
 (843) 280-5555 (phone)



**ENLARGED PLAN VIEW #3**  
 (ACCESS CANALS: K, L, M, N and MINOR CHANNEL: Station 57+00 through 37+00)

**PROJECT NAME:** Cherry Grove Beach Canal Dredging Permit, 2021  
**PROJECT LOCATION:** North Myrtle Beach (Cherry Grove Canals)  
**ADJACENT WATERBODY:** House Creek -&- Hog Inlet  
**COUNTY:** Horry **STATE:** South Carolina

**PROPOSED ACCESS CANAL / MINOR CHANNEL LAYOUTS FOR MAINTENANCE DREDGING**

**PROPOSED ACTIVITY:** The project involves maintenance dredging of up to approximately 180,000 cubic yards (CY) of material from approximately 24 acres of the existing man-made canals in Cherry Grove. Dredged material will be removed by hydraulic dredge and pumped to the Horry County-owned spoil basin (CDF-320; Tidewater Disposal Basin) near Tidewater Plantation on the Atlantic Intracoastal Waterway. Minor Channel will be dredged 34 feet wide dredge path and a minimum required depth of 3.0 ft. MLW, with 1:4 allowable overdepth. Access Canals will be generally dredged 24 feet wide dredge path, with a few variations to provide improved access and flushing, to a minimum required depth of 3.0 ft. MLW, for approx. 2.5' of their length in order to avoid creating a pocket for stagnant water, with 1:4 allowable overdepth. Dredged side slopes will be 4H:1V, except in close proximity to marsh vegetation where dredge cut will be vertical. An additional 1:4 depth for advanced maintenance dredging is also proposed throughout the project, resulting in max. project depths of 3.0' MLW + 1' = -5.0-ft. MLW and -2.5-ft. MLW + 1' = -2.5-ft. MLW, for locations noted above.

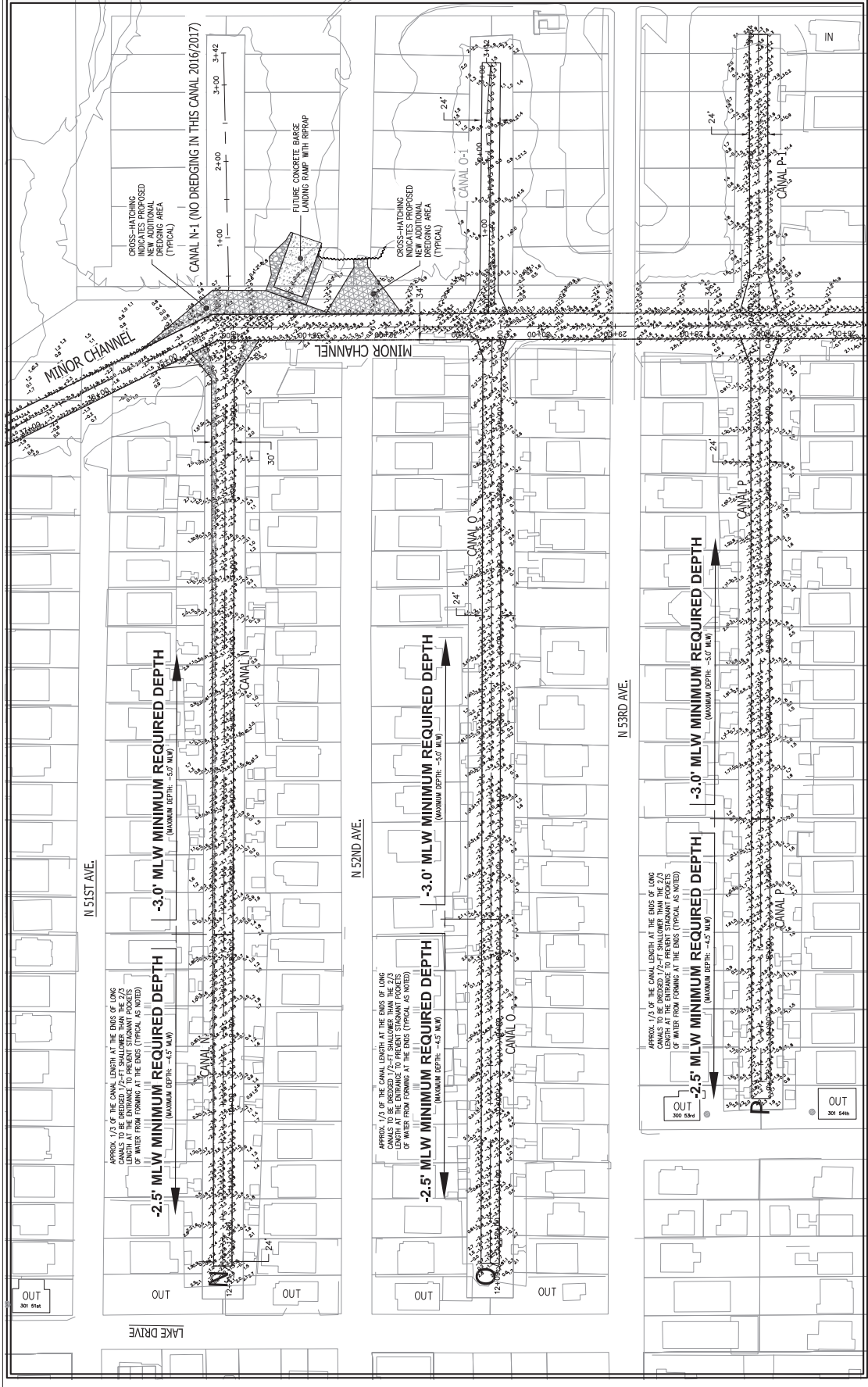

FOR PERMITTING PURPOSES ONLY; DO NOT USE FOR CONSTRUCTION

PROJECT ORIGINALLY PERMITTED UNDER P/N: SAC 2004-02988-3J. PERMIT ISSUE DATE: JULY 11, 2013

**LEGEND**  
 ORIGINAL UN-REPAIRED & MARKED CANAL  
 2021 PROPOSED ADJUSTED CANAL DREDGE PATH  
 ORIGINAL PERMITTED CANAL 2013; NOT DREDGED IN 2016 / 2017  
 THE NEW 2021 DREDGE PERMIT.

ALL POINTS IN FEET UNLESS NOTED OTHERWISE  
 LATITUDE: 33° 50' 28.00" N  
 LONGITUDE: -78° 36' 54.00" W

GRAPHIC SCALE: 1" = 60'

ENLARGED PLAN VIEW #4  
 (ACCESS CANALS: N, O, O-1, P, 8-P-1 and- Minor Channel- Station 37+00 through 26+00)

PROPOSED ACCESS CANAL / MINOR CHANNEL LAYOUTS FOR MAINTENANCE DREDGING

**PROPOSED ACTIVITY:** The project involves maintenance dredging of up to approximately 180,000 cubic yards (CY) of material from approximately 24 acres of the existing man-made canals in Cherry Grove. Dredged material will be removed by hydraulic dredge and pumped to the Horry County-owned spoil basin (CDF-320; Tidewater Disposal Basin) near Tidewater Plantation on the Atlantic Intracoastal Waterway. Minor Channel to be dredged 34 feet wide dredge path and to a minimum required depth of 3.0 ft. MLW; with 1:4 allowable overdepth. Access Canals will be generally dredged 24 feet wide dredge path, with a few variations to provide improved access and flushing, to a minimum required depth of 3.0 ft. MLW for approx. 2.5<sup>th</sup> of their length and -2.5 ft. MLW for the remaining 1.5<sup>th</sup> of their length in order to avoid creating a pocket for stagnant water, with 1-ft. allowable overdepth. Dredged side slopes will be 4H:1V, except in close proximity to marsh vegetation where dredge cut will be vertical. An additional 1-ft. depth for advanced maintenance dredging is also proposed throughout the project, resulting in max. project depths of 3.0' MLW + 1' + 1' = -5.0-ft. MLW and -2.5-ft. MLW + 1' + 1' = -4.5-ft. MLW for locations noted above.

**PROJECT NAME:** Cherry Grove Beach Canal Dredging Permit, 2021  
**PROJECT LOCATION:** North Myrtle Beach (Cherry Grove Canals)  
**ADJACENT WATERBODY:** House Creek -&- Hog Inlet  
**COUNTY:** Horry **STATE:** South Carolina

**APPLICANT:**  
 City of North Myrtle Beach  
 1018 Second Avenue South  
 North Myrtle Beach, SC 29582  
 Contact: Mike Mahaney; City Manager  
 mmahaney@nmb.us (email)  
 (843) 280-5555 (phone)



SAC-2004-02988

**Cherry Grove Canal 2021 Maintenance Dredge**  
 Horry County, SC  
 Sheet 6 of 13  
 Date: October 19, 2021

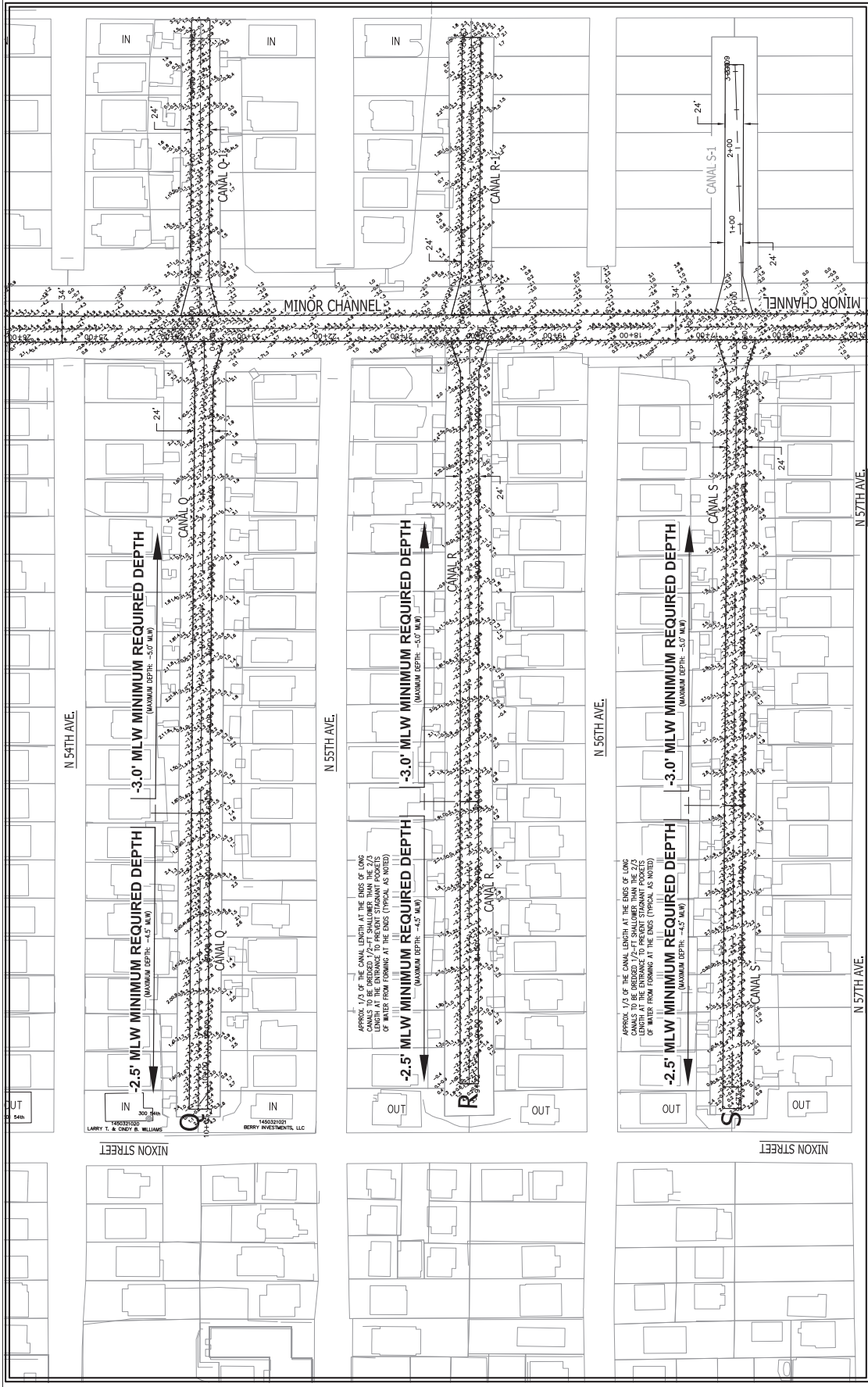

FOR PERMITTING PURPOSES ONLY; DO NOT USE FOR CONSTRUCTION

PROJECT ORIGINALLY PERMITTED UNDER P/N: SAC 2004-02988-3J. PERMIT ISSUE DATE: JULY 11, 2013

LEGEND	
(Symbol: Dashed line)	ORIGINALLY-PERMITTED & REDESIGNED CANAL DREDGE PATH 2017 / 2017
(Symbol: Solid line)	2021 PROPOSED ADJUSTED CANAL DREDGE PATH
(Symbol: Dotted line)	ORIGINALLY-PERMITTED CANAL 2012; NOT DREDGED IN 2016 / 2017; 2021 PROPOSED ADJUSTED IN THE NEW 2021 DREDGE PERMIT.

REVISIONS TO BE MADE TO THIS PLAN SHALL BE MADE TO THE ORIGINAL SET.

NAD 83: 33° 57' 28.80" P  
Easting: 421,142.541071

APPLICANT:  
City of North Myrtle Beach  
1018 Second Avenue South  
North Myrtle Beach, SC 29582  
Contact: Mike Mahaney; City Manager  
mmahaney@cityofnb.us (email)  
(843) 280-5555 (phone)

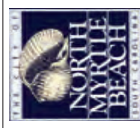

**PROJECT NAME:** Cherry Grove Beach Canal Dredging Permit, 2021  
**PROJECT LOCATION:** North Myrtle Beach (Cherry Grove Canals)  
**ADJACENT WATERBODY:** House Creek -4- Hog Inlet  
**COUNTY:** Horry **STATE:** South Carolina

**ENLARGED PLAN VIEW #5**  
 (ACCESS CANALS: Q, Q-1, R, R-1, S & S-1 -and- Minor Channel; Station 26+00 through 15+00)

**PROPOSED ACCESS CANAL / MINOR CHANNEL LAYOUTS FOR MAINTENANCE DREDGING**

**PROPOSED ACTIVITY:** The project involves maintenance dredging of up to approximately 180,000 cubic yards (CY) of material from approximately 24 acres of the existing man-made canals in Cherry Grove. Dredged material will be removed by hydraulic dredge and pumped to the Horry County-owned spoil basin (CDF-320; Tidewater Disposal Basin) near Tidewater Plantation on the Atlantic Intracoastal Waterway. Minor Channel will be dredged 34 feet wide dredge path and a minimum required depth of 3.0 ft. MLW, with 1-ft. allowable overdepth. Access Canals will be generally dredged 24 feet wide dredge path, with a few variations to provide improved access and flushing, to a minimum required depth of 3.0 ft. MLW, for approx. 2.5' MLW for the remaining 1/3<sup>rd</sup> of their length in order to avoid creating a pocket for stagnant water, with 1-ft. allowable overdepth. Dredged side slopes will be 4H:1V, except in close proximity to marsh vegetation where dredge cut will be vertical. An additional 1-ft. depth for advanced maintenance dredging is also proposed throughout the project, resulting in max. project depths of 3.0' MLW + 1' = -5.0-ft. MLW and -2.5-ft. MLW + 1' = -4.5-ft. MLW, for locations noted above.

**DATE:** October 19, 2021

**SAC-2004-02988**  
**Cherry Grove Canal 2021 Maintenance Dredge**  
**Horry County, SC**  
**Sheet 7 of 13**

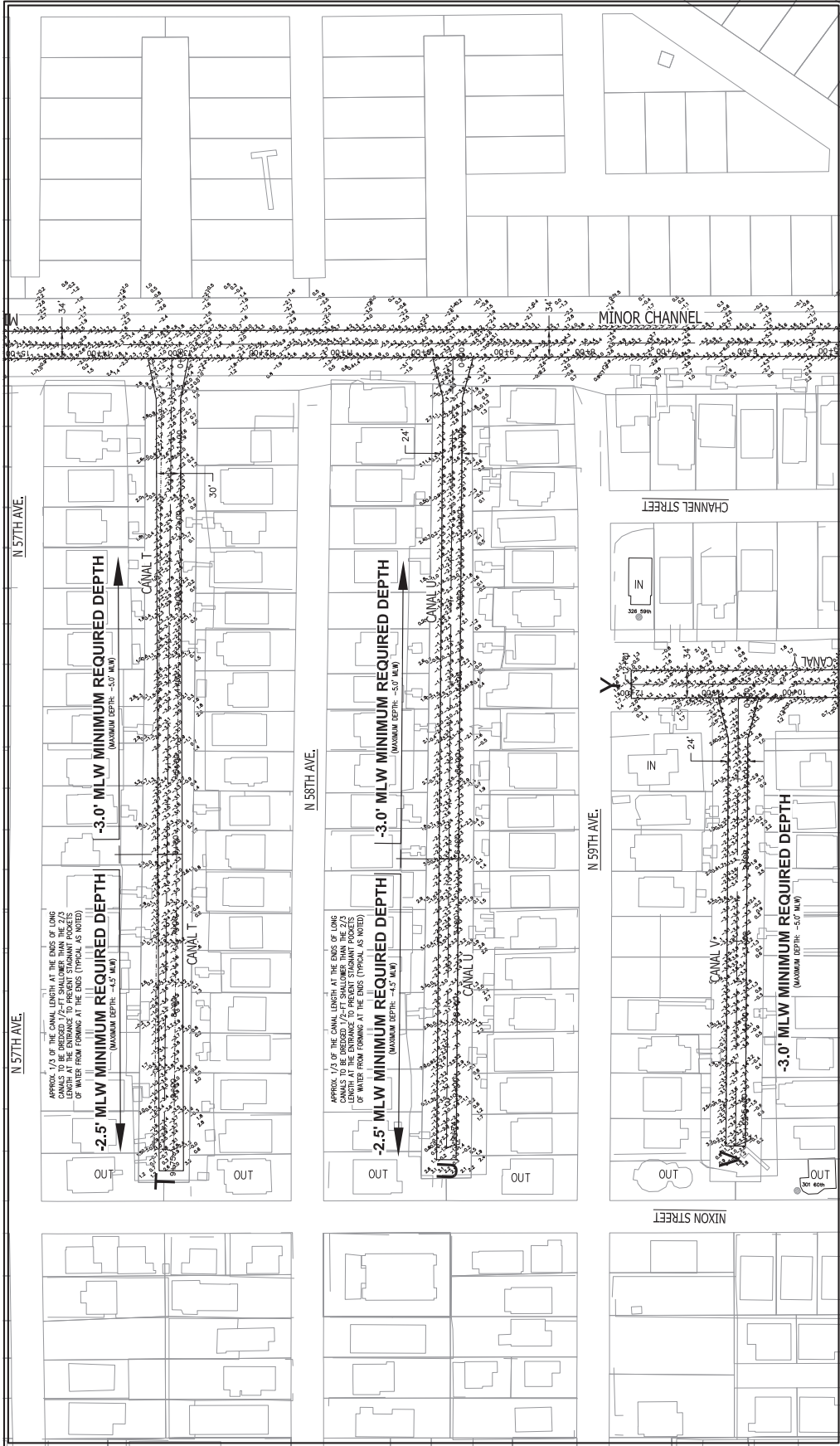

(ACCESS CANALS: T, U, & V -and- Minor Channel: Station 15+00 through 5+00 -and- Canal V: Station 12+01 through 9+50)

**ENLARGED PLAN VIEW #6**

**PROPOSED ACCESS CANAL / MINOR CHANNEL LAYOUTS FOR MAINTENANCE DREDGING**

**PROPOSED ACTIVITY:** The project involves maintenance dredging of up to approximately 180,000 cubic yards (CY) of material from approximately 24 acres of the existing man-made canals in Cherry Grove. Dredged material will be removed by hydraulic dredge and pumped to the Horry County-owned spoil basin (CDF 320; Tidewater Disposal Basin) near Tidewater Plantation on the Atlantic Intracoastal Waterway. Minor Channel to be dredged 34 feet wide dredge path and to a minimum required depth of -3.0 ft. MLW; with 1-ft. allowable overdepth. Access Canals will be generally dredged 24 feet wide dredge path, with a few variations to provide improved access and flushing, to a minimum required depth of -3.0 ft. MLW for approx. 2.5' of their length and -2.5 ft. MLW for the remaining 1.5' of their length in order to avoid creating a pocket for stagnant water, with 1-ft. allowable overdepth. Dredged side slopes will be 4H:1V, except in close proximity to marsh vegetation where dredge cut will be vertical. An additional 1-ft. depth for advanced maintenance dredging is also proposed throughout the project, resulting in max. project depths of 3.0' MLW + 1' = -5.0-ft. MLW and -2.5-ft. MLW + 1' = -4.5-ft. MLW for locations noted above.

**PROJECT NAME:** Cherry Grove Beach Canal Dredging Permit, 2021  
**PROJECT LOCATION:** North Myrtle Beach (Cherry Grove Canals)  
**ADJACENT WATERBODY:** House Creek -&- Hog Inlet  
**COUNTY:** Horry **STATE:** South Carolina

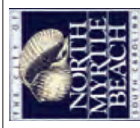

**APPLICANT:**  
 City of North Myrtle Beach  
 1018 Second Avenue South  
 North Myrtle Beach, SC 29582  
 Contact: Mike Mahaney; City Manager  
 mmahaney@cmho.us (email)  
 (843) 280-5555 (phone)

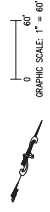

LATITUDE: 33° 50' 26.80" N  
 LONGITUDE: -79° 36' 54.00" W

ALL DEPTHS ARE FOR WATER SURFACE UNLESS NOTED OTHERWISE

LEGEND	
---	ORIGINALLY PERMITTED & DREDGED CANAL DREDGE PATH 2016 / 2017
---	2021 PROPOSED ADJUSTED CANAL DREDGE PATH
---	ORIGINALLY PERMITTED CANAL, 2016; NOT DREDGED IN 2016 / 2017. PROPOSED TO ALSO BE INCLUDED IN THE NEW 2021 DREDGE PERMIT.

PROJECT ORIGINALLY PERMITTED UNDER P/N: SAC 2004-02988-3L. PERMIT ISSUE DATE: JULY 11, 2013

FOR PERMITTING PURPOSES ONLY: CONSTRUCTION FOR CONSTRUCTION

**SAC-2004-02988**  
**Cherry Grove Canal 2021**  
**Maintenance Dredge**  
**Horry County, SC**  
**Sheet 8 of 13**  
**Date: October 19, 2021**



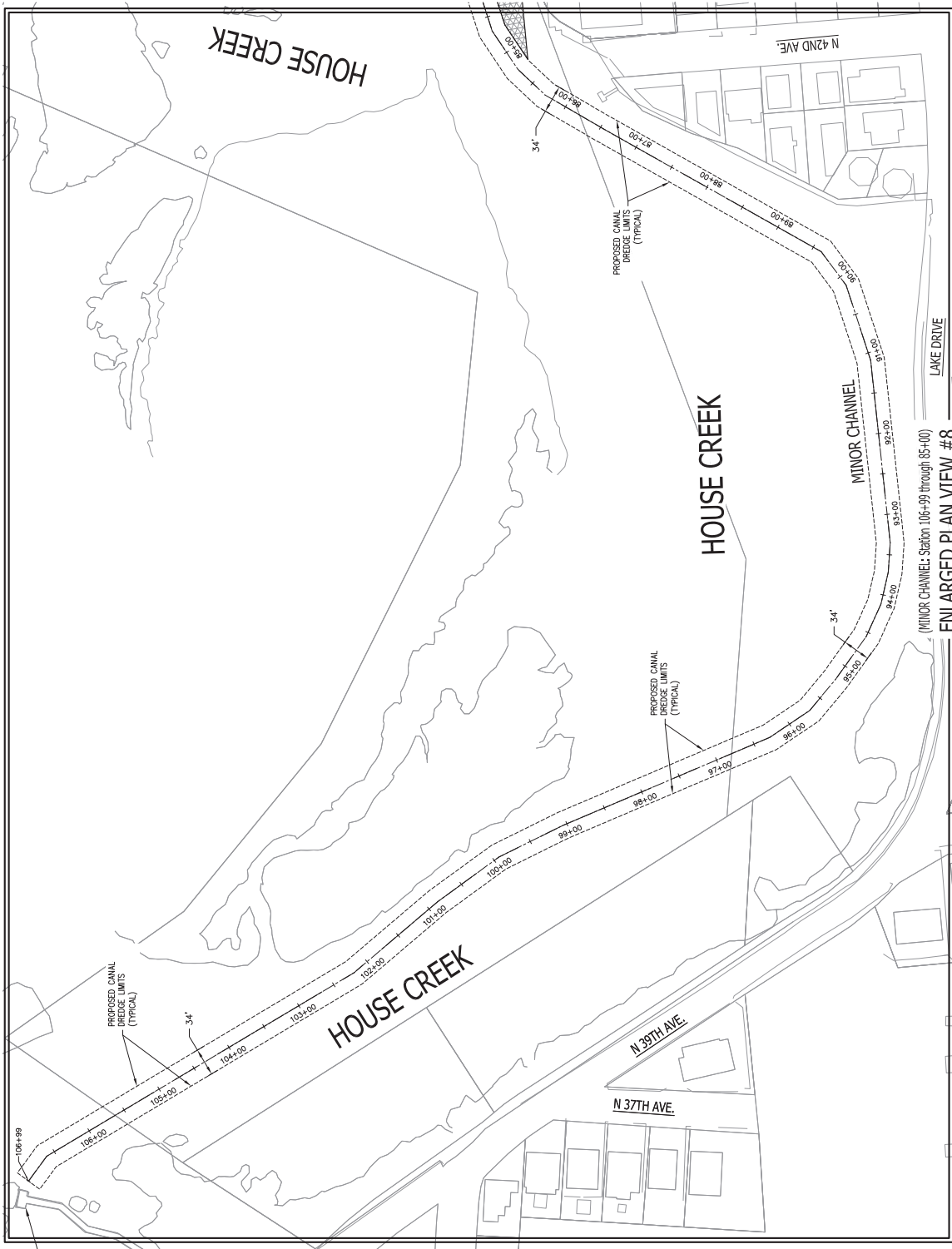

PROJECT ORIGINALLY PERMITTED UNDER F/N: SAC 2004-02988-3I. PERMIT ISSUE DATE: JULY 11, 2013

FOR PERMITTING PURPOSES ONLY; DO NOT USE FOR CONSTRUCTION

LEGEND	
---	ORIGINALLY PERMITTED & DREDGED CANAL DREDGE PATH 2016 / 2017
---	2021 PROPOSED DREDGED CANAL DREDGE PATH
---	ORIGINALLY PERMITTED CANAL 2013, NOT DREDGED SINCE 2013. PROPOSED TO ALSO BE INCLUDED IN THE NEW 2021 DREDGE PERMIT.

ALL DREDGE AREAS TO BE DREDGED WITHIN 100' OF THE CANAL CENTERLINE.

LATITUDE: 33° 50' 26.00" N  
LONGITUDE: 78° 30' 54.00" W



<b>SHEET:</b> P-10 of 13
<b>DATE:</b> October 29, 2021
<b>REV. DATE:</b> 01-
<b>REV. DATE:</b> 01-
<b>SCALE:</b> AS SHOWN
<b>FILE:</b> CHERRY GROVE 2021 P&B



**AGENT:**  
H. Wayne Beam, PE  
Beam & Associates  
P. O. Box 3238  
North Myrtle Beach, SC 29582  
w.beam@att.net (email)  
(843) 814-7145 (cell)



**APPLICANT:**  
City of North Myrtle Beach  
1018 Second Avenue South  
North Myrtle Beach, SC 29582  
Contact: Mike Mahaney, City Manager  
mmahaney@citymb.us (email)  
(843) 280-5555 (phone)

**PROJECT NAME:** Cherry Grove Beach Canal Dredging Permit 2021  
**PROJECT LOCATION:** North Myrtle Beach (Cherry Grove Canals)  
**ADJACENT WATERBODY:** House Creek -&- Hog Inlet  
**COUNTY:** Horry **STATE:** South Carolina

**PROPOSED ACTIVITY:** The existing man-made canals in Cherry Grove, Dredging Basin near Tidewater Plantation on the Atlantic Intracoastal Waterway will be dredged to a depth of 2.5 ft. MLW for approx. 2.3' of their length and 2.5 ft. Dredged side slopes will be 4H:1V, except in those areas where the project is proposed to be deepened throughout the project, resulting in max. pr...

**SAC-2004-02988**  
**Cherry Grove Canal 2021 Maintenance**  
**Dredge**  
**Horry County, SC**  
**Sheet 10 of 13**  
**Date: October 19, 2021**

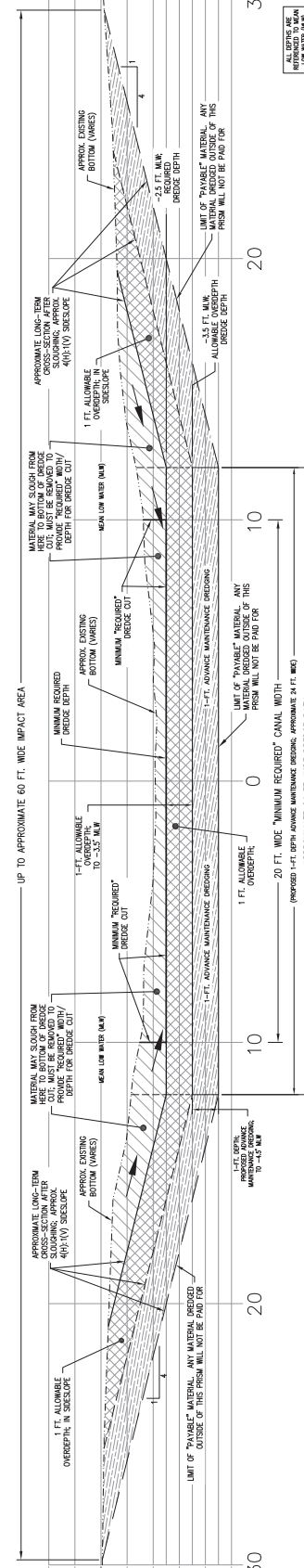

**20 FT. WIDE ACCESS CANAL (2.5 FT. MINIMUM REQUIRED DEPTH)**

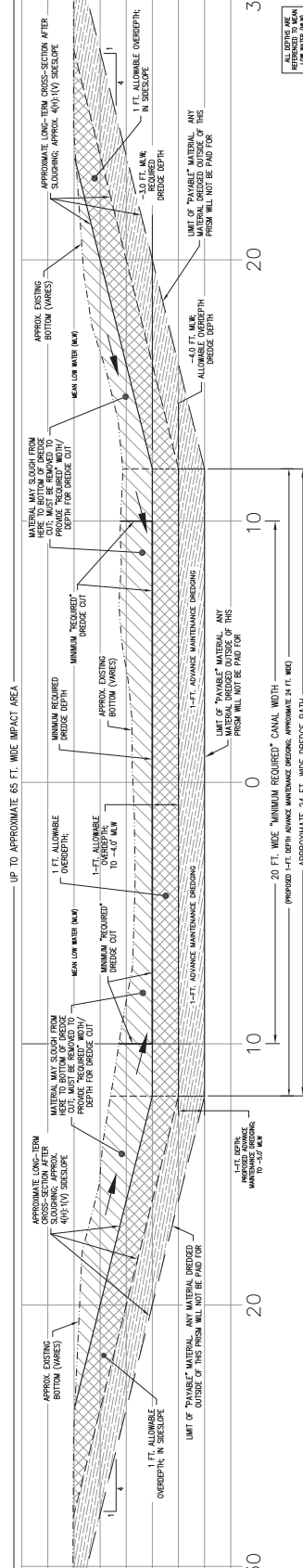

**20 FT. WIDE ACCESS CANAL (3.0 FT. MINIMUM REQUIRED DEPTH)**

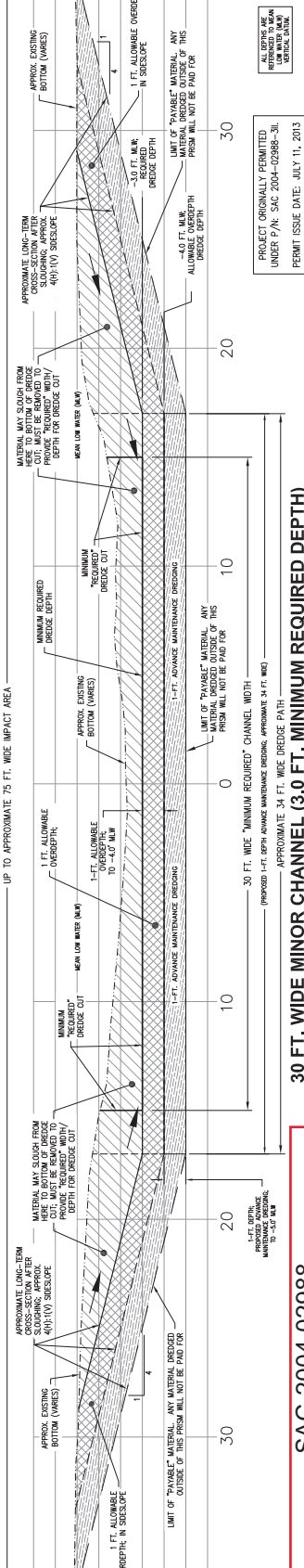

**30 FT. WIDE MINOR CHANNEL (3.0 FT. MINIMUM REQUIRED DEPTH)**

**SAC-2004-02988**  
**Cherry Grove Canal 2021 Maintenance**  
**Dredge**  
**Horry County, SC**  
**Sheet 11 of 13**  
**Date: October 19, 2021**

**PROPOSED ACCESS CANAL**  
 existing man-made canals in Basin near Tidewater Plant and flushing to a minimum required depth of -3.0 ft. MLW, with 1:4:1 allowable overdepth. Access canal width shall be 30 ft. MLW for approx. 2.5' dredged side slopes will be proposed throughout the project.

**PROJECT NAME:** Cherry Grove Beach Canal Dredging Permit, 2021  
**PROJECT LOCATION:** North Myrtle Beach (Cherry Grove Canals)  
**ADJACENT WATERBODY:** House Creek -> Hog Inlet  
**COUNTY:** Horry **STATE:** South Carolina

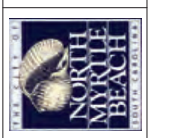

**APPLICANT:**  
 City of North Myrtle Beach  
 1018 Second Avenue South  
 North Myrtle Beach, SC 29582  
 Contact: Mike Mahaney, City Manager  
 mmahaney@citymb.us (email)  
 (843) 380-5555 (phone)

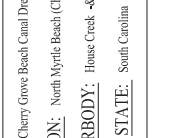

**AGENT:**  
 H. Wayne Beam, P.H.D.  
 Beam & Associates  
 P.O. Box 3238  
 North Myrtle Beach, SC 29582  
 w.beam@att.net (email)  
 (843) 814-7145 (cell)

**FOR PERMITTING PURPOSES ONLY - DO NOT USE FOR CONSTRUCTION**

**NOT TO SCALE**

**PROJECT ORIGINALLY PERMITTED UNDER P.N. SAC 2004-02988-3I.**  
**PERMIT ISSUE DATE: JULY 11, 2013**

**LATITUDE: 33° 59' 28.80" N**  
**LONGITUDE: -78° 36' 54.00" W**

**SHEET: P-11 of 13**  
**DATE: October 29, 2021**  
**REV. DATE: 08**  
**REV. DATE: 08**  
**SCALE: AS SHOWN**  
**FILE: CHERRY GROVE 2021 P28a**





