

JOINT
PUBLIC NOTICE

CHARLESTON DISTRICT, CORPS OF ENGINEERS
69A Hagood Avenue
Charleston, South Carolina 29403-5107
and
THE S.C. DEPARTMENT OF HEALTH AND ENVIRONMENTAL CONTROL
Office of Ocean and Coastal Resource Management
1362 McMillan Avenue, Suite 400
North Charleston, South Carolina 29405

REGULATORY DIVISION

Refer to: P/N SAC-2017-01033

November 21, 2024

Pursuant to Section 10 of the Rivers and Harbors Act of 1899 (33 U.S.C. 403), Sections 401 and 404 of the Clean Water Act (33 U.S.C. 1344), and the South Carolina Coastal Zone Management Act (48-39-10 et.seq.), an application has been submitted to the Department of the Army and the S.C. Department of Health and Environmental Control by

Mr. Johnson Stevens
Stevens Towing Company
4170 Highway 165
Yonges Island, South Carolina 29449
j.stevens@stevens-towing.com

for a permit to discharge fill into the Wadmalaw River in order to construct a work barge, work barge access, and relocation of a 150-ton travel lift pier.

The project is located on the Wadmalaw River at 4170 Highway 165, Yonges Island, Charleston County, South Carolina (Latitude: 32.6917°, Longitude: -80.2248°).

In order to give all interested parties an opportunity to express their views

N O T I C E

is hereby given that written statements regarding the proposed work will be received by the **Corps** until

15 Days from the Date of this Notice,

and **SCDHEC** will receive written statements regarding the proposed work until

30 Days from the Date of this Notice

from those interested in the activity and whose interests may be affected by the

proposed work.

The work affecting waters of the United States is part of an overall project known as Stevens Towing Facility Expansion. The proposed activities in waters of the United States include the discharge of fill material into the Wadmalaw River in order to construct a work barge, work barge access, and relocation of a 150-ton travel lift pier. The total work barge system will be 60' 8" by 744', secured by 11 spud piles (non-permanent) each up to 54" in diameter. The work barge access will be expanded from 30' wide (110' long) to 41' wide. The 150-ton travel lift pier will be relocated 390 feet north of its current location. This will cause impacts to the waterway consisting of 1.06 acres of shading due to the size of the barge structures and approximately 0.001 acre of fill impact related to the spud piles.

NOTE: This public notice and associated plans are available on the Corps' website at: <http://www.sac.usace.army.mil/Missions/Regulatory/PublicNotices> .

The District Engineer has concluded that the discharges associated with this project, both direct and indirect, should be reviewed by the South Carolina Department of Health and Environmental Control in accordance with provisions of Section 401 of the Clean Water Act. As such, this notice constitutes a request, on behalf of the applicant, for certification that this project will comply with applicable effluent limitations and water quality standards. The work shown on this application must also be certified as consistent with applicable provisions of the Coastal Zone Management Program (15 CFR 930). This activity may also require evaluation for compliance with the S. C. Construction in Navigable Waters Permit Program. State review, permitting and certification is conducted by the S. C. Department of Health and Environmental Control. The District Engineer will not process this application to a conclusion until such certifications are received. The applicant is hereby advised that supplemental information may be required by the State to facilitate the review. This Public Notice will serve as the notification to the Administrator of the Environmental Protection Agency (EPA) pursuant to section 401(a)(2) of the Clean Water Act.

This notice initiates the Essential Fish Habitat (EFH) consultation requirements of the Magnuson-Stevens Fishery Conservation and Management Act. The District Engineer's initial determination is that the proposed action would not have a substantial individual or cumulative adverse impact on EFH or fisheries managed by the South Atlantic Fishery Management Council and the National Marine Fisheries Service (NMFS). The District Engineer's final determination relative to project impacts and the need for mitigation measures is subject to review by and coordination with the NMFS.

Pursuant to the Section 7 of the Endangered Species Act of 1973 (as amended), the Corps has reviewed the project area, examined all information provided by the applicant, and the District Engineer has determined, based on the most recently available

information that the project will have no effect on the frosted flatwoods salamander, Bachman's warbler, Eastern black rail, piping plover, red-cockaded woodpecker, Rufa red knot, Canby's dropwort, American chaffseed, and pondberry; the project is not likely to adversely affect the Northern long-eared bat and the American wood stork; and the project will not result in the destruction or adverse modification of designated or proposed critical habitat. This public notice serves as a request to the U.S. Fish and Wildlife Service and the National Marine Fisheries Service for any additional information they may have on whether any listed or proposed endangered or threatened species or designated or proposed critical habitat may be present in the area which would be affected by the activity.

Pursuant to Section 106 of the National Historic Preservation Act (NHPA), this public notice also constitutes a request to Indian Tribes to notify the District Engineer of any historic properties of religious and cultural significance to them that may be affected by the proposed undertaking.

In accordance with Section 106 of the NHPA, the District Engineer has consulted South Carolina ArchSite (GIS), for the presence or absence of historic properties (as defined in 36 C.F.R. 800.16)(1)(1)), and has initially determined that historic properties, are present; moreover, these historic properties may be affected by the undertaking. This public notice serves to notify the State Historic Preservation Office that the Corps plans to initiate Section 106 consultation on these historic properties. Individuals or groups who would like to be consulting parties for the purposes of the NHPA should make such a request to the Corps in writing within 30 days of this public notice. To ensure that other historic properties that the District Engineer is not aware of are not overlooked, this public notice also serves as a request to the State Historic Preservation Office and other interested parties to provide any information they may have with regard to historic properties.

The District Engineer's final eligibility and effect determination will be based upon coordination with the SHPO and/or THPO, as appropriate and required and with full consideration given to the proposed undertaking's potential direct and indirect effects on historic properties within the Corps-identified permit area.

Any person may request, in writing, within the comment period specified in this notice, that a public hearing be held to consider this application. Requests for a public hearing shall state, with particularity, the reasons for holding a public hearing.

The decision whether to issue a permit will be based on an evaluation of the probable impact including cumulative impacts of the proposed activity on the public interest and will include application of the guidelines promulgated by the Administrator, Environmental Protection Agency (EPA), under authority of Section 404(b) of the Clean Water Act and, as appropriate, the criteria established under authority of Section 102 of the Marine Protection, Research and Sanctuaries Act of 1972, as amended. That decision will reflect the national concern for both protection and utilization of important resources. The benefit which reasonably may be expected to accrue from the project must be

balanced against its reasonably foreseeable detriments. All factors which may be relevant to the project will be considered including the cumulative effects thereof; among those are conservation, economics, aesthetics, general environmental concerns, wetlands, historic properties, fish and wildlife values, flood hazards, flood plain values, land use, navigation, shoreline erosion and accretion, recreation, water supply and conservation, water quality, energy needs, safety, food and fiber production and, in general, the needs and welfare of the people. A permit will be granted unless the District Engineer determines that it would be contrary to the public interest. In cases of conflicting property rights, the Corps cannot undertake to adjudicate rival claims.

The Corps is soliciting comments from the public; Federal, state, and local agencies and officials; Indian Tribes; and other interested parties in order to consider and evaluate the impacts of this activity. Any comments received will be considered by the Corps to determine whether to issue, modify, condition or deny a permit for this project. To make this decision, comments are used to assess impacts on endangered species, historic properties, water quality, general environmental effects, and the other public interest factors listed above. Comments are used in the preparation of an Environmental Assessment and/or an Environmental Impact Statement pursuant to the National Environmental Policy Act. Comments are also used to determine the need for a public hearing and to determine the overall public interest of the activity. **Please submit comments in writing, identifying the project of interest by public notice number, to the following address:**

**U.S. Army Corps of Engineers
ATTN: REGULATORY DIVISION
69A Hagood Avenue
Charleston, South Carolina 29403-5107**

If there are any questions concerning this public notice, please contact Carl Johnson, Project Manager, at (843) 494-0348, or by email at Carl.a.Johnson@usace.army.mil.

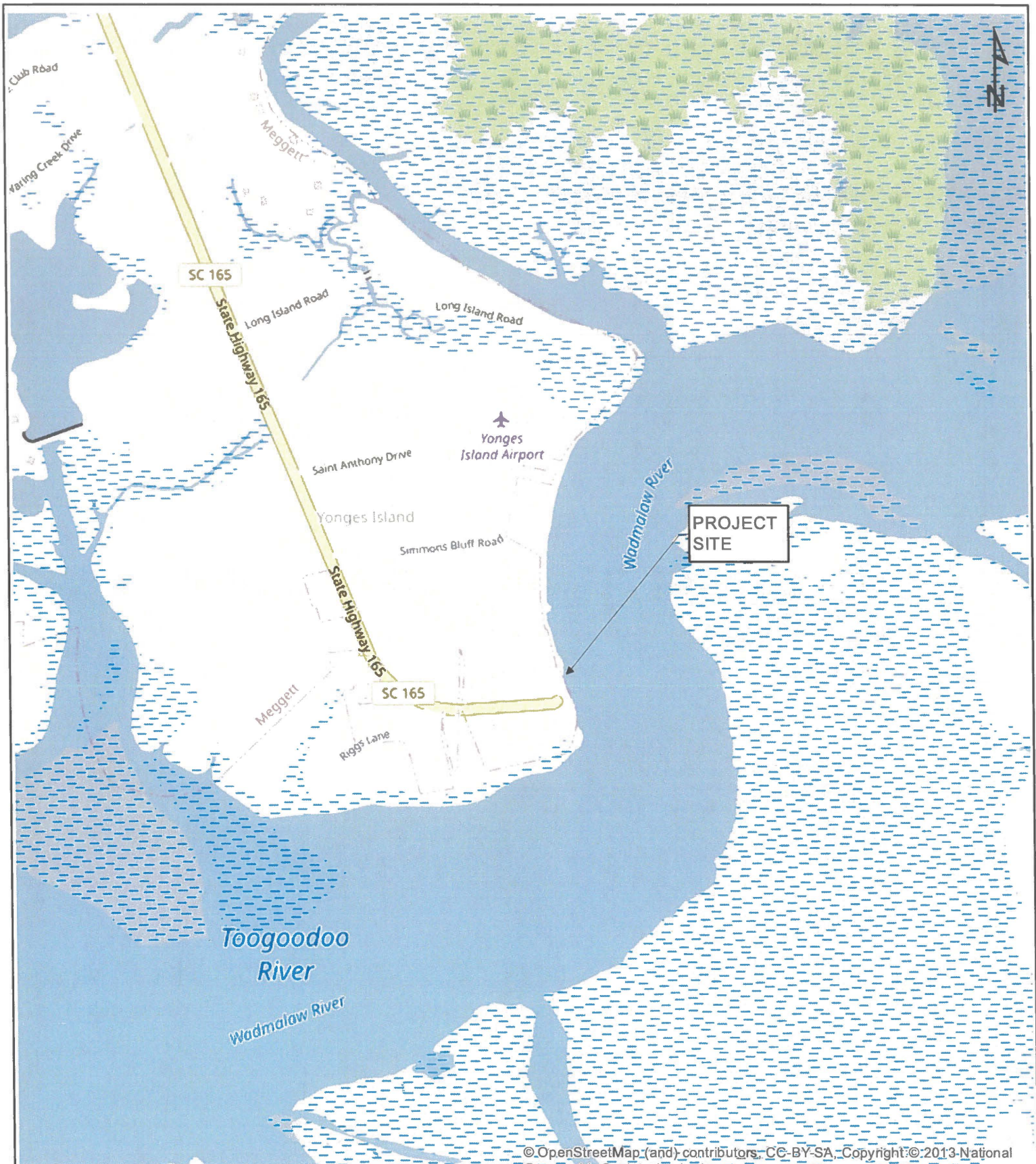

© OpenStreetMap (and) contributors, CC-BY-SA, Copyright: © 2013 National

PURPOSE: SHIPYARD MODERNIZATION

ADJACENT PROPERTY OWNERS:

SEE ATTACHED LIST

SURVEY DATUM: MLW

DATE: MAY 16, 2024

FIGURE 1
LOCATION MAP



STEVENS TOWING COMPANY, INC.
4170 HWY 165
YORGES ISLAND, SC 29449

PROPOSED: WORK BARGE SYSTEM &
TRAVEL LIFT

AT: 4170 HWY 165, YORGES ISLAND

IN: WADMALLOW RIVER

COUNTY: CHARLESTON
SOUTH CAROLINA

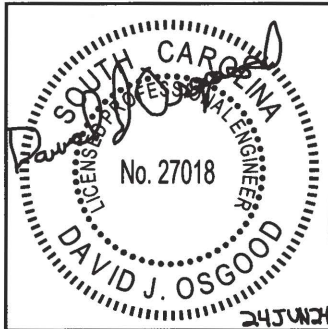

24JUN24

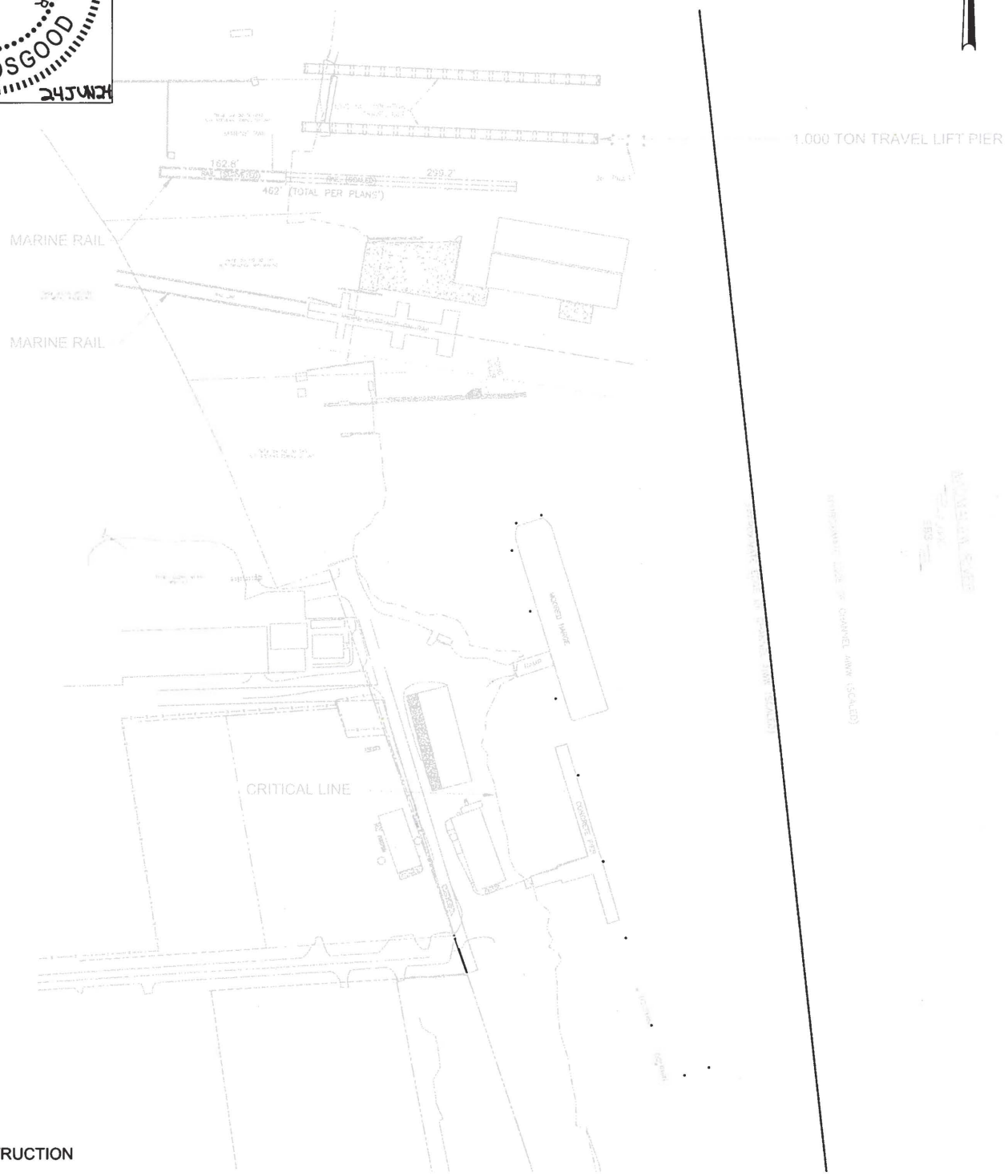
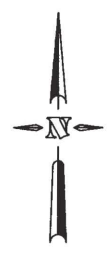

NOT FOR CONSTRUCTION

PURPOSE: SHIPYARD MODERNIZATION

ADJACENT PROPERTY OWNERS
SEE ATTACHED

SURVEY DATUM MLW

DATE: 06/17/2024

FIGURE 2
EXISTING CONDITIONS

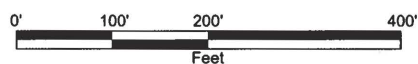

STEVENS TOWING COMPANY, INC.
4170 HIGHWAY 165
MEGGETT, SOUTH CAROLINA

PROPOSED: WORK BARGE SYSTEM & TRAVEL
LIFT

AT: 4170 HIGHWAY 165, MEGGETT
SOUTH CAROLINA

IN: WADMALAW RIVER

COUNTY: CHARLESTON, SOUTH CAROLINA

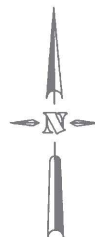

WADMALAW RIVER

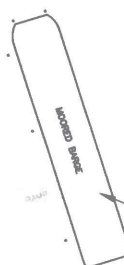

DOLPHINS TO BE DEMOLISHED

APPROXIMATE ELEVATION OF CHANNEL, 1985 (SCALED)

WADMALAW RIVER
-2.1000
ELEV -2.1

MOORED BARGE
TO BE REMOVED

CONCRETE "T" HEAD
TO BE DEMOLISHED

NOT FOR CONSTRUCTION

PURPOSE: SHIPYARD MODERNIZATION

ADJACENT PROPERTY OWNERS
SEE ATTACHED

SURVEY DATUM MLW

DATE: 06/17/2024

FIGURE 3
PROPOSED DEMOLITION PLAN

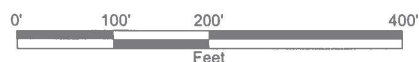

STEVENS TOWING COMPANY, INC.
4170 HIGHWAY 165
MEGGETT, SOUTH CAROLINA

PROPOSED: WORK BARGE SYSTEM & TRAVEL
LIFT

AT: 4170 HIGHWAY 165, MEGGETT
SOUTH CAROLINA

IN: WADMALAW RIVER

COUNTY: CHARLESTON, SOUTH CAROLINA

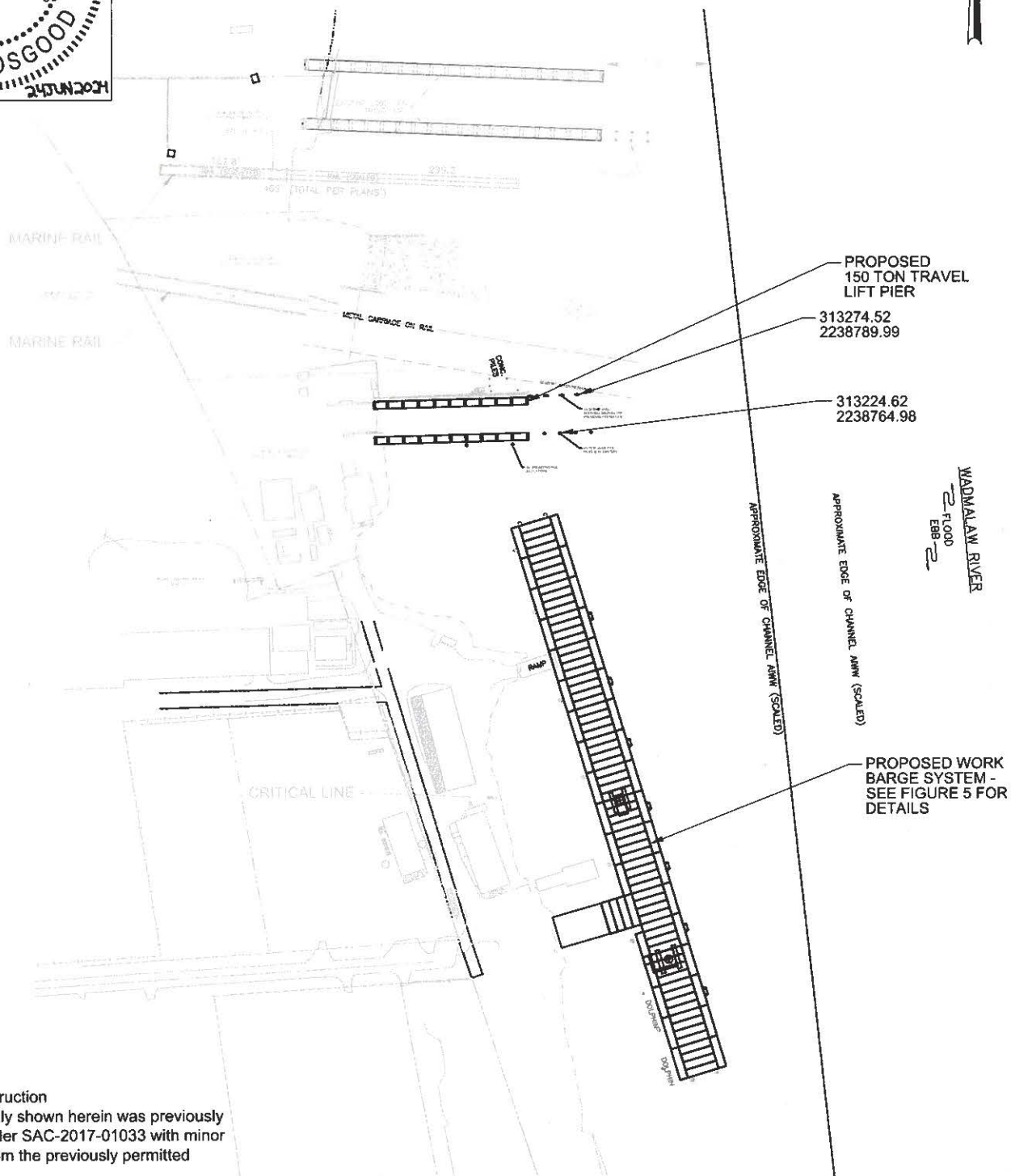
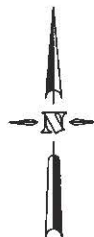
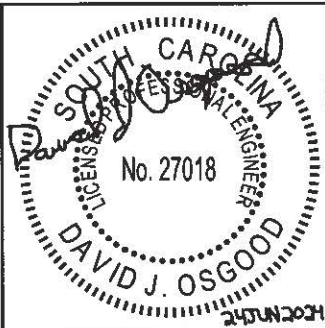

Notes:

1. Not for Construction
2. Work generally shown herein was previously permitted under SAC-2017-01033 with minor deviations from the previously permitted plans.

PURPOSE: SHIPYARD MODERNIZATION

ADJACENT PROPERTY OWNERS
SEE ATTACHED

SURVEY DATUM MLW

DATE: 06/03/2024

FIGURE 4
PROPOSED UPGRADES

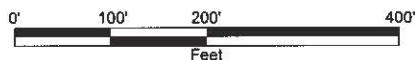

STEVENS TOWING COMPANY, INC.
4170 HIGHWAY 165
MEGGETT, SOUTH CAROLINA

PROPOSED: WORK BARGE SYSTEM & TRAVEL
LIFT

AT: 4170 HIGHWAY 165, MEGGGETT
SOUTH CAROLINA

IN: WADMALAW RIVER

COUNTY: CHARLESTON, SOUTH CAROLINA

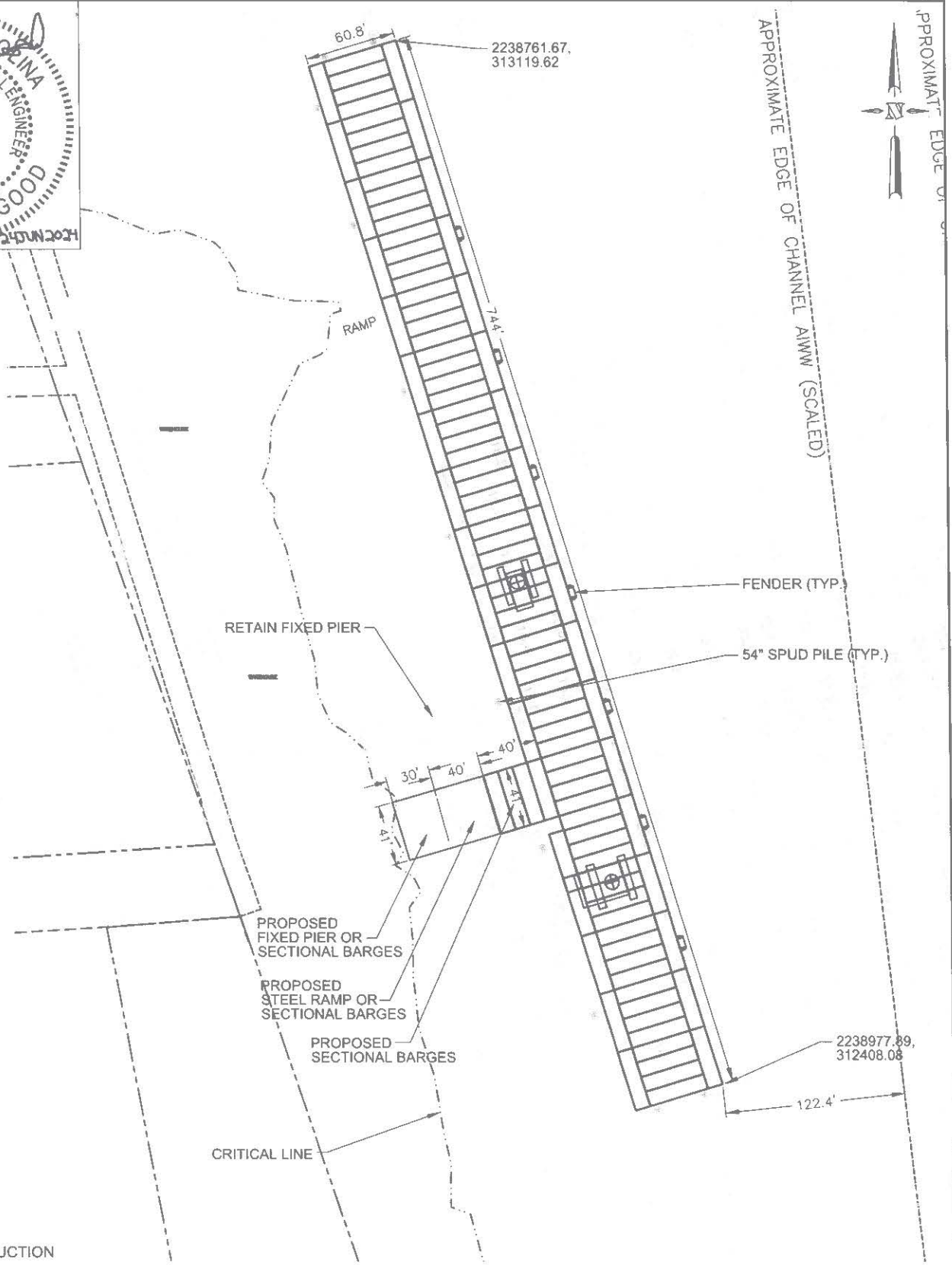

NOT FOR CONSTRUCTION

PURPOSE: SHIPYARD MODERNIZATION

ADJACENT PROPERTY OWNERS
SEE ATTACHED

SURVEY DATUM MLW

DATE: 06/03/2024

FIGURE 5
PROPOSED WORK BARGE SYSTEM

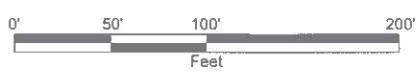

STEVENS TOWING COMPANY, INC.
4170 HIGHWAY 165
MEGGETT, SOUTH CAROLINA

PROPOSED: WORK BARGE SYSTEM & TRAVEL LIFT

AT: 4170 HIGHWAY 165, MEGGETT
SOUTH CAROLINA

IN: WADMALAW RIVER

COUNTY: CHARLESTON, SOUTH CAROLINA

FILE LOCATION: M:\ClientFiles\State - Stevens Towing\2024 Projects\stls00424 - 2024 Wadmalaw River Permitting\CAD\stls00424_perm.dwg LAYOUT TAB: 5
PLOTED: Jun 11, 2024 - 1:45pm BY: Thomas Patton

stlw00424

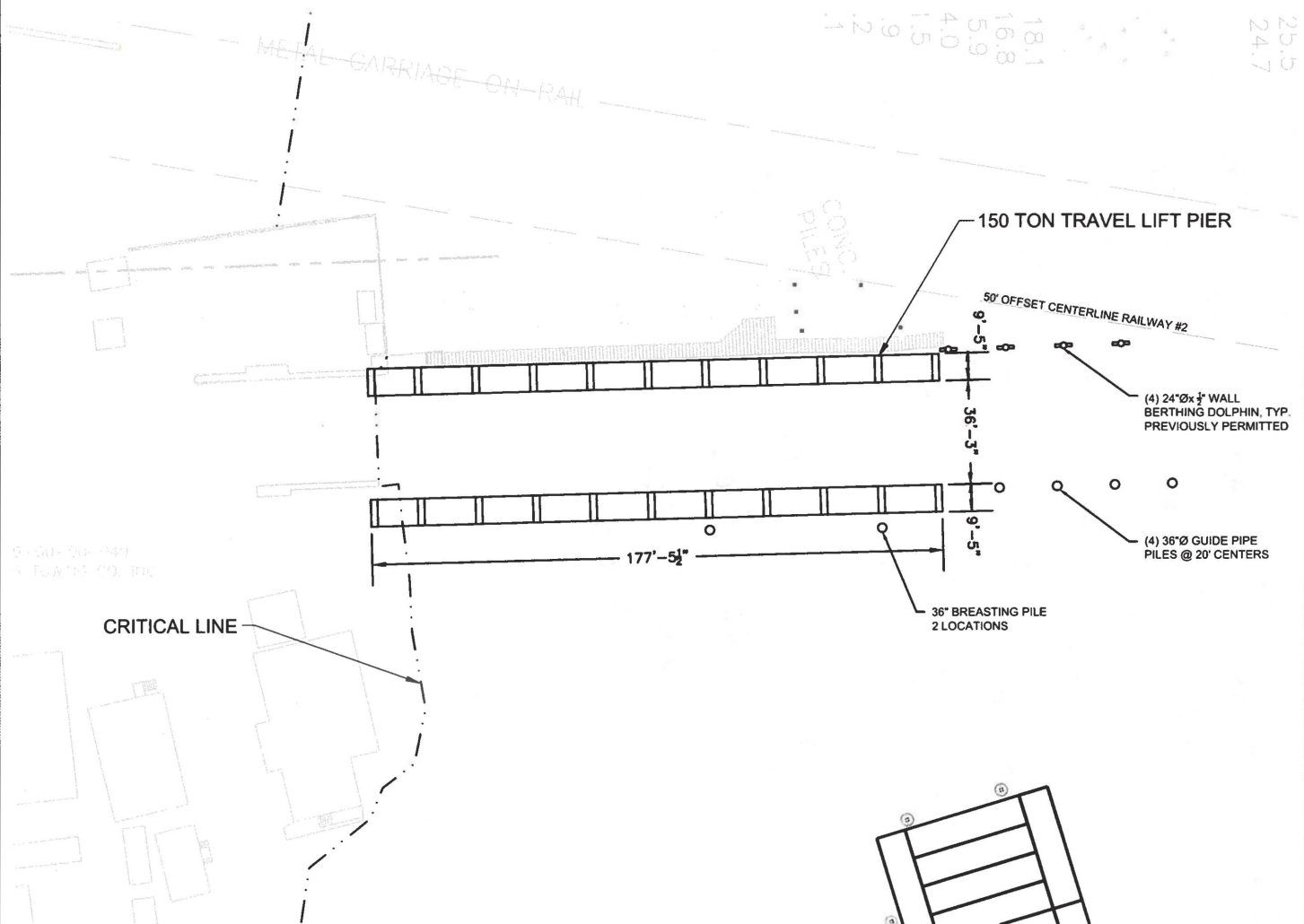

NOT FOR CONSTRUCTION

PURPOSE: SHIPYARD MODERNIZATION

ADJACENT PROPERTY OWNERS
SEE ATTACHED

SURVEY DATUM MLW

DATE: 06/03/2024

FIGURE 6
150 TON TRAVEL LIFT PIER

NOT TO SCALE

STEVENS TOWING COMPANY, INC.
4170 HIGHWAY 165
MEGGETT, SOUTH CAROLINA

PROPOSED: WORK BARGE SYSTEM & TRAVEL
LIFT

AT: 4170 HIGHWAY 165, MEGGGETT
SOUTH CAROLINA

IN: WADMALAW RIVER

COUNTY: CHARLESTON, SOUTH CAROLINA

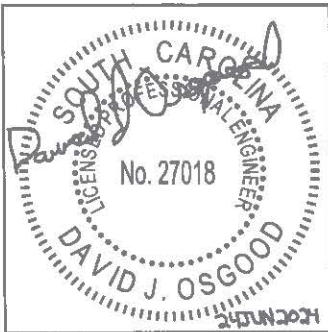

PLOTTED: Jun 11, 2024 - 1:45pm BY: Thomas Porten FILE LOCATION: M:\ClientFiles\Stevens Towing\2024 Waterfront Permitting\CAD\sttw00424_permit.dwg LAYOUT TAB: 7

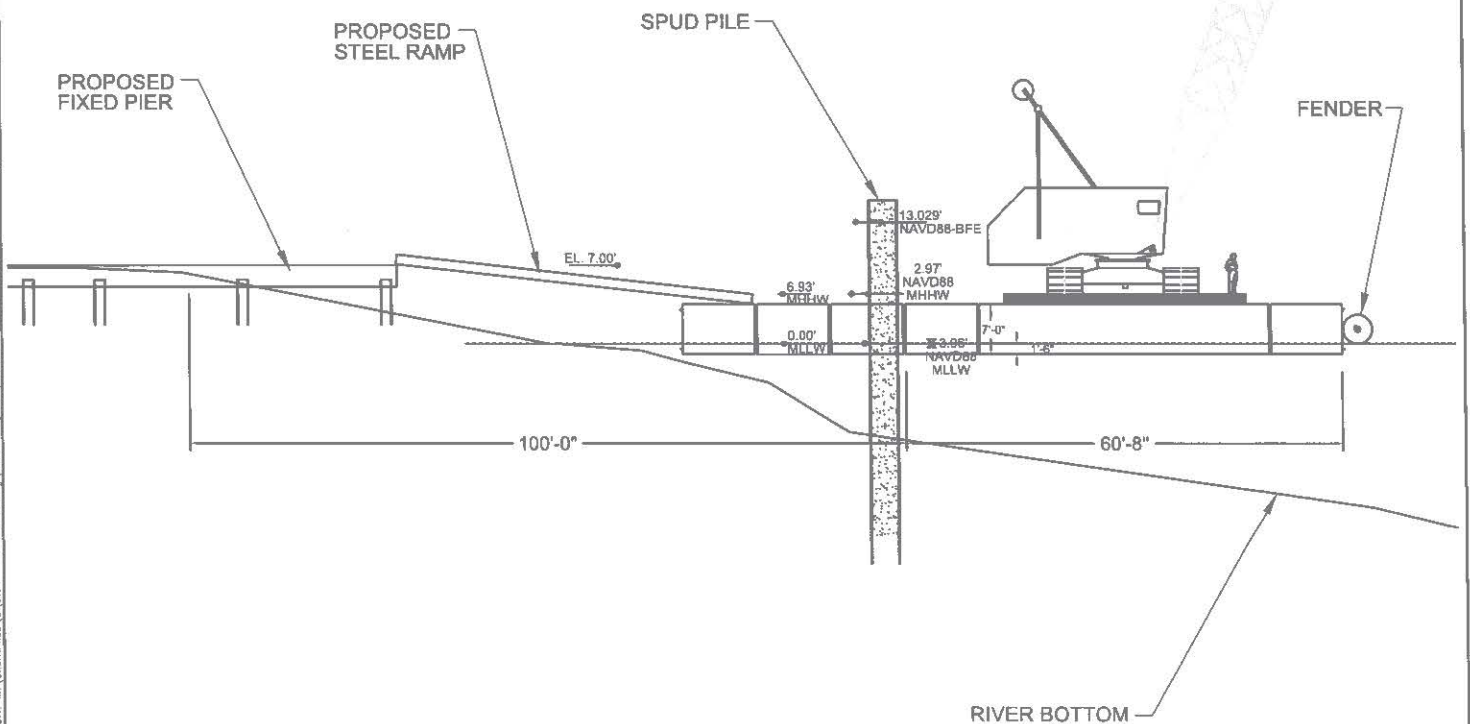

PURPOSE: SHIPYARD MODERNIZATION

ADJACENT PROPERTY OWNERS
SEE ATTACHED

SURVEY DATUM MLW

DATE: 06/03/2024

FIGURE 7
CROSS-SECTION
PROPOSED WORK BARGE SYSTEM

NOT TO SCALE

STEVENS TOWING COMPANY, INC.
4170 HIGHWAY 165
MEGGETT, SOUTH CAROLINA

PROPOSED: WORK BARGE SYSTEM & TRAVEL
LIFT

AT: 4170 HIGHWAY 165, MEGGETT
SOUTH CAROLINA

IN: WADMALAW RIVER

COUNTY: CHARLESTON, SOUTH CAROLINA

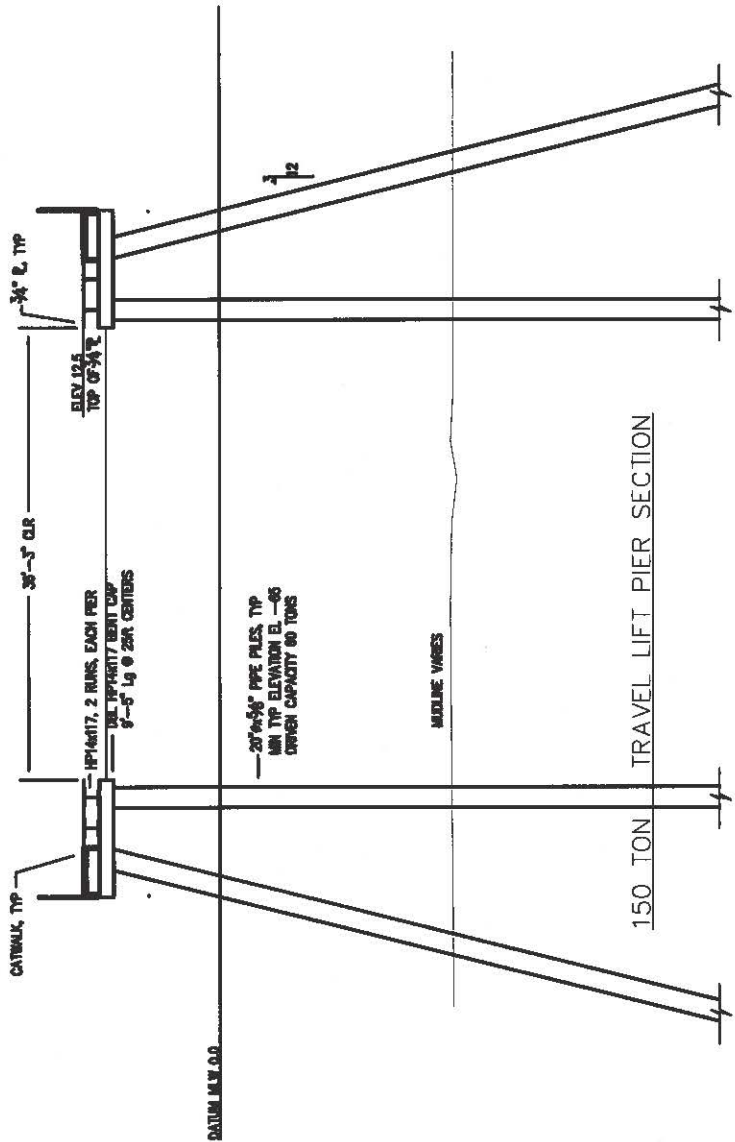
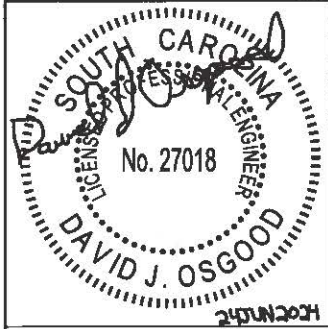

20 1/2" DIA. PILE PILES
TOP OF PILE 12.5
PILE TOP ELEV -10.0
4 LOCATIONS
PROVIDE TIMBER FACING ON ONE
SIDE AND PROVIDE CORNER GUARD
RAILS ON OTHER SIDE OF EACH
PILE

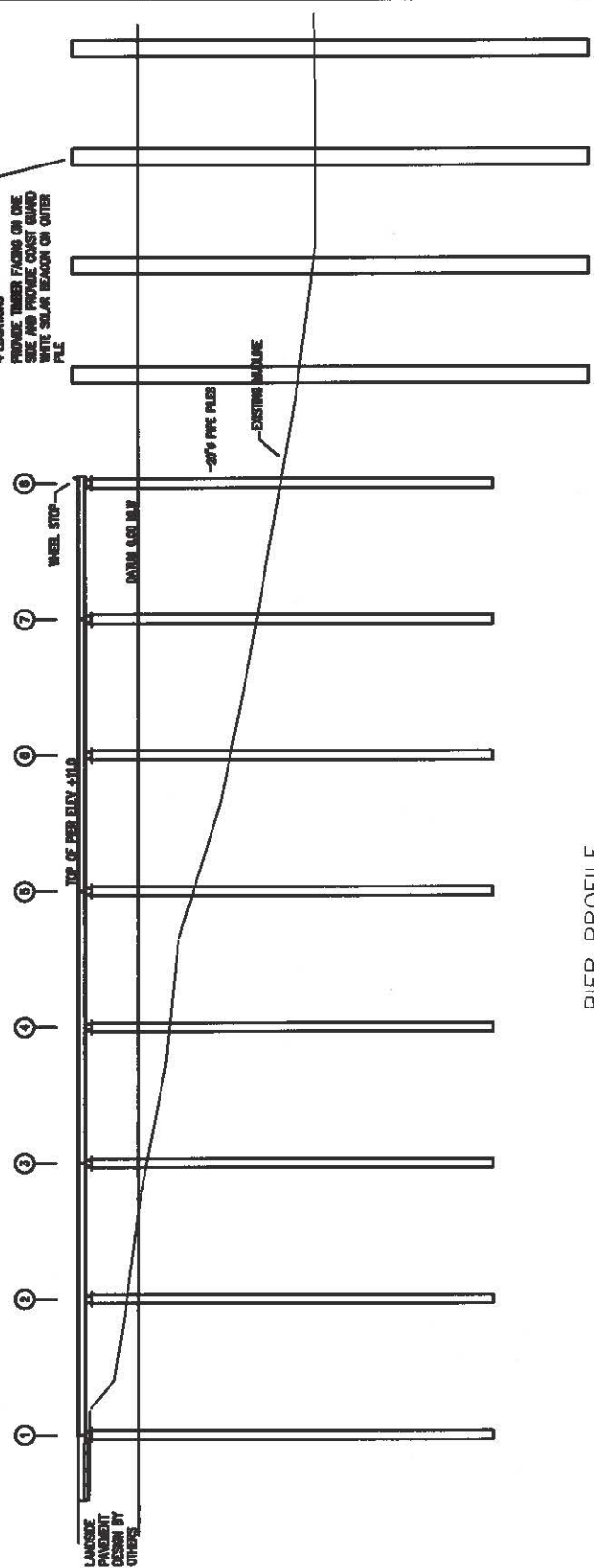

NOT FOR CONSTRUCTION

PURPOSE: SHIPYARD MODERNIZATION

ADJACENT PROPERTY OWNERS
SEE ATTACHED

SURVEY DATUM MLW

DATE: 06/03/2024

FIGURE 8
CROSS-SECTION
TRAVEL LIFT PIER

NOT TO SCALE

STEVENS TOWING COMPANY, INC.
4170 HIGHWAY 165
MEGGETT, SOUTH CAROLINA

PROPOSED: WORK BARGE SYSTEM & TRAVEL
LIFT

AT: 4170 HIGHWAY 165, MEGGETT
SOUTH CAROLINA

IN: WADMALAW RIVER

COUNTY: CHARLESTON, SOUTH CAROLINA