

JOINT
PUBLIC NOTICE

CHARLESTON DISTRICT, CORPS OF ENGINEERS
1949 Industrial Park Road, Room 140
Conway, South Carolina 29526

and

THE S.C. DEPARTMENT OF HEALTH AND ENVIRONMENTAL CONTROL
Office of Environmental Quality Control
Water Quality Certification and Wetlands Programs Section
2600 Bull Street
Columbia, South Carolina 29201

REGULATORY DIVISION

Refer to: P/N #2012-00265-4M

November 19, 2012

Pursuant to Section 10 of the Rivers and Harbors Act of 1899 (33 U.S.C. 403), and the S.C. Construction in Navigable Waters Permit Program (R. 19-450, et. seq., 1976 S.C. Code of Laws, as amended), an application has been submitted to the Department of the Army and the State of South Carolina by

HARRY WHITE, JR.
C/O RICHARD HADDOCK
EASTERN ENGINEERING LLC
P.O. BOX 1322
LAKE CITY, SOUTH CAROLINA 29560

for a permit to authorize an existing residential structure constructed partially in the

BLACK RIVER

located at the terminus of Red's Landing Road, north of the Town of Andrews, Williamsburg County, South Carolina. The property is described in the Williamsburg County Property Records as Tax Parcel # 14598. (Latitude 33.487096°N; Longitude: -79.546061°W).

In order to give all interested parties an opportunity to express their views

NOTICE

is hereby given that written statements regarding the proposed work will be received by both of the above mentioned offices until

15 Days from the Date of this Notice,

from those interested in the activity and whose interests may be affected by the proposed work.

The existing structure consists of a wood frame, one room house placed on top of an old water pump station on the edge of the Black River. The pump station, which dates back to the 1940's is constructed of concrete and bricks. The house is approximately 213 S.F. and is mounted to a steel structure that is built around the pump station. In addition to the home on top, a balcony of steel decking has been constructed on the side toward the river. The portion of the cantilevered balcony which extends over the Black River is approximately 9' x 22' (198 S.F.). The applicant proposes no mitigation due to the minimal impacts associated with the existing structure.

NOTE: Plans depicting the work described in this notice are available and will be provided, upon receipt of a written request, to anyone that is interested in obtaining a copy of the plans for the specific project. The request must identify the project of interest by public notice number and a self-addressed stamped envelope must also be provided for mailing the drawings to you. Your request for drawings should be addressed to the

**U.S. Army Corps of Engineers
ATTN: REGULATORY DIVISION
1949 Industrial Park Road, Room 140
Conway, South Carolina 29526**

The work shown on this application must be determined consistent with applicable provisions of the South Carolina Construction in Navigable Waters Permit Program. The applicant is hereby advised that supplemental information may be required by the State to facilitate the review. Persons wishing to comment or object to State navigable waters permit must submit all comments in writing to the S.C. Department of Health and Environmental Control at the above address within thirty (30) days of the date of this notice.

Preliminary review of the scope of work sought by this application indicates that State and Federal permits should be processed concurrently. If the Federal permit is issued in advance of the State's a special provision will be included in the Federal permit expressing the endorsement of the District Engineer to any revisions or conditions subsequently imposed by the State permit.

This notice initiates the Essential Fish Habitat (EFH) consultation requirements of the Magnuson-Stevens Fishery Conservation and Management Act. The existing structure impacted 0.005 acres of riverine shoreline which has not been identified as a Habitat Area of Particular Concern (HAPC) or EFH Areas Protected from Fishing (EFHA) according to the EFH Mapper. Our initial determination is that the existing structure has no effect on EFH or fisheries managed by the South Atlantic Fishery Management Council and the National Marine Fisheries Service (NMFS). Our final determination relative to project impacts and the need for mitigation measures is subject to review by and coordination with the NMFS.

The District Engineer has consulted the most recently available information and has determined that the project will have no effect on any Federally endangered, threatened, or proposed species and will not result in the destruction or adverse modification of designated or proposed critical habitat. This public notice serves as a request to the U.S. Fish and Wildlife Service and the National Marine Fisheries Service for any additional information they may have on whether any listed or proposed endangered or threatened species or designated or proposed critical habitat may be present in the area which would be affected by the activity, pursuant to Section 7(c) of the Endangered Species Act of 1973 (as amended).

Pursuant to Section 106 of the National Historic Preservation Act (NHPA), this public notice also constitutes a request to Indian Tribes to notify the District Engineer of any historic properties of religious and cultural significance to them that may be affected by the proposed undertaking.

In accordance with the NHPA, the District Engineer has also consulted the latest published version of the National Register of Historic Places for the presence or absence of registered properties, or properties listed as being eligible for inclusion therein, and this worksite is not included as a registered property or property listed as being eligible for inclusion in the Register. A review of available resources indicates that there are three (3) archaeological sites located in the near vicinity of the existing structure. These resources are identified as "38WG0107," "38WG0146," and "38GE0210" according to the ArchSite database. The status of these resources is unknown regarding eligibility for inclusion in the Register. To insure that other cultural resources that the District Engineer is not aware of are not overlooked, this public notice also serves as a request to the State Historic Preservation Office to provide any information it may have with regard to historic and cultural resources.

Any person may request, in writing, within the comment period specified in this notice, that a public hearing be held to consider this application. Requests for a public hearing shall state, with particularity, the reasons for holding a public hearing.

The decision whether to issue a permit will be based on an evaluation of the probable impact including cumulative impacts of the activity on the public interest. That decision will reflect the national concern for both protection and utilization of important resources. The benefit which reasonably may be expected to accrue from the project must be balanced against its reasonably foreseeable detriments. All factors which may be relevant to the project will be considered including the cumulative effects thereof; among those are conservation, economics, aesthetics, general environmental concerns, wetlands, historic properties, fish and wildlife values, flood hazards, flood plain values, land use, navigation, shoreline erosion and accretion, recreation, water supply and conservation, water quality, energy needs, safety, food and fiber production and, in general, the needs and welfare of the people. A permit will be granted unless the District Engineer determines that it would be contrary to the public interest. In cases of conflicting property rights, the Corps of Engineers cannot undertake to adjudicate rival claims.

The Corps of Engineers is soliciting comments from the public; Federal, state, and local agencies and officials; Indian Tribes; and other interested parties in order to consider and evaluate the impacts of this activity. Any comments received will be considered by the Corps of Engineers to determine whether to issue, modify, condition or deny a permit for this project. To make this decision, comments are used to assess impacts on endangered species, historic properties, water quality, general environmental effects, and the other public interest factors listed above. Comments are used in the preparation of an Environmental Assessment and/or an Environmental Impact Statement pursuant to the National Environmental Policy Act. Comments are also used to determine the need for a public hearing and to determine the overall public interest of the activity.

If there are any questions concerning this public notice, please contact Joshua Mitchell at 843-365-0583.

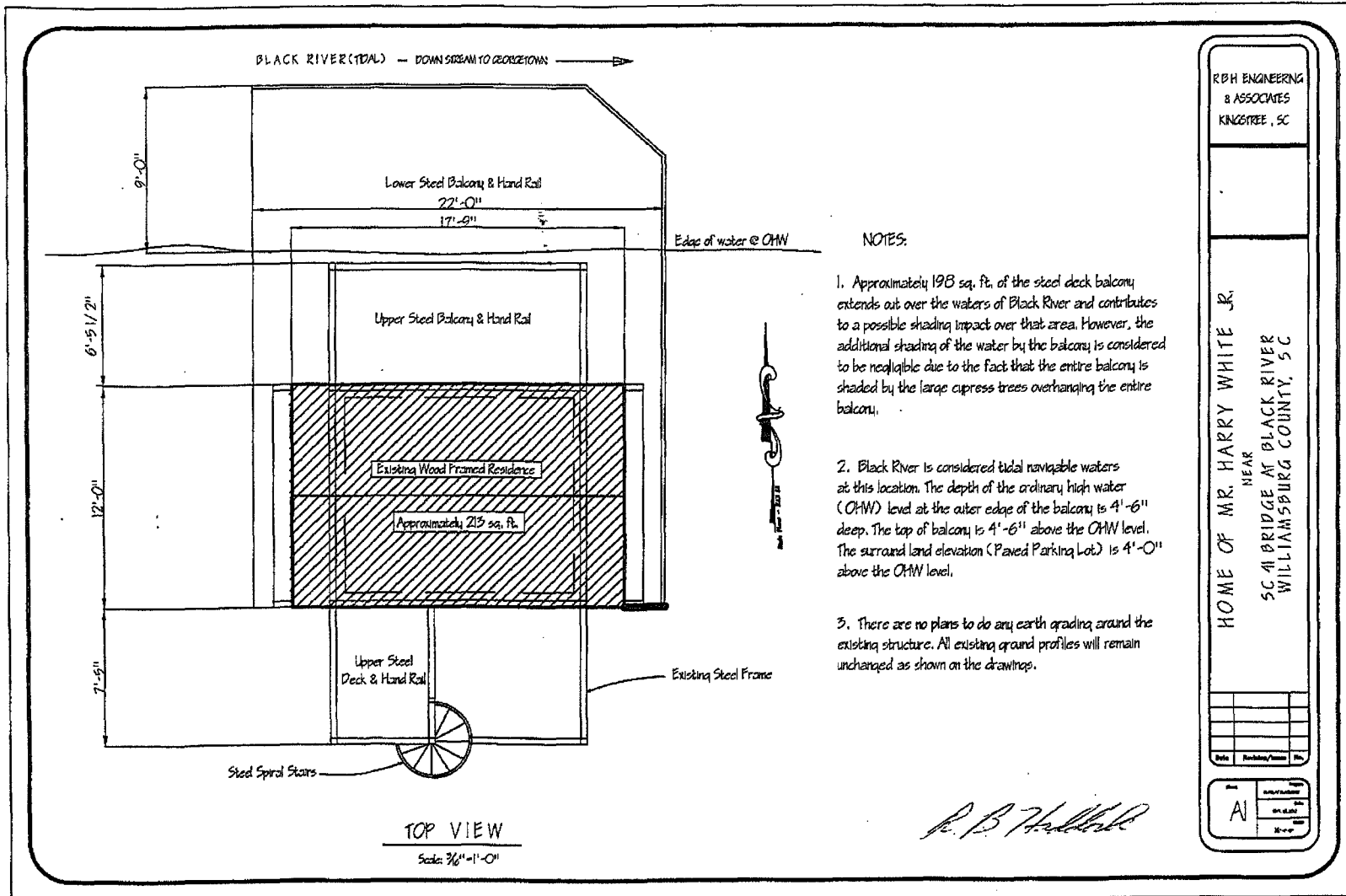

NOTES:

1. Approximately 198 sq. ft. of the steel deck balcony extends out over the waters of Black River and contributes to a possible shading impact over that area. However, the additional shading of the water by the balcony is considered to be negligible due to the fact that the entire balcony is shaded by the large cypress trees overhanging the entire balcony.
2. Black River is considered tidal navigable waters at this location. The depth of the ordinary high water (OHW) level at the outer edge of the balcony is 4'-6" deep. The top of balcony is 4'-6" above the OHW level. The surround land elevation (Paved Parking Lot) is 4'-0" above the OHW level.
3. There are no plans to do any earth grading around the existing structure. All existing ground profiles will remain unchanged as shown on the drawings.

R.B.H. ENGINEERING
& ASSOCIATES
KINGSTREE, SC

HOME OF MR. HARRY WHITE JR.
NEAR
SC 41 BRIDGE AT BLACK RIVER
WILLIAMSBURG COUNTY, SC

Date	Revised/Amend	By

A1	Scale	3/16" = 1'-0"
	Sheet No.	1 of 3

R. B. Hall

SAC-2012-00265-4M
Reds Landing Residence
November 16, 2012
Sheet 1 of 3

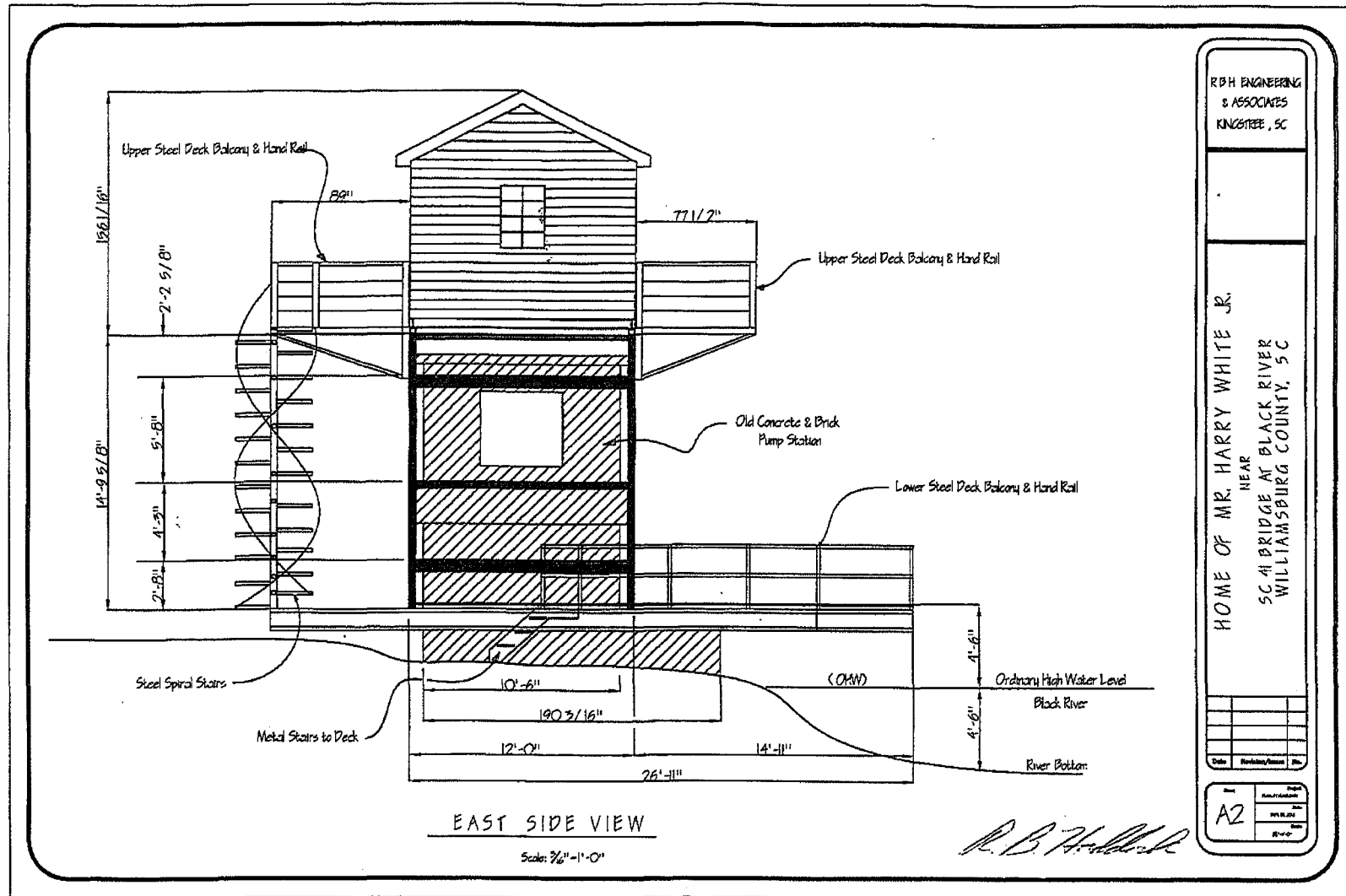

R B H ENGINEERING
 & ASSOCIATES
 KINGSTREE, SC

HOME OF MR. HARRY WHITE JR.
 NEAR
 SC 41 BRIDGE AT BLACK RIVER
 WILLIAMSBURG COUNTY, SC

Date	Revisions/Issues	By

A2	

SAC-2012-00265-4M
 Reds Landing Residence
 November 16, 2012
 Sheet 2 of 3

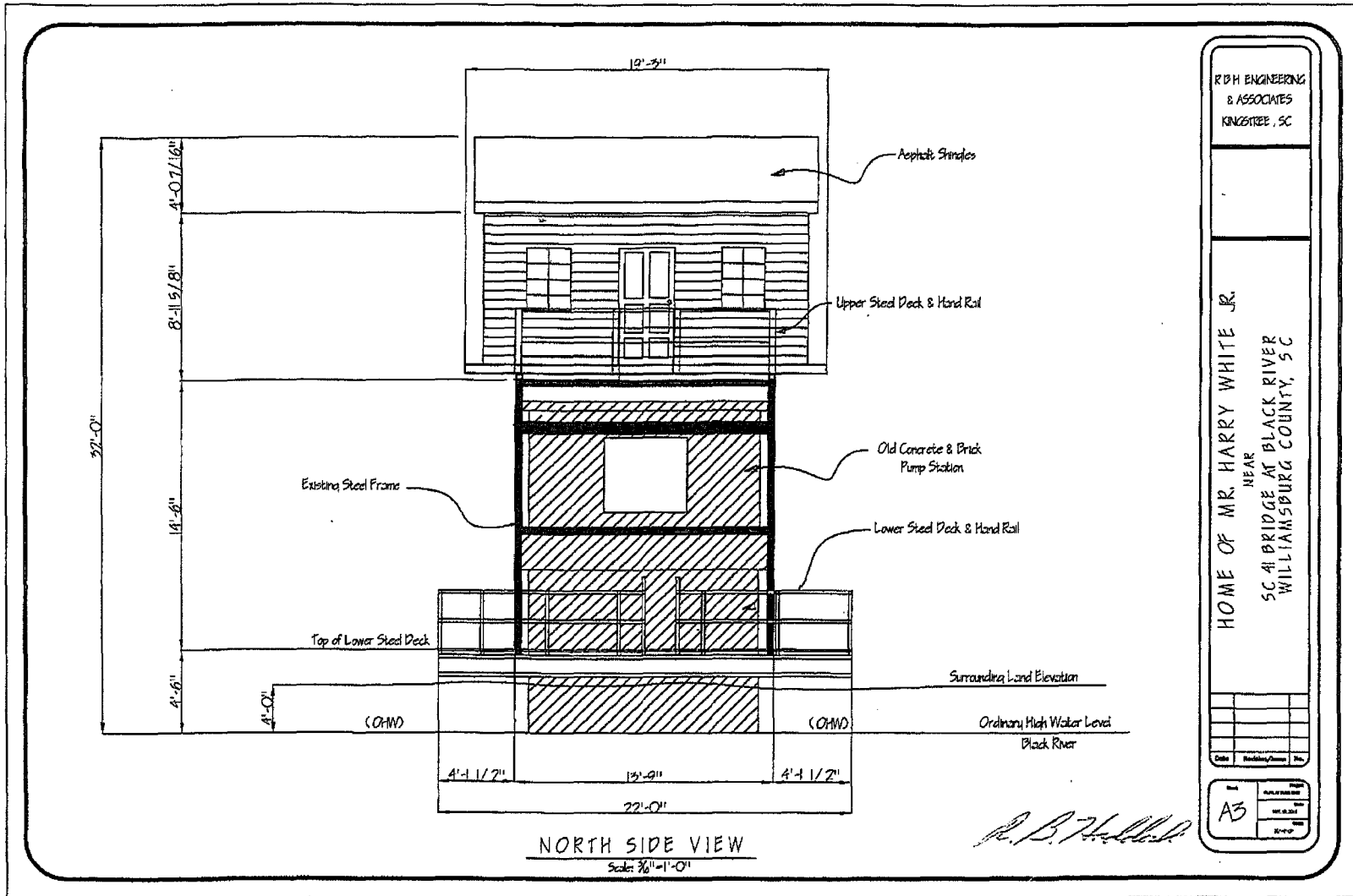

SAC-2012-00265-4M
 Reds Landing Residence
 November 16, 2012
 Sheet 3 of 3