

**JOINT**  
**PUBLIC NOTICE**

**CHARLESTON DISTRICT, CORPS OF ENGINEERS**  
**69A Hagood Avenue**  
**Charleston, SC 29403**  
**and**  
**THE S.C. DEPARTMENT OF HEALTH AND ENVIRONMENTAL CONTROL**  
**Water Quality Certification and Wetlands Section**  
**2600 Bull Street**  
**Columbia, South Carolina 29201**

REGULATORY DIVISION  
Refer to: P/N SAC-2018-00160

15 APRIL 2020

Pursuant to Sections 401 and 404 of the Clean Water Act (33 U.S.C. 1344), and the South Carolina Coastal Zone Management Act (48-39-10 et.seq.), an application has been submitted to the Department of the Army and the S.C. Department of Health and Environmental Control by

**Charleston County**  
**4045 Bridge View Drive, Suite C204**  
**North Charleston, South Carolina 29405**

for a permit to construct a new interchange connecting Palmetto Commerce Parkway and Ingleside Boulevard with I-26 at Mile Marker 206 in

wetlands and streams associated with Bluehouse Swamp and Goose Creek

at a location adjacent to I-26 and Ingleside Boulevard, Charleston County, South Carolina (Latitude: 32.966°, Longitude: -80.074°), Ladson Quadrangle.

In order to give all interested parties an opportunity to express their views

**NOTICE**

is hereby given that written statements regarding the proposed work will be received by the **Corps** until

**15 Days from the Date of this Notice,**

and **SCDHEC** will receive written statements regarding the proposed work until

**30 Days from the Date of this Notice**

from those interested in the activity and whose interests may be affected by the proposed work.

The proposed work consists of constructing roads, overpass structures, and stormwater treatment facilities necessary to establish a new interchange with Interstate 26 at Mile Marker 206. In detail the proposed work will require the placement of fill material within 4.69 acres of wetlands and 1,459.51 linear feet of other waters of the United States. The applicant has proposed to mitigate for impacts to wetlands and/or waters of the United States by purchasing credits available at the Palmetto Umbrella Mitigation Bank—Big Run Mitigation Site. The project purpose is to

provide the transportation infrastructure necessary to improve mobility and reduce travel times for both existing and projected future traffic conditions in a developing area of Charleston County. The project will specifically provide improved travel times and access options to the centers along Palmetto Commerce Parkway and Ingleside Boulevard, improve traffic mobility for the area served by Ashley Phosphate Road/I-26 interchange, and provide more efficient commute options. Additionally, the proposed project is to complement existing and planned economic development in the area by improving access to the nearby commercial, industrial and mixed-use high employment areas.

**NOTE: This public notice and associated plans are available on the Corps' website at: <http://www.sac.usace.army.mil/Missions/Regulatory/PublicNotices> .**

The District Engineer has concluded that the discharges associated with this project, both direct and indirect, should be reviewed by the South Carolina Department of Health and Environmental Control in accordance with provisions of Section 401 of the Clean Water Act. As such, this notice constitutes a request, on behalf of the applicant, for certification that this project will comply with applicable effluent limitations and water quality standards. The work shown on this application must also be certified as consistent with applicable provisions of the Coastal Zone Management Program (15 CFR 930). This activity may also require evaluation for compliance with the S. C. Construction in Navigable Waters Permit Program. State review, permitting and certification is conducted by the S. C. Department of Health and Environmental Control. The District Engineer will not process this application to a conclusion until such certifications are received. The applicant is hereby advised that supplemental information may be required by the State to facilitate the review.

This notice initiates the Essential Fish Habitat (EFH) consultation requirements of the Magnuson-Stevens Fishery Conservation and Management Act. Implementation of the proposed project would impact 4.69 acres of wetlands and 1,459.51 linear feet of freshwater streams situated inland of estuarine substrates and emergent wetlands utilized by various life stages of species comprising the shrimp, and snapper-grouper management complexes. The District Engineer's initial determination is that the proposed action would not have a substantial individual or cumulative adverse impact on EFH or fisheries managed by the South Atlantic Fishery Management Council and the National Marine Fisheries Service (NMFS). The District Engineer's final determination relative to project impacts and the need for mitigation measures is subject to review by and coordination with the NMFS.

Pursuant to Section 7 of the Endangered Species Act of 1973 (as amended), the applicant has provided a protected species survey for the property associated with the activity described above as well as the results of consultation concluded by Federal Highway Administration. Based upon this report and the previous federal action agency determination, the District Engineer has determined that the project is not likely to adversely affect any Federally endangered, threatened, or proposed species or result in the destruction or adverse modification of designated or proposed critical habitat. This public notice serves to advise the Services that no further consultation pursuant to Section 7 of the Endangered Species Act (as amended) will occur.

Pursuant to Section 106 of the National Historic Preservation Act (NHPA), this public notice also constitutes a request to Indian Tribes to notify the District Engineer of any historic properties of religious and cultural significance to them that may be affected by the proposed undertaking.

In accordance with Section 106 of the NHPA, the District Engineer has consulted South

Carolina ArchSite (GIS) for the presence or absence of historic properties (as defined in 36 C.F.R. 800.16)(f)(1) and has reviewed the determination of no effect on historic properties previously made by South Carolina Department of Transportation on behalf of Federal Highway Administration, with concurrence of the State Historic Preservation Officer (SHPO). Based thereon, the District Engineer has determined that no historic properties are present; therefore, there will be no effect on historic properties. To ensure that other historic properties that the District Engineer is not aware of are not overlooked, this public notice also serves as a request to the SHPO and any other interested parties to provide any information they may have with regard to historic properties. This public notice serves as a request for concurrence within 30 days from the SHPO (and/or Tribal Historic Preservation Officer).

Any person may request, in writing, within the comment period specified in this notice, that a public hearing be held to consider this application. Requests for a public hearing shall state, with particularity, the reasons for holding a public hearing.

The decision whether to issue a permit will be based on an evaluation of the probable impacts including cumulative impacts of the activity on the public interest and will include application of the guidelines promulgated by the Administrator, Environmental Protection Agency (EPA), under authority of Section 404(b) of the Clean Water Act. That decision will reflect the national concern for both protection and utilization of important resources. The benefit which reasonably may be expected to accrue from the project must be balanced against its reasonably foreseeable detriments. All factors which may be relevant to the project will be considered including the cumulative effects thereof; among those are conservation, economics, aesthetics, general environmental concerns, wetlands, historic properties, fish and wildlife values, flood hazards, flood plain values, land use, navigation, shoreline erosion and accretion, recreation, water supply and conservation, water quality, energy needs, safety, food and fiber production and, in general, the needs and welfare of the people. A permit will be granted unless the District Engineer determines that it would be contrary to the public interest. In cases of conflicting property rights, the Corps cannot undertake to adjudicate rival claims.

The Corps is soliciting comments from the public; Federal, state, and local agencies and officials; Indian Tribes; and other interested parties in order to consider and evaluate the impacts of this activity. Any comments received will be considered by the Corps to determine whether to issue, modify, condition or deny a permit for this project. To make this decision, comments are used to assess impacts on endangered species, historic properties, water quality, general environmental effects, and the other public interest factors listed above. Comments are used in the preparation of an Environmental Assessment and/or an Environmental Impact Statement pursuant to the National Environmental Policy Act. Comments are also used to determine the need for a public hearing and to determine the overall public interest of the activity. **Please submit comments in writing, identifying the project of interest by public notice number, to the following address:**

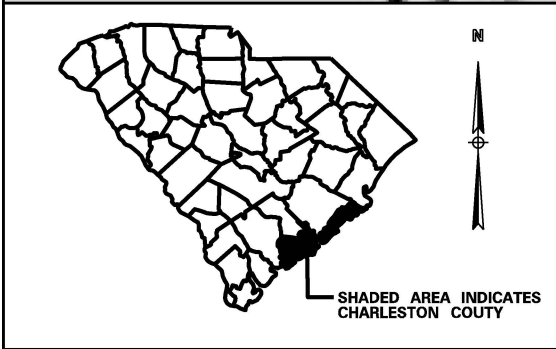

**U.S. Army Corps of Engineers  
ATTN: REGULATORY DIVISION  
69A Hagood Avenue  
Charleston, SC 29403**

If there are any questions concerning this public notice, please contact Richard L. Darden, Ph.D., Project Manager, at (843) 329-8043, toll free at 1-866-329-8187, or by email at [Richard.L.Darden@usace.army.mil](mailto:Richard.L.Darden@usace.army.mil).

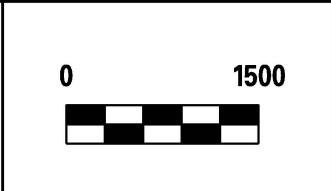

PREPARED BY:  
**DAVIS &  
 FLOYD, INC.**  
 CHARLESTON, SC



LEGEND	
	PROJECT STUDY AREA
	PROPOSED PAVEMENT
	LIMITS OF CONSTRUCTION

**PALMETTO COMMERCE INTERCHANGE  
 CHARLESTON COUNTY, SC**  
 APPLICATION BY CHARLESTON COUNTY  
 FEBRUARY 2020

VICINITY MAP

---

SHEET 1



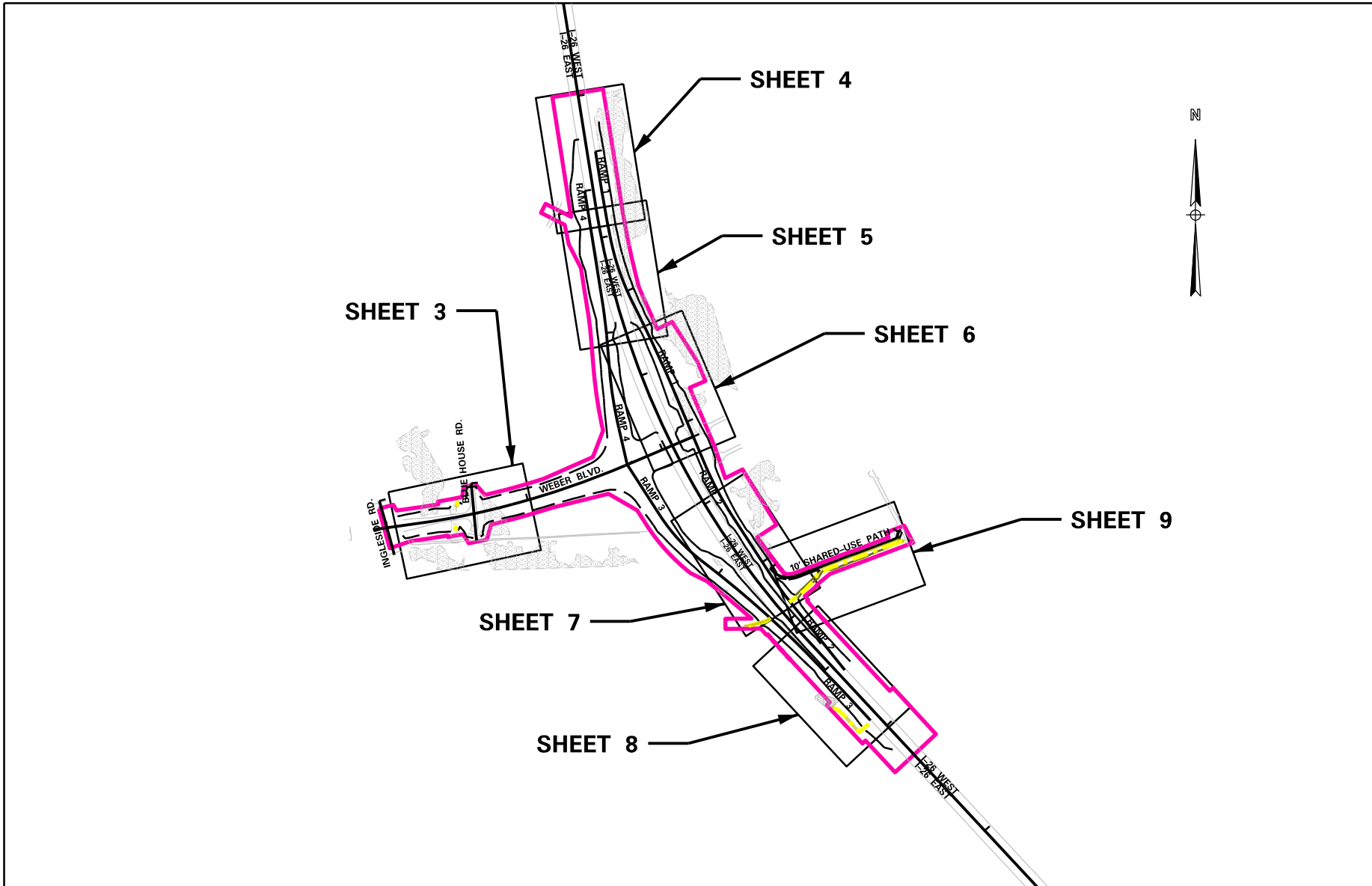

PREPARED BY:  
**DAVIS &  
 FLOYD, INC.**  
 CHARLESTON, SC

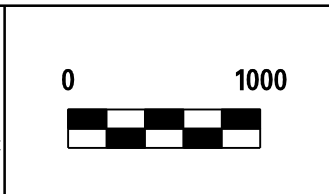

LEGEND	
PROJECT AREA BOUNDARY	WETLAND
EXISTING ROAD LIMITS OF CONSTRUCTION	TRIBUTARY IMPACT

**PALMETTO COMMERCE INTERCHANGE**  
 CHARLESTON COUNTY, SC  
 APPLICATION BY CHARLESTON COUNTY  
 FEBRUARY 2020

**PERMIT DRAWING**  
**PLAN SHEET**  
**LAYOUT INDEX**

---

**SHEET 2**

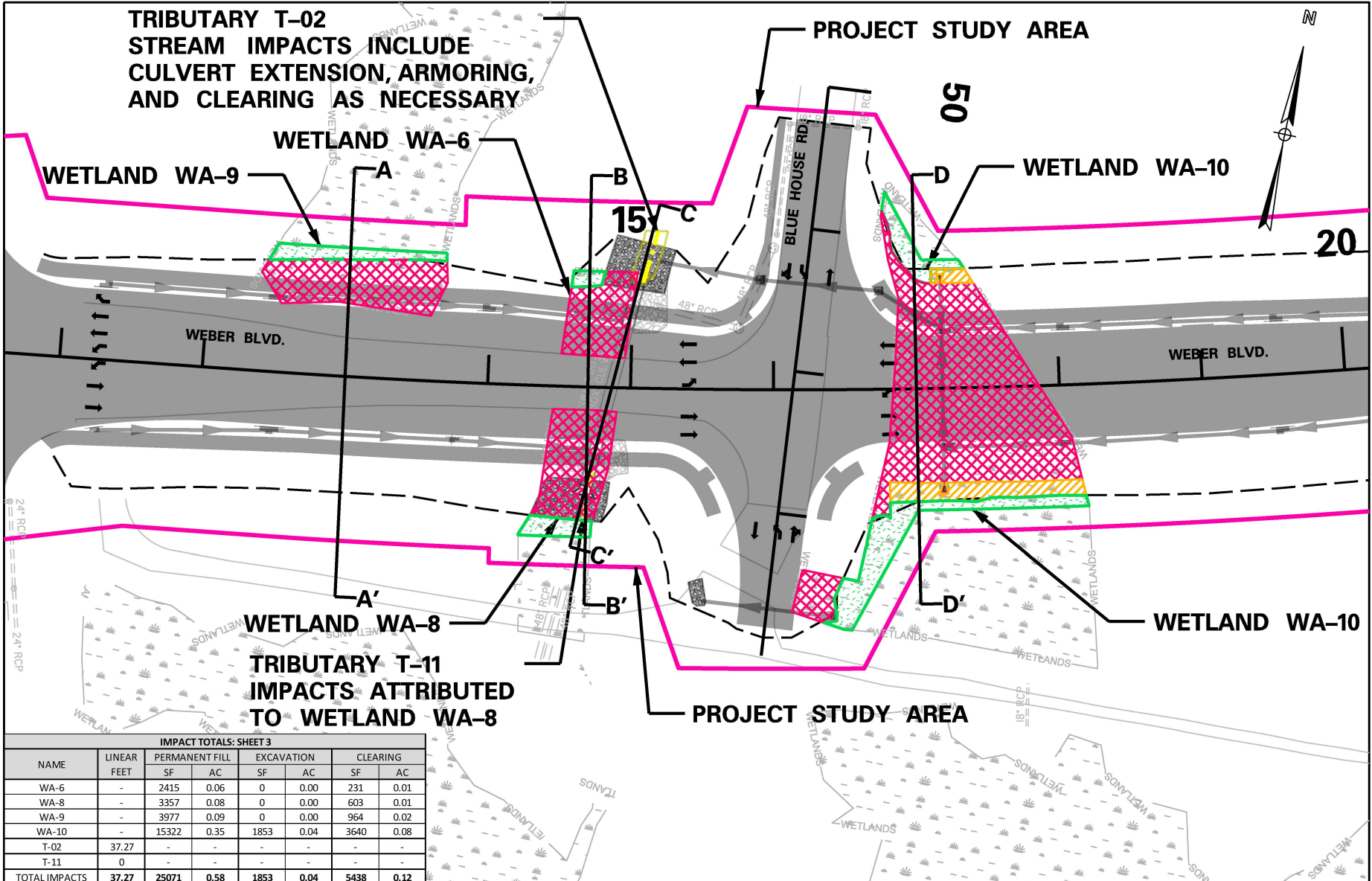

**TRIBUTARY T-02  
STREAM IMPACTS INCLUDE  
CULVERT EXTENSION, ARMORING,  
AND CLEARING AS NECESSARY**

**PROJECT STUDY AREA**

**WETLAND WA-6**

**WETLAND WA-9**

**WETLAND WA-10**

**WEBER BLVD.**

**WEBER BLVD.**

**BLUE HOUSE RD.**

**WETLAND WA-8**

**WETLAND WA-10**

**TRIBUTARY T-11  
IMPACTS ATTRIBUTED  
TO WETLAND WA-8**

**PROJECT STUDY AREA**

**IMPACT TOTALS: SHEET 3**

NAME	LINEAR FEET	PERMANENT FILL		EXCAVATION		CLEARING	
		SF	AC	SF	AC	SF	AC
WA-6	-	2415	0.06	0	0.00	231	0.01
WA-8	-	3357	0.08	0	0.00	603	0.01
WA-9	-	3977	0.09	0	0.00	964	0.02
WA-10	-	15322	0.35	1853	0.04	3640	0.08
T-02	37.27	-	-	-	-	-	-
T-11	0	-	-	-	-	-	-
<b>TOTAL IMPACTS</b>	<b>37.27</b>	<b>25071</b>	<b>0.58</b>	<b>1853</b>	<b>0.04</b>	<b>5438</b>	<b>0.12</b>

**PREPARED BY:  
DAVIS &  
FLOYD, INC.  
CHARLESTON, SC**



**LEGEND**

- PERMANENT FILL IMPACT
- EXCAVATION IMPACT
- PERMANENT CLEARING IMPACT
- PROJECT AREA BOUNDARY
- TRIBUTARY IMPACT
- RIP RAP
- WETLAND
- PROPOSED PAVEMENT
- EXISTING ROAD
- LIMITS OF CONSTRUCTION

**PALMETTO COMMERCE INTERCHANGE  
CHARLESTON COUNTY, SC  
APPLICATION BY CHARLESTON COUNTY  
FEBRUARY 2020**

**WETLANDS WA-6, WA-8,  
WA-9, AND WA-10  
TRIBUTARIES T-02  
AND T-11**

**SHEET 3**

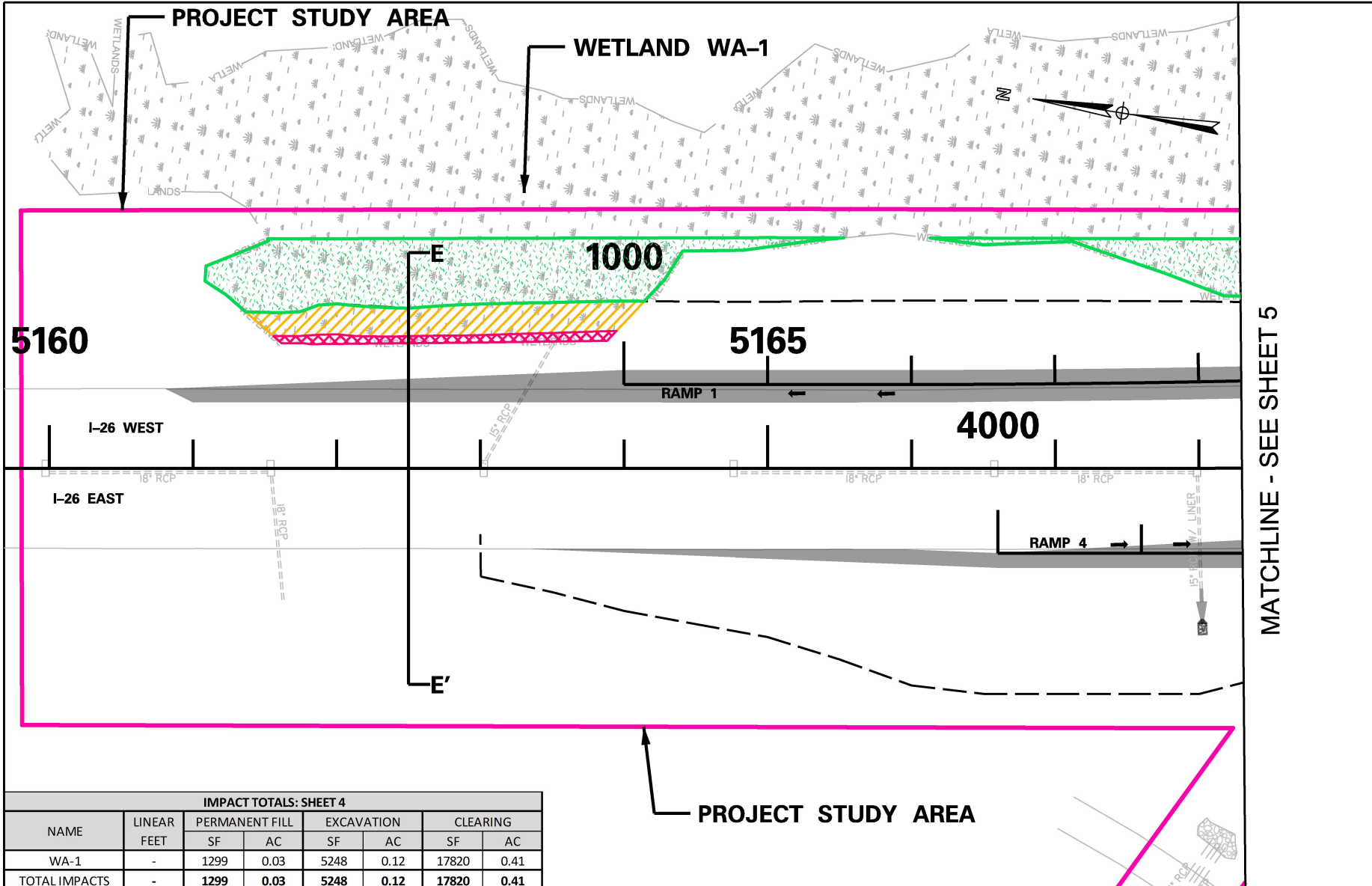

MATCHLINE - SEE SHEET 5

IMPACT TOTALS: SHEET 4

NAME	LINEAR FEET	PERMANENT FILL		EXCAVATION		CLEARING	
		SF	AC	SF	AC	SF	AC
WA-1	-	1299	0.03	5248	0.12	17820	0.41
TOTAL IMPACTS	-	1299	0.03	5248	0.12	17820	0.41

**PREPARED BY:**  
**DAVIS & FLOYD, INC.**  
**CHARLESTON, SC**

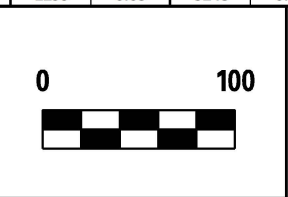

**LEGEND**

PERMANENT FILL IMPACT	RIP RAP
EXCAVATION IMPACT	WETLAND
PERMANENT CLEARING IMPACT	PROPOSED PAVEMENT
PROJECT AREA BOUNDARY	EXISTING ROAD
TRIBUTARY IMPACT	LIMITS OF CONSTRUCTION

**PALMETTO COMMERCE INTERCHANGE**  
**CHARLESTON COUNTY, SC**  
**APPLICATION BY CHARLESTON COUNTY**  
**FEBRUARY 2020**

**WETLAND WA-1**

---

**SHEET 4**

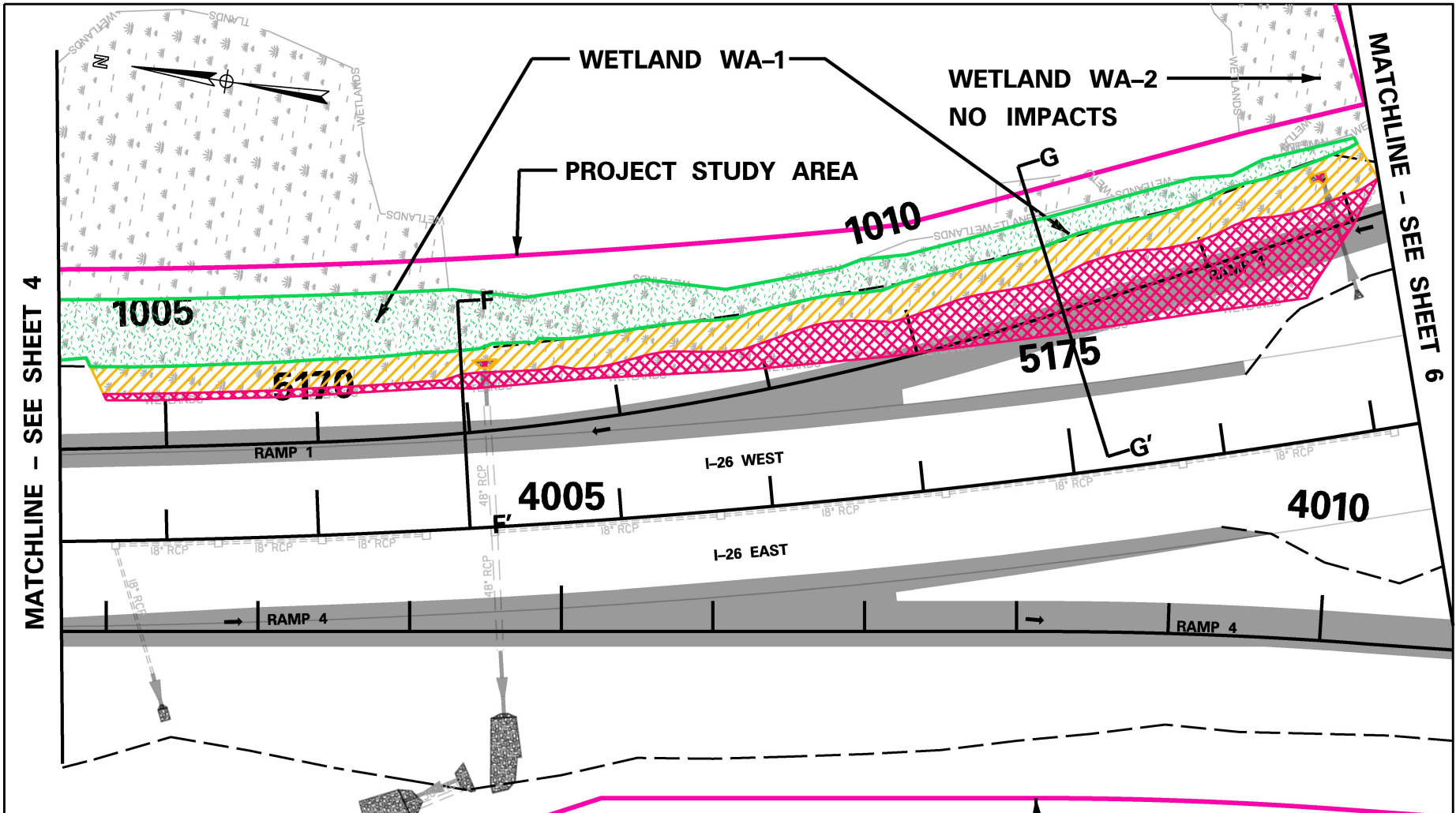

IMPACT TOTALS: SHEET 5

NAME	LINEAR FEET	PERMANENT FILL		EXCAVATION		CLEARING	
		SF	AC	SF	AC	SF	AC
WA-1	-	18271	0.42	17406	0.40	23271	0.53
WA-2	-	0	0.00	0	0.00	0	0.00
TOTAL IMPACTS	-	18271	0.42	17406	0.40	23271	0.53

PREPARED BY:  
DAVIS &  
FLOYD, INC.  
CHARLESTON, SC



LEGEND

- PERMANENT FILL IMPACT
- EXCAVATION IMPACT
- PERMANENT CLEARING IMPACT
- PROJECT AREA BOUNDARY
- TRIBUTARY IMPACT
- RIP RAP
- WETLAND
- PROPOSED PAVEMENT
- EXISTING ROAD
- LIMITS OF CONSTRUCTION

PALMETTO COMMERCE INTERCHANGE  
CHARLESTON COUNTY, SC  
APPLICATION BY CHARLESTON COUNTY  
FEBRUARY 2020

WETLANDS WA-1  
AND WA-2



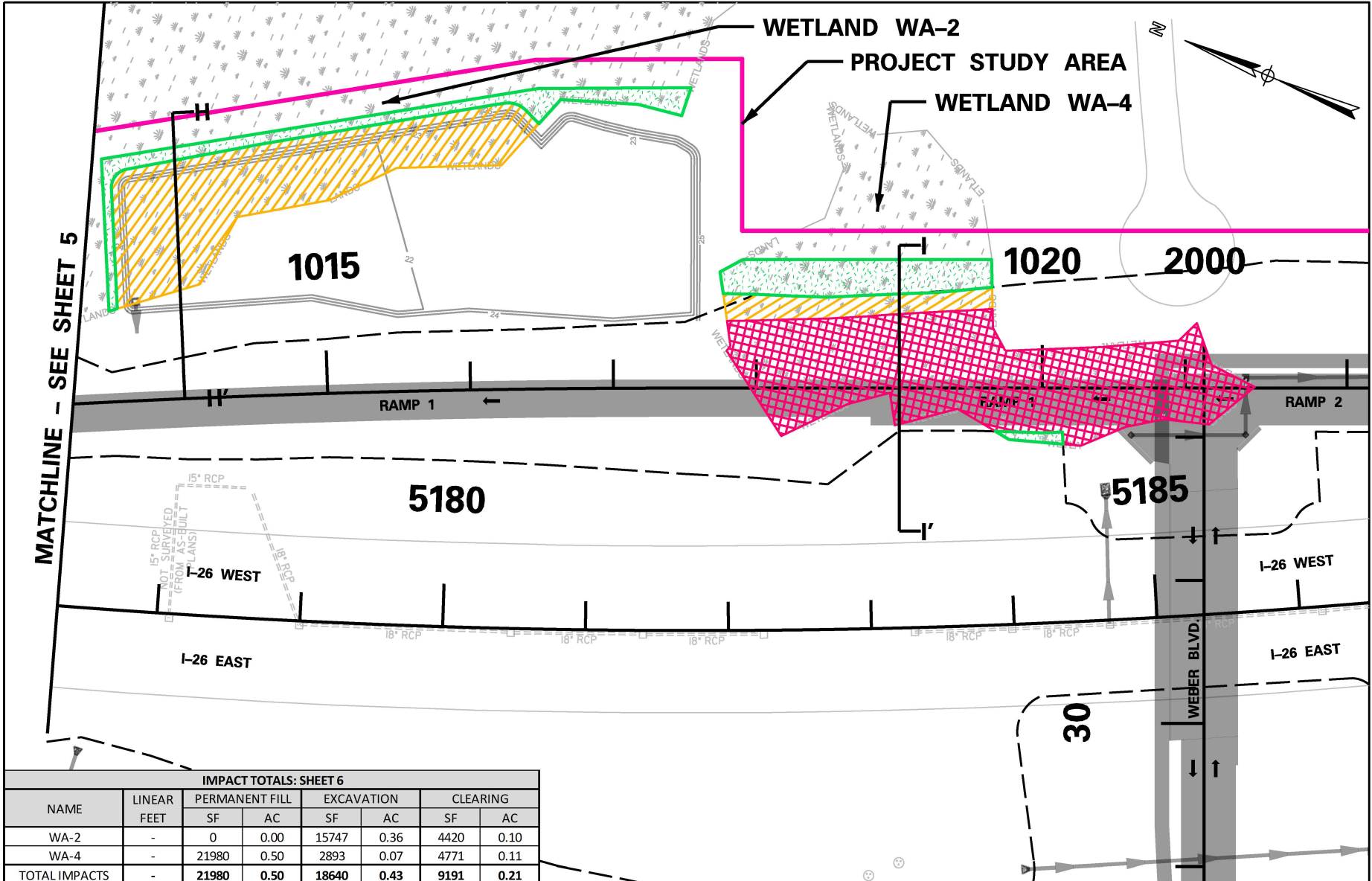

**IMPACT TOTALS: SHEET 6**

NAME	LINEAR FEET	PERMANENT FILL		EXCAVATION		CLEARING	
		SF	AC	SF	AC	SF	AC
WA-2	-	0	0.00	15747	0.36	4420	0.10
WA-4	-	21980	0.50	2893	0.07	4771	0.11
<b>TOTAL IMPACTS</b>	-	<b>21980</b>	<b>0.50</b>	<b>18640</b>	<b>0.43</b>	<b>9191</b>	<b>0.21</b>

**PREPARED BY:  
DAVIS &  
FLOYD, INC.  
CHARLESTON, SC**



**LEGEND**

PERMANENT FILL IMPACT	RIP RAP
EXCAVATION IMPACT	WETLAND
PERMANENT CLEARING IMPACT	PROPOSED PAVEMENT
PROJECT AREA BOUNDARY	EXISTING ROAD
TRIBUTARY IMPACT	LIMITS OF CONSTRUCTION

**PALMETTO COMMERCE INTERCHANGE  
CHARLESTON COUNTY, SC  
APPLICATION BY CHARLESTON COUNTY  
FEBRUARY 2020**

**WETLANDS WA-2  
AND WA-4**

---

**SHEET 6**



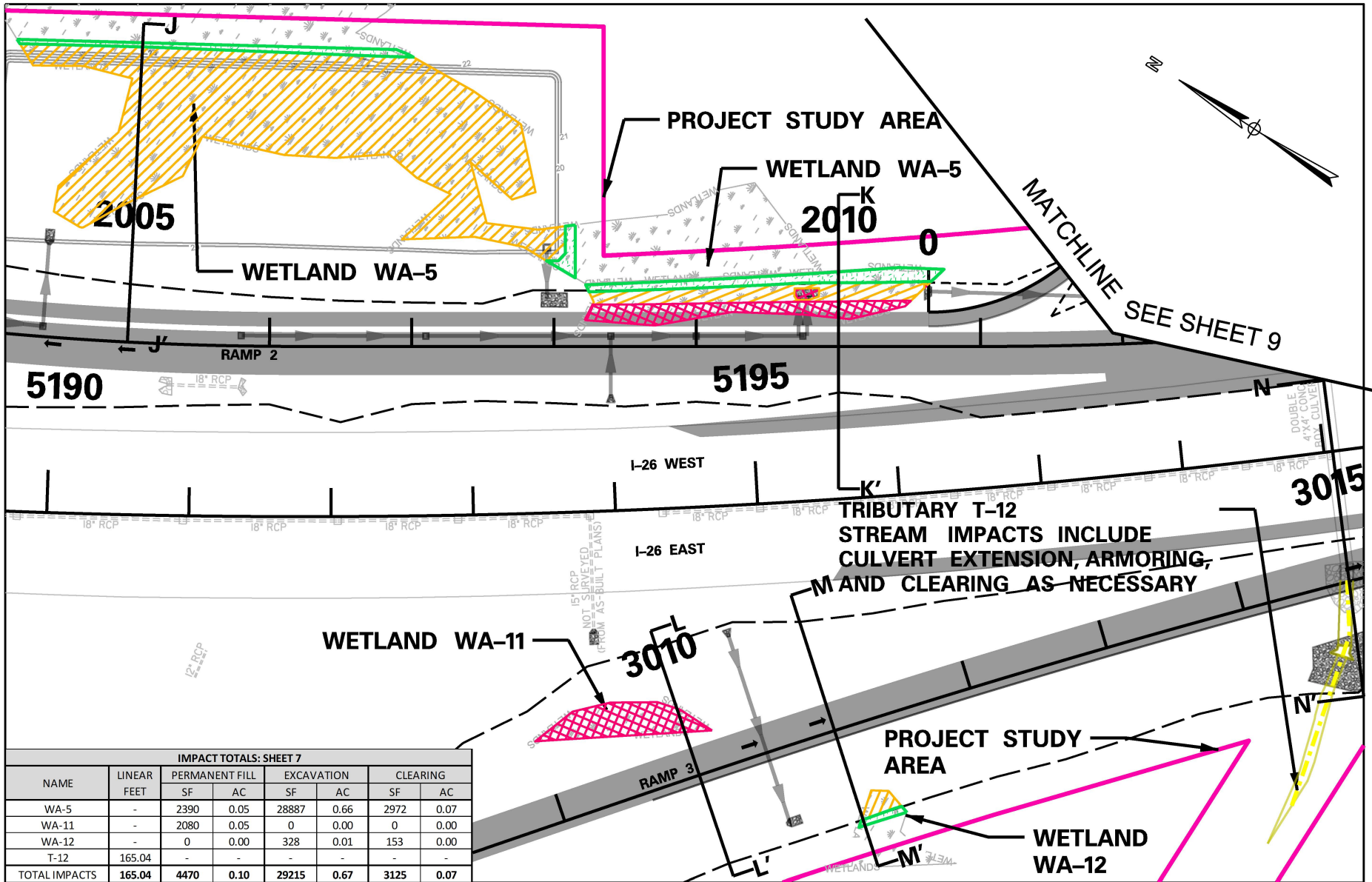

**IMPACT TOTALS: SHEET 7**

NAME	LINEAR FEET	PERMANENT FILL		EXCAVATION		CLEARING	
		SF	AC	SF	AC	SF	AC
WA-5	-	2390	0.05	28887	0.66	2972	0.07
WA-11	-	2080	0.05	0	0.00	0	0.00
WA-12	-	0	0.00	328	0.01	153	0.00
T-12	165.04	-	-	-	-	-	-
<b>TOTAL IMPACTS</b>	<b>165.04</b>	<b>4470</b>	<b>0.10</b>	<b>29215</b>	<b>0.67</b>	<b>3125</b>	<b>0.07</b>

**PREPARED BY:  
DAVIS &  
FLOYD, INC.  
CHARLESTON, SC**

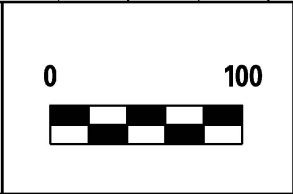

**LEGEND**

PERMANENT FILL IMPACT	RIP RAP
EXCAVATION IMPACT	WETLAND
PERMANENT CLEARING IMPACT	PROPOSED PAVEMENT
PROJECT AREA BOUNDARY	EXISTING ROAD
TRIBUTARY IMPACT	LIMITS OF CONSTRUCTION

**PALMETTO COMMERCE INTERCHANGE  
CHARLESTON COUNTY, SC  
APPLICATION BY CHARLESTON COUNTY  
FEBRUARY 2020**

**WETLANDS WA-5,  
WA-11, AND WA-12  
TRIBUTARY T-12**

**SHEET 7**

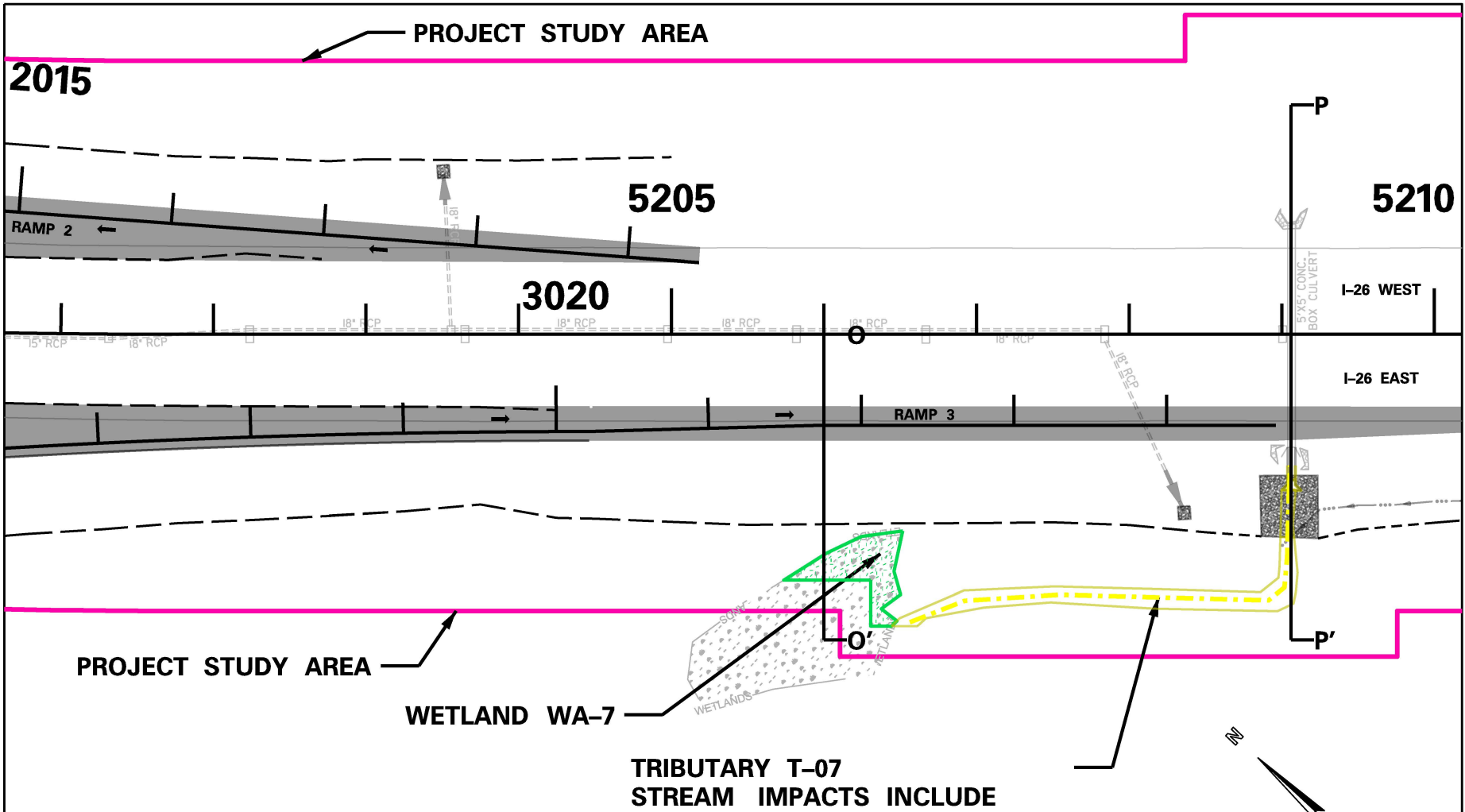

**TRIBUTARY T-07  
 STREAM IMPACTS INCLUDE  
 CULVERT EXTENSION, ARMORING,  
 AND CLEARING AS NECESSARY**

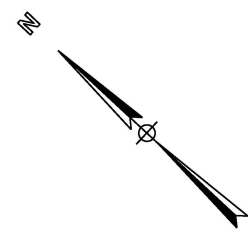

**IMPACT TOTALS: SHEET 8**

NAME	LINEAR FEET	PERMANENT FILL		EXCAVATION		CLEARING	
		SF	AC	SF	AC	SF	AC
WA-7	-	0	0.00	0	0.00	1938	0.04
T-07	331.14	-	-	-	-	-	-
<b>TOTAL IMPACTS</b>	<b>331.14</b>	<b>0</b>	<b>0.00</b>	<b>0</b>	<b>0.00</b>	<b>1938</b>	<b>0.04</b>

**PREPARED BY:  
 DAVIS &  
 FLOYD, INC.  
 CHARLESTON, SC**

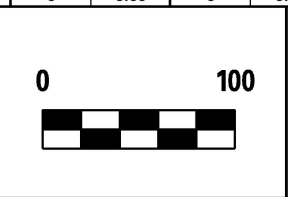

**LEGEND**

PERMANENT FILL IMPACT	RIP RAP
EXCAVATION IMPACT	WETLAND
PERMANENT CLEARING IMPACT	PROPOSED PAVEMENT
PROJECT AREA BOUNDARY	EXISTING ROAD
TRIBUTARY IMPACT	LIMITS OF CONSTRUCTION

**PALMETTO COMMERCE INTERCHANGE  
 CHARLESTON COUNTY, SC  
 APPLICATION BY CHARLESTON COUNTY  
 FEBRUARY 2020**

**WETLAND WA-7  
 TRIBUTARY T-07**

---

**SHEET 8**

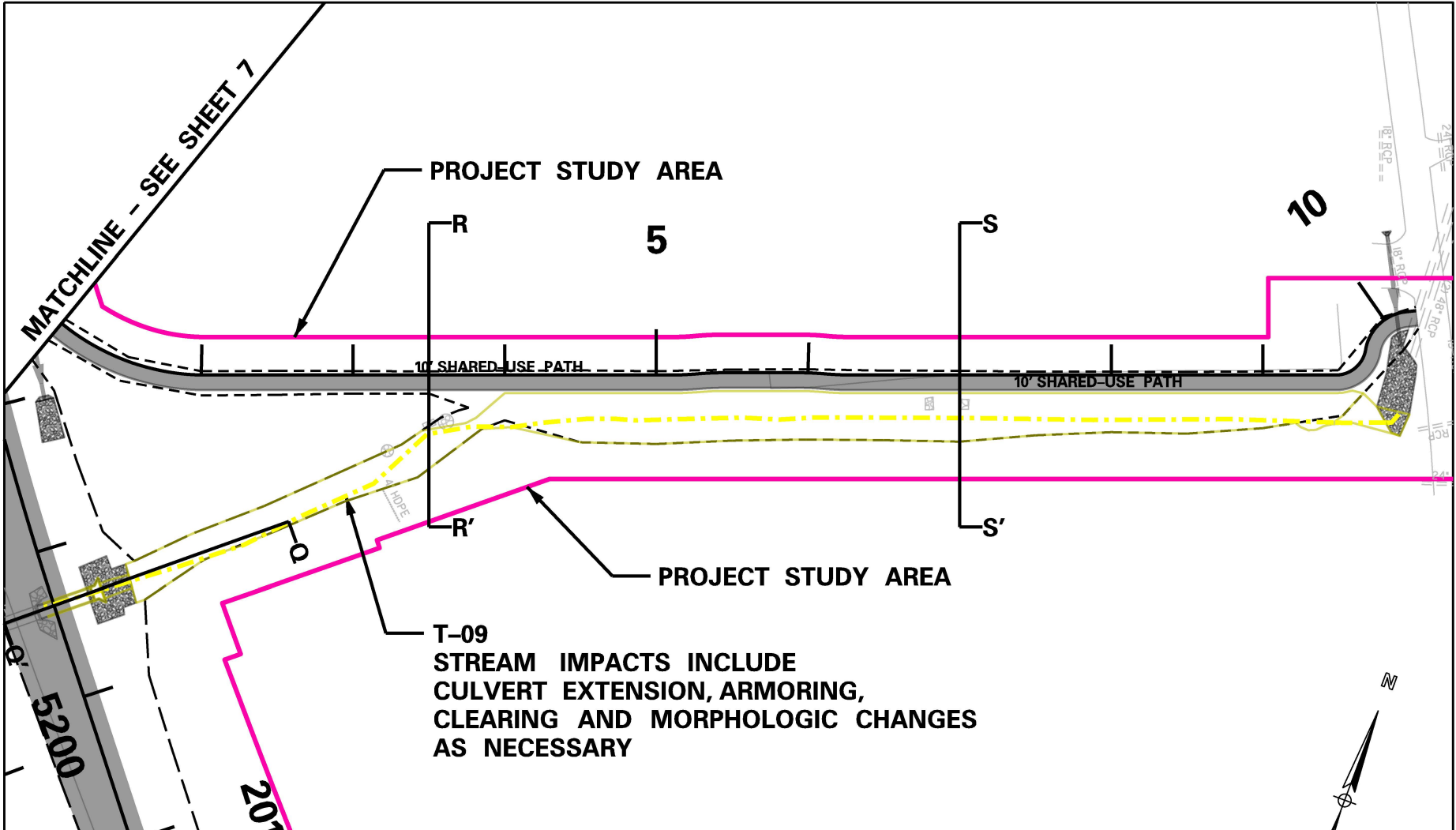

IMPACT TOTALS: SHEET 9

NAME	LINEAR FEET	PERMANENT FILL		EXCAVATION		CLEARING	
		SF	AC	SF	AC	SF	AC
T-09	926.06	-	-	-	-	-	-
<b>TOTAL IMPACTS</b>	<b>926.06</b>	<b>0</b>	<b>0.00</b>	<b>0</b>	<b>0.00</b>	<b>0</b>	<b>0.00</b>

PREPARED BY:  
DAVIS &  
FLOYD, INC.  
CHARLESTON, SC



**LEGEND**

- PERMANENT FILL IMPACT
- EXCAVATION IMPACT
- PERMANENT CLEARING IMPACT
- PROJECT AREA BOUNDARY
- TRIBUTARY IMPACT
- RIP RAP
- WETLAND
- PROPOSED PAVEMENT
- EXISTING ROAD
- LIMITS OF CONSTRUCTION

PALMETTO COMMERCE INTERCHANGE  
CHARLESTON COUNTY, SC  
APPLICATION BY CHARLESTON COUNTY  
FEBRUARY 2020

TRIBUTARY T-09

SHEET 9

LABEL	NAME	SHEET NUMBERS	LINEAR FEET	PERMITTED IMPACTS					
				PERMANENT FILL		EXCAVATION		CLEARING	
				SF	AC	SF	AC	SF	AC
Freshwater Wetland	WA-6	SHEET 3	-	2415	0.06	0	0.00	231	0.01
Freshwater Wetland	WA-8	SHEET 3	-	3357	0.08	0	0.00	603	0.01
Freshwater Wetland	WA-9	SHEET 3	-	3977	0.09	0	0.00	964	0.02
Freshwater Wetland	WA-10	SHEET 3	-	15322	0.35	1853	0.04	3640	0.08
Freshwater Wetland	WA-1	SHEET 4, SHEET 5	-	19570	0.45	22654	0.52	41091	0.94
Freshwater Wetland	WA-2	SHEET 5, SHEET 6	-	0	0.00	15747	0.36	4420	0.10
Freshwater Wetland	WA-4	SHEET 6	-	21980	0.50	2893	0.07	4771	0.11
Freshwater Wetland	WA-5	SHEET 7	-	2390	0.05	28887	0.66	2972	0.07
Freshwater Wetland	WA-11	SHEET 7	-	2080	0.05	0	0.00	0	0.00
Freshwater Wetland	WA-12	SHEET 7	-	0	0.00	328	0.01	153	0.00
Freshwater Wetland	WA-7	SHEET 8	-	0	0.00	0	0.00	1938	0.04
Tributary	T-02	SHEET 3	37.27	-	-	-	-	-	-
Tributary	T-11	SHEET 3	0	-	-	-	-	-	-
Tributary	T-12	SHEET 7	165.04	-	-	-	-	-	-
Tributary	T-07	SHEET 8	331.14	-	-	-	-	-	-
Tributary	T-09	SHEET 9	926.06	-	-	-	-	-	-
<b>TOTAL:</b>			1459.51	71091	1.63	72362	1.66	60783	1.40
<b>TOTAL WETLAND IMPACTS (AC):</b>		<b>4.69</b>							
<b>TOTAL TRIBUTARY IMPACTS (LF):</b>		<b>1459.51</b>							
<b>TOTAL PROJECT AREA (AC):</b>		<b>72.09</b>							

N.T.S.

PREPARED BY:  
DAVIS &  
FLOYD, INC.  
CHARLESTON, SC

PALMETTO COMMERCE INTERCHANGE  
CHARLESTON COUNTY, SC  
APPLICATION BY CHARLESTON COUNTY  
FEBRUARY 2020

IMPACT SUMMARY

SHEET 10

PERMANENT EXCAVATION  
 IMPACT

PERMANENT FILL IMPACT

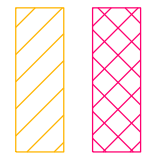

**WEBER  
 CROSS-SECTIONS**

**SHEET 11**

1" = 40'

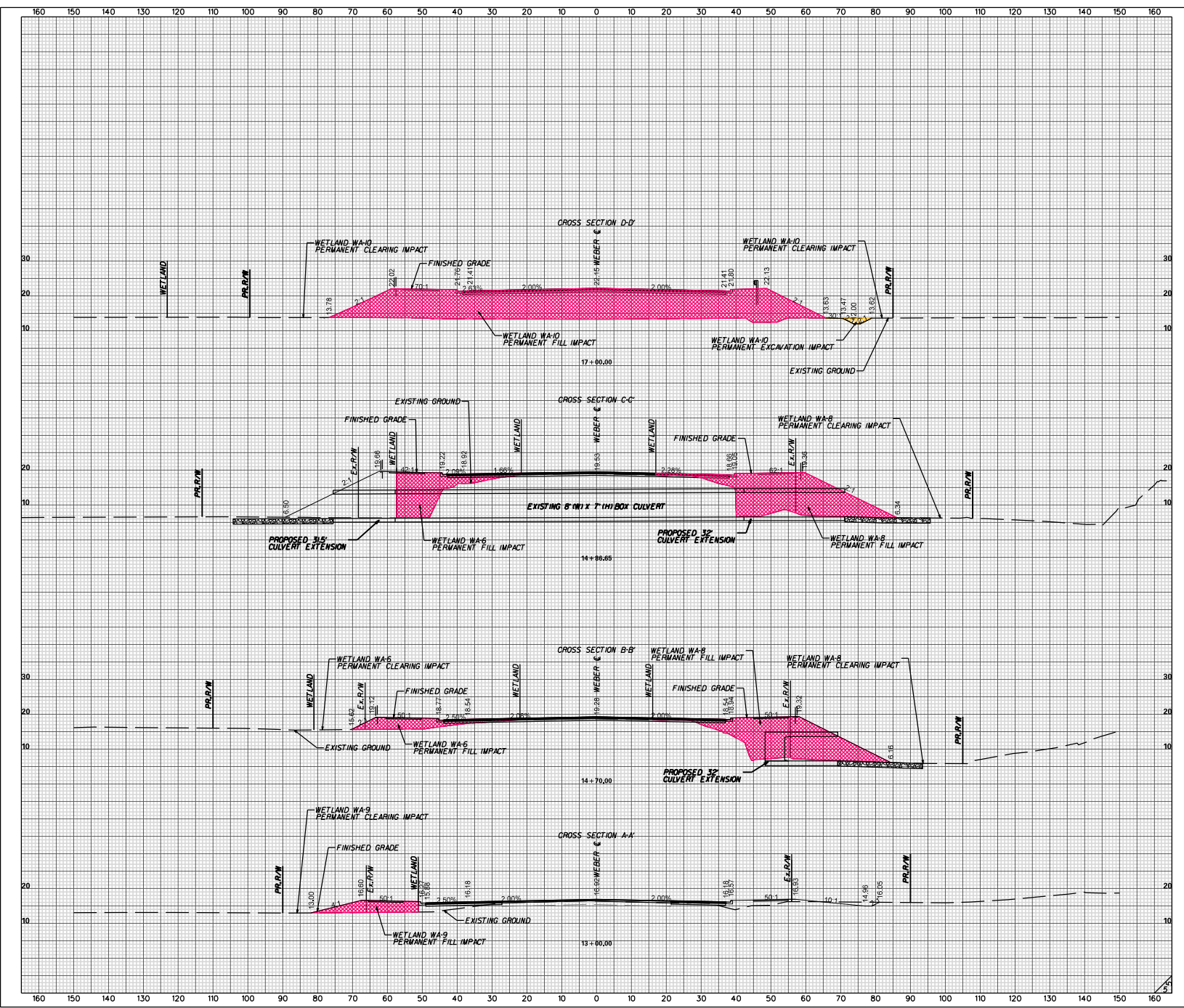



PREPARED BY:  
**DAVIS &  
 FLOYD, INC.**  
 CHARLESTON, SC

**PERMANENT EXCAVATION  
 IMPACT**

**PERMANENT FILL IMPACT**

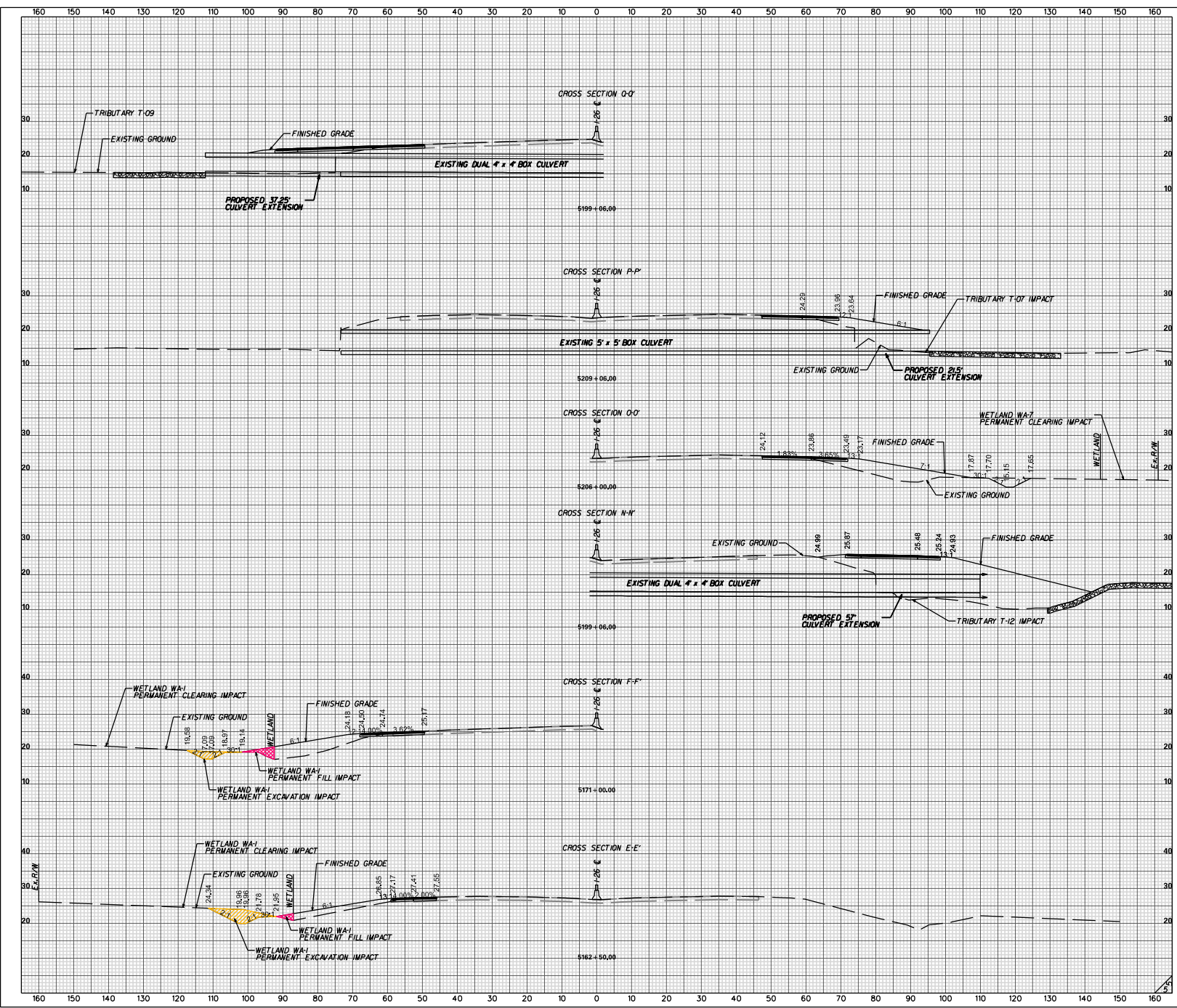
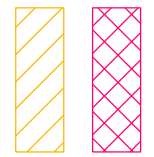

I-26  
 CROSS-SECTIONS

SHEET 12

1" = 40'

PREPARED BY:  
**DAVIS &  
 FLOYD, INC.**  
 CHARLESTON, SC

**PERMANENT EXCAVATION  
 IMPACT**

**PERMANENT FILL IMPACT**

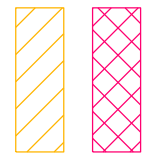

**RAMP 1  
 CROSS-SECTIONS**

**SHEET 13**

**1" = 40'**

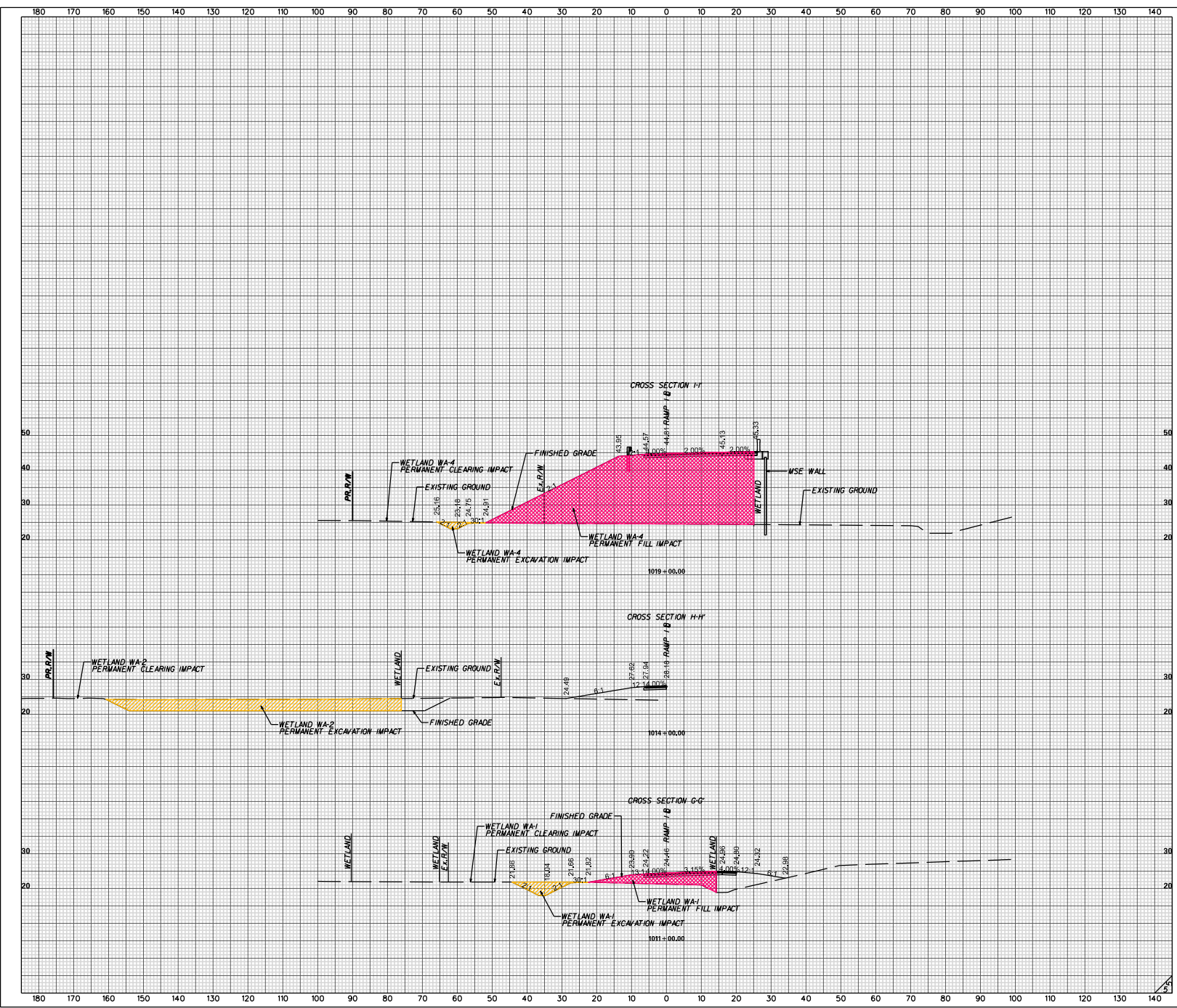

PREPARED BY:  
**DAVIS &  
 FLOYD, INC.**  
 CHARLESTON, SC

**PERMANENT EXCAVATION  
 IMPACT**

**PERMANENT FILL IMPACT**

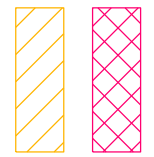

**RAMP 2  
 CROSS-SECTIONS**

**SHEET 14**

**1" = 40'**



PREPARED BY:  
**DAVIS &  
 FLOYD, INC.**  
 CHARLESTON, SC

**PERMANENT EXCAVATION  
 IMPACT**

**PERMANENT FILL IMPACT**

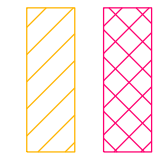

**RAMP 3  
 CROSS-SECTIONS**

**SHEET 15**

**1" = 40'**

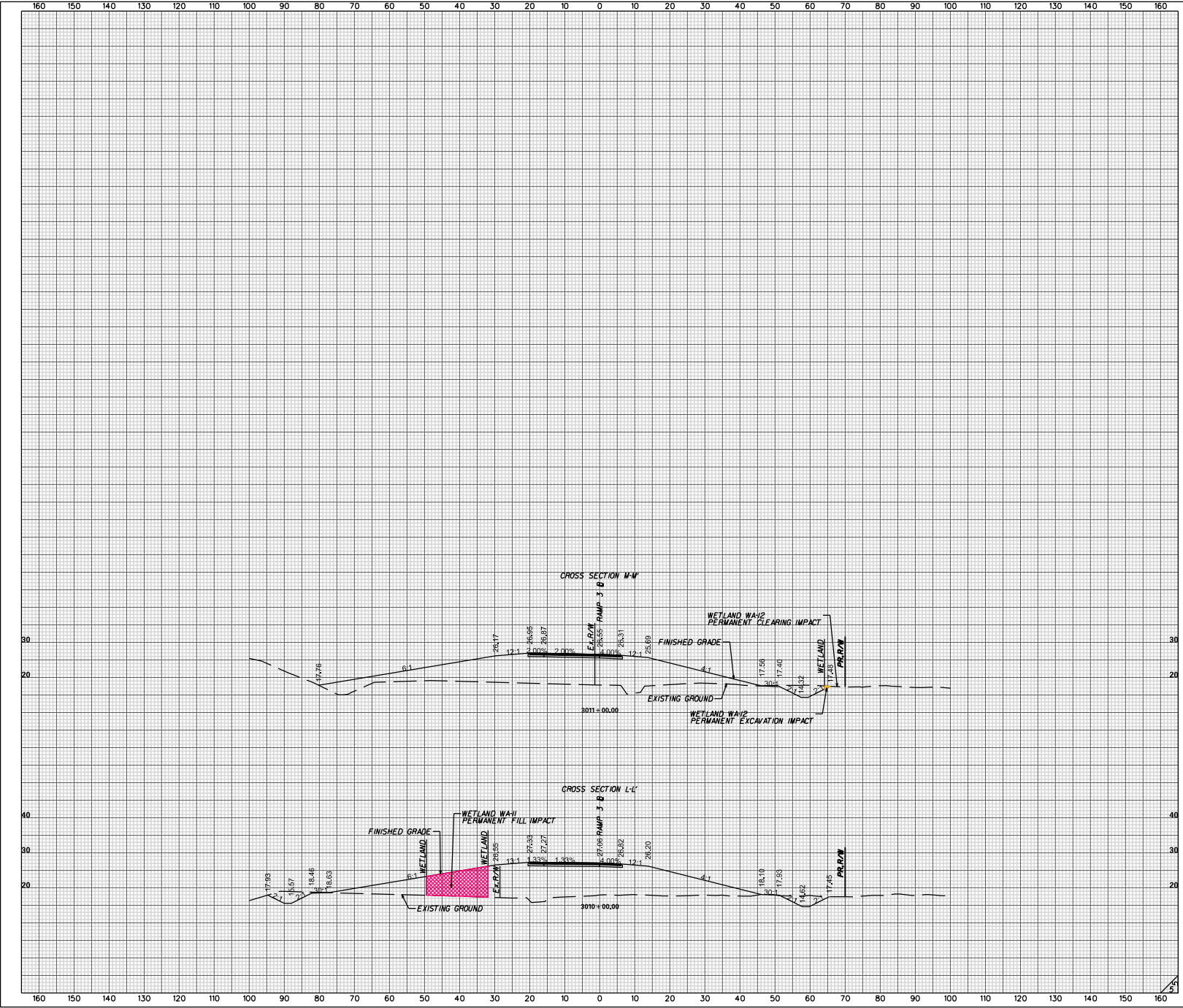

PREPARED BY:  
**DAVIS &  
 FLOYD, INC.**  
 CHARLESTON, SC

PERMANENT EXCAVATION  
 IMPACT

PERMANENT FILL IMPACT

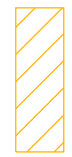

SUP  
 CROSS-SECTIONS

SHEET 16

1" = 40'

